

RM B - BUILDING

SIGN
MA 02108COMMONWEALTH OF MASSACHUSETTS
MASSACHUSETTS HISTORICAL COMMISSION
80 BOYLSTON STREET
BOSTON, MASSACHUSETTS 02116Town Arlington, MAAddress 83 Appleton StreetHistoric Name Addison Hill HouseUse: Present Multi-family residenceOriginal Residence

DESCRIPTION:

Date Early-mid 19th CenturySource Visual analysisStyle Greek Revival with Italianate elements.Architect UnknownExterior wall fabric Clapboard & Flush BoardOutbuildings Garage

Major alterations (with dates) _____

Late Victorian addition on left of house;Victorian cupola.Moved No Date N/AApprox. acreage Less than one acreSetting Set back from the street, itslawn enclosed by hedges, this house islocated in a suburban neighborhood.UTM: 19/320 550/4698820

(Staple additional sheets here)

MAR 6 1985

te)
mation
or

geographical features. Indicate
all buildings between inventoried
property and nearest intersection.
Indicate north.

Recorded by Betsy FriedbergOrganization Mass. Historical CommissionDate 12/84

ARCHITECTURAL SIGNIFICANCE (Describe important architectural features and evaluate in terms of other buildings within the community.)

Though now converted into apartments, this house remains a well-preserved and particularly opulent example of the transition from the Greek Revival to the Italianate architectural style. The contrast in siding, with clapboards set flush on the first story and overlapped on the second, the boldly bracketed architrave, and the stylish wood cupola with its wrought-iron crown (a later addition), are its most distinctive features. Unfortunately, the barn that once stood to the right and rear of the house and boasted an equally ornamented cupola, crowned by a centaur weathervane, has been demolished.

HISTORICAL SIGNIFICANCE (Explain the role owners played in local or state history and how the building relates to the development of the community.)

The original owner of this house, Addison Hill, was descended from families who in the 17th century had settled much of the area that was to become Arlington Heights and western Belmont. His own large estate extended to Massachusetts Avenue, his orchard was in the area of the present Daniels Street, and his sheep grazed where the Locke School (#569) now stands.

CRITERIA FOR EVALUATION

The Addison Hill House retains integrity of location, design, setting, materials, workmanship, feeling, and association. As a well detailed building displaying both Greek Revival and Italianate features, it meets Criterion C of the National Register of Historic Places.

BIBLIOGRAPHY and/or REFERENCES (name of publication, author, date and publisher)

Parker's History of Arlington
Cutter's History of Arlington
Assessors Records

RECEIVED
20
COMMISSION
COMMONWEALTH OF MASSACHUSETTS

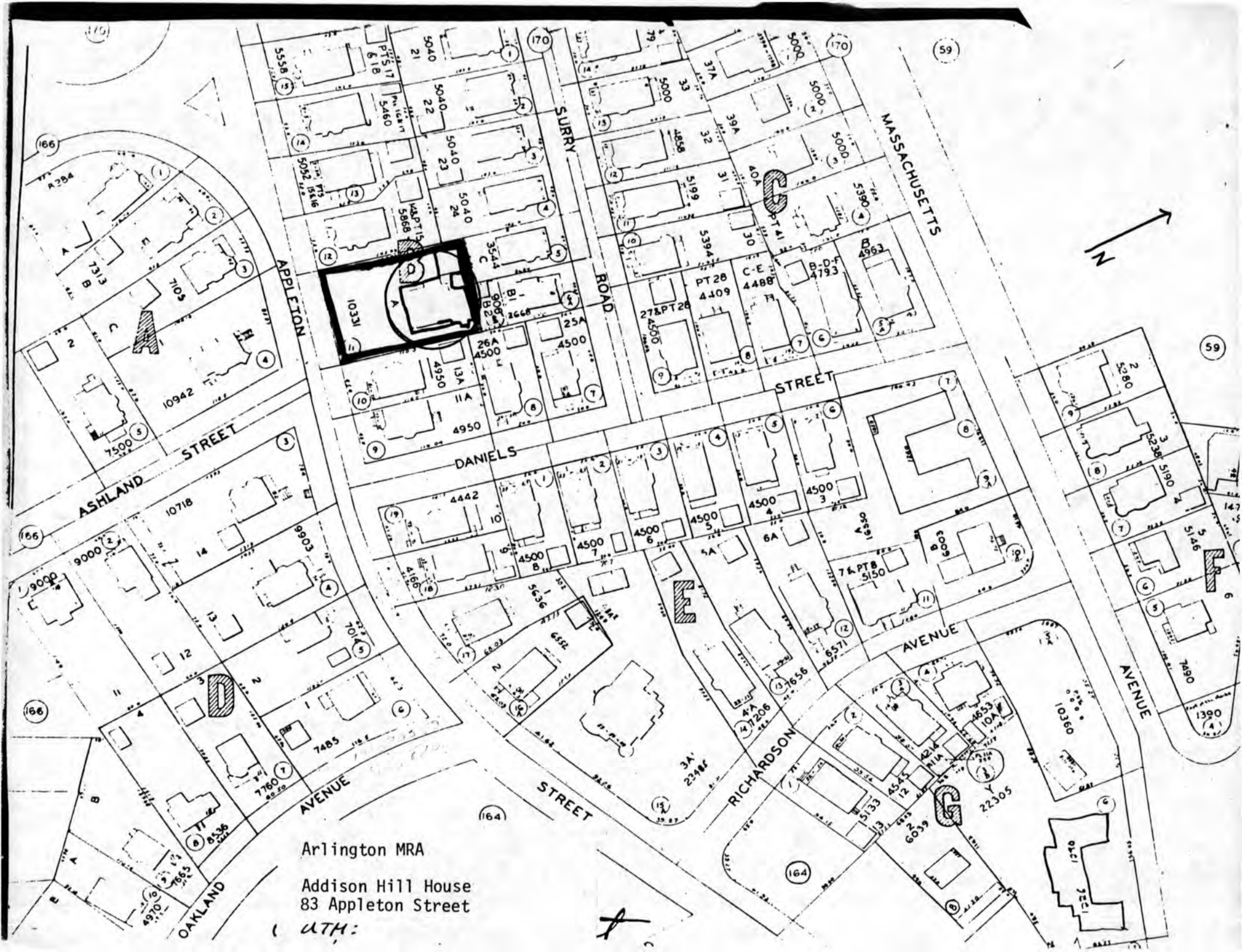

Arlington MRA

Addison Hill House
83 Appleton Street

(UTH:

NATIONAL REGISTER OF HISTORIC PLACES
EVALUATION/RETURN SHEET

Hill, Addison, House (Arlington MRA)
Middlesex County
MASSACHUSETTS

Working No. MAR 6 1985
Fed. Reg. Date: _____
Date Due: 4/4/85 - 4/20/85
Action: ACCEPT
 RETURN 4-18-85
 REJECT
Federal Agency: _____

- resubmission
- nomination by person or local government
- owner objection
- appeal

Substantive Review: sample request appeal NR decision

Reviewer's comments:

Recom./Criteria _____
Reviewer _____
Discipline _____
Date _____
_____ see continuation sheet

Nomination returned for: technical corrections cited below
 substantive reasons discussed below

1. Name

2. Location

3. Classification

| Category | Ownership Public Acquisition | Status Accessible | Present Use |
|----------|---------------------------------|----------------------|-------------|
|----------|---------------------------------|----------------------|-------------|

4. Owner of Property

5. Location of Legal Description

6. Representation in Existing Surveys

Has this property been determined eligible? yes no

7. Description

| | | | |
|--|---|--|---|
| Condition <input type="checkbox"/> excellent <input type="checkbox"/> good <input type="checkbox"/> fair | <input type="checkbox"/> deteriorated <input type="checkbox"/> ruins <input type="checkbox"/> unexposed | Check one <input type="checkbox"/> unaltered <input type="checkbox"/> altered | Check one <input type="checkbox"/> original site <input type="checkbox"/> moved date _____ |
|--|---|--|---|

Describe the present and original (if known) physical appearance

- summary paragraph
- completeness
- clarity
- alterations/integrity
- dates
- boundary selection

8. Significance

Period _____ Areas of Significance—Check and justify below

Specific dates _____ Builder/Architect _____

Statement of Significance *(in one paragraph)*

- summary paragraph
- completeness
- clarity
- applicable criteria
- justification of areas checked
- relating significance to the resource
- context
- relationship of integrity to significance
- justification of exception
- other

(in one paragraph)

9. Major Bibliographical References

10. Geographical Data

Acreage of nominated property _____

Quadrangle name _____

UTM References _____

Verbal boundary description and justification _____

11. Form Prepared By

12. State Historic Preservation Officer Certification

The evaluated significance of this property within the state is:

____ national ____ state ____ local

State Historic Preservation Officer signature

title _____ date _____

13. Other

- Maps
- Photographs
- Other

Please provide scale for maps

Questions concerning this nomination may be directed to _____

Signed *W. Byer* Date *4/18/85* Phone: _____

MASSACHUSETTS HISTORICAL COMMISSION
294 WASHINGTON STREET, BOSTON, MA 02108

COMMONWEALTH OF MASSACHUSETTS
MASSACHUSETTS HISTORICAL COMMISSION
80 BOYLSTON STREET
BOSTON, MASSACHUSETTS 02116

Town Arlington, MA

Address 83 Appleton Street

Historic Name Addison Hill House

Use: Present Multi-family residence

Original Residence

DESCRIPTION:

Date Early-mid 19th Century

Source Visual analysis

Style Greek Revival with Italianate elements.

Architect Unknown

Exterior wall fabric Clapboard & Flush Board

Outbuildings Garage

Major alterations (with dates) _____
Late Victorian addition on left of house;

Victorian cupola.

Moved No Date N/A

Approx. acreage Less than one acre

Setting Set back from the street, its lawn enclosed by hedges, this house is located in a suburban neighborhood.

UTM: 19/320550/4698820

PHOTO: (3x3" or 3x5", black & white)
staple to left side of form

Photo number _____

SKETCH MAP

Show property's location in relation to nearest cross streets and/or geographical features. Indicate all buildings between inventoried property and nearest intersection. Indicate north.

See attached map.

Recorded by Betsy Friedberg

Organization Mass. Historical Commission

Date 12/84

(Staple additional sheets here)

ARCHITECTURAL SIGNIFICANCE (Describe important architectural features and evaluate in terms of other buildings within the community.)

Though now converted into apartments, this house remains a well-preserved and particularly opulent example of the transition from the Greek Revival to the Italianate architectural style. The contrast in siding, with clapboards set flush on the first story and overlapped on the second, the boldly bracketed architrave, and the stylish wood cupola with its wrought-iron crown (a later addition), are its most distinctive features. Unfortunately, the barn that once stood to the right and rear of the house and boasted an equally ornamented cupola, crowned by a centaur weathervane, has been demolished.

HISTORICAL SIGNIFICANCE (Explain the role owners played in local or state history and how the building relates to the development of the community.)

The original owner of this house, Addison Hill, was descended from families who in the 17th century had settled much of the area that was to become Arlington Heights and western Belmont. His own large estate extended to Massachusetts Avenue, his orchard was in the area of the present Daniels Street, and his sheep grazed where the Locke School (#569) now stands.

CRITERIA FOR EVALUATION

The Addison Hill House retains integrity of location, design, setting, materials, workmanship, feeling, and association. As a well detailed building displaying both Greek Revival and Italianate features, it meets Criterion C of the National Register of Historic Places.

BIBLIOGRAPHY and/or REFERENCES (name of publication, author, date and publisher)

Parker's History of Arlington
Cutter's History of Arlington
Assessors Records

BOSTON MASSACHUSETTS STATE
BO BOSTON FREE
MASSACHUSETTS HISTORICAL COMMISSION
COMMONWEALTH OF MASSACHUSETTS

**United States Department of the Interior
National Park Service**

**National Register of Historic Places
Inventory—Nomination Form**

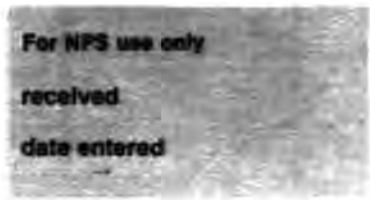

Continuation sheet

Item number

Page

Multiple Resource Area
Thematic Group

Name Arlington Multiple Resource Area
State Middlesex County, MASSACHUSETTS

Nomination/Type of Review

Date/Signature

21. First Parish Church
Parsonage

Entered in the
National Register

for Keeper

Melrose Byers 4/18/85

Attest

22. Hall, Edward, House

Entered in the
National Register

for Keeper

Melrose Byers 4/18/85

Attest

23. Highland Hose House

Entered in the
National Register

for Keeper

Melrose Byers 4/18/85

Attest

✓ 24. Hill, Addison, House

Entered in the
National Register

for Keeper

Melrose Byers 9/27/85

Attest

25. Hornblower, Edward, House
and Barn

Entered in the
National Register

for Keeper

Melrose Byers 4/18/85

Attest

26. House at 45 Claremont Avenue

Entered in the
National Register

for Keeper

Melrose Byers 4/18/85

Attest

27. House at 5--7 Winter Street

Entered in the
National Register

for Keeper

Melrose Byers 4/18/85

Attest

28. House at 5 Willow Court

Entered in the
National Register

for Keeper

Melrose Byers 4/18/85

Attest

29. Kimball, W.W., House

Entered in the
National Register

for Keeper

Melrose Byers 4/18/85

Attest

30. Locke, Lt. Benjamin, Store

Entered in the
National Register

for Keeper

Melrose Byers 4/18/85

Attest

REF #
85002682

NATIONAL REGISTER OF HISTORIC PLACES
EVALUATION/RETURN SHEET

Hill, Addison, House (Arlington MRA)
Middlesex County
MASSACHUSETTS

Working No. 3/6/85
Fed. Reg. Date: 2/4/84
Date Due: 9/28/85
Action: ACCEPT 9-27-85 o/c
 RETURN
 REJECT
Federal Agency: _____

Entered in the
National Register

- resubmission
- nomination by person or local government
- owner objection
- appeal

Substantive Review: sample request appeal NR decision

Reviewer's comments:

Recom./Criteria _____
Reviewer _____
Discipline _____
Date _____
_____ see continuation sheet

Nomination returned for: _____ technical corrections cited below
_____ substantive reasons discussed below

1. Name

2. Location

3. Classification

| Category | Ownership Public Acquisition | Status Accessible | Present Use |
|----------|---------------------------------|----------------------|-------------|
| | | | |

4. Owner of Property

5. Location of Legal Description

6. Representation in Existing Surveys

Has this property been determined eligible? yes no

7. Description

| | | |
|------------------------------------|---------------------------------------|---|
| Condition | Check one | Check one |
| <input type="checkbox"/> excellent | <input type="checkbox"/> deteriorated | <input type="checkbox"/> original site |
| <input type="checkbox"/> good | <input type="checkbox"/> ruins | <input type="checkbox"/> moved date _____ |
| <input type="checkbox"/> fair | <input type="checkbox"/> unexposed | |
| | <input type="checkbox"/> unaltered | |
| | <input type="checkbox"/> altered | |

Describe the present and original (if known) physical appearance

- summary paragraph
- completeness
- clarity
- alterations/integrity
- dates
- boundary selection

8. Significance

Period _____ Areas of Significance—Check and justify below

Specific dates _____ Builder/Architect _____

Statement of Significance (*in one paragraph*) _____

- summary paragraph
- completeness
- clarity
- applicable criteria
- justification of areas checked
- relating significance to the resource
- context
- relationship of integrity to significance
- justification of exception
- other

9. Major Bibliographical References

10. Geographical Data

Acreage of nominated property _____

Quadrangle name _____

UTM References _____

Verbal boundary description and justification _____

11. Form Prepared By

12. State Historic Preservation Officer Certification

The evaluated significance of this property within the state is:

____ national ____ state ____ local

State Historic Preservation Officer signature _____

title _____ date _____

13. Other

- Maps
- Photographs
- Other

Questions concerning this nomination may be directed to _____

Signed _____ Date _____ Phone: _____



Addison Hill House, Arlington MRA, MA

421

83 Appleton St

694M

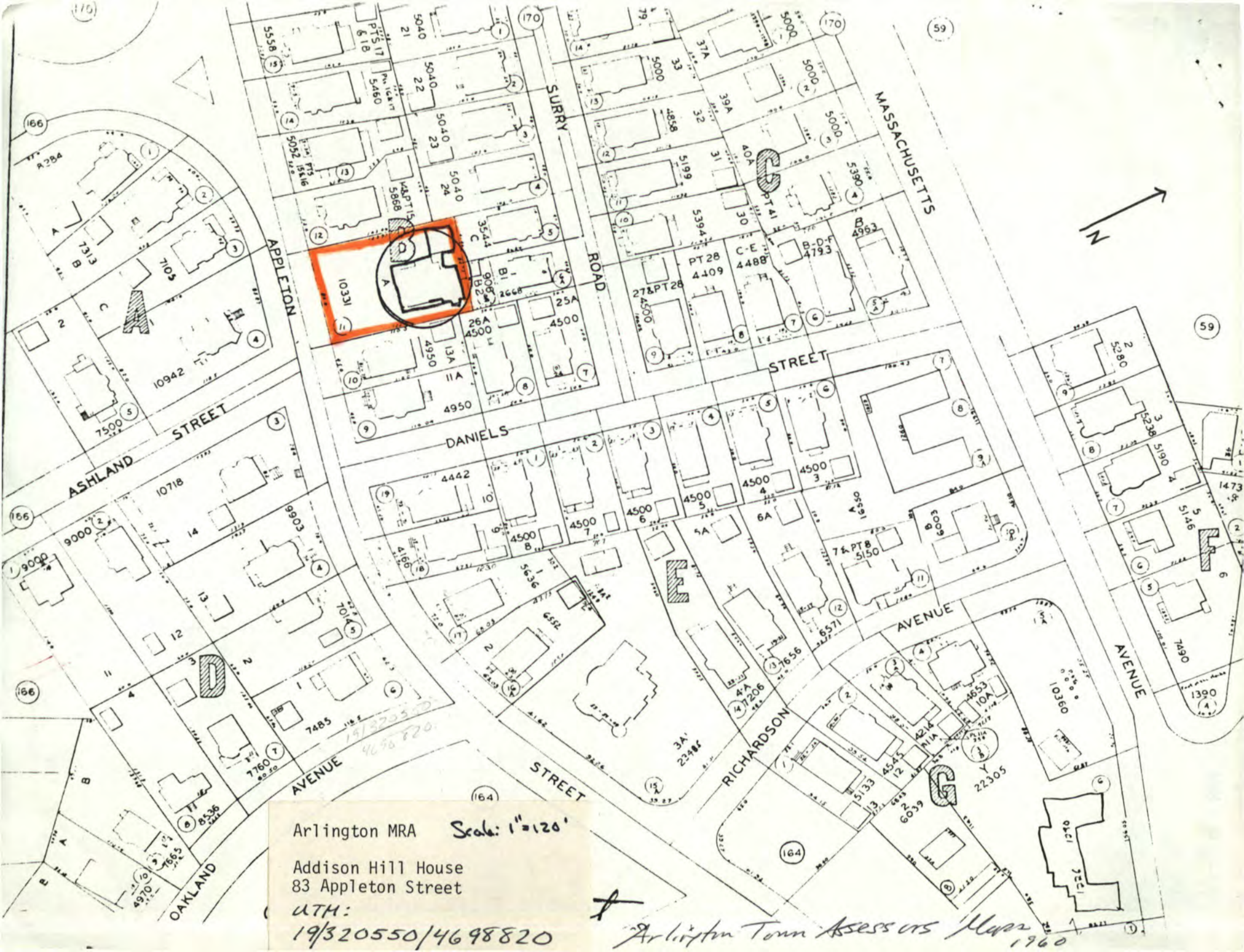

Arlington MRA Scale: 1"=120'
 Addison Hill House
 83 Appleton Street
 UTM:
 19/320550/4698820

*
 Arlington Town Assessors Map 1960

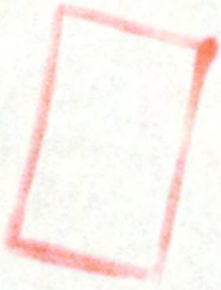

MAR 6 1985