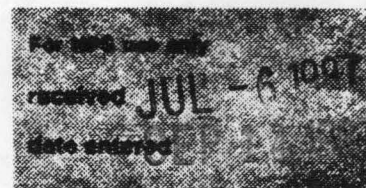

United States Department of the Interior
National Park ServiceNational Register of Historic Places
Inventory—Nomination Form

Continuation sheet

Item number 7 & 8

Page 9

INDIVIDUAL DATA SHEET

SURVEY NUMBER 0039
PROPERTY NAME Borum Building
LOCATION 201 W. Hale
CONSTRUCTION DATE 1902

PROPERTY OWNER Dr. Eldon Fairley
ADDRESS 710 W. Keiser
Osceola, AR

DESCRIPTION

When Osceola began laying out the new townsite at the turn of the century, the Borum Building was among the first brick structures to be constructed. Built in 1902, this two-story building is of brick construction with a parapet on the facade (north elevation). The rooflines of the east and west elevations feature long, graduated steps punctuated by chimney vents. This large rectangular structure is distinguished by the second story of the facade which is visually divided into three bays by simple brick pilasters. Pairings of sash windows topped by simple brick arches appear on the second story. A band of decorative brickwork is featured at the top of recessed areas in the three bays. A stone band outlines the top of the building. In 1904 a one-story addition was constructed on the west elevation. This addition features the same recessed bays, decorative brickwork on the cornice, and stone banding across the top as the original two-story building.

SIGNIFICANCE

One of the first brick buildings in Osceola's "new town", the two-story Borum Store, was built in 1902 at a cost of \$3,450. The first story of this building contained the "most-to-date" ladies ready-to-wear and millinery establishment in the county. The owners, Mr. and Mrs. James D. Borum, lived in the spacious apartment in the second story of the building. Mrs. Borum continued to live in the apartment until the 1950's. Early interior photographs of the Borum Store show elaborate Victorian decorations and displays. This building represents the beginnings of the successful shift of the city's downtown closer to the railroad line. The Borum Building is an anchor to the east corner of the one block district on Hale Avenue. Of brick construction, this two-story building features modest decorative features and its vernacular small town business style typifies the turn of the century growth in Osceola.

ACREAGE less than oneVERBAL BOUNDARY DESCRIPTION Lots 1 & 2, Block 19, Townsite AdditionQUADRANGLE NAME Osceola, AR-TN QUADRANGLE SCALE 1:24000UTM REFERENCE: ZONE 16 EASTING NORTHING

** see district boundary references -- Item 10

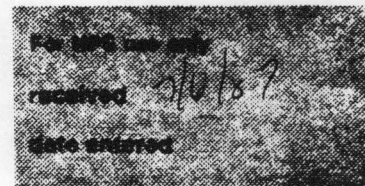
United States Department of the Interior
National Park ServiceNational Register of Historic Places
Inventory—Nomination Form

Continuation sheet

Item number 7 & 8

Page 10

INDIVIDUAL DATA SHEET

PROPERTY NUMBER	0040	PROPERTY OWNER	Henry Patterson
PROPERTY NAME	Patterson Building	ADDRESS	319 N. Maple
LOCATION	200 block, Hale Ave.		Osceola, AR
CONSTRUCTION DATE	1902		

DESCRIPTION

The Patterson Building is a one-story brick store built in 1902. The simple vernacular styling of this building features an original wood storefront with cast iron columns and plate glass windows on the display bays. A parapet rises from the center of the facade roofline above the brick dentiled cornice. Located in this parapet is a stone panel inscribed "Patterson Building 1902". Identical to the building constructed next door by Fred Patterson two years later, the facade of the 1902 Patterson Building is articulated into three bays by four brick pilasters; two are located on the ends of the building and two flank the parapet. A band of brick corbelling marks the upper portion of the building, above which metal vents appear in the outer bays. The wood awning supported by single wood posts is identical to the original. This awning covers the sidewalk in front of the store. The sidewalk on Hale Avenue in front of the two Patterson Buildings is stepped down to the street, distinguishing these stores' original appearance from adjacent historic structures.

SIGNIFICANCE

As one of the first businesses in Osceola's "new town" at the turn of the century, the Patterson Building significantly contributes to the architectural composition and history of the town's move to accommodate the railroad. Constructed in 1902, this building remains unaltered as has its companion building next door constructed in 1904. Of simple vernacular design, this brick building has been continuously operated as the same business by the same family for over 80 years.

ACREAGE less than one

VERBAL BOUNDARY DESCRIPTION Lot 3, Block 19, Townsite Addition

QUADRANGLE NAME Osceola, AR-TN

QUADRANGLE SCALE 1:24000

UTM REFERENCE: **ZONE 16

EASTING

NORTHING

** see district boundary references -- Item 10

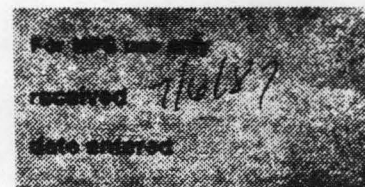
United States Department of the Interior
National Park ServiceNational Register of Historic Places
Inventory—Nomination Form

Continuation sheet

Item number 7 & 8

Page 11

INDIVIDUAL DATA SHEET

SURVEY NUMBER 0041
PROPERTY NAME Fred Patterson Store
LOCATION 200 block, Hale Ave.
CONSTRUCTION DATE 1904

PROPERTY OWNER Henry Patterson
ADDRESS 319 N. Maple
Osceola, AR

DESCRIPTION

In 1904, Fred Patterson built a store almost identical to the Patterson Building (0040), constructed in 1902. The 1904 building is one story of red brick construction, resting on a brick foundation. As in its companion store, the facade (north elevation) of the Fred Patterson Store is divided into three bays by brick pilasters with corbelled caps. This building also features an arched parapet flanked by brick pilasters. The stone panel located under the parapet is inscribed "Fred Patterson 1904". A shed roof wood awning covers the sidewalk in front of these buildings, supported by wood columns set into brick bases. The building features original display windows with plate glass and cast iron columns. The interiors of both buildings are unaltered and are an accurate and unique reflection of small town business in the early twentieth century.

SIGNIFICANCE

The Fred Patterson Store, constructed in 1904, reflects the historic significance of early business operated in Osceola's "new town". Built two years after construction of Fred Patterson's first store (0040), this building reflects the successful attempt to relocate the town's business section closer to the railroad lines at the turn of the century. Indicative of early twentieth century commercial vernacular styling, the building features an arched parapet rising from the center of the roofline and is distinguished by its unaltered condition, complete with the original storefront plate glass window display areas. Owned and operated by Henry Patterson, the son of the builder, the building represents a successful business which has resisted changes in its 80 years of operation. This building presents an original version of an early twentieth century dry goods store and reflects an unbroken stability in Osceola's historic business district. The building is unaltered and its interior includes original furnishings, lighting, and wood-burning stove (a traditional local winter gathering spot).

ACREAGE less than oneVERBAL BOUNDARY DESCRIPTION Lot 4, Block 19, Townsite AdditionQUADRANGLE NAME Osceola, AR-TNQUADRANGLE SCALE 1:24000UTM REFERENCE: **ZONE 16 EASTING NORTHING

** see district boundary references -- Item 10

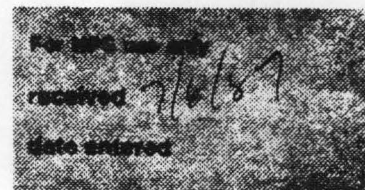
United States Department of the Interior
National Park ServiceNational Register of Historic Places
Inventory—Nomination Form

Continuation sheet

Item number 7 & 8

Page 12

INDIVIDUAL DATA SHEET

SURVEY NUMBER 0042

PROPERTY OWNER Robbins Brothers

PROPERTY NAME Hubbard and Hoke

ADDRESS 800 W. Keiser

LOCATION 213 W. Hale

Osceola, AR

CONSTRUCTION DATE 1917

DESCRIPTION

Serving as a link in the Hale Street district, the Hubbard and Hoke building was constructed in 1917 to house the Bryan and Hook Dry Goods Store. This one-story flat-roofed building is of simple functional design and is devoid of ornamentation. A stone string course runs across the upper section of the facade (north elevation) above the metal awning. Another string course appears toward the top of the structure, giving the portion above it a parapet-like appearance. These string courses provide a visual break from the otherwise plain expanse of brick facade.

SIGNIFICANCE

The Hubbard and Hoke building, constructed in 1917, has been a consistent part of the Hale Avenue commercial district. When this building was constructed it was described as having fixtures of the very latest type in Flemish Oak, giving the interior a metropolitan appearance. The structure's uniqueness in 1917 was the immense plate glass front in which displays were arranged so as to attract customers. The Hubbard and Hoke building has consistently remained a viable part of downtown Osceola commerce. Although simple in design and altered in the store front display area, this building serves as a link for the other buildings on the South side of Hale Avenue.

ACREAGE less than one

VERBAL BOUNDARY DESCRIPTION Lots 5 & 6, Block 19, Townsite Addition

QUADRANGLE NAME Osceola, AR-TN

QUADRANGLE SCALE 1:24000

UTM REFERENCE: ** ZONE 16 EASTING NORTHING

** see district boundary reference -- Item 10

United States Department of the Interior
National Park ServiceNational Register of Historic Places
Inventory—Nomination Form

Continuation sheet

Item number 7 & 8

Page 13

INDIVIDUAL DATA SHEET

SURVEY NUMBER 0043
PROPERTY NAME Coston Building
LOCATION 217 W. Hale
CONSTRUCTION DATE 1915

PROPERTY OWNER Ronnie Sorrells
ADDRESS 307 E. Semmes
Osceola, AR

DESCRIPTION

Located in the block across Hale Avenue from the Mississippi County Courthouse (0011, N.R. 1978), the Coston Building is a two-story flat-roofed structure built in 1915. This building is of brick construction with the front elevation (north) facaded with cut mortar blocks. The facade is vertically articulated on each end by brick block piers. These piers are topped with corbelled caps, which extend from the roof of the building to the height of the center parapet. The plain parapet, also of brick block, rises from the center of the facade. A stone panel is placed under the parapet, and is inscribed "19 COSTON 15". The first floor store front features plate glass window display areas and is covered by an added canvas awning. Four plate glass sash windows are evenly spaced across the second story. These are set into recessed areas outlined in vertically-set block bricks. A brick ledge runs beneath the windows and defines a narrow recessed area.

SIGNIFICANCE

The Coston building is architecturally significant in the built environment of Osceola. It was constructed in 1915 by Joseph T. Coston, an attorney who had moved to Osceola before the turn of the century. Coston, a native of Franklin County, Tennessee, was a graduate of Vanderbilt University in Nashville. After relocation in Osceola, Coston had a number of prestigious clients; among them was plantation owner R. E. Lee Wilson of Wilson, Arkansas. Wilson's land was greatly affected by the continual flooding, and he encouraged Coston to become involved in the efforts to improve drainage in Mississippi County. Coston was a well-liked man who attained much of his local notoriety from his successful dealings in support of drainage districts. The Coston building is one of the more notable buildings in the commercial district, reflecting the solidity of the Courthouse across the street in its brick block construction.

ACREAGE less than oneVERBAL BOUNDARY DESCRIPTION Lot 7, Block 19, Townsite AdditionQUADRANGLE NAME Osceola, AR-TNQUADRANGLE SCALE 1:24000UTM REFERENCE: ****ZONE** 16EASTING NORTHING

** see district boundary references -- Item 10

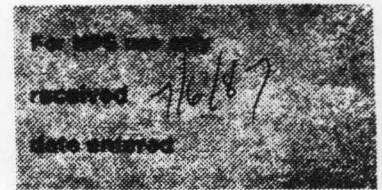
United States Department of the Interior
National Park ServiceNational Register of Historic Places
Inventory—Nomination Form

Continuation sheet

Item number 7 & 8

Page 14

INDIVIDUAL DATA SHEET

SURVEY NUMBER <u>0044</u>	PROPERTY OWNER <u>Reggie Collom</u>
PROPERTY NAME <u>Raines Play House</u>	ADDRESS <u>119 East Drive</u>
LOCATION <u>216 W. Hale</u>	<u>Osceola, AR</u>
CONSTRUCTION DATE <u>1915</u>	

DESCRIPTION

Constructed in 1915, the Raines Play House (which derives its name from more recent usage), was built to house Osceola's post office. Designed and built by Memphis architect G. C. Parlow, this one story 26' by 70' building is constructed of brick and on the facade (north elevation) is faced with cut mortar block. The entrance to this building is flanked by fluted pilasters topped by Ionic capitals and set in stone block bases. On either edge of the building are one-story pilasters of cut block with corbelled caps. Double-hung plate glass windows flanking the entrance feature large multi-paned transoms. The decorative cornice of cut mortar block features bands of dentiling in two sizes. A slight parapet rises from the center of the roofline. The original structure featured two 4' by 8' skylights supplemented by electric light fixtures. The mosaic tile floor and steam heat contributed to the building's notoriety at the time of its construction.

SIGNIFICANCE

When businesses began moving west of the railroad tracks to "new town", a point of contention was the location of the post office. References in the Osceola Times shortly after the turn of the century point out the constant moving of the town's post office from one building to another. Weekly issues of the paper at that time featured articles entitled "Where is The Post Office This Week". In 1915 funds for building a post office were finally secured and the city employed the talents of a Memphis architect, G. C. Parlow, to erect the structure. Parlow, who was also working on the adjacent Coston office building, used the same cut mortar block to face the north elevation of the one-story post office. This building provided long-needed stability in the postal service of the small town. Elegant in its decorative facade, with fluted columns and such modern features as electric lights and a mosaic tile floor, this building now presents a unique character within the Hale Street district.

ACREAGE less than one**VERBAL BOUNDARY DESCRIPTION** Lot 8, Block 19, Townsite Addition**QUADRANGLE NAME** Osceola, AR-TN **QUADRANGLE SCALE** 1:24000**UTM REFERENCE: **ZONE** 16 **EASTING** **NORTHING**

** see district boundary references -- Item 10

87001349

NATIONAL REGISTER OF HISTORIC PLACES
EVALUATION/RETURN SHEET

Hale Avenue Historic District (Osceola MRA)
Mississippi County
ARKANSAS

JUL - 6 1987

Working No. _____
Fed. Reg. Date: _____
Date Due: 8/6/87 - 8/20/87
Action: ACCEPT
RETURN 8-6-87
REJECT
Federal Agency: _____

- ☐ resubmission
☐ nomination by person or local government
☐ owner objection
☐ appeal

Substantive Review: ☐ sample ☐ request ☐ appeal ☐ NR decision

Reviewer's comments:

Recom./Criteria _____
Reviewer _____
Discipline _____
Date _____
_____ see continuation sheet

Nomination returned for: X technical corrections cited below
_____ substantive reasons discussed below

1. Name

2. Location

3. Classification

Category	Ownership Public Acquisition	Status Accessible	Present Use

4. Owner of Property

5. Location of Legal Description

6. Representation in Existing Surveys

Has this property been determined eligible? ☐ yes ☐ no

7. Description

Condition	Check one	Check one
<input type="checkbox"/> excellent	<input type="checkbox"/> deteriorated	<input type="checkbox"/> original site
<input type="checkbox"/> good	<input type="checkbox"/> ruins	<input type="checkbox"/> moved date _____
<input type="checkbox"/> fair	<input type="checkbox"/> unexposed	
	<input type="checkbox"/> unaltered	
	<input type="checkbox"/> altered	

Describe the present and original (if known) physical appearance

- ☐ summary paragraph
☐ completeness
☐ clarity
☐ alterations/integrity
☐ dates
☐ boundary selection

8. Significance

Period Areas of Significance—Check and justify below

Specific dates

Builder/Architect

Statement of Significance (in one paragraph)

- ☐ summary paragraph
- ☐ completeness
- ☐ clarity
- ☐ applicable criteria
- ☐ justification of areas checked
- ☐ relating significance to the resource
- ☐ context
- ☐ relationship of integrity to significance
- ☐ justification of exception
- ☐ other

9. Major Bibliographical References

10. Geographical Data

✓ Acreage of nominated property

Quadrangle name

UTM References

Verbal boundary description and justification

11. Form Prepared By

12. State Historic Preservation Officer Certification

The evaluated significance of this property within the state is:

____ national ____ state ____ local

State Historic Preservation Officer signature

title

date

13. Other

- ☐ Maps
- ☐ Photographs
- ☐ Other

Questions concerning this nomination may be directed to

Signed

Date

Phone:

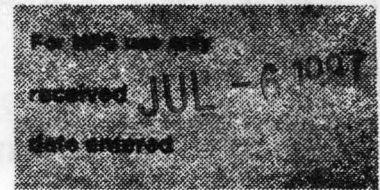
United States Department of the Interior
National Park ServiceNational Register of Historic Places
Inventory—Nomination Form

Continuation sheet

Item number 7 & 8

Page 9

INDIVIDUAL DATA SHEET

SURVEY NUMBER	0039	PROPERTY OWNER	Dr. Eldon Fairley
PROPERTY NAME	Borum Building	ADDRESS	710 W. Keiser
LOCATION	201 W. Hale		Osceola, AR
CONSTRUCTION DATE	1902		

DESCRIPTION

When Osceola began laying out the new townsite at the turn of the century, the Borum Building was among the first brick structures to be constructed. Built in 1902, this two-story building is of brick construction with a parapet on the facade (north elevation). The rooflines of the east and west elevations feature long, graduated steps punctuated by chimney vents. This large rectangular structure is distinguished by the second story of the facade which is visually divided into three bays by simple brick pilasters. Pairings of sash windows topped by simple brick arches appear on the second story. A band of decorative brickwork is featured at the top of recessed areas in the three bays. A stone band outlines the top of the building. In 1904 a one-story addition was constructed on the west elevation. This addition features the same recessed bays, decorative brickwork on the cornice, and stone banding across the top as the original two-story building.

SIGNIFICANCE

One of the first brick buildings in Osceola's "new town", the two-story Borum Store, was built in 1902 at a cost of \$3,450. The first story of this building contained the "most-to-date" ladies ready-to-wear and millinery establishment in the county. The owners, Mr. and Mrs. James D. Borum, lived in the spacious apartment in the second story of the building. Mrs. Borum continued to live in the apartment until the 1950's. Early interior photographs of the Borum Store show elaborate Victorian decorations and displays. This building represents the beginnings of the successful shift of the city's downtown closer to the railroad line. The Borum Building is an anchor to the east corner of the one block district on Hale Avenue. Of brick construction, this two-story building features modest decorative features and its vernacular small town business style typifies the turn of the century growth in Osceola.

ACREAGE less than one

VERBAL BOUNDARY DESCRIPTION Lots 1 & 2, Block 19, Townsite Addition

QUADRANGLE NAME Osceola, AR-TN

QUADRANGLE SCALE 1:24000

UTM REFERENCE: ZONE 16

EASTING

NORTHING

** see district boundary references -- Item 10

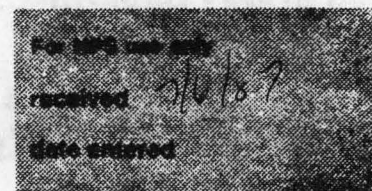
United States Department of the Interior
National Park ServiceNational Register of Historic Places
Inventory—Nomination Form

Continuation sheet

Item number 7 & 8

Page 10

INDIVIDUAL DATA SHEET

PROPERTY NUMBER	0040	PROPERTY OWNER	Henry Patterson
PROPERTY NAME	Patterson Building	ADDRESS	319 N. Maple
LOCATION	200 block, Hale Ave.		Osceola, AR
CONSTRUCTION DATE	1902		

DESCRIPTION

The Patterson Building is a one-story brick store built in 1902. The simple vernacular styling of this building features an original wood storefront with cast iron columns and plate glass windows on the display bays. A parapet rises from the center of the facade roofline above the brick dentiled cornice. Located in this parapet is a stone panel inscribed "Patterson Building 1902". Identical to the building constructed next door by Fred Patterson two years later, the facade of the 1902 Patterson Building is articulated into three bays by four brick pilasters; two are located on the ends of the building and two flank the parapet. A band of brick corbelling marks the upper portion of the building, above which metal vents appear in the outer bays. The wood awning supported by single wood posts is identical to the original. This awning covers the sidewalk in front of the store. The sidewalk on Hale Avenue in front of the two Patterson Buildings is stepped down to the street, distinguishing these stores' original appearance from adjacent historic structures.

SIGNIFICANCE

As one of the first businesses in Osceola's "new town" at the turn of the century, the Patterson Building significantly contributes to the architectural composition and history of the town's move to accommodate the railroad. Constructed in 1902, this building remains unaltered as has its companion building next door constructed in 1904. Of simple vernacular design, this brick building has been continuously operated as the same business by the same family for over 80 years.

ACREAGE less than one

VERBAL BOUNDARY DESCRIPTION Lot 3, Block 19, Townsite Addition

QUADRANGLE NAME Osceola, AR-TN

QUADRANGLE SCALE 1:24000

UTM REFERENCE: **ZONE 16

EASTING

NORTHING

** see district boundary references -- Item 10

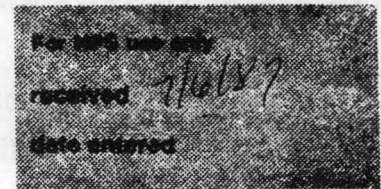
United States Department of the Interior
National Park ServiceNational Register of Historic Places
Inventory—Nomination Form

Continuation sheet

Item number 7 & 8

Page 11

INDIVIDUAL DATA SHEET

SURVEY NUMBER	0041	PROPERTY OWNER	Henry Patterson
PROPERTY NAME	Fred Patterson Store	ADDRESS	319 N. Maple
LOCATION	200 block, Hale Ave.		Osceola, AR
CONSTRUCTION DATE	1904		

DESCRIPTION

In 1904, Fred Patterson built a store almost identical to the Patterson Building (0040), constructed in 1902. The 1904 building is one story of red brick construction, resting on a brick foundation. As in its companion store, the facade (north elevation) of the Fred Patterson Store is divided into three bays by brick pilasters with corbelled caps. This building also features an arched parapet flanked by brick pilasters. The stone panel located under the parapet is inscribed "Fred Patterson 1904". A shed roof wood awning covers the sidewalk in front of these buildings, supported by wood columns set into brick bases. The building features original display windows with plate glass and cast iron columns. The interiors of both buildings are unaltered and are an accurate and unique reflection of small town business in the early twentieth century.

SIGNIFICANCE

The Fred Patterson Store, constructed in 1904, reflects the historic significance of early business operated in Osceola's "new town". Built two years after construction of Fred Patterson's first store (0040), this building reflects the successful attempt to relocate the town's business section closer to the railroad lines at the turn of the century. Indicative of early twentieth century commercial vernacular styling, the building features an arched parapet rising from the center of the roofline and is distinguished by its unaltered condition, complete with the original storefront plate glass window display areas. Owned and operated by Henry Patterson, the son of the builder, the building represents a successful business which has resisted changes in its 80 years of operation. This building presents an original version of an early twentieth century dry goods store and reflects an unbroken stability in Osceola's historic business district. The building is unaltered and its interior includes original furnishings, lighting, and wood-burning stove (a traditional local winter gathering spot).

ACREAGE less than one

VERBAL BOUNDARY DESCRIPTION Lot 4, Block 19, Townsite Addition

QUADRANGLE NAME Osceola, AR-TN

QUADRANGLE SCALE 1:24000

UTM REFERENCE: **ZONE 16

EASTING

NORTHING

** see district boundary references -- Item 10

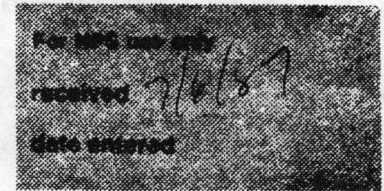
United States Department of the Interior
National Park ServiceNational Register of Historic Places
Inventory—Nomination Form

Continuation sheet

Item number 7 & 8

Page 12

INDIVIDUAL DATA SHEET

SURVEY NUMBER 0042
PROPERTY NAME Hubbard and Hoke
LOCATION 213 W. Hale
CONSTRUCTION DATE 1917

PROPERTY OWNER Robbins Brothers
ADDRESS 800 W. Keiser
Osceola, AR

DESCRIPTION

Serving as a link in the Hale Street district, the Hubbard and Hoke building was constructed in 1917 to house the Bryan and Hook Dry Goods Store. This one-story flat-roofed building is of simple functional design and is devoid of ornamentation. A stone string course runs across the upper section of the facade (north elevation) above the metal awning. Another string course appears toward the top of the structure, giving the portion above it a parapet-like appearance. These string courses provide a visual break from the otherwise plain expanse of brick facade.

SIGNIFICANCE

The Hubbard and Hoke building, constructed in 1917, has been a consistent part of the Hale Avenue commercial district. When this building was constructed it was described as having fixtures of the very latest type in Flemish Oak, giving the interior a metropolitan appearance. The structure's uniqueness in 1917 was the immense plate glass front in which displays were arranged so as to attract customers. The Hubbard and Hoke building has consistently remained a viable part of downtown Osceola commerce. Although simple in design and altered in the store front display area, this building serves as a link for the other buildings on the South side of Hale Avenue.

ACREAGE less than oneVERBAL BOUNDARY DESCRIPTION Lots 5 & 6, Block 19, Townsite AdditionQUADRANGLE NAME Osceola, AR-TN QUADRANGLE SCALE 1:24000UTM REFERENCE: ** ZONE 16 EASTING NORTHING

** see district boundary reference -- Item 10

United States Department of the Interior
National Park ServiceNational Register of Historic Places
Inventory—Nomination Form

Continuation sheet

Item number 7 & 8

Page 13

INDIVIDUAL DATA SHEET

SURVEY NUMBER 0043
PROPERTY NAME Coston Building
LOCATION 217 W. Hale
CONSTRUCTION DATE 1915

PROPERTY OWNER Ronnie Sorrells
ADDRESS 307 E. Semmes
Osceola, AR

DESCRIPTION

Located in the block across Hale Avenue from the Mississippi County Courthouse (0011, N.R. 1978), the Coston Building is a two-story flat-roofed structure built in 1915. This building is of brick construction with the front elevation (north) facaded with cut mortar blocks. The facade is vertically articulated on each end by brick block piers. These piers are topped with corbelled caps, which extend from the roof of the building to the height of the center parapet. The plain parapet, also of brick block, rises from the center of the facade. A stone panel is placed under the parapet, and is inscribed "19 COSTON 15". The first floor store front features plate glass window display areas and is covered by an added canvas awning. Four plate glass sash windows are evenly spaced across the second story. These are set into recessed areas outlined in vertically-set block bricks. A brick ledge runs beneath the windows and defines a narrow recessed area.

SIGNIFICANCE

The Coston building is architecturally significant in the built environment of Osceola. It was constructed in 1915 by Joseph T. Coston, an attorney who had moved to Osceola before the turn of the century. Coston, a native of Franklin County, Tennessee, was a graduate of Vanderbilt University in Nashville. After relocation in Osceola, Coston had a number of prestigious clients; among them was plantation owner R. E. Lee Wilson of Wilson, Arkansas. Wilson's land was greatly affected by the continual flooding, and he encouraged Coston to become involved in the efforts to improve drainage in Mississippi County. Coston was a well-liked man who attained much of his local notoriety from his successful dealings in support of drainage districts. The Coston building is one of the more notable buildings in the commercial district, reflecting the solidity of the Courthouse across the street in its brick block construction.

ACREAGE less than oneVERBAL BOUNDARY DESCRIPTION Lot 7, Block 19, Townsite AdditionQUADRANGLE NAME Osceola, AR-TNQUADRANGLE SCALE 1:24000UTM REFERENCE: ****ZONE** 16EASTING NORTHING

** see district boundary references -- Item 10

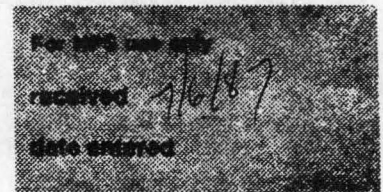
United States Department of the Interior
National Park ServiceNational Register of Historic Places
Inventory—Nomination Form

Continuation sheet

Item number 7 & 8

Page 14

INDIVIDUAL DATA SHEET

SURVEY NUMBER 0044
PROPERTY NAME Raines Play House
LOCATION 216 W. Hale
CONSTRUCTION DATE 1915

PROPERTY OWNER Reggie Collom
ADDRESS 119 East Drive
Osceola, AR

DESCRIPTION

Constructed in 1915, the Raines Play House (which derives its name from more recent usage), was built to house Osceola's post office. Designed and built by Memphis architect G. C. Parlow, this one story 26' by 70' building is constructed of brick and on the facade (north elevation) is faced with cut mortar block. The entrance to this building is flanked by fluted pilasters topped by Ionic capitals and set in stone block bases. On either edge of the building are one-story pilasters of cut block with corbelled caps. Double-hung plate glass windows flanking the entrance feature large multi-paned transoms. The decorative cornice of cut mortar block features bands of dentiling in two sizes. A slight parapet rises from the center of the roofline. The original structure featured two 4' by 8' skylights supplemented by electric light fixtures. The mosaic tile floor and steam heat contributed to the building's notoriety at the time of its construction.

SIGNIFICANCE

When businesses began moving west of the railroad tracks to "new town", a point of contention was the location of the post office. References in the Osceola Times shortly after the turn of the century point out the constant moving of the town's post office from one building to another. Weekly issues of the paper at that time featured articles entitled "Where is The Post Office This Week". In 1915 funds for building a post office were finally secured and the city employed the talents of a Memphis architect, G. C. Parlow, to erect the structure. Parlow, who was also working on the adjacent Coston office building, used the same cut mortar block to face the north elevation of the one-story post office. This building provided long-needed stability in the postal service of the small town. Elegant in its decorative facade, with fluted columns and such modern features as electric lights and a mosaic tile floor, this building now presents a unique character within the Hale Street district.

ACREAGE less than one

VERBAL BOUNDARY DESCRIPTION Lot 8, Block 19, Townsite Addition

QUADRANGLE NAME Osceola, AR-TN **QUADRANGLE SCALE** 1:24000

UTM REFERENCE: **ZONE 16 **EASTING** **NORTHING**

** see district boundary references -- Item 10

United States Department of the Interior
National Park Service

National Register of Historic Places
Inventory—Nomination Form

Hale Avenue Historic District
Osceola MRA, Mississippi Co.

For NPS use only
received 8/21/07
date entered

Continuation sheet

Item number 10

Page 15

10. GEOGRAPHICAL DATA

Acreage of nominated property- 1.5 acres

For remainder of geographical information see cover form

7/6/87

United States Department of the Interior
National Park Service

AUG -6 1987

National Register of Historic Places
Continuation Sheet

Section number _____ Page _____

Multiple Resource Area
Thematic GroupName Osceola MRA
State Mississippi County, ARKANSAS

Nomination/Type of Review

Entered in the
National Register

Date/Signature

Cover

Keeper Delores Byrum 8/6/87

1. Bank of Osceola

Entered in the
National RegisterKeeper Delores Byrum 8/6/87

Attest _____

2. City Hall

Entered in the
National RegisterKeeper Delores Byrum 8/6/87

Attest _____

3. Florida Brothers Building

Entered in the
National RegisterKeeper Delores Byrum 8/6/87

Attest _____

4. Hale Avenue Historic District

Entered in the
National RegisterKeeper Delores Byrum 9/14/87

Attest _____

5. Mississippi County Jail

Entered in the
National RegisterKeeper Delores Byrum 8/6/87

Attest _____

6. Old Bell Telephone Building

Entered in the
National RegisterKeeper Delores Byrum 8/6/87

Attest _____

7. Osceola Times Building

Entered in the
National RegisterKeeper Delores Byrum 8/6/87

Attest _____

8. Planters Bank Building

Entered in the
National RegisterKeeper Delores Byrum 8/6/87

Attest _____

9.

Keeper _____

Attest _____

10.

Keeper _____

Attest _____

NATIONAL REGISTER OF HISTORIC PLACES
EVALUATION/RETURN SHEETHale Avenue Historic District (Osceola MRA)
Mississippi County
ARKANSASWorking No. 7-6/-87
Fed. Reg. Date: 2/2/88
Date Due: 10-15-87
Action: ☒ ACCEPT 9-14-87
☐ RETURN
☐ REJECT
Federal Agency: _____

- ☒
- resubmission
-
- ☐
- nomination by person or local government
-
- ☐
- owner objection
-
- ☐
- appeal

Entered in the
National RegisterSubstantive Review: ☐ sample ☐ request ☐ appeal ☐ NR decision

Reviewer's comments:

Recom./Criteria _____
Reviewer _____
Discipline _____
Date _____
_____ see continuation sheetNomination returned for: _____ technical corrections cited below
_____ substantive reasons discussed below

1. Name

2. Location

3. Classification

Category	Ownership	Status	Present Use
	Public Acquisition	Accessible	

4. Owner of Property

5. Location of Legal Description

6. Representation in Existing Surveys

Has this property been determined eligible? ☐ yes ☐ no

7. Description

Condition

- | | |
|------------------------------------|---------------------------------------|
| <input type="checkbox"/> excellent | <input type="checkbox"/> deteriorated |
| <input type="checkbox"/> good | <input type="checkbox"/> ruins |
| <input type="checkbox"/> fair | <input type="checkbox"/> unexposed |

Check one

- ☐
- unaltered
-
- ☐
- altered

Check one

- ☐
- original site
-
- ☐
- moved date _____

Describe the present and original (if known) physical appearance

- ☐
- summary paragraph
-
- ☐
- completeness
-
- ☐
- clarity
-
- ☐
- alterations/integrity
-
- ☐
- dates
-
- ☐
- boundary selection

8. Significance

Period _____ Areas of Significance—Check and justify below

Specific dates _____

Builder/Architect _____

Statement of Significance (*in one paragraph*) _____

- ☐ summary paragraph
- ☐ completeness
- ☐ clarity
- ☐ applicable criteria
- ☐ justification of areas checked
- ☐ relating significance to the resource
- ☐ context
- ☐ relationship of integrity to significance
- ☐ justification of exception
- ☐ other

9. Major Bibliographical References

10. Geographical Data

Acreage of nominated property _____

Quadrangle name _____

UTM References _____

Verbal boundary description and justification _____

11. Form Prepared By

12. State Historic Preservation Officer Certification

The evaluated significance of this property within the state is:

_____ national _____ state _____ local

State Historic Preservation Officer signature _____

title _____ date _____

13. Other

- ☐ Maps
- ☐ Photographs
- ☐ Other

Questions concerning this nomination may be directed to _____

Signed _____ Date _____ Phone: _____

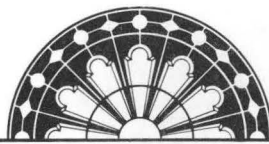

Resubm.

ARKANSAS
HISTORIC
PRESERVATION
PROGRAM

August 25, 1987

Ms. Carol D. Shull
Chief of Registration
U.S. Department of the Interior
National Register of Historic Places
National Park Service
1100 "L" Street, NW
Washington, D.C. 20240

RE: Hale Avenue Historic District
Osceola Multiple Resource Area
Osceola, Mississippi County

Dear Carol:

Enclosed is the nomination for the Hale Avenue Historic District, which was returned to us for technical correction. We have indicated the total acreage for the district on a continuation sheet.

Thank you for your consideration in this matter.

Sincerely,

Wilson Stiles
State Historic Preservation Officer

WS/TJ/dr

Enclosure



AUG 31 1987



PATTERSON BUILDING
200 BLOCK, HALE AVE.
OSCEOLA, AR 1902

Patterson Building - 0040 HALE AVE. HIST. DIST.
Osceola MRA
Osceola, Mississippi County
Photographed by Carolyn Wallace
June 1986
Negatives on file at AHPP



BORUM BUILDING

201 W. HALE 1902

OSCEOLA, AR

Borum Building - 0039 HALP AVE, HIST. DIST.

Osceola MRA

Osceola, Mississippi County

Photographed by Carolyn Wallace

June 1986

Negatives on file at AHPP



FRED PATTERSON STORE
200 BLOCK, HALE AVE.
OSCEOLA, AR 1904

Fred Patterson Store - 0041HALE AVE. HIST. DIST.
Osceola MRA
Osceola, Mississippi County
Photographed by Carolyn Wallace
June 1986
Negatives on file at AHPP



HUBBARD AND HOKE
213 W. HALE
OSCEOLA, AR 1917

Hubbard and Hoke - 0042 *HALE AVE. HIST. DIST.*

Osceola MRA

Osceola, Mississippi County

Photographed by Carolyn Wallace

June 1986

Negatives on file at AHPP



COSTON BUILDING
217 W. HALE
OSCEOLA, AR 1915

Coston Building - 0043 HALE AVE. HIST. DIST.
Osceola MRA

Osceola, Mississippi County

Photographed by Carolyn Wallace

June 1986

Negatives on file at AHPP



RAINES PLAY HOUSE

216 W. HALE

OSCEOLA, AR 1915

Raines Play House - 0044 *HALE AVE. HIST. DIST.*

Osceola MRA

Osceola, Mississippi County

Photographed by Carolyn Wallace

June 1986

Negatives on file at AHPP



MISSISSIPPI COUNTY COURTHOUSE

HALE AVE. 1912

OSCEOLA, AR NR 12-13-78

Mississippi County Courthouse - 0011

Osceola MRA

Osceola, Mississippi County

Photographed by Carolyn Wallace

June 1986

Negatives on file at AHPP

United States Department of the Interior
National Park Service

National Register of Historic Places
Inventory—Nomination Form

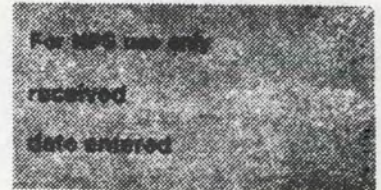

Continuation sheet

Item number

Page

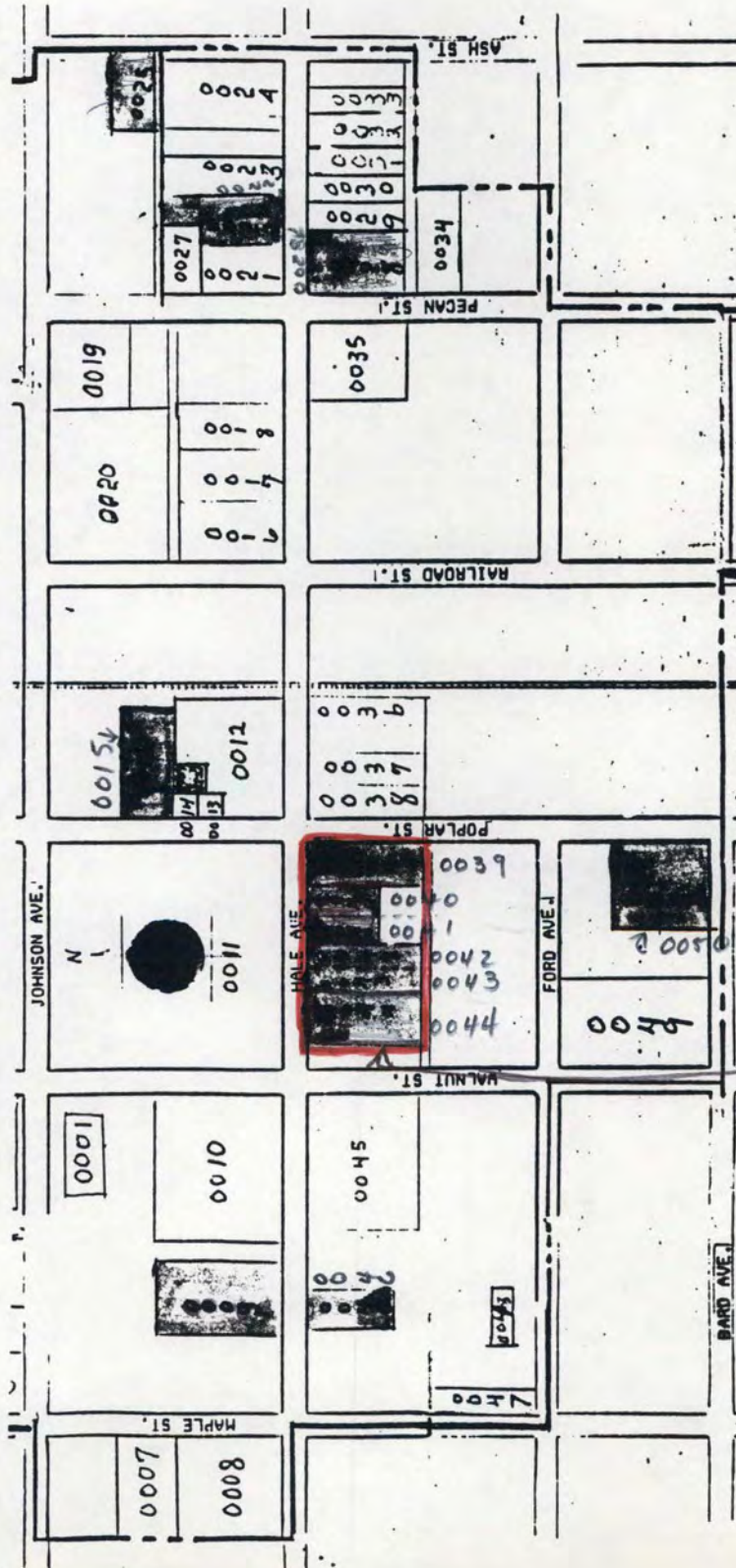

HALE AVENUE
HISTORIC DISTRICT
Osceola MRA

- UTM References:
- A-16/2313000/3954840
 - B-16/231360/3954840
 - C-16/231300/3954790
 - D-16/231360/3954790

UNITED STATES
DEPARTMENT OF THE INTERIOR
GEOLOGICAL SURVEY

OSCEOLA QUADRANGLE
ARKANSAS-TENNESSEE
7.5 MINUTE SERIES (TOPOGRAPHIC)
NW/4 OSCEOLA 15' QUADRANGLE

HALE AVENUE
Historic District

Hale Avenue Historic District- Osceola MRA
Osceola, Mississippi County
UTM References:
A-16/231300/3954840
B-16/231360/3954840
C-16/231300/3954790
D-16/231360/3954790
Osceola, AR-TN Quadrangle
1:24000

Mapped, edited, and published by the Geological Survey
Control by USGS and USC&GS
Topography by photogrammetric methods from aerial
photographs taken 1971. Field checked 1972
Projection: Arkansas coordinate system, north zone
(Lambert conformal conic)
10,000-foot grid ticks based on Arkansas coordinate
system, north zone and Tennessee coordinate system
1000-meter Universal Transverse Mercator grid ticks,
zone 16, shown in blue. 1927 North American datum
Red tint indicates area in which only landmark buildings are shown
Fine red dashed lines indicate selected fence and field lines where
generally visible on aerial photographs. This information is unchecked

UTM GRID AND 1972 MAGNETIC NORTH
DECLINATION AT CENTER OF SHEET

SCALE 1:24,000
CONTOUR INTERVAL 5 FEET
DATUM IS MEAN SEA LEVEL

THIS MAP COMPLIES WITH NATIONAL MAP ACCURACY STANDARDS
FOR SALE BY U. S. GEOLOGICAL SURVEY, DENVER, COLORADO 80225, OR RESTON, VIRGINIA 22092
ARKANSAS GEOLOGICAL COMMISSION, LITTLE ROCK, ARKANSAS 72201
AND TENNESSEE DIVISION OF GEOLOGY, NASHVILLE, TENNESSEE 37219
A FOLDER DESCRIBING TOPOGRAPHIC MAPS AND SYMBOLS IS AVAILABLE ON REQUEST



ROAD CLASSIFICATION
Primary highway, hard surface
Secondary highway, hard surface
Interstate Route
U. S. Route
State Route
Light-duty road, hard or improved surface
Unimproved road

OSCEOLA, ARK.-TENN.
NW/4 OSCEOLA 15' QUADRANGLE
N3537.5-W8952.5/7.5

1972
AMS 8055 III NW-SERIES V884