

JAN 05 1988
FEB 10 1988

9

(N/A) NOT FOR PUBLICATION

SOUTH CAROLINA INVENTORY FORM FOR HISTORIC DISTRICTS AND
INDIVIDUAL PROPERTIES IN A MULTIPLE PROPERTY SUBMISSION

NAME OF MULTIPLE PROPERTY SUBMISSION: City of Darlington
Multiple Resource Area

PREFERRED NAME OF PROPERTY: Charles S. McCullough House

HISTORIC NAME OF PROPERTY: Same

COMMON NAME OF PROPERTY: Memorial Center

LOCATION: 480 Pearl Street

CLASSIFICATION: Building

NUMBER OF RESOURCES WITHIN PROPERTY: 1 Building

OWNER: City of Darlington
Darlington, South Carolina 29532

DESCRIPTION

Characteristic of a Second Empire style house, the Charles S. McCullough House has a mansard roof covered with multi-colored slates laid in decorative patterns. Built in 1889 (the date is found in a red sandstone cartouche in a gable end on the east side of the house), the brick residence has a one and one-half story square core, a projecting one-story ell, and a porch on three sides, the east side of which has been enclosed. The front porch is characterized by elaborate sawn brackets on paired turned posts and an ornamental balustrade. Dormer windows with pedimented gables punctuate the roof. The roof, dormers, and porches all have heavily bracketed cornices.

The front (south) elevation features a steeply pitched gable, the peak of which rises above the cornice line of the top of the mansard roof; this gable contains a row of four one-over-one windows. The front entrance consists of double doors framed by elaborate colored glass transoms and sidelights within a paneled inset. The front windows are triple-hung, each having Queen Anne block glass embellishments in the top sash and single light lower sashes. The kitchen/dining room ell has chimneys with vaulted caps and, on its east side, six-over-six windows. A large octagonal bay extends from the north elevation below the mansard roof.

The interior of the house features parquet flooring, plaster cornices and rosettes, carved foliated motifs in the mantels, paneled wainscoting, louvered shutters which fold back into window jambs, and elaborate Eastlake hardware.

SIGNIFICANCE

AREA OF SIGNIFICANCE: Architecture

LEVEL OF SIGNIFICANCE: L (for office use only)

SUMMARY OF SIGNIFICANCE

One of the few remaining large residences on Pearl Street, the Charles S. McCullough House is significant as an outstanding local example of the Second Empire style. The house is primarily defined by its multi-colored slate mansard roof with dormer windows. The large scale of the house with its brick walls punctuated by tall openings and wrapped on three sides by a wide veranda reflect a mastery of composition on the part of the designer.

The original owner, Charles S. McCullough, had been a partner in the McCullough & Blackwell Livery Stable business since 1881.¹ The firm also dealt in the feed and grain business in addition to importing horses from Kentucky.²

Charles S. McCullough was a director of the Darlington Agricultural & Mechanical Fair Company in 1889 and was a sergeant in the Darlington Guards during the same period.³ The house remained in the McCullough family until the early 1940's when it was donated to the city of Darlington with the stipulation that it be used as a recreation center. The city used the facility until 1986 when the recreation department moved into the old armory building. The city currently has leased the house to the Darlington County Council on Aging, which plans to renovate the facility for its headquarters.

ACREAGE: Less than one acre

VERBAL BOUNDARY DESCRIPTION: The boundary of the Charles S. McCullough House nomination is shown as the red line on the accompanying map entitled "Charles S. McCullough House." The map was copied from a map of the town of Darlington, S.C., which is dated June, 1980, and is drawn at a scale of one inch to 500 feet. The nominated property includes only the historic building and the lot on which it is situated.

QUAD NAME: Darlington West, S.C.

QUAD SCALE: 1:24,000

UTM REFERENCE POINT: 17/603360/3795800

FOOTNOTES

¹Darlington, S.C., 1893, A Guide to Leading Industries (n.p., 1893), p. 34.

²Ibid.

³Eliza Cowan Ervin and Horace Fraser Rudisill, Darlingtoniana (Columbia, S.C.: R. L. Bryan Co., 1964), p. 459 and p. 466; "Premium List of the Darlington Agricultural & Mechanical Fair Co." (n.p., 1889).

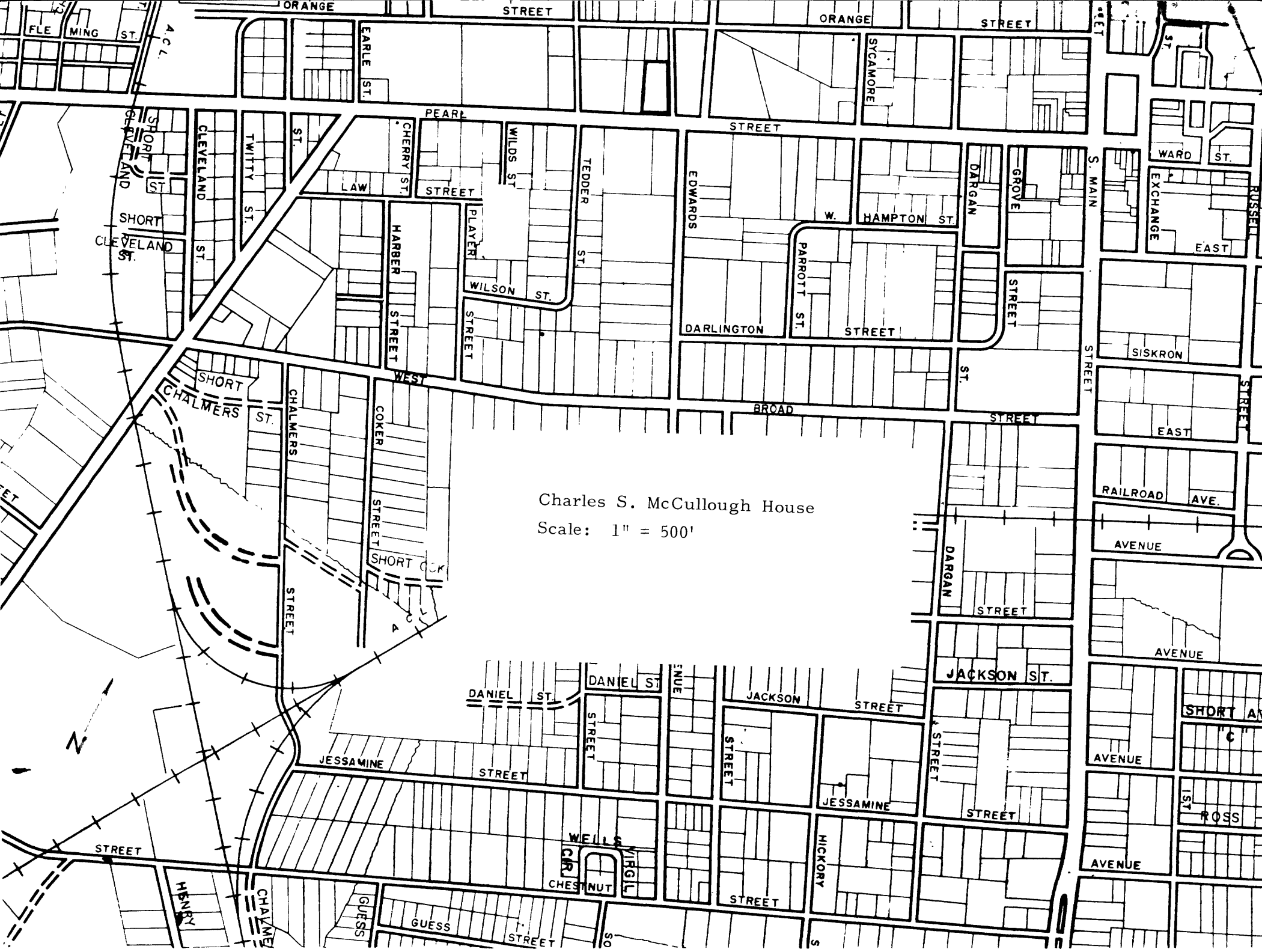

Charles S. McCullough House
Scale: 1" = 500'