

DEC 8 1986

3272

KENTUCKY HISTORIC RESOURCES  
Individual Inventory Form

Resource # Be-103  
Boone County

1. Name of Resource: Kirtley, Rev. Robert E., House			16. Date: Original Building mid-19th c. [ ] Addition porch, c. 1970 [ ]		
2. Original Owner: Reverend Robert E. Kirtley			17. Style: Greek Revival [ ]		
3. Other Names: None			18. Architect/Builder: unknown		
4. Prehistoric Site	Building X	Object	19. No. of Stories: two [ ]		
Historic Site	Structure	Other	20. Original Floor Plan: three rooms backed by two rooms [ ]		
5. Location: 8545 River Road Hebron, KY			21. Single Pile Double Pile X N.A.		
6. Owner's Name: Harold and Sherry Hempfling [ ]			22. Roof Form & Material: Original X gable/st. seam tin Not Original		
7. Owner's Address: 8545 River Road Hebron, KY 41048			23. Structural Material: common bond brick [ ]		
8. Evaluation: National Register [ ]			24. Exterior Material: brick common bond [ ] stone [ ]		
9. Recognition & Date: Nat.Landmark _____ Local Landmark _____ Nat.Register _____ HABS/HAER _____ Highway Marker _____ KY Inventory 1977 _____ KY Landmark Certificate _____			25. Foundation Material: brick [ ]		
10. N.R.Status & Date:			26. Major Alterations: None Moved/Rebuilt Other Additions X		
11. N.R.Group: District Name: [ ] Mult.Resource Area: Boone County [ ] Thematic Name: [ ]			27. Special Features: some interior rooms remain unfinished		
12. Historical Theme: Primary: Architecture [ ] Secondary: [ ] Other: [ ]			28. Outbuildings: two: noncontributing barn & garage [ ]		
13. Statement of Significance: This property is significant under criterion C as a good example of the Greek Revival style, significant to Boone County in the period 1840-1880. The house is notable for its plan, large scale and interior detail and unusual in that the 2nd floor interior is left unfinished. The front porch addition does not obscure the overall form, design or character.			29. Original Function: farm dwelling [ ]		
14. History: Robert E. Kirtley was the minister of Sand Run Baptist Church from 1871 to 1897, as well as minister of Bullittsburg Baptist Church and other Boone County Baptist churches.			30. Present Use: farm dwelling [ ]		
15. Source of historical information and/or contact person: "History of Sand Run Baptist Church"			31. Condition: excellent [ ]		
			32. Endangered: Yes _____ No X		
			33. Attach Photos: Roll: 3 Photo Nos: 0-9 No. of Slides:		
			34. Prepared by: Kenneth T. Gibbs		
			35. Organization: Boone Co.Hist.Pres.Rev.Brd.		
			36. Date: September 1986		
			37. New Survey _____ Resurvey X		

KENTUCKY HISTORIC RESOURCES  
Individual Inventory Form

Resource # Be-103

38. UTM Point of Primary Building: Zone Easting Northing 39. G.I.S. Mod. [ ]  
 Quadrant: Addyston 16 694640 4333540 40. Coordi.Accuracy [ ]

41. UTM Points of Boundary (for N. R. eligible sites only):

A.	---	-----	-----	D.	---	-----	-----
B.	---	-----	-----	E.	---	-----	-----
C.	---	-----	-----	F.	---	-----	-----

42. Total Acreage in Present Property: 1.611 43. Acreage included in proposed N.R. boundary: 1.611

44. Site Plan (and boundary description and justification for N.R. sites):

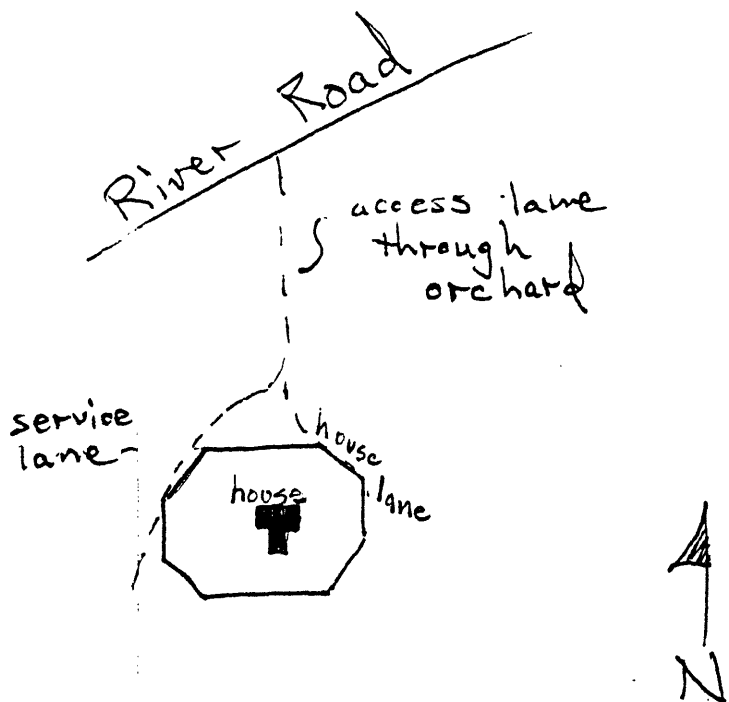

The nominated property occupies tax parcel 23-04 A and is an octagonal shape that is roughly 325' x 225' in size. This shape reflects current ownership and includes the lane to the house but not the service lane to the west or the lane from the public road. Nor does it include the barn, east of the house, that has lost integrity. The lane from River Road passes through an orchard, not reflecting the original agricultural uses of the farm, and is under different ownership.

Contributing: 1 building

45. Description and House Plan:

The main block of the house was planned on an unusually large scale, so that it appears to dwarf the rear service wing to the south, built slightly later and scaled more in keeping with houses of the period. The main (north) front and the gable-ends have three symmetrical bays each. The gable-ends suggest pediments due to the proportions, the symmetrical bays and the elliptical, louvered attic openings. The central front door is lighted by an elliptical fanlight and sidelights, framed with pilasters; the front porch, which replaced one built in the late 19th century, was constructed in about 1970 in a decidedly late 20th century neoclassical style that complements the house without copying it stylistically.

The double-pile plan features a rectangular entrance vestibule flanked by square corner chambers, rather than the expected central passage. The vestibule also provided access to the pair of large, roughly square parlors that are connected by sliding doors. The first floor interior was finished with grandly conceived Greek Revival moldings, which include hoods, or drip moldings, but the second floor was left an unfinished shell. Because the left-front "chamber" was not ceiled (until the present owners covered the open joists), and because this room was given an exterior entrance (although it was never provided with steps or a porch), the original intention may have been to locate a staircase to the second floor in this room. The only access to the second floor is by way of a staircase enclosed in the two-story part of the service wing.

The house was carefully sited on a nearly circular hilltop overlooking the fertile floodplain of the Ohio River, a section of the county known as North Bend Bottoms.

DEC 8 1986

3272

KENTUCKY HISTORIC RESOURCES  
Individual Inventory Form

Resource # Be-103  
Boone County

1. Name of Resource: Kirtley, Rev. Robert E., House			16. Date: Original Building mid-19th c. [ ] Addition porch, c. 1970 [ ]		
2. Original Owner: Reverend Robert E. Kirtley			17. Style: Greek Revival [ ]		
3. Other Names: None			18. Architect/Builder: unknown		
4. Prehistoric Site	Building X	Object	19. No. of Stories: two [ ]		
Historic Site	Structure	Other	20. Original Floor Plan: three rooms backed by two rooms [ ]		
5. Location: 8545 River Road Hebron, KY			21. Single Pile Double Pile X N.A.		
6. Owner's Name: Harold and Sherry Hempfling [ ]			22. Roof Form & Material: Original X gable/st. seam tin Not Original		
7. Owner's Address: 8545 River Road Hebron, KY 41048			23. Structural Material: common bond brick [ ]		
8. Evaluation: National Register [ ]			24. Exterior Material: brick common bond [ ] stone [ ]		
9. Recognition & Date: Nat.Landmark _____ Local Landmark _____ Nat.Register _____ HABS/HAER _____ Highway Marker _____ KY Inventory 1977 _____ KY Landmark Certificate _____			25. Foundation Material: brick [ ]		
10. N.R.Status & Date:			26. Major Alterations: None Moved/Rebuilt Other Additions X		
11. N.R.Group: District Name: [ ] Mult.Resource Area: Boone County [ ] Thematic Name: [ ]			27. Special Features: some interior rooms remain unfinished		
12. Historical Theme: Primary: Architecture [ ] Secondary: [ ] Other: [ ]			28. Outbuildings: two: noncontributing barn & garage [ ]		
13. Statement of Significance: This property is significant under criterion C as a good example of the Greek Revival style, significant to Boone County in the period 1840-1880. The house is notable for its plan, large scale and interior detail and unusual in that the 2nd floor interior is left unfinished. The front porch addition does not obscure the overall form, design or character.			29. Original Function: farm dwelling [ ]		
14. History: Robert E. Kirtley was the minister of Sand Run Baptist Church from 1871 to 1897, as well as minister of Bullittsburg Baptist Church and other Boone County Baptist churches.			30. Present Use: farm dwelling [ ]		
15. Source of historical information and/or contact person: "History of Sand Run Baptist Church"			31. Condition: excellent [ ]		
			32. Endangered: Yes _____ No X		
			33. Attach Photos: Roll: 3 Photo Nos: 0-9 No. of Slides:		
			34. Prepared by: Kenneth T. Gibbs		
			35. Organization: Boone Co.Hist.Pres.Rev.Brd.		
			36. Date: September 1986		
			37. New Survey _____ Resurvey X		

KENTUCKY HISTORIC RESOURCES  
Individual Inventory Form

Resource # Be-103

38. UTM Point of Primary Building: Zone Easting Northing 39. G.I.S. Mod. [ ]  
 Quadrant: Addyston 16 694640 4333540 40. Coordi.Accuracy [ ]

41. UTM Points of Boundary (for N. R. eligible sites only):

A.	---	---	---	D.	---	---	---
B.	---	---	---	E.	---	---	---
C.	---	---	---	F.	---	---	---

42. Total Acreage in Present Property: 1.611 43. Acreage included in proposed N.R. boundary: 1.611

44. Site Plan (and boundary description and justification for N.R. sites):

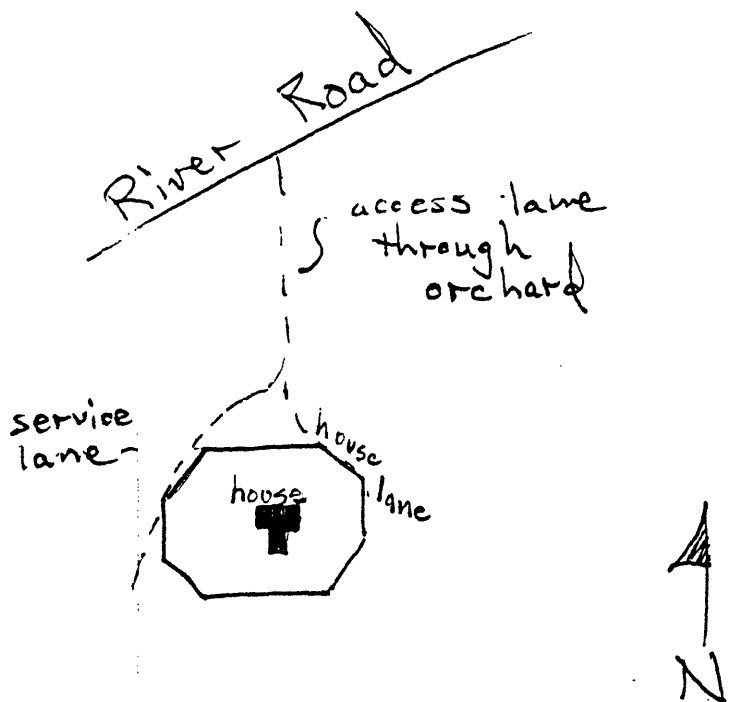

The nominated property occupies tax parcel 23-04 A and is an octagonal shape that is roughly 325' x 225' in size. This shape reflects current ownership and includes the lane to the house but not the service lane to the west or the lane from the public road. Nor does it include the barn, east of the house, that has lost integrity. The lane from River Road passes through an orchard, not reflecting the original agricultural uses of the farm, and is under different ownership.

Contributing: 1 building

45. Description and House Plan:

The main block of the house was planned on an unusually large scale, so that it appears to dwarf the rear service wing to the south, built slightly later and scaled more in keeping with houses of the period. The main (north) front and the gable-ends have three symmetrical bays each. The gable-ends suggest pediments due to the proportions, the symmetrical bays and the elliptical, louvered attic openings. The central front door is lighted by an elliptical fanlight and sidelights, framed with pilasters; the front porch, which replaced one built in the late 19th century, was constructed in about 1970 in a decidedly late 20th century neoclassical style that complements the house without copying it stylistically.

The double-pile plan features a rectangular entrance vestibule flanked by square corner chambers, rather than the expected central passage. The vestibule also provided access to the pair of large, roughly square parlors that are connected by sliding doors. The first floor interior was finished with grandly conceived Greek Revival moldings, which include hoods, or drip moldings, but the second floor was left an unfinished shell. Because the left-front "chamber" was not ceiled (until the present owners covered the open joists), and because this room was given an exterior entrance (although it was never provided with steps or a porch), the original intention may have been to locate a staircase to the second floor in this room. The only access to the second floor is by way of a staircase enclosed in the two-story part of the service wing.

The house was carefully sited on a nearly circular hilltop overlooking the fertile floodplain of the Ohio River, a section of the county known as North Bend Bottoms.