

Iowa Site Inventory

Office of Historic Preservation
Iowa State Historical Department
East 12th & Grand Avenue
Des Moines, Iowa 50319

Site Number 151
District Name _____
Map Reference # 151

Identification

- Site Name Round Barn, Norway Twp., Winnebago County
- Village/Town/City Scarville vic. Township Norway County Winnebago
- Street Address Off County R60
- Legal Location 100 N 23 W 7 SE 1/4 of SE 1/4
Urban: Rural subdivision township block range parcel section subparcel 1/4 section of 1/4 section
- UTM Location: zone 15 easting 451,680 northing 4,815,120; Acreage less than one acre
- Owner(s) Name Mrs. Malena Swenson
- Owner(s) Address Box 98 Scarville Iowa 50473
(Street address) (City) (State) (Zip)
- Use: Present Not in use Original Dairy and horse barn

Description

- Date of Construction c. 1916-20 Architect/Builder Not known
- Building Type:

<input type="checkbox"/> single-family dwelling	<input type="checkbox"/> industrial	<input type="checkbox"/> other institutional	<input type="checkbox"/> religious
<input type="checkbox"/> multiple-family dwelling	<input type="checkbox"/> educational	<input type="checkbox"/> public	<input checked="" type="checkbox"/> agricultural
<input type="checkbox"/> commercial			
- Exterior Walls: clapboard stone brick board and batten shingles stucco
 other _____
- Structural System: wood frame with interlocking joints wood frame with light members (balloon frame)
 masonry load-bearing walls iron frame steel frame with curtain walls reinforced concrete
 other _____
- Condition: excellent good fair deteriorated
- Integrity: original site moved—if so, when? _____
 Notes on alterations, additions (with dates and architect, if known) and any other notable features of building and site:
See reverse side.
- Related Outbuildings and Property: barn other farm structures carriage house garage privy
 other _____
- Is the building endangered? no yes—if so, why? _____
- Surroundings of the building: open land woodland scattered outbuildings densely built-up commercial
 industrial residential other _____

18. Map

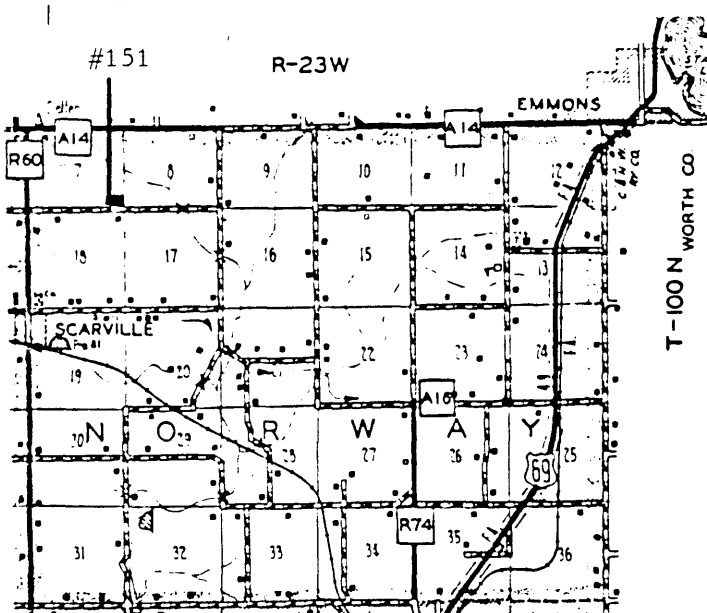

19. Photo

Roll 592 Frame 20 A View _____

VBD: A circle 80' in diameter, based on the center point of the barn.

MAY 27 1986

Significance (Indicate sources of information for all statements)

20. Architectural significance

- a. Key structure: individually may qualify for the National Register
- b. Contributing structure
- c. Not eligible: intrusion

N/A

Continuation of 14. Integrity.

Circular interior around central clay tile silo. Central roof of 8 sections. Asphalt shingles. Large hay dormer with half conical overhangs above hay doors. Taken out of use in 1970.

21. Historical Significance

Theme(s) True-Round; Iowa/King type; Johnston Brothers. True-Round; Specialty Contractor; Clay Tile Supplier

- a. Key structure: individually may qualify for the National Register
- b. Contributing structure
- c. Not eligible: intrusion

See Continuation Sheet.

22. Sources (for primary and secondary sources, give complete facts of publication: author, title, place of publication, date, etc.):

Mrs. Malena Swenson, Scarville, IA 50473
Soike, Lowell J. Without Right Angles. Des Moines, Iowa: Iowa State Historical Department, Office of Historic Preservation, 1983.

Prepared by _____ Date _____
Address _____ Telephone _____
Organization _____

For Office of Historic Preservation Use Only

1. Office Information Sources on this Property

- County Resource File
- Windshield Surveys
- National Register
- Grants-In-Aid: _____
- Determination of Eligibility

Review and Compliance Project:

- Other _____
- Other _____
- Other _____

2. Subject Traces

- a. _____
- b. _____
- c. _____
- d. _____
- e. _____

3. Photo Images _____

- _____
- _____
- _____
- _____
- _____

FEB 11 1987

Iowa Site Inventory

Office of Historic Preservation
Iowa State Historical Department
East 12th & Grand Avenue
Des Moines, Iowa 50319

Site Number 151

Continuation Sheet

Item Number(s)

Part of Hillside Stock Farm. One of eighteen similar round barns known to have been built on an Iowa farm. The vitrified clay tiles are believed to have been supplied by the Johnston Brothers' Clay Works of Webster County. The design is similar to the Johnston Brothers' 1910 promotional barn located on their farm next to the clay pits. The names of the actual builders of this barn, and their connection with the Johnston Brothers, is unknown.

This barn is specifically characterized as a Johnston Brothers' sub-type by its exterior wall of "...small red clay tile in the lower story and larger tile above..." (Soike 1983). The conical roof is another common feature of the Johnston Brothers' design. The clay tile exterior wall and silo wall generally classify this barn as an Iowa Agricultural Experiment Station / Matt King influenced type. The use of structural clay tile was one of the later improvements in the history of round barns, believed to have been introduced around 1910.