

**NATIONAL REGISTER OF HISTORIC PLACES
INVENTORY - NOMINATION FORM**

(Type all entries - complete applicable sections)

STATE: Nebraska	
COUNTY: Douglas	
FOR NPS USE ONLY	
ENTRY NUMBER 69-10-26-0013	DATE 10/15/69

SEE INSTRUCTIONS

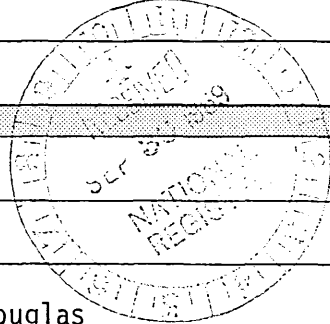

1. NAME

COMMON:
Bank of Florence

AND/OR HISTORIC:

2. LOCATION

STREET AND NUMBER:
8502 North 30th Street

CITY OR TOWN:
Omaha

STATE: Nebraska CODE: 26 COUNTY: Douglas CODE: 055

3. CLASSIFICATION

CATEGORY (Check One)		OWNERSHIP		STATUS		ACCESSIBLE TO THE PUBLIC	
District <input type="checkbox"/>	Building <input checked="" type="checkbox"/>	Public <input checked="" type="checkbox"/>	Public Acquisition: <input type="checkbox"/>	Occupied <input checked="" type="checkbox"/>	Yes:		
Site <input type="checkbox"/>	Structure <input type="checkbox"/>	Private <input checked="" type="checkbox"/>	In Process <input type="checkbox"/>	Unoccupied <input type="checkbox"/>	Restricted <input checked="" type="checkbox"/>		
Object <input type="checkbox"/>		Both <input type="checkbox"/>	Being Considered <input type="checkbox"/>	Preservation work in progress <input type="checkbox"/>	Unrestricted <input type="checkbox"/>		
PRESENT USE (Check One or More as Appropriate)							
Agricultural <input type="checkbox"/>	Government <input type="checkbox"/>	Park <input type="checkbox"/>	Transportation <input type="checkbox"/>	Comments <input type="checkbox"/>			
Commercial <input type="checkbox"/>	Industrial <input type="checkbox"/>	Private Residence <input type="checkbox"/>	Other (Specify) <input type="checkbox"/>	_____			
Educational <input type="checkbox"/>	Military <input type="checkbox"/>	Religious <input type="checkbox"/>	_____	_____			
Entertainment <input type="checkbox"/>	Museum <input checked="" type="checkbox"/>	Scientific <input type="checkbox"/>	_____	_____			

4. OWNER OF PROPERTY

OWNERS NAME:
Florence Historical Foundation

STREET AND NUMBER:
8502 North 30th Street

CITY OR TOWN: Omaha STATE: Nebraska CODE: 26

5. LOCATION OF LEGAL DESCRIPTION

COURTHOUSE, REGISTRY OF DEEDS, ETC:
County Clerk, Douglas County Court House

STREET AND NUMBER:
1700 Farnum Street

CITY OR TOWN: Omaha STATE: Nebraska CODE: 26

APPROXIMATE ACREAGE OF NOMINATED PROPERTY: 1/4 acre

6. REPRESENTATION IN EXISTING SURVEYS

TITLE OF SURVEY:

DATE OF SURVEY: Federal State County Local

DEPOSITORY FOR SURVEY RECORDS:

STREET AND NUMBER:

CITY OR TOWN: STATE: CODE:

STATE: Nebraska
COUNTY: Douglas
FOR NPS USE ONLY
ENTRY NUMBER
DATE

7 DESCRIPTION

CONDITION	(Check One)					
	Excellent <input checked="" type="checkbox"/>	Good <input type="checkbox"/>	Fair <input type="checkbox"/>	Deteriorated <input type="checkbox"/>	Ruins <input type="checkbox"/>	Unexposed <input type="checkbox"/>
INTEGRITY	(Check One)			(Check One)		
	Altered <input checked="" type="checkbox"/>	Unaltered <input type="checkbox"/>		Moved <input type="checkbox"/>	Original Site <input checked="" type="checkbox"/>	

DESCRIBE THE PRESENT AND ORIGINAL (if known) PHYSICAL APPEARANCE

The building is located on lot 8, block 33, in the former town of Florence, now part of Omaha. It was erected in 1856 as a modest two story brick building with a low pitched hip roof. The heavy cornices and the treatment of the wall openings place the structure within the tradition of Greek Revival commercial architecture, even though the building is almost devoid of ornamentation. Many years ago, the original double doors of the principal facade (east) entrance were replaced by a single door, and the numerous lights and glazing bars of each window were replaced by large panes of glass. Otherwise, very few exterior alterations have been made over the years. Although the interior appears to have been remodeled extensively around the turn of the century, the original bank vault remains intact. Shipped by steamboat from western Pennsylvania in 1856, this vault consists of interwoven strips of quarter-inch sheet steel. The vault is ventilated by concealed air shafts and enclosed within three foot thick masonry walls.

Within the past five years, the building has been acquired and partially restored by the Florence Historical Foundation under the leadership of J. M. Hart, Jr., President of Omaha's North Side Bank. The Foundation has removed the many layers of exterior paint through sandblasting, repointed and waterproofed the walls, and repaired and repainted the wood trim. The large "Bank of Florence" sign across the facade has also been restored recently and is said to be original to the structure. The building is now occasionally opened to the public as a museum. Late nineteenth century bank furnishings, including teller's cages, were recently removed from an old bank near David City, Nebraska, and installed inside the Florence bank, recreating the appearance of a small Nebraska bank at the turn of the century. The bank's history is summarized on an official Nebraska Historical Marker located just south of the building.

SEE INSTRUCTIONS

B. SIGNIFICANCE

PERIOD (Check One or More as Appropriate)

Pre-Columbian <input type="checkbox"/>	16th Century <input type="checkbox"/>	18th Century <input type="checkbox"/>	20th Century <input type="checkbox"/>
15th Century <input type="checkbox"/>	17th Century <input type="checkbox"/>	19th Century <input checked="" type="checkbox"/>	

SPECIFIC DATE(S) (If Applicable and Known) 1856

AREAS OF SIGNIFICANCE (Check One or More as Appropriate)

Aboriginal <input type="checkbox"/>	Education <input type="checkbox"/>	Political <input type="checkbox"/>	Urban Planning <input type="checkbox"/>
Prehistoric <input type="checkbox"/>	Engineering <input type="checkbox"/>	Religion/Philosophy <input type="checkbox"/>	Other (Specify) <input type="checkbox"/>
Historic <input type="checkbox"/>	Industry <input type="checkbox"/>	Science <input type="checkbox"/>	_____
Agriculture <input type="checkbox"/>	Invention <input type="checkbox"/>	Sculpture <input type="checkbox"/>	_____
Art <input type="checkbox"/>	Landscape <input type="checkbox"/>	Social/Humanitarian <input type="checkbox"/>	_____
Commerce <input checked="" type="checkbox"/>	Architecture <input type="checkbox"/>	Theater <input type="checkbox"/>	_____
Communications <input type="checkbox"/>	Literature <input type="checkbox"/>	Transportation <input type="checkbox"/>	_____
Conservation <input type="checkbox"/>	Military <input type="checkbox"/>		_____
	Music <input type="checkbox"/>		_____

STATEMENT OF SIGNIFICANCE (Include Personages, Dates, Events, Etc.)

SEE INSTRUCTIONS

Now a section of northeastern Omaha, the former town of Florence figures prominently in the early history of Nebraska, created as a territory in 1854. Florence was platted in 1854 on the site of Winter Quarters, which had been established by the Mormons in 1846 as their principal encampment between Nauvoo and Salt Lake City during their epic westward migration. Briefly, during the 1850's, Florence stood as one of Nebraska's leading Missouri River steamboat ports. The Bank of Florence is the most important and least altered of the few extant early buildings in Florence. It is also one of the oldest commercial buildings in Nebraska and is perhaps the oldest building in Omaha, Nebraska's largest city.

The Bank of Florence was chartered by Nebraska's territorial legislature on January 18, 1856, and the building was erected the following summer at a cost of \$4500 by builder Levi Harsh for the financial firm of Cook, Sargent & Parker of Davenport, Iowa. The bank soon played an important role in the development of the Florence area. Frontier banking practices were lax, and along with other Nebraska banks of the 1850's the Bank of Florence issued quantities of unsecured "wild cat" currency and financed land speculation. Much of this money still exists in museums and private collections. Weakened by the Panic of 1857, the bank failed in 1859. (Only one Nebraska bank survived the Panic.) Various businesses continued to use the bank building prior to the organization of the second Bank of Florence, which occupied the structure from 1904 to 1939. Omaha's present North Side Bank, located south of the Florence area, traces its origin to both the first Bank of Florence and the second Bank of Florence.

9 MAJOR BIBLIOGRAPHICAL REFERENCES

Archives, Nebraska State Historical Society

10. GEOGRAPHICAL DATA

LATITUDE AND LONGITUDE COORDINATES DEFINING A RECTANGLE LOCATING THE PROPERTY			O R	LATITUDE AND LONGITUDE COORDINATES DEFINING THE CENTER POINT OF A PROPERTY OF LESS THAN ONE ACRE		
CORNER	LATITUDE	LONGITUDE		LATITUDE	LONGITUDE	
	Degrees Minutes Seconds	Degrees Minutes Seconds		Degrees Minutes Seconds	Degrees Minutes Seconds	
NW	° ' "	° ' "		41° 20' 15"	95° 57' 38"	
NE	° ' "	° ' "				
SE	° ' "	° ' "				
SW	° ' "	° ' "				

NO
LITM
CD

LIST ALL STATES AND COUNTIES FOR PROPERTIES OVERLAPPING STATE OR COUNTY BOUNDARIES

STATE:	CODE	COUNTY	CODE

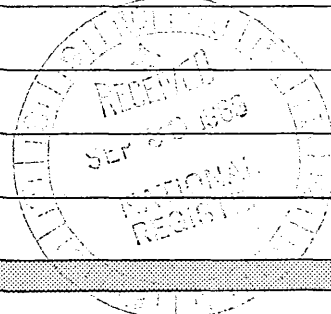

SEE INSTRUCTIONS

11. FORM PREPARED BY

NAME AND TITLE: John Q. Magie, Curator of History

ORGANIZATION: Nebraska State Historical Society DATE: August 22, 1969

STREET AND NUMBER: 1500 R Street

CITY OR TOWN: Lincoln STATE: Nebraska CODE: 68508

12. STATE LIAISON OFFICER CERTIFICATION

As the designated State Liaison Officer for the National Historic Preservation Act of 1966 (Public Law 89-665), I hereby nominate this property for inclusion in the National Register and certify that it has been evaluated according to the criteria and procedures set forth by the National Park Service. The recommended level of significance of this nomination is:

National State Local

Name Martin O. Smith Director

Title Nebr. State Hist. Soc.

Date Sept 22, 1969

NATIONAL REGISTER VERIFICATION

I hereby certify that this property is included in the National Register.

Ernest Allen Connally
Chief, Office of Archeology and Historic Preservation

OCT 15 1969

Date _____

ATTEST:

William J. Swintz
Keeper of The National Register

OCT 06 1969

Date _____

(FREMONT 1:125,000)

UNITED STATES
DEPARTMENT OF THE INTERIOR
GEOLOGICAL SURVEY

BLAIR 14 MI.
NASHVILLE 0.9 MI.

1:320,000 FEET (IOWA)

252,000m.E.

57'30"

R. 13 E.

96°00'
41°22'30"

510,000 FEET
(IOWA)

458,400m.N.

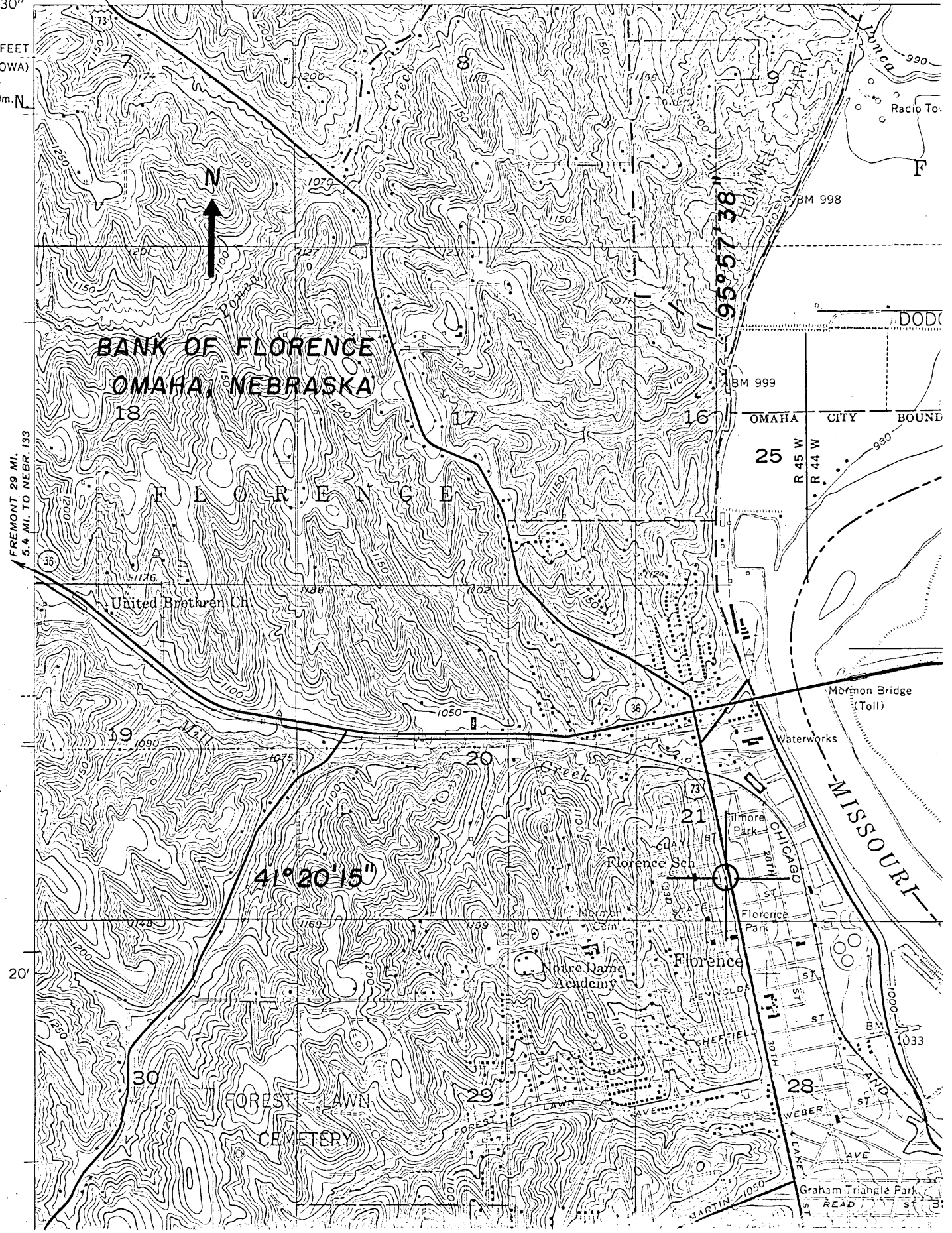

FREMONT 29 MI.
5.4 MI. TO NEBR. 133

20'

Form 10-301
(Dec. 1968)

UNITED STATES DEPARTMENT OF THE INTERIOR
NATIONAL PARK SERVICE

**NATIONAL REGISTER OF HISTORIC PLACES
PROPERTY MAP FORM**

(Type all entries - attach to or enclose with map)

STATE Nebraska	
COUNTY Douglas	
FOR NPS USE ONLY	
ENTRY NUMBER 68-10-26-0013	DATE 10/15/69

SEE INSTRUCTIONS

1. NAME			
COMMON:		Bank of Florence	
AND/OR HISTORIC:			
2. LOCATION			
STREET AND NUMBER:			
8502 North 30th Street			
CITY OR TOWN:			
Omaha			
STATE:	CODE	COUNTY:	CODE
Nebraska	26	Douglas	055
3. MAP REFERENCE			
SOURCE:			
U.S.G.S. 7½', quadrangle Omaha North			
SCALE:			
1:24,000			
DATE:			
1956			
4. REQUIREMENTS			
TO BE INCLUDED ON ALL MAPS			
1. Property boundaries where required.			
2. North arrow.			
3. Latitude and longitude reference.			

