

United States Department of the Interior  
National Park Service

National Register of Historic Places  
Continuation Sheet

RECEIVED

MAY 27 1987

NATIONAL  
REGISTER

Section number CZ 9 Page 1 Travnicek House

---

Site # CZ 9

1. John Travnicek Chalkrock House.
2. Tabor Township  
Tabor Vicinity  
South Dakota Code: 046
3. Building; Privately owned; NA acquisition; Occupied; Restricted access;  
Private residence.
4. Donald Zimmerman  
RR 1, Box 226  
Tabor, SD 57063
5. Register of Deeds  
Bon Homme County Courthouse  
Tyndall, SD 57066
7. Excellent; Altered; Original site.

The Travnicek House is an L-shaped three-bay masonry structure built of chalkrock blocks and mortared with mud. Its stone foundation includes a rectangular cellar entered from a trap door in the floor of the northwest bay (kitchen). The original plaster veneer has been removed and replaced with a modern stucco. An intersecting gable roof is constructed of common rafters, horizontal boards, and modern asphalt shingles. There are two chimneys. A recent fire gutted the building necessitating interior remodeling; however, the basic form is still intact. At that time one entry door on the south was eliminated and one interior bay was subdivided to provide space for a modern bathroom. A small vestibule was also added to the west facade.

8. 1869-1899; Architecture, Exploration/Settlement, Czech Ethnic.

Specific date unknown. Attributed to John Travnicek.

Significant in architecture, the John Travnicek House is a good example of modification of an Old World folk building tradition to accommodate modern living without destroying that basic form. The present owner uses the house as a residence for his hired farm hands.

United States Department of the Interior  
National Park Service

**National Register of Historic Places  
Continuation Sheet**

Section number CZ 9 Page 2 Travnicek House

---

The Travnicek House is also significant in the history of Czech settlement in the state. John Travnicek came to Dakota Territory from Moravia in 1874. He was one of the region's first Presbyterians. He helped found a congregation and cemetery about 2 miles northwest of his farmstead.

Major biographical source: Dvorak (1980), 110, 163.

10. Acreage: less than one acre. Scale: 1:24,000.  
Quad.: Tabor. UTM: 14/ 604780/ 4757270.

This site consists of an L-shaped house and the entrance vestibule on the west. The northern boundary is an imaginary line lying 5 feet from the northernmost wall of the house and running parallel to that wall. The eastern boundary is an imaginary line lying 5 feet from the easternmost wall of the house and running parallel to that wall. The southern boundary is an imaginary line lying 5 feet from the southernmost wall of the house and running parallel to that wall. The western boundary is an imaginary line lying 5 feet from the westernmost wall of the entrance vestibule and running to that wall. The site is located in the Northeast Quarter of the Northeast Quarter of Section 17, Township 94 North, Range 58 West, in Bon Homme County.

**United States Department of the Interior**  
**National Park Service**

# **National Register of Historic Places**

## **Continuation Sheet**

Section number CZ 9 Page 3

---

SITE PLAN OF FARMSTEAD CONTAINING CZ 9 ON RESERSE SIDE

SITE PLAN (Complete inventory of all structures, their function, dates & details of construction, and surrounding vegetation) WITH NORTH ARROW

SITE NAME: John Travnicek  
CZ SURVEY #: 9

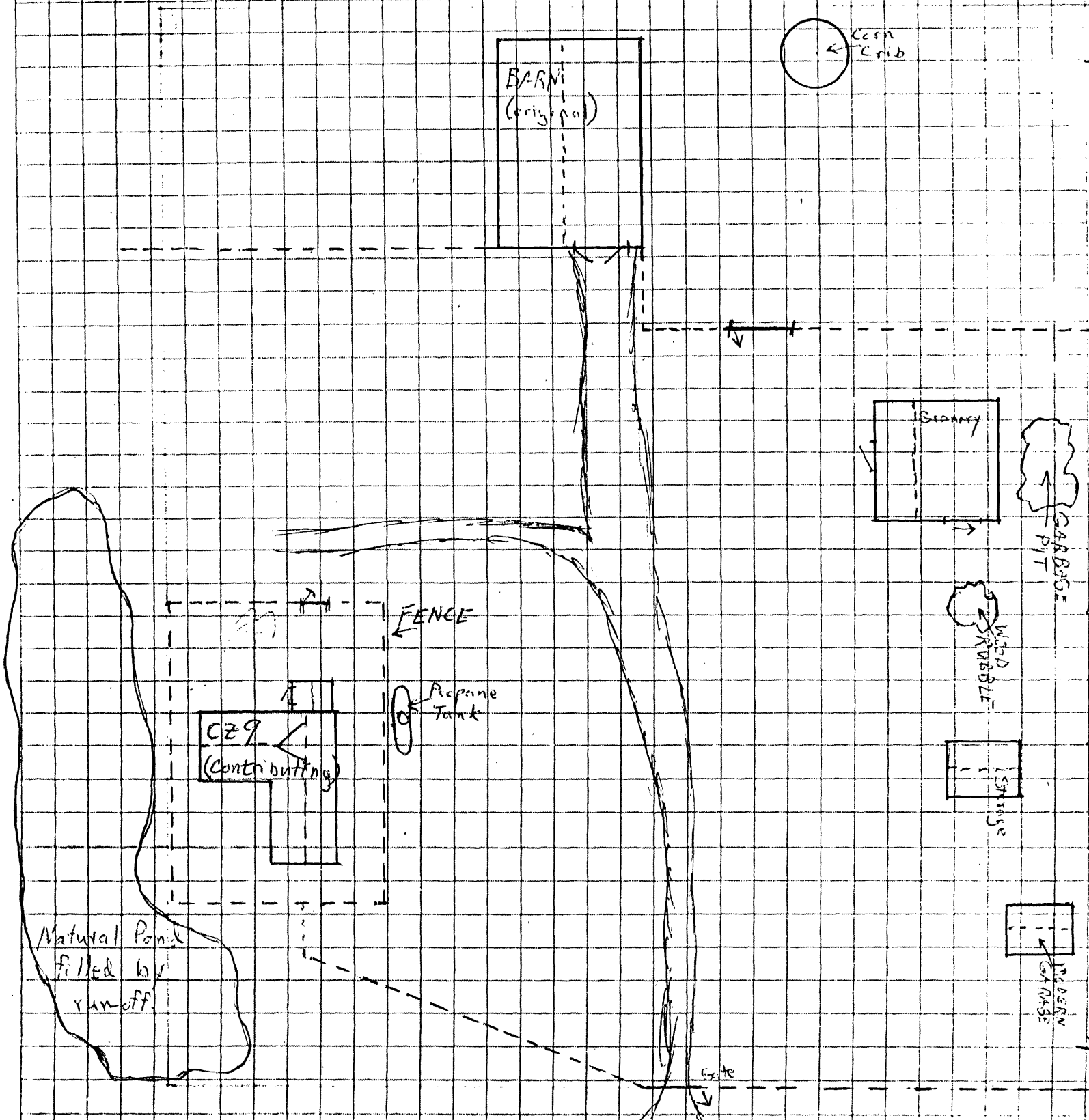

SD Hy 25

(approx 1/2 mi to SD Hy 50)