

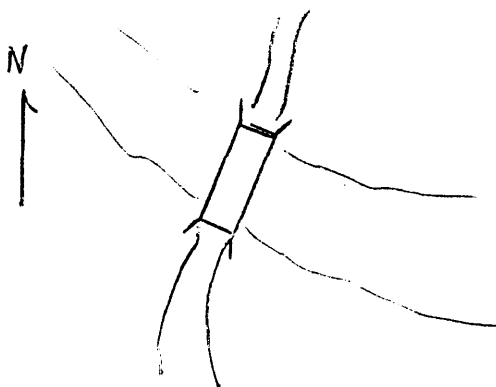

KENTUCKY HISTORIC RESOURCES INVENTORY

Site No. WS-84

1. Historic Name(s) Bridge--Long Lick Creek		22. ADD/County Lincoln Trail/Wash. 115	
Original Owner		23. U.S.G.S. Quadrant (15/75') Brush Grove 107	
2. Present Name As above		24. UTM Reference 16 65,7,3,4,0 4,1,8,6,1,0,0 Zone Easting Northing	
3. Location Hardesty-Polin Rd., over Long Lick Creek		25. Coordinate Accuracy □	
4. Owner's Name Washington County Fiscal Court		26. Prehistoric Site Object Historic Site <input checked="" type="checkbox"/> Structure Building Other	
5. Owner's Address Springfield, Ky. 40069		27. National Register District Name: N/A □□□□	
6. Open to Public Yes <input checked="" type="checkbox"/> No <input type="checkbox"/>	7. Visible from road Yes <input checked="" type="checkbox"/> No <input type="checkbox"/>	8. Ownership Private <input type="checkbox"/> Local <input checked="" type="checkbox"/> X State <input type="checkbox"/> Federal <input type="checkbox"/>	
9. Local Contact/Organization Wash. Co. Fiscal Ct.		28. Significance Evaluation NR N	
10. Site Plan with North Arrow 	11. Architect unknown		29. Status Date National Landmark <input type="checkbox"/> National Register <input type="checkbox"/> Landmark Certificate <input type="checkbox"/> Kentucky Survey <input type="checkbox"/> Local Landmark <input type="checkbox"/> HABS/HAER <input type="checkbox"/>
	12. Builder unknown		30. Historic Theme Primary Engineering C Secondary Transportation. G G Other □ □
	13. Date 1901-1925 A. <input checked="" type="checkbox"/> B. <input type="checkbox"/>		
	14. Style A. NA <input type="checkbox"/> B. <input type="checkbox"/>		31. Endangered Yes <input checked="" type="checkbox"/> No <input type="checkbox"/>
	15. Original Use Bridge Q		32. Preservation Project Status □ Actual Cost in \$1,000s □□□□□□
	16. Present use Bridge		33. ATTACH PHOTO 
	17. Condition Fair C		
18. Description Single lane, single span metal truss on limestone buttresses			
No. Stories N/A □	Single Pile <input type="checkbox"/> NA <input checked="" type="checkbox"/>	34. Prepared by: Joe DeSpain	
Double Pile <input type="checkbox"/>	Floor Plan N/A □	35. Organization Green Co. Hist. Soc., Inc.	
Structural Fabric Metal A. <input checked="" type="checkbox"/> B. <input type="checkbox"/>	Decorative Fabric N/A A. <input type="checkbox"/> B. <input type="checkbox"/>	36. Date Jan., 1983	
Roof Form N/A	37. Revision Dates 1/87	38. Staff Review	
19. History Unknown		21. Source of Information N/A and as a rare survival of metal truss bridge s. constructed by the county road system.	
20. Significance One of the few remaining metal truss bridges in Wash. Co. Unique in the county in its height and bracing. Significant under criterion C		21. Source of Information N/A and as a rare survival of metal truss bridge s. constructed by the county road system.	

(Continue on Back)

Roll No. 10
Picture No. 35

Direction _____

34. Prepared by:
Joe DeSpain

35. Organization
Green Co. Hist. Soc., Inc.

36. Date **Jan., 1983**

37. Revision Dates **1/87**

38. Staff Review

KENTUCKY HISTORIC RESOURCE INVENTORY SUPPLEMENT
BOUNDARY AND LOCATION INFORMATION

Historic Property Name Bridge -- Long Lick Creek Site # WS-84

Multiple Resource/Thematic Nomination Title Washington County Multiple Resource Area

U.T.M. Coordinates - List multiple UTM's if property is ten or more acres.

A. 16 657340 4186100 D. _____

B. _____ E. _____

C. _____ F. _____

Verbal Boundary Description

Acreage less than 1 acre

The structure is contained within a rectangle: 10' from the east and west sides of the bridge and 10' from the north and south sides of the bridge. The nominated acreage includes the bridge and the land immediately around it.

The nominated area includes one contributing structure.

Sketch of Site Plan (Showing outbuildings, structures, landscape features and the site boundary as described above.)

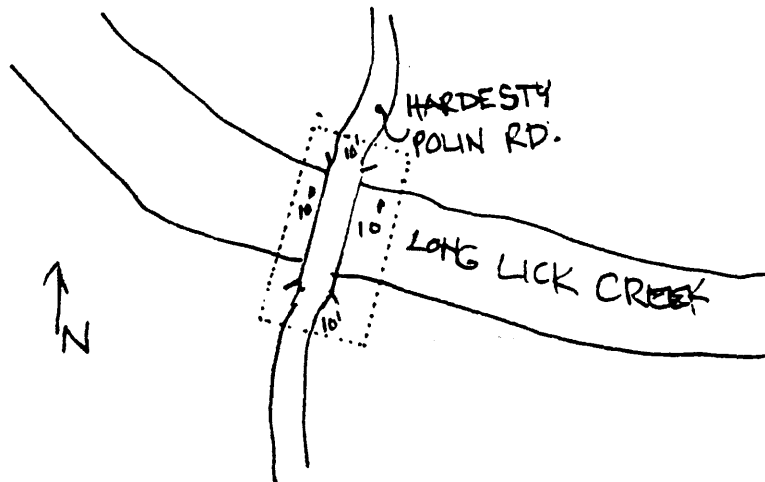

Official Courthouse Property Reference:

Washington County Courthouse, Springfield, Kentucky