

MASSACHUSETTS HISTORICAL COMMISSION  
294 Washington Street, Boston, MA 02108

PHOTO (3x3" or 3x5", black & white)  
Staple to left side of form  
Photo number 103:11

SKETCH MAP

Draw map showing property's location in relation to nearest cross streets and other buildings or geographical features. Indicate north.



UTM: 19/312570/4637300

Recorded by V H Adams

Organization Rehoboth Historical Commission

Date \_\_\_\_\_

Town REHOBOTH

Address 158 Perryville Road

Historic Name Goff Farm

Use: Original residence

Present residence

Ownership:  Private individual  
 Private organization

Public \_\_\_\_\_

Original owner Cromwell Goff

DESCRIPTION:

Date c. 1800; remodelled 1897

Source Snape, ed. 1979, pp. 28-32

Style Victorian

Architect unknown

Exterior wall fabric clapboard

Outbuildings barn/ice house

Major alterations (with dates) \_\_\_\_\_

1897 - see text

Moved no Date \_\_\_\_\_

Approx. acreage 2.5

Setting 40' from road across from associated dairy pasturage, now golf course

**ARCHITECTURAL SIGNIFICANCE (describe important architectural features and evaluate in terms of other buildings within community)**

The Goff Farm captures an important aspect of the conservative spirit of architectural expression in Rehoboth. While replacement or modifications of existing structures rather than wholly new construction has been a prevailing historical pattern, seldom were alterations guided by an interest in creating a modern architectural statement. The Goff Farm reflects an attempt of a prominent farming family to express their sense of pride and accomplishment within the means available to them.

The original structure of the house dates from the 18th or early 19th century. In 1897, the house was raised and a new first floor constructed as well as a 2½-story side ell. The result is a handsome though simple Italianate style residence which retains echoes  
(Continued)

**HISTORICAL SIGNIFICANCE (explain the role owners played in local or state history and how the building relates to the development of the community)**

In the early 1800s, Cromwell Goff bought land here. The property remained in the Goff family until recently. A large dairy business was operated here until the barn across from the house (built in 1897) was severely damaged by a hurricane in 1954. The barn was then demolished (portion of foundation still remains). Most of the farm land became property of the Rehoboth Country Club, which has kept the old grazing lands open, retaining the landscape of a large dairy farm. At the turn of the century after the house was enlarged, eight members of the Goff family (three generations) plus three or four hired men all lived there at one time. Harold Goff (1887-1974), the last family member to live there, was very active in the community. He was Selectman for twenty years, Registrar of Deeds for North Bristol County for eighteen years, and on the Board of Welfare for 47 years. He also belonged to several civic and fraternal organizations: Rising Sun Masonic Lodge (East Providence, Rhode Island), Senior Warden of Rehoboth Eastern Star Masonic Lodge, 55 years member of Taunton Lodge of Elks, and a trustee of the Bristol County Agricultural School. He and his wife donated 54 acres on the Palmer River to the Pawtucket Boys Club.

**BIBLIOGRAPHY and/or REFERENCES**

Snape, S. E., ed. In Old Rehoboth, 1979, pp.28-32.

INVENTORY FORM CONTINUATION SHEET

MASSACHUSETTS HISTORICAL COMMISSION  
Office of the Secretary, Boston

Community: Rehoboth	Form No: 213
Property Name: Goff Farm	

Indicate each item on inventory form which is being continued below.

ARCHITECTURAL SIGNIFICANCE (Continued)

of its earlier origins on the exterior, but is particularly notable for the fine craftsmanship of its interior.

Interior details from this remodelling include varnished woodwork, brass door plates and handles, and wainscoting in the ell (both floors). A walk-in refrigerator in the pantry behind the kitchen has its original brass handle and heavy varnished door, reflecting the success of this dairying family. At the time the house was remodelled, a large barn, an ice house, and a windmill were also built; only the ice house remains, south of the house. As a significant reflection of the evolution of architectural type in response to social changes over time, the Goff Farm meets criterion C of the National Register of Historic Places individually.

Staple to Inventory form at bottom

**United States Department of the Interior**  
**National Park Service**  
**National Register of Historic Places**  
**Inventory—Nomination Form**

For NPS use only

received

date entered

Continuation sheet

Item number

Page 3 of 4

Multiple Resource Area  
Thematic Group

Name Rehoboth Multiple Resource Area  
State Massachusetts

Nomination/Type of Review

Date/Signature

- |   |                                  |            |                                |
|---|----------------------------------|------------|--------------------------------|
| 21. <b>Goff Farm</b>                      | Substantive Review               | Keeper     | <u>Theresa Lundberg 6/6/83</u> |
|   | Entered in the National Register | Attest     | _____                          |
| 22. Goff Homestead                        |                                  | for Keeper | <u>Delores Byers 6/6/83</u>    |
|   |                                  | Attest     | _____                          |
| 23. Hornbine Baptist Church               | Entered in the National Register | for Keeper | <u>Delores Byers 6/6/83</u>    |
|   |                                  | Attest     | _____                          |
| 24. Hornbine School                       | Entered in the National Register | for Keeper | <u>Delores Byers 6/6/83</u>    |
|   |                                  | Attest     | _____                          |
| 25. Horton, Welcome, Farm                 | Entered in the National Register | for Keeper | <u>Delores Byers 6/6/83</u>    |
|   |                                  | Attest     | _____                          |
| 26. House at 197 Hornbine Road            | Entered in the National Register | for Keeper | <u>Delores Byers 6/6/83</u>    |
|   |                                  | Attest     | _____                          |
| 27. House at 30 Kelton Street             | Entered in the National Register | for Keeper | <u>Delores Byers 6/6/83</u>    |
|   |                                  | Attest     | _____                          |
| 28. Ingalls-Wheeler-Horton Homestead Site | Entered in the National Register | for Keeper | <u>Delores Byers 6/6/83</u>    |
|   |                                  | Attest     | _____                          |
| 29. Kingsley House                        | Entered in the National Register | for Keeper | <u>Delores Byers 6/6/83</u>    |
|   |                                  | Attest     | _____                          |
| 30. Knapp, Seth, Jr., House               | Entered in the National Register | for Keeper | <u>Delores Byers 6/6/83</u>    |
|   |                                  | Attest     | _____                          |

United States Department of the Interior  
National Park Service

Substantive Review

Goff Farm (Rehoboth MRA)  
Bristol County  
MASSACHUSETTS

Working No. 4/25/83  
Fed. Reg. Date: 2.7.84  
Date Due: 5/26/83 - 6/9/83  
Action:  ACCEPT 6/6/83  
 RETURN  
 REJECT

Federal Agency: \_\_\_\_\_

- resubmission
- nomination by person or local government
- owner objection
- appeal

Substantive Review:  sample  request  appeal  NR decision

Reviewer's comments:

Recom./Criteria ACCEPT  
Reviewer Mar Dwyer  
Discipline A.H.  
Date 6-6-83  
see continuation sheet

Nomination returned for:  technical corrections cited below  
 substantive reasons discussed below

1. Name

2. Location

3. Classification

Category	Ownership	Status	Present Use
	Public Acquisition	Accessible	

4. Owner of Property

5. Location of Legal Description

6. Representation in Existing Surveys

has this property been determined eligible?  yes  no

7. Description

Condition		Check one	Check one
<input type="checkbox"/> excellent	<input type="checkbox"/> deteriorated	<input type="checkbox"/> unaltered	<input type="checkbox"/> original site
<input type="checkbox"/> good	<input type="checkbox"/> ruins	<input type="checkbox"/> altered	<input type="checkbox"/> moved date _____
<input type="checkbox"/> fair	<input type="checkbox"/> unexposed		

Describe the present and original (if known) physical appearance

- summary paragraph
- completeness
- clarity
- alterations/integrity
- dates
- boundary selection

## 8. Significance

Period \_\_\_\_\_ Areas of Significance—Check and justify below

Specific dates \_\_\_\_\_ Builder/Architect \_\_\_\_\_

Statement of Significance (in one paragraph)

- summary paragraph  
 completeness  
 clarity  
 applicable criteria  
 justification of areas checked  
 relating significance to the resource  
 context  
 relationship of integrity to significance  
 justification of exception  
 other

## 9. Major Bibliographical References

## 10. Geographical Data

Acreage of nominated property \_\_\_\_\_

Quadrangle name \_\_\_\_\_

USGT References \_\_\_\_\_

Verbal boundary description and justification \_\_\_\_\_

## 11. Form Prepared By

## 12. State Historic Preservation Officer Certification

The evaluated significance of this property within the state is:

\_\_\_\_ national \_\_\_\_ state \_\_\_\_ local

State Historic Preservation Officer signature \_\_\_\_\_

title \_\_\_\_\_ date \_\_\_\_\_

## 13. Other

- Maps  
 Photographs  
 Other

Questions concerning this nomination may be directed to \_\_\_\_\_

Signed \_\_\_\_\_ Date \_\_\_\_\_ Phone: 202 272-3504

Comments for any item may be continued on an attached sheet



#213

103:11

Goff Farm  
Rehoboth MA, Ma

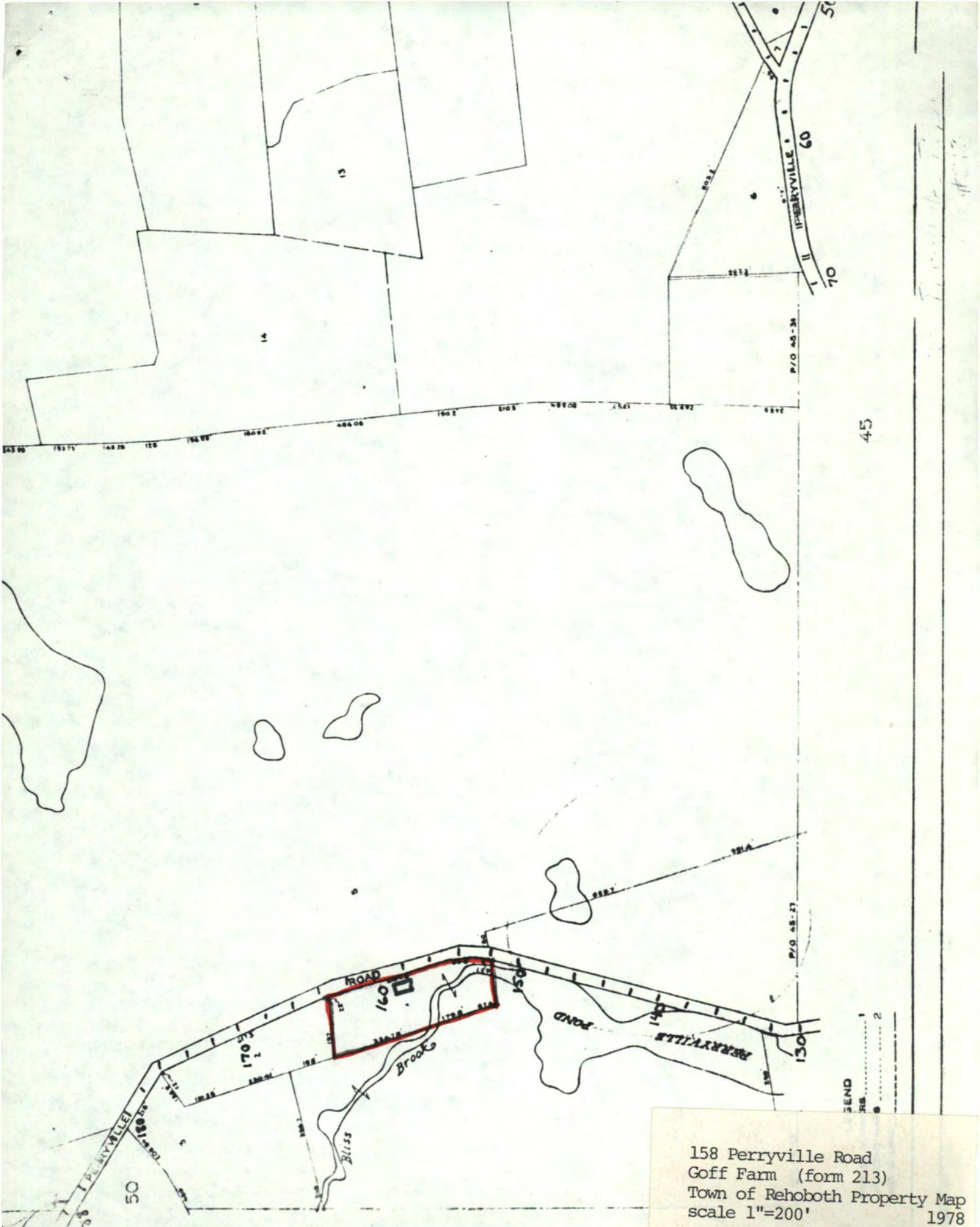

158 Perryville Road  
 Goff Farm (form 213)  
 Town of Rehoboth Property Map  
 scale 1"=200' 1978

Please refer to the map in the  
Multiple Property Cover Sheet  
for this property

Multiple Property Cover Sheet Reference Number: 64000292