

United States Department of the Interior  
National Park Service

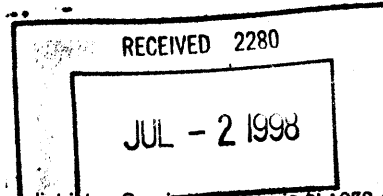

NATIONAL REGISTER OF HISTORIC PLACES  
REGISTRATION FORM

This form is for use in nominating or requesting determinations for individual properties and districts. See instructions on the back of this form. Complete the National Register of Historic Places Registration Form (National Register Bulletin 16A). Complete each item by checking the appropriate box or by entering the information requested. If any item does not apply to the property being documented, enter "N/A" if not applicable. For functions, architectural classification, materials, and areas of significance, enter only categories and subcategories from the instructions. Place additional entries and narrative items on continuation sheets (NPS Form 10-900a). Use a typewriter, word processor, or computer, to complete all items.

1. Name of Property

historic name LLOYD WOMAN'S CLUB

other names/site number Lloyd Home Demonstration Club

2. Location

street & number Bond Street (no number) N/A  not for publication

city or town Lloyd N/A  vicinity

state FLORIDA code FL county Jefferson code 065 zip code 32337

3. State/Federal Agency Certification

As the designated authority under the National Historic Preservation Act, as amended, I hereby certify that this  nomination  request for determination of eligibility meets the documentation standards for registering properties in the National Register of Historic Places and meets the procedural and professional requirements set forth in 36 CFR Part 60. In my opinion, the property  meets  does not meet the National Register criteria. I recommend that this property be considered significant  nationally  statewide  locally. ( See continuation sheet for additional comments.)

Janice L. Pithy, DSHPO 6-24-98  
Signature of certifying official/Title Date

Florida State Historic Preservation Officer, Division of Historical Resources  
State or Federal agency and bureau

In my opinion, the property  meets  does not meet the National Register criteria. ( See continuation sheet for additional comments.)

\_\_\_\_\_  
Signature of certifying official/Title Date

\_\_\_\_\_  
State or Federal agency and bureau

4. National Park Service Certification

I hereby certify that the property is:

- entered in the National Register  See continuation sheet
- determined eligible for the National Register  See continuation sheet.
- determined not eligible for the National Register  See continuation sheet.
- removed from the National Register.
- other, (explain) \_\_\_\_\_

for Signature of the Keeper

Date of Action

M. J. M. [Signature]

8/10/98

Lloyd Woman's Club  
Name of Property

Jefferson Co., FL  
County and State

**5. Classification**

**Ownership of Property**  
(Check as many boxes as apply)

- private
- public-local
- public-State
- public-Federal

**Category of Property**  
(Check only one box)

- buildings
- district
- site
- structure
- object

**Number of Resources within Property**  
(Do not include any previously listed resources in the count)

Contributing	Noncontributing	
<u>1</u>	<u>0</u>	buildings
<u>0</u>	<u>0</u>	sites
<u>0</u>	<u>0</u>	structures
<u>0</u>	<u>0</u>	objects
<u>1</u>	<u>0</u>	total

**Name of related multiple property listings**  
(Enter "N/A" if property is not part of a multiple property listing.)

**Number of contributing resources previously listed in the National Register**

Clubhouses of Florida's Woman's Clubs

0

**6. Function or Use**

**Historic Functions**  
(Enter categories from instructions)

SOCIAL: meeting hall  
\_\_\_\_\_  
\_\_\_\_\_  
\_\_\_\_\_  
\_\_\_\_\_  
\_\_\_\_\_  
\_\_\_\_\_

**Current Functions**  
(Enter categories from instructions)

SOCIAL: meeting hall  
\_\_\_\_\_  
\_\_\_\_\_  
\_\_\_\_\_  
\_\_\_\_\_  
\_\_\_\_\_

**7. Description**

**Architectural Classification**  
(Enter categories from instructions)

OTHER: frame vernacular  
\_\_\_\_\_  
\_\_\_\_\_

**Materials**  
(Enter categories from instructions)

foundation BRICK  
walls WOOD  
\_\_\_\_\_  
roof METAL  
other \_\_\_\_\_  
\_\_\_\_\_

**Narrative Description**

(Describe the historic and current condition of the property on one or more continuation sheets.)

**8. Statement of Significance**

**Applicable National Register Criteria**

(Mark "x" in one or more boxes for the criteria qualifying the property for National Register listing.)

- A** Property is associated with events that have made a significant contribution to the broad patterns of our history.
- B** Property is associated with the lives of persons significant in our past.
- C** Property embodies the distinctive characteristics of a type, period, or method of construction or represents the work of a master, or possesses high artistic values, or represents a significant and distinguishable entity whose components lack individual distinction.
- D** Property has yielded, or is likely to yield information important in prehistory or history.

**Criteria Considerations**

(Mark "x" in all the boxes that apply.)

Property is:

- A** owned by a religious institution or used for religious purposes.
- B** removed from its original location.
- C** a birthplace or grave.
- D** a cemetery.
- E** a reconstructed building, object, or structure.
- F** a commemorative property.
- G** less than 50 years of age or achieved significance within the past 50 years

**Narrative Statement of Significance**

(Explain the significance of the property on one or more continuation sheets.)

**9. Major Bibliographical References**

**Bibliography**

Cite the books, articles, and other sources used in preparing this form on one or more continuation sheets.)

**Previous documentation on file (NPS):**

- preliminary determination of individual listing (36 CFR 36) has been requested
  - previously listed in the National Register
  - previously determined eligible by the National Register
  - designated a National Historic Landmark
  - recorded by Historic American Buildings Survey
- # \_\_\_\_\_

**Areas of Significance**

(Enter categories from instructions)

**SOCIAL HISTORY**

---



---



---



---



---

**Period of Significance**

1939-1948

---



---

**Significant Dates**

1939

---



---

**Significant Person**

N/A

---

**Cultural Affiliation**

N/A

---



---

**Architect/Builder**

unknown/Works Progress Administration

---



---

**Primary location of additional data:**

- State Historic Preservation Office
- Other State Agency
- Federal agency
- Local government
- University
- Other

Name of Repository

---

Lloyd Woman's Club  
Name of Property

Jefferson Co., FL  
County and State

**10. Geographical Data**

**Acreeage of Property** less than one (.5)

**UTM References**

(Place additional references on a continuation sheet.)

1	1 7	7 8 5 4 0 0	3 3 7 5 2 8 0
	Zone	Easting	Northing
2			

3			
	Zone	Easting	Northing
4			

See continuation sheet

**Verbal Boundary Description**

(Describe the boundaries of the property on a continuation sheet.)

**Boundary Justification**

(Explain why the boundaries were selected on a continuation sheet.)

**11. Form Prepared By**

name/title Rhea Miller/Robert O. Jones, Historic Sites Specialist

organization Bureau of Historic Preservation date June 1998

street & number R.A. Gray Building, 500 S. Bronough Street telephone (850) 487-2333

city or town Tallahassee state Florida zip code 32399-0250

**Additional Documentation**

Submit the following items with the completed form:

**Continuation Sheets**

**Maps**

A **USGS map** (7.5 or 15 minute series) indicating the property's location.

A **Sketch map** for historic districts and properties having large acreage or numerous resources.

**Photographs**

Representative **black and white photographs** of the property.

**Additional items**

(check with the SHPO or FPO for any additional items)

**Property Owner**

(Complete this item at the request of SHPO or FPO.)

name Jefferson County

street & number County Courthouse telephone 850-342-0218

city or town Monticello state FL zip code 32344

United States Department of the Interior  
National Park Service

**NATIONAL REGISTER OF HISTORIC PLACES  
CONTINUATION SHEET**

Section number 7 Page 1 **LLOYD WOMAN'S CLUB, LLOYD, JEFFERSON  
COUNTY, FLORIDA**

---

**SUMMARY**

The Lloyd Woman's Club building is located on Bond Street (no number), in the un-incorporated community of Lloyd, Jefferson County, Florida. The main, north facade fronts onto Bond Street. The 1939, one-story frame vernacular building has an irregular footprint, rests on a brick pier foundation, and has a cross gable roof, surfaced with metal. A brick chimney pierces the roof peak of a southern extension. The exterior is horizontal drop siding, and windows are 2/2, double-hung wooden sash.

**SETTING**

When constructed in 1939, the building was in an open field, and located on the south side of Bond Street, the community's main east/west thoroughfare, and directly across from the newly constructed WPA Lloyd School. Trees and shrubs surround the property and building, and a circular drive and club sign are adjacent to Bond Street (Photo #1). The crossroads of Bond and the north/south Main Street is less than one-half mile to the east. The 1939 building lies just west of the Lloyd Historic District (NR 1991), which has a period of significance from 1840 - 1920.

**DESCRIPTION**

**Exterior**

The building was constructed with a "T" footprint with the main block having side gables, and a central, cross gable southerly extension to accommodate a kitchen. A small addition onto the west gable end was made in 1963. Built on brick piers, the building has drop siding exterior and metal roof.

The main, north facade contains central double doors with four lights in the upper half. The entry is reached from a wooden porch with three steps and a concrete ramp. The porch is sheltered by a gable portico supported by two square corner posts (Photo #2). Molding around the tops of the posts gives the appearance of capitals. The entry is flanked by pairs of windows with narrow shutters. One window is in the western extension whose roof line is below the main block roof line.

The west elevation has a gable extension with a louvered vent in the gable and two small windows on the south side (Photo #3). A louvered vent is visible in the gable of the main block. The south extension is visible

**United States Department of the Interior  
National Park Service**

**NATIONAL REGISTER OF HISTORIC PLACES  
CONTINUATION SHEET**

Section number 7 Page 2 **LLOYD WOMAN'S CLUB, LLOYD, JEFFERSON  
COUNTY, FLORIDA**

---

with one window in its wall, and a the profile of the rear portico is visible as well.

The south elevation has a gable extension with a gable portico at the west corner, and a pair of windows to the east (Photo #4). A window is visible to the west and east within the main block.

The east elevation has the gable end of the main block with a louvered vent within the gable, and two windows (Photo #5). One window within the side wall of the south extension is visible.

**Interior**

Within the main entrance is one main room with a brick fireplace centered on the southern wall (Photos #6&7). The floors are wooden, and the walls and ceiling are finished with tongue and groove pine wood paneling. Two doors in the western wall of the main room access men's and women's toilets, and a storage area. Two doors flanking the fireplace access the kitchen which has a door in the southwest corner. A sink and counter, with under-counter cabinets, and simple wood shelving, are present (Photos #8&9).

**ALTERATIONS**

In 1954, running water was installed. In 1963 the west extension to accommodate restrooms was added.

**United States Department of the Interior  
National Park Service**

**NATIONAL REGISTER OF HISTORIC PLACES  
CONTINUATION SHEET**

Section number 8 Page 1 **LLOYD WOMAN'S CLUB, LLOYD, JEFFERSON  
COUNTY, FLORIDA**

---

**SUMMARY**

The Lloyd Woman's Club is nominated to the National Register under Criterion A on the local level in the area of Social History. Prior to the building's construction, and ever since, the club has been involved with community betterment programs. The club house is the only community facility Lloyd has had, past or present. The building is a good example of vernacular construction, and maintains its architectural integrity. The property is nominated under the Multiple Property cover "Clubhouses of Florida's Woman's Clubs," under the historic context of Great Depression, World War II and Aftermath, 1929-1948, and under the Property Type F.1, Clubhouses: Frame Vernacular.

**HISITORIC CONTEXT**

Florida became a United States territory in 1821, and Tallahassee was made the territorial capital in 1824. One of the first settlers in the Lloyd area was William Bailey who established a grist mill to serve the surrounding plantations. Bailey's Mill was the first name for the late 1820s settlement. Jefferson County was established in 1827. In 1831 a post office was established at the mill. Cotton was the primary crop in the antibellum period in north Florida, and Jefferson County was a part of that plantation economy. The cotton crop had to be shipped out of the port at St. Mark's on the Gulf Coast, but transportation became easier when a railroad connecting the region to Lake City to the east, and Georgia, was built in 1858. When a railroad depot was built at Lloyd, it dominated the economic activity of the settlement, which then was called Station #2, number one being Tallahassee. Following the Civil War, the region became more diversified agriculturally, and by the 1870s, the community, now called Lloyd, prospered and grew slowly until the 1920s. Boll weevils devastated cotton production in 1916 and 1917, and with the growing use of automobiles, Tallahassee and Monticello became the preferred places to buy supplies. Lloyd remained a quiet community of about 300 people. In the late 1930s, a modest amount of construction occurred at the western boundary to the community, which included the WPA assisted school across the street from the club house.

In 1917, the Women's and Girl's Club was organized as a part of the Home Demonstration work begun in 1911. It was the second Home Demonstration group to form in Jefferson County, the first being in Aucilla, and the third in Lamont. Six members formed the group and three

**United States Department of the Interior  
National Park Service**

**NATIONAL REGISTER OF HISTORIC PLACES  
CONTINUATION SHEET**

Section number 8 Page 2 **LLOYD WOMAN'S CLUB, LLOYD, JEFFERSON  
COUNTY, FLORIDA**

---

were elected officers. At their first meeting their numbers tripled. Reflecting wartime concerns, the club promoted sugarless recipes, clothing makeovers, "Victory" gardening, and assisting the Red Cross. Conforming to the format of Home Demonstration Extension offices, the club changed their name to The Lloyd Home Demonstration Club. The club, however, always kept a bank account in the name of the "Women's Club." They met in a local school room and private homes. Home demonstration work was discontinued from 1921-1929. T.H. Lloyd, the town's founder and prominent businessman offered the women two rooms within the Lloyd-Bond House (NR 1984). The club by this time desired a permanent community center, and every year a finance committee raised money with many activities including cake sales, suppers, and most popular, political rally suppers. During the Great Depression the Works Progress Administration furnished labor for community buildings, the women applied for the support. Being \$100 short of the cash needed, they successfully appealed to the community to raise the lump sum.

**HISTORIC SIGNIFICANCE**

The frame community building was formally opened on April 11, 1939 with a luncheon for 65 members of the Jefferson County Home Demonstration Council. A formal dedication was held May 25<sup>th</sup>. The club continued their earlier activities of a village clean-up day, shrubbery purchases, and food demonstrations. When active, the Girl Scouts, and the 4-H Club met in the building. The club continued their tradition of hosting dinners where political candidates would speak, as well as hosting annual community suppers, and the building has always been used as a polling place.

The name of the club underwent several changes during the 1960s, adopting the name of "The Lloyd Homemakers Club" in 1973, and most recently the "Lloyd Women's Club" in 1975. Despite these changes, the name "Woman's Club" has always been painted on a sign since its construction, and has been referred to as such within the community. The club has worked to beautify the town, build a playground, install street lights, and has confronted community issues of the water supply, impact of the interstate highway, and a proposed gas pipeline. The club contributed to the well being of Lloyd until being officially disbanded in May of 1991.



**United States Department of the Interior  
National Park Service**

**NATIONAL REGISTER OF HISTORIC PLACES  
CONTINUATION SHEET**

Section number 9 Page 1 **LLOYD WOMAN'S CLUB, LLOYD, JEFFERSON  
COUNTY, FLORIDA**

---

**BIBLIOGRAPHY**

- Gaddy, Nan Gadsden, recollections, 1997. (Founding member)
- Clayton, Gladys, "History of Lloyd Home Demonstration Club," u.p., 1967.
- Clayton, Gladys, recollections, 1997. (Club member and officer)
- Johnson, Frank, recollections, 1997. (Founding member of men's Civic Club)
- Lloyd Home Demonstration Club, minutes, Jefferson County Extension Office, Monticello.
- , scrapbooks, Keystone Genealogical Library, Monticello.
- McLeod, Mary, recollections, 1997. (Club member and officer)
- Miller, Rhea Bond, recollections, 1997. (Club member and officer)
- Newcomb, Ruth, recollections, 1997. (Club member and officer)
- Rothman, Betty, recollections, 1997. (Club member)
- Simpson, Alda, recollections, 1997. (Club member)
- Shofner, Jerrell, Jefferson County, Florida. Tallahassee: Sentry Press, 1976.
- Taylor Posey, "Historical Sketch of Lloyd Home Demonstration Club," u.p. 1946.
- (Unpublished accounts of the club by Clayton and Taylor are stored at the Jefferson County Extension Office, Monticello)

**United States Department of the Interior  
National Park Service**

**NATIONAL REGISTER OF HISTORIC PLACES  
CONTINUATION SHEET**

Section number 10 Page 1 **LLOYD WOMAN'S CLUB, LLOYD, JEFFERSON  
COUNTY, FLORIDA**

---

**VERBAL BOUNDARY DESCRIPTION**

Commencing at a point on the Old Public Road leading from Lloyd, Florida to Tallahassee, Florida (On the south side thereof) and at the Northwest corner of that certain Two acre tract of land which was conveyed by Carson Downing and wife to James V. Johnson by deed dated July 28<sup>th</sup>, 1936, and recorded in deed book "WW" at page 469 of the Public Records of said County of Jefferson; and running thence South a distance of Two Hundred and Ten (210) Feet, thence running North Two Hundred and Ten feet more or less and to the Southern Border of said Public Road to starting point, and containing one-half (1/2) acre more or less, and being a portion of the Northeast Quarter of the Northeast Quarter of Section Twenty-One (21) Township One (1) North of Range Three (3) east.

**BOUNDARY JUSTIFICATION**

The boundary encompasses the property historically associated with the Lloyd Woman's Club.

**United States Department of the Interior  
National Park Service**

**NATIONAL REGISTER OF HISTORIC PLACES  
CONTINUATION SHEET**

Section number          Photos          Page   1   **LLOYD WOMAN'S CLUB, LLOYD, JEFFERSON  
COUNTY, FLORIDA**

---

**PHOTOGRAPH LIST**

1. Lloyd Woman's Club, Bond Street, Lloyd
2. Jefferson County, Florida
3. Carol M. Miller
4. December 1997
5. Lloyd Community Preservation Trust
6. North and east elevations, facing southwest
7. Photo #1 of 10

Items 1-5 are the same for the following photographs.

6. Main entrance, facing southeast
7. Photo #2 of 10
  
6. North and west elevations, facing southeast
7. Photo #3 of 10
  
6. South elevation, facing north
7. Photo #4 of 10
  
6. East elevation, facing northwest
7. Photo #5 of 10
  
6. Interior of main entrance and north wall, facing northeast
7. Photo #6 of 10
  
6. Fireplace and south interior wall, facing southwest
7. Photo #7 of 10
  
6. Kitchen, southeast corner, facing southeast
7. Photo #8 of 10
  
6. Kitchen shelves and wall, facing west
7. Photo #9 of 10
  
6. Rear of fireplace, north wall of kitchen, facing northeast
7. Photo #10 of 10

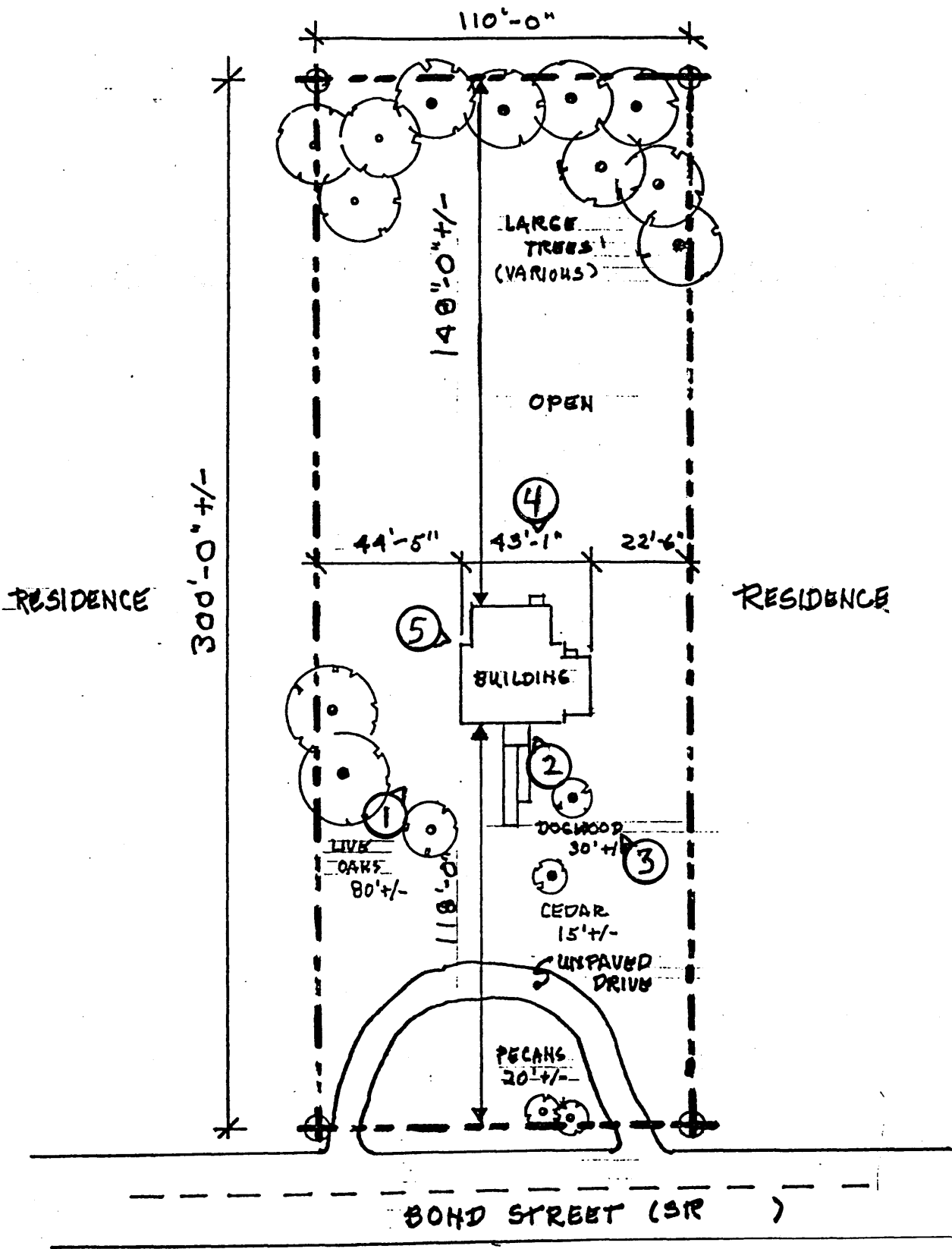

LLOYD, JEFFERSON CO., FL  
LLOYD WOMENS CLUB

SITE PLAN  
 & PHOTO DIAGRAM

LLOYD, JEFFERSON CO., FL  
LLOYD WOMENS CLUB  
FLOOR PLAN & PHOTO DIAGRAM

