

**NATIONAL REGISTER OF HISTORIC PLACES  
INVENTORY - NOMINATION FORM**

(Type all entries - complete applicable sections)

|                               |                 |
|-------------------------------|-----------------|
| STATE:<br>Nebraska            |                 |
| COUNTY:<br>Sarpy              |                 |
| FOR NPS USE ONLY              |                 |
| ENTRY NUMBER<br>69-04-26-0003 | DATE<br>4/16/69 |

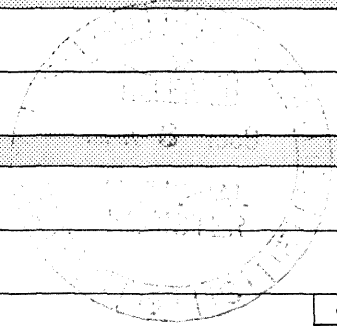

SEE INSTRUCTIONS

**1. NAME**

COMMON:  
Fontanelle Bank

AND/OR HISTORIC:  
Bellevue Town Hall, Sarpy County Court House

**2. LOCATION**

STREET AND NUMBER:  
2212 Main Street

CITY OR TOWN:  
Bellevue

STATE: Nebraska      CODE: 26      COUNTY: Sarpy      CODE: 153

**3. CLASSIFICATION**

| CATEGORY<br>(Check One)  | OWNERSHIP                                   | STATUS   | ACCESSIBLE TO THE PUBLIC  |
|--|---|--|---|
| District <input type="checkbox"/> Building <input checked="" type="checkbox"/> | Public <input type="checkbox"/>             | Occupied <input type="checkbox"/>                      | Yes: Restricted <input type="checkbox"/>                                  |
| Site <input type="checkbox"/> Structure <input type="checkbox"/>               | Private <input checked="" type="checkbox"/> | Unoccupied <input checked="" type="checkbox"/>         | Unrestricted <input type="checkbox"/>                                     |
| Object <input type="checkbox"/>  | Both <input type="checkbox"/>               | Preservation work in progress <input type="checkbox"/> | No: <input checked="" type="checkbox"/>                                   |
| PRESENT USE (Check One or More as Appropriate)                                 |   |  |   |
| Agricultural <input type="checkbox"/>  | Government <input type="checkbox"/>         | Park <input type="checkbox"/>                          | Transportation <input type="checkbox"/> Comments <input type="checkbox"/> |
| Commercial <input type="checkbox"/>  | Industrial <input type="checkbox"/>         | Private Residence <input type="checkbox"/>             | Other (Specify) <input checked="" type="checkbox"/>                       |
| Educational <input type="checkbox"/>   | Military <input type="checkbox"/>           | Religious <input type="checkbox"/>                     | _____   |
| Entertainment <input type="checkbox"/>   | Museum <input type="checkbox"/>             | Scientific <input type="checkbox"/>                    | Vacant _____  |

**4. OWNER OF PROPERTY**

OWNERS NAME:  
Mrs. Harold D. LeMar

STREET AND NUMBER:  
3807 Burt Street

CITY OR TOWN: Omaha      STATE: Nebraska      CODE: 26

**5. LOCATION OF LEGAL DESCRIPTION**

COURTHOUSE, REGISTRY OF DEEDS, ETC.:  
County Clerk, Sarpy County Court House

STREET AND NUMBER:  
122 East 3rd Street

CITY OR TOWN: Papillion      STATE: Nebraska      CODE: 26

APPROXIMATE ACREAGE OF NOMINATED PROPERTY: 1/4 acre

**6. REPRESENTATION IN EXISTING SURVEYS**

TITLE OF SURVEY:  
Historic American Buildings Survey

DATE OF SURVEY: 1934      Federal       State       County       Local

DEPOSITORY FOR SURVEY RECORDS:  
Library of Congress

STREET AND NUMBER:  
\_\_\_\_\_

CITY OR TOWN: Washington      STATE: D.C.      CODE: 08

STATE: Nebraska  
COUNTY: Sarpy  
ENTRY NUMBER: 69-04-26-0003  
DATE: 4/16/69  
FOR NPS USE ONLY

**7. DESCRIPTION**

|           |                                    |   |                               |                                       |   |                                    |
|-----------|------------------------------------|---|-------------------------------|---------------------------------------|---|------------------------------------|
| CONDITION | (Check One)                        |   |                               |                                       |   |                                    |
|           | Excellent <input type="checkbox"/> | Good <input checked="" type="checkbox"/>      | Fair <input type="checkbox"/> | Deteriorated <input type="checkbox"/> | Ruins <input type="checkbox"/>                    | Unexposed <input type="checkbox"/> |
| INTEGRITY | (Check One)                        |   |                               | (Check One)                           |   |                                    |
|           | Altered <input type="checkbox"/>   | Unaltered <input checked="" type="checkbox"/> |                               | Moved <input type="checkbox"/>        | Original Site <input checked="" type="checkbox"/> |                                    |

DESCRIBE THE PRESENT AND ORIGINAL (if known) PHYSICAL APPEARANCE

Few exterior alterations appear to have been made to this building since its construction in 1856. It is a modestly pretentious, two story brick structure, rectangular in plan and crowned by a hipped roof. The placement of four brick pilasters across the first floor facade (east elevation) suggests Greek Revival influence, while the elaborate window caps and the elongation of the wall openings show early Italianate influence. Several interior alterations have been made over the years, although what is evidently the original bank vault remains intact on the first floor.

The Fontanelle Bank was purchased in 1961 by a local preservationist, Mrs. Harold D. LeMar, President of the Greater Nebraska Historical Foundation. She has made several needed repairs. For the past several years, she has rented the building for use as an antique shop. The future use of the building, now vacant, remains uncertain. An official Nebraska Historical Marker has recently been installed on the lawn in front of the building.

SEE INSTRUCTIONS

**8. SIGNIFICANCE**

PERIOD (Check One or More as Appropriate)

- Pre-Columbian       16th Century       18th Century       20th Century   
 15th Century       17th Century       19th Century

SPECIFIC DATE(S) (If Applicable and Known)      1856

AREAS OF SIGNIFICANCE (Check One or More as Appropriate)

- |                |              |                          |                |                                     |                 |                          |
|----------------|--------------|--------------------------|----------------|-------------------------------------|-----------------|--------------------------|
| Aboriginal     | Education    | <input type="checkbox"/> | Political      | <input checked="" type="checkbox"/> | Urban Planning  | <input type="checkbox"/> |
| Prehistoric    | Engineering  | <input type="checkbox"/> | Religion/Phi-  |                                     | Other (Specify) | <input type="checkbox"/> |
| Historic       | Industry     | <input type="checkbox"/> | losophy        | <input type="checkbox"/>            | _____           |                          |
| Agriculture    | Invention    | <input type="checkbox"/> | Science        | <input type="checkbox"/>            | _____           |                          |
| Art            | Landscape    | <input type="checkbox"/> | Sculpture      | <input type="checkbox"/>            | _____           |                          |
| Commerce       | Architecture | <input type="checkbox"/> | Social/Human-  |                                     | _____           |                          |
| Communications | Literature   | <input type="checkbox"/> | itarian        | <input type="checkbox"/>            | _____           |                          |
| Conservation   | Military     | <input type="checkbox"/> | Theater        | <input type="checkbox"/>            | _____           |                          |
|                | Music        | <input type="checkbox"/> | Transportation | <input type="checkbox"/>            | _____           |                          |

STATEMENT OF SIGNIFICANCE (Include Personages, Dates, Events, Etc.)

This structure was built in 1856 as the Fontanelle Bank, a "wildcat" bank which failed in the Panic of 1857. The building later served as the Sarpy County Court House from 1861 to 1875, when the county seat was moved to Papillion. It served thereafter as Bellevue's Town Hall until 1959. Few Greek Revival structures remain in Nebraska, founded as a territory in 1854, when this style was losing its popularity in America. The Fontanelle Bank is a rare Nebraska example of transitional Greek Revival- Italianate styling. It is possibly the oldest commercial building, as well as the oldest public building, in Nebraska. Founded as a fur trading post in the early 1800's, Bellevue was Nebraska's only non-military settlement in existence prior to 1854.

SEE INSTRUCTIONS

9. MAJOR BIBLIOGRAPHICAL REFERENCES

Information based primarily on archival records

10. GEOGRAPHICAL DATA

| LATITUDE AND LONGITUDE COORDINATES<br>DEFINING A RECTANGLE LOCATING THE PROPERTY |                         |                         | O<br>R | LATITUDE AND LONGITUDE COORDINATES<br>DEFINING THE CENTER POINT OF A PROPERTY<br>OF LESS THAN ONE ACRE |                         |  |
|--|-------------------------|-------------------------|--------|--|-------------------------|--|
| CORNER   | LATITUDE                | LONGITUDE               |        | LATITUDE   | LONGITUDE               |  |
|  | Degrees Minutes Seconds | Degrees Minutes Seconds |        | Degrees Minutes Seconds  | Degrees Minutes Seconds |  |
| NW   | ° ' "                   | ° ' "                   |        | N 41° 08' 12"  | W 95° 53' 27"           |  |
| NE   | ° ' "                   | ° ' "                   |        |  |                         |  |
| SE   | ° ' "                   | ° ' "                   |        |  |                         |  |
| SW   | ° ' "                   | ° ' "                   |        |  |                         |  |

NO  
LITM  
CD

LIST ALL STATES AND COUNTIES FOR PROPERTIES OVERLAPPING STATE OR COUNTY BOUNDARIES

| STATE: | CODE | COUNTY  | CODE |
|--------|------|---------|------|
|        |      |         |      |
| STATE: | CODE | COUNTY: | CODE |
|        |      |         |      |
| STATE: | CODE | COUNTY: | CODE |
|        |      |         |      |
| STATE: | CODE | COUNTY: | CODE |
|        |      |         |      |

SEE INSTRUCTIONS

11. FORM PREPARED BY

NAME AND TITLE:  
John Q. Magie, Curator of History

ORGANIZATION: Nebraska State Historical Society

DATE: 2-21-69

STREET AND NUMBER:  
1500 R Street

CITY OR TOWN: Lincoln

STATE: Nebraska

CODE: 26

12. STATE LIAISON OFFICER CERTIFICATION

NATIONAL REGISTER VERIFICATION

As the designated State Liaison Officer for the National Historic Preservation Act of 1966 (Public Law 89-665), I hereby nominate this property for inclusion in the National Register and certify that it has been evaluated according to the criteria and procedures set forth by the National Park Service. The recommended level of significance of this nomination is:

National  State  Local

Name Morris W. Kevett

Title Director, Neb. State Hist. Soc.

Date Feb 27, 1969

I hereby certify that this property is included in the National Register.

Ernest Allen Cunniff  
Chief, Office of Archeology and Historic Preservation

Date \_\_\_\_\_

ATTEST:

William J. Stewart  
Keeper of The National Register

Date \_\_\_\_\_

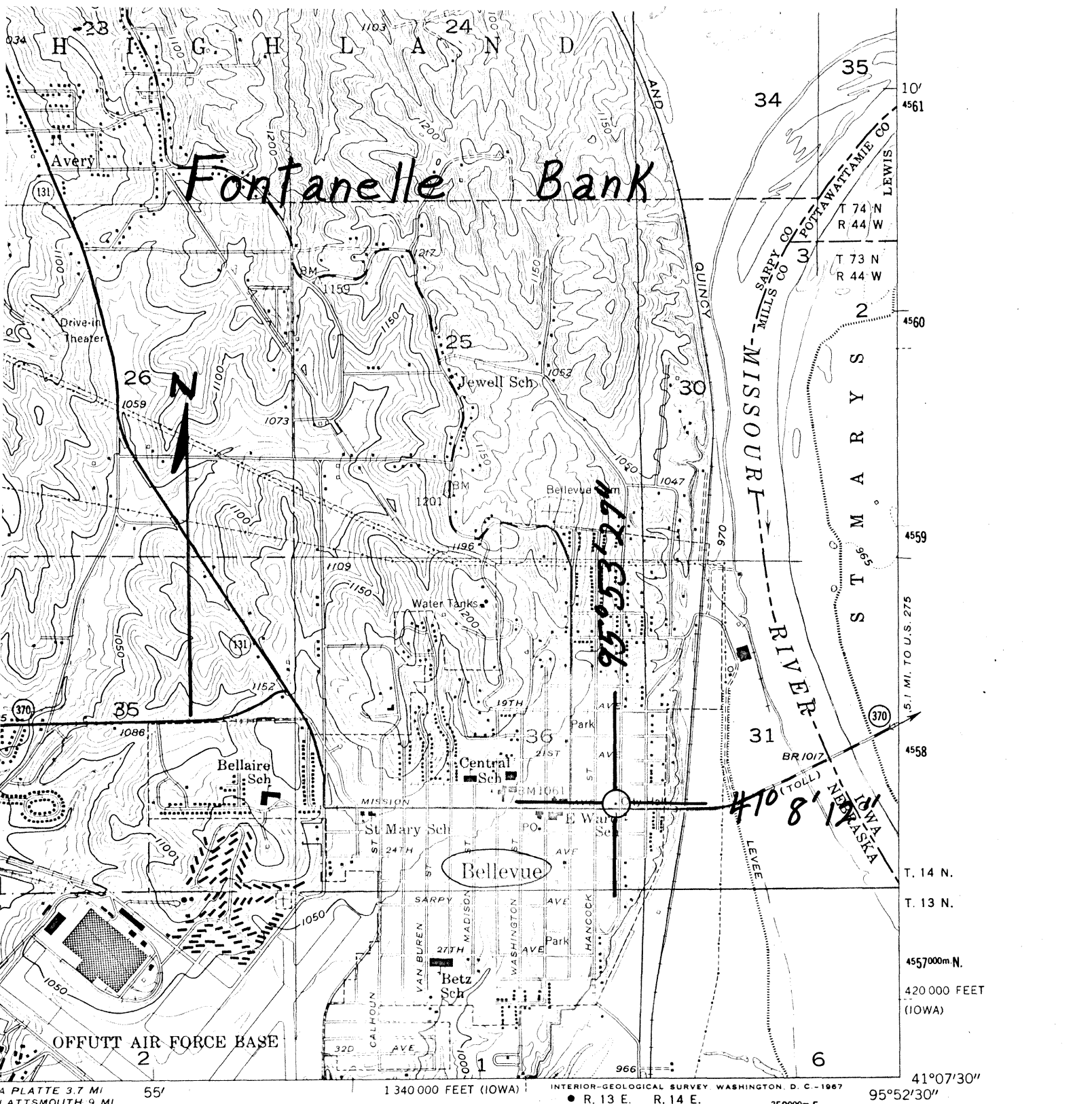

PLATTE 3.7 MI  
LATTSMOUTH 9 MI.

1 340 000 FEET (IOWA)

INTERIOR-GEOLOGICAL SURVEY WASHINGTON, D. C. - 1987  
R. 13 E. R. 14 E.

258000m E. 95°52'30"

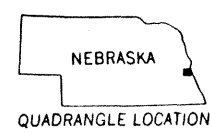
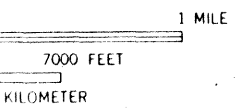

ROAD CLASSIFICATION

- Heavy-duty ————— Light-duty —————
- Medium-duty ————— Unimproved dirt - - - - -
- U. S. Route (Shield symbol) State Route (Circle symbol)

(PACIFIC JUNCTION)  
6866 II SE

OMAHA SOUTH, NEBR.—IOWA  
N 4107.5—W 9552.5/7.5

1956

AMS 6866 III NW—SERIES V875

WASHINGTON, D. C. 20242

Form 10-301  
(Dec. 1968)

UNITED STATES DEPARTMENT OF THE INTERIOR  
NATIONAL PARK SERVICE

**NATIONAL REGISTER OF HISTORIC PLACES  
PROPERTY MAP FORM**

*(Type all entries - attach to or enclose with map)*

|                  |         |
|------------------|---------|
| STATE            |         |
| Nebraska         |         |
| COUNTY           |         |
| Sarpy            |         |
| FOR NPS USE ONLY |         |
| ENTRY NUMBER     | DATE    |
| 69-04-26-0003    | 4/16/69 |

SEE INSTRUCTIONS

|   |      |         |      |
|---|------|---------|------|
| <b>1. NAME</b>  |      |         |      |
| COMMON: Fontanelle Bank                                       |      |         |      |
| AND/OR HISTORIC: Bellevue Town Hall, Sarpy County Court House |      |         |      |
| <b>2. LOCATION</b>  |      |         |      |
| STREET AND NUMBER:  |      |         |      |
| 2212 Main Street  |      |         |      |
| CITY OR TOWN:   |      |         |      |
| Bellevue  |      |         |      |
| STATE:  | CODE | COUNTY: | CODE |
| Nebraska  | 26   | Sarpy   | 153  |
| <b>3. MAP REFERENCE</b>                                       |      |         |      |
| SOURCE:   |      |         |      |
| U.S.G.S. 7½', quadrangle Omaha South                          |      |         |      |
| SCALE: 1: 24,000  |      |         |      |
| DATE: 1956  |      |         |      |
| <b>4. REQUIREMENTS</b>  |      |         |      |
| TO BE INCLUDED ON ALL MAPS                                    |      |         |      |
| 1. Property boundaries where required.                        |      |         |      |
| 2. North arrow.   |      |         |      |
| 3. Latitude and longitude reference.                          |      |         |      |