

UNITED STATES DEPARTMENT OF THE INTERIOR
NATIONAL PARK SERVICE

**NATIONAL REGISTER OF HISTORIC PLACES
INVENTORY -- NOMINATION FORM**

FOR FEDERAL PROPERTIES

FOR NPS USE ONLY	
RECEIVED	APR 28 1976
DATE ENTERED	SEP 29 1976

SEE INSTRUCTIONS IN *HOW TO COMPLETE NATIONAL REGISTER FORMS*
TYPE ALL ENTRIES -- COMPLETE APPLICABLE SECTIONS

1 NAME

HISTORIC

AND/OR COMMON

wh Italian Rock Ovens (2 sites)

2 LOCATION

STREET & NUMBER

S of Cheney

Turnbull NWR, Route 3, Box 385

___ NOT FOR PUBLICATION

CITY, TOWN

Cheney *mic.*

CONGRESSIONAL DISTRICT

#4 - Honorable Mike McCormack

STATE

Washington

___ VICINITY OF

CODE
53

COUNTY

Spokane

CODE

063

3 CLASSIFICATION

CATEGORY	OWNERSHIP	STATUS	PRESENT USE
<input type="checkbox"/> DISTRICT	<input checked="" type="checkbox"/> PUBLIC	<input type="checkbox"/> OCCUPIED	<input checked="" type="checkbox"/> AGRICULTURE <input type="checkbox"/> MUSEUM
<input type="checkbox"/> BUILDING(S)	<input type="checkbox"/> PRIVATE	<input checked="" type="checkbox"/> UNOCCUPIED	<input type="checkbox"/> COMMERCIAL <input type="checkbox"/> PARK
<input checked="" type="checkbox"/> STRUCTURE	<input type="checkbox"/> BOTH	<input type="checkbox"/> WORK IN PROGRESS	<input type="checkbox"/> EDUCATIONAL <input type="checkbox"/> PRIVATE RESIDENCE
<input type="checkbox"/> SITE	PUBLIC ACQUISITION	ACCESSIBLE	<input type="checkbox"/> ENTERTAINMENT <input type="checkbox"/> RELIGIOUS
<input type="checkbox"/> OBJECT	<input type="checkbox"/> IN PROCESS	<input checked="" type="checkbox"/> YES: RESTRICTED	<input checked="" type="checkbox"/> GOVERNMENT <input type="checkbox"/> SCIENTIFIC
	<input type="checkbox"/> BEING CONSIDERED	<input type="checkbox"/> YES: UNRESTRICTED	<input type="checkbox"/> INDUSTRIAL <input type="checkbox"/> TRANSPORTATION
		<input type="checkbox"/> NO	<input type="checkbox"/> MILITARY <input checked="" type="checkbox"/> OTHER: NWR

4 AGENCY

REGIONAL HEADQUARTERS: *(if applicable)*

U. S. Fish and Wildlife Service

STREET & NUMBER

P. O. Box 3737, 1500 NE Irving St.

CITY, TOWN

Portland

___ VICINITY OF

STATE

OR

5 LOCATION OF LEGAL DESCRIPTION

COURTHOUSE,
REGISTRY OF DEEDS, ETC.

Spokane County Courthouse

STREET & NUMBER

W. 1116 Broadway Ave.

CITY, TOWN

Spokane

STATE

WA

6 REPRESENTATION IN EXISTING SURVEYS

TITLE

DATE

___ FEDERAL ___ STATE ___ COUNTY ___ LOCAL

DEPOSITORY FOR
SURVEY RECORDS

CITY, TOWN

STATE

7 DESCRIPTION

CONDITION

EXCELLENT
 GOOD
 FAIR

DETERIORATED
 RUINS
 UNEXPOSED

CHECK ONE

UNALTERED
 ALTERED

CHECK ONE

ORIGINAL SITE
 MOVED DATE _____

DESCRIBE THE PRESENT AND ORIGINAL (IF KNOWN) PHYSICAL APPEARANCE

These are roughly pyramidal-shaped rock mounds, hollow in the center, with chimney-like openings in the top. On one side at the base is an opening approximately 10 inches wide and 6 inches high allowing access to the hollow center portion of the rock ovens. The ovens are made of flat to rounded basalt, and are approximately 5 feet wide at the base. They vary from about 3 to 5 feet in height.

Two such ovens are found in the Turnbull National Wildlife Refuge approximately two miles apart, and near the Spokane, Portland and Seattle Railroad tracks which pass through the northwest portion of this refuge. Both are built on the edge of natural soil mounds which are typical in the mounded soil type of the channeled scablands of Eastern Washington.
(see attached map and geographical data)

8 SIGNIFICANCE

PERIOD	AREAS OF SIGNIFICANCE -- CHECK AND JUSTIFY BELOW			
<input type="checkbox"/> PREHISTORIC	<input type="checkbox"/> ARCHEOLOGY-PREHISTORIC	<input type="checkbox"/> COMMUNITY PLANNING	<input type="checkbox"/> LANDSCAPE ARCHITECTURE	<input type="checkbox"/> RELIGION
<input type="checkbox"/> 1400-1499	<input type="checkbox"/> ARCHEOLOGY-HISTORIC	<input type="checkbox"/> CONSERVATION	<input type="checkbox"/> LAW	<input type="checkbox"/> SCIENCE
<input type="checkbox"/> 1500-1599	<input type="checkbox"/> AGRICULTURE	<input type="checkbox"/> ECONOMICS	<input type="checkbox"/> LITERATURE	<input type="checkbox"/> SCULPTURE
<input type="checkbox"/> 1600-1699	<input type="checkbox"/> ARCHITECTURE	<input type="checkbox"/> EDUCATION	<input type="checkbox"/> MILITARY	<input checked="" type="checkbox"/> SOCIAL/HUMANITARIAN
<input type="checkbox"/> 1700-1799	<input type="checkbox"/> ART	<input checked="" type="checkbox"/> ENGINEERING	<input type="checkbox"/> MUSIC	<input type="checkbox"/> THEATER
<input type="checkbox"/> 1800-1899	<input checked="" type="checkbox"/> COMMERCE	<input type="checkbox"/> EXPLORATION/SETTLEMENT	<input type="checkbox"/> PHILOSOPHY	<input checked="" type="checkbox"/> TRANSPORTATION
<input checked="" type="checkbox"/> 1900-	<input type="checkbox"/> COMMUNICATIONS	<input type="checkbox"/> INDUSTRY	<input type="checkbox"/> POLITICS/GOVERNMENT	<input type="checkbox"/> OTHER (SPECIFY)
		<input type="checkbox"/> INVENTION		

SPECIFIC DATES

BUILDER/ARCHITECT

STATEMENT OF SIGNIFICANCE

These rock ovens were built by Italian laborers who worked on construction of the Spokane, Portland and Seattle Railroad in 1906. There were several contractors and subcontractors crews building the railroad in this vicinity.

The nearest labor camp to these ovens was at Mock, about 1-2 miles to the southeast. About 50 to 75 men worked out of this camp, which was run by an Italian subcontractor named Gabriel Ballante. Construction through the basalt rock outcrops was very difficult, and required extensive blasting. Holes for the charges were hand drilled with drills up to 16 feet long.

Fires were built in these ovens to heat the rocks. Coals were removed and the bread loaves were inserted through the side openings with long wooden paddles. The Italians subsisted almost entirely on bread and macaroni during the construction period. Only occasionally did they purchase meat from local farmers.

9 MAJOR BIBLIOGRAPHICAL REFERENCES

Information was obtained from an interview of Mr. John Van Brundt, a resident of Cheney, Washington. He was raised on a homestead near the rock ovens and was present during the construction period.

10 GEOGRAPHICAL DATA

ACREAGE OF NOMINATED PROPERTY 0.1 acre (2 sites of 0.05 acre each)

UTM REFERENCES

A	1, 1	4, 5, 5	0, 1, 9	5, 2, 5, 5	0, 0, 3	B	1, 1	4, 5, 3	0, 0, 5	5, 2, 5, 1	0, 8, 4
	ZONE	EASTING	NORTHING				ZONE	EASTING	NORTHING		
C						D					

VERBAL BOUNDARY DESCRIPTION

Latitude Longitude

47° 26' 47" 117° 35' 47"

and
47° 25' 11" 117° 37' 18"

(Two sites)

LIST ALL STATES AND COUNTIES FOR PROPERTIES OVERLAPPING STATE OR COUNTY BOUNDARIES

STATE	CODE	COUNTY	CODE
STATE	CODE	COUNTY	CODE

11 FORM PREPARED BY

NAME / TITLE

Called for map - 9.16.76
Jon M. Malcolm, Refuge Manager

ORGANIZATION

Turnbull National Wildlife Refuge

STREET & NUMBER

Route 3, Box 107

CITY OR TOWN

Cheney

DATE

TELEPHONE

(509) 235-4723

STATE

Washington

12 CERTIFICATION OF NOMINATION

STATE HISTORIC PRESERVATION OFFICER RECOMMENDATION

YES NO NONE

See a Hatched form

STATE HISTORIC PRESERVATION OFFICER SIGNATURE

In compliance with Executive Order 11593, I hereby nominate this property to the National Register, certifying that the State Historic Preservation Officer has been allowed 90 days in which to present the nomination to the State Review Board and to evaluate its significance. The evaluated level of significance is ___ National ___ State Local.

FEDERAL REPRESENTATIVE SIGNATURE

TITLE

Robert A. Wheeler

DATE

4-23-76

FOR NPS USE ONLY

I HEREBY CERTIFY THAT THIS PROPERTY IS INCLUDED IN THE NATIONAL REGISTER

DATE

9/29/96

Acting DIRECTOR, OFFICE OF ARCHEOLOGY AND HISTORIC PRESERVATION

ATTEST:

DATE

9/25/96

KEEPER OF THE NATIONAL REGISTER

CHENEY QUADRANGLE
 WASHINGTON
 15 MINUTE SERIES (TOPOGRAPHIC)

2579 III
 (SPOKANE)

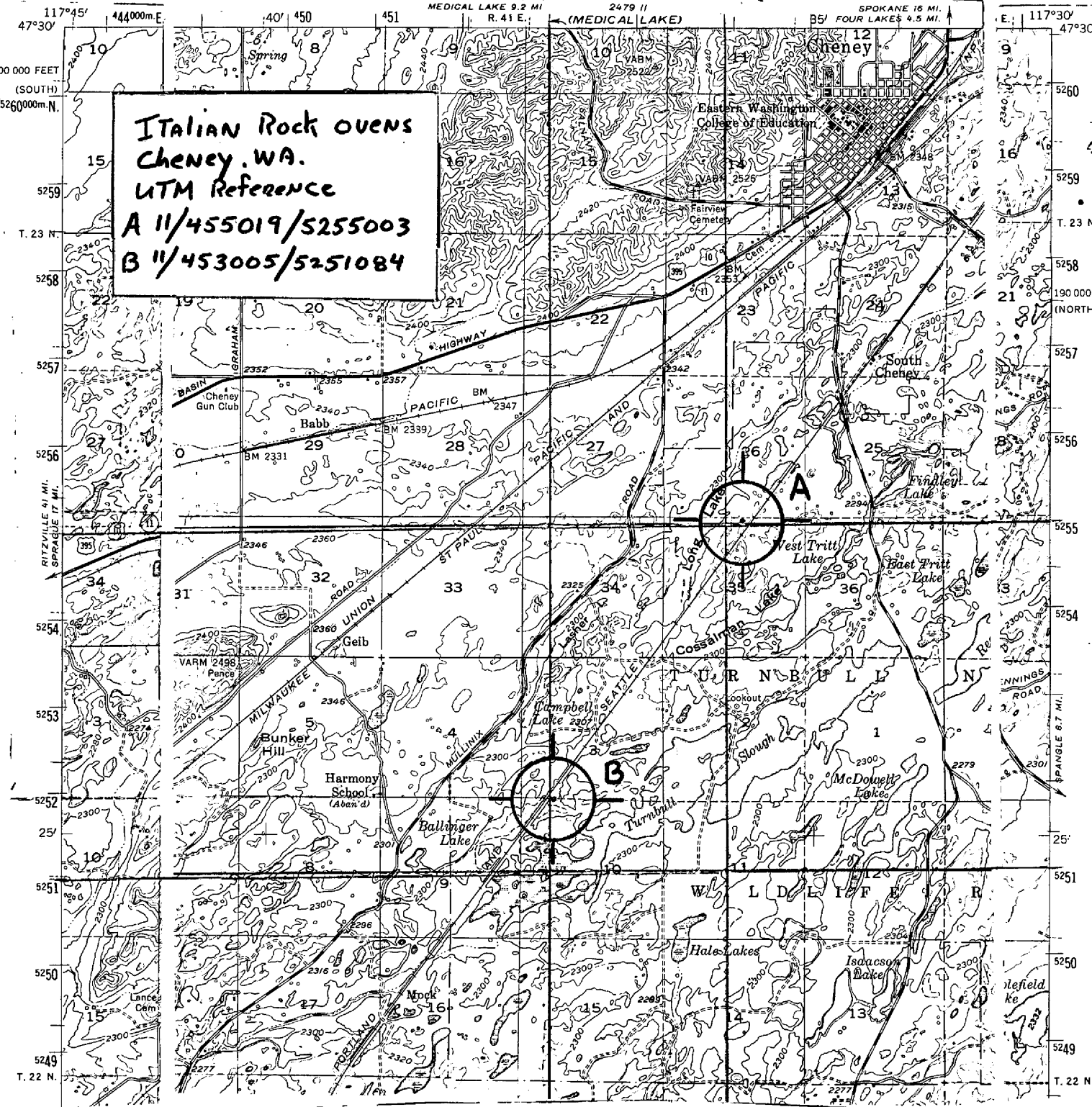

**ITALIAN ROCK OVENS
 Cheney, WA.
 UTM Reference
 A 11/455019/5255003
 B 11/453005/5251084**

117°45' 47°30'
 444000m E
 40' 450 451
 TYLER 12 MI. MEDICAL LAKE 9.2 MI R. 41 E. 2479 II (MEDICAL LAKE)
 SPOKANE 16 MI. FOUR LAKES 4.5 MI.
 30 000 FEET (SOUTH)
 5260000m N.
 15
 5259
 T. 23 N.
 5258
 5257
 5256
 5255
 5254
 5253
 5252
 25'
 5251
 5250
 5249
 T. 22 N.

117°30' 47°30'
 9
 16
 21
 20
 19
 18
 17
 16
 15
 14
 13
 12
 11
 10
 9
 8
 7
 6
 5
 4
 3
 2
 1
 0
 1
 2
 3
 4
 5
 6
 7
 8
 9
 10
 11
 12
 13
 14
 15
 16
 17
 18
 19
 20
 21
 22
 23
 24
 25
 26
 27
 28
 29
 30
 31
 32
 33
 34
 35
 36
 37
 38
 39
 40
 41
 42
 43
 44
 45
 46
 47
 48
 49
 50
 51
 52
 53
 54
 55
 56
 57
 58
 59
 60
 61
 62
 63
 64
 65
 66
 67
 68
 69
 70
 71
 72
 73
 74
 75
 76
 77
 78
 79
 80
 81
 82
 83
 84
 85
 86
 87
 88
 89
 90
 91
 92
 93
 94
 95
 96
 97
 98
 99
 100

