

RECEIVED  
MAY 22 1990

NATIONAL REGISTER

NPS FORM 10-900 (Rev. 8-86) OMB No. 1024-0018 [SD-SHPO # ECA-OH-597-1/89]  
[use paper with at least 25% cotton rag content, use NLQ or LQ printer]

United States Department of the Interior -- National Park Service  
NATIONAL REGISTER OF HISTORIC PLACES -- REGISTRATION FORM

This form is for use in nominating or requesting determinations of eligibility for individual properties or districts. See instructions in Guidelines for Completing National Register Forms (National Register Bulletin 16). Complete each item by marking "x" in the appropriate box or by entering "NA" for "not applicable." For functions, styles, materials, and areas of significance, enter only the categories and subcategories listed in the instructions. For additional space use continuation sheets (Form 10-900a). Type all entries.

1. Name of Property

historic name: Lampert, Charles and Ollie, Ranch  
other name/ site number: CU-SP-3

2. Location

street & number: south of the Elk Mountains, north of Dewey /NA/ not for publication  
city, town: Custer /XX/ vicinity  
state: SOUTH DAKOTA code: SD county: Custer code: SD 033 zip code: 57730

3. Classification

Ownership of Property:	Category of Property	Number of Resources within Property:		
		Contributing	Noncontributing	
/XX/ private	/ / building(s)	6	5	buildings
/ / public-local	/XX/ district			sites
/ / public-state	/ / site	1		structures
/ / public-federal	/ / structure			objects
	/ / object	7	5	Total

Name of related multiple property listing: Ranches of Southwestern Custer County, SD  
Number of contributing resources previously listed in the National Register: 0

11. Form Prepared by

name/title: Rebecca Sample Bernstein, Preservation Consultant  
organization: Custer County Board of Commissioner date: January 17, 1990  
street & number: 420 Mt. Rushmore Road telephone: 605-673-4815  
city or town: Custer state: SOUTH DAKOTA zip code: 57730

page 2: Charles & Ollie Lampert Ranch  
property name

, Custer County  
county

, SOUTH DAKOTA  
state

4. State/Federal Agency Certification

As the designated authority under the National Historic Preservation Act of 1966, as amended, I hereby certify that this  nomination  request for determination of eligibility meets the documentation standards for registering properties in the National Register of Historic Places and meets the procedural and professional requirements set forth in 36 CFR Part 60. In my opinion, the property  meets  does not meet the National Register criteria.  See continuation sheet.

[Signature]  
Signature of certifying official

5/12/91  
Date

South Dak SHPO  
State or Federal agency or bureau

In my opinion, the property  meets  does not meet the National Register Criteria.  
 See continuation sheet.

\_\_\_\_\_  
Signature of commenting or other official

\_\_\_\_\_  
Date

\_\_\_\_\_  
State or Federal agency or bureau

5. National Park Service Certification

I, hereby, certify that this property is:

entered in the National Register

see continuation sheet

determined eligible for the National Register

see continuation sheet

determined not eligible for the National Register

removed from the National Register

other, (explain) \_\_\_\_\_

\_\_\_\_\_  
\_\_\_\_\_

Beth Boland 7/5/90  
\_\_\_\_\_  
\_\_\_\_\_  
\_\_\_\_\_  
\_\_\_\_\_  
Signature of the Keeper Date

page 3: Charles & Ollie Lampert Ranch  
property name

, Custer  
county

, SOUTH DAKOTA  
state

6. Function or Use (enter categories from instructions)

Historic functions:

DOMESTIC/Single Dwelling  
AGRICULTURE/Animal Facility  
AGRICULTURE/Storage  
AGRICULTURE/Agricultural Outbuilding

Current Functions:

DOMESTIC/Single Dwelling  
AGRICULTURE/Animal Facility  
AGRICULTURE/Storage  
AGRICULTURE/Agricultural Outbuilding

---

7. Description

Architectural Classification:

(enter categories from instructions)  
No Style

Materials:

(enter categories from instructions)  
foundation Stone, Concrete  
walls Stucco, Wood,  
Stone  
roof Asphalt, Wood, Metal  
other NA

Describe present and historic physical appearance: /XX/ see continuation sheet

---

8. Significance

Certifying official has considered the significance of this property in  
relation to other properties: / / / / /XX/  
nationally statewide locally

Applicable National Register Criteria /XX/ A / /B / /C / /D

Criteria Considerations / /A / /B / /C / /D / /E / /F / /G

Areas of Significance (enter from instructions)

Exploration/Settlement

Period of Significance  
circa 1916-1940

Significant Dates  
NA

Significant Person  
NA

Cultural Affiliation  
NA

Architect/Builder  
Unknown

State significance of property, and justify criteria, criteria considerations,  
and periods of significance noted above /XX/ see continuation sheet

**United States Department of the Interior  
National Park Service**

**National Register of Historic Places  
Continuation Sheet**

Section number 7 Page 1

---

The Charles and Ollie Lampert Ranch is located at the foot of the Elk Mountains, approximately six miles north of Dewey, South Dakota. The approach is along a rough gravel lane branching off from Custer County Route 769 at the Lauzon School.

List of Resources:

1. House: (Contributing), c. 1916; The stucco-covered, wood frame, house is a T-shaped building with a stone masonry sun room addition on the south. It is capped by an intersecting gable roof covered with tin. A shed roofed open porch supported by stone piers sprawls across the west (front) facade. Stone masonry chimneys protrude from the north and south elevations. Fenestration is irregular, consisting of an assortment of window styles.
2. Root Cellar: (Contributing), c. 1916-1940; The root cellar is adjacent to the house. Its stucco-covered frame walls rise from ground level and are capped by a very wide low-pitched gable roof.
3. Privy: (Contributing), c. 1916; The privy is a rectangular pen, wood frame building with a shed roof.
4. Bunkhouse: (Contributing), c. 1916-1934; The bunkhouse is a one-story, rectangular pen, wood frame building clad with stucco. It is capped by a shallow tin-clad gable roof. Window and door openings pierce only the south facade.
5. Barn: (Contributing), c. 1916-1934; Rising from a concrete foundation, the barn is a wood frame building capped by a tin-covered gable roof.
6. Barn: (Contributing), c. 1916-1934; The second barn is a rectangular, wood frame, building that is covered with vertical boards on all facades except on the north side where it is dug into a hillside. It is capped by a gable roof covered with asphalt paper. The walls rise from a wood sill.
7. Barn: (Contributing), c. 1916-1934; The third barn is identical to the second barn except that it is not dug into the hillside.
8. Sheep-shearing Shed: (Noncontributing), post-1940; The sheep-shearing shed is a one-story, rectangular pen, wood frame building clad with vertical boards. It is capped by a low-pitched gable roof covered with tin.
9. Log Outbuilding: (Noncontributing), moved after 1980; The ruins of a log building were moved to this site after 1980.

**United States Department of the Interior  
National Park Service**

**National Register of Historic Places  
Continuation Sheet**

Section number   7   Page   2  

---

10. Shed: (Noncontributing), moved after 1980; The rectangular, board-and-batten-covered, wood frame, shed rises from a wood sill. The gable roof is covered with tin.

11. Shed: (Noncontributing), moved after 1980; The rectangular wood frame shed rises from a wood sill. The gable roof is covered in tin.

12. Log shed: (Noncontributing), moved circa 1983; The log walls of the rectangular shed are joined with double-vertical corner notching. The gable roof is covered with tin.

**United States Department of the Interior  
National Park Service**

**National Register of Historic Places  
Continuation Sheet**

Section number   7   Page   3  

---

LAMPERT RANCH SITE MAP ON REVERSE SIDE

Site Plan (Complete Inventory of Structures and Features) with North Arrow

1000  
1000  
1000  
1000  
1000

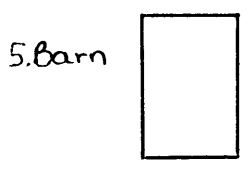
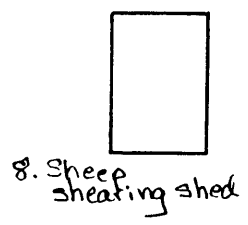
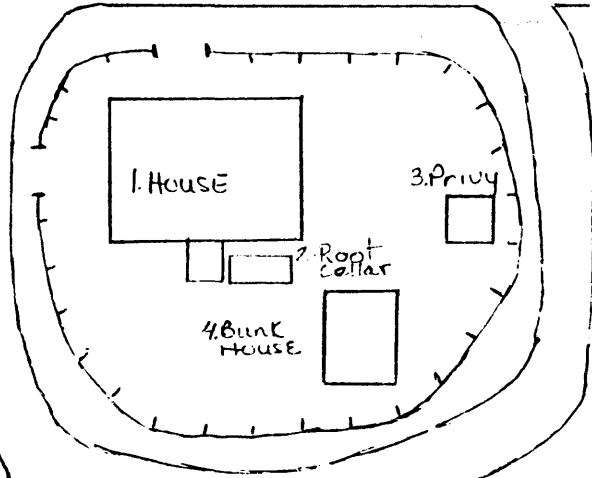
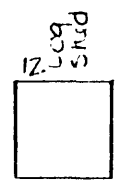
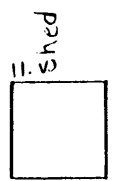
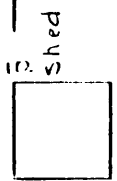
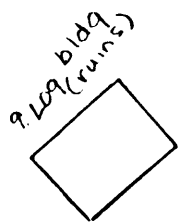
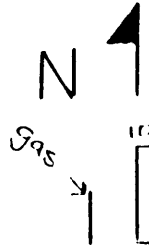

Loading Chute  
↑

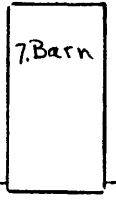
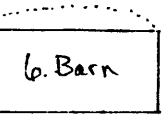

**United States Department of the Interior  
National Park Service**

**National Register of Historic Places  
Continuation Sheet**

Section number 8 Page 1

---

Under Criterion A of the National Register Criteria, the Charles and Ollie Lampert ranch is significant in the area of Exploration/Settlement, because it represents the development of the legal homestead rancher in the southwestern corner of Custer County, South Dakota. In particular, this ranch represents the acquisition of land through both homesteading new claims and purchasing previously established ranches. Homestead ranchers were the first generation of settlers to make good and to continue to live on a homestead claim in this semiarid part of Custer County. The homestead rancher who lived on his/her property, as did the Lampert family, represents a shift from the owners and workers of large cattle companies of the open range period who frequently lived in town.

Under the South Dakota State Historical Preservation Plan the nominated property relates to the historic contexts labeled: IV. Permanent Rural and Urban Settlement, A. Claim Era; and IV. C. Permanent Farm and Ranch Development. This property relates to the local historic context and property type labeled: "Ranches of Southwestern Custer County, South Dakota."

In circa 1916, Charles and Ollie Lampert moved from their farm near Battle Creek, Nebraska, to southwestern Custer County and homesteaded in the Elk Mountain area. Soon, they purchased the ranch district nominated here from the Sterdevan family. Although there were buildings at the ranch prior to 1916, its extant built environment dates from the time after the Lamperts took possession of it. The Lamperts were primarily cattle ranchers, but they also ran a few sheep in later years. Familiar with raising crops in a dry climate, Charles Lampert tried unsuccessfully to irrigate some of his land.

The three Lampert boys went to school at nearby Lauzon School. At that time, the community of Lauzon consisted of only a school and a post office.

In the early 1940s, Ollie Lampert, who was now a widow, sold the ranch to Jesse Cornelieson. She then bought another ranch, adjacent to U. S. Highway 16. Later she sold the second ranch, keeping a only small piece of property, on which she built the Elk Mountain Inn. Mrs. Lampert operated that establishment for approximately thirty years.

Jesse Cornelieson, who was 75 years of age when he purchased the Lampert Ranch, came to South Dakota in 1896 driving a band of 2500 "weathers" (texas cattle) to winter on the Dakota range. He died at age 96, a wealthy man.

Jess Drinkwalter leased the property from Cornelieson for a short time. Eventually, Cornelieson sold it to the Sand Hills Ranch of Nebraska. The ranch is currently owned by Hoyt Nicholas.



**United States Department of the Interior  
National Park Service**

**National Register of Historic Places  
Continuation Sheet**

Section number 8 Page 2

---

The period of significance of the nominated property extends from circa 1916, the construction date of the oldest extant resources and the date that the Lamperts acquired the ranch, to 1940, the established 50-year cut-off date for the National Register. This terminal date also coincides closely with the date that the Lampert family ceased to occupy the ranch.

page 4: Charles & Ollie Lampert Ranch  
property name

, Custer  
county

, SOUTH DAKOTA  
state

9. Major Bibliographical References

/XX/ see continuation sheet

Previous documentation by NPS:

- / / preliminary determination of individual listing (36 CFR 67) has been requested
- / / previously listed in the National Register
- / / previously determined eligible by the National Register
- / / designated a National Historic Landmark
- / / recorded by Historic American Buildings Survey # \_\_\_\_\_
- / / recorded by Historic American Engineering Record # \_\_\_\_\_

Primary location of additional data:

- /XX/ State historic preservation office
- / / Other State agency
- / / Federal agency
- / / Local government
- / / University
- / / Other

Specify repository:

South Dakota Historical Preservation Center

---

10. Geographical Data

Acreage of property: 6.5 acres

UTM References:

A = /13/	/579-600/	/4830-560/	B = / /	/ /	/ /
C = / /	/ /	/ /	D = / /	/ /	/ /
ZONE	EASTING	NORTHING	ZONE	EASTING	NORTHING

Quad: Clifton, Wyo.-S. Dak. (1951)

Scale: 1:24000

/ / see continuation sheet

Verbal Boundary Description:

/XX/ see continuation sheet

Boundary Justification:

/XX/ see continuation sheet

United States Department of the Interior  
National Park Service

National Register of Historic Places  
Continuation Sheet

Section number 9 Page 1

---

Brown, Mabel. "Not Much Doing at Dewey." Bits and Pieces, Your Own Western History Magazine. Vol 3, no.10., 1967.

Kraenzel, Carl Frederick. The Great Plains in Transition. Norman: University of Oklahoma Press, 1955.

Lee, Bob, and Dick Williams. The Last Grass Frontier, The South Dakota Stock Grower Heritage. Sturgis, South Dakota: Black Hills Publishers, Inc., 1964.

Schell, Herbert Samuel. History of South Dakota. 3rd. ed., rev.: Lincoln: University of Nebraska Press, 1975.

Sundstrom, Jessie Y., ed. Custer County History to 1976. Custer, South Dakota: Custer County Historical Society, (printed by Rapid City, South Dakota, Printing, Inc.), 1977.

Personal and Telephone Interviews by Rebecca Sample Bernstein, Summer/Fall, 1988:

Mr. Lampert, Newcastle, Wyoming.

Irma Lampert, Newcastle, Wyoming.

Harry Mann, Newcastle, Wyoming.

Hoyt Nicholas, Custer, South Dakota.

William Stearns, Newcastle, Wyoming.

Jesse Sundstrom, Custer, South Dakota.

**United States Department of the Interior  
National Park Service**

**National Register of Historic Places  
Continuation Sheet**

Section number 10 Page 1

---

GEOGRAPHICAL DATA

VERBAL BOUNDARY DESCRIPTION: The nominated property is bounded by a set of imaginary lines that intersect to form a rectangle around the ranch district. The northern boundary line lies 90 meters north of the northernmost wall of the House (resource # 1) and runs parallel to that wall. The eastern boundary line lies 20 meters east of the easternmost wall of the house and runs parallel to that wall. The southern boundary line lies 60 meters south of the southernmost wall of the House and runs parallel to that wall. The western boundary line lies 120 meters west of the westernmost wall of the House and runs parallel to that wall. The ranch is located in the North Half of the Southwest Quarter of the Southwest Quarter of Section 9, Township 5 South, Range 1 East, (Black Hills Meridian) in Custer County, South Dakota.

BOUNDARY JUSTIFICATION: The boundary lines of the nominated property are set to include all features of the ranch complex, but to exclude pasture land and any public roadways.

United States Department of the Interior  
National Park Service

National Register of Historic Places  
Continuation Sheet

Section number photos Page 1

---

1.  
Charles and Ollie Lampert Ranch  
Custer Vicinity, Custer County, South Dakota  
by Rebecca Sample Bernstein  
June 1988  
Neg: State Historical Preservation Center  
House (resource no. 1), south and west elevations,  
camera facing northeast  
Photo No. 1
  
2.  
Charles and Ollie Lampert Ranch  
Custer Vicinity, Custer County, South Dakota  
by Rebecca Sample Bernstein  
June 1988  
Neg: State Historical Preservation Center  
House (resource no. 1), south and east elevations,  
camera facing northwest  
Photo No. 2
  
3.  
Charles and Ollie Lampert Ranch  
Custer Vicinity, Custer County, South Dakota  
by Rebecca Sample Bernstein  
June 1988  
Neg: State Historical Preservation Center  
Barn (resource no. 6), barn (resource no. 7), and corrals,  
north and east elevations, camera facing southwest  
Photo No. 3
  
4.  
Charles and Ollie Lampert Ranch  
Custer Vicinity, Custer County, South Dakota  
by Rebecca Sample Bernstein  
June 1988  
Neg: State Historical Preservation Center  
Barn (resource no. 5) and corral,  
north and east elevations, camera facing southwest  
Photo No. 4

**United States Department of the Interior  
National Park Service**

**National Register of Historic Places  
Continuation Sheet**

Section number photos Page 2

---

5.  
Charles and Ollie Lampert Ranch  
Custer Vicinity, Custer County, South Dakota  
by Rebecca Sample Bernstein  
June 1988  
Neg: State Historical Preservation Center  
Privy (resource no. 3) south and east elevations,  
camera facing northwest  
Photo No. 5