

RECEIVED

AUG 23 1993

NATIONAL REGISTER

United States Department of the Interior
National Park Service

National Register of Historic Places Registration Form

This form is for use in nominating or requesting determinations for individual properties and districts. See instructions in *How to Complete the National Register of Historic Places Registration Form* (National Register Bulletin 16A). Complete each item by marking "x" in the appropriate box or by entering the information requested. If any item does not apply to the property being documented, enter "N/A" for "not applicable." For functions, architectural classification, materials, and areas of significance, enter only categories and subcategories from the instructions. Place additional entries and narrative items on continuation sheets (NPS Form 10-900a). Use a typewriter, word processor, or computer, to complete all items.

1. Name of Property

historic name Duquesne, Achille, House

other names/site number _____

2. Location

street & number 710 W. Midway n/a not for publication

city or town Filer n/a vicinity

state Idaho code ID county Twin Falls code 083 zip code 83328

3. State/Federal Agency Certification

As the designated authority under the National Historic Preservation Act of 1986, as amended, I hereby certify that this X nomination request for determination of eligibility meets the documentation standards for registering properties in the National Register of Historic Places and meets the procedural and professional requirements set forth in 36 CFR Part 60. In my opinion, the property X meets does not meet the National Register criteria. I recommend that this property be considered significant nationally statewide X locally. (See continuation sheet for additional comments.)

[Signature] 3 Aug 93
Signature of certifying official Date

John B. Hill, State Historic Preservation Officer
State or Federal agency and bureau

In my opinion, the property meets does not meet the National Register criteria. (See continuation sheet for additional comments.)

Signature of commenting or other official Date

State or Federal agency and bureau

4. National Park Service Certification

I, hereby, certify that this property is:

X entered in the National Register. [Signature] 9/23/93
See continuation sheet

determined eligible for the National Register. See continuation sheet

determined not eligible for the National Register.

removed from the National Register.

other, (explain:)

[Signature] for
Signature of Keeper Date of Action

USDI/NPS NRHP Registration Form

Property Name Duquesne, Achille, House

County and State Twin Falls County, Idaho

Page 2

5. Classification

Ownership of Property	Category of Property	No. of Resources within Property	
		contributing	noncontributing
<input checked="" type="checkbox"/> private	<input checked="" type="checkbox"/> building(s)	<u>1</u>	<u>1</u> buildings
<input type="checkbox"/> public-local	<input type="checkbox"/> district	<u> </u>	<u> </u> sites
<input type="checkbox"/> public-State	<input type="checkbox"/> site	<u> </u>	<u> </u> structures
<input type="checkbox"/> public-Federal	<input type="checkbox"/> structure	<u> </u>	<u> </u> objects
	<input type="checkbox"/> object	<u> </u>	<u> </u> Total
		<u>1</u>	<u>1</u> Total

Name of related multiple property listing: N/A

No. of contributing resources previously listed in the National Register: 0

6. Functions or Use

Historic Functions (Enter categories from instructions.)

Cat: DOMESTIC Sub: Single Dwelling/Residence

Current Functions (Enter categories from instructions.)

Cat: DOMESTIC Sub: Single Dwelling/Residence

7. Description

Architectural Classification (Enter categories from instructions.)

Queen Anne

Materials (Enter categories from instructions.)

foundation Concrete (block)

walls Concrete (block)

roof Wood (shingles)

other _____

Narrative Description (Describe the historic and current condition of the property on one or more continuation sheets.)

Property Name Duquesne, Achille, House

County and State Twin Falls County, Idaho

8. Statement of Significance

Applicable National Register Criteria (Mark "x" in one or more boxes for the criteria qualifying the property for National Register listing.)

- A Property is associated with events that have made a significant contribution to the broad patterns of our history.
- B Property is associated with the lives of persons significant in our past.
- C Property embodies the distinctive characteristics of a type, period, or method of construction or represents the work of a master, or possesses high artistic values, or represents a significant and distinguishable entity whose components lack individual distinction.
- D Property has yielded, or is likely to yield, information important in prehistory or history.

Criteria Considerations (Mark "x" in all the boxes that apply.)

- A owned by a religious institution or used for religious purposes.
- B removed from its original location.
- C a birthplace or a grave.
- D a cemetery.
- E a reconstructed building, object, or structure.
- F a commemorative property.
- G less than 50 years of age or achieved significance within the past 50 years.

Areas of Significance

(Enter categories from instructions.)

Architecture

Period of Significance

1912

Significant Dates

1912

Cultural Affiliation

N/A

Significant Person

n/a

Architect/Builder

Achille Duquesne

Narrative Statement of Significance (Explain the significance of the property on one or more continuation sheets.)

Property Name Duquesne, Achille, House

County and State Twin Falls County, Idaho

Page 4

9. Major Bibliographical References

(Cite the books, articles, and other sources used in preparing this form on one or more continuation sheets.)

Previous documentation on file (NPS): N/A

- preliminary determination of individual listing (36 CFR 67) has been requested
- previously listed in the National Register
- previously determined eligible by the National Register
- designated a National Historic Landmark
- recorded by Historic American Buildings Survey # _____
- recorded by Historic American Engineering Record # _____

- Primary location of additional data:
- State Historic Preservation Office
 - Other State agency
 - Federal agency
 - Local government
 - University
 - Other
- Specify repository: _____

10. Geographical Data

Acreage of property Less than one acre

UTM References

1	<u>1/1</u>	<u>6/9/5/8/7/0</u>	<u>4/7/1/5/7/8/0</u>	3	<u>/</u>	<u>/</u>	<u>/</u>	<u>/</u>	<u>/</u>	<u>/</u>
	Zone	Easting	Northing		Zone	Easting	Northing			

2	<u>/</u>	<u>/</u>	<u>/</u>	<u>/</u>	<u>/</u>	<u>/</u>	<u>/</u>	<u>/</u>	<u>/</u>	<u>/</u>
	Zone	Easting	Northing		Zone	Easting	Northing			

See continuation sheet

Verbal Boundary Description (Describe the boundaries of the property on a continuation sheet.)

Boundary Justification (Explain why the boundaries were selected on a continuation sheet.)

11. Form Prepared By

name/title Carolyn M. C. Burke/Architectural Intern

organization Twin Falls Historic Preservation Commission date June 30, 1992

street & number 168 Park Avenue telephone (208) 233-3616

city or town Pocatello state Idaho zip code 83201

Additional Documentation

Submit the following items with the completed form:
Continuation Sheets

Maps

- A USGS map (7.5 or 15 minute series) indicating the property's location.
- A sketch map for historic districts and properties having large acreage or numerous resources.

Photographs

Representative black and white photographs of the property.

Additional items (Check with the SHPO or FPO for any additional items.)

Property Owner

(Complete this item at the request of the SHPO or FPO.)

name _____

street & number _____ telephone _____

city or town _____ state _____ zip code _____

United States Department of the Interior
National Park Service

National Register of Historic Places Continuation Sheet

Section number 7 Page 1

Name of Property Duquesne, Achille, House

County and State Twin Falls County, Idaho

The Achille Duquesne House is located on the corner of Midway Street and Old Highway 30 in Filer, Idaho. Built in 1912, the home is located in the center of the lot and is surrounded on the north and west sides by a large wooden fence. There are a few trees on the lot--some newer, some more mature. The surrounding neighborhood is residential for the most part, with agricultural/industrial mills located a few blocks away.

Constructed of rock-faced, cast concrete blocks, the house features an irregular roofline, cast stone lintels and sills in all window and door openings, a shingle roof and an eclectic design that incorporates Gothic Revival window surrounds into a Queen Anne plan. Dormer surrounds on the south and east facades, as well as the gable bargeboards on the south, are clad with diamond-patterned shingles. A slender brick chimney rises from the center of the north, hipped roof.

Apart from the extensive use of cast concrete blocks, the home's most distinguishing feature is a squared wrap-around porch with flat roof, supported by unusual cast stone columns which are fluted and banded. The east facade presents a roughly symmetrical appearance with a broad, plate-glass window located between two columns. A one-over-one, double hung sash projects from a second story, gabled dormer. Shed-roofed dormers are embedded into the north and west hipped roofs.

The south facade is the principal entry and contains steps leading to an entry door. Another broad, plate-glass window is located at the left side; a one-over-one, double hung sash is located in the gable, directly above. An expanding bargeboard, designed to create a gothic arch frame for the window, extends out from the plane of the gable surface. The gable itself is clad with weatherboard. Located adjacent to this gable in another roof is a gabled dormer which is framed by a gothic arch surround--in the manner of the east elevation.

The north facade contains a narrow, single plate window (replaced), centered below the second story, shed dormer. The west (rear) facade has another broad, plate-glass window; two narrow windows with single plates of glass are found at either end. A small porch, located at the northwest corner has been enclosed with rough boards. Aside from the installation of single plates into window openings on the north and west facades, the home remains unaltered.

The complexity of the exterior belies a fairly simple interior configuration. The first floor contains the living room, dining room and kitchen in an almost open plan. The staircase is located against the living room wall, adjacent to the front door. Each bedroom has its own unique character because of the placement of dormers and various roof inclines.

United States Department of the Interior
National Park Service

National Register of Historic Places Continuation Sheet

Section number 8 Page 1

Name of Property Duquesne, Achille, House

County and State Twin Falls County, Idaho

The Achille Duquesne House is architecturally the most sophisticated residential design in Filer and the best representation of the Queen Anne style. This stylistic merit, as well as the use of decorative, cast concrete blocks make the home significant under Criterion C.

The home's builder, Achille Duquesne, is known to have managed the factory which produced the concrete block materials used in the house. Duquesne was an original owner in the community of Filer and one of the first to build in the area. His 1912 house was an obvious attempt to showcase the mass-produced building materials that were his livelihood. Another home in Filer, located directly across the street at 207 Eighth Street, is constructed of cast concrete block. This Craftsman-style home is more modest in design and features rock-faced blocks with simulated, drafted margins. Duquesne's home, the home across the street, and another Craftsman-style home located two blocks south are local examples incorporating a building material that was commonly used throughout the country during this period.

While the home is noteworthy for its use of a period building material, its Queen Anne design is also significant in the local context. Architectural flourishes such as the Gothic Revival arches; banded, fluted columns; and highly irregular massing, were details seldom used in the community of Filer. The house is unparalleled as a local example of late Queen Anne design and serves as a rare emblem of the national, architectural trends that were barely felt in this small farming community.

United States Department of the Interior
National Park Service

National Register of Historic Places Continuation Sheet

Section number 9 Page 1

Name of Property Duquesne, Achille, House

County and State Twin Falls County, Idaho

Attebery, Jennifer. *Building Idaho; An Architectural History*. Moscow, Idaho: University of Idaho Press, 1991. Pp. 82,83.

McAlester, Virginia & Lee. *A Field Guide To American Houses*. New York, Alfred A. Knopf, Inc., 1984.

Moon, Howard J. *Early History of Filer Idaho School Communities*. Filer, Idaho: The Print Shoppe, 1976.

Polk's Twin Falls City and County Directory, 1908-09. Salt Lake City, Utah, 1909.

Reconnaissance Site Survey of Architectural Properties. Twin Falls Historic Preservation Commission, 1989.

Sanborn 1922 plot map of Twin Falls.

Wright, Patricia. *Twin Falls County; A Look at Idaho Architecture*. Boise, Idaho: Idaho State Historic Preservation Office, 1979.

United States Department of the Interior
National Park Service

National Register of Historic Places Continuation Sheet

Section number 10 Page 1

Name of Property Duquesne, Achille, House

County and State Twin Falls County, Idaho

VERBAL BOUNDARY DESCRIPTION

The nomination includes the Achille Dusquesne House and the property on which it is located: Filer Property Tax #630, which is 135' x 120'.

Filer acres inside tax no. 630 except the west 130 feet. Sec. 7, T10S, R16E.

United States Department of the Interior
National Park Service

National Register of Historic Places Continuation Sheet

Section number 10 Page 2

Name of Property Duquesne, Achille, House

County and State Twin Falls County, Idaho

BOUNDARY JUSTIFICATION

Boundaries for the nomination include the entire city lot that has historically been associated with the property of the Achille Dusquesne Residence.

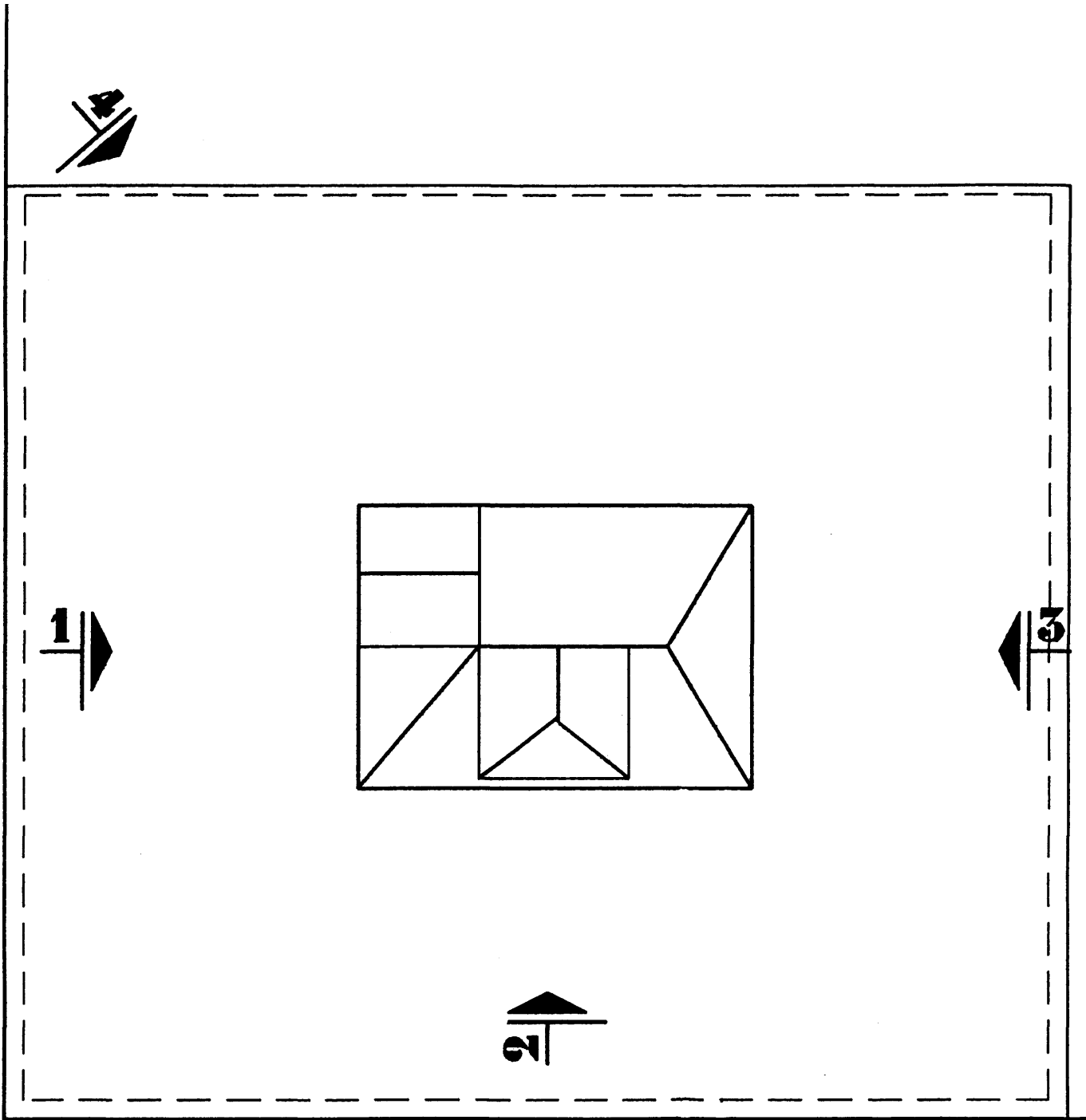

MIDWAY

HIGHWAY 30

ACHILLE DUQUESNE HOUSE

LOT TO SCALE

