

UNITED STATES DEPARTMENT OF THE INTERIOR
NATIONAL PARK SERVICE

**NATIONAL REGISTER OF HISTORIC PLACES
INVENTORY -- NOMINATION FORM**

FOR FEDERAL PROPERTIES

FOR NPS USE ONLY

RECEIVED MAY 12 1986
DATE ENTERED JUN 18 1986

SEE INSTRUCTIONS IN *HOW TO COMPLETE NATIONAL REGISTER FORMS*
TYPE ALL ENTRIES -- COMPLETE APPLICABLE SECTIONS

1 NAME

HISTORIC

United States Post Office

AND/OR COMMON

Newburyport Main Post Office

2 LOCATION

STREET & NUMBER

61 Pleasant Street

N/A NOT FOR PUBLICATION

CITY, TOWN

Newburyport

CONGRESSIONAL DISTRICT

N/A VICINITY OF

Sixth Congresssional District

STATE

Massachusetts 01950

CODE

0860

COUNTY

Essex

CODE

009

3 CLASSIFICATION

CATEGORY	OWNERSHIP	STATUS	PRESENT USE
<input type="checkbox"/> DISTRICT	<input checked="" type="checkbox"/> PUBLIC	<input checked="" type="checkbox"/> OCCUPIED	<input type="checkbox"/> AGRICULTURE
<input checked="" type="checkbox"/> BUILDING(S)	<input type="checkbox"/> PRIVATE	<input type="checkbox"/> UNOCCUPIED	<input type="checkbox"/> MUSEUM
<input type="checkbox"/> STRUCTURE	<input type="checkbox"/> BOTH	<input type="checkbox"/> WORK IN PROGRESS	<input type="checkbox"/> COMMERCIAL
<input type="checkbox"/> SITE	PUBLIC ACQUISITION	ACCESSIBLE	<input type="checkbox"/> EDUCATIONAL
<input type="checkbox"/> OBJECT	N/A IN PROCESS	<input checked="" type="checkbox"/> YES: RESTRICTED	<input type="checkbox"/> ENTERTAINMENT
	<input type="checkbox"/> BEING CONSIDERED	<input type="checkbox"/> YES: UNRESTRICTED	<input checked="" type="checkbox"/> GOVERNMENT
		<input type="checkbox"/> NO	<input type="checkbox"/> RELIGIOUS
			<input type="checkbox"/> INDUSTRIAL
			<input type="checkbox"/> MILITARY
			<input type="checkbox"/> PARK
			<input type="checkbox"/> PRIVATE RESIDENCE
			<input type="checkbox"/> SCIENTIFIC
			<input type="checkbox"/> TRANSPORTATION
			<input type="checkbox"/> OTHER

4 AGENCY

REGIONAL HEADQUARTERS: (If applicable)

New England Field Real Estate and Buildings Office

STREET & NUMBER

1050 Waltham Street

CITY, TOWN

Lexington

STATE

Massachusetts 02173

N/A VICINITY OF

5 LOCATION OF LEGAL DESCRIPTION

COURTHOUSE,
REGISTRY OF DEEDS, ETC.

Registry of Deeds, Salem Probate Courthouse

STREET & NUMBER

36 Federal Street

CITY, TOWN

Salem

STATE

Massachusetts 01970

6 REPRESENTATION IN EXISTING SURVEYS

TITLE

Newburyport (Market Square) Historic District

DATE

February 25, 1971

FEDERAL STATE COUNTY LOCAL

DEPOSITORY FOR
SURVEY RECORDS

City of Newburyport, Office of Community Development

CITY, TOWN

Newburyport

STATE

Massachusetts 01950

7 DESCRIPTION

CONDITION		CHECK ONE	CHECK ONE
<input type="checkbox"/> EXCELLENT	<input type="checkbox"/> DETERIORATED	<input type="checkbox"/> UNALTERED	<input checked="" type="checkbox"/> ORIGINAL SITE
<input checked="" type="checkbox"/> GOOD	<input type="checkbox"/> RUINS	<input checked="" type="checkbox"/> ALTERED	<input type="checkbox"/> MOVED DATE _____
<input type="checkbox"/> FAIR	<input type="checkbox"/> UNEXPOSED		

DESCRIBE THE PRESENT AND ORIGINAL (IF KNOWN) PHYSICAL APPEARANCE

LOCAL CONTEXT

Within Newburyport's downtown historic district, the Newburyport Post Office is located at one of the city's main intersections, Pleasant and Green Streets. Adjacent are business offices, storefront retail, two churches (a Baptist Church to the west and the Church of the First Religious Society to the east), Brown Square Park, and Newburyport City Hall (built in 1851 in an Italian Villa style with rusticated quoins, gable roof, and round-headed pediment windows). A new brick sidewalk has been laid throughout the area.

PHYSICAL APPEARANCE

Overall, the building and corner lot are in good condition. Its distinctive features include three large arched, marble-trimmed openings with a Palladian motif, symmetrical floorplan and elevation, a hip roof, brick quoins, and a marble belt course and cornice line. The structure is on the front portion of the site, with a paved vehicle maneuvering area occupying most of the east side and all of the back of the property. In plan the building has an original vestibule that leads to a public lobby flanked by the Postmaster's office to the right and service area to the left. Behind the service screen is the workroom with mail vestibule and platform beyond.

Seven granite steps with brass pipe railings create the main approach. Low wing walls, brick with a marble cap, frame the stairs; on top are cast iron lampposts. The front (north) elevation is a five-bay structure with a three-bay central projecting entrance. The elevations are of red brick laid in an English bond with corner quoins reminiscent of the adjacent City Hall. The windows are double-hung wood sash, 12/12 lights with marble sills and keystones. The central Palladian windows include marble trim, keystone and

United States Department of the Interior
National Park Service

National Register of Historic Places
Inventory—Nomination Form

For NPS use only

received

date entered

Continuation sheet Newburyport Post Office

Item number 7

Page 2

springer stones, and a pilastered balustrade panel below. The door is within an arch opening framed by marble Roman Doric three-quarter engaged columns, entablature, keystone and springer stones, and fanlight with decorative trimming. The replacement glass and aluminum doors are topped with a nameplate and decorative metal grilles. The entablature's cornice is denticulated, and its frieze consists of geometric and floral patterns.

On the exterior front - the lobby, service counter and Postmaster's office - is marked by a continuous decorated marble cornice, a brick parapet inset with marble balustrade panels above the arched openings, a slate hip roof, and inverted corners.

The side elevations are similar in detail to the front facade. The east elevation conforms to Green Street once past the main front public block. The rear (south) elevation contains the mail platform. Metal grilles with a Greek key pattern are common above most of the building's rectangular windows. The back of the building has a flat gravel roof with parapet walls.

One enters the building through a steel and glass vestibule into the two story height public lobby. The floor is red quarry tile bordered with white marble; the walls are plaster with a paneled wood dado and black marble base. The coffered ceiling and its simple molding are also of plaster. The Palladian window motif is recalled in the center of the service screen wall and above the replacement service counter on the east wall by the overhead wood frame openings.

ALTERATIONS

The far east side of the south wall, which once contained service windows has been replaced with a door and additional boxes. The individual service windows on the east wall have been opened up and widened beyond the window frame above to form a single service counter. The molding along the ceiling's edge is in poor condition and parts have been replaced. The interior side of the front facade has been replaced due to a roof collapse.

**United States Department of the Interior
National Park Service**

**National Register of Historic Places
Inventory—Nomination Form**

For NPS use only

received

date entered

Continuation sheet Newburyport Post Office Item number 7

Page 3

The roof has been repaired and reslated.

8 SIGNIFICANCE

PERIOD	AREAS OF SIGNIFICANCE -- CHECK AND JUSTIFY BELOW			
<input type="checkbox"/> PREHISTORIC	<input type="checkbox"/> ARCHEOLOGY-PREHISTORIC	<input type="checkbox"/> COMMUNITY PLANNING	<input type="checkbox"/> LANDSCAPE ARCHITECTURE	<input type="checkbox"/> RELIGION
<input type="checkbox"/> 1400-1499	<input type="checkbox"/> ARCHEOLOGY-HISTORIC	<input type="checkbox"/> CONSERVATION	<input type="checkbox"/> LAW	<input type="checkbox"/> SCIENCE
<input type="checkbox"/> 1500-1599	<input type="checkbox"/> AGRICULTURE	<input type="checkbox"/> ECONOMICS	<input type="checkbox"/> LITERATURE	<input type="checkbox"/> SCULPTURE
<input type="checkbox"/> 1600-1699	<input checked="" type="checkbox"/> ARCHITECTURE	<input type="checkbox"/> EDUCATION	<input type="checkbox"/> MILITARY	<input type="checkbox"/> SOCIAL/HUMANITARIAN
<input type="checkbox"/> 1700-1799	<input type="checkbox"/> ART	<input type="checkbox"/> ENGINEERING	<input type="checkbox"/> MUSIC	<input type="checkbox"/> THEATER
<input type="checkbox"/> 1800-1899	<input type="checkbox"/> COMMERCE	<input type="checkbox"/> EXPLORATION/SETTLEMENT	<input type="checkbox"/> PHILOSOPHY	<input type="checkbox"/> TRANSPORTATION
<input checked="" type="checkbox"/> 1900-	<input type="checkbox"/> COMMUNICATIONS	<input type="checkbox"/> INDUSTRY	<input type="checkbox"/> POLITICS/GOVERNMENT	<input type="checkbox"/> OTHER (SPECIFY)
		<input type="checkbox"/> INVENTION		

SPECIFIC DATES	Construction started: July 1927 Dedication: May 3, 1928	ARCHITECT	James A. Wetmore, Sup. Architect
		BUILDER/ARCHITECT	A.M. Lundburg, Builder
STATEMENT OF SIGNIFICANCE	Repairs: 1975		Arnold Shorrnick, Architects

The Newburyport Main Post Office building is situated in the heart of Newburyport's historic downtown. Built in 1928 it was designed in the Colonial or more specifically, Georgian Revival style. Architecturally it is significant as an example of the U.S. Treasury Department's policy during the 1910's and 1920's to erect "buildings adapted to local conditions and in keeping with the importance of the communities in which they are erected." Compatibility, interiors forms, style and materials with surrounding structures is the Newburyport Post Office building's chief hallmark. The monumentality, expensive building materials and lavish interior treatments, typical of the early 1900's post office design, is nowhere in evidence. Its boxy red brick with stone trimmed form complements the red brick Italianate City Hall (1851) and other buildings in the immediate area.

During the mid 1970's, Newburyport was one of 799 towns and cities determined eligible for a Federal building by a U. S. Treasury Department survey. The Newburyport Post Office building owes its existence to the Public Buildings Act of 1926 - a general enabling act which allotted \$100,000.00 for buildings outside the District of Columbia. The building falls within Class C of the Secretary of the Treasury's 1915 Classification of Buildings by virtue of its location within a "second class city" and the type of materials employed in its construction.

This building's U.S. Treasury Supervising Architect was James A. Wetmore - born November 10, 1863 in Bath, New York, he was a graduate of Georgetown University. He began work as a law and court stenographer and joined the U.S. Treasury Department in 1885. Over a 45 year period, he held positions within the U.S. Treasury Department ranging from stenographer to Supervising Architect. During his tenure at least 2,000 buildings were designed in his office. He died March 4, 1940. Arthur Shorrnick was the local architect charged with preparing designs and floor plans that would serve as a guide for working drawings and specification produced within the Supervising Architect's office (a search in Boston and local libraries did not yield information on Shorrnick). The Public Buildings Act of May 25, 1926 (Keyes-Elliott Act) authorized the Secretary of the Treasury to hire outside architects in "special cases."

The Newburyport Main Post Office occupies the site of the old "Star Theatre, a popular entertainment spot at the turn of the century. The government purchased the land in 1911 for \$25,000.00 and over the years slowly developed a plan calling for a two-story post office. The original appropriation was \$75,000.00 but war efforts caused construction costs to rise. Funds were raised to meet building costs of \$102,000.00

9 MAJOR BIBLIOGRAPHICAL REFERENCES

"Newburyport Daily News and Newburyport Herald" - May 31, 1978

History of Post Office Construction 1900-1940, July, 1982

Boston Public Library Files - no information on Arthur Shorrnick

Newburyport Daily News - 5/31/28; 1/10-28/4-11-85

10 GEOGRAPHICAL DATA

ACREAGE OF NOMINATED PROPERTY 0.358

UTM REFERENCES

A	19	327600	4693840	B			
	ZONE	EASTING	NORTHING		ZONE	EASTING	NORTHING
C				D			

VERBAL BOUNDARY DESCRIPTION

Southeast to Northwest - 137' along Pleasant Street
 Northeast to Southwest - 130' along Green Street
 Northwest to Southeast - 115' along rear lot line
 Southwest to Northeast - 112' along side lot line

LIST ALL STATES AND COUNTIES FOR PROPERTIES OVERLAPPING STATE OR COUNTY BOUNDARIES

STATE	CODE	COUNTY	CODE
STATE	CODE	COUNTY	CODE

11 FORM PREPARED BY

NAME / TITLE

Steven M. Smith, Project Manager

ORGANIZATION

SULLIVAN DESIGN GROUP, INC.

STREET & NUMBER

44 Adams Street

CITY OR TOWN

Braintree

DATE

September 24, 1985

TELEPHONE

(617) 848-1545

STATE

Massachusetts 02184

12 CERTIFICATION OF NOMINATION

STATE HISTORIC PRESERVATION OFFICER RECOMMENDATION

YES

NO

NONE

Valerie Talma

STATE HISTORIC PRESERVATION OFFICER SIGNATURE

In compliance with Executive Order 11593, I hereby nominate this property to the National Register, certifying that the State Historic Preservation Officer has been allowed 90 days in which to present the nomination to the State Review Board and to evaluate its significance. The evaluated level of significance is State National State Local.

FEDERAL REPRESENTATIVE SIGNATURE

John S. Larson

TITLE Realty Specialist, Senior

DATE

4/29/86

FOR NPS USE ONLY

I HEREBY CERTIFY THAT THIS PROPERTY IS INCLUDED IN THE NATIONAL REGISTER

Patrick Anders

DATE

6/18/86

DIRECTOR, OFFICE OF ARCHEOLOGY AND HISTORIC PRESERVATION

ATTEST: Beth L. Savage

DATE

6-16-86

KEEPER OF THE NATIONAL REGISTER

United States Department of the Interior
National Park Service

**National Register of Historic Places
Inventory—Nomination Form**

For NPS use only

received

date entered

Continuation sheet Newburyport Main Post Office Item number 8

Page 2

Construction began in July, 1927 and the building was opened on May 31, 1928, making it the first permanent postal location in the city.

The Newburyport Post Office is symbolic of Newburyport's prosperity during the late 1920's. In 1928 a major industrial developemnt was completed in buildings on Warren/Kent Streets in the former property of N.D. Dodge Shoe Company. Seventy-five thousand (75,000) square feet of floor space was rented to shoe factories and a rain coat company along with smaller shops. In addition a large branch of the 5 cents Savings Bank was opened in Newburyport in February, 1928.

In April, 1985 the Newburyport Main Post Office Building received a \$90,000.00 face lift. It was repointed by the Alan Tisbert Masonry Co. of Methuen. The three month project included the repair of its slate roof. Compatibility with its surroundings was once again an important issue as it was "spruced up to match the rest of the downtown." The repairs were supervised by the real estate division at Lexington, MA

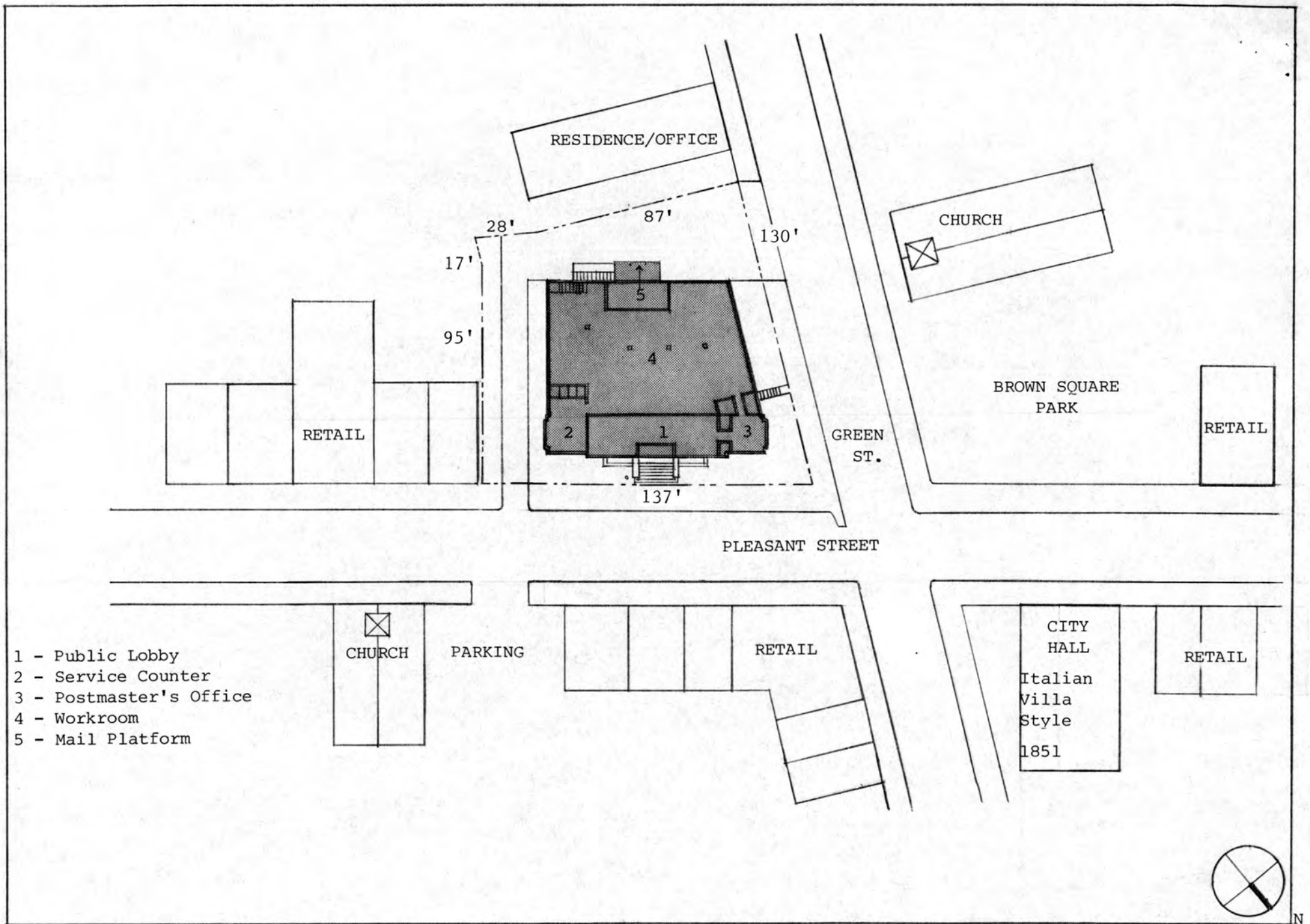

- 1 - Public Lobby
- 2 - Service Counter
- 3 - Postmaster's Office
- 4 - Workroom
- 5 - Mail Platform

UNITED STATES POST OFFICE - NEWBURYPORT, MASSACHUSETTS

NATIONAL REGISTER OF HISTORIC PLACES
EVALUATION/RETURN SHEET

Substantive Review

U. S. Post Office--Newburyport Main
Essex County
MASSACHUSETTS

MAY 12 1986

Working No. _____
Fed. Reg. Date: 2/3/87
Date Due: 6/13/86 - 6/26/86
Action: ACCEPT 6-18-86
 RETURN _____
 REJECT _____
Federal Agency: USPS

- resubmission
- nomination by person or local government
- owner objection
- appeal

Substantive Review: sample request appeal NR decision

Reviewer's comments:

Locally significant relatively intact representative of Georgian Revival style reflective of Newbury's prosperity during the 1920's. The first permanent post office in the city.

Recom./Criteria Accept C & A
Reviewer Savage
Discipline Architectural History
Date 6-16-86
____ see continuation sheet

Nomination returned for: _____ technical corrections cited below
_____ substantive reasons discussed below

1. Name

2. Location

3. Classification

Category Ownership Status Present Use
Public Acquisition Accessible

4. Owner of Property

5. Location of Legal Description

6. Representation in Existing Surveys

Has this property been determined eligible? yes no

7. Description

Condition Check one Check one
 excellent deteriorated unaltered original site
 good ruins altered moved date _____
 fair unexposed

Describe the present and original (if known) physical appearance

- summary paragraph
- completeness
- clarity
- alterations/integrity
- dates
- boundary selection

8. Significance

Period _____ Areas of Significance—Check and justify below

Specific dates _____ Builder/Architect _____

Statement of Significance *(in one paragraph)*

- summary paragraph
- completeness
- clarity
- applicable criteria
- justification of areas checked
- relating significance to the resource
- context
- relationship of integrity to significance
- justification of exception
- other

9. Major Bibliographical References

10. Geographical Data

Acreage of nominated property _____

Quadrangle name _____

UTM References _____

Verbal boundary description and justification

11. Form Prepared By

12. State Historic Preservation Officer Certification

The evaluated significance of this property within the state is:

____ national ____ state ____ local

State Historic Preservation Officer signature _____

title _____ date _____

13. Other

- Maps
- Photographs
- Other

Questions concerning this nomination may be directed to _____

Signed _____ Date _____ Phone: _____



UNITED STATES

POST OFFICE

000 00
000 00
000 00

Newburyport Post Office

NEWBURYPORT MAIN POST OFFICE
Newburyport, MA
David R. Hooker
Earl R. Flansburgh and Associates
Sept. 1982
Front elevation. Right view



UNITED STATES POST OFFICE

A person walking on the sidewalk to the left of the entrance.

A vintage car parked on the right side of the image.

Newburyport Post Office

NEWBURYPORT MAIN POST OFFICE
Newburyport, MA
David R. Hooker
Earl R. Flansburgh and Associates
Sept. 1982
Front elevation



Newburyport post Office

NEWBURYPORT MAIN POST OFFICE
Newburyport, MA
David R. Hooker
Earl R. Flansburgh and Associates
Sept. 1982
Front elevation. Left view

Newburyport

UNITED STATES
DEPARTMENT OF THE INTERIOR
GEOLOGICAL SURVEY

COMMONWEALTH OF MASSACHUSETTS
DEPARTMENT OF PUBLIC WORKS

NEWBURYPORT EAST QUADRANGLE
MASSACHUSETTS-NEW HAMPSHIRE
7.5 MINUTE SERIES (TOPOGRAPHIC)



U.S. POST OFFICE
NEWBURYPORT, MA
UTM REFERENCE:
19J347860/4741275

Mapped, edited, and published by the Geological Survey
Control by USGS, USC&GS, and Massachusetts Geodetic Survey
Topography by planetable surveys 1942. Revised 1966
Selected hydrographic data compiled from USC&GS Charts 213 (1965)
and 1206 (1966). This information is not intended for navigational
purposes.

Polyconic projection. 1927 North American datum
10,000-foot grids based on Massachusetts coordinate system,
mainland zone, and New Hampshire coordinate system
1000-meter Universal Transverse Mercator grid ticks,
zone 19, shown in blue

Red tint indicates area in which only landmark buildings are shown
Boundaries in tidewater areas from information furnished
by Massachusetts Department of Public Works

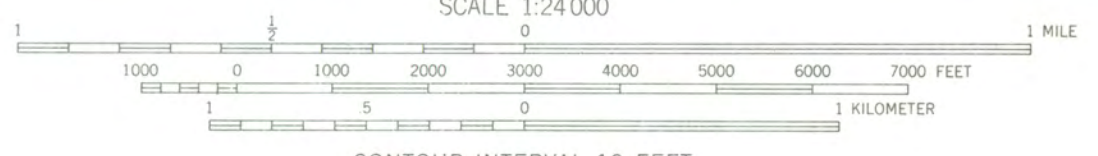
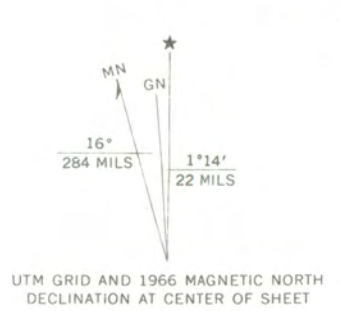

CONTOUR INTERVAL 10 FEET
DATUM IS MEAN SEA LEVEL
DEPTH CURVES AND SOUNDINGS IN FEET—DATUM IS MEAN LOW WATER
SHORELINE SHOWN REPRESENTS THE APPROXIMATE LINE OF MEAN HIGH WATER
THE MEAN RANGE OF TIDE IS APPROXIMATELY 8.3 FEET



ROAD CLASSIFICATION
Heavy-duty ——— Light-duty ———
Medium-duty ——— Unimproved dirt ———
U.S. Route (red circle) State Route (black circle)

NEWBURYPORT EAST, MASS.—N. H.
N4245—W7045/7.5

1966

AMS 6869 IV SE—SERIES V814



FIELD REAL ESTATE AND BUILDINGS OFFICE

P.O. Box 324
Lexington, MA 02173-0324

August 27, 1985

The Honorable Richard Sullivan
Mayor, City of Newburyport
Newburyport City Hall
Pleasant Street
Newburyport, MA 01950

Dear Mayor Sullivan:

The U. S. Postal Service, in conjunction with the Massachusetts State Historic Preservation Officer in Boston, has evaluated the Main Post Office in Newburyport and has determined it is significant from an historical viewpoint.

In view of the above evaluation, the U. S. Postal Service intends to nominate this building to the National Register of Historic Places. We would, prior to our taking formal action, appreciate receiving your concurrence.

If you concur with our proposed action, kindly return a signed copy of this letter in the enclosed envelope.

Sincerely,

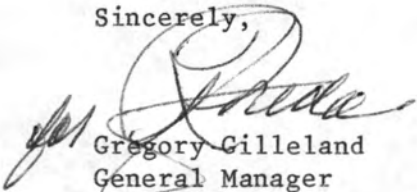
Gregory Gilleland
General Manager

Concur: 

Enclosure

JPC/phw

RECEIVED
U.S. POSTAL SERVICE

SEP 9 11 30 PM '85

NEW ENGLAND FIELD REAL
ESTATE & BLDG. OFFICE
LEXINGTON, MA 02173

TO: [Faint recipient address]

FROM: [Faint sender address]

[Faint body text]



FIELD OFFICE AND BUREAU OFFICE





UNITED STATES POSTAL SERVICE
475 L'Enfant Plaza, SW
Washington, DC 20260

May 7, 1986

Ms. Carol D. Shull
Chief of Registration
National Register of Historic Places
National Park Service
Department of Interior
Washington, D.C. 20240-1002

Dear Ms. Shull:

The Postal Service hereby submits a nomination for the post office located at 61 Pleasant Street, Essex County, Newburyport, Massachusetts.

If you have questions concerning this nomination, please call me at 202/268-3107.

Sincerely,

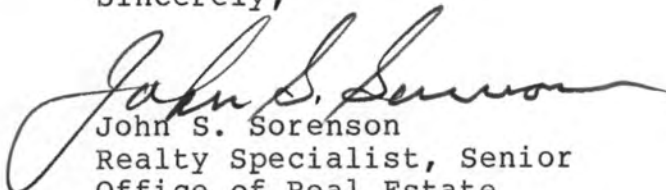
John S. Sorenson
Realty Specialist, Senior
Office of Real Estate

Enclosure

MAY 12 1986