

# ARIZONA STATE HISTORIC PROPERTY INVENTORY

### IDENTIFICATION

SURVEY AREA NAME: Phoenix Commercial  
 HISTORIC NAME: Security Building  
 ADDRESS/LOCATION: 234 N. Central  
 CITY/TOWN: Phoenix  
 TAX PARCEL NUMBER: 112/21/72B  
 OWNER: Security Center Company  
 OWNER ADDRESS: c/o Kelcher Management Services  
234 N. Central Ave., Suite 623, Phx, AZ 85003  
 HISTORIC USE: Offices  
 PRESENT USE: Offices  
 BUILDING TYPE: Commercial/Offices  
 STYLE: Second Renaissance Revival  
 CONSTRUCTION DATE: 1928  
 ARCHITECT/BUILDER: Curlett and Beelman, Architects  
Edwards, Wildey & Dixon, Contractors  
 INTEGRITY: Original Site/Unaltered/Altered Minor  
 CONDITION: Good

COUNTY: Maricopa SURVEY SITE: 28-7  
 USGS QUAD: Phoenix  
 T 1N R 3E S 8 N1/2 1/4 OF THE 1/4  
 UTM Zone 12 Easting 400250 Northing 370162

### Description (contd.)

ROOF TYPE: flat  
 ROOF SHEATHING: built-up  
 EAVES TREATMENT: dentils-boxed  
 WINDOWS: casement with transom  
 ENTRY: recessed/offset broken pediment  
 PORCHES: \_\_\_\_\_  
 STOREFRONTS: \_\_\_\_\_

### DESCRIPTION

STORIES: 9 B DIMENSIONS: (l) 120(w) 130  
 STRUCTURAL MATERIAL: Reinforced concrete  
 FOUNDATION MATERIAL: concrete  
 WALL SHEATHING: hand-molded brick  
 APPLIED ORNAMENT: concrete quoins, arcade at  
original roofline, balcony near top/copper tower

NOTABLE INTERIOR: marble floors & walls,  
brass elevator doors, painted designed  
ceiling, original letter drops & lights.  
 OUTBUILDINGS: \_\_\_\_\_  
 ALTERATIONS: \_\_\_\_\_

### PHOTOGRAPH

PHOTOGRAPHER: Francissen  
 DATE: August 1983 VIEW: W

### SKETCH MAP:

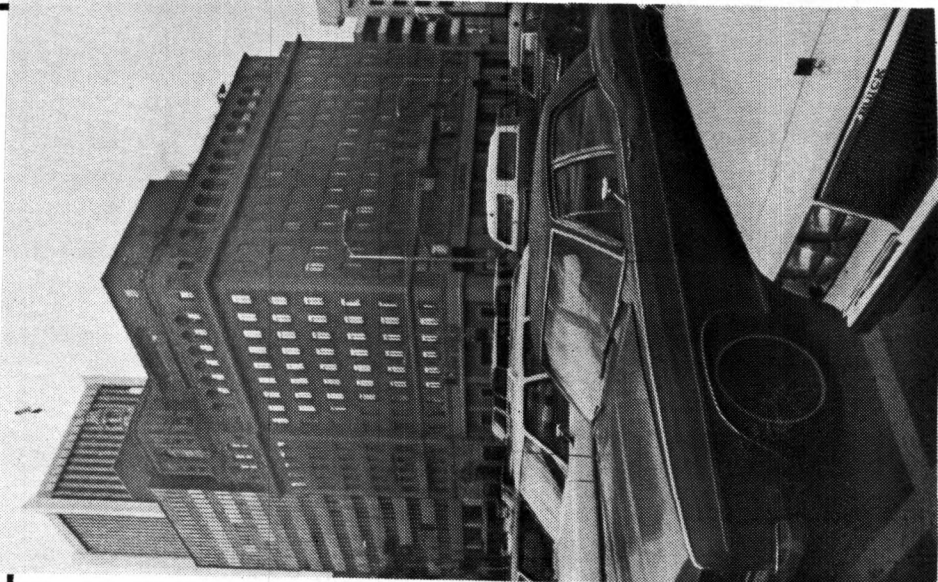
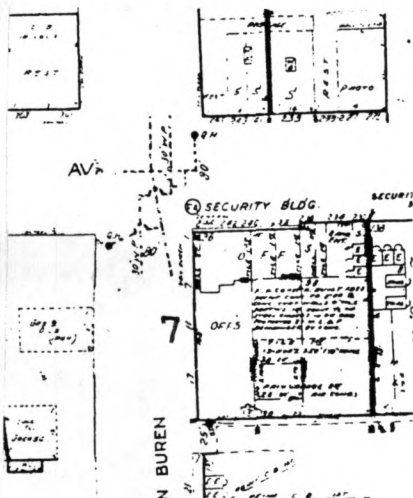

ADDITIONAL DESCRIPTION/ANALYSIS (annotated form):

SIGNIFICANCE:

AREAS OF SIGNIFICANCE: COMMERCE  COMMUNITY PLANNING \_\_\_\_\_ ECONOMICS \_\_\_\_\_  
 EXPLORATION/SETTLEMENT \_\_\_\_\_ GOVERNMENTAL \_\_\_\_\_ MILITARY \_\_\_\_\_ RELIGION \_\_\_\_\_ SCIENCE \_\_\_\_\_  
 THEATRE \_\_\_\_\_ TRANSPORTATION \_\_\_\_\_ TOURISM \_\_\_\_\_ OTHER(specify) \_\_\_\_\_

HISTORIC ASSOCIATIONS (be concise):

PROMINENT OCCUPANT/HISTORIC ASSOCIATION(S) Curlett and Beelman, regional architects, Edwards, Wildey, & Dixon, regional contractors, Security Improvement Co., local business.

RELATIONSHIP TO LOCAL DEVELOPMENT part of the Heard Investment Co. commitment to downtown Phoenix.

CULTURAL AFFILIATIONS \_\_\_\_\_

ARCHITECTURAL STYLE good example of Second Renaissance Revival design .

MAJOR ARCH. FORM/MATERIAL use of copper and hand-molded bricks.

ENGINEERING/STRUCTURAL Known for speed of construction.

DISTRICT/STREETScape CONTRIBUTION major intersection

DISCUSSION AS REQUIRED:

Dwight B. Heard, prominent Phoenix realtor and cattleman, was President of the Security Improvement Co. when the building was erected. Heard was one of the city's most powerful and influential men from 1897 until his death in 1929. He owned the Arizona Republican, the Dwight Heard Investment Co., Bartlett-Heard Cattle Co., and was an active member of dozens of civic organizations. See MRA text, Item 8, pages 37,48,49.

CONTEXT: ISOLATED/RURAL \_\_\_\_\_ RESIDENTIAL STREET \_\_\_\_\_ COMMERCIAL  CENTRAL SQUARE \_\_\_\_\_  
 CBD:  OTHER: Highrise

BIBLIOGRAPHY/SOURCES:

Arizona Republican, various issues 1927-1928 especially 7/28/28 Section 2, several pages.  
 Phoenix City Directories

LISTING IN OTHER SURVEYS: AIA Guide to Phoenix / Page Survey / Army Corps Survey

NATIONAL REGISTER STATUS:

LISTED \_\_\_\_\_ DETERMINED ELIGIBLE  DETERMINED NOT ELIGIBLE \_\_\_\_\_ NOT EVALUATED \_\_\_\_\_  
 12-13-84 (by letter from Carol Shull)

COMMENTS/DEVELOPMENT PLANS/THREATS:

SURVEYOR J. Garrison etal SURVEY DATE May 1984 DATE FORM COMPLETED May 1984