

**United States Department of the Interior
National Park Service**

**National Register of Historic Places
Registration Form**

This form is for use in nominating or requesting determinations for individual properties and districts. See instructions in *How to Complete the National Register of Historic Places Registration Form* (National Register Bulletin 16A). Complete each item by marking "x" in the appropriate box or by entering the information requested. If an item does not apply to the property being documented, enter "N/A" for "not applicable." For functions, architectural classification, materials, and areas of significance, enter only categories and subcategories from the instructions. Place additional entries and narrative items on continuation sheets (NPS Form 10-900a). Use a typewriter, word processor, or computer, to complete all items.

1. Name of Property

historic name Morrison, Hattie Merrill, Farmstead

other name/site number Hansen, Soren H., Farmstead

2. Location

street & town 1367 South State Street not for publication

city or town Richmond vicinity

state Utah code UT county Cache code 005 zip code 84333

3. State/Federal Agency Certification

As the designated authority under the National Historic Preservation Act, as amended, I hereby certify that this nomination request for determination of eligibility meets the documentation standards for registering properties in the National Register of Historic Places and meets the procedural and professional requirements set forth in 36 CFR Part 60. In my opinion, the property meets does not meet the National Register criteria. I recommend that this property be considered significant nationally statewide locally. (See continuation sheet for additional comments.)

[Signature]
Signature of certifying official/Title

Aug 20, 2004
Date

Utah Division of State History, Office of Historic Preservation
State or Federal agency and bureau

In my opinion, the property meets does not meet the National Register criteria. (See continuation sheet for additional comments.)

Signature of certifying official/Title

Date

State or Federal agency and bureau

4. National Park Service Certification

I hereby certify that the property is:

- entered in the National Register. See continuation sheet.
- determined eligible for the National Register. See continuation sheet.
- determined not eligible for the National Register.
- removed from the National Register.
- other, (explain:) _____

[Signature] Signature of the Keeper

Date of Action

10/2/04

Morrison, Hattie Merrill, Farmstead
Name of Property

Richmond, Cache County, Utah
City, County and State

5. Classification

Ownership of Property

(check as many boxes as apply)

- public-local
- private
- public-State
- public-Federal

Category of Property

(check only one box)

- district
- building(s)
- site
- structure
- object

Number of Resources within Property

(Do not include previously listed resources in the count.)

Contributing	Noncontributing	
5	2	buildings
		sites
		structures
		objects
5	2	Total

Name of related multiple property listing

(Enter "N/A" if property is not part of a multiple property listing.)

Number of contributing resources previously listed in the National Register

Historic and Architectural Resources of Richmond, Utah, 1859-1954

6. Function or Use

Historic Function

(Enter categories from instructions)

DOMESTIC: single family

AGRICULTURE/SUBSISTENCE: animal facility

AGRICULTURE/SUBSISTENCE: storage

Current Function

(Enter categories from instructions)

DOMESTIC: single family

AGRICULTURE/SUBSISTENCE: animal facility

AGRICULTURE/SUBSISTENCE: storage

7. Description

Architectural Classification

(Enter categories from instructions)

LATE VICTORIAN: Victorian Eclectic

Other: Cross Wing

Other: 20th century agricultural outbuildings

Materials

(Enter categories from instructions)

foundation STONE

walls BRICK

roof ASPHALT SHINGLE

other

Narrative Description

(Describe the historic and current condition of the property on one or more continuation sheets.)

See continuation sheet(s) for Section No. 7

United States Department of the Interior
National Park Service

National Register of Historic Places Continuation Sheet

Section No. 7 Page 1

Morrison, Hattie Merrill, Farmstead, Richmond, Cache County, UT

Narrative Description

The Hattie Merrill Morrison Farmstead is a multi-resource property located at 1367 South State Street just south of Richmond, Utah. The 2.04-acre property includes a Victorian-era brick residence, a contributing garage, a contributing barn and granary, a contributing outhouse and two non-contributing outbuildings. The house was built circa 1898, and is a 1½-story brick Victorian Eclectic central-block-with-projecting-bays type house with an enclosed porch addition (circa 1915) at the rear. The house is built on a stone foundation and has an asphalt shingle roof (date unknown, probably 1970s). The buildings and structure are all in excellent condition and contribute to the historic resources of Richmond.

Residence

The houses faces west on State Street. The brick is laid in running bond with flush mortar joints. The raised foundation is rock-faced random ashlar stone. There are three courses of rock-faced brick above the foundation. Rock-faced header bricks are also used as the top course of the segmental windows hoods. The brick of the relieving arches is laid using an unusual “woven” patten where holes have been left in the projecting brickwork. These hoods are found on every elevation of the brick portion of the house. A tax photograph indicates the house’s original red brick was painted sometime after 1935. A later photograph shows the house with dark trim. Currently, the brick has been painted red and the brick, stone and wood details are painted a light grey. An enclosed porch was added circa 1915 on almost the full width of the rear elevation. This addition is sheathed in narrow clapboards and painted red. There is a (circa 1980) metal canopy sheltering a concrete patio at the southeast corner of the house.

The Victorian-era windows are a combination of original one-over-one, double-hung wood sash windows, and some aluminum replacements and storm windows (circa 1980). The sills are sandstone. The façade is the west elevation. There is a larger window on the main level with a leaded-glass transom. The upper window is a small double-hung window surrounded by fish-scale shingles in the gable trim. This elevation features a full-width box cornice on the projecting wing. There are two windows on the south wing. The entry faces south and has an original wood-panel half-glass door and transom. The original lathe-turn and spindle Victorian porch was replaced with square posts after 1935. The porch deck is wood, but the steps are concrete. The north elevation is blank with no openings except at the basement level. The site slopes from east to west so there is more foundation visible on west elevation. The south elevation has two windows, one on each level in the projecting wing. Here the brick continues to the apex with cornice returns and a plain frieze. The rear (east) elevation is obscured on the main floor by the enclosed porch addition. On the south elevation, the addition has a ribbon of short double-hung windows. There is a back door and two small windows on the east elevation. At the northeast corner is a covered shed area. On the interior, the house has three levels: the main floor, the upper floor, and a partial basement. The living room and parlor are on the west side. The kitchen is in the southeast corner, and the bathroom is to the north. There are bedrooms on the upper level.

National Register of Historic Places Continuation Sheet

Section No. 7 Page 2

Morrison, Hattie Merrill, Farmstead, Richmond, Cache County, UT

Outbuildings

One of the most important elements of the property is the collection of contributing outbuildings. The two-car garage is located near State Street and probably dates from 1915. It has a simple-gable roof covered with corrugated metal and sits on a concrete pad. It is a frame garage covered in narrow clapboard siding similar to the enclosed porch. The original door is missing and the opening filled with siding and a regular door. The contributing agricultural outbuildings include a barn and a granary. The barn is south of the house and was probably built around 1915. It is constructed on a concrete foundation, visible on the west elevation. The lower portion is sheathed with horizontal planks and the upper portion sheathed with vertical planks. It was probably used as a hay barn, but may have been used for dairy production as well. The barn has a slightly gambrel-shaped roof covered with corrugated metal. The roofline suggests an Improvement Era-style barn.¹ There is a concrete silo attached to the east side of the barn (date unknown, probably 1950s). The small rectangular outbuilding located east and north of the barn was probably originally used as a granary because of the solid walls with no fenestration. The building differs from the most common type Utah granaries of the period. The door is in the long side (west elevation). The building is constructed on notched lumber laid horizontally. The foundation is early concrete, suggesting a construction date of around 1915. The simple gable roof is covered with rolled roofing. There is a small six-pane window and drop siding in the gable trim. The frame outhouse located in the northeast corner of the property was probably associated with the house and is therefore a contributing outbuilding. The two non-contributing outbuildings are a gazebo (circa 1990) and a shed (circa 1980).

Site

The Hattie Merrill Morrison Farmstead is located about a mile south of the center of Richmond. The site sloped slightly from east to west, and the house and outbuildings, with the exception of the garage, sit above the street level where State Street curves to become 9000 North. This was the first road into Richmond from its neighbors to the south until State Highway 91 (200 West in Richmond) was developed as the main corridor. The property has mature trees, lawn and flowerbeds near the house. There is pasture and agricultural to the north, east and south. Once part of a larger parcel, only a small portion of this land belongs with the house and barn. There is a gravel driveway between the house and barn. The property is fenced with combination of wood post and wire. The Morrison Farmstead is isolated from other residences in the Richmond area, making it an exceptional example of a historic farmstead. The property is significant for its isolated location, the architectural details of the residence, intact historic outbuildings. The Hattie Merrill Morrison Farmstead is a contributing resource in Richmond.

¹ The Improvement Era-style barn was usually built for dairy cows with two rows of metal stanchions and an attached milk house. The gambrel-roof barn was popular in rural Utah between 1910-1940.

Morrison, Hattie Merrill, Farmstead
Name of Property

Richmond, Cache County, Utah
City, County and State

8. Description

Applicable National Register Criteria

(Mark "x" in one or more boxes for the criteria qualifying the property for National Register listing.)

- A** Property is associated with events that have made a significant contribution to the broad patterns of our history.
- B** Property is associated with the lives of persons significant in our past.
- C** Property embodies the distinctive characteristics of a type, period, or method of construction or represents the work of a master, or possesses high artistic values, or represents a significant and distinguishable entity whose components lack individual distinction.
- D** Property has yielded, or is likely to yield, information important in prehistory or history.

Criteria Considerations

(Mark "x" in all the boxes that apply.)

Property is:

- A** owned by a religious institution or used for religious purposes.
- B** removed from its original location.
- C** a birthplace or grave.
- D** a cemetery.
- E** a reconstructed building, object, or structure.
- F** a commemorative property.
- G** less than 50 years of age or achieved significance within the past 50 years.

Narrative Statement of Significance

(Explain the significance of the property on one or more continuation sheets.)

See continuation sheet(s) for Section No. 8

9. Major Bibliographical References

Bibliography

(Cite the books, articles, and other sources used in preparing this form on one or more continuation sheets.)

Previous documentation on file (NPS):

- preliminary determination of individual listing (36 CFR 67) has been requested
- previously listed in the National Register
- previously determined eligible by the National Register
- designated a National Historic Landmark
- recorded by Historic American Buildings Survey # _____
- recorded by Historic American Engineering Record # _____

Areas of Significance

(enter categories from instructions)

ARCHITECTURE _____

AGRICULTURE/SUBSISTENCE _____

SOCIAL HISTORY _____

Period of Significance

circa 1898-1954

Significant Dates

circa 1898

1913 _____

Significant Persons

(Complete if Criterion B is marked above)

N/A _____

Cultural Affiliation

N/A _____

Architect/Builder

Builder unknown: possibly James Lewis Burnham

Primary location of additional data:

- State Historic Preservation Office
- Other State agency
- Federal agency
- Local government
- University
- Other Name of repository: _____

See continuation sheet(s) for Section No. 9

National Register of Historic Places Continuation Sheet

Section No. 8 Page 1

Morrison, Hattie Merrill, Farmstead, Richmond, Cache County, UT

Narrative Statement of Significance

The Hattie Merrill Morrison Farmstead, consists of a Victorian Eclectic brick residence, built circa 1898, and associated outbuildings, which are eligible for the National Register of Historic Places under Criterion A and Criterion C. The farmstead is significant under Criterion A for its association with the early twentieth-century development of Richmond, Utah. The property is eligible within the *Historic and Architectural Resources of Richmond, Utah, 1859-1954* Multiple Property Documentation. The associated historic context is the *Diversification and the Early Industry Period, 1874-1903* and the *Dairy and Agriculture, and Early Twentieth-Century Community Development Period, 1904-1954*. The house was built for Hattie Merrill Barnett, a divorcée with two children. Hattie later married Andrew Morrison and with him raised a second family. Hattie Morrison was a teacher who also held numerous church and civic positions, including Richmond Postmistress. She lived to the age of 102. The property's second owner was Soren H. Hansen, a widower, who lived and farmed in Richmond with his extended family for fifty-eight years. The property is also architecturally significant under Criterion C as an excellent example of the Victorian Eclectic style as executed by a local builder. The Morrison Farmstead is in excellent condition and contributes to the historic resources of Richmond, Utah.

History of the Hattie Merrill Morrison:

The community of Richmond was established in 1859 more than a decade after the arrival of members of the Church of Jesus Christ of Latter-day Saints (LDS or Mormon Church) to the Salt Lake Valley in 1847, and about the same time as other settlements in the Cache Valley. Richmond was settled the same year as Logan fourteen miles to the south. Before that time, Native American Shoshoni used the valley for hunting and camping. Fur trappers were also frequent visitors to the area. In 1859, seventeen families of Mormon converts built a fort and spent the winter on the banks of the City Creek. After an influx of new settlers beginning in the spring of 1860, the land was planted and roads were built. Irrigation ditches were dug to obtain water from the Cherry and City Creeks. A second fort large enough for ninety families was built in 1860-1861 along present-day Main Street from 200 West to 300 East.

The town site was surveyed in 1861 into ten-acre blocks of eight 1.25-acre lots. Farm acreage was surveyed to the west of the town. Additional blocks were surveyed and annexed in the 1891. The plan of Richmond followed the "plat of Zion" recommendations espoused by LDS Church leader Brigham Young and appearing in town site variations throughout the Intermountain West. Like other Mormon settlers, the citizens of Richmond built their houses congregated within the town site and worked on farms in the outlying areas. Each lot usually had a single-family dwelling uniformly set back from the street. Animal shelters and agricultural storage, along with vegetable gardens and orchards, were built at the rear of the large lots. The Hattie Merrill Morrison farm was not within the town site, but located in the outlying farmland and on the original main road into town from the south (the route of the current State Street).

United States Department of the Interior
National Park Service

National Register of Historic Places Continuation Sheet

Section No. 8 Page 2

Morrison, Hattie Merrill, Farmstead, Richmond, Cache County, UT

The residents of Richmond moved quickly beyond subsistence farming. The valley proved especially conducive to the raising of dairy cattle. The settlement had the first two creameries in the valley, as well as a number of sawmills, gristmills, and other early industries. Richmond was incorporated as a city on February 26, 1868. In 1874 the Utah & Northern Railway (later the Oregon Short Line) came to Richmond and became the last stop on the line before crossing the Idaho border. In 1890 the community had a population of 1,232. By 1900, the town boasted two general merchandise stores, a drug store, multiple creameries and mills, two saloons and a plow-bobsled factory. The community also had a number of carpenters, painters, masons, a brick kiln and an architect. Historically the population peaked in 1910 at 1,562, six years after the Utah Condensed Milk Plant, which produced canned milk under the Se-go milk label, went into operation.

The Hattie Merrill Morrison Farmstead was built on land originally owned by Hattie's father, Marriner W. Merrill, Richmond's most prominent early citizen and an LDS Church Apostle. Marriner W. Merrill was given the patent to the land in 1882. It was probably part of the acreage known as Merrill's South Farm. Hattie Loenza Merrill was born in Richmond on February 24, 1873, the daughter of Marriner W. Merrill (1832-1906) and his second (polygamous) wife, Maria Loenza Kingsbury (1852-1925). Hattie attended Brigham Young College at Logan and later taught school in Richmond and Fairview, Utah, and Preston, Idaho. She married John W. Barnett (1861-1931) on July 16, 1894. They had two daughters, Loenza and Ethel. Hattie's obituary states she received a temple divorce on April 6, 1899.² On August 3, 1898, Hattie was deeded the property by her father and his first wife, Sarah Atkinson Merrill (1834-1915). The house was probably built for Hattie around that time.

By the time of the 1900 census enumeration, Hattie had dropped Barnett from her name, and was listed under her maiden name. Her occupation is listed as schoolteacher. On April 14, 1909, Hattie married a widower with five children, Andrew Morrison. Andrew Smart Morrison was born in Oneida, Idaho, on May 24, 1866. His first wife was Hilda Hendricks (?-1909). The 1910 census lists Hattie and Andrew with her daughters, his children, and a new baby named Marriner. Three more children were later born to the couple. Andrew is listed on the census as a farmer. Hattie was not listed with an occupation, but according to her obituary, she held several important church positions and served as the postmistress in Richmond for five years. In June 1913, the Morrisons sold the house and farm to Soren H. Hansen. The family moved to Enterprise, Utah and then to Tremonton, Utah in 1919. Andrew Morrison died in Tremonton on November 3, 1937. In 1939, Hattie Merrill Morrison moved to Logan, Utah. She was an LDS temple worker there for thirteen years. On June 20, 1945, she married Clarence L. Funk. Clarence Lorenzo Funk was born in Richmond on April 22, 1872. He and his wife, Hattie's sister, Laura Vilate Merrill (1875-1945), were neighbors to Hattie on the 1900 census in Richmond. Clarence Funk died in Logan on October 3, 1945, only three months after the marriage. Hattie M. Funk continued to live in Logan for several years. She lived with her children in her later years and died in Delta, Utah, on October 13, 1975, at the age of 102. She is buried in Richmond.

² There is no mention of a civil divorce, but the couple would probably have been separated at least a year before the temple divorce was granted. LDS Church officials perform a sealing ritual in the temple, which is accepted by the State of Utah as a civil marriage ceremony. However, if a couple is later divorced, the civil divorce does not affect the temple sealing and the couple must obtain special permission from LDS Church authorities to void the temple sealing.

National Register of Historic Places Continuation Sheet

Section No. 8 Page 3

Morrison, Hattie Merrill, Farmstead, Richmond, Cache County, UT

The farm's second owner was Soren H. Hansen. Soren Hyrum Hansen was born in Mantua, Utah, on June 24, 1866, the son of Danish immigrants. He married Julia Maria Olsen on April 3, 1889. Julia was born in Paradise, Utah, in 1872. The couple had four children all born in Paradise. Julia Hansen died on January 1, 1900, shortly after the birth of her only son. Soren H. Hansen never remarried. He moved to Richmond and purchased the Morrison property in June 1913. Soren Hansen was a farmer and some of the outbuildings may have been constructed after he obtained the property. The 1920 census Soren with a full household: grown children Ivy and Hyrum, Julia's sister-in-law, Mary Ann McMurdie, Mary Ann's son, William A. Olson, and Soren's brother James Hansen. Next door to Soren was his married daughter, Hannah, who lived with her husband, William M. McMurdie, and their children. Soren was listed as a farmer and William McMurdie was a renter and farm laborer, probably on his father-in-law's farm. On the 1930 census, Soren Hansen also had an extended family, including his two young grandsons. Nephew, William A. Olson, was married and living next door with his young family. Mary Ann McMurdie lived in the Hansen household until her death in 1941. Soren H. Hansen retired from farming probably in 1945 when he sold the farm to Warren and Wanda Stanley. He died on October 22, 1949, at the home of this daughter in Richmond at the age of 83 and returned to Paradise for burial.

Warren and Wanda Stanley held the property only a short time before selling it to Lisle Stanley Fuller and Sarah [Sadie] Fuller. Lisle and Sadie Fuller sold it to George H. and Emma E. Bell in 1948. George and Emma Bell were farmers and longtime residents. The deed eventually passed to Donald W. and Kaye J. Bell in 1973. The title went to Dennis Boyd Bell in 1984. Dennis Bell sold it to the current owner, Nolan Kurt Anhder, in 1988. During this period, the parcel with the house and outbuildings became smaller with a large portion of the land going to the Utah State University for one of their experimental agricultural farms. Despite the loss of the associated farmland, the Hattie Merrill Morrison Farmstead is a multi-resource property with a long historic association with the development of Richmond and contributes to the historic resources of Richmond.

Architecture:

The Hattie Merrill Morrison Farmstead includes an architecturally significant example of a Victorian Eclectic-style house as executed by a skilled local builder. The Victorian Eclectic style was popular in Utah from 1885 to 1910. The Victorian Eclectic style is a catchall term for buildings that combine a variety of elements from different popular styles. An expression of the style was also found in the variety of colors and textures used on the exterior of a Victorian Eclectic residence. The characteristics of the style found in the Morrison house include an asymmetrical façade and irregular floor plan, segmental windows, leaded glass, and shingled gable trim. The architectural detail of the house includes usual brickwork in the "woven" window hoods. The house type is a compact version of the central-block-with-projecting-bays house type popular in the late Victorian period. The central block residence includes a main core with one or more projecting bays and the asymmetrical footprint was well suited to the characteristically varied style of the Victorian Eclectic period.

United States Department of the Interior
National Park Service

National Register of Historic Places Continuation Sheet

Section No. 8 Page 4

Morrison, Hattie Merrill, Farmstead, Richmond, Cache County, UT

The builder is unknown, but a possibility may have been a prolific Richmond builder named James Lewis Burnham. Burnham was a brick mason most of his life. He designed and built numerous buildings in Richmond, most notably, the two-story red brick schoolhouse, which served the community between 1890 and its demolition in 1934. There is some similarity between the Morrison house and others built by Burnham.

The barn and granary also have unique characteristics of construction (see Section 7) and are significant outbuildings in the community.

National Register of Historic Places Continuation Sheet

Section No. 9 Page 1

Morrison, Hattie Merrill, Farmstead, Richmond, Cache County, UT

Bibliography

Architectural Survey Data for Richmond, Utah. Report produced by the Utah State Historic Preservation Office, 2003.

Bair, Amos W. *History of Richmond, Utah.* Published by the Richmond Bicentennial Committee and the Richmond City Council, 1976.

Broschinsky, Korral. *Historic and Architectural Resources of Richmond, Utah: 1859-1954.* National Register of Historic Places Multiple Property Documentation Form, 2003. Available at the Utah State Historic Preservation Office.

[Cache County Tax Cards and Photographs]. Available at the Cache County Assessor's Office.

[Cache Title Abstracts and Plat Maps]. Available at the Cache County Recorder's Office.

Carter, Thomas and Peter Goss. *Utah's Historic Architecture: A Guide, 1847-1940.* Salt Lake City, Utah: University of Utah Press, 1988.

Daughters of Utah Pioneers (D.U.P.) Relic Museum, Richmond, Utah. Miscellaneous files.

[Family Search Database.] Maintained online by the Church of Jesus Christ of Latter-day Saints.

Merrill, Melvin. Clarence, ed. *Utah pioneer and apostle; Marriner Wood Merrill and his family; material obtained from the autobiography, diaries, and notes of Marriner Wood Merrill and from record data and textual contributions by members of the family.* Salt Lake City, Utah: Deseret News, 1937.

Peterson, F. Ross. *A History of Cache County.* Utah Centennial County History Series, Utah State Historical Society. Salt Lake City, Utah: Utah State Historical Society, 1996.

Richmond Cemetery Records.

Salt Lake Tribune.

United States Census Enumerations, *Richmond, Utah, 1880 - 1930.*

Utah History Encyclopedia, Allan Kent Powell, ed. Salt Lake City, Utah: University of Utah Press, 1994.

Utah State Gazetteers, 1890 – 1937. Published by R.L. Polk & Co. Available at the Utah State Historical Society and the Marriott Library, University of Utah.

United States Department of the Interior
National Park Service

National Register of Historic Places Continuation Sheet

Section No. 9 Page 2

Morrison, Hattie Merrill, Farmstead, Richmond, Cache County, UT

Utah State Historic Preservation Office. *Reconnaissance Level Survey, Richmond, Utah, October 2000.*
Unpublished TMs, 2000. Prepared by Tania Tully, Cory Jensen for the Richmond Historic Preservation
Committee/CLG. Available at the Utah State Historic Preservation Office.

Morrison, Hattie Merrill, Farmstead
Name of Property

Richmond, Cache County, Utah
City, County and State

10. Geographical Data

Acreage of Property 2.04 acres

UTM References

(Place additional boundaries of the property on a continuation sheet.)

1 1/2 4/3/2/8/6/0 4/6/3/8/4/0/0
Zone Easting Northing

2 / / / / / / / / / / /
Zone Easting Northing

3 / / / / / / / / / / /
Zone Easting Northing

4 / / / / / / / / / / /
Zone Easting Northing

Verbal Boundary Description

(Describe the boundaries of the property.)

See continuation sheet for Section No. 10.

Property Tax No. 08 - 002 - 0014

Boundary Justification

(Explain why the boundaries were selected.)

The current parcel is a small portion of the original farmstead, but the only part with extant historic buildings.

See continuation sheet(s) for Section No. 10

11. Form Prepared By

name/title Korral Broschinsky, Preservation Documentation Resource

organization prepared for the Richmond Historic Preservation Commission date July 15, 2004

street & number P.O. Box 58766 telephone (801) 581-1497

city or town Salt Lake City state UT zip code 84158

Additional Documentation

Submit the following items with the completed form:

Continuation Sheets

Maps A **USGS map** (7.5 or 15 minute series) indicating the property's location.

A **Sketch map** for historic districts and properties having large acreage or numerous resources.

Photographs: Representative **black and white photographs** of the property.

Additional items: (Check with the SHPO or FPO for any additional items)

Property Owner

name/title Nolan Kurt Anhder

street & number 1367 South State Street telephone (435) 258-5237

city or town Richmond state UT zip code 84333

Paperwork Reduction Act Statement: This information is being collected for applications to the National Register of Historic Places to nominate properties for listing or determine eligibility for listing, to list properties, and to amend existing listings. Response to this request is required to obtain a benefit in accordance with the National Historic Preservation Act, as amended (16 U.S.C. 470 *et seq.*).

Estimated Burden Statement: Public reporting burden for this form is estimated to average 18.1 hours per response including time for reviewing instructions, gathering and maintaining data, and completing and reviewing the form. Direct comments regarding this burden estimate or any aspect of this form to the Chief, Administrative Services Division, National Park Service, P.O. Box 37127, Washington, DC 20013-7127; and the Office of Management and Budget, Paperwork Reductions Projects (1024-0018), Washington, DC 20503.

National Register of Historic Places Continuation Sheet

Section No. 10 Page 1

Morrison, Hattie Merrill, Farmstead, Richmond, Cache County, UT

Verbal Boundary Description (continued)

BEG 93 RDS E OF W/4 COR OF SEC 2 T 13N R 1E & TH N 78 FT TH E 276 FT TH S 78 FT TH W 276 FT TO BEG.

ALSO BEG 90 RDS 1.5 FT E OF NW COR OF SW/4 OF SEC 2 & TH E 16 RDS 11 FT TH SW \square LY 17 RDS 4.5 FT TH W 2 RDS 12 FT TH N 1 RD TH NW \square LY 4 RDS 8 FT TO E LN OF ST TH N ALG ST 12 RDS TO BEG LESS STATE ROADS.

ALSO THE E 339.83 FT OF FOLLOWING: BEG 23 RDS E OF NW COR SW/4 SEC 2 & TH E 63 RDS 7.5 FT TH S 4 RDS 11 FT TH W \square LY ALG N LN OF ST 63 RDS 15 FT TH NW \square LY ALG CO ROAD 8.67 RDS TO BEG.

CONT 2.04 AC IN ALL.

National Register of Historic Places Continuation Sheet

Section No. PHOTOS Page 1

Morrison, Hattie Merrill, Farmstead, Richmond, Cache County, UT

Common Label Information:

1. Morrison, Hattie Merrill, House
2. Richmond, Cache County, Utah
3. Photographer: Korral Broschinsky
4. Date: 2004
5. Negatives on file at Utah SHPO.

Archival:

Photo No. 1

6. West and south elevations of house. Camera facing northeast.

Photo No. 2

6. South elevation of house and enclosed porch. Camera facing north.

Supplemental:

Photo No. 3

6. West and north elevations of house. Camera facing southeast.

Photo No. 4

6. East elevation of house. Camera facing southwest.

Photo No. 5

6. North and east elevations of barn and silo. Camera facing southwest.

Photo No. 6

6. West and north elevations of granary. Camera facing southeast.

Photo No. 7

6. View of site with bend in road. Camera facing east.

HATTIE M. MORRISON FARMSTEAD
1367 SOUTH STATE STREET
RICHMOND, CACHE CO., UT

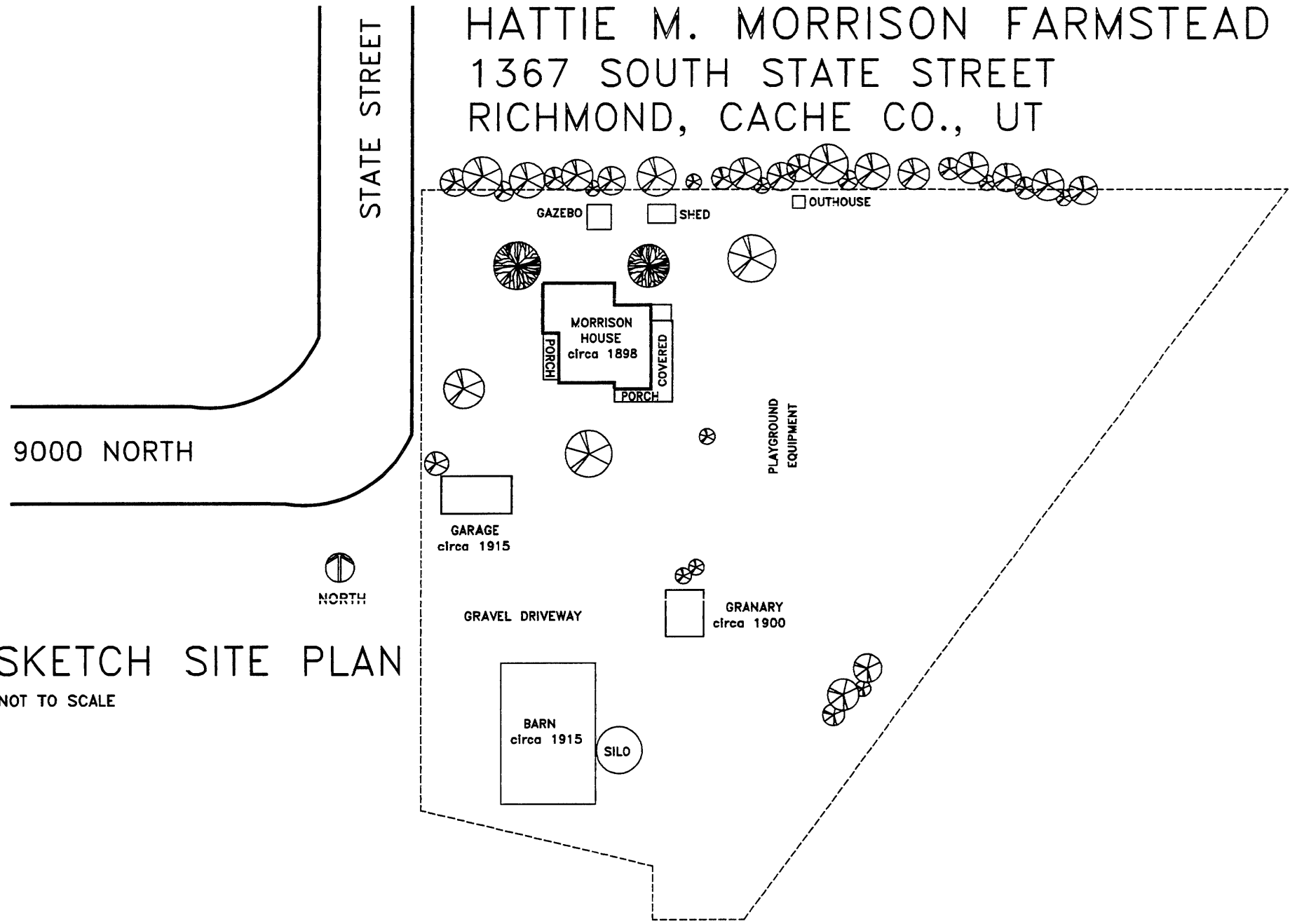

SKETCH SITE PLAN
NOT TO SCALE

UTAH STATE UNIVERSITY FARMLAND