

PH0005363

NATIONAL REGISTER OF HISTORIC PLACES
INVENTORY - NOMINATION FORM

(Type all entries - complete applicable sections)

STATE: Maryland	
COUNTY: Calvert	
FOR NPS USE ONLY	
ENTRY NUMBER JUL 2 1973	DATE

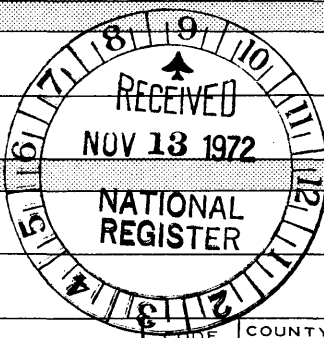

1. NAME

COMMON:
Willow Glenn

AND/OR HISTORIC:
Weems House

2. LOCATION

STREET AND NUMBER: *off Md. 507*
Barstow Road

CITY OR TOWN:
Barstow

STATE: Maryland CODE: 24 COUNTY: Calvert CODE: 009

3. CLASSIFICATION

CATEGORY (Check One)	OWNERSHIP	STATUS	ACCESSIBLE TO THE PUBLIC
<input type="checkbox"/> District <input checked="" type="checkbox"/> Building <input type="checkbox"/> Site <input type="checkbox"/> Structure <input type="checkbox"/> Object	<input type="checkbox"/> Public <input checked="" type="checkbox"/> Private <input type="checkbox"/> Both	<input checked="" type="checkbox"/> Occupied <input type="checkbox"/> Unoccupied <input type="checkbox"/> Preservation work in progress	Yes: <input type="checkbox"/> Restricted <input type="checkbox"/> Unrestricted <input checked="" type="checkbox"/> No
PRESENT USE (Check One or More as Appropriate)			
<input type="checkbox"/> Agricultural <input type="checkbox"/> Commercial <input type="checkbox"/> Educational <input type="checkbox"/> Entertainment	<input type="checkbox"/> Government <input type="checkbox"/> Industrial <input type="checkbox"/> Military <input type="checkbox"/> Museum	<input type="checkbox"/> Park <input checked="" type="checkbox"/> Private Residence <input type="checkbox"/> Religious <input type="checkbox"/> Scientific	<input type="checkbox"/> Transportation <input type="checkbox"/> Other (Specify) _____ _____ _____

4. OWNER OF PROPERTY

OWNER'S NAME:
Thomas I. Weems

STREET AND NUMBER:
Barstow Road

CITY OR TOWN: Barstow STATE: Maryland CODE: 24

5. LOCATION OF LEGAL DESCRIPTION

COURTHOUSE, REGISTRY OF DEEDS, ETC.:
Calvert County Courthouse

STREET AND NUMBER:

CITY OR TOWN: Prince Frederick STATE: Maryland CODE: 24

6. REPRESENTATION IN EXISTING SURVEYS

TITLE OF SURVEY:
Maryland Register of Historic Sites and Landmarks

DATE OF SURVEY: 1970 Federal State County Local

DEPOSITORY FOR SURVEY RECORDS:
Maryland Historical Trust

STREET AND NUMBER:
2525 Riva Road

CITY OR TOWN: Annapolis STATE: Maryland CODE: 24

SEE INSTRUCTIONS

STATE: Maryland
COUNTY: Calvert
ENTRY NUMBER: JUL 2 1973
FOR NPS USE ONLY
DATE

7. DESCRIPTION

CONDITION	(Check One)					
	<input type="checkbox"/> Excellent	<input checked="" type="checkbox"/> Good	<input type="checkbox"/> Fair	<input type="checkbox"/> Deteriorated	<input type="checkbox"/> Ruins	
	(Check One)			(Check One)		
	<input type="checkbox"/> Altered	<input checked="" type="checkbox"/> Unaltered		<input type="checkbox"/> Moved	<input checked="" type="checkbox"/> Original Site	

DESCRIBE THE PRESENT AND ORIGINAL (if known) PHYSICAL APPEARANCE

Willow Glenn is located on the southeast corner of the intersection of Barstow Road and Stoakley Road, about two miles northwest of Barstow, Maryland.

An impressive, Georgian structure of grand proportions, Willow Glenn is constructed entirely of Flemish bond with random glazed headers. It is five bays long with a centrally placed door. Although the house is very deep, only two small windows exist per floor on each gable end. The windows on the principal facade have six-over-six sashes and flat brick lintels. The basement windows have segmental arches.

A simple water table of protruding square brick encircles the house. A three-string belt course separates the first and second stories of the house but stops short of each corner.

A 19th century cornice has replaced the original roof trim. The second floor ceilings were raised and the pitch of the roof changed in the early nineteenth century.

On the interior, all the fireplaces have simple moldings and covered-arch openings. Three of the fireplaces on the first floor are angled in corners while the fourth is flat against the wall. Huge stress arches in the basement, eight feet high by four feet thick, support the fireplaces.



SEE INSTRUCTIONS

8. SIGNIFICANCE

PERIOD (Check One or More as Appropriate)

<input type="checkbox"/> Pre-Columbian	<input type="checkbox"/> 16th Century	<input checked="" type="checkbox"/> 18th Century	<input type="checkbox"/> 20th Century
<input type="checkbox"/> 15th Century	<input type="checkbox"/> 17th Century	<input type="checkbox"/> 19th Century	

SPECIFIC DATE(S) (If Applicable and Known)

AREAS OF SIGNIFICANCE (Check One or More as Appropriate)

<input type="checkbox"/> Aboriginal	<input type="checkbox"/> Education	<input type="checkbox"/> Political	<input type="checkbox"/> Urban Planning
<input type="checkbox"/> Prehistoric	<input type="checkbox"/> Engineering	<input type="checkbox"/> Religion/Philosophy	<input type="checkbox"/> Other (Specify)
<input type="checkbox"/> Historic	<input type="checkbox"/> Industry	<input type="checkbox"/> Science	
<input checked="" type="checkbox"/> Agriculture	<input type="checkbox"/> Invention	<input type="checkbox"/> Sculpture	
<input checked="" type="checkbox"/> Architecture	<input type="checkbox"/> Landscape Architecture	<input type="checkbox"/> Social/Humanitarian	
<input type="checkbox"/> Art	<input type="checkbox"/> Literature	<input type="checkbox"/> Theater	
<input type="checkbox"/> Commerce	<input type="checkbox"/> Military	<input type="checkbox"/> Transportation	
<input type="checkbox"/> Communications	<input type="checkbox"/> Music		
<input type="checkbox"/> Conservation			

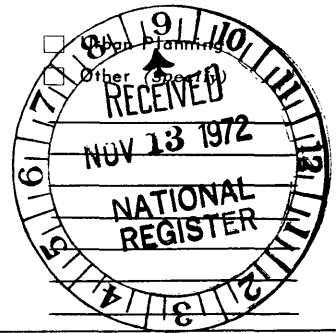

STATEMENT OF SIGNIFICANCE

Willow Glenn is architecturally important as an example of a Georgian-style structure of substantial proportions. It typifies the kind of dwelling erected by Maryland's wealthiest tobacco planters of the colonial period.¹

In the late nineteenth century George Washington Henry Jones lived at Willow Glenn. He achieved prominence in the Barstow community as a physician and politician, specifically as a state legislator and a county treasurer.² Fragmentary evidence indicates that he inherited the property, then called Ballard Farm, from Washington Jones.³ The absence of any Calvert County records prior to the 1880's makes it impossible to determine beyond question the documentary history of the property. However, other state records indicate that the farm may have been named after Levin Ballard who bought property in the area in 1832 from the estate of Tubman Long.⁴ A map made in the 1820's indicates that a Long lived in a house at the location of Willow Glenn.⁵ Tubman Long married a daughter of James Weems, Jr., who, in the eighteenth century, may have owned the property on which Willow Glenn is located.

¹Aubrey Land, "The Planters of Colonial Maryland," Maryland Historical Magazine, Vol. 67 (summer 1972), 109-128.

²Eugene Cordell, Medical Annals of Maryland 1799-1899, Baltimore: 1903, 460-461.

³Calvert County Deeds, Liber SS #1 folio 450.

⁴Chancery Papers #6501, Hall of Records, Annapolis, Maryland

⁵Major J.J. Albert and Major J. Kearney, Map of Patuxent and St. Mary's Rivers, Maryland, Survey 1824, for the Secretary of War, Washington: 1837.

SEE INSTRUCTIONS

9. MAJOR BIBLIOGRAPHICAL REFERENCES

PRIMARY SOURCES:

Hall of Records, Annapolis, Maryland

Albert, Maj. J.J. and Maj. J. Kearney. Map of Patuxent and St. Mary's Rivers Maryland, Survey 1824, for the Secretary of War. Washington: Bureau of Topographical Engineering, 1837. Assessment of 1783.

10. GEOGRAPHICAL DATA (See Continuation Sheet)

LATITUDE AND LONGITUDE COORDINATES DEFINING A RECTANGLE LOCATING THE PROPERTY			O R	LATITUDE AND LONGITUDE COORDINATES DEFINING THE CENTER POINT OF A PROPERTY OF LESS THAN TEN ACRES		
CORNER	LATITUDE	LONGITUDE		LATITUDE	LONGITUDE	
	Degrees Minutes Seconds	Degrees Minutes Seconds		Degrees Minutes Seconds	Degrees Minutes Seconds	
NW	38° 32' 58"	76° 38' 20"		0	0	
NE	38° 32' 58"	76° 37' 49"				
SE	38° 32' 30"	76° 37' 50"				
SW	38° 32' 30"	76° 38' 20"				

APPROXIMATE ACREAGE OF NOMINATED PROPERTY: 187.5 acres

LIST ALL STATES AND COUNTIES FOR PROPERTIES OVERLAPPING STATE OR COUNTY BOUNDARIES

STATE:	CODE	COUNTY	CODE
STATE:	CODE	COUNTY:	CODE
STATE:	CODE	COUNTY:	CODE
STATE:	CODE	COUNTY:	CODE



SEE INSTRUCTIONS

11. FORM PREPARED BY

NAME AND TITLE:
Nancy Miller and Paul Brinkman

ORGANIZATION: Maryland Historical Trust DATE: August 17, 1972

STREET AND NUMBER:
2525 Riva Road

CITY OR TOWN: Annapolis STATE: Maryland 21401 CODE: 24

12. STATE LIAISON OFFICER CERTIFICATION

NATIONAL REGISTER VERIFICATION

As the designated State Liaison Officer for the National Historic Preservation Act of 1966 (Public Law 89-665), I hereby nominate this property for inclusion in the National Register and certify that it has been evaluated according to the criteria and procedures set forth by the National Park Service. The recommended level of significance of this nomination is:

National State Local

Name Orlando Ridout IV
Orlando Ridout IV *act.*

Title State Liaison Officer for the State of Maryland

Date Aug. 17, 1972

I hereby certify that this property is included in the National Register.

Robert M. Utley
Chief, Office of Archeology and Historic Preservation

Date 7/2/73

ATTEST: W.S. Mumby
Keeper of The National Register

Date 6 19 73

Form 10-300a
(July 1969)UNITED STATES DEPARTMENT OF THE INTERIOR
NATIONAL PARK SERVICENATIONAL REGISTER OF HISTORIC PLACES
INVENTORY - NOMINATION FORM

(Continuation Sheet)

STATE Maryland	
COUNTY Calvert	
FOR NPS USE ONLY	
ENTRY NUMBER JUL 2 1973	DATE

(Number all entries)

#9. MAJOR BIBLIOGRAPHICAL REFERENCES continued

Calvert County Land Records.

Chancery Papers and Records.

Debt Books.

Maryland Directory. Baltimore: J. Frank Lewis, 1880.

Patents.

Rent Records.

The State Gazette and Merchants' and Farmers' Directory for Maryland and the District of Columbia. Baltimore: Sudler, Drysdale and Purnell, 1871.

SECONDARY SOURCES:

Cordell, Eugene. Medical Annals of Maryland. 1799-1899. Baltimore: Williams and Wilkins, 1903.Stien, Charles Francis. History of Calvert County. N.D.: The Author, 1960.

22
BENEDICT QUADRANGLE
USGS 7.5 minute map
scale: 1: 24 000
1953

CREEK

HUNTING

St. Wrens
32°

(PRINCE FATE DE WISSE)

lat. 32° 30' 28"
long. 76° 38' 20"

lat. 32° 30' 28"
long. 76° 37' 49"

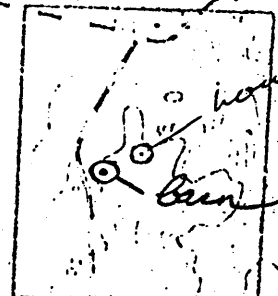

WILLOW GLENN.

Ramsey

lat. 32° 30' 00"
long. 76° 38' 20"

lat. 32° 30' 00"
long. 76° 37' 50"
32'30"

Duloren

Branch

Buena Vista



Cass

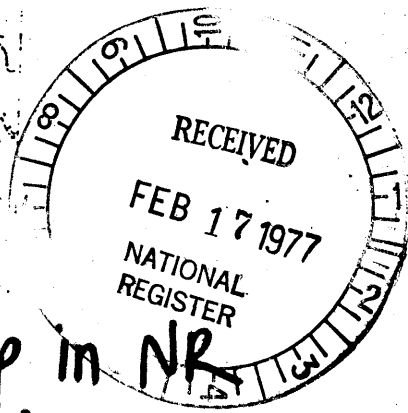

Copy of map in NR
office showing
location of barn.

UNITED STATES DEPARTMENT OF THE INTERIOR
NATIONAL PARK SERVICE

**NATIONAL REGISTER OF HISTORIC PLACES
INVENTORY -- NOMINATION FORM**

FOR NPS USE ONLY

RECEIVED FEB 17 1977

DATE ENTERED

CONTINUATION SHEET

ITEM NUMBER

PAGE

ADDENDUM TO "WILLOW GLEN"

The outbuildings at Willow Glen form a complex which along with the main house documents plantation life in both the 18th and 19th centuries. The most significant of these outbuildings is the tobacco barn located southwest of the house next to Barstow Road.

In his 1800 Essay on the Culture and Commerce of Tobacco, William Tatham stated that among the various types of tobacco houses he observed in Virginia, "the most ordinary kinds consist of two square pens built out of logs." The building which Tatham goes on to describe is nearly a perfect description of the structure at Willow Glen.

The two pens there are made out of notched logs and placed on a line with each other at the opposite extremes of an oblong square with a space large enough to accommodate a wagon left inbetween. The two structures share a common roof (as if evidenced by the plates) and when seen from within the modern structure which now houses them, appear quite like the drawing provided by Tatham.

The pens at Willow Glen are twenty feet square which is one of two sizes mentioned by Tatham. Also mentioned in the Essay are the doors cut into each of the sides which form the passageway and "sticks of tobacco" hung in four foot tiers. The only noticeable difference between Willow Glen and the 1800 description is that the center passageway, which appears to be narrower than the width of a single pen in the Tatham drawing, is identical to the width of a single pen at Willow Glen. The length of the entire structure then is sixty feet. (See attached plan.)

A plan providing for square pens made of logs separated by an open passageway, but having a common roof apparently constitutes somewhat of an American tradition. It is pointed out by H. Morrison, T. Waterman and others that in the early 18th Century, the "dog-run" was a common plan for log cabins in Virginia and North Carolina. Minus the chimneys, windows and chinking necessary for a house, one can see that the two plans are identical. The tobacco barn at Willow Glen thus shows that a common plan for log construction sufficed for both house and barn.

UNITED STATES DEPARTMENT OF THE INTERIOR
NATIONAL PARK SERVICE

**NATIONAL REGISTER OF HISTORIC PLACES
INVENTORY -- NOMINATION FORM**

FOR NPS USE ONLY

RECEIVED

FEB 17 1977

DATE ENTERED

CONTINUATION SHEET

ITEM NUMBER

PAGE

ADDENDUM TO "WILLOW GLEN", continued

Assuming that Tatham's observations in Virginia in the 1790's are applicable to Southern Maryland (and there is little reason not to since both were tidewater tobacco cultures which have exhibited many similarities in other areas of architecture), we may see the double-pen tobacco house at Willow Glen as one of the very few remaining examples of what was once a common type. This significance is further reinforced when one considers the importance of such a structure to the tobacco process which was in itself a determining factor in 18th century tidewater society.

Bibliography

Morrison, H. Early American Architecture, N.Y., 1952

Tatham, W. An Historical and Practical Essay on the Culture and Commerce of Tobacco, London, 1800.

Sloan, E. Early American Barns.

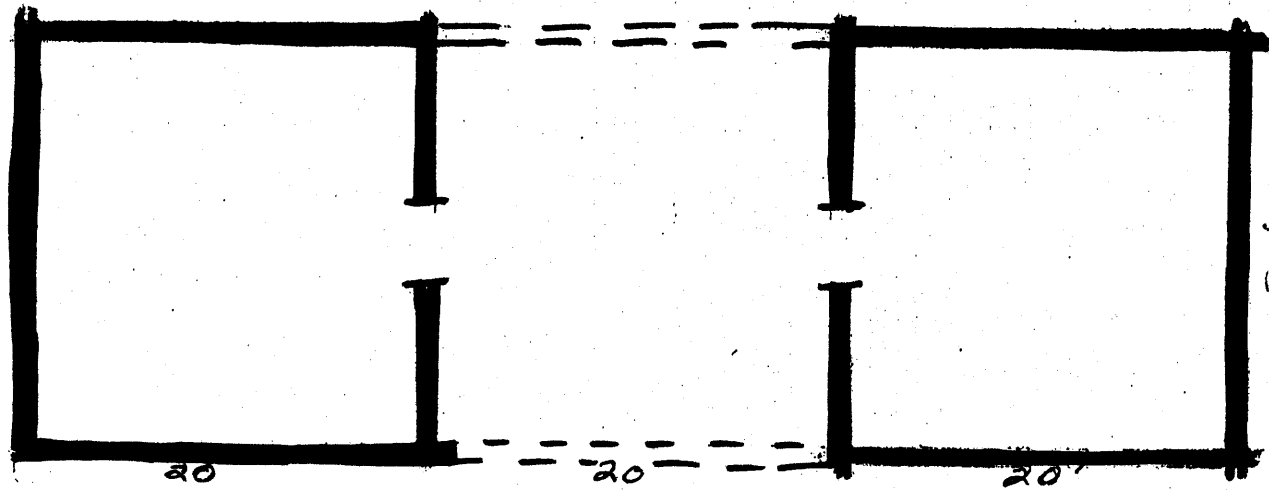

WILLOW GLEN, Calvert County, Maryland

Tobacco House

FEB 17 1977

sketch, 9/23/76

Wayne Nield
Broomes Island, MD

sills and plates were altered but appear
to have been continuous in original