

SEE ATTACHMENTS FOR PHOTOGRAPHS

(PHOTOGRAPH)

STANDING STRUCTURES SURVEY

Site Number _____

PARISH Lafayette

MUNICIPALITY Broussard

USGS QUAD _____

Township _____ Range _____ Section _____

TYPE OF PROPERTY district (residential and commercial)

NAME (common) Main St. Historic District

NAME (historic) N/A

ADDRESS N/A 203-302 E. Main St.

DATE OF CONSTRUCTION c.1890-c.1910

II. 1. Condition good

2. Style see attached inventory sheets

3. Floor Plan N/A

4. Building Material see attached inventory sheets

III. Physical description of property and historic significance

The Main Street Historic District consists of five turn-of-the-century structures set in a contiguous grouping at the intersection of Main and Washington Streets. Three are Queen Anne Revival residences, one is a late Italianate commercial building, and one is a commercial vernacular store. (See the attached inventory sheets.)

The district is immediately encompassed by non-contributing elements. For example, north of the district are two modern convenience stores and a parking lot. A railroad siding and some less than fifty year old storage buildings are located to the south. To the east and west are residential neighborhoods with numerous less than fifty year old houses. In short, to have extended the boundaries in any direction to pick up any of the resources being submitted separately would have meant taking in numerous intrusions, thereby creating a fragmented entity without a convincing historic character.

The buildings are sufficiently concentrated that this portion of Main Street (near the intersection with Washington St.) has an overwhelming turn-of-the-century character. In fact, it is the only turn-of-the-century streetscape remaining in Broussard. But beyond this, it is easily the most impressive turn-of-the-century streetscape in Lafayette Parish. This is because of the district's two landmark anchor buildings (E and D, see map).

CONTINUED ON REVERSE SIDE

IV. Recorded by see nomination form--

Date _____ Item 7

For _____

V. Sources consulted See nomination

form--Item 9

Main Street District (continued)

Of the approximately 111 late nineteenth/early twentieth century residences in the parish these two have undoubtedly the most elaborate massing and detailing. However, this is not their only contribution to the architectural importance of the streetscape. The State Historic Preservation Office is aware of only six Queen Anne Revival houses in the parish which have turrets. Four of these have the additional pretention of bell cast cupolas. The Main Street District has two of them side by side.

NB: The attached inventory forms, with the exception of the one for Building C, were prepared by the Lafayette Regional Planning Commission.

BROUSSARD MULTIPLE RESOURCE AREA

Lafayette Parish, LA

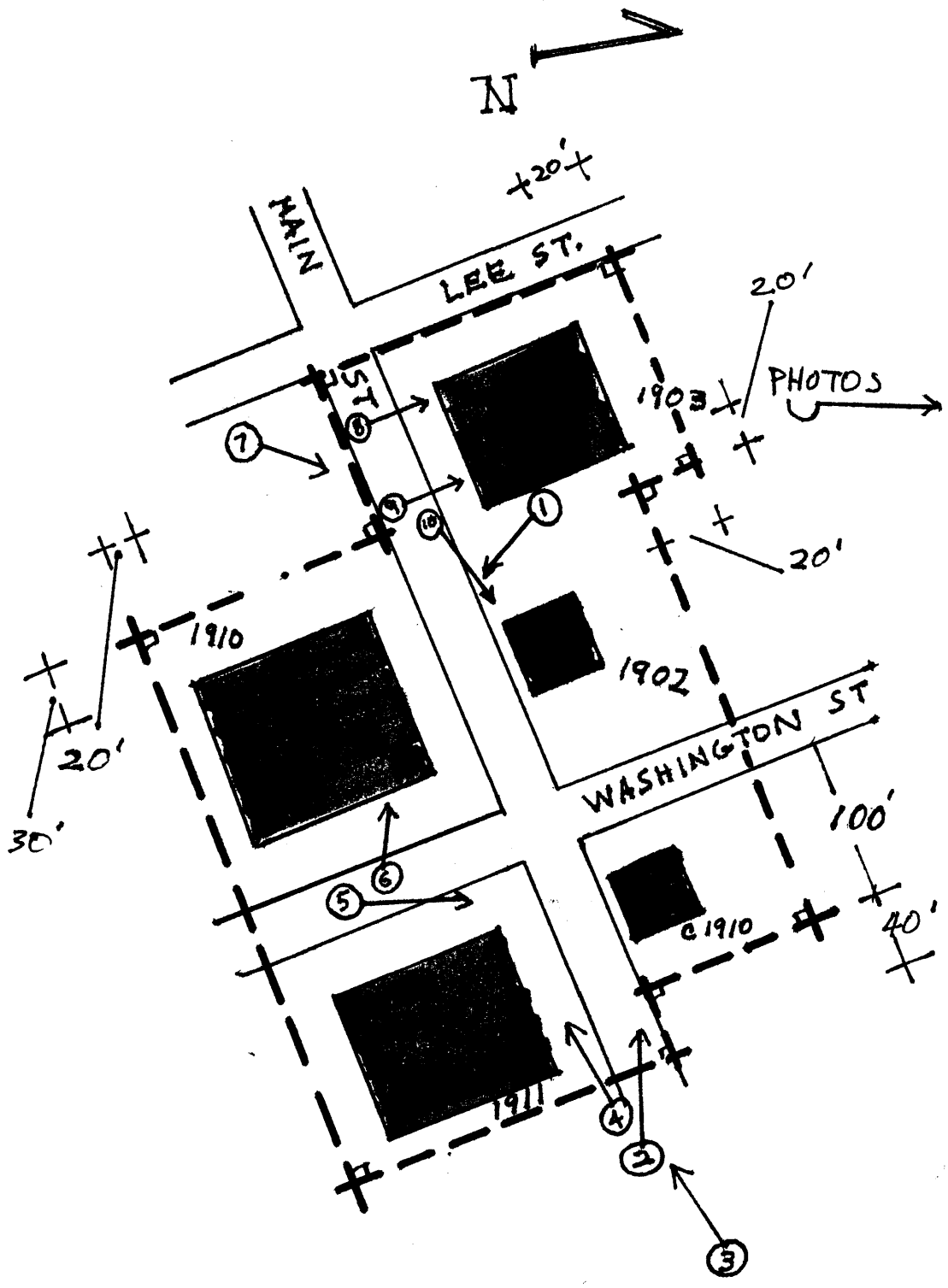

MAIN ST. HISTORIC DISTRICT
BROUSSARD (NOT TO SCALE)

NB ALL BOUNDARIES PARALLEL TO THE ADJACENT STREETS

BUILDING A

NAME: Andre Billeaud House

LOCATION: 203 East Main Street, Broussard, La.

OWNER OF PROPERTY: Mr. and Mrs. William McKnight

DESCRIPTION: The main roof structure of the house is gable running east and west with gabled dormer centered over entry with a matching one on the rear side. The octagonal shaped parlor to the left as you enter has a large gabled roof with "fish scale" shingle siding at pediments. Gables of east and west ends of main portion of home match, with the east side sheltering a sun porch and the west (left) side, a two story octagonal shaped wing. Interior features include a large entrance foyer, 14 foot ceilings, 12' double hung windows, operable transoms above all doors, large double raised panel sliding doors between parlor and dining room.

SIGNIFICANCE/HISTORY: This home was constructed by Andre' Billeaud in 1903. Mr. Billeaud lived in the home with his family until his death. Mrs. Billeaud lived in this home until her death in 1958. After her death, the children sold the home to Mr. Walter Broussard. The Broussard's lived in the home until 1965. At this time, it was purchased by Mr. & Mrs. William McKnight. Shortly after the purchase, Mrs. McKnight, a renowned artist, converted a portion of the residence into an art studio and classroom. The studio is known as one of the finest between Houston and New Orleans.

REFERENCES/SOURCES:

- 1) Mrs. William McKnight

BUILDING B

NAME: Bernard Building

LOCATION: 211 East Main Street, Broussard, La.

OWNER OF PROPERTY: L. D. Bernard

DESCRIPTION: Typical commercial building at the turn of the century, this structure was altered to accommodate its use as a service station in later years. The porch is free-span supported by tension rods and turn brackets. Large glass windows and transom for display and interior light are note worthy. The building is wood frame with the exterior front fake facade covered with embossed galvanized metal in the shape of stone masonry. There is an open gallery in the main store area.

SIGNIFICANCE/HISTORY: This structure was built by Mr. Guilliam Bernard in 1902 and operated as a grocery store. The building was purchased in the 1920's by Denis Bernard who converted and altered the structure for use as a gas service station and repair shop. The business and building is now owned by Mr. L. D. Bernard, a great grandson of Valsin Broussard, the founder of the Town of Broussard.

REFERENCES/SOURCES:

- 1) Mr. L. D. Bernard

Building C (shown in foreground in above photograph)

Name: Bobby's Lounge

Location: East Main Street, Broussard, LA

Owner of Property: Charles A. Girouard

The above c.1910 structure was not noted in the 1976-77 survey prepared by the Lafayette Regional Planning Commission. It is a relatively simple frame commercial building with a stepped parapet front. It retains its original galleries, although some of the ventilators have been filled in. In about 1940 a small brick side wing was added. Although it is owned in common with the original frame commercial building, today it houses a separate business.

BUILDING D

NAME: Paul Billeaud Home

LOCATION: 302 East Main Street, Broussard, La.

OWNER OF PROPERTY: Mr. and Mrs. Sam Goodwin

DESCRIPTION: The Paul Billeaud home is the largest and among the most flamboyant of all Victorian structures in Lafayette Parish. Asymmetry and irregular mass characterize the house as late Victorian with elements of several architectural styles including Queen Anne, Gothic Revival, Italianate, Greek Revival and even Palladian. The contrasting shapes, irregular floor plan, complex geometry, galleries, bracketed overhangs, bay windows, pseudo-half-timbered gables, balconies, leaded glass, dormers, the domed octagonal turret, varying roof planes, the mixed use of Doric and Ionic columns, and elaborate woodwork combine to make the structure both stately and whimsical.

SIGNIFICANCE/HISTORY: Paul Billeaud, one of Martial Billeaud's sons, built the house in 1911. He was married to Laurence Lacaze, and had three children: Lacaze, Emma and Mrs. Paul Bechet. In 1940 the structure was purchased by J. J. Hooper who was associated with an oil company. In 1955, the present owners, Mr. and Mrs. Sam Goodwin, purchased the house from Mrs. Blanche Hooper.

REFERENCES/SOURCES:

- (1) George Billeaud, Jr.
- (2) Clerk of Court Office
- (3) Mrs. Paul Bechet

BUILDING E

NAME: Hub City Bank

LOCATION: 208 East Main Street, Broussard, La.

OWNER OF PROPERTY: Hub City Bank

DESCRIPTION: A fine example of Late Victorian fantasy, the Old Comeaux Home is considered by some to be the most successful representative of the era in Lafayette Parish. The elaborate woodwork, contrasting geometric shapes, and irregular roof planes combine in ostentatious display. A wide gallery wraps three-quarters of the way around the house and is supported by pairs of fluted Ionic columns resting on paneled rectangular piers. Similar columns support the balcony directly over the main entrance. Clusters of three columns are located at either end of the front gallery. The elaborately turned spindles of the railing continue to the side and rear portions of the gallery which are supported by simple Doric columns.

The large octagonal bay to the left of the entrance is decorated with corner brackets, stained glass, and paneled exterior walls. The gable-end over the bay has scalloped shingles ("fishscales") and a triple stained glass window with a central arch reminiscent of a Palladian window. The entrance and balcony pediments are finished in the "sunburst" motif. The octagonal bay in the extreme

left of the photograph is entirely paneled and contains an oval cameo window. A domed octagonal tower is located on the right side of the structure. Note the large window panes in the tower and other areas of the house.

The front entrance is a heavily leaded glass door with side lights and a segmented arch transom. The doors upstairs are beveled glass with elaborate carvings. There is a magnificent staircase in the entry hall and another leading from the kitchen to the servants quarters upstairs. One can still see the tubing for the ceiling gas lights and crystal chandeliers.

SIGNIFICANCE/HISTORY: This structure was built by Mrs. Alphonse Comeaux, nee Eulalie Billeaud, a daughter of Martial Billeaud in 1910. Next to the site of the old cistern to the rear of the house is an inscription in concrete which reads "Mrs. A. Comeaux, July 22, 1910". Hub City Bank bought the home from the St. Juliens, descendants of the original owners, in December, 1971. The former residence is now used as Hub City's Broussard branch bank.

This is an excellent example of adaptive re-use of an architecturally significant building. In today's economy, few families can afford to operate and maintain a residence of this type. Rather than being neglected or demolished, the old Comeaux residence stands as a proud reminder of the past and also performs a viable function for the present.

REFERENCES/SOURCES:

- (1) Hub City Bank, Inc.