

KENTUCKY HISTORIC RESOURCES
Individual Inventory Form

Resource # BN-239
Barren County

<p>1. Name of Resource: <u>Gullian Gerig's Mill (a.k.a. Killian Kreek's Mill)</u></p> <p>2. Original Owner: <u>Gullian Gerig a.k.a. Killian Kreek</u></p> <p>3. Other Names: <u>Killian Kreek's Mill</u></p> <p>4. Prehistoric Site <input type="checkbox"/> Building <input checked="" type="checkbox"/> Object Historic Site Structure Other</p> <p>5. Location: <u>End of Beaver Valley Road #1370 on south bank of Beaver Creek near Glasgow</u></p> <p>6. Owner's Name: <u>Martha Reneau</u> [P]</p> <p>7. Owner's Address: <u>Route #1, Box 285 Glasgow, Kentucky 42141</u></p> <p>8. Evaluation: [G]</p> <p>9. Recognition & Date: Nat.Landmark <input type="checkbox"/> Local Landmark <input type="checkbox"/> Nat.Register <input type="checkbox"/> HABS/HAER <input type="checkbox"/> Highway Marker <input type="checkbox"/> KY Inventory <input checked="" type="checkbox"/> KY Landmark Certificate <input type="checkbox"/></p> <p>10. N.R.Status & Date:</p> <p>11. N.R.Group: District Name: [] Mult.Resource Area: [] Thematic Name: <u>Early Stone Buildings</u> []</p> <p>12. Historical Theme: Primary: <u>Architecture</u> [030] Secondary: <u>Settlement</u> [140] Other: <u>Milling</u> [160]</p> <p>13. Statement of Significance: <u>While at one time there were hundreds of water-powered mills in Kentucky, almost all of them have succumbed to the ravages of periodic flooding. Although the wooden roof of this mill has been redesigned and rebuilt, the masonry work is testimony to the careful construction,</u></p> <p>14. History: <u>Mill built by Gullian Gerig (colloquialized to Killian Kreek); mill site approved by jury in 1798, when still part of Warren County; was second mill in Barren County. Kreek was a stone mason/builder; later moved to Indiana and built courthouse in Gibson County in 1814 (now demolished).</u> <u>An old Indian trail went past the mill loca- tion, later used as road. The mill was used as a distillery around 1900. Congregational baptisms were done in the mill pond in 1910.</u></p> <p>15. Source of historical information and/or contact person: <u>Research of owner in court records. Barren County Heritage, by Goode & Gardner.</u></p>	<p>16. Date: <u>Original Building 1798</u> [9] <u>Addition</u> []</p> <p>17. Style: <u>Industrial Vernacular</u> [80] []</p> <p>18. Architect/Builder: <u>Gullian Gerig</u></p> <p>19. No. of Stories: <u>now</u> [1.5]</p> <p>20. Original Floor Plan: [NA]</p> <p>21. Single Pile <input type="checkbox"/> Double Pile <input type="checkbox"/> N.A. <input checked="" type="checkbox"/></p> <p>22. Roof Form & Material: <u>Original</u> <u>Gable</u> Not Original</p> <p>23. Structural Material: <u>Stone</u> [S]</p> <p>24. Exterior Material: [S] <u>Stone</u> []</p> <p>25. Foundation Material: <u>Stone</u> [S]</p> <p>26. Major Alterations: <u>None</u> <u>Moved/Rebuilt roof</u> Other <u>Additions 2nd Fl. demolished by river flooding</u></p> <p>27. Special Features:</p> <p>28. Outbuildings: <u>None</u> [0]</p> <p>29. Original Function: <u>Mill</u> [10A]</p> <p>30. Present Use: <u>Vacant</u> [99V]</p> <p>31. Condition: [F]</p> <p>32. Endangered: Yes <input type="checkbox"/> No <input checked="" type="checkbox"/></p> <p>33. Attach Photos: <u>Roll: 3 Photo Nos 7-21 No. of Slides:</u></p> <p>34. Prepared by: <u>Carolyn Murray-Wooley</u></p> <p>35. Organization: <u>Kentucky Heritage Council</u></p> <p>36. Date: <u>Dec 1983</u></p> <p>37. New Survey <input type="checkbox"/> <u>Inventory</u> <input checked="" type="checkbox"/></p>
--	--

SEP 4 1987

KENTUCKY HISTORIC RESOURCES
Individual Inventory Form

Resource # BN-239

38. UTM Point of Primary Building: Quadrant: Glasgow	Zone 1 6	Easting 5 9 2 1 0 0	Northing 4 0 9 7 9 9 5	39. G.I.S. Mod. []	40. Coordi.Accuracy []
---	-------------	------------------------	---------------------------	---------------------	-------------------------

41. UTM Points of Boundary (for N. R. eligible sites only):

A. ---	D. ---
B. ---	E. ---
C. ---	F. ---

42. Total Acreage in Present Property: 43. Acreage included in proposed N.R. boundary: 6.88 acres

44. Site Plan (and boundary description and justification for N.R. sites):

See Attached

45. Description and House Plan:

Single-cell, about 30 x 30 feet, dry-stone mill, built on bank of Beaver Creek; ruins of mill dam below mill. Undershot wheel was under floor. Has hewn log framing, pegged window frames, batten "Dutch" doors with strap hinges (now stored in garage). Mill originally had second story of frame, with gambrel roof (see drawing, attached); and two-story frame shed-roofed section on each side. These deteriorated after severe flooding--present gable roof built to cover one story in 1957. Mill stones removed to yard of owner. Sawn-frame barn at site has hollow log trough. Stone is fossiliferous limestone, Ordovician.

13. Statement of Significance: (Continued)

technique of the builder, Gullian Gerig. It survives as representation of the once flourishing pioneer milling industry throughout the Commonwealth and is the only surviving example of an undershot wheel of the period in Kentucky. It is the only remaining early stone building in Barren County and illustrates dry-stone masonry technology in an early industrial building.

KENTUCKY HISTORIC RESOURCE INVENTORY SUPPLEMENT
BOUNDARY AND LOCATION INFORMATION

Historic Property Name William Strick's Mill Site # Bn 239
Multiple Resource/Thematic Nomination Title (a.k.a. William Strick's Mill)

U.T.M. Coordinates - List multiple UTM's if property is ten or more acres.

A. 16 592100 4097995 D. _____
B. _____ E. _____
C. _____ F. _____

Verbal Boundary Description Acreage 6.88 acres

Beginning where lane crosses the railroad, thence at 90° to R.R., N 300 ft to bank of Beaver Creek, thence W creek E 1000 ft to C, thence parallel to A-B, 200 ft to D at the R.R., thence W R.R. 1000 ft to the beginning, containing the stone mill and mill yard.

1 contrib bldg., 1 non contrib bldg.

Sketch of Site Plan (Showing outbuildings, structures, landscape features and the site boundary as described above.)

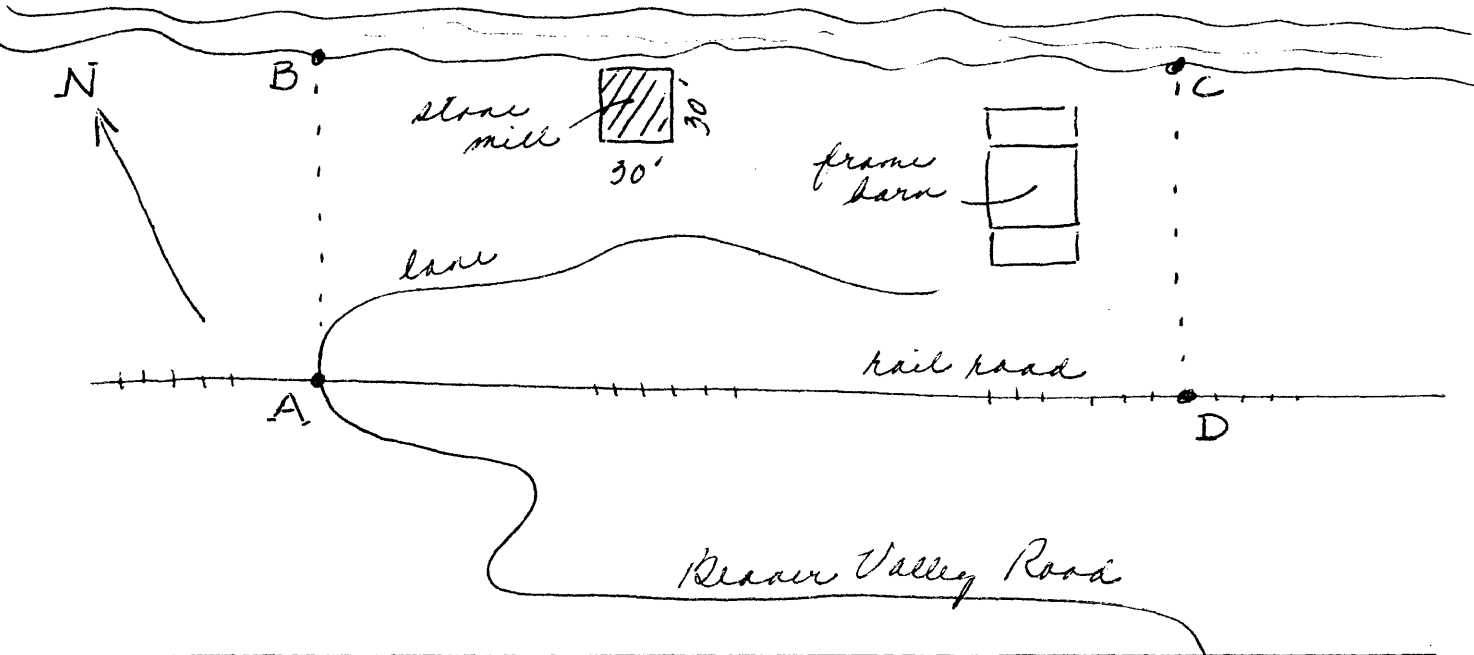

Official Courthouse Property Reference:

Barron County Courthouse

GULLIAN GERIG's MILL (BN-239) (a.k.a. Killian Kreek's Mill)
(Early Stone Bldgs. of KY TR)

Dn 239
p. 4 of 4

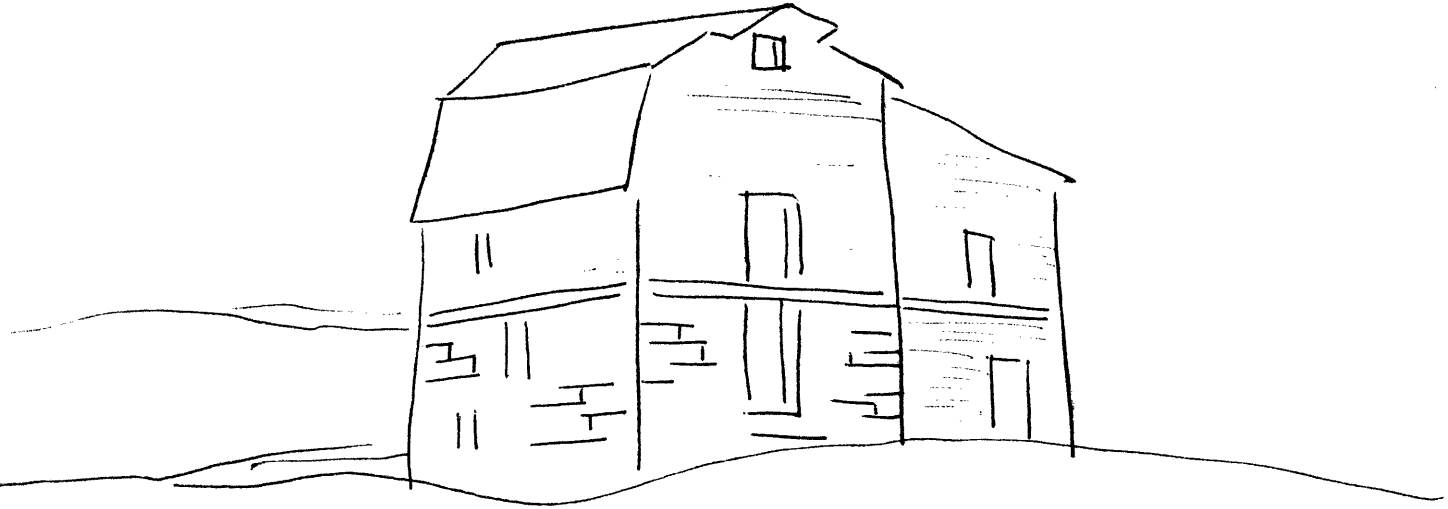

*Gullian Gerig's Mill
as it looked ca. 1910.*

KENTUCKY HISTORIC RESOURCES
Individual Inventory Form

Resource # BN-239
Barren County

1. Name of Resource: Gullian Gerig's Mill (a.k.a. Killian Kreek's Mill)		16. Date: Original Building 1798 [9] Addition []	
2. Original Owner: Gullian Gerig a.k.a. Killian Kreek		17. Style: Industrial Vernacular [80] []	
3. Other Names: Killian Kreek's Mill		18. Architect/Builder: Gullian Gerig	
4. Prehistoric Site Building <input checked="" type="checkbox"/> Object Historic Site Structure Other		19. No. of Stories: now [1.5]	
5. Location: End of Beaver Valley Road #1370 on south bank of Beaver Creek near Glasgow		20. Original Floor Plan: [NA]	
6. Owner's Name: Martha Reneau [P]		21. Single Pile Double Pile N.A. <input checked="" type="checkbox"/>	
7. Owner's Address: Route #1, Box 285 Glasgow, Kentucky 42141		22. Roof Form & Material: Original <input type="checkbox"/> Gable Not Original <input type="checkbox"/>	
8. Evaluation: [G]		23. Structural Material: Stone [S]	
9. Recognition & Date: Nat.Landmark <input type="checkbox"/> Local Landmark <input type="checkbox"/> Nat.Register <input type="checkbox"/> HABS/HAER <input type="checkbox"/> Highway Marker <input type="checkbox"/> KY Inventory <input checked="" type="checkbox"/> KY Landmark Certificate <input type="checkbox"/>		24. Exterior Material: Stone []	
10. N.R.Status & Date:		25. Foundation Material: Stone [S]	
11. N.R.Group: District Name: [] Mult.Resource Area: [] Thematic Name: Early Stone Buildings []		26. Major Alterations: None <input type="checkbox"/> Moved/Rebuilt roof Other <input type="checkbox"/> Additions 2nd Fl. demolished by river flooding	
12. Historical Theme: Primary: Architecture [030] Secondary: Settlement [140] Other: Milling [160]		27. Special Features:	
13. Statement of Significance: While at one time there were hundreds of water-powered mills in Kentucky, almost all of them have succumbed to the ravages of periodic flooding. Although the wooden roof of this mill has been redesigned and rebuilt, the masonry work is testimony to the careful construction.		28. Outbuildings: None [0]	
14. History: Mill built by Gullian Gerig (colloquialized to Killian Kreek); mill site approved by jury in 1798, when still part of Warren County; was second mill in Barren County. Kreek was a stone mason/builder; later moved to Indiana and built courthouse in Gibson County in 1814 (now demolished). An old Indian trail went past the mill loca- tion, later used as road. The mill was used as a distillery around 1900. Congregational baptisms were done in the mill pond in 1910.		29. Original Function: Mill [10A]	
15. Source of historical information and/or contact person: Research of owner in court records. Barren County Heritage, by Goode & Gardner.		30. Present Use: Vacant [99V]	
		31. Condition: [F]	
		32. Endangered: Yes <input type="checkbox"/> No <input checked="" type="checkbox"/>	
		33. Attach Photos: Roll: 3 Photo Nos 7-21 No. of Slides:	
		34. Prepared by: Carolyn Murray-Wooley	
		35. Organization: Kentucky Heritage Council	
		36. Date: Dec 1983	
		37. New Survey <input type="checkbox"/> <input checked="" type="checkbox"/>	

SEP 4 1987

KENTUCKY HISTORIC RESOURCES
 Individual Inventory Form

Resource # BN-239

38. UTM Point of Primary Building: Quadrant: <u>Glasgow</u>	Zone <u>16</u>	Easting <u>592100</u>	Northing <u>4097995</u>	39. G.I.S. Mod. []
				40. Coordi.Accuracy []

41. UTM Points of Boundary (for N. R. eligible sites only):

A. ---	D. ---
B. ---	E. ---
C. ---	F. ---

42. Total Acreage in Present Property: _____ 43. Acreage included in proposed N.R. boundary: 6.88 acres
 44. Site Plan (and boundary description and justification for N.R. sites):

See Attached

45. Description and House Plan:

Single-cell, about 30 x 30 feet, dry-stone mill, built on bank of Beaver Creek; ruins of mill dam below mill. Undershot wheel was under floor. Has hewn log framing, pegged window frames, batten "Dutch" doors with strap hinges (now stored in garage). Mill originally had second story of frame, with gambrel roof (see drawing, attached); and two-story frame shed-roofed section on each side. These deteriorated after severe flooding--present gable roof built to cover one story in 1957. Mill stones removed to yard of owner. Sawn-frame barn at site has hollow log trough. Stone is fossiliferous limestone, Ordovician.

13. Statement of Significance: (Continued)

technique of the builder, Gullian Gerig. It survives as representation of the once flourishing pioneer milling industry throughout the Commonwealth and is the only surviving example of an undershot wheel of the period in Kentucky. It is the only remaining early stone building in Barren County and illustrates dry-stone masonry technology in an early industrial building.

KENTUCKY HISTORIC RESOURCE INVENTORY SUPPLEMENT
BOUNDARY AND LOCATION INFORMATION

Historic Property Name William Strick's Mill Site # Bn 239
Multiple Resource/Thematic Nomination Title (a.k.a. William Strick's Mill)

U.T.M. Coordinates - List multiple UTM's if property is ten or more acres.

A. 16 592100 4097995 D. _____
B. _____ E. _____
C. _____ F. _____

Verbal Boundary Description Acreage 6.88 acres

Beginning where lane crosses the railroad, thence at 90° to R.R., 11300 ft to bank of Beaver Creek, thence w creek E 1100 ft to C, thence parallel to A-B, 200 ft to D at the R.R., thence w R.R. 1000 ft to the beginning, containing the stone mill and mill yard.

1 contrib bldg., 1 non contrib bldg.

Sketch of Site Plan (Showing outbuildings, structures, landscape features and the site boundary as described above.)

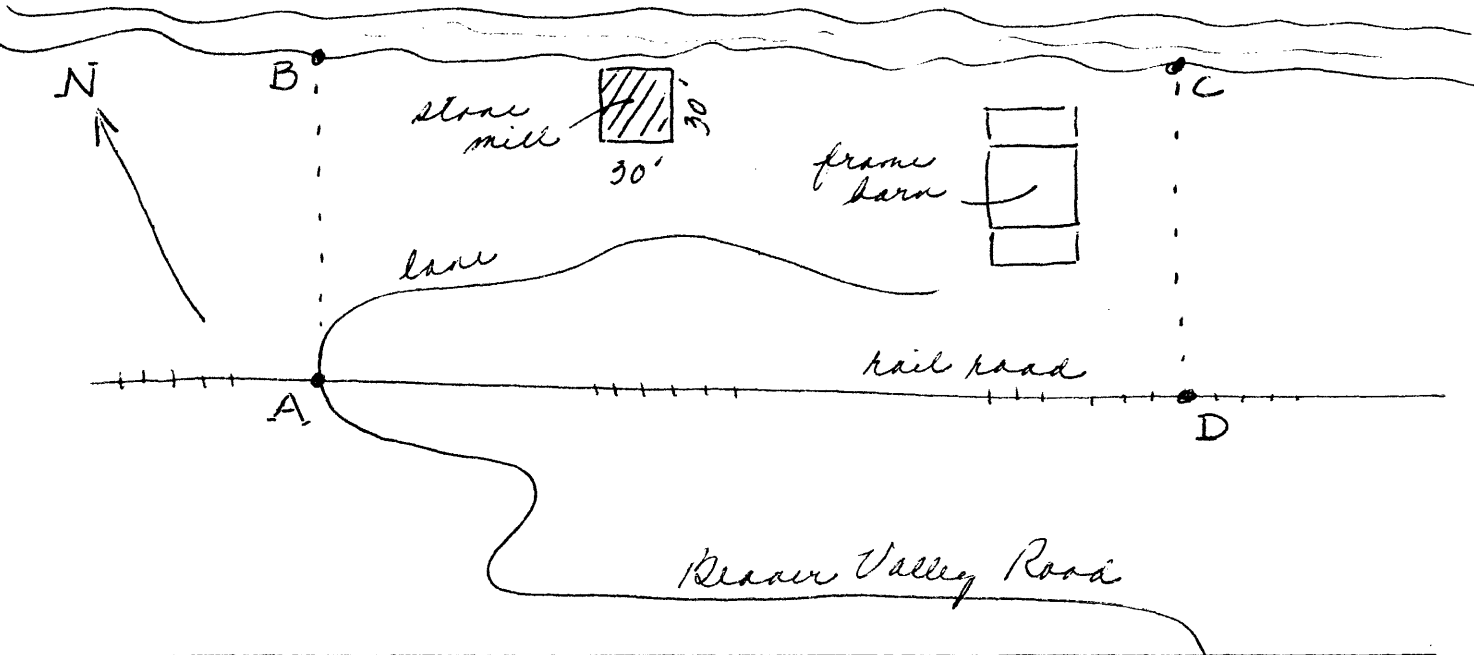

Official Courthouse Property Reference:

Barron County Courthouse

GULLIAN GERIG's MILL (BN-239) (a.k.a. Killian Kreek's Mill)
(Early Stone Bldgs. of KY TR)

Dn 239
p. 4 of 4

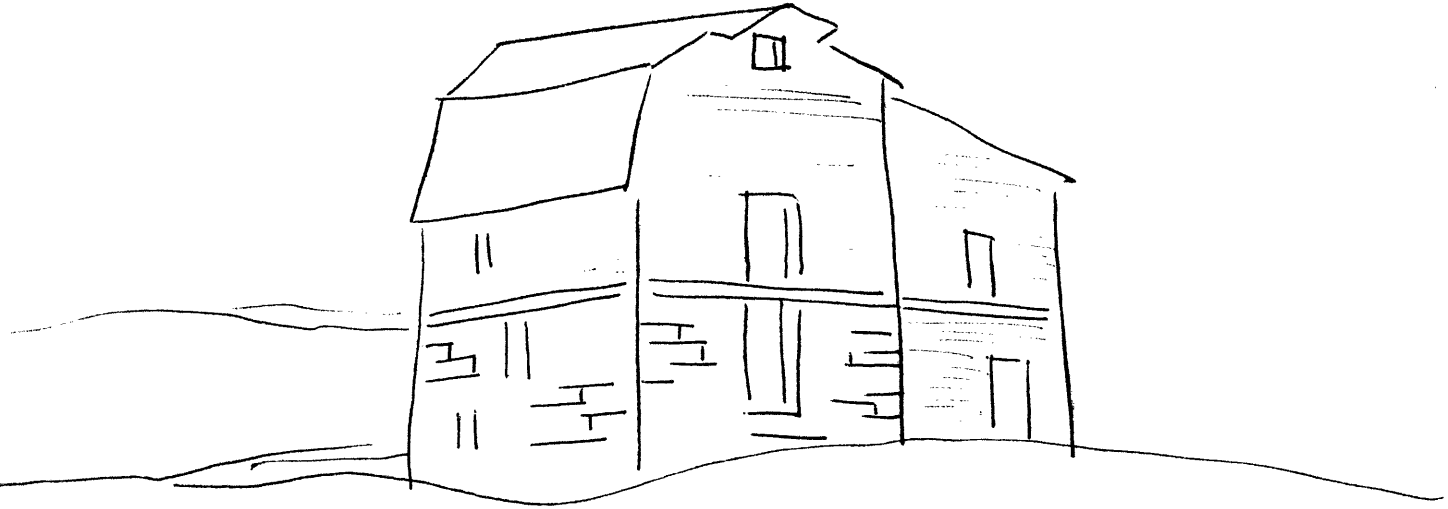

*Gullian Gerig's Mill
as it looked ca. 1910.*