

UNITED STATES DEPARTMENT OF THE INTERIOR
NATIONAL PARK SERVICE

FOR NPS USE ONLY

RECEIVED MAY 15 1975
DATE ENTERED JUN 5 1975

NATIONAL REGISTER OF HISTORIC PLACES
INVENTORY -- NOMINATION FORM

SEE INSTRUCTIONS IN HOW TO COMPLETE NATIONAL REGISTER FORMS
TYPE ALL ENTRIES -- COMPLETE APPLICABLE SECTIONS

1 NAME

HISTORIC

AND/OR COMMON

Rancocas Historic Village

LOCATION

STREET & NUMBER

*bounded N and W by E to Springside Rd. and D. 2
irregular pattern between W. Willingsboro line, to 3rd St.*

See Continuation Sheet

NOT FOR PUBLICATION

CITY, TOWN

CONGRESSIONAL DISTRICT

Rancocas

VICINITY OF

Sixth District

STATE

CODE

COUNTY

CODE

New Jersey

34

Burlington

005

CLASSIFICATION

CATEGORY	OWNERSHIP	STATUS	PRESENT USE
<input checked="" type="checkbox"/> DISTRICT	<input type="checkbox"/> PUBLIC	<input checked="" type="checkbox"/> OCCUPIED	<input type="checkbox"/> AGRICULTURE <input type="checkbox"/> MUSEUM
<input type="checkbox"/> BUILDING(S)	<input type="checkbox"/> PRIVATE	<input type="checkbox"/> UNOCCUPIED	<input checked="" type="checkbox"/> COMMERCIAL <input type="checkbox"/> PARK
<input type="checkbox"/> STRUCTURE	<input checked="" type="checkbox"/> BOTH	<input type="checkbox"/> WORK IN PROGRESS	<input checked="" type="checkbox"/> EDUCATIONAL <input checked="" type="checkbox"/> PRIVATE RESIDENCE
<input type="checkbox"/> SITE	PUBLIC ACQUISITION	ACCESSIBLE	<input type="checkbox"/> ENTERTAINMENT <input checked="" type="checkbox"/> RELIGIOUS
<input type="checkbox"/> OBJECT	<input type="checkbox"/> IN PROCESS	<input checked="" type="checkbox"/> YES: RESTRICTED	<input checked="" type="checkbox"/> GOVERNMENT <input type="checkbox"/> SCIENTIFIC
	<input type="checkbox"/> BEING CONSIDERED	<input type="checkbox"/> YES: UNRESTRICTED	<input type="checkbox"/> INDUSTRIAL <input type="checkbox"/> TRANSPORTATION
		<input type="checkbox"/> NO	<input type="checkbox"/> MILITARY <input type="checkbox"/> OTHER

OWNER OF PROPERTY

NAME

Multiple

STREET & NUMBER

CITY, TOWN

STATE

VICINITY OF

LOCATION OF LEGAL DESCRIPTION

COURTHOUSE,
REGISTRY OF DEEDS, ETC.

County Clerk's Office

STREET & NUMBER

Rancocas Road

CITY, TOWN

STATE

Mount Holly

New Jersey

6 REPRESENTATION IN EXISTING SURVEYS

TITLE

HABS (variety of listings)

DATE

FEDERAL STATE COUNTY LOCAL

DEPOSITORY FOR
SURVEY RECORDS

Library of Congress

CITY, TOWN

STATE

Washington

D.C.

7 DESCRIPTION

CONDITION		CHECK ONE	CHECK ONE
<input type="checkbox"/> EXCELLENT	<input type="checkbox"/> DETERIORATED	<input type="checkbox"/> UNALTERED	<input checked="" type="checkbox"/> ORIGINAL SITE
<input checked="" type="checkbox"/> GOOD	<input type="checkbox"/> RUINS	<input checked="" type="checkbox"/> ALTERED	<input type="checkbox"/> MOVED
<input type="checkbox"/> FAIR	<input type="checkbox"/> UNEXPOSED		DATE _____

DESCRIBE THE PRESENT AND ORIGINAL (IF KNOWN) PHYSICAL APPEARANCE

Rancocas Village is a mid-nineteenth century Quaker Village surrounding an eighteenth century Friends Meeting House. The Village stands as a reminder of the pattern of life in nineteenth century rural America. (The numbers in parentheses refer to the numbers on the enclosed Sketch Map)

1. Quaker Meeting House, 1772, Main Street (#26)

One and a half story building with a central block layout and small symmetrical wings. The foundation is fieldstone and the walls are Flemish bond in the front and common bond brick on the other three walls. The main roof is gabled with a pent roof at the east end of the building. There are two inside end chimneys and one outside chimney at the middle back of the building. The windows are twelve over twelve sash double hung with panelled shutters. There are two one bay entrance porches with double four panel, four tier doors with beaded board backing.

2. Samuel Wills House, c. 1790, Main Street (#10)

A two and one half story house with a T shaped wing. The foundation is stone and brick with common bond brick walls. The roof is gabled with a front center gable. There are two inside end chimneys and one in the rear. The windows are six over six sash. There is one casement in the gable end and in the front center gable there are two narrow four over four sash windows. The shutters are panelled. This house is said to be the oldest in Rancocas. The former library is still on the property.

3. Friends School, 1822, Main Street (#25)

This school is one story with a block layout and a rear wing. The foundation is fieldstone and the walls are brick. The windows are two over two sash in the main section and six over six sash in the addition. There are panelled shutters on the brick section only. The roof is gabled on the main section and there is a shed roof on the wing. There is one center chimney. The entrance is a one bay porch with four panel, three tier door with glass in top. The side entrance is a plain stoop.

4. William Rodgers House, 1833, 110 Bridge Street (#44)

This house, formerly a blacksmith shop, is two story with an L shaped layout. The foundation is cement slab in the front and fieldstone in the rear. The walls are double used-brick veneer over original weather boarding. The windows are six over six with no shutters. The roof is gabled in the front and a shed roof in the back. There are two outside chimneys. The entrances are of the brick foyer type. There is one side and one rear entrance also.

(see cont. sheet)

UNITED STATES DEPARTMENT OF THE INTERIOR
NATIONAL PARK SERVICE

FOR NPS USE ONLY

RECEIVED MAY 15 1975

DATE ENTERED

JUN 5 1975

**NATIONAL REGISTER OF HISTORIC PLACES
INVENTORY -- NOMINATION FORM**

Rancocas Historic Village
Burlington County 005
New Jersey 34

CONTINUATION SHEET

ITEM NUMBER 7

PAGE 1

5. Andrew Hollingshead House, 1837, 104 Main Street (#24)
There are three stories with a two story wing in the rear. The foundation is fieldstone and brick with common bond walls. The windows are double sash six over nine and six over six. The shutters are four panelled in the front and three panelled elsewhere on the first floor. They are louvered on the other stories. The flat roof has box cornices with brackets. There is a central chimney in the top roof and one in the rear of the second floor. There is a covered porch with scroll brackets. The double doors have glass panels, transom and sidelights.
6. Ezra Haines House, 1837, 104 Main Street (#16)
This T shaped house has three stories, a fieldstone foundation and weather boarding walls. The windows are six over six sash with two panelled shutters on the first floor and louvered on the second. The gable roof has a dormer with three part entablature and a dormer with segmental pediment. There is a four panelled front door with square transom and three small sidelights on each side.
7. James French House, 1837, 18 Main Street (#13)
This double house is a two and one half story L shape with a stone foundation and brick walls. The windows are two over two sash on the main floor and six over six sash on the second floor. The roof is gabled with two segmental pediment dormers. There are four inside end chimneys. There are scroll brackets on the porch with a small baluster railing dividing it.
8. Samuel Woolman House, 1838, E. Main Street (#16)
This house is two and one half story with a two story wing. It is of rectangular shape with a foundation of field stone and brick. The walls are common bond brick. The windows are double sash six over six with three panel shutters. The gabled roof has bridge chimneys and dormers. There is a covered porch over both sides of the double house each with panelled doors and fanlights.
9. David Woolman House, 1842, 200 Bridge Street (#41)
This house is two and one half story with a one story addition in the rear and a two story semicircle addition on the side. The foundation is fieldstone and brick with common bond brick walls. The windows are double sash six over six with two panelled shutters on the first floor and louvered shutters on the second. There is a gable roof with gable dormers and bracketed cornice. There are two inside chimneys and two outside chimneys in the rear. There is a one bayed entrance with arched console and another entrance into the semicircular room set back a few feet from the front.

UNITED STATES DEPARTMENT OF THE INTERIOR
NATIONAL PARK SERVICE

FOR NPS USE ONLY

RECEIVED MAY 15 1975

DATE ENTERED

JUN 5 1975

**NATIONAL REGISTER OF HISTORIC PLACES
INVENTORY -- NOMINATION FORM**

Rancocas Historic Village
Burlington County 005
New Jersey 34

CONTINUATION SHEET

ITEM NUMBER 7 PAGE 2

11. Public School, Grange Hall, 1874, Green Street (#34)

This is a two story rectangular building with a brick foundation and brick walls. The windows are nine over nine sash with no shutters. The gabled roof has box cornices with brackets. There is one interior chimney. The entrance way is a two panelled door with two panels of glass and a transom. This was used as a school until 1916 then a grange hall until 1970.

12. Joel Haines House, 1876, 44 East Main Street (#6)

This two and one half story T shaped house has a fieldstone foundation and common bond brick and weather boarding walls. The windows are six over six double hung sash windows with panelled shutters on the first floor and louvered on the second. There are front and side entrances each with a one story porch. The roof is gabled on the main section with "A" at the middle front. There is a flat roof in the rear with a shed roof on the addition. There are two inside chimneys and one middle one.

13. Henry Hallowell Leeds House, 1876, 45 East Main Street (#29)

This two and one half T shaped house has a high brick foundation and common bond brick walls. The windows are double sash two over two with three panelled shutters on the first floor and two panelled and louvered on the second floor. The gable roof has four dormers. There are three exterior chimneys. The covered porches have scrolled brackets. The double front door has glass panels and a glass transom.

Rancocas Village contains approximately 22 brick, 1 stone and 37 frame structures of historic significance. Rancocas is bound on the north by a small brook and natural thickets, on the south by a buffer strip of trees and the Rancocas by-pass, on the west by a clear area and the Willingboro township line and on the east, by a group of modern homes and, beyond Springside Road, farmland. The area within the Historic District is visibly distinct from the surrounding environs and forms an integral community setting, similar to its original settlement pattern.

According to early records of the town, the village developed on the Mt. Holly-Beverly Turnpike. In 1844, Barber and Howe described the village as a new and handsome area with a Friends Meeting House and about 30 dwellings. Lots were first sold along Main Street, and then others were opened on Olive and Second. The Village developed in that direction first. The village was then, and to some degree, today, surrounded by a farm area.

8 SIGNIFICANCE

PERIOD	AREAS OF SIGNIFICANCE -- CHECK AND JUSTIFY BELOW				
<input type="checkbox"/> PREHISTORIC	<input type="checkbox"/> ARCHEOLOGY-PREHISTORIC	<input type="checkbox"/> COMMUNITY PLANNING	<input type="checkbox"/> LANDSCAPE ARCHITECTURE	<input type="checkbox"/> RELIGION	
<input type="checkbox"/> 1400-1499	<input type="checkbox"/> ARCHEOLOGY-HISTORIC	<input type="checkbox"/> CONSERVATION	<input type="checkbox"/> LAW	<input type="checkbox"/> SCIENCE	
<input type="checkbox"/> 1500-1599	<input type="checkbox"/> AGRICULTURE	<input type="checkbox"/> ECONOMICS	<input type="checkbox"/> LITERATURE	<input type="checkbox"/> SCULPTURE	
<input type="checkbox"/> 1600-1699	<input checked="" type="checkbox"/> ARCHITECTURE	<input checked="" type="checkbox"/> EDUCATION	<input type="checkbox"/> MILITARY	<input type="checkbox"/> SOCIAL/HUMANITARIAN	
<input checked="" type="checkbox"/> 1700-1799	<input type="checkbox"/> ART	<input type="checkbox"/> ENGINEERING	<input type="checkbox"/> MUSIC	<input type="checkbox"/> THEATER	
<input checked="" type="checkbox"/> 1800-1899	<input checked="" type="checkbox"/> COMMERCE	<input type="checkbox"/> EXPLORATION/SETTLEMENT	<input type="checkbox"/> PHILOSOPHY	<input type="checkbox"/> TRANSPORTATION	
<input type="checkbox"/> 1900-	<input type="checkbox"/> COMMUNICATIONS	<input type="checkbox"/> INDUSTRY	<input type="checkbox"/> POLITICS/GOVERNMENT	<input checked="" type="checkbox"/> OTHER (SPECIFY) cultural	
		<input type="checkbox"/> INVENTION			

SPECIFIC DATES

1832

BUILDER/ARCHITECT

STATEMENT OF SIGNIFICANCE

Rancocas Village is architecturally significant because the town has a wide range of architectural styles. Examples of the development of building in this part of New Jersey range from the Friends Meeting House built in 1772 to several houses built in and styled after the period around the end of the 19th Century.

The geography of Rancocas contributed greatly to its growth. The area close to the Rancocas Creek developed as early as 1680. The present village of Rancocas was slow in its growth until 1832 when the Centerton bridge was built.

Art and culture played an important role in the development of Rancocas. It was an exceptionally cultured area and the center for the arts in the early 19th century. Its popularity in this area extended into the 20th century. The upper story of the Blacksmith shop was used as a playhouse and it attracted many visitors from throughout Burlington County. The Rancocas Lyceum, established in 1860, was famous throughout the County for its debates, concerts and entertainment. Rancocas Hall was built in the 1880's to house these popular activities.

Commerce was an important facet in shaping Rancocas as an independent town. It had a post office, stage coach service, a lamp lighter and three or four telephones. There was a grist mill, a blacksmith shop, a wheel wright shop, farm machinery shop, two general stores, a butcher and slaughter house, a barber shop and a candy shop. The village also had a poultry dealer, local milk dealer, cobbler, cigar manufacturer, carpenter and builder, dressmaker and two doctors.

Educationally, the village of Rancocas claimed two schools, a public or free school built in 1874 and a Quaker school dating from 1822. The town also supported a Literary Society for several years.

Religious history of Rancocas almost parallels its development as a town. It is said that even before the building of the Centerton bridge a small community centered around the Quaker Meeting House erected in 1722. Until 1874 when a public school was built, the Quakers provided the only instruction available to village children. The town, during the 19th century supported a Methodist and an Episcopal Church.

(see cont. sheet)

9 MAJOR BIBLIOGRAPHICAL REFERENCES

Woodward and Hageman. History of Burlington and Mercer Counties, Philadelphia: 1883
The Historic Rancocas, George DeCou, The News Cronicle, Moorestown, N.J., 1949
 Minutes of Burlington Monthly Meeting of Friends, Quaker Archives, Third and Archer, Philadelphia, Pennsylvania (see continuation sheet)

10 GEOGRAPHICAL DATA

ACREAGE OF NOMINATED PROPERTY 25 acres approximately

VTM OK
HL

UTM REFERENCES

NW	A	18	511010	4429020	NE	B	18	5111840	4428820
SE	C	18	5111710	4428390	SW	D	18	5110810	4428620
		ZONE	EASTING	NORTHING			ZONE	EASTING	NORTHING

VERBAL BOUNDARY DESCRIPTION

Beginning at the intersection of Stokes and Main Streets proceed North along Stokes Drive 280'. Thence proceed East-North-East across Lundy's Lane 540' to Bridge Street. Thence proceed E 420'. Thence South 460' to Main St. Thence E 340'. Thence S 130'. Thence E 280' to projected line of Springside Rd.. Thence proceed S 240' along that projected line. Thence W across Bridge and Olive and Green Sts. to a point 180' beyond Green. Thence N to Main. Thence E to point of beginning.

LIST ALL STATES AND COUNTIES FOR PROPERTIES OVERLAPPING STATE OR COUNTY BOUNDARIES

STATE	CODE	COUNTY	CODE
STATE	CODE	COUNTY	CODE

11 FORM PREPARED BY

NAME / TITLE

Staff of Historic Sites Section

ORGANIZATION

DATE

1975

Historic Sites-Department of Environmental Protection

STREET & NUMBER

TELEPHONE

(609) 292-2023

Box 1420

CITY OR TOWN

STATE

New Jersey

Trenton

12 STATE HISTORIC PRESERVATION OFFICER CERTIFICATION

THE EVALUATED SIGNIFICANCE OF THIS PROPERTY WITHIN THE STATE IS:

NATIONAL

STATE

LOCAL

As the designated State Historic Preservation Officer for the National Historic Preservation Act of 1966 (Public Law 89-665), I hereby nominate this property for inclusion in the National Register and certify that it has been evaluated according to the criteria and procedures set forth by the National Park Service.

SIGNATURE

David J. Bond

May 8, 1975

TITLE

Commissioner, Dept. of Environmental Protection

DATE

FOR NPS USE ONLY

I HEREBY CERTIFY THAT THIS PROPERTY IS INCLUDED IN THE NATIONAL REGISTER

A. K. Wautersen

DATE

6/5/75

DIRECTOR, OFFICE OF ARCHEOLOGY AND HISTORIC PRESERVATION

ATTEST:

Charles [Signature]

DATE

6-4-75

KEEPER OF THE NATIONAL REGISTER

[Signature]

UNITED STATES DEPARTMENT OF THE INTERIOR
NATIONAL PARK SERVICE

**NATIONAL REGISTER OF HISTORIC PLACES
INVENTORY -- NOMINATION FORM**

FOR NPS USE ONLY

RECEIVED MAY 15 1975

DATE ENTERED

JUN 5 1975

CONTINUATION SHEET

ITEM NUMBER 8 PAGE 1

Rancocas Historic Village
Burlington County 005
New Jersey 34

There are few intrusions in the historic district. Although the wheelwright shop has been torn down, the adjacent blacksmith shop (#44) still stands. Other commercial enterprises are still being carried on in buildings constructed for that purpose. The Rancocas Fire Company presently occupies the structure originally built for the Literary Society (#27). The Gristmill is no longer extant, but the millstones have been located in the vicinity of the mill site.

The town retains much of its heritage. It is saved from extinction by its boundaries which separate it from a rapidly changing environment.

UNITED STATES DEPARTMENT OF THE INTERIOR
NATIONAL PARK SERVICE

FOR NPS USE ONLY	
RECEIVED	MAY 15 1975
DATE ENTERED	JUN 5 1975

**NATIONAL REGISTER OF HISTORIC PLACES
INVENTORY -- NOMINATION FORM**

Rancocas Historic Village
Burlington County 005
New Jersey 34

CONTINUATION SHEET

ITEM NUMBER 9

PAGE 1

Place Names in Burlington County, New Jersey, Henry H. Bisbee, Burlington
County Publishing Company, Riverside, New Jersey, 1955

Deeds

Historic American Buildings Survey

Barber and Howe, Historic Collections of New Jersey, 1846, Trenton,
New Jersey

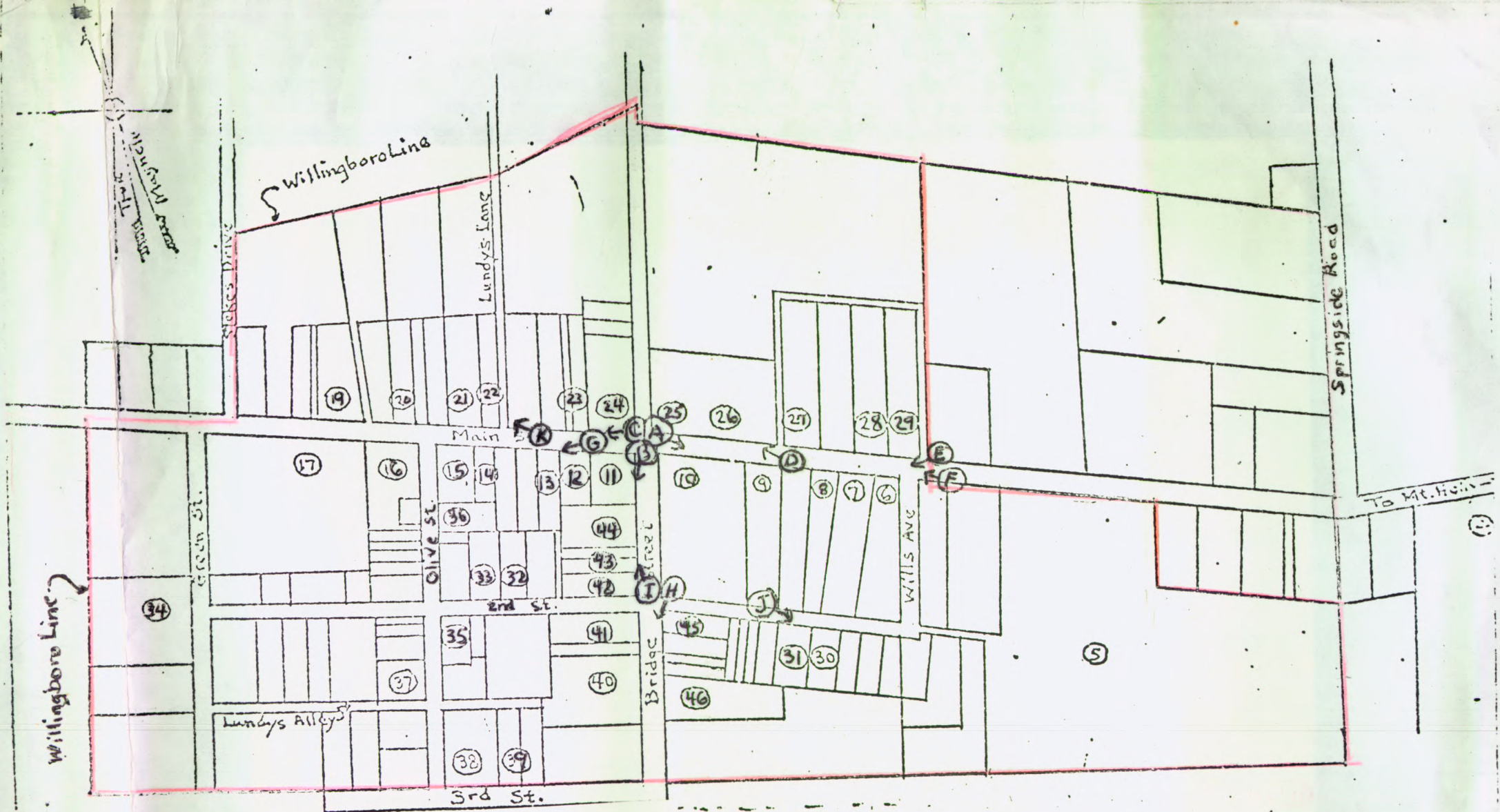

Rancoas Historic Village
 Burlington 005
 New Jersey 34

LETTERS DESIGNATE
 PLACE AND DIRECTION
 OF STREET SCOPES

VILLAGE OF RANCOCAS

SCALED DOWN FROM TAX MAP

Scale 1"=200'
 By A.R. Pettit 4/25/73