

United States Department of the Interior
National Park Service

National Register of Historic Places Continuation Sheet

Section number _____ Page _____

SUPPLEMENTARY LISTING RECORD

NRIS Reference Number: 91000943 Date Listed: 8/5/91

George A. C. Christiancy House San Diego CA
Property Name County State

Lilian Rice Designed Buildings in Rancho Santa Fe MPS
Multiple Name

This property is listed in the National Register of Historic Places in accordance with the attached nomination documentation subject to the following exceptions, exclusions, or amendments, notwithstanding the National Park Service certification included in the nomination documentation.

for *Antoinette Lee*
Signature of the Keeper

8/5/91
Date of Action

=====
Amended Items in Nomination:

Classification: The Category of Property is a building, not a district.

This information was confirmed with Cynthia Howse of the California State Historic Preservation Office.

This will not be counted in an audit.

DISTRIBUTION:

- National Register property file
- Nominating Authority (without nomination attachment)

NPS Form 10-900
(Rev. 8-86)

OMB No. 1024-0018

United States Department of the Interior
National Park Service

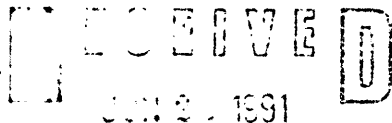

NATIONAL REGISTER OF HISTORIC PLACES
REGISTRATION FORM

NATIONAL
REGISTER

=====

1. Name of Property

=====

historic name: Christiancy, George A.C., Residence

other name/site number: NA

=====

2. Location

=====

street & number: 17078 El Mirador

not for publication: NA

city/town: Rancho Santa Fe

vicinity: NA

state: CA county: San Diego

code: 073 zip code: 92067

=====

3. Classification

=====

Ownership of Property: Private

Category of Property: District

Number of Resources within Property:

Contributing	Noncontributing	
__1__	__2__	buildings
__0__	__0__	sites
__0__	__1__	structures
__0__	__0__	objects
__1__	__3__	Total

Number of contributing resources previously listed in the National Register: __0__

Name of related multiple property listing: Lilian Rice Designed Buildings in Rancho Santa Fe, California

4. State/Federal Agency Certification

As the designated authority under the National Historic Preservation Act of 1986, as amended, I hereby certify that this XX nomination request for determination of eligibility meets the documentation standards for registering properties in the National Register of Historic Places and meets the procedural and professional requirements set forth in 36 CFR Part 60. In my opinion, the property XX meets does not meet the National Register Criteria. See continuation sheet.

Signature of certifying official: Kathryn Guattieri Date: 6-12-91

California State Historic Preservation Officer
State or Federal agency and bureau

In my opinion, the property meets does not meet the National Register criteria. See continuation sheet.

Signature of commenting or other official Date

State or Federal agency and bureau

5. National Park Service Certification

I, hereby certify that this property is:

- entered in the National Register See continuation sheet.
determined eligible for the National Register See continuation sheet.
determined not eligible for the National Register
removed from the National Register
other (explain):

Signature of Keeper: Autumn A. Lee Date of Action: 8/2/91

6. Function or Use

Historic: Domestic

Sub: Single Family

Current : Domestic

Sub: Single Family

=====
7. Description
=====

Architectural Classification:

Spanish Colonial Revival

Other Description: NA

Materials: foundation: concrete roof: red clay tile
 walls: stucco other:
 wood

Describe present and historic physical appearance. X See continuation sheet.

=====
8. Statement of Significance
=====

Certifying official has considered the significance of this property in relation to other properties: at the state level in area of community planning as at local level in area of architecture.

Applicable National Register Criteria: C

Criteria Considerations (Exceptions) : NA

Areas of Significance: Architecture

 Community Planning and Development

Period(s) of Significance: 1927

Significant Dates: 1927

Significant Person(s): NA

Cultural Affiliation: NA

Architect/Builder: Rice, Lilian Jenette

State significance of property, and justify criteria, criteria considerations, and areas and periods of significance noted above.
 X See continuation sheet.

=====

9. Major Bibliographical References

=====

X See continuation sheet.

Previous documentation on file (NPS):

- preliminary determination of individual listing (36 CFR 67) has been requested.
- previously listed in the National Register
- previously determined eligible by the National Register
- designated a National Historic Landmark
- recorded by Historic American Buildings Survey # _____
- recorded by Historic American Engineering Record # _____

Primary Location of Additional Data:

- State historic preservation office
- Other state agency
- Federal agency
- Local government
- University
- Other -- Specify Repository: Rancho Santa Fe Association

=====

10. Geographical Data

=====

Acreage of Property: 4.02 acres

UTM References: Zone Easting Northing Zone Easting Northing

A	11	482440	3654360	B	_____	_____
C	_____	_____	_____	D	_____	_____

____ See continuation sheet.

Verbal Boundary Description: ____ See continuation sheet.

Assessor's Parcel Number: 267-100-17
 Rancho santa Fe, Block 27, Lot 6, (Arb 17)

Boundary Justification: The boundary includes the entire lot that has historically been associated with the property.

=====

11. Form Prepared By

=====

Name/Title: Ray Brandes, Ph.D. (revised by OHP 1/18/91)

Organization: Historian Date: November 5, 1990

Street & Number: 2725 Barnson Place Telephone: (619) 296-8619

City or Town: San Diego State: CA ZIP: 92103

United States Department of the Interior
National Park Service

National Register of Historic Places Continuation Sheet

Section number 7 Page 5

Christiancy Residence

The George A.C. Christiancy residence was built in 1927, at 17078 El Mirador in Rancho Santa Fe, California. The New York financier had desired a place where he would have a winter home. His two story estate is sited on the peak of a hill with a wide view of the countryside. Lilian Rice designed the Spanish Colonial Revival home to fit his needs within the Rancho Santa Fe Covenant, as a "country gentleman's home." It is two-story, rectangular in shape with one wing angled to the north, to take advantage of the shape and contour of the hill. The exterior walls are of above-standard framing, 2 x 4 x 16" and framing and stucco on a bright white; the trim is also white.

The numerous windows vary in size, sash and in shape; windows are primarily at the second floor, and wood casement. There are three chimneys and fireplaces in the home; they have decorative tile or brick spark arresters, particularly important in an area such as this where there are many trees and shrubs susceptible to fire. The roof is 4 x 4 gable with 4 x 6 x 24" rafters. The gable form varies because of the variety of rooflines in the home. The square footage of the main residence is 4,463 square feet of living space.

The interior walls are of lath and plaster; floors are hardwood with some linoleum in the kitchen and bathrooms. The home has a living room, dining room, a den and five bedrooms.

The steep driveway to the home leads to a paved parking area. The entry to the home is unusual. It is via a two arch stairway which climbs to a circular paved or inner courtyard at the upper level. Stairs and the patio area as well as the pool area contain decorated tile.

A detached guest house was built at the northeast end of the home in 1947 and contains 539 square feet of living space; a swimming pool was built in 1980 and a lath house was constructed at some unknown time in the past on the grounds. Exterior changes include the enclosing of a 6' x 6' porch on the southeast corner of the main house in 1957. The porch at the top floor which had stucco pillars as supports had been open, has been glass enclosed. Not recorded on the Residential Building Record is a change on the north side of the home. Three windows on the top floor were converted into bays, apparently to provide a wider range of vision over the region.

United States Department of the Interior
National Park Service

NATIONAL REGISTER OF HISTORIC PLACES
CONTINUATION SHEET

Section number 8

Christiarcy Residence

Page 6

=====

The Christiarcy Residence is significant under Criterion C in the architectural history of Rancho Santa Fe as an excellent example of the large homes designed by Lilian Rice in the Spanish Colonial Revival style and in the community planning and development history of California as a component of a carefully laid out group of buildings over a large planned area. The house is beautifully sited on a steeply sloped hill with wide views of the surrounding countryside. The design is reflective of the reductive nature of Rice's work. Deeply recessed voids contrast with smooth sculptural volumes which spread themselves over the site. The Christiarcy Residence exhibits the major characteristics of its property type, making it eligible for the National Register in the context of The Work of Lilian Jenette Rice in Rancho Santa Fe During the Years 1923-1938.

The Christiarcy Residence was built in 1927 as a winter home for George A.C. Christiarcy, a New York financier. From Christiarcy's house he could view his horse breeding business operation on the open flats below.

National Register of Historic Places Continuation Sheet

Section number 9 Page 7

Christiarcy Residence

Major Bibliographical Resources

Lilian Rice rendering of residence, 1927, San Diego Historical Society

Rancho Santa Fe Progress, January 1928

Residential Building Record on file, Office of San Diego County
Assessor's Office, Carlsbad, California

Photo 84:15077, dated circa 1926. Ticor Collection, San Diego Historical Society

United States Department of the Interior
National Park Service

17078 El Mirador
Rancho Santa Fe, CA
San Diego County

National Register of Historic Places
Continuation Sheet

Section number _____ Page _____ CHRISTIANCY RESIDENCE

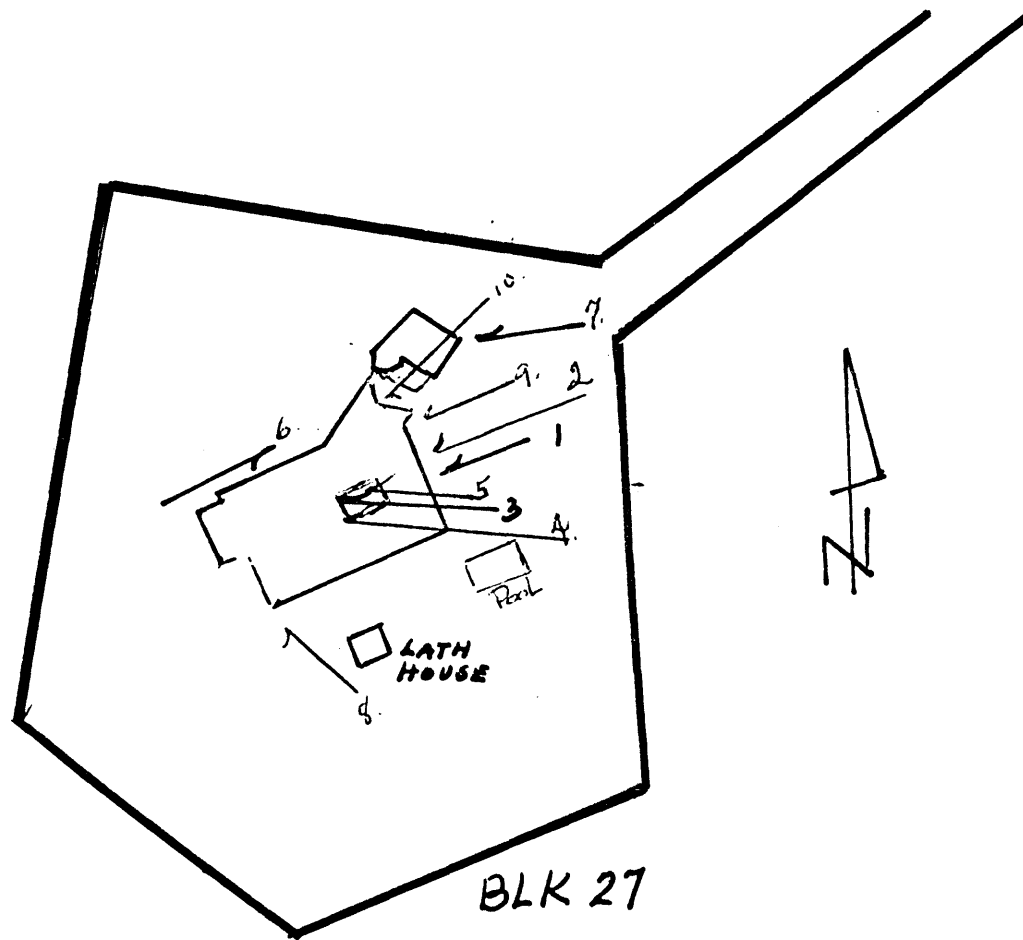

= BOUNDARY

United States Department of the Interior
National Park Service

National Register of Historic Places Continuation Sheet

Section number _____ Photographs
Page 1 _____

Following information is the same for all photographs.

George Christiancy Residence, 17078 El Mirador, Rancho Santa Fe, CA.92067

Current Owners: Mr. and Mrs. Jack Manion

Photographer, negatives on file: Phyllis Paul, Box 2034, Rancho Santa Fe, CA.

Dates of Photographs: August, September 1990.

1. View east to west approaching bricked parking area. Stairway below covered double arch leads to front entrance and an upper main patio.
2. Close view of curved arch covering stairway to upper level patio and front entrance. Hand rail has been added in recent years. A former owner hand painted the unusual stucco design curving around the lower arch. Present owners have saved a family crest but have covered it with a Della Robbia plaque in center of arch.
3. & 4. Views of patio area at top of stairs. Main entrance of the home is to the left. Facing east to west, notice the red clay tile roofing, the subdued railing and lantern. The front door and double doors to the right are original and all reflect the care Rice gave to such details.
5. Additional view of upper patio, east to west. Note outdoor patio fireplace with rounded stucco trim over fireplace opening.
6. View along north wall of house. Note cobblestone walk and recessed grille windows and double sash triple-paned windows which open out at the first floor level. At second floor level, note the three bay windows which offer views of the canyon area.
7. View of detached guest house built about 1947.
8. View of the north wall of home with unusual grillwork.
9. View of stucco details under eaves.

United States Department of the Interior
National Park Service

National Register of Historic Places Continuation Sheet

Section number Photographs Page 2

George Christiancy Residence (continued)

10. Details of upper porch overlooking bricked driveway. Note recessed windows, beautiful detailed corbels, support beams and posts. Also, the unusual window covering of small window on the right.
11. Stairway leading under curved arch to rooms over garage. This outside entrance was perhaps intended for an entrance to maids quarters. The stairwell turns left beyond the picture here and at the interior landing Rice designed a small uncovered opening with a curved arch to match the curve at the stairwell entrance. It provides a beautiful view of the surrounding countryside.