

**HISTORIC RESOURCES INVENTORY  
BUILDING AND STRUCTURES**

HIST-6 NEW 5 77

STATE OF CONNECTICUT  
**CONNECTICUT HISTORICAL COMMISSION**  
59 SOUTH PROSPECT STREET, HARTFORD, CONNECTICUT 06106  
(203) 566-3005

Asylum Hill Historic MRA

FOR OFFICE USE ONLY	
Town No.:	Site No.
UTM	
QUAD:	
DISTRICT	IF NR SPECIFY
<input type="checkbox"/> S <input type="checkbox"/> NR	<input type="checkbox"/> Actual <input type="checkbox"/> Potential

<b>IDENTIFICATION</b>	1. BUILDING NAME (Common) <i>(Historic)</i> Spencer House   Spencer House		
	2. TOWN CITY Hartford	COUNTY Hartford	
	3. STREET AND NUMBER (and/or location) 1039 Asylum Ave.		
	4. OWNER(S) Parkside Management Co., 90 Park Ave., New York, NY 10016 <input type="checkbox"/> Public <input checked="" type="checkbox"/> Private		
	5. USE (Present) <i>(Historic)</i> Now vacant. Will become studios for radio station.   Residence		
	6. ACCESSIBILITY TO PUBLIC: <input checked="" type="checkbox"/> Yes <input type="checkbox"/> No	INTERIOR ACCESSIBLE IF YES, EXPLAIN: <input type="checkbox"/> Yes <input checked="" type="checkbox"/> No	
	7. STYLE OF BUILDING Georgian Revival		
DATE OF CONSTRUCTION 1929			
<b>DESCRIPTION</b>	8. MATERIAL(S) (Indicate use or location when appropriate)		
	<input type="checkbox"/> Clapboard	<input type="checkbox"/> Asbestos Siding	
	<input checked="" type="checkbox"/> Brick	<input type="checkbox"/> Other (Specify) _____	
	<input type="checkbox"/> Wood Shingle	<input type="checkbox"/> Asphalt Siding	
	<input type="checkbox"/> Board & Batten	<input type="checkbox"/> Stucco	
	<input type="checkbox"/> Fieldstone	<input type="checkbox"/> Cobblestone	
	<input type="checkbox"/> Aluminum Siding	<input type="checkbox"/> Concrete Type: _____	
	<input type="checkbox"/> Cut stone Type: _____		
	9. STRUCTURAL SYSTEM		
	<input type="checkbox"/> Wood frame	<input type="checkbox"/> Post and beam	
<input checked="" type="checkbox"/> balloon	<input type="checkbox"/> Structural iron or steel		
<input type="checkbox"/> Load bearing masonry			
<input type="checkbox"/> Other (Specify) _____			
10. ROOF (Type)			
<input checked="" type="checkbox"/> Gable	<input type="checkbox"/> Flat		
<input type="checkbox"/> Mansard	<input type="checkbox"/> Monitor		
<input type="checkbox"/> sawtooth			
<input type="checkbox"/> Gambrel	<input type="checkbox"/> Shed		
<input type="checkbox"/> Hip	<input type="checkbox"/> Round		
<input type="checkbox"/> Other (Specify) _____			
(Material)			
<input type="checkbox"/> Wood Shingle	<input type="checkbox"/> Roll Asphalt		
<input type="checkbox"/> Tin	<input checked="" type="checkbox"/> Slate		
<input type="checkbox"/> Asphalt shingle	<input type="checkbox"/> Built up		
<input type="checkbox"/> Tile	<input type="checkbox"/> Other (Specify) _____		
11. NUMBER OF STORIES   APPROXIMATE DIMENSIONS 2 1/2   28x40' with 14x30' wing			
12. CONDITION (Structural) <i>(Exterior)</i>			
<input type="checkbox"/> Excellent	<input checked="" type="checkbox"/> Good		
<input type="checkbox"/> Fair	<input type="checkbox"/> Deteriorated		
<input type="checkbox"/> Excellent	<input checked="" type="checkbox"/> Good		
<input type="checkbox"/> Fair	<input type="checkbox"/> Deteriorated		
13. INTEGRITY (Location)   WHEN?   (Alterations)   IF YES, EXPLAIN			
<input checked="" type="checkbox"/> On original site	<input type="checkbox"/> Moved	<input checked="" type="checkbox"/> Yes <input type="checkbox"/> No	Altered to medical offices 1959, and to radio station studios 1979.
14. RELATED OUTBUILDINGS OR LANDSCAPE FEATURES			
<input type="checkbox"/> Barn	<input type="checkbox"/> Shed	<input checked="" type="checkbox"/> Garage	<input type="checkbox"/> Other landscape features or buildings (Specify)
<input type="checkbox"/> Carriage house	<input type="checkbox"/> Shop	<input type="checkbox"/> Garden	
15. SURROUNDING ENVIRONMENT			
<input type="checkbox"/> Open land	<input type="checkbox"/> Wood-land	<input checked="" type="checkbox"/> Residential	<input type="checkbox"/> Scattered buildings visible from site
<input checked="" type="checkbox"/> Commercial	<input type="checkbox"/> Industrial	<input type="checkbox"/> Rural	<input type="checkbox"/> High building density
16. INTERRELATIONSHIP OF BUILDING AND SURROUNDINGS			
Asylum Avenue is a main east-west artery. It is built up with apartment and office buildings in large part. Behind the Spencer House, however, there are several square blocks that are still residential in use.			

(OVER)

17 OTHER NOTABLE FEATURES OF BUILDING OR SITE (interior and/or exterior)

DESCRIPTION (Continued)

The house is a 2½-story, 5-bay, red brick, Georgian Revival structure with a high, slate, gabled roof, facing north. There are three, prominent, gabled dormers in the front slope of the roof. The central entrance has a small, gabled portico supported by simple, round columns. There is an exterior chimney on the west wall and a central chimney in the wing that runs to the south. Windows are 12/1 double hung sash. The interior ground floor plan includes a central hall with living room (originally) to the west and library to the east. Behind the library was the dining room, and then the service wing.

18 ARCHITECT	BUILDER
Ebbets & Frid	Carlson-Torrell

19 HISTORICAL OR ARCHITECTURAL IMPORTANCE

SIGNIFICANCE

The Spencer House is one of the last fine homes to be built in Asylum Hill, the neighborhood that from the Civil War to World War II was the most fashionable of Hartford neighborhoods. It is a workmanlike example of tasteful, Georgian Revival architecture by Ebbets & Frid, then and now (through a successor firm that continues the Frid name) a leading firm of Hartford architects. The house was built for Alfred Spencer, Jr., who was Chairman of the Executive Committee of the Hartford National Bank and Trust Co. and Chairman of the Gray Telephone Pay Station Co. (the pay telephone was invented in Hartford). He was precisely the sort of person who lived in Asylum Hill by the score, whose homes, churches, and schools are memorialized by the Asylum Hill Multiple Resources nomination.

SOURCES

Hartford Land Records, Building Permits, and City Directories.

Geographical Data:

    Acreage - Less than one (0.30 acre prox.).

    Verbal boundary description - The nominated property is described in the Hartford Land Records at volume 1654, page 212.

PHOTO	PHOTOGRAPHER	DATE	Place  Photograph  Here
	D. Ransom	1/79	
VIEW	NEGATIVE ON FILE		
Southwest	Conn. Hist. Commission		
COMPILED BY	NAME	DATE	
	David F. Ransom	Feb. 3, 1979	
	ORGANIZATION		
	ADDRESS		
	33 Sunrise Hill Dr., West Hartford, CT 06107		

20 SUBSEQUENT FIELD EVALUATIONS

21 THREATS TO BUILDING OR SITE

None knowr.     Highways     Vandalism     Developers     Other \_\_\_\_\_

Renewal     Private     Deterioration     Zoning     Explanation \_\_\_\_\_

STATE OF CONNECTICUT  
CONNECTICUT HISTORICAL COMMISSION  
59 South Prospect Street, Hartford, Connecticut 06106  
HISTORIC RESOURCES INVENTORY FORM  
For Buildings and Structures

<b>FOR OFFICE USE ONLY</b>			
TOWN NO.:	SITE NO.:		
UTM: 18/	/	/	/
QUAD:			
DISTRICT:	S	NR:	ACTUAL POTENTIAL

CONTINUATION SHEET

Item number: \_\_\_\_\_ Date: \_\_\_\_\_

Asylum Hill Historic MRA

Spencer House  
1039 Asylum Avenue  
Hartford, CT

Item number 19 (continued)

The Georgian Revival style became popular in Hartford in the first quarter of the 20th century, toward the end of the era of development for Asylum Hill. As Asylum Hill developed from downtown westward, the remaining vacant lots after 1900 were on such streets as Woodland and Forest, near the Little River, the area's western boundary. The Spencer House, located less than a block from Woodland Street, is in this final section to be built up and is in the architectural style that characterized several houses built there in the opening decades of the 20th century.

Perhaps the earliest, and finest, Georgian Revival style house to be built in Asylum Hill is the Cheney House at 40 Woodland Street, 1895, William C. Brocklesby, architect. Its 2-story central portico is imposing and its elaborate details of columns, pilasters and entablatures are carefully designed and well executed. Four houses standing on the east side of Forest Street are later and more representative work. 54 Forest Street, 1923, Russell F. Barker, architect, is similar to the Spencer House with its exterior of red brick and white trim and its interior of pilasters and moldings associated with the Georgian Revival style.

The Spencer House, competently designed and constructed, is no better example than the others of its architectural style, but is outstanding for its date. Constructed in 1929, it is one of the last houses to be built in Asylum Hill and is representative of the last in the series of architectural styles that were popular in the area. The Spencer House was built in the year of Black Friday and the beginning of the Great Depression that marked the end of Asylum Hill's preeminence as the fashionable residential neighborhood for Hartford's leaders.

The Spencer House  
Hartford, CT

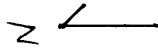

# CITY OF HARTFORD CONNECTICUT 1977

SCALE 1"=2000'

SCALE 1"=2000'

## MULTIPLE RESOURCES OF ASYLUM HILL

- A. NOOK FARM - WOODLAND
- B. COLLINS - TOWNLEY
- C. LAUREL - MARSHALL
- D. IMLAY - LAUREL
- E. ASYLUM AVENUE

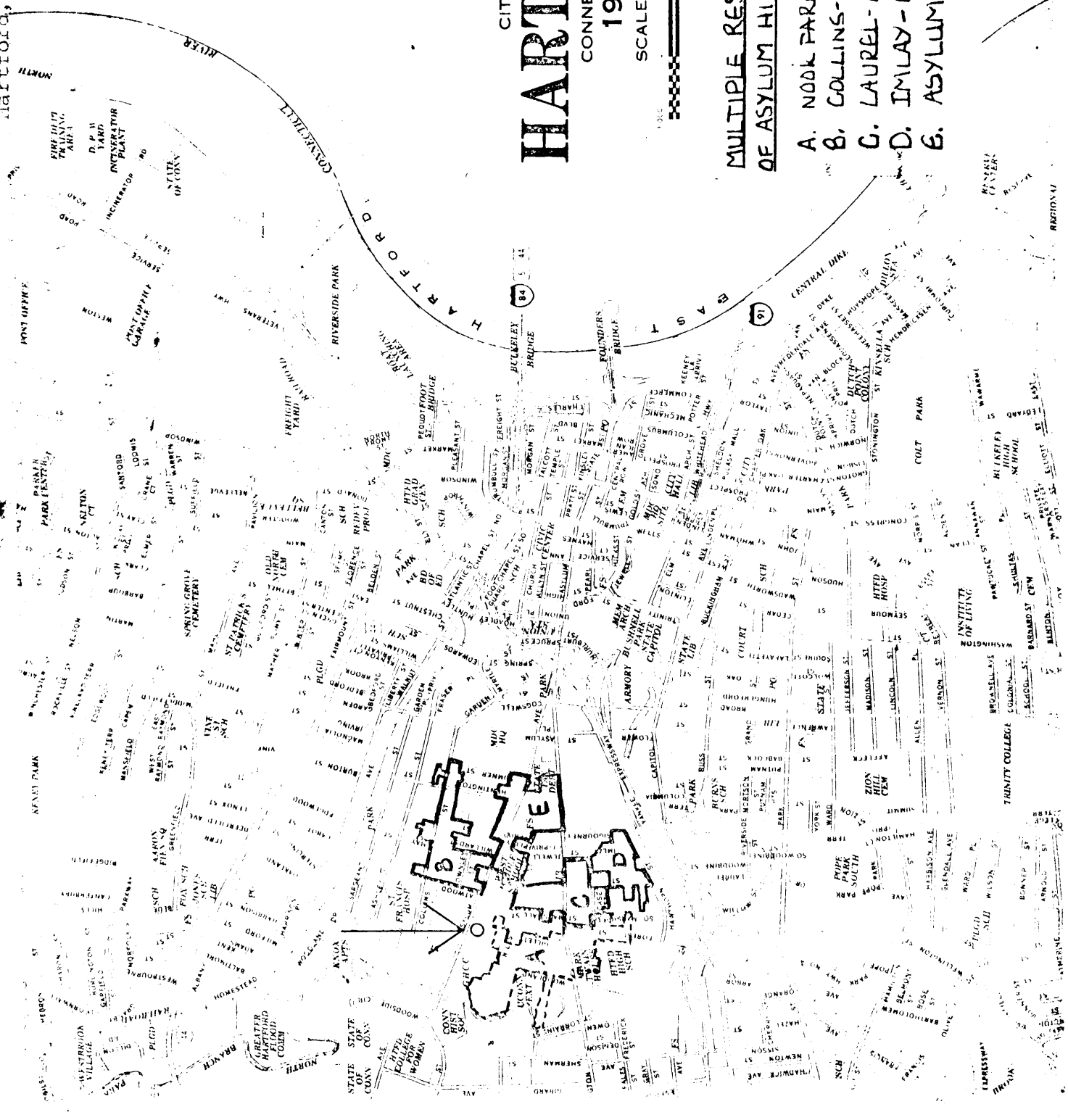

Map labels include: POST OFFICE, FIRE FIGHTING AREA, D.P. H. LAND INCUBATOR PLANT, STATE OF CONN., RIVERSIDE PARK, HARTFORD BRIDGE, BUCKLEY BRIDGE, FOUNDRY BRIDGE, CENTRAL DIKE, ASYLUM HILL, TRINITY COLLEGE, SENIORS CENTER, and various street names like MAIN ST, ELM ST, and STATE ST.

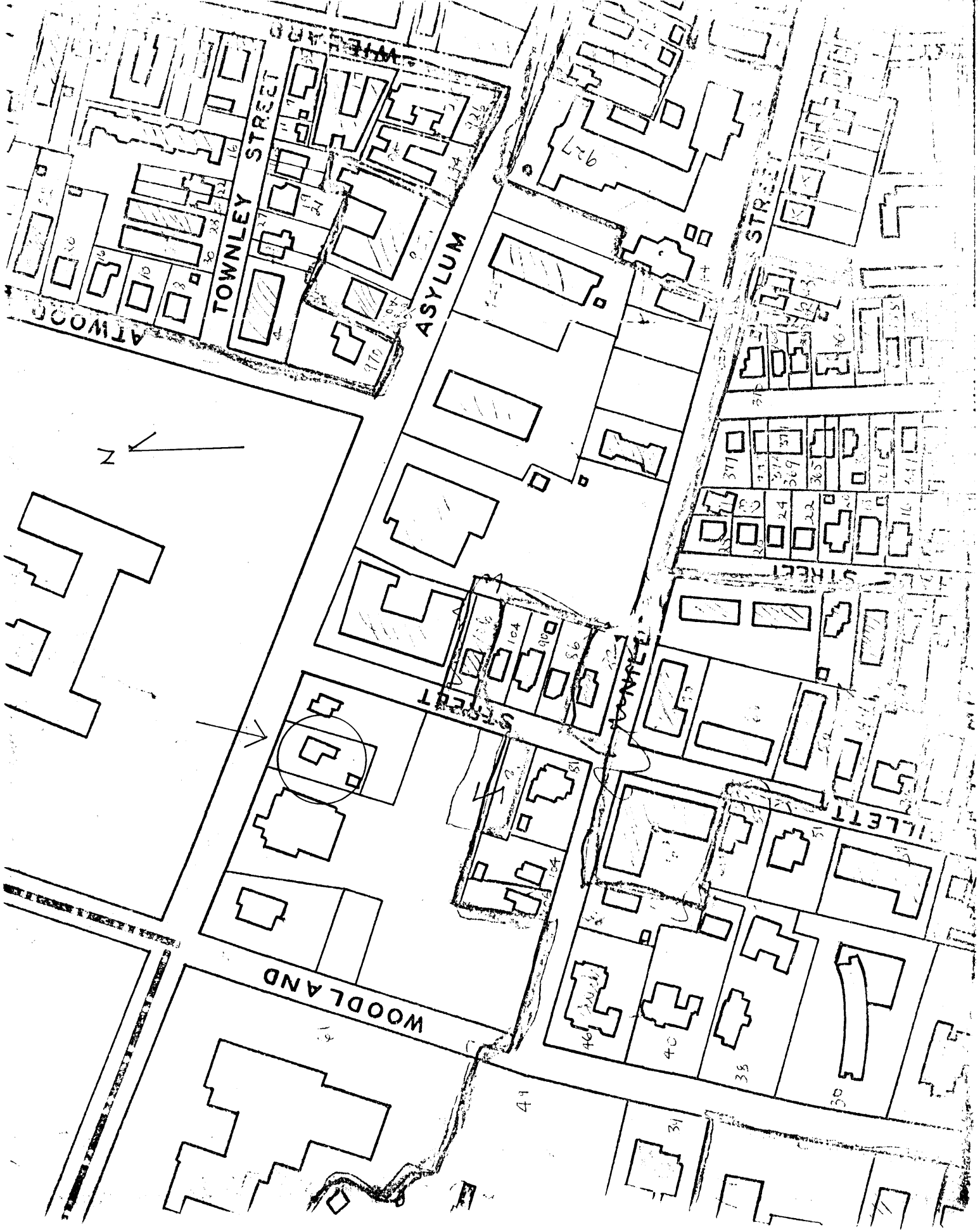

RECREAT AND HI  
 GOVERN AN  
 1. BUREAU OF REVENUE  
 2. BUREAU OF THE MINT  
 3. BUREAU OF CUSTOMS  
 4. BUREAU OF EXCISE  
 5. BUREAU OF INLAND NAVIGATION  
 6. BUREAU OF MARITIME AFFAIRS  
 7. BUREAU OF PUBLIC HEALTH  
 8. BUREAU OF THE INSULAR AFFAIRS  
 9. BUREAU OF THE PENITENTIARY  
 10. BUREAU OF THE SHERIFF  
 11. BUREAU OF THE TRUSTEES OF THE PUBLIC DEBT  
 12. BUREAU OF THE UNITED STATES MERCHANT MARINE SERVICE  
 13. BUREAU OF THE UNITED STATES MARSHALS SERVICE  
 14. BUREAU OF THE UNITED STATES NATIONAL GUARD  
 15. BUREAU OF THE UNITED STATES NATIONAL RESERVE  
 16. BUREAU OF THE UNITED STATES NATIONAL YOUTH GUARD  
 17. BUREAU OF THE UNITED STATES NATIONAL YOUTH RESERVE  
 18. BUREAU OF THE UNITED STATES NATIONAL YOUTH TRAINING CENTER  
 19. BUREAU OF THE UNITED STATES NATIONAL YOUTH CENTER  
 20. BUREAU OF THE UNITED STATES NATIONAL YOUTH CENTER  
 21. BUREAU OF THE UNITED STATES NATIONAL YOUTH CENTER  
 22. BUREAU OF THE UNITED STATES NATIONAL YOUTH CENTER  
 23. BUREAU OF THE UNITED STATES NATIONAL YOUTH CENTER  
 24. BUREAU OF THE UNITED STATES NATIONAL YOUTH CENTER  
 25. BUREAU OF THE UNITED STATES NATIONAL YOUTH CENTER  
 26. BUREAU OF THE UNITED STATES NATIONAL YOUTH CENTER  
 27. BUREAU OF THE UNITED STATES NATIONAL YOUTH CENTER  
 28. BUREAU OF THE UNITED STATES NATIONAL YOUTH CENTER  
 29. BUREAU OF THE UNITED STATES NATIONAL YOUTH CENTER  
 30. BUREAU OF THE UNITED STATES NATIONAL YOUTH CENTER  
 31. BUREAU OF THE UNITED STATES NATIONAL YOUTH CENTER  
 32. BUREAU OF THE UNITED STATES NATIONAL YOUTH CENTER  
 33. BUREAU OF THE UNITED STATES NATIONAL YOUTH CENTER  
 34. BUREAU OF THE UNITED STATES NATIONAL YOUTH CENTER  
 35. BUREAU OF THE UNITED STATES NATIONAL YOUTH CENTER  
 36. BUREAU OF THE UNITED STATES NATIONAL YOUTH CENTER  
 37. BUREAU OF THE UNITED STATES NATIONAL YOUTH CENTER  
 38. BUREAU OF THE UNITED STATES NATIONAL YOUTH CENTER  
 39. BUREAU OF THE UNITED STATES NATIONAL YOUTH CENTER  
 40. BUREAU OF THE UNITED STATES NATIONAL YOUTH CENTER  
 41. BUREAU OF THE UNITED STATES NATIONAL YOUTH CENTER  
 42. BUREAU OF THE UNITED STATES NATIONAL YOUTH CENTER  
 43. BUREAU OF THE UNITED STATES NATIONAL YOUTH CENTER  
 44. BUREAU OF THE UNITED STATES NATIONAL YOUTH CENTER  
 45. BUREAU OF THE UNITED STATES NATIONAL YOUTH CENTER  
 46. BUREAU OF THE UNITED STATES NATIONAL YOUTH CENTER  
 47. BUREAU OF THE UNITED STATES NATIONAL YOUTH CENTER  
 48. BUREAU OF THE UNITED STATES NATIONAL YOUTH CENTER  
 49. BUREAU OF THE UNITED STATES NATIONAL YOUTH CENTER  
 50. BUREAU OF THE UNITED STATES NATIONAL YOUTH CENTER  
 51. BUREAU OF THE UNITED STATES NATIONAL YOUTH CENTER  
 52. BUREAU OF THE UNITED STATES NATIONAL YOUTH CENTER  
 53. BUREAU OF THE UNITED STATES NATIONAL YOUTH CENTER  
 54. BUREAU OF THE UNITED STATES NATIONAL YOUTH CENTER  
 55. BUREAU OF THE UNITED STATES NATIONAL YOUTH CENTER  
 56. BUREAU OF THE UNITED STATES NATIONAL YOUTH CENTER  
 57. BUREAU OF THE UNITED STATES NATIONAL YOUTH CENTER  
 58. BUREAU OF THE UNITED STATES NATIONAL YOUTH CENTER  
 59. BUREAU OF THE UNITED STATES NATIONAL YOUTH CENTER  
 60. BUREAU OF THE UNITED STATES NATIONAL YOUTH CENTER  
 61. BUREAU OF THE UNITED STATES NATIONAL YOUTH CENTER  
 62. BUREAU OF THE UNITED STATES NATIONAL YOUTH CENTER  
 63. BUREAU OF THE UNITED STATES NATIONAL YOUTH CENTER  
 64. BUREAU OF THE UNITED STATES NATIONAL YOUTH CENTER  
 65. BUREAU OF THE UNITED STATES NATIONAL YOUTH CENTER  
 66. BUREAU OF THE UNITED STATES NATIONAL YOUTH CENTER  
 67. BUREAU OF THE UNITED STATES NATIONAL YOUTH CENTER  
 68. BUREAU OF THE UNITED STATES NATIONAL YOUTH CENTER  
 69. BUREAU OF THE UNITED STATES NATIONAL YOUTH CENTER  
 70. BUREAU OF THE UNITED STATES NATIONAL YOUTH CENTER  
 71. BUREAU OF THE UNITED STATES NATIONAL YOUTH CENTER  
 72. BUREAU OF THE UNITED STATES NATIONAL YOUTH CENTER  
 73. BUREAU OF THE UNITED STATES NATIONAL YOUTH CENTER  
 74. BUREAU OF THE UNITED STATES NATIONAL YOUTH CENTER  
 75. BUREAU OF THE UNITED STATES NATIONAL YOUTH CENTER  
 76. BUREAU OF THE UNITED STATES NATIONAL YOUTH CENTER  
 77. BUREAU OF THE UNITED STATES NATIONAL YOUTH CENTER  
 78. BUREAU OF THE UNITED STATES NATIONAL YOUTH CENTER  
 79. BUREAU OF THE UNITED STATES NATIONAL YOUTH CENTER  
 80. BUREAU OF THE UNITED STATES NATIONAL YOUTH CENTER  
 81. BUREAU OF THE UNITED STATES NATIONAL YOUTH CENTER  
 82. BUREAU OF THE UNITED STATES NATIONAL YOUTH CENTER  
 83. BUREAU OF THE UNITED STATES NATIONAL YOUTH CENTER  
 84. BUREAU OF THE UNITED STATES NATIONAL YOUTH CENTER  
 85. BUREAU OF THE UNITED STATES NATIONAL YOUTH CENTER  
 86. BUREAU OF THE UNITED STATES NATIONAL YOUTH CENTER  
 87. BUREAU OF THE UNITED STATES NATIONAL YOUTH CENTER  
 88. BUREAU OF THE UNITED STATES NATIONAL YOUTH CENTER  
 89. BUREAU OF THE UNITED STATES NATIONAL YOUTH CENTER  
 90. BUREAU OF THE UNITED STATES NATIONAL YOUTH CENTER  
 91. BUREAU OF THE UNITED STATES NATIONAL YOUTH CENTER  
 92. BUREAU OF THE UNITED STATES NATIONAL YOUTH CENTER  
 93. BUREAU OF THE UNITED STATES NATIONAL YOUTH CENTER  
 94. BUREAU OF THE UNITED STATES NATIONAL YOUTH CENTER  
 95. BUREAU OF THE UNITED STATES NATIONAL YOUTH CENTER  
 96. BUREAU OF THE UNITED STATES NATIONAL YOUTH CENTER  
 97. BUREAU OF THE UNITED STATES NATIONAL YOUTH CENTER  
 98. BUREAU OF THE UNITED STATES NATIONAL YOUTH CENTER  
 99. BUREAU OF THE UNITED STATES NATIONAL YOUTH CENTER  
 100. BUREAU OF THE UNITED STATES NATIONAL YOUTH CENTER