

**NATIONAL REGISTER OF HISTORIC PLACES
INVENTORY - NOMINATION FORM**

(Type all entries - complete applicable sections)

STATE: Minnesota	
COUNTY: Hennepin	
FOR NPS USE ONLY	
ENTRY NUMBER 70.10.22.0018	DATE 10/9/70

1. NAME

COMMON:
Cahill School

AND/OR HISTORIC:

2. LOCATION

STREET AND NUMBER:
Eden Avenue at Highway #100

CITY OR TOWN:
Edina

STATE Minnesota	CODE 55436	COUNTY: Hennepin	CODE 053
---------------------------	----------------------	----------------------------	--------------------

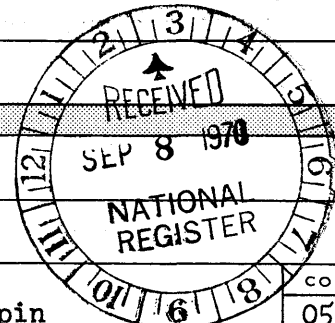

3. CLASSIFICATION

CATEGORY (Check One)	OWNERSHIP	STATUS	ACCESSIBLE TO THE PUBLIC
<input type="checkbox"/> District <input type="checkbox"/> Site <input type="checkbox"/> Object <input checked="" type="checkbox"/> Building <input type="checkbox"/> Structure <input type="checkbox"/> Object	<input checked="" type="checkbox"/> Public <input type="checkbox"/> Private <input type="checkbox"/> Both	Public Acquisition: <input type="checkbox"/> In Process <input type="checkbox"/> Being Considered <input type="checkbox"/> Occupied <input type="checkbox"/> Unoccupied <input checked="" type="checkbox"/> Preservation work in progress	Yes: <input checked="" type="checkbox"/> Restricted <input type="checkbox"/> Unrestricted <input type="checkbox"/> No

PRESENT USE (Check One or More as Appropriate)

<input type="checkbox"/> Agricultural	<input type="checkbox"/> Government	<input type="checkbox"/> Park	<input type="checkbox"/> Transportation	<input type="checkbox"/> Comments
<input type="checkbox"/> Commercial	<input type="checkbox"/> Industrial	<input type="checkbox"/> Private Residence	<input type="checkbox"/> Other (Specify)	_____
<input checked="" type="checkbox"/> Educational	<input type="checkbox"/> Military	<input type="checkbox"/> Religious	_____	_____
<input type="checkbox"/> Entertainment	<input checked="" type="checkbox"/> Museum	<input type="checkbox"/> Scientific	_____	_____

4. OWNER OF PROPERTY

OWNER'S NAME:
Village of Edina

STREET AND NUMBER:
4801 West 50th Street

CITY OR TOWN:
Edina

STATE:
Minnesota

CODE:
22

5. LOCATION OF LEGAL DESCRIPTION

COURTHOUSE, REGISTRY OF DEEDS, ETC.:
Register of Deeds, Hennepin County Courthouse

STREET AND NUMBER:
5th Street

CITY OR TOWN:
Minneapolis

STATE:
Minnesota

CODE:
22

6. REPRESENTATION IN EXISTING SURVEYS

TITLE OF SURVEY:
none

DATE OF SURVEY:
 Federal State County Local

DEPOSITORY FOR SURVEY RECORDS:

STREET AND NUMBER:

CITY OR TOWN:

STATE:

CODE:

SEE INSTRUCTIONS

STATE: **Minnesota**

COUNTY: **Hennepin**

ENTRY NUMBER: **70.10.22.0018**

DATE: **10/9/70**

FOR NPS USE ONLY

7. DESCRIPTION

CONDITION	(Check One)					
	<input type="checkbox"/> Excellent	<input checked="" type="checkbox"/> Good	<input type="checkbox"/> Fair	<input type="checkbox"/> Deteriorated	<input type="checkbox"/> Ruins	<input type="checkbox"/> Unexposed
	(Check One)			(Check One)		
	<input checked="" type="checkbox"/> Altered	<input type="checkbox"/> Unaltered	<input checked="" type="checkbox"/> Moved	<input type="checkbox"/> Original Site		

DESCRIBE THE PRESENT AND ORIGINAL (if known) PHYSICAL APPEARANCE

The building is an excellent example of the one room schools that dotted the rural landscape of Minnesota in the 1800's. The school has a rectangular plan (26 ft. x 40 ft.) with a later stairway addition (10 ft. x 10 ft.) at the rear of the building. The stairway addition replaced the old wood shed.

The original building was a one-story structure with a crawl space. Later (1917) a partial basement was added and a warm air furnace installed.

The foundation of the school was of Minnesota limerock. The first floor beams are of heavy timbers (8" x 8"), with mortise and tenon joints. Floor joists (2" x 8"), 20" o.c. span between the beams. The walls and roof are of frame construction.

The exterior of the school is lap siding (5" to the weather) and has always been painted white. The windows are double hung. Those on the sidewalls had an ogee moulding on the frames which has been removed. The windows on the front of the building are probably a later addition.

The original school had two doors on the front providing separate entrances to the boys' and girls' cloakrooms. Later (about 1910) these doors were removed and a single entrance door installed. The partition separating the two cloakrooms was also removed at this time.

The original chimney which has been removed was of buff "Chaska" brick. A tapered wood flagpole extending 12 ft. above the ridge over the main entrance has also been removed. The original roof was of wood shingles and has been covered over with green asphalt shingles.

The interior walls and ceilings were of plaster on wood lath. A wood wainscot (43" high) of beaded wood siding was installed throughout. The wainscot in the cloakroom is probably a later addition. The walls and ceiling were replastered in 1928.

The floors are 3/4" x 2-1/4" maple flooring over a 3/4" x 12" wood subfloor. There is an elevated platform at the front of the classroom. A portion of this platform has been removed and a secondary exit installed. Slate chalkboards are installed across the front of the classroom and part way down the sidewalls as far as the windows.

Originally heating was provided by a cordwood stove in the center of the classroom. This was replaced by a warm air floor furnace in 1917. Still later (1937) a ducted warm air system was installed.

Outside privies were used on the original site until after 1936 when inside toilets were installed at each end of the cloakroom.

Electric lights were installed in 1935. Prior to that time, illumination was provided by kerosene lamps mounted on brackets between the windows.

SEE INSTRUCTIONS



SIGNIFICANCE

PERIOD (Check One or More as Appropriate)

- | | | | |
|--|---------------------------------------|--|---------------------------------------|
| <input type="checkbox"/> Pre-Columbian | <input type="checkbox"/> 16th Century | <input type="checkbox"/> 18th Century | <input type="checkbox"/> 20th Century |
| <input type="checkbox"/> 15th Century | <input type="checkbox"/> 17th Century | <input checked="" type="checkbox"/> 19th Century | |

SPECIFIC DATE(S) (If Applicable and Known) 1864

AREAS OF SIGNIFICANCE (Check One or More as Appropriate)

- | | | | |
|--|---|--|--|
| <input type="checkbox"/> Aboriginal | <input checked="" type="checkbox"/> Education | <input type="checkbox"/> Political | <input type="checkbox"/> Urban Planning |
| <input type="checkbox"/> Prehistoric | <input type="checkbox"/> Engineering | <input type="checkbox"/> Religion/Philosophy | <input type="checkbox"/> Other (Specify) |
| <input type="checkbox"/> Historic | <input type="checkbox"/> Industry | <input type="checkbox"/> Science | _____ |
| <input type="checkbox"/> Agriculture | <input type="checkbox"/> Invention | <input type="checkbox"/> Sculpture | _____ |
| <input checked="" type="checkbox"/> Architecture | <input type="checkbox"/> Landscape Architecture | <input type="checkbox"/> Social/Humanitarian | _____ |
| <input type="checkbox"/> Art | <input type="checkbox"/> Literature | <input type="checkbox"/> Theater | _____ |
| <input type="checkbox"/> Commerce | <input type="checkbox"/> Military | <input type="checkbox"/> Transportation | _____ |
| <input type="checkbox"/> Communications | <input type="checkbox"/> Music | | |
| <input type="checkbox"/> Conservation | | | |

STATEMENT OF SIGNIFICANCE

School District No. 16, Hennepin County, Minnesota was one of the early school districts in the State. The land for the Cahill School was deeded to the school directors of School District No. 16 by Mr. Hugh Darcy on June 27, 1864, for the sum of \$5.00. A one-room, white frame school house was erected that year on the two-acre site.

For the next 100 years, this building was to serve as the nucleus of the Cahill District of the Village of Edina. Named for Father Thomas Cahill, an early missionary priest in the Northwest, the area was settled in 1854 by a group of Irish settlers fleeing from the potato famine in Ireland. For a time the one-room school house located on the southeast corner of West 70th Street and Cahill Road was also used for church services by St. Patrick's Catholic Church. Village elections, community dances, plays and other social activities in addition to daily classes for the children of the community were held at the school. Much later, the school house was again used for church services, this time by Calvary of Cahill Lutheran Church, during the period from 1934 to 1938.

Until April 20, 1953 when District No. 16 was dissolved and annexed by District No. 17, the school was in use continuously for grades 1 through 8. After that date, District No. 17 continued to use it for kindergarten classes. In 1963 the School District no longer had use for the facility and sold the land to a commercial developer. The Village of Edina acquired the building and moved it to its present location so that it could be restored and preserved.

Mr. John Woods was the first teacher at the school. In the early days school was held three months in the winter and three months in the summer so that the boys could help their fathers in the fields. Enrollment averaged 30 students and at times as many as 43 students were enrolled.

As one of the few remaining school houses of this era, it is the feeling of the Village of Edina that this building should be preserved and restored. Accordingly, the school is to be incorporated in the Edina Historical Park so that future generations may relate to the early development of the Village and the surrounding area.

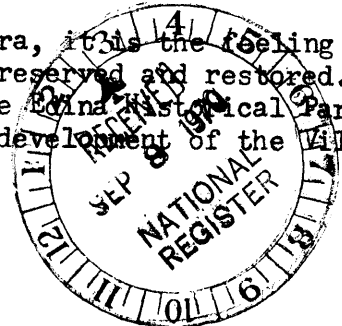

SEE INSTRUCTIONS

9 MAJOR BIBLIOGRAPHICAL REFERENCES

Deed, 27 June 1864, Hugh Darcy to School District No. 16, Register of Deeds, Hennepin County, Minnesota, Book Z, page 430.
Clerk's Book of Records, Cahill School District No. 16, Hennepin County, Minnesota, 1913 to 1939.
Annual Reports, Hennepin County Schools, 1935-1953.
Register of School Officers, Hennepin County Schools, 1868-1953.
Through the Years in Edina-Morningside Public Schools, 1960, page 9.
The Church of St. Patrick, Edina, Minnesota, 1857-1957, page 1.
"Calvary of Cahill Grew up in Catholic Settlement", The Courier, July 20, 1967, p.6.
"Irish Potato Famine Fostered First Edina Congregation", The Courier, June 22, 1967, p.3.

10 GEOGRAPHICAL DATA

LATITUDE AND LONGITUDE COORDINATES DEFINING A RECTANGLE LOCATING THE PROPERTY				OR	LATITUDE AND LONGITUDE COORDINATES DEFINING THE CENTER POINT OF A PROPERTY OF LESS THAN TEN ACRES									
CORNER	LATITUDE				LONGITUDE									
	Degrees	Minutes	Seconds	Degrees	Minutes	Seconds	Degrees	Minutes	Seconds					
NW	0	.	"	0	.	"	44	0	54	46	93	0	21	1.6
NE	0	.	"	0	.	"								
SE	0	.	"	0	.	"								
SW	0	.	"	0	.	"								

APPROXIMATE ACREAGE OF NOMINATED PROPERTY: **0.619**

LIST ALL STATES AND COUNTIES FOR PROPERTIES OVERLAPPING STATE OR COUNTY BOUNDARIES

STATE:	CODE	COUNTY	CODE

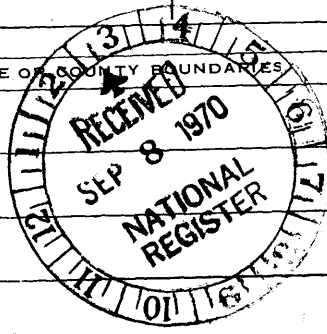

SEE INSTRUCTIONS

11 FORM PREPARED BY

NAME AND TITLE: **Brooks Cavin, AIA**

ORGANIZATION: **Cavin & Page** DATE: **July 31, 1970**

STREET AND NUMBER: **102 Hubbard Building, 2675 University Avenue**

CITY OR TOWN: **St. Paul** STATE: **Minnesota** CODE: **22**

12 STATE LIAISON OFFICER CERTIFICATION

<p>As the designated State Liaison Officer for the National Historic Preservation Act of 1966 (Public Law 89-665), I hereby nominate this property for inclusion in the National Register and certify that it has been evaluated according to the criteria and procedures set forth by the National Park Service. The recommended level of significance of this nomination is:</p> <p>National <input type="checkbox"/> State <input checked="" type="checkbox"/> Local <input type="checkbox"/></p> <p>Name: <u><i>Russell W. Fridley</i></u></p> <p>Title: <u>Director, Minnesota Historical Society</u></p> <p>Date: _____</p>	<p style="text-align: center;">NATIONAL REGISTER VERIFICATION</p> <p>I hereby certify that this property is included in the National Register.</p> <p style="text-align: center;"><u><i>Ernest Allen Connolly</i></u> Chief, Office of Archeology and Historic Preservation</p> <p style="text-align: center;">OCT 9 1970</p> <p>Date: _____</p> <p>ATTEST: <u><i>William J. Mustang</i></u> Keeper of The National Register</p> <p style="text-align: center;">SEP 16 1970</p> <p>Date: _____</p>
---	---

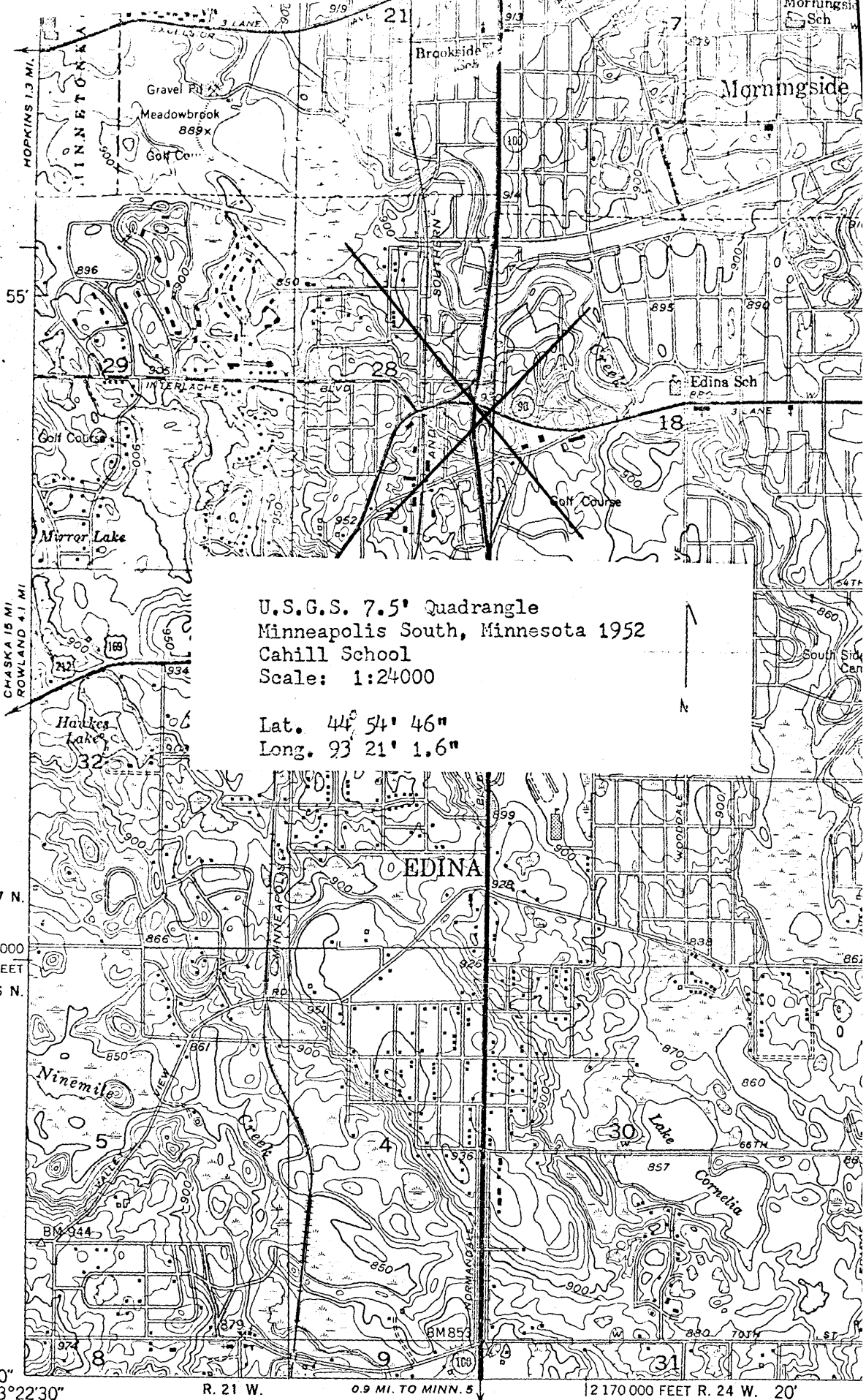
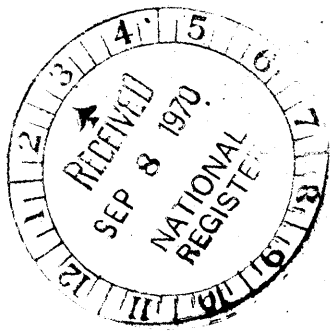

U.S.G.S. 7.5' Quadrangle
Minneapolis South, Minnesota 1952
Cahill School
Scale: 1:24000

Lat. 44° 54' 46"
Long. 93° 21' 1.6"

T. 117 N.
690 000
FEET
T. 116 N.

44°52'30" 93°22'30" R. 21 W. 0.9 MI. TO MINN. S. 12 170 000 FEET R. 24 W. 20'

(MINNEAPOLIS 1:62,500)

Mapped, edited, and published by the Geological Survey
Control by USGS, USC&GS, and USCE
Topography from aerial photographs by Kelsh plotter
Aerial photographs taken 1947. Field check 1952
Polyconic projection. 1927 North American datum

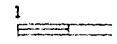

Form 10-301
(Dec. 1968)

UNITED STATES DEPARTMENT OF THE INTERIOR
NATIONAL PARK SERVICE

**NATIONAL REGISTER OF HISTORIC PLACES
PROPERTY MAP FORM**

(Type all entries - attach to or enclose with map)

STATE Minnesota	
COUNTY Hennepin	
FOR NPS USE ONLY	
ENTRY NUMBER 70.10.22.0018	DATE 10/9/70

SEE INSTRUCTIONS

1. NAME			
COMMON: Cahill School			
AND/OR HISTORIC:			
2. LOCATION			
STREET AND NUMBER: Eden Avenue at Highway #100			
CITY OR TOWN: Edina			
STATE: Minnesota	CODE 22	COUNTY: Hennepin	CODE 053
3. MAP REFERENCE			
SOURCE: U.S.G.S. 7.5' Quadrangle			
SCALE: 1:24000			
DATE: 1952			
4. REQUIREMENTS			
TO BE INCLUDED ON ALL MAPS			
1. Property boundaries where required.			
2. North arrow.			
3. Latitude and longitude reference.			

