

United States Department of the Interior
National Park Service

National Register of Historic Places
Registration Form

This form is for use in nominating or requesting determinations for individual properties and districts. See instructions in *How to Complete the National Register of Historic Places Registration Form* (National Register Bulletin 16A). Complete each item by marking "x" in the appropriate box or by entering the information requested. If an item does not apply to the property being documented, enter "N/A" for "not applicable." For functions, architectural classification, materials, and areas of significance, enter only categories and subcategories from the instructions. Place additional entries and narrative items on continuation sheets (NPS Form 10-900a). Use a typewriter, word processor, or computer, to complete all items.

1. Name of Property

historic name Kemp Cotton Gin Historic District

other names/site number Site #DE0240

2. Location

street & number Desha County Road 227 west of Arkansas Highway 1

☐ not for publication

city or town Rohwer

☐ vicinity

state Arkansas code AR county Desha code 041 zip code

3. State/Federal Agency Certification

As the designated authority under the National Historic Preservation Act, as amended, I hereby certify that this ☒ nomination ☐
request for determination of eligibility meets the documentation standards for registering properties in the National Register of Historic
Places and meets the procedural and professional requirements set for in 36 CFR Part 60. In my opinion, the property ☒ meets ☐
does not meet the National Register criteria. I recommend that this property be considered significant
☐ nationally ☐ statewide ☒ locally. (See continuation sheet for additional comments.)

Cathy Mallett
Signature of certifying official/Title

3/18/05
Date

Arkansas Historic Preservation Program

State or Federal agency and bureau

In my opinion, the property ☐ meets ☐ does not meet the National Register criteria. (☐ See Continuation sheet for additional comments.)

Signature of certifying official/Title

Date

State or Federal agency and bureau

4. National Park Service Certification

I hereby certify that the property is:

☒ entered in the National Register.

☐ See continuation sheet

☐ determined eligible for the
National Register.

☐ See continuation sheet

☐ determined not eligible for the
National Register.

☐ removed from the National
Register.

☐ other, (explain:)

Edson H. Beall
Signature of the Keeper

6/1/05
Date of Action

Kemp Cotton Gin Historic District
Name of Property

Desha County, Arkansas
County and State

5. Classification

Ownership of Property
(Check as many boxes as apply)

- ☒ private
☐ public-local
☐ public-State
☐ public-Federal

Category of Property
(Check only one box)

- ☐ building(s)
☒ district
☐ site
☐ structure
☐ object

Number of Resources within Property
(Do not include previously listed resources in count.)

Contributing	Noncontributing
2	buildings
	sites
2	structures
	objects
4	Total

Name of related multiple property listing
(Enter "N/A" if property is not part of a multiple property listing.)

Get Down the Shovel and the Hoe!: Cotton and Rice Farm
History and Architecture in the Arkansas Delta, 1900-1955

Number of Contributing resources previously listed
in the National Register

6. Function or Use

Historic Functions
(Enter categories from instructions)

AGRICULTURE/SUBSISTENCE/processing
COMMERCE/TRADE/business
AGRICULTURE/SUBSISTENCE/agricultural outbuilding

Current Functions
(Enter categories from instructions)

VACANT/NOT IN USE
COMMERCE/TRADE/business
AGRICULTURE/SUBSISTENCE/agricultural outbuilding

7. Description

Architectural Classification
(Enter categories from instructions)

OTHER/Plain Traditional

Materials
(Enter categories from instructions)

foundation CONCRETE
walls METAL

roof METAL
other

Narrative Description
(Describe the historic and current condition of the property on one or more continuation sheets.)

United States Department of the Interior
National Park Service

National Register of Historic Places Continuation Sheet

Section number 7 Page 1

SUMMARY

Located in the southeast Arkansas community of Rohwer, Desha County, the Kemp Cotton Gin Historic District consists of the gin building with loading dock, bookkeeper's office, scale house with scale, and pump house. The gin, pump house, and scale house are all frame buildings with corrugated metal walls and roofs while the bookkeeper's office is a brick building with a hipped, asphalt shingle-clad roof. The buildings in the complex have a variety of foundations, including continuous cast concrete (gin), brick (bookkeeper's office), and wood (scale house and pump house). The complex is located just west of the former Missouri Pacific railroad line that connects Rohwer with McGehee to the south and the Helena area to the north.

ELABORATION

The Kemp Cotton Gin Historic District is located in Rohwer, Desha County, Arkansas, located approximately 115 miles southeast of Little Rock. The complex is located just to the west of the former Missouri Pacific railroad line that connects Rohwer with McGehee to the south and the Helena area to the north, and consists of the gin building, bookkeeper's office, scale house with associated scale, and pump house.

The gin building is the centerpiece of the complex, and it rests on a continuous cast concrete foundation. The frame building is sheathed in corrugated sheet metal and has a sheet-metal-clad gable roof. The building is fenestrated with metal-framed casement windows. It also has a metal and cast concrete loading dock at its north end. Like the gin, the pump house and scale house also have corrugated sheet metal walls and metal roofs, a gable roof on the pump house and a shed roof on the scale house. The pump house has a continuous wood block foundation and the scale house has a wood pier foundation.

Unlike the other buildings in the complex the bookkeeper's office is a brick building resting on a continuous brick foundation. The building's hipped roof is covered in gray asphalt shingles, and a small porch spans the front façade. All four buildings, the gin and loading dock, scale house with its associated scale, pump house, and bookkeeper's office are all included in the nomination.

Cotton Gin

Front/East Façade

Beginning at the south end of the east façade, there are two evenly-spaced, metal-framed, six-pane casement windows on the first level followed by a large, two-panel, sliding metal door. To the right of the door are two more evenly-spaced, metal-framed, six-pane casement windows followed by a metal-framed, four-pane casement window set low in the façade. Running the entire length of the façade, in between the first and second levels, is a shed-roofed awning with a gable-fronted shelter approximately half way down its length that shelters the telescoping pipe that removed the cotton from the truck or wagon. A truck scale is located on the ground under the shelter.

United States Department of the Interior
National Park Service

National Register of Historic Places Continuation Sheet

Section number 7 Page 2

On the second level of the east façade are three metal-framed, four-pane casement windows to the left of the shelter. Two of the windows are evenly-spaced near the south end of the façade, while the third window abuts the south side of the gable-fronted shelter. Three evenly-spaced, metal-framed, four-pane casement windows are located to the right of the shelter.

In addition, at the north end of the building are the east end of the concrete loading dock and the shed-roofed awning over it.

Side/North Façade

The north façade of the gin building is dominated by the cast-concrete loading dock, which is supported by three square, cast-concrete pillars evenly spaced along its length. To the west side of the loading dock is a metal deck truss ramp that slopes from the loading dock to a separate lower cast concrete loading dock with metal hoist in the yard.

The loading dock level of the façade has a large two-panel metal sliding door on the left side and a single metal-framed, six-pane casement window on the right side. There is no fenestration on the upper level above the shed-roofed awning.

In addition, at the east end of the building is the north end of the east façade's shed-roofed awning.

Rear/West Façade

On the lower level of the west façade, at the north end, is a metal-framed, six-pane casement window set low in the façade. The rest of the façade on the lower level is fenestrated by three evenly-spaced, metal-framed, six-pane casement windows. The northern half of the façade's second level is fenestrated by three evenly-spaced, metal-framed, four-pane casement windows located just below the eave.

In addition, at the north end of the building are the west end of the concrete loading dock and the shed-roofed awning over it.

Side/South Façade

The lower level of the building's south façade is dominated by a large, two-panel, metal sliding door that allows vehicle access to the building. A sloped concrete ramp leads up to the door. The second level of the façade is fenestrated by two evenly-spaced metal-framed, six-pane casement windows.

United States Department of the Interior
National Park Service

National Register of Historic Places Continuation Sheet

Section number 7 Page 3

Bookkeeper's Office

Front/South Façade

The bookkeeper's office is located just to the west of the cotton gin. The south façade of the bookkeeper's office is spanned by a porch with a shed roof that is supported by three metal poles, evenly spaced along its width. In addition, a metal pipe guardrail spans the façade, except in front of the front door.

The main entrance to the building is located on the west side of the façade, and consists of a wood door with two horizontal panes of glass in its top half. A screen door with vertical bars over the lower screen panel is also present at the entrance. To the right of the door is a single window with two horizontal panes in both its top and bottom sashes.

Side/East Façade

The east façade is fenestrated by three windows with two horizontal panes in its top and bottom sashes, one located towards each end of the façade and one located just to the left of the façade's center.

Rear/North Façade

The rear of the building is fenestrated by two windows with two horizontal panes in its top and bottom sashes, one located towards each end of the façade.

Side/West Façade

The west façade of the bookkeeper's office faces the gin building and like the front façade, a metal pipe guardrail spans the façade, except in front of the front door. The door is located towards the northern end of the façade and is a wood door with two horizontal panes of glass in its top half like the door on the front of the building. Just to the right of the façade's center is a pair of windows with two horizontal panes in their top and bottom sashes followed by a single window with two horizontal panes in its top and bottom sashes near the south end of the façade.

Scale House

The scale house is located approximately 150 feet north of the bookkeeper's office, and is a small square-shaped building. The shed roof of the building slopes to the north and a doorway is located on the building's east side. The wood door has three recessed horizontal panels on the bottom half and had a single pane window on the top half. A deteriorated set of wood steps leads up to the doorway.

The only fenestration in the building is a single rectangular window opening on the building's south side that overlooks the scale. A series of five 2x4 boards, placed on end, protrude from the bottom of the façade. The scale, which is overgrown, abuts the building on the south and some of the scale equipment remains inside the building.

United States Department of the Interior
National Park Service

National Register of Historic Places Continuation Sheet

Section number 7 Page 4

Pump House

The pump house is located just to the northwest of the gin, and has a gable roof with a north/south oriented gable peak. The only opening in the building is a small doorway at the southeast corner.

Integrity

Overall, the Kemp Cotton Gin Historic District retains excellent integrity. Although most of the gin equipment has been removed from the main building, the building's form allows it to remain easily recognizable as a cotton gin. Also, even though the scale house is deteriorated due to a lack of maintenance, it still retains its historic form and materials, and even retains some of its scale equipment. The presence of the associated bookkeeper's office, scale house with scale, and pump house make the Kemp Cotton Gin Historic District a good example of a mid-twentieth-century cotton gin complex. Also, Rohwer remains a small community just as it was when the Kemp Cotton Gin Historic District was built c.1950.

United States Department of the Interior
National Park Service

National Register of Historic Places Continuation Sheet

Section number 7 Page 5

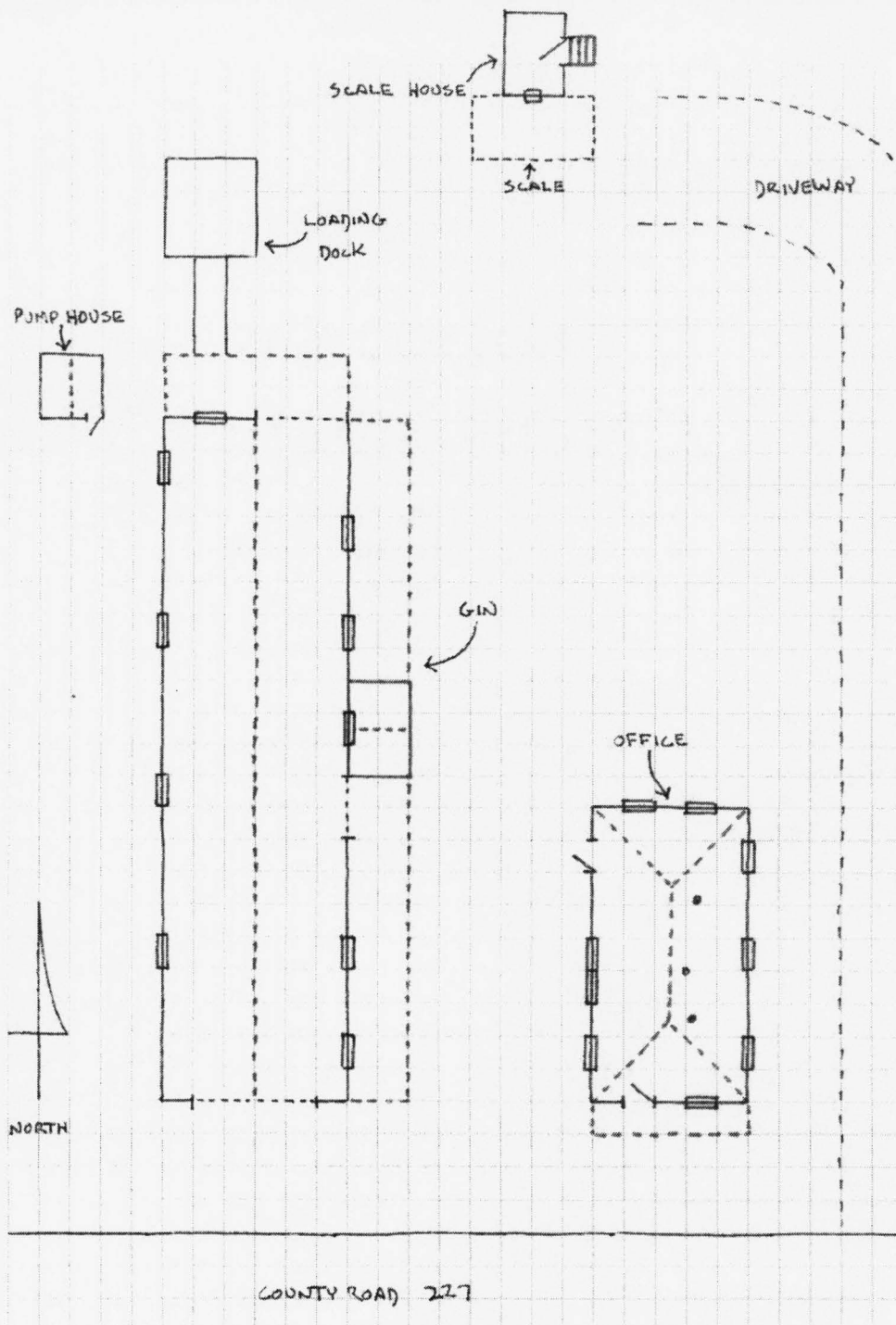

8. Statement of Significance**Applicable National Register Criteria**

(Mark "x" in one or more boxes for the criteria qualifying the property for National Register listing.)

- ☒ **A** Property is associated with events that have made a significant contribution to the broad patterns of our history.
- ☐ **B** Property is associated with the lives of persons significant in our past.
- ☒ **C** Property embodies the distinctive characteristics of a type, period, or method of construction or represents the work of a master, or possesses high artistic values, or represents a significant and distinguishable entity whose components lack individual distinction.
- ☐ **D** Property has yielded, or is likely to yield, information important in prehistory or history.

Criteria Considerations

(Mark "x" in all the boxes that apply.)

Property is:

- ☐ **A** owned by a religious institution or used for religious purposes.
- ☐ **B** removed from its original location.
- ☐ **C** birthplace or grave of a historical figure of outstanding importance.
- ☐ **D** a cemetery.
- ☐ **E** a reconstructed building, object, or structure.
- ☐ **F** a commemorative property
- ☐ **G** less than 50 years of age or achieved significance within the past 50 years.

Levels of Significance (local, state, national)

Local

Areas of Significance (Enter categories from instructions)

Architecture

Agriculture

Period of Significance

c.1950-1955

Significant Dates

c.1950-1955

Significant Person (Complete if Criterion B is marked)**Cultural Affiliation** (Complete if Criterion D is marked)**Architect/Builder****Narrative Statement of Significance**

(Explain the significance of the property on one or more continuation sheets.)

9. Major Bibliographical References**Bibliography**

(Cite the books, articles, and other sources used in preparing this form on one or more continuation sheets.)

Previous documentation on file (NPS):

- ☐ preliminary determination of individual listing (36 CFR 67) has been requested
- ☐ previously listed in the National Register
- ☐ Previously determined eligible by the National Register
- ☐ designated a National Historic Landmark
- ☐ recorded by Historic American Buildings Survey # _____
- ☐ recorded by Historic American Engineering Record # _____

Primary location of additional data:

- ☒ State Historic Preservation Office
- ☐ Other State Agency
- ☐ Federal Agency
- ☐ Local Government
- ☐ University
- ☐ Other

Name of repository: _____

United States Department of the Interior
National Park Service

National Register of Historic Places Continuation Sheet

Section number 8 Page 1

SUMMARY

The Kemp Cotton Gin Historic District, which was built c.1950, is being nominated to the National Register of Historic Places under **Criterion C** with **local significance** as the only example of a cotton gin in the Rohwer vicinity. The gin, with its associated bookkeeper's office, scale house, and pump house, represents a good example of a mid-twentieth-century cotton gin. The Kemp Cotton Gin Historic District is also being nominated to the National Register with **local significance** under **Criterion A** for its associations with the role of cotton production in the agricultural history of Rohwer and Desha County. The nomination for the Kemp Cotton Gin Historic District is being submitted under the multiple-property listing "Get Down the Shovel and the Hoe!: Cotton and Rice Farm History and Architecture in the Arkansas Delta, 1900-1955."

ELABORATION

Desha County was formed on December 12, 1838, and was named after Captain Ben Desha. Desha, whose brother Joseph Desha was a general in the U.S. Army and governor of Kentucky, was appointed by James Monroe as the receiver of public moneys in the Arkansas Territory in 1822. Although a portion of Desha County was attached to Drew County on January 21, 1861, a part of Chicot County was annexed to Desha County on February 10, 1879, and a portion of Lincoln County was annexed on March 10, 1880.¹

In its early days, the development of the county was severely hampered by the Mississippi River, which often inundated the area, destroying property and retarding the growth of crops. It was only after the record 1927 Mississippi River flood that Congress authorized a federal program of river control, which really made large-scale agriculture a safer reality. (Rohwer is located approximately one mile west of the levee and approximately 7.5 miles west of the Mississippi River currently.)²

Little is known about the early history of Rohwer. By 1872, the line of the Little Rock, Pine Bluff & New Orleans Railroad was planned through the Rohwer vicinity, and by 1895 the Mississippi River and Northwestern Railroad had a line that came south out of Watson, through Rohwer, to Arkansas City.³ A post office was established in 1901 and the settlement was named Harding. However, the name was changed to Rohwer in 1904.⁴

¹ *The Goodspeed Biographical and Historical Memoirs of Southern Arkansas*. Chicago: The Goodspeed Publishing Company, 1890, p. 997, and information on Desha County from www.couchgenweb.com/arkansas/desha.

² Elliott West. *The WPA Guide to 1930s Arkansas*. Lawrence, KS: University Press of Kansas, 1987 reprint of 1941 publication p. 43.

³ *Maps showing Arkansas Central, the Helena & Corinth, and the Pine Bluff & Southwestern Railroads together forming the Texas & Northeastern Railway*. Map. New York, G.W. & C. B. Colton & Co., 1872, and *Cram's Township and Rail Road Map of Arkansas*. Map. Chicago, George Franklin Cram, 1895.

⁴ Russell Pierce Baker. *From Memdag to Norsk: A Historical Directory of Arkansas Post Offices, 1832-1971*. Hot Springs, AR: Arkansas Genealogical Society, 1988, p. 99 and 192.

United States Department of the Interior

National Park Service

National Register of Historic Places Continuation Sheet

Section number 8 Page 2

Early on, Rohwer was a small community serving the needs of the farmers in its rural part of Desha County. However, the isolated location of the community in the center of the country was appealing to the War Relocation Authority, which was responsible for the establishment of relocation centers for Japanese-Americans. From 1942 until late 1945, approximately 10,000 people lived at the 10,161-acre Rohwer Relocation Center located just to the north of the community (NR-listed 07/30/74, NHL 07/06/92). Once the center was disbanded, however, many of the center's buildings were demolished or relocated to other parts of the county, and the land reverted back to its agricultural roots.⁵

With increased agricultural activity in the Rohwer vicinity after the closing of the relocation center, O. O. Kemp built his cotton gin c.1950 in the heart of Rohwer just west of the Missouri Pacific railroad line. The location was ideal being near the railroad line and Arkansas Highway 1, which allowed easy access to means of transportation, and also being near the surrounding farmland. In addition to the cotton gin, a pump house and scale house were also built on the site. As the business grew, Kemp built the bookkeeper's office at a later date, likely c.1955, to have a centralized place from which to run the business.⁶

When Kemp retired from running the gin, the property was acquired by W. F. Rice. Subsequently, it was purchased by Bill Smith, and then by the Baxter Land Company of Kelso, Arkansas. The gin remained in continuous use until c.1975 when it was closed, a fate that has befallen many smaller gins in Arkansas.

Currently, the building is owned by Jake Kemp, grandson of the O. O. Kemp, the gin's builder. Although the original equipment has been removed from the gin, Kemp is proud of the building's connection to his family. As a result, the complex is well maintained and the gin is currently used for storage.

As the number of cotton gins steadily declines across Arkansas, intact cotton gin complexes will become rarer and more significant as reflections of Arkansas's agricultural history. Today the Kemp Cotton Gin Historic District with its gin, scale house, pump house, and bookkeeper's office represents an excellent example of a mid-twentieth-century gin complex. Although no longer used, it remains a wonderful monument to the agricultural heritage of Desha County.

STATEMENT OF SIGNIFICANCE

The Kemp Cotton Gin Historic District, which was built c.1950, is being nominated to the National Register of Historic Places under **Criterion C** with **local significance** as the only example of a cotton gin in the

⁵ Dianna Kirk. "National Register of Historic Places Inventory - Nomination Form for the Rohwer Relocation Center Site." In the files of the Arkansas Historic Preservation Program, 1974.

⁶ Jake Kemp. Telephone conversation with the author. 9 September 2004.

United States Department of the Interior

National Park Service

National Register of Historic Places

Continuation Sheet

Section number 8 Page 3

Rohwer vicinity. The gin, with its associated bookkeeper's office, scale house, and pump house, represents a good example of a mid-twentieth-century cotton gin. The Kemp Cotton Gin Historic District is also being nominated to the National Register with **local significance** under **Criterion A** for its associations with the role of cotton production in the agricultural history of Rohwer and Desha County. The nomination for the Kemp Cotton Gin Historic District is being submitted under the multiple-property listing "Get Down the Shovel and the Hoe!: Cotton and Rice Farm History and Architecture in the Arkansas Delta, 1900-1955."

United States Department of the Interior
National Park Service

National Register of Historic Places Continuation Sheet

Section number 9 Page 1

BIBLIOGRAPHY

Baker, Russell Pierce. *From Memdag to Norsk: A Historical Directory of Arkansas Post Offices, 1832-1971*. Hot Springs, AR: Arkansas Genealogical Society, 1988.

Cram's Township and Rail Road Map of Arkansas. Map. Chicago, George Franklin Cram, 1895.

The Goodspeed Biographical and Historical Memoirs of Southern Arkansas. Chicago: The Goodspeed Publishing Company, 1890.

Information on Desha County from www.couchgenweb.com/arkansas/desha.

Kemp, Jake. Telephone conversation with the author. 9 September 2004.

Kirk, Dianna. "National Register of Historic Places Inventory – Nomination Form for the Rohwer Relocation Center Site." In the files of the Arkansas Historic Preservation Program, 1974.

Maps showing Arkansas Central, the Helena & Corinth, and the Pine Bluff & Southwestern Railroads together forming the Texas & Northeastern Railway. Map. New York, G.W. & C. B. Colton & Co., 1872,

West, Elliott. *The WPA Guide to 1930s Arkansas*. Lawrence, KS: University Press of Kansas, 1987 reprint of 1941 publication.

Kemp Cotton Gin Historic District
Name of Property

Desha County, Arkansas
County and State

10. Geographical Data

Acreage of Property Approximately 2.25 acres.

UTM References

(Place additional UTM references on a continuation sheet.)

1 15 659610 3737067
Zone Easting Northing
2 _____

3 _____
Zone Easting Northing
4 _____

☐ See continuation sheet

Verbal Boundary Description

(Describe the boundaries of the property on a continuation sheet.)

Boundary Justification

(Explain why the boundaries were selected on a continuation sheet.)

11. Form Prepared By

name/title Ralph S. Wilcox, National Register & Survey Coordinator
organization Arkansas Historic Preservation Program date December 15, 2004
street & number 1500 Tower Building, 323 Center Street telephone (501) 324-9787
city or town Little Rock state AR zip code 72201

Additional Documentation

Submit the following items with the completed form:

Continuation Sheets

Maps

A **USGS map** (7.5 or 15 minute series) indicating the property's location

A **Sketch map** for historic districts and properties having large acreage or numerous resources.

Photographs

Representative **black and white photographs** of the property.

Additional items

(Check with the SHPO or FPO for any additional items.)

Property Owner

(Complete this item at the request of SHPO or FPO.)

name Jake Kemp
street & number 1408 Crooked Bayou telephone _____
city or town McGehee state AR zip code 71654

Paperwork Reduction Act Statement: This information is being collected for applications to the National Register of Historic Places to nominate properties for listing or determine eligibility for listing, to list properties, and to amend existing listing. Response to this request is required to obtain a benefit in accordance with the National Historic Preservation Act, as amended (16 U.S.C. 470 *et seq.*)

Estimated Burden Statement: Public reporting burden for this form is estimated to average 18.1 hours per response including time for reviewing instructions, gathering and maintaining data, and completing and reviewing the form. Direct comments regarding this burden estimate or any aspect of this form to the Chief, Administrative Services Division, National Park Service, P. O. Box 37127, Washington, DC 20013-7127; and the Office of Management and Budget, Paperwork Reductions Projects (1024-0018), Washington, DC 20303.

United States Department of the Interior

National Park Service

National Register of Historic Places Continuation Sheet

Section number 10 Page 1

VERBAL BOUNDARY DESCRIPTION

Beginning at the northwest corner of the Desha County Road 227 and Missouri Pacific railroad line intersection, proceed westerly 330 feet along the north side of Desha County Road 227, thence proceed northerly 270 feet, thence proceed easterly 310 feet, thence proceed southerly 350 feet along the west side of the Missouri Pacific railroad line to the point of beginning.

BOUNDARY JUSTIFICATION

The boundary contains the land that is historically associated with the Kemp Cotton Gin Historic District.

UNITED STATES DEPARTMENT OF THE INTERIOR
NATIONAL PARK SERVICE

NATIONAL REGISTER OF HISTORIC PLACES
EVALUATION/RETURN SHEET

REQUESTED ACTION: NOMINATION

PROPERTY NAME: Kemp Cotton Gin Historic District

MULTIPLE NAME: Cotton and Rice Farm History and Architecture in the Arkansas Delta MPS

STATE & COUNTY: ARKANSAS, Desha

DATE RECEIVED: 4/18/05 DATE OF PENDING LIST: 5/17/05
DATE OF 16TH DAY: 6/01/05 DATE OF 45TH DAY: 6/01/05
DATE OF WEEKLY LIST:

REFERENCE NUMBER: 05000491

REASONS FOR REVIEW:

APPEAL: N DATA PROBLEM: N LANDSCAPE: N LESS THAN 50 YEARS: N
OTHER: N PDIL: N PERIOD: N PROGRAM UNAPPROVED: N
REQUEST: N SAMPLE: N SLR DRAFT: N NATIONAL: N

COMMENT WAIVER: N

☒ ACCEPT ☐ RETURN ☐ REJECT 6/1/05 DATE

ABSTRACT/SUMMARY COMMENTS:

Entered in the
National Register

RECOM./CRITERIA _____

REVIEWER _____ DISCIPLINE _____

TELEPHONE _____ DATE _____

DOCUMENTATION see attached comments Y/N see attached SLR Y/N

If a nomination is returned to the nominating authority, the nomination is no longer under consideration by the NPS.



KEMP COTTON GIN HISTORIC DISTRICT

DESHA COUNTY, AR

SARAH JAMPOLE

SEPTEMBER 2004

ARKANSAS HISTORIC PRESERVATION PROGRAM, LITTLE ROCK, AR

PUMPHOUSE NORTH AND WEST FACADES, LOOKING SOUTHEAST



KEMP COTTON GIN HISTORIC DISTRICT

DESHA COUNTY, AR

SARAH JAMPOLE

SEPTEMBER 2004

ARKANSAS HISTORIC PRESERVATION PROGRAM, LITTLE ROCK, AR

COTTON GIN SOUTH AND WEST FACADES, LOOKING NORTHEAST



KEMP COTTON GIN HISTORIC DISTRICT

DESHA COUNTY, AR

SARAH JAMPOLE

SEPTEMBER 2004

ARKANSAS HISTORIC PRESERVATION PROGRAM, LITTLE ROCK, AR

BOOKKEEPER'S OFFICE SOUTH AND WEST FACADES, LOOKING NORTHEAST



KEMP COTTON GIN HISTORIC DISTRICT

DESHA COUNTY, AR

SARAH JAMPOLE

SEPTEMBER 2004

ARKANSAS HISTORIC PRESERVATION PROGRAM, LITTLE ROCK, AR

BOOKKEEPER'S OFFICE NORTH AND EAST FACADES, LOOKING SOUTHWEST



KEMP COTTON GIN HISTORIC DISTRICT

DESHA COUNTY, AR

SARAH JAMPOLE

SEPTEMBER 2004

ARKANSAS HISTORIC PRESERVATION PROGRAM, LITTLE ROCK, AR

SCALE HOUSE SOUTH FACADE, LOOKING NORTH



KEMP COTTON GIN HISTORIC DISTRICT

DESHA COUNTY, AR

SARAH JAMPOLE

SEPTEMBER 2004

ARKANSAS HISTORIC PRESERVATION PROGRAM, LITTLE ROCK, AR

SCALE HOUSE NORTH AND EAST FACADES, LOOKING SOUTHWEST



KEMP COTTON GIN HISTORIC DISTRICT

DESHA COUNTY, AR

SARAH JAMPOLE

SEPTEMBER 2004

ARKANSAS HISTORIC PRESERVATION PROGRAM, LITTLE ROCK, AR
COTTON GIN NORTH AND EAST FACADES, LOOKING SOUTHWEST



KEMP COTTON GIN HISTORIC DISTRICT

DESHA COUNTY, AR

SARAH JAMPOLE

SEPTEMBER 2004

ARKANSAS HISTORIC PRESERVATION PROGRAM, LITTLE ROCK, AR

COTTON GIN LOADING DOCK, LOOKING WEST



KEMP COTTON GIN HISTORIC DISTRICT

DESHA COUNTY, AR

SARAH JAMPOLE

SEPTEMBER 2004

ARKANSAS HISTORIC PRESERVATION PROGRAM, LITTLE ROCK, AR

COTTON GIN NORTH AND WEST FACADES, LOOKING SOUTHEAST



KEMP COTTON GIN HISTORIC DISTRICT

DESHA COUNTY, AR

SARAH JAMPOLE

SEPTEMBER 2004

ARKANSAS HISTORIC PRESERVATION PROGRAM, LITTLE ROCK, AR

COTTON GIN SOUTH AND EAST FACADES, LOOKING NORTHWEST

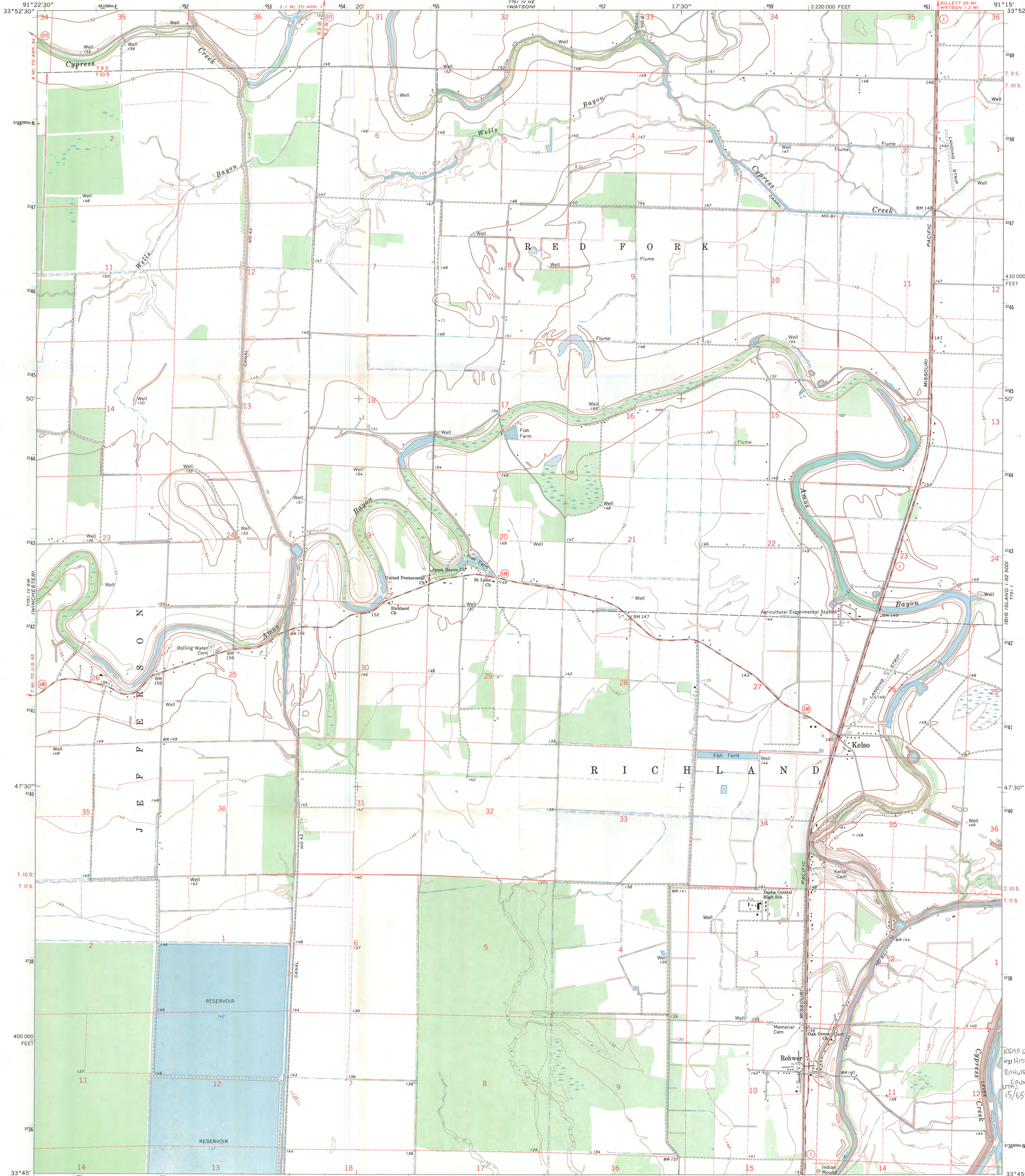

Maped, edited, and published by the Geological Survey
Control by USGS and USC&GS
Planimetry by photogrammetric methods from aerial photographs taken 1966. Topography by planimetric surveys 1969
Polyconic projection. 1927 North American datum
10,000-foot grid based on Arkansas coordinate system, south zone
1000-meter Universal Transverse Mercator grid ticks, zone 15, shown in blue
Fine red dashed lines indicate selected fence and field lines where generally visible on aerial photographs. This information is unchecked

UTM GRID AND 1969 MAGNETIC NORTH DECLINATION AT CENTER OF SHEET

THIS MAP COMPLIES WITH NATIONAL MAP ACCURACY STANDARDS
FOR SALE BY U. S. GEOLOGICAL SURVEY, DENVER, COLORADO 80225, OR WASHINGTON, D. C. 20242
AND BY THE ARKANSAS GEOLOGICAL COMMISSION, LITTLE ROCK, ARKANSAS 72201
A FOLDER DESCRIBING TOPOGRAPHIC MAPS AND SYMBOLS IS AVAILABLE ON REQUEST

ROAD CLASSIFICATION
Secondary highway, all weather. Light-duty road, all weather, hard surface.
Unimproved road, fair or dry weather.
State Route

KELSO, ARK.
SE 1/4 DUMAS 15' QUADRANGLE
N3345—W9115/7.5
1969
AMS 7751 IV SE—SERIES V884



The Department of Arkansas Heritage

Mike Huckabee, Governor
Cathie Matthews, Director

Arkansas Arts Council

Arkansas Natural Heritage
Commission

Historic Arkansas Museum

Delta Cultural Center

Old State House Museum



Arkansas Historic Preservation Program

1500 Tower Building

323 Center Street

Little Rock, AR 72201

(501)324-9880

fax: (501)324-9184

tdd: (501)324-9811

e-mail:

info@arkansaspreservation.org

website:

www.arkansaspreservation.org

April 6, 2005

Carol D. Shull
Chief of Registration
United States Department of the Interior
National Register of Historic Places
National Park Service
8th Floor
1201 Eye Street, NW
Washington, DC 20005

RE: Kemp Cotton Gin Historic District – Rohwer, Desha
County, Arkansas

Dear Carol:

We are enclosing for your review the above-referenced nomination. The Arkansas Historic Preservation Program has complied with all applicable nominating procedures and notification requirements in the nomination process.

If you need further information, please call Ralph S. Wilcox of my staff at (501) 324-9787. Thank you for your cooperation in this matter.

Sincerely,

Cathie Matthews
State Historic Preservation Officer

CM:rsw

Enclosure



An Equal Opportunity Employer

