

United States Department of the Interior
National Park Service

National Register of Historic Places
Registration Form

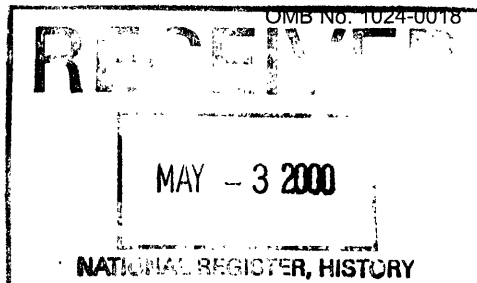

This form is for use in nominating or requesting determinations for individual properties and districts. See instructions in How to Complete the National Register of Historic Places Registration Form (National Register Bulletin 16A). Complete each item in the appropriate box or by entering the information requested. If any item does not apply to the property being documented, enter "N/A" for not applicable. For functions, architectural classification, materials, and areas of significance, enter only categories and subcategories from the instructions. Place additional entries and narrative items on continuation sheets (NPS Form 10-900a). Use a typewriter, word processor, or computer to complete all items.

1. Name of Property

historic name Great Falls Downtown Historic District
other names/site number _____

2. Location

street & number Dearborn Street (between Church Street and Republic Street) not for publication _____
city or town Great Falls vicinity _____
state South Carolina code SC county Chester code 023 zip code 29055

3. State/Federal Agency Certification

As the designated authority under the National Historic Preservation Act of 1986, as amended, I hereby certify that this X nomination ___ request for determination of eligibility meets the documentation standards for registering properties in the National Register of Historic Places and meets the procedural and professional requirements set forth in 36 CFR Part 60. In my opinion, the property X meets ___ does not meet the National Register Criteria. I recommend that this property be considered significant ___ nationally ___ statewide X locally. (___ See continuation sheet for additional comments.)

Mary W. Edmonds 4/28/2000
Signature of certifying official Date

Mary W. Edmonds, Deputy State Historic Preservation Officer, S.C. Dept. of Archives and History, Columbia, S.C.
State or Federal agency and bureau

In my opinion, the property ___ meets ___ does not meet the National Register criteria. (___ See continuation sheet for additional comments.)

Signature of commenting or other official Date

State or Federal agency and bureau

4. National Park Service Certification

I, hereby certify that this property is:

entered in the National Register
___ See continuation sheet.

___ determined eligible for the
National Register
___ See continuation sheet.

___ determined not eligible for the
National Register

___ removed from the National Register

___ other (explain): _____

Edson H. Beall 6-2-00
Signature of the Keeper Date of Action

Great Falls Downtown Historic District
Name of Property

Chester County, South Carolina
County and State

5. Classification

Ownership of Property
(Check as many boxes as apply)

Category of Property
(Check only one box)

Number of Resources within Property
(Do not include previously listed resources)

- private
- public-local
- public-State
- public-Federal

- building(s)
- district
- site
- structure
- object

Contributing	Noncontributing	
14	1	buildings
_____	_____	sites
_____	_____	structures
_____	_____	objects
14	1	Total

Name of related multiple property listing
(Enter "N/A" if property is not part of a multiple property listing.)
N/A

Number of contributing resources previously listed
in the National Register
1

6. Function or Use

Historic Functions
(Enter categories from instructions)

Category: Commerce
Commerce
Commerce
Commerce
Recreation and Culture

Subcategory: business
financial institution
specialty store
department store
theater

Current Functions
(Enter categories from instructions)

Category: Commerce
Commerce
Vacant/Not In Use

Subcategory: business
specialty store

7. Description

Architectural Classification
(Enter categories from instructions)
Early 20th Century Revivals

Materials
(Enter categories from instructions)
foundation brick
walls brick
limestone
roof asphalt
other stucco
terra cotta

Narrative Description

(Describe the historic and current condition of the property on one or more continuation sheets.)

Great Falls Downtown Historic District
Name of Property

Chester County, South Carolina
County and State

8. Statement of Significance

Applicable National Register Criteria

(Mark "x" in one or more boxes for the criteria qualifying the property for National Register listing)

- A Property is associated with events that have made a significant contribution to the broad patterns of our history.
- B Property is associated with the lives of persons significant in our past.
- C Property embodies the distinctive characteristics of a type, period, or method of construction or represents the work of a master, or possesses high artistic values, or represents a significant and distinguishable entity whose components lack individual distinction.
- D Property has yielded, or is likely to yield information important in prehistory or history.

Criteria Considerations

(Mark "X" in all the boxes that apply.)

- a owned by a religious institution or used for religious purposes.
- b removed from its original location.
- c a birthplace or a grave.
- d a cemetery.
- e a reconstructed building, object, or structure.
- f a commemorative property.
- g less than 50 years of age or achieved significance within the past 50 years.

Areas of Significance

(Enter categories from instructions)

Architecture
Commerce

Period of Significance

ca. 1910 – ca. 1930

Significant Dates

Significant Person

(Complete if Criterion B is marked above)

Cultural Affiliation

Architect/Builder

Sirrine, Joseph Emory
Potter & Shackelford

Narrative Statement of Significance

Explain the significance of the property on one or more continuation sheets.)

9. Major Bibliographical References

(Cite the books, articles, and other sources used in preparing this form on one or more continuation sheets.)

Previous documentation on file (NPS):

- preliminary determination of individual listing (36 CFR 67) has been requested.
- previously listed in the National Register
- previously determined eligible by the National Register
- designated a National Historic Landmark
- recorded by Historic American Buildings Survey # _____
- recorded by Historic American Engineering Record # _____

Primary location of additional data:

- State Historic Preservation Office
 - Other State agency
 - Federal agency
 - Local government
 - University
 - Other
- Name of repository:
Great Falls Hometown Association,
Great Falls, S.C.

Great Falls Downtown Historic District
Name of Property

Chester County, South Carolina
County and State

10. Geographical Data

Acreeage of Property 12.6 acres

UTM References

(Place additional UTM references on a continuation sheet)

Zone Easting Northing	Zone Easting Northing	Zone Easting Northing
1 17 510097 3825045	3 17 510143 3824809	5 17 510058 3824912
2 17 510135 3824912	4 17 510047 3824805	6 17 510069 3825048

See continuation sheet.

Verbal Boundary Description (Describe the boundaries of the property on a continuation sheet.)

Boundary Justification (Explain why the boundaries were selected on a continuation sheet.)

11. Form Prepared By

name/title Sandra Scurry Varner, Elizabeth Wilson, David McKeown (with assistance from SHPO staff)
organization Great Falls Hometown Association, Inc. date February 2000
street & number Post Office Box 215 telephone (803) 482-6265
city or town Great Falls state SC zip code 29055

Additional Documentation

Submit the following items with the completed form:

Continuation Sheets

Maps

- A USGS map (7.5 or 15 minute series) indicating the property's location.
- A sketch map for historic districts and properties having large acreage or numerous resources.

Photographs

Representative black and white photographs of the property.

Additional items

(Check with the SHPO or FPO for any additional items)

Property Owner

(Complete this item at the request of the SHPO or FPO.)

name Multiple owners (see continuation sheets)
street & number _____ telephone _____
city or town _____ state _____ zip code _____

Paperwork Reduction Act Statement: This information is being collected for applications to the National Register of Historic Places to nominate properties for listing or determine eligibility for listing, to list properties, and to amend existing listings. Response to this request is required to obtain a benefit in accordance with the National Historic Preservation Act, as amended (16 U.S.C. 470 et seq.). **Estimated Burden Statement:** Public reporting burden for this form is estimated to average 18.1 hours per response including the time for reviewing instructions, gathering and maintaining data, and completing and reviewing the form. Direct comments regarding this burden estimate or any aspect of this form to the Chief, Administrative Services Division, National Park Service, P.O. Box 37127, Washington, DC 20013-7127; and the Office of Management and Budget, Paperwork Reductions Project (1024-0018), Washington, DC 20503.

United States Department of the Interior
National Park Service

National Register of Historic Places
Continuation Sheet

Section number 7 Page 5

Great Falls Downtown Historic District
Name of Property
Chester County, South Carolina
County and State

The Great Falls Downtown Historic District includes fourteen contributing buildings and one non-contributing building on Dearborn Street between Church Street and Republic Street in the Town of Great Falls, in eastern Chester County on the Catawba River. The contributing properties represent the development of the downtown as a center of commerce between circa 1910 and circa 1930. The owners of the Republic Cotton Mills contracted with Joseph Emory Serrine & Company of Greenville, South Carolina, to design the mills, residential villages, company store, bank building, theatre and store buildings.¹ The theatre and store buildings were begun in 1921. Buildings #2, #3 and #6 through #14 (see list below) were designed by Serrine & Company and all had similar details, including sandstone brick, sloped tar paper roofs, terra-cotta cornices, and white cast concrete cap parapets. Buildings #6 through #14 were designed with double display windows beside each entrance and transom glass above the windows. All buildings within the district are in a commercial setting which comprises most of the downtown area of Great Falls. The downtown is surrounded by three mill villages that housed the mill workers. Villages #1 and #2 are bordered by the Catawba River, a diversion canal, and three Duke hydro plants. Mill #3 is bordered by US Highway 21 and SC 200.

The following properties contribute to the character of the Great Falls Downtown Historic District:

1. The Company Store – 651 Dearborn Street (ca. 1910)

The Republic Cotton Mills constructed this two-story brick building in 1910 at a cost of \$8,000.

Exterior (Original and Present):

There are double display windows on either side of the entrance. The brick walls have been painted white. The white paint has faded significantly. There are several chimneys, a hipped roof, jack arches, a central curvilinear gable and exposed rafter tails.

Interior (Original and Present):

The original wood flooring and pressed metal ceilings are still in repairable condition.

Uses During Period Of Significance:

This was the first commercial building in Great Falls. The street level contained grocery, drug, dry good, millinery and coffin departments. The first public school was located in the upper level until 1916 when it became the Masonic lodge hall. In 1921 the lower level became the McFadden Mercantile Company. Belk Department Stores took over the operation in 1939. One-half of the building was Belk Department Store and the other half was a pool room. It has been vacant since 1982 when the Belk store closed.

Alterations:

Permastone was applied to the front lower level of the building by the Belk Company, leaving all historic storefront material in place.

¹ John E. Wells and Robert E. Dalton, The South Carolina Architects, 1885-1935: A Biographical Dictionary (Richmond, Virginia: New South Architectural Press, 1992), 164-167.

United States Department of the Interior
National Park Service

National Register of Historic Places
Continuation Sheet

Section number 7 Page 6

Great Falls Downtown Historic District
Name of Property
Chester County, South Carolina
County and State

2. Republic Cotton Mills Bank and Store Building – 810 Dearborn Street (ca. 1917)

This two-story brick building was the first architecturally designed public building in the Town of Great Falls. It was designed and built by Joseph Emory Sistine in the Renaissance Revival style for the Republic Cotton Mills at a cost of \$35,000.

Exterior (Original and Present):

Constructed of sandstone-colored brick, the building is organized with a full rusticated brick first level, a short second level of smooth brick, and a full entablature and roof parapet. Its first level street façade is five bays in width, consisting of three large segmental arched commercial windows [originally all with a tripartite window division and corresponding paneled brick bulkhead; only the one to the far right of the façade or northernmost remains] with radiating voussoir. Between the three large bays are two limestone-surrounded double-leaf door infilled entry portals with denticulated shelf-architraves. Along the exposed, six-bay deep side elevation is a large plate glass window with transom at the front corner and five small square windows located high along the wall. A brick and terra cotta cornice separates the first and second levels. Eleven one-over-one light, double-hung sash windows line the street façade, with six along the side elevation. A soldier course and terra cotta moulding caps the windows and surrounds the building. Above this is a brick frieze and a denticulated and modillioned protruding cornice which wraps the front and side elevations. A brick roof parapet is capped with a cast stone coping. The building's condition is good. See alterations below.

Interior (Original and Present):

1st Floor – wood floor has been covered by tile, plaster walls have been paneled and pressed tin ceiling has been covered with a dropped ceiling.

2nd Floor – wood floor, plaster walls and ceiling consist of original materials.

Uses During Period Of Significance:

The property housed the financial, medical, legal and educational services for the developing community. The first floor was used as a bank, drugstore and post office. The second floor contained twelve (12) offices which were used by doctors, lawyers, dentists and as a public library. It has been empty since 1990.

Alterations:

The Town of Great Falls replaced the roof in 1998 with the same type materials. At an unknown date the window area was altered with gravel inserts and window treatments.

3. The Republic Theatre – 806 Dearborn Street (ca. 1921)

This property was individually listed in the National Register of Historic Places on November 26, 1980.

United States Department of the Interior
National Park Service

National Register of Historic Places
Continuation Sheet

Section number 7 Page 7

Great Falls Downtown Historic District
Name of Property
Chester County, South Carolina
County and State

4. Western Union Telegraph Office – 804 Dearborn Street (ca. 1930)

This one-story brick building was built by the Republic Cotton Mills to house the Western Union Telegraph office. It was later used as a medical office and is currently the home of the Great Falls Insurance Agency.

Exterior (Original and Present):

There is a corbeled base for the chimney stack. The original brick has been painted.

Interior (Original and Present):

The brick walls have been painted.

Uses During Period Of Significance:

This building originally housed the Western Union Telegraph Office.

Alterations:

Alterations consist of siding over front window and door with a corbeled cornice and exterior chimney flue. There are two windows on the side.

5. Ice House – 647 Dearborn Street (ca. 1919)

This one-story brick structure was built by The Republic Cotton Mills to house the manufacture of ice. It is currently an automotive repair shop.

Exterior (Original and Present):

There is a modern flat-roofed shed, segmental arched windows infilled with brick. The original brick wall has been painted.

Interior (Original and Present):

The original cement and brick interior remains.

Uses During Period Of Significance:

The building was originally used to manufacture ice.

Alterations:

The roof has been extended to accommodate the shed configuration. Bricked-in segmented arched windows.

Properties #6 through #14 constitute a commercial block. The interior and exterior descriptions are grouped together because the buildings share a common design and materials. The row of stores is composed of one-part commercial block buildings influenced by the Classical Revival Style. The buildings were designed by Joseph Emory Sirrine and built in 1921 by Potter and Shackelford of Greenville, S. C. at a cost of \$56,489.16. The funds were provided by The Republic Cotton Mills in order to provide a commercial district for the growing textile town.

Exterior (Original)

The exterior consists of a gabled and stepped parapet, coping, white glazed terra cotta tile ornamentation, lozenge-shaped tiles, white glazed terra cotta cornice, soldier course, and white glazed terra cotta rosettes. Square inset panel details have quatrefoil decorated frieze.

United States Department of the Interior
National Park Service

National Register of Historic Places
Continuation Sheet

Section number 7 Page 8

Great Falls Downtown Historic District
Name of Property
Chester County, South Carolina
County and State

The walls are constructed of light colored sandstone brick. Originally each building had a sloped and built-up commercial type roof. Each building had double display windows flanking the entrances, with transom glass above the windows. The transoms consisted of prismatic glass with operable hopper type ventilator panels. A few transoms remain.

Interior (Original)

The interior of the buildings in the block all originally featured plastered brick walls, pressed tin ceilings, and wood floors.

6. Furniture Store – 645 Dearborn Street (ca. 1921)

Uses During Period Of Significance:

This building originally housed a furniture store and a grocery store.

Alterations:

A fire on 1/13/99 destroyed the roof and contents. The interior features were destroyed. The structure is repairable.

7. Dry Goods Store – 641 Dearborn Street (ca. 1921)

Uses During Period Of Significance:

This building originally consisted of a dry goods store and later became the Francis Department Store.

Alterations:

Black Carrera glass has been added as a border to the windows.

8. Francis Department Store – 637 Dearborn Street (ca. 1921)

Uses During Period Of Significance:

This building was used as Francis Department Store.

Alterations:

Black Carrera glass has been added as a border to the windows. Composition board painted black has been placed at the bottom of the facade.

9. Barber Shop – 635 Dearborn Street (ca. 1921)

Uses During Period Of Significance:

This building was used as a barber shop and a beauty shop. It later became a women's clothing store.

Alterations:

The façade has been painted and a belcast shingled awning has been added. Modern materials have been placed on the interior surfaces.

United States Department of the Interior
National Park Service

**National Register of Historic Places
Continuation Sheet**

Section number 7 Page 9

Great Falls Downtown Historic District
Name of Property
Chester County, South Carolina
County and State

10. Dime Store – 633 Dearborn Street (ca. 1921)

Uses During Period Of Significance:

This building was used as a dime store until 1950 and has been vacant since then.

Alterations:

The roof has collapsed due to weather deterioration. Most of the façade is damaged, with only one piece of transom remaining. The windows are boarded up. The interior ceiling and wood flooring have been destroyed.

11. Candy Kitchen – 629 Dearborn Street (ca. 1921)

Uses During Period Of Significance:

This building was used as a candy kitchen originally and was later used as a bus station and a cafe.

Alterations:

Weather deterioration has resulted in serious damage to the building. The roof has collapsed and the display windows are boarded up. The transom windows are missing. The interior ceiling and wood flooring have been destroyed.

12. Grocery Store – 627 Dearborn Street (ca. 1921)

Uses During Period Of Significance:

This building was used as a men's clothing store and later as a pool room. It has been vacant for a number of years.

Alterations:

Weather deterioration has resulted in the collapse of the roof. The display windows are boarded up and no transom remains. The ceiling and wood flooring have been destroyed.

13. Dry Goods Store – 625 Dearborn Street (ca. 1921)

Uses During Period Of Significance:

This building was originally a dry goods store. It became a grocery store from 1940 to 1984, and is currently a beauty shop.

Alterations:

An air conditioner has been inserted in a portion of one transom. Interior materials remain.

14. Ford Motor Company – 623 Dearborn Street (ca. 1921)

Uses During Period Of Significance:

This building was originally used as a Ford Motor Company dealership. It is presently used for storage.

Alterations:

The entry has been altered. The interior surfaces have been covered with modern materials.

United States Department of the Interior
National Park Service

National Register of Historic Places
Continuation Sheet

Section number 7 Page 10

Great Falls Downtown Historic District
Name of Property
Chester County, South Carolina
County and State

The following property does not contribute to the Great Falls Downtown Historic District:

- 15. U. S. Post Office – 649 Dearborn Street (ca. 1961), NONCONTRIBUTING**
Modern brick and concrete building with brick and large aluminum-framed window front.

United States Department of the Interior
National Park Service

National Register of Historic Places
Continuation Sheet

Section number 8 Page 11

Great Falls Downtown Historic District
Name of Property
Chester County, South Carolina
County and State

The Great Falls Downtown Historic District is eligible for listing in the National Register of Historic Places under Criterion A for its association with the development of the Town of Great Falls from circa 1910 to circa 1930, and under Criterion C for its architecture which exemplifies the growth and development of a textile mill community in the Piedmont of South Carolina.

The "Great Falls of the Catawba" has been a well-known natural feature throughout the recorded history of the area. Robert Mills noted in his *Statistics of South Carolina* that the falls created a great roar. Benson J. Lossing (*The Pictorial Field-Book of the Revolution*, 1860) described the area as "wild and romantic. Almost the whole volume of the river is here compressed by a rugged island into a narrow channel... There are no perpendicular falls; but down a rocky bed the river tumbles in mingled rapids and cascades, roaring and foaming."² The falls posed a barrier to navigation, and a company was formed in 1789 to build a canal to bypass the rapids. The vast water power available at the site was one of the factors in the location of a United States Armory on Mount Dearborn in 1802.³

In the early part of the Twentieth Century, visionaries were planning for the industrial development of the South through the conversion of water power into electricity. Sites with hydroelectric potential along many rivers in the Piedmont of the Carolinas became logical places to develop textile mills. In 1905, the Southern Power Company (now known as Duke Energy) was chartered to develop the potential of the Great Falls of the Catawba. The principals in this endeavor were William States Lee, a pioneering engineer; Dr. W. Gill Wylie, a Chester County native who had gained prominence as a physician in New York; and James Buchanan Duke, industrialist and investor. Southern Power completed the first power house and dam at Great Falls in 1907. The three partners, along with other investors, also organized the Republic Textile Mills Company to capitalize on the abundant power made available at the site. The first mill was online by 1910 with a few hundred workers living around the mill and a company store. A second mill and mill village was in operation by 1917, and a third by 1923. The company also constructed a downtown commercial area to serve the new community. The town was named Great Falls in honor of the nearby natural feature. The Great Falls Downtown Historic District consists of the buildings constructed by the Republic Textile Mills Company between circa 1910 and circa 1930 to provide a commercial area to meet the needs of the mill workers and their families.⁴

² Benson J. Lossing, *The Pictorial Field-Book of the Revolution*, (New York: Harper & Brothers, 1860).

³ Arthur P. Wade, "Mount Dearborn: The National Armory at Rocky Mount, South Carolina, 1802-1829", *South Carolina Historical Magazine* 81:3 (July 1980), 207, 210.

⁴ Anne P. Collins, *A Goodly Heritage: History of Chester County, South Carolina* (Columbia, SC: The R. L. Bryan Company, 1986), 276-278.

United States Department of the Interior
National Park Service

National Register of Historic Places
Continuation Sheet

Section number 8 Page 12

Great Falls Downtown Historic District
Name of Property
Chester County, South Carolina
County and State

The Great Falls Downtown Historic District possesses significance because it represents an intact collection of early twentieth century commercial buildings associated with the development of Great Falls. Thirteen of the fourteen contributing properties in the district were designed by Joseph Emory Surrine, a noted South Carolina architect who was employed by the Republic Textile Mills Company.⁵ Most of the buildings reflect the Classical Revival style which was popular for many building types during the period of construction. The district is also significant because it reflects the development of commerce in the new mill town. In the early years of Great Falls, almost all the commercial activity in the community took place in the downtown area. The area included the mill-operated company store, the block of buildings which were made available to various commercial businesses, and the buildings which housed various services, such as the bank, medical offices, and telegraph office. While this collection of buildings is similar to those in many other towns of the period, it is unique in that the entire downtown was built by the mill company and is largely intact.

⁵ Wells and Dalton.

United States Department of the Interior
National Park Service

National Register of Historic Places
Continuation Sheet

Section number 9 Page 13

Great Falls Downtown Historic District
Name of Property
Chester County, South Carolina
County and State

BIBLIOGRAPHY

- Collins, Anne P. A Goodly Heritage: History of Chester County, South Carolina. Columbia, South Carolina: The R. L. Bryan Company, 1986.
- Lossing, Benson J. The Pictorial Field-Book of the Revolution. New York: Harper & Brothers, 1860.
- Wade, Arthur P. "Mount Dearborn: The National Armory at Rocky Mount, South Carolina, 1802-1829," South Carolina Historical Magazine 81:3 (July 1980).
- Wells, John E and Robert E. Dalton. The South Carolina Architects, 1885-1935: A Biographical Dictionary. Richmond, Virginia: New South Architectural Press, 1992.

United States Department of the Interior
National Park Service

National Register of Historic Places
Continuation Sheet

Section number 10 Page 14

Great Falls Downtown Historic District
Name of Property
Chester County, South Carolina
County and State

Verbal Boundary Description

The boundaries of the Great Falls Downtown Historic District are shown as the dotted line on the accompanying map entitled "Great Falls Downtown Historic District" and drawn at the scale of 1 inch equals 220 feet.

Boundary Justification

The boundaries include the fourteen contributing and one non-contributing properties along Dearborn Street between Church Street and Republic Street. This is the historic center of the commercial district in Great Falls.

United States Department of the Interior
National Park Service

National Register of Historic Places
Continuation Sheet

Section number 11 Page 15

Great Falls Downtown Historic District
Name of Property
Chester County, South Carolina
County and State

Property Owner(s): Property ownership is provided as recorded in the Chester County Tax Assessor's Office.

<u>Property Address</u>	<u>Tax Map#</u>	<u>Owner/Address</u>
1. The Company Store 651 Dearborn Street	202-13-2-2	First Citizens Bank PO Box 418, Great Falls, SC 29055
2. Bank & Store Bldg. 910 Dearborn Street	202-10-22-8&9	Town Of Great Falls PO Box 177, Great Falls, SC 29055
3. Republic Theatre 806 Dearborn Street	202-10-10	Great Falls Home Town, Asso., Inc. PO Box 215, Great Falls, SC 29055
4. Western Union Office 804 Dearborn Street	202-10-22-11	Peni Miller PO Drawer 582, Winnsboro, SC 29180
5. Ice House 647 Dearborn Street	202-13-2-19	Toby Gladden 1 Latimer Street, Great Falls, SC 29055
6. Furniture Store 645 Dearborn Street	202-7-19-12	David & Sandra Varner PO Box 461, Great Falls, SC 29055
7. Dry Goods Store 641 Dearborn Street	202-7-19-11	Helen Lucas 72 Poplar Street, Great Falls, SC 29055
8. Francis Dept. Store 637 Dearborn Street	202-7-19-10	Ronald J. Thomasson PO Box 333, Great Falls, SC 29055
9. Barber Shop 635 Dearborn Street	202-7-19-9	Spratt Savings & Loan 121 Saluda Street, Chester, SC 29706
10. Dime Store 633 Dearborn Street	202-7-19-8	Fred Hardee & Sallie Hudson PO Box 157, Great Falls, SC 29055

United States Department of the Interior
National Park Service

National Register of Historic Places
Continuation Sheet

Section number 11 Page 16

Great Falls Downtown Historic District
Name of Property
Chester County, South Carolina
County and State

- | | | |
|-----|--|--|
| 11. | Candy Kitchen
629 Dearborn Street 202-7-19-7 | Fred Hardee & Sallie Hudson
PO Box 157, Great Falls, SC 29055 |
| 12. | Grocery Store
627 Dearborn Street 202-7-19-6 | TJ Williams & Leighmons
1 Dunaway Court, Greensboro, NC 27408 |
| 13. | Dry Goods Store
625 Dearborn Street 202-7-19-5 | Amy & Tommy Baker
625 Dearborn Street, Great Falls, SC 29055 |
| 14. | Ford Motor Company
623 Dearborn Street 202-7-19-4 | Gary Helms
1510 Danlee Drive, Lancaster, SC 29720 |
| 15. | Post Office
649 Dearborn Street 202-13-2-1 | Rosanne Moore Jeter, c/o Steve Moore,
313 Bailey Ave, Rock Hill 29732 |

United States Department of the Interior
National Park Service

National Register of Historic Places
Continuation Sheet

Section number Photographs Page 17 Great Falls Downtown Historic District
Name of Property
Chester County, South Carolina
County and State

The following information is the same for each photograph:

Name of Property: Great Falls Downtown Historic District
Location of Property: Chester County, South Carolina
Photographer: Sandra Scurry Varner – photos #1 - #20, except photos #5,6,7,10,11
(photographer unknown); Kay Moore – photo #21
Location of Negatives: Great Falls Home Town Association, Inc.
Post Office Box 215
Great Falls, South Carolina 29055

Additional information for each photograph follows:

	<u>Name</u>	<u>Address</u>	<u>Date</u>	<u>Direction of camera</u>
1.	The Company Store	651 Dearborn Street	12-10-99	view to Northeast
2.	"	"	"	view to East
3.	"	"	"	view to Southeast
4.	"	"	"	view to South
5.	"	"	1918	view to North
6.	"	"	1918	view to Southeast
7.	"	"	1918	view of Interior
8.	Bank/Drugstore Bldg.	910 Dearborn Street	12-10-99	view to Northwest
9.	"	"	12-10-99	view to Southwest
10.	"	"	circa 1918	view to West
11.	"	"	circa 1921	view to Southwest
12.	Republic Theatre	806 Dearborn Street	8-17-99	view to Northwest
	& Western Union	804 Dearborn Street	"	"
13.	Bank/Drugstore Bldg.	910 Dearborn Street	12-10-99	view to Southwest
	Theatre	806 Dearborn Street	"	"
	Western Union	804 Dearborn Street	"	"
14.	Ice House	647 Dearborn Street	12-10-99	view to East
15.	Furniture Store	645 Dearborn Street	12-10-99	view to East
16.	Dry Goods Store	641 Dearborn Street	12-10-99	view to Northeast
	Francis Dept. Store	637 Dearborn Street	"	"
	Barber Shop	635 Dearborn Street	"	"
17.	Barber Shop	635 Dearborn Street	12-10-99	view to East
	Dime Store	633 Dearborn Street	"	"
	Candy Kitchen	629 Dearborn Street	"	"
	Grocery Store	627 Dearborn Street	"	"
18.	Grocery Store	627 Dearborn Street	12-10-99	view to East
	Dry Goods Store	625 Dearborn Street	"	"
	Ford Motor Company	623 Dearborn Street	"	"
19.	Streetscape	Dearborn Street	12-10-99	view to North
20.	Streetscape	Dearborn Street	6-17-99	view to Northeast
21.	Streetscape	Dearborn Street	7-13-99	view to South

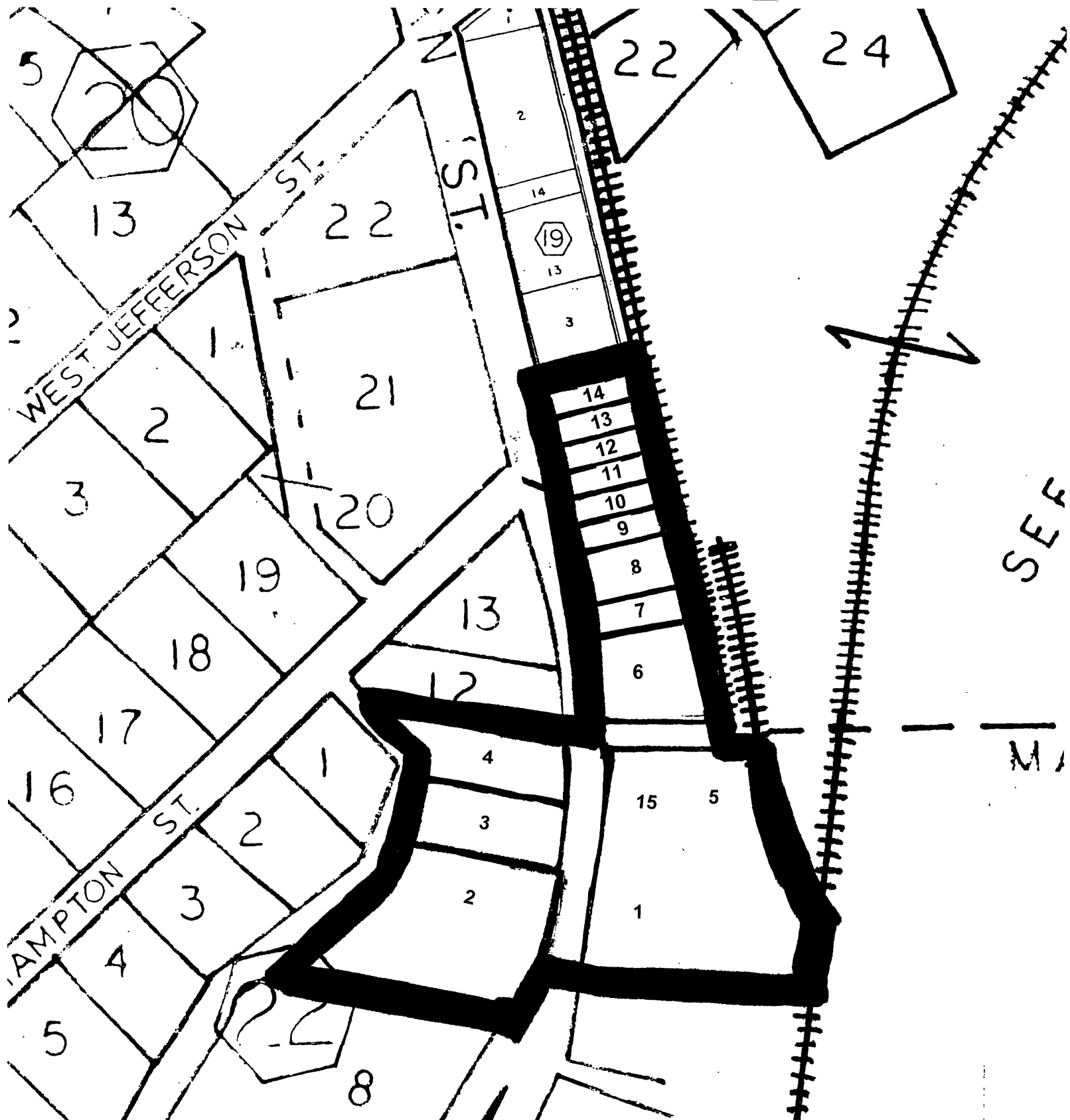

Great Falls Downtown Historic District
Great Falls, Chester County, S.C.



District Boundary

