

FORM B - BUILDING

MASSACHUSETTS HISTORICAL COMMISSION  
Office of the Secretary, State House, Boston

In Area no.	Form no.
Old Camb.	OC IIB5

1. Town Cambridge

Address 22 Larch Road

Name The Larches

Present use residential

Present owner Margaret W. Thompson  
12 Larch Road

3. Description:

Date c. 1808

Source deed records

Style Georgian

Architect unknown

Exterior wall fabric wood

Outbuildings (describe) -----

Other features conservative use of quoins  
and projecting cornice, the detailing  
in dentil, and leafed capitals.

Federal. Altered Yes Date 1915

Moved Yes Date 1915

5. Lot size:

One acre or less        Over one acre XX

Approximate frontage 240 feet

Approximate distance of building from street  
58 feet

6. Recorded by Bainbridge Bunting

Organization Cambridge Historical Comm.

Date 1964

UTM - LEXINGTON  
19/323550/4693600

2. Photo (3x3" or 3x5")  
Staple to left side of form  
Photo number 1100-19,21

4. Map. Draw sketch of building location in relation to nearest cross streets and other buildings. Indicate north.

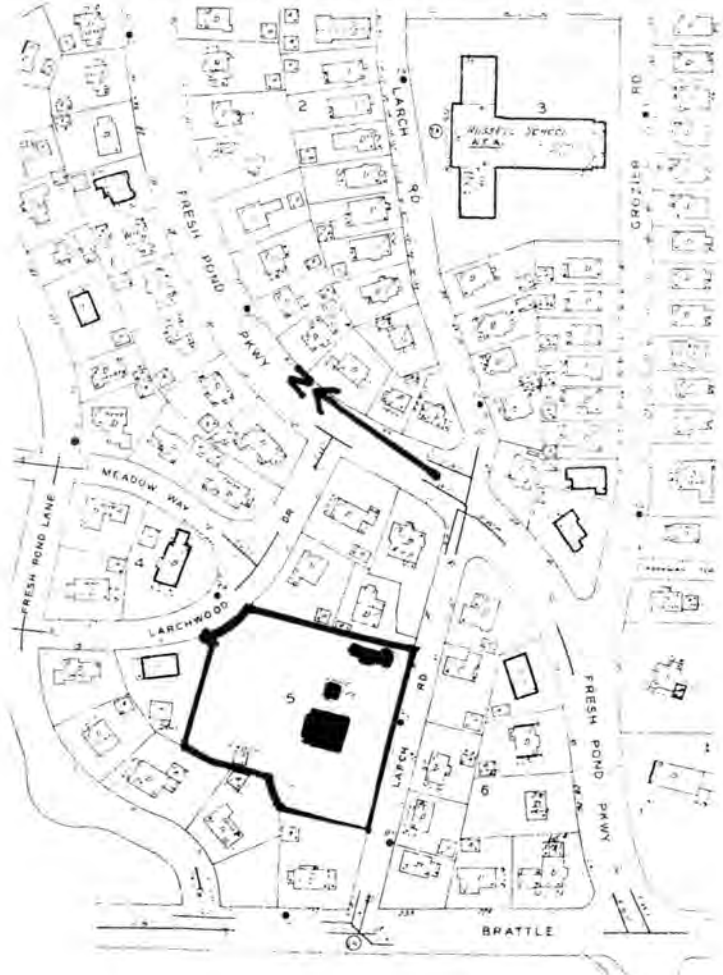

Assessor # 250-221

7. Original owner (if known) Jonathan Hastings, later William Gray

Original use residential

Subsequent uses (if any) and dates same

8. Themes (check as many as applicable)

Aboriginal	<input type="checkbox"/>	Conservation	<input type="checkbox"/>	Recreation	<input type="checkbox"/>
Agricultural	<input type="checkbox"/>	Education	<input type="checkbox"/>	Religion	<input type="checkbox"/>
Architectural	<input checked="" type="checkbox"/>	Exploration/ settlement	<input type="checkbox"/>	Science/ invention	<input type="checkbox"/>
The Arts	<input type="checkbox"/>	Industry	<input type="checkbox"/>	Social/ humanitarian	<input type="checkbox"/>
Commerce	<input type="checkbox"/>	Military	<input type="checkbox"/>	Transportation	<input type="checkbox"/>
Communication	<input type="checkbox"/>	Political	<input type="checkbox"/>		
Community development	<input checked="" type="checkbox"/>				

9. Historical significance (include explanation of themes checked above)

Built around 1808, The Larches was the mansion of the last important Cambridge estate to be subdivided for suburban development. The Larches was originally used as a summer home. In 1915, the grounds were subdivided and the Gray House and its ell were moved to their present locations, 22 and 36 Larch Road respectively. At the time of the 1915 move, alterations on 22 Larch Road were carried out by the architect Alexander Wadsworth Longfellow, Jr.

The low hip roof and delicate cornice with fretted dentils and mutules, lightened by a pattern of drilled holes is characteristic of its early 19th century date. The entrance has a graceful elliptical fan light and sidelights, and is set within a porch supported by light fluted columns with papyrus leaf capitals. The surface ornamentation implies that the designer was still compiling ornamentation in the Georgian manner.

The interior of The Larches constitutes the best surviving Federal period work in Cambridge. A graceful flight of stairs rises in a semi-circle. Doors throughout the structure are capped by delicate friezes of molded plaster. The woodwork is light and elegant in scale throughout.

The Larches is now the home of the composer Randall Thompson. It was originally built for Jonathan Hastings in 1808, and was later finished in 1810 by William Gray of Salem for his country home.

10. Bibliography and/or references (such as local histories, deeds, assessor's records, early maps, etc.)

NDV 7 4 1980

United States Department of the Interior  
National Park Service

National Register of Historic Places  
Inventory—Nomination Form



Continuation sheet

Item number

Page 11 of 17

Multiple Resource Area  
Thematic Group

Name Cambridge Multiple Resource Area  
State MA

Nomination/Type of Review

Date/Signature

- 101. Harvard Graduate Center **DOE/OWNER OBJECTION** Keeper Harvard  
Attest Harvard
- 102. Child, Francis J., House **Substantive Review** ✓ Keeper Robert M. Boyd 6.30.83  
Attest \_\_\_\_\_
- 103. Hill, Aaron, House **Substantive Review** ✓ Keeper Robert M. Boyd 6.30.83  
Attest \_\_\_\_\_
- 104. Cook, William, House **Substantive Review** ✓ Keeper William H. Brackham 4.13.82  
Attest \_\_\_\_\_
- 105. Building at 10 Follen Street **Substantive Review** ✓ Keeper William H. Brackham 4.13.82  
Attest \_\_\_\_\_
- 106. Hall Tavern **Substantive Review** ✓ Keeper Robert M. Boyd 6.30.83  
Attest \_\_\_\_\_
- 107. Cloverden (Mann House) **Substantive Review** ✓ Keeper Robert M. Boyd 6.30.83  
Attest \_\_\_\_\_
- 108. The Fairfax **DOE/OWNER OBJECTION** Keeper Harvard  
Attest Harvard
- 109. Larches, The **Substantive Review** ✓ Keeper William H. Brackham 4.13.82  
Attest \_\_\_\_\_
- 110. Holmes, Joseph, House **Substantive Review** ✓ Keeper Robert M. Boyd 6.30.83  
Attest \_\_\_\_\_



## 8. Significance

Period \_\_\_\_\_ Areas of Significance—Check and justify below

Specific dates \_\_\_\_\_ Builder/Architect \_\_\_\_\_

Statement of Significance (in one paragraph)

- \_\_\_\_\_ summary paragraph
- \_\_\_\_\_ completeness
- \_\_\_\_\_ clarity
- \_\_\_\_\_ applicable criteria
- \_\_\_\_\_ justification of areas checked
- \_\_\_\_\_ relating significance to the resource
- \_\_\_\_\_ context
- \_\_\_\_\_ relationship of integrity to significance
- \_\_\_\_\_ justification of exception
- \_\_\_\_\_ other

## 9. Major Bibliographical References

## 10. Geographical Data

Address of nominated property \_\_\_\_\_

Quadrangle name \_\_\_\_\_

UNIT References \_\_\_\_\_

Verbal boundary description and justification \_\_\_\_\_

## 11. Form Prepared By

## 12. State Historic Preservation Officer Certification

The evaluated significance of this property within the state is:

\_\_\_\_\_ national \_\_\_\_\_ state \_\_\_\_\_ local

State Historic Preservation Officer signature \_\_\_\_\_

Site \_\_\_\_\_ date \_\_\_\_\_

## 13. Other

- \_\_\_\_\_ Maps
- \_\_\_\_\_ Photographs
- \_\_\_\_\_ Other

Questions concerning this nomination may be directed to \_\_\_\_\_

Signed \_\_\_\_\_ Date \_\_\_\_\_ Phone: 202 272-3504

Comments for any item may be continued on an attached sheet



1100-21

NOV 14 1980

0760

Cambridge MA, Ma  
The Larches

(36)

22<sub>1</sub> Larch Road

1100-21



1100-19

NOV 4 1980

Cambridge MA, Ma

0760

The Larches

22 Larch Road

1100-19

Please refer to the map in the  
Multiple Property Cover Sheet  
for this property

Multiple Property Cover Sheet Reference Number: 64000275