

17/92

United States Department of the Interior
National Park Service

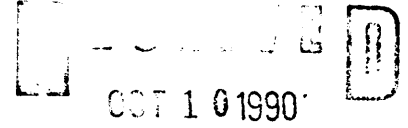

National Register of Historic Places
Registration Form

NATIONAL
REGISTER

This form is for use in nominating or requesting determinations of eligibility for individual properties or districts. See instructions in *Guidelines for Completing National Register Forms* (National Register Bulletin 18). Complete each item by marking "x" in the appropriate box or by entering the requested information. If an item does not apply to the property being documented, enter "N/A" for "not applicable." For functions, styles, materials, and areas of significance, enter only the categories and subcategories listed in the instructions. For additional space use continuation sheets (Form 10-900a). Type all entries.

1. Name of Property

historic name Lacombe School
other names/site number Lacombe Museum

2. Location

street & number corner of St. Mary and 14th Streets N/A not for publication
city, town Lacombe N/A vicinity
state Louisiana code LA county St. Tammany code 103 zip code 70445

3. Classification

Ownership of Property	Category of Property	Number of Resources within Property	
<input type="checkbox"/> private	<input checked="" type="checkbox"/> building(s)	Contributing	Noncontributing
<input checked="" type="checkbox"/> public-local	<input type="checkbox"/> district	<u>1</u>	<u>0</u> buildings
<input type="checkbox"/> public-State	<input type="checkbox"/> site	<u> </u>	<u> </u> sites
<input type="checkbox"/> public-Federal	<input type="checkbox"/> structure	<u> </u>	<u> </u> structures
	<input type="checkbox"/> object	<u>1</u>	<u>0</u> Total

Name of related multiple property listing: N/A
Number of contributing resources previously listed in the National Register 0

4. State/Federal Agency Certification

As the designated authority under the National Historic Preservation Act of 1966, as amended, I hereby certify that this nomination request for determination of eligibility meets the documentation standards for registering properties in the National Register of Historic Places and meets the procedural and professional requirements set forth in 36 CFR Part 60. In my opinion, the property meets does not meet the National Register criteria. See continuation sheet.

Leslie Tassin October 4, 1990
Signature of certifying official Leslie Tassin, LA State Historic Preservation Date
Officer, Dept of Culture, Recreation and Tourism
State or Federal agency and bureau

In my opinion, the property meets does not meet the National Register criteria. See continuation sheet.

Signature of commenting or other official _____ Date _____
State or Federal agency and bureau _____

5. National Park Service Certification

I, hereby, certify that this property is:

entered in the National Register. entered in the National Register
 See continuation sheet. 11/8/90

determined eligible for the National Register. See continuation sheet.

determined not eligible for the National Register.

removed from the National Register.

other, (explain:) _____

Andrew Byrne _____
Signature of the Keeper Date of Action

6. Function or Use

Historic Functions (enter categories from instructions)

EDUCATION/school

Current Functions (enter categories from instructions)

RECREATION & CULTURE/museum

7. Description

Architectural Classification
(enter categories from instructions)no style

Materials (enter categories from instructions)

foundation brick

walls weatherboard

roof tin

other

Describe present and historic physical appearance.

The Lacombe School (1913) is a one story, two room, frame schoolhouse located on the Lacombe Junior High School property in the old residential section of the small community. The modern junior high complex is linked to the old building by means of a covered walkway. The old school itself is very well-preserved, but there has been a noticeable side wing attached at the rear.

The Lacombe School is a plain building with a hipped tin roof. The principal feature of the facade is a pedimented entrance porch with cloakrooms on either side. The open space between the cloakrooms is highlighted by curving brackets. There are two doors, one leading into each classroom. Windows are grouped in sets of three. Sometime in the 1930s two restrooms and an office were added to the rear. They were serviced by a open hallway running parallel to the main building. In the 1940s a side lunchroom wing was attached at the southeast (rear) corner abutting the restroom/office addition. The other end of the once open hallway between the school and restroom/office addition has since been filled in with a door.

The beaded board interior basically retains its historic appearance. The building is now being used as a museum, and some of the wall surface is obscured by removable exhibit boards.

Assessment of Integrity:

Although the side wing attached at the rear corner is unsightly, it almost appears to be a separate building. The old school dominates and would immediately be recognizable to its students during the historic period.

8. Statement of Significance

Certifying official has considered the significance of this property in relation to other properties:

nationally statewide locally

Applicable National Register Criteria A B C D

Criteria Considerations (Exceptions) A B C D E F G N/A

Areas of Significance (enter categories from instructions)
education

Period of Significance
1913-1940

Significant Dates
1913-1940

Cultural Affiliation
N/A

Significant Person
N/A

Architect/Builder
Unknown

State significance of property, and justify criteria, criteria considerations, and areas and periods of significance noted above.

The Lacombe School is of local educational significance because it was the only means of receiving an elementary education within the community. The period of significance spans from 1913, when classes began, until 1940. (The school continued in the same role well into the post World War II era; hence the fifty year cutoff is being used for the ending date.)

The Lacombe School was established through the generosity of John H. Davis, Sr., who is generally regarded as the "father of Lacombe." Davis had the small settlement surveyed in 1908 under the name Oaklawn, but in 1910 the postal authorities denied the use of this name because of its similarity to another post office name. The post office instead was given the name Lacombe, after Bayou Lacombe, where the village is located. The economy of the community was based on lumber, agriculture and brickyards.

Realizing the need for a school for Lacombe, Davis in July 1912 donated land for said purpose and provided for the construction of a building. During the period of significance, grades 1-6 were taught by either one or two teachers. The school was the only one in the community, and had it not existed, children would have had to go to either Mandeville or Slidell (8 and 10 miles respectively). While such a distance is negligible today, one must remember that rural roads of the period were gravel and automobiles moved slowly. Such an obstacle would have prevented many children from attending school on a regular basis. Although there are no attendance records for the Lacombe School, photos of graduating classes and recollections of former students indicate that enrollment was anywhere from a dozen or so in the early years to around forty in the late '30s. One room of the Lacombe School was still being used for educational purposes as late as 1986.

See continuation sheet

9. Major Bibliographical References

St. Tammany Parish Conveyance Records.
Ellis, Frederick S. St. Tammany Parish: L'Autre Cote du Lac. Gretna, Louisiana:
Pelican Publishing Company, 1981
Written Recollections of Marjorie Davis Moran, Lacombe native and graddaughter of
John H. Davis, Sr. Mrs. Moran attended school in the nominated building,
beginning in 1925.
Interviews conducted by Mrs. Moran with various teachers and students of the school
during the historic period.
Primary sources (including old photos) on exhibit at the Lacombe Museum.

- See continuation sheet
- Previous documentation on file (NPS): N/A
- preliminary determination of individual listing (36 CFR 67)
has been requested
- previously listed in the National Register
- previously determined eligible by the National Register
- designated a National Historic Landmark
- recorded by Historic American Buildings
Survey # _____
- recorded by Historic American Engineering
Record # _____

- State historic preservation office
- Other State agency
- Federal agency
- Local government
- University
- Other
- Specify repository: _____

10. Geographical Data

Acreeage of property less than one acre

UTM References

A	<u>11</u> <u>5</u>	<u>2</u> <u>1</u> <u>6</u> <u>9</u> <u>4</u> <u>0</u>	<u>3</u> <u>3</u> <u>5</u> <u>7</u> <u>2</u> <u>6</u> <u>0</u>	B	<u> </u> <u> </u> <u> </u> <u> </u> <u> </u> <u> </u>	<u> </u> <u> </u> <u> </u> <u> </u> <u> </u> <u> </u>	<u> </u> <u> </u> <u> </u> <u> </u> <u> </u> <u> </u>
	Zone	Easting	Northing		Zone	Easting	Northing
C	<u> </u> <u> </u> <u> </u> <u> </u> <u> </u> <u> </u>	<u> </u> <u> </u> <u> </u> <u> </u> <u> </u> <u> </u>	<u> </u> <u> </u> <u> </u> <u> </u> <u> </u> <u> </u>	D	<u> </u> <u> </u> <u> </u> <u> </u> <u> </u> <u> </u>	<u> </u> <u> </u> <u> </u> <u> </u> <u> </u> <u> </u>	<u> </u> <u> </u> <u> </u> <u> </u> <u> </u> <u> </u>

See continuation sheet

Verbal Boundary Description

Please refer to enclosed sketch map.

See continuation sheet

Boundary Justification Boundary lines follow property lines along St. Mary and 14th streets (see map). They do not follow property lines to the rear or to the southeast because the old school is located on the grounds of a modern school complex. To have followed property lines in all instances would have meant including various modern buildings in the school complex. The boundary line cuts very closely to the rear because of the proximity of one of these modern facilities.

See continuation sheet

11. Form Prepared By

name/title National Register Staff
organization Division of Historic Preservation date July 1990
street & number P. O. Box 44247 telephone (504) 342-8160
city or town Baton Rouge state Louisiana zip code 70804

Owner: St. Tammany Parish School Board
P. O. Box 940
Covington, LA 70434-0940

Lacombe School
St. Tammany Parish, LA

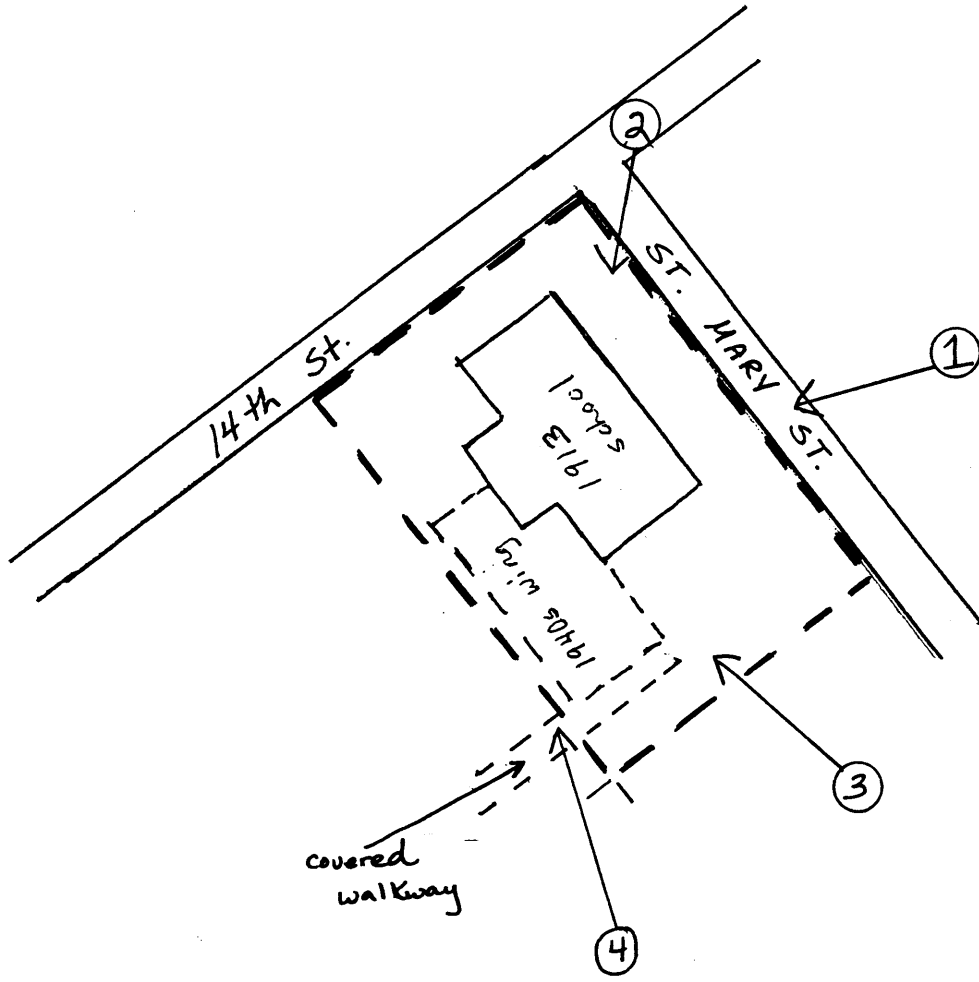

Scale: 1" = 50'



--- boundary