

**United States Department of the Interior
National Park Service**

**National Register of Historic Places
Continuation Sheet**

Section number _____ Page _____

SUPPLEMENTARY LISTING RECORD

NRIS Reference Number: 02001229

Date Listed: October 24, 2002

Property Name: Ames High School

County: Story

State: Iowa

Public Schools for Iowa: Growth and Change
Multiple Name

This property is listed in the National Register of Historic Places in accordance with the attached nomination documentation subject to the following exceptions, exclusions, or amendments, notwithstanding the National Park Service certification included in the nomination documentation.

for Michael J. V. via
Signature of the Keeper

October 24, 2002
Date of Action

Amended Items in Nomination:

Section 8: Statement of Significance

"1990" is hereby deleted as a significant date because it is not within the period of significance.

The Iowa State Historic Preservation Office was notified of this amendment.

DISTRIBUTION:

- National Register property file**
- Nominating Authority (without nomination attachment)**

AUG 27 2002

NPS Form 10-900
(Rev. 10-90)

OMB No. 10024-0018

United States Department of the Interior
National Park Service

**NATIONAL REGISTER OF HISTORIC PLACES
REGISTRATION FORM**

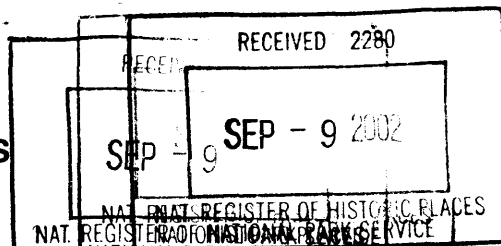

1229

This form is for use in nominating or requesting determinations for individual properties and districts. See instructions in How to Complete the National Register of Historic Places Registration Form (National Register Bulletin 16A). Complete each item by marking "x" in the appropriate box or by entering the information requested. If any item does not apply to the property being documented, enter "N/A" for "not applicable." For functions, architectural classification, materials, and areas of significance, enter only categories and subcategories from the instructions. Place additional entries and narrative items on continuation sheets (NPS Form 10-900a). Use a typewriter, word processor, or computer, to complete all items.

1. Name of Property

historic name Ames High School

other names/site number Ames City Hall

2. Location

street & number 515 Clark Avenue

not for publication N/A

city or town Ames

vicinity N/A

state Iowa code IA county Story code 169 zip code 50010

3. State/Federal Agency Certification

As the designated authority under the National Historic Preservation Act of 1966, as amended, I hereby certify that this X nomination request for determination of eligibility meets the documentation standards for registering properties in the National Register of Historic Places and meets the procedural and professional requirements set forth in 36 CFR Part 60. In my opinion, the property X meets does not meet the National Register Criteria. I recommend that this property be considered significant nationally statewide X locally.

(See continuation sheet for additional comments.)

Howell G. Lorke
Signature of certifying official

August 28, 2002
Date

STATE HISTORICAL SOCIETY OF IOWA
State or Federal agency and bureau

In my opinion, the property meets does not meet the National Register criteria.
(See continuation sheet for additional comments.)

Signature of commenting or other official

Date

State or Federal agency and bureau

4. National Park Service Certification

I hereby certify that this property is:

- entered in the National Register
See continuation sheet.
- determined eligible for the National Register
See continuation sheet.
- determined not eligible for the National Register
- removed from the National Register
- other (explain):

Daniel J. Vivian 10/24/02

Jr _____
Signature of the Keeper

Date of Action

5. Classification

Ownership of Property

(Check as many boxes as apply.)

- private
- public-local
- public-State
- public-Federal

Category of Property

(Check only one box.)

- building(s)
- district
- site
- structure
- object

Number of Resources within Property

Contributing	Noncontributing	
<u> 1 </u>	<u> 0 </u>	buildings
<u> </u>	<u> </u>	sites
<u> </u>	<u> </u>	structures
<u> </u>	<u> </u>	objects
<u> 1 </u>	<u> 0 </u>	Total

Number of contributing resources previously listed in the National Register: 0

Name of related multiple property listing (enter "N/A" if property is not part of a multiple property listing):

Public Schools for Iowa: Growth and Change, 1848-1966

Name of Property or District
County, State

Ames High School
Story County, Iowa

6. Function or Use

Historic Functions (enter categories from instructions)

Cat: EDUCATION Sub: School

Current Functions (enter categories from instructions)

Cat: GOVERNMENT Sub: City Hall

7. Description

Architectural Classification (enter categories from instructions):

Cat: LATE 19th AND 20th CENTURY REVIVALS Sub: Classical Revival

Materials (enter categories from instructions):

foundation CONCRETE

roof ASPHALT

walls BRICK

other CONCRETE

Narrative Description (Describe the historic and current condition of the property on one or more continuation sheets.)

8. Statement of Significance

Applicable National Register Criteria

(Mark "x" in one or more boxes for the criteria qualifying the property for National Register listing.)

- A Property is associated with events that have made a significant contribution to the broad patterns of our history.
- B Property is associated with the lives of persons significant in our past.
- C Property embodies the distinctive characteristics of a type, period, or method of construction or represents the work of a master, or possesses high artistic values, or represents a significant and distinguishable entity whose components lack individual distinction.
- D Property has yielded, or is likely to yield information important in prehistory or history.

Criteria Considerations

(Mark "x" in all the boxes that apply.)

- A owned by a religious institution or used for religious purposes
- B removed from its original location
- C a birthplace or a grave
- D a cemetery
- E a reconstructed building, object, or structure
- F a commemorative property
- G less than 50 years of age or achieved significance within the past 50 years

Areas of Significance (enter categories from instructions):

EDUCATION
ARCHITECTURE

Period of Significance

1938-1952

Significant Dates

1938
1990

Significant Person (complete if Criterion B is marked above)

N/A

Cultural Affiliation

Architect/Builder

Tinsley, McBroom and Higgins

Narrative Statement of Significance (Explain the significance of the property on one or more continuation sheets.)

Name of Property or District
County, State

Ames High School
Story County, Iowa

9. Major Bibliographical References

(Cite the books, articles, and other sources used in preparing this form on one or more continuation sheets.)

Previous documentation on file (NPS)

- preliminary determination of individual listing (36 CFR 67) has been requested.
- previously listed in the National Register
- previously determined eligible by the National Register
- designated a National Historic Landmark
- recorded by Historic American Buildings Survey #
- recorded by Historic American Engineering Record #

Primary Location of Additional Data

- State Historic Preservation Office
- Other State agency
- Federal agency
- Local government
- University
- Other

Name of repository

10. Geographical Data

Acreege of Property: 2 Acres

UTM References (Place additional UTM references on a continuation sheet)

	Zone	Easting	Northing		Zone	Easting	Northing
1	<u>15</u>	<u>448917.5</u>	<u>4652674.057</u>	3	<u> </u>	<u> </u>	
2	<u> </u>	<u> </u>	<u> </u>	4	<u> </u>	<u> </u>	

See continuation sheet.

Verbal Boundary Description (Describe the boundaries of the property on a continuation sheet.)

Boundary Justification (Explain why the boundaries were selected on a continuation sheet.)

Name of Property or District
County, State

Ames High School
Story County, Iowa

11. Form Prepared By

name/title Camilla Deiber, Architectural Historian

organization The Louis Berger Group, Inc.

date 7/10/02

street & number 950 50th Street

telephone 319-373-3043

city or town Marion

state Iowa

zip code 52302

Additional Documentation

(Submit the following items with the completed form.)

Continuation Sheets

Maps: A USGS map (7.5 or 15 minute series) indicating the property's location.

A sketch map for historic districts and properties having large acreage or numerous resources.

Photographs: Representative black and white photographs of the property.

Additional items (check with the SHPO or FPO for any additional items)

Property Owner

(Complete this item at the request of the SHPO or FPO.)

name City of Ames, City Manager Steve Schinker

street & number 515 Clark Avenue

telephone 515-239-5101

city or town Ames

state Iowa

zip code 50010

Paperwork Reduction Act Statement: This information is being collected for applications to the National Register of Historic Places to nominate properties for listing or determine eligibility for listing, to list properties, and to amend existing listings. Response to this request is required to obtain a benefit in accordance with the National Historic Preservation Act, as amended (16 U.S.C. 470 et seq.).

Estimated Burden Statement: Public reporting burden for this form is estimated to average 18.1 hours per response including the time for reviewing instructions, gathering and maintaining data, and completing and reviewing the form. Direct comments regarding this burden estimate or any aspect of this form to the Chief, Administrative Services Division, National Park Service, P.O. Box 37127, Washington, DC 20013-7127; and the Office of Management and Budget, Paperwork Reductions Project (1024-0018), Washington, DC 20503.

United States Department of the Interior
National Park Service

**NATIONAL REGISTER OF HISTORIC PLACES
CONTINUATION SHEET**

Section 7 Page 1 name of property: Ames High School
county, state: Story County, Iowa

DESCRIPTION SUMMARY

Ames High School, built in 1938, is a two-story Classical Revival structure that was renovated into city offices in 1990. The building retains its original auditorium, gymnasium, lobby, and library.

GENERAL DESCRIPTION

Ames High School, which is currently used as the Ames City Hall, is located at 515 Clark Avenue in Ames, Iowa. The building and parking lots encompass the entire 500 block of Clark Avenue. The building is set back approximately ten feet from the street its north, south and east side.

The two-story Classical Revival style school, designed by Tinsley, McBroom and Higgins, is laid out as a hollow rectangle. The main (east) façade is symmetrical with a central entrance pavilion flanked on either side by thirteen fenestration bays, one of which is emphasized by a slightly projecting pavilion with corbelled brick pilasters and a limestone urn and swag. The entrance pavilion features limestone pilasters that visually support a limestone entablature with dentil molding, and pediment with dentil molding and classical urn and swag motifs. Each pavilion bay has double door entries with alternate closed and broken pediments, each entry surmounted by a sixteen light window on the second level. The words, "Ames City Hall" are inscribed into the entablature.

The north façade is 21 bays wide with bays 1-5 and 17-21 slightly recessed from the main plane of the façade. The third bay is identical to the slightly projecting pavilions on the main (east) façade. Bays 18-20 form an entrance pavilion for the auditorium that is identical to the central pavilion except that it has a round arch pediment and has "Auditorium" inscribed into the entablature. Bays to either side of the auditorium entrance pavilion each have a multi-pane window with a limestone architrave and pediment on the first level and multi-pane oculus on the second level. The south façade is also 21 bays wide with a slightly projecting pavilion in bay 3. The three bays at the west end of this façade form a one-story entrance pavilion to the gymnasium that is composed of three round arch doorways, limestone swags, and a concrete cornice.

The rear (west) façade is thirteen bays wide. Six fenestration bays are separated with corbelled brick pilasters and contain one round arch multi-pane window. Bays 2-5 extend above the main roofline and are separated by corbelled brick piers. In 1990, a one-story brick loading dock that is four bays wide and one bay deep was added onto the rear façade.

INTERIOR ARRANGEMENT

The building has a hollow rectangular plan with an open courtyard. Most of the building, except the lobby, auditorium, gymnasium, and library, was gutted when the city took possession of the building in 1989. The gymnasium and auditorium are located in the west section; city offices are located in the north and south sections. A small section of hallway, located along the west wall of the courtyard, retains its original flooring, glazed block walls, and metal lockers. The remainder of the original double-loaded corridor was changed to a single loaded corridor that ran along the north and south courtyard walls. The main lobby and vestibule retained their original terrazzo flooring; but the doors were replaced with modern oak doors. New terrazzo flooring was installed in the new hallways to match the existing material in the lobby.

United States Department of the Interior
National Park Service

**NATIONAL REGISTER OF HISTORIC PLACES
CONTINUATION SHEET**

Section 7 Page 2 name of property: Ames High School
county, state: Story County, Iowa

AUDITORIUM

The auditorium, located in the northwest corner of the building, has a separate public entrance on the north façade. The auditorium lobby has a four foot high cherry dado, ceiling beams with paneled soffits supported by fluted pilasters, and terrazzo flooring set in a block design that mirrors the pattern of beams and voids on the ceiling. A staircase on the west end of the lobby leads to the balcony. Features such as an Art Deco style ticket booth, a terrazzo lined drinking foundation, and an original telephone booth are located in the lobby and have been restored to their original condition.

The auditorium has curved sidewalls and is decorated with simple classical elements such as fluted pilasters. The proscenium is framed by two pilasters and an oversized ogee molding.

GYMNASIUM

The gymnasium is located in the southwest corner of the building and also has a separate public entrance on the south façade. The space retains its pine flooring, glazed block and brick walls, round arch windows, and steel roof trusses. Original pull-out bleachers were removed during renovation.

LIBRARY

The library, which was located on the second floor above the main lobby, was converted into the city council's chambers. Originally, the library and adjoining study hall were one open room. The two rooms were separated during renovation. The space retains its original built-in oak cabinetry and oak beamed ceiling.

The school building is currently being used by the City of Ames for administrative offices. The city has no plans for further renovation or additions at the present time.

United States Department of the Interior
National Park Service

**NATIONAL REGISTER OF HISTORIC PLACES
CONTINUATION SHEET**

Section 8

Page 3

name of property: Ames High School
county, state: Story County, Iowa

SIGNIFICANCE SUMMARY

Ames High School is locally significant under Criterion A as it is associated with development and early consolidation of high school educational facilities in Ames, Iowa and is locally significant under Criterion C as it embodies significant characteristics of the Classical Revival style. Evaluation of the Ames High School for National Register eligibility is based upon criteria outlined in the Multiple Property Documentation Form *Public Schools for Iowa: Growth and Change, 1848-1966* (Beedle and Deiber 2002) under the property type "City High School." Ames High School was built to accommodate the city's entire high school population, which was previously housed in schools on the north and south sides of the city. The school, which was designed by Tinsley, McBroom and Higgins, has all of the hallmarks of the Classical Revival style including three entrance pavilions comprised of limestone pilasters, limestone entablatures with dentil molding, and pediments. The school has a high degree of integrity on its exterior and retains its integrity of design, location, feeling, setting, and association. Despite major renovation of the interior, the school building does retain its integrity of feeling, setting and association, with a number of key interior spaces remaining intact to convey the building's original character and finishes. Ames High School meets all of the requirements for registration of the city high school type including separate gymnasium and auditorium and specialized rooms for courses like home economics and art.

RESOURCE HISTORY AND HISTORIC CONTEXT

Old Central School was built in 1887 on Clark Avenue and housed both elementary and high school grades. By 1900, an addition was constructed to accommodate an increasing enrollment. In 1911, the first high school building in Ames was constructed across the street from Old Central. It contained a 700-seat auditorium, gymnasium, specialized classrooms, and a library. A second high school building, called Lincoln, was approved for the south side of town that same year.

Increases in high school enrollment in the 1930s led to the construction of Ames High School on the site of Old Central School, which was razed in 1936. Original plans for the school called for classrooms only. The city unexpectedly received a PWA grant to construct an auditorium and gymnasium. Construction began in 1937 and was not completed until 1939. Junior high and high school students attended half-day classes during construction. The school continued to be used as a high school until 1967 when a new high school was constructed on 20th Street. The Ames High School then became Central Junior High School. The school was abandoned in the mid 1980s when a new middle school was built. The city administration reoccupied the former high school in 1989 to consolidate scattered city offices.

The firm of Tinsley, McBroom and Higgins was established in 1929 after Burdette Higgins joined the firm of Tinsley and McBroom. The firm's first major commission was the Bankers Life Insurance Company building in Des Moines, which was featured in an article in *Architectural Record* magazine. Other major commissions by the firm include the Physical Education Building, Wilhem Hall, and Spedding Hall at Iowa State University, the United Benefit Life Office Building in Omaha, Nebraska, and numerous homes in Ottumwa, Iowa.

United States Department of the Interior
National Park Service

**NATIONAL REGISTER OF HISTORIC PLACES
CONTINUATION SHEET**

Section 9 Page 4

name of property: Ames High School
county, state: Story County, Iowa

MAJOR BIBLIOGRAPHICAL REFERENCES

Ames Centennial Incorporated

1964 *Ames Community History*. Revenue Division of Ames Centennial Incorporated. Ames, Iowa.

Brown, Farwell T.

1993 *Ames: The Early Years in Word and Picture, From Marsh to Modern City*. Farwell T. Brown & Heuss Printing, Ames, Iowa.

1999 *Ames: The Early Years in Word and Picture, Further Tales and Personal Memories*. Farwell T. Brown & Heuss Printing, Ames, Iowa.

Sanborn Fire Insurance Company

1901-57 *Map of Ames, Iowa*. Sanborn Fire Insurance Company, Chicago.

Shank, Wesley

1999 *Iowa's Historic Architects*. University of Iowa Press, Iowa City, Iowa.

United States Department of the Interior
National Park Service

**NATIONAL REGISTER OF HISTORIC PLACES
CONTINUATION SHEET**

Section 10

Page 5

name of property: Ames High School
county, state: Story County, Iowa

GEOGRAPHICAL DATA

Verbal Boundary Description

The National Register boundary for Ames High School is depicted on the following figure.

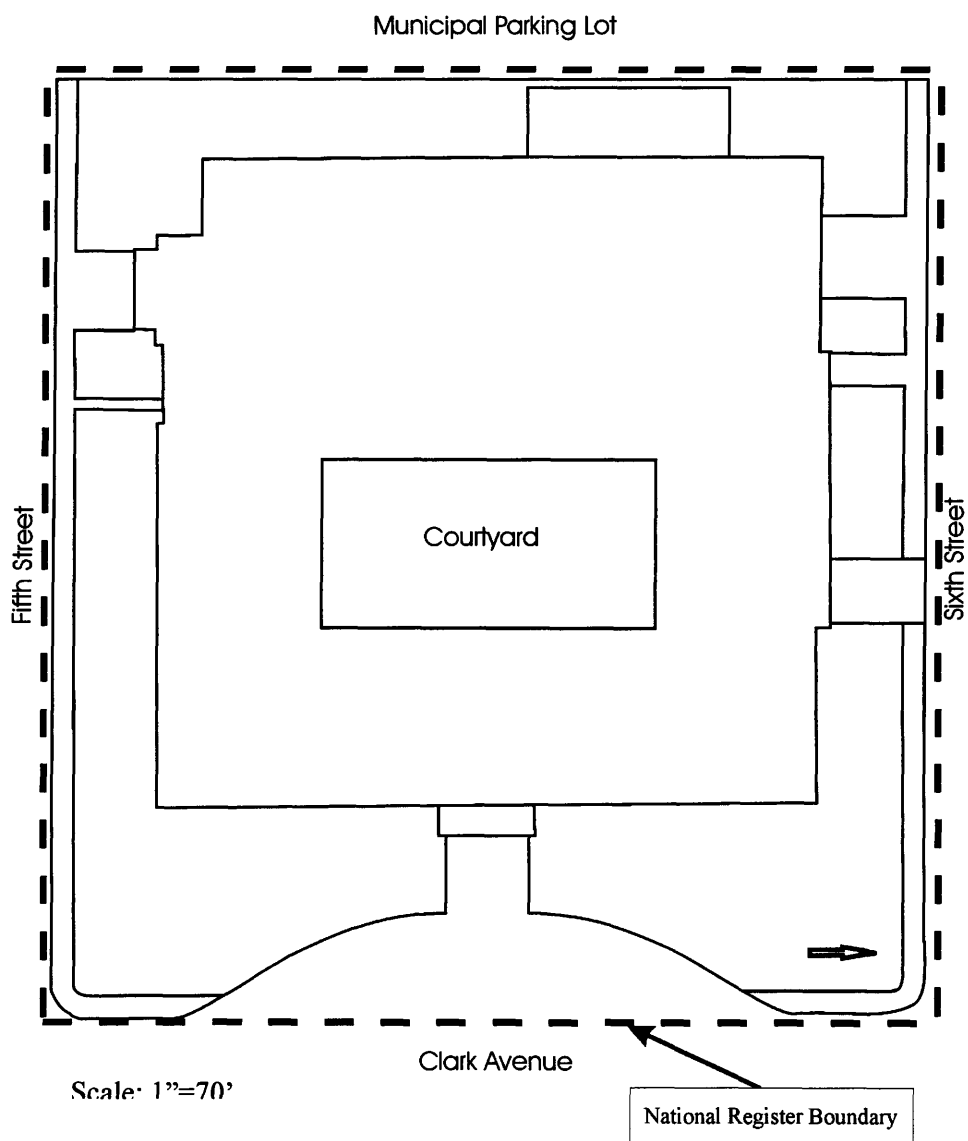

Boundary Justification

The nominated property includes the entire parcel historically associated with the school.

United States Department of the Interior
National Park Service

**NATIONAL REGISTER OF HISTORIC PLACES
CONTINUATION SHEET**

Section Photos Page 6 name of property: Ames High School
county, state: Story County, Iowa

The following items apply to all photographs:

Property Name: Ames High School

Location: Ames, Story County, Iowa

Photographer: Camilla R. Deiber

Date of Photographs: 2001

Location of Negatives: The State Historical Society of Iowa, Community Programs Bureau, Des Moines

Individual Photograph Identifications:

1. Overall view, looking southwest
2. Overall view, looking west by southwest
3. Overall view of entrance, looking west
4. Auditorium entrance, looking southeast
5. View of gymnasium entrance, looking north
6. Overall view of rear facade, looking north by northeast
7. View of courtyard, looking north
8. View of hallway in west section, looking south
9. View of auditorium lobby, looking west by southwest
10. View of auditorium, looking southwest
11. View of gymnasium, looking northwest
12. View of courtroom (former library), looking northeast

United States Department of the Interior
National Park Service

**NATIONAL REGISTER OF HISTORIC PLACES
CONTINUATION SHEET**

Section Floor Plans Page 7 name of property: Ames High School
county, state: Story County, Iowa

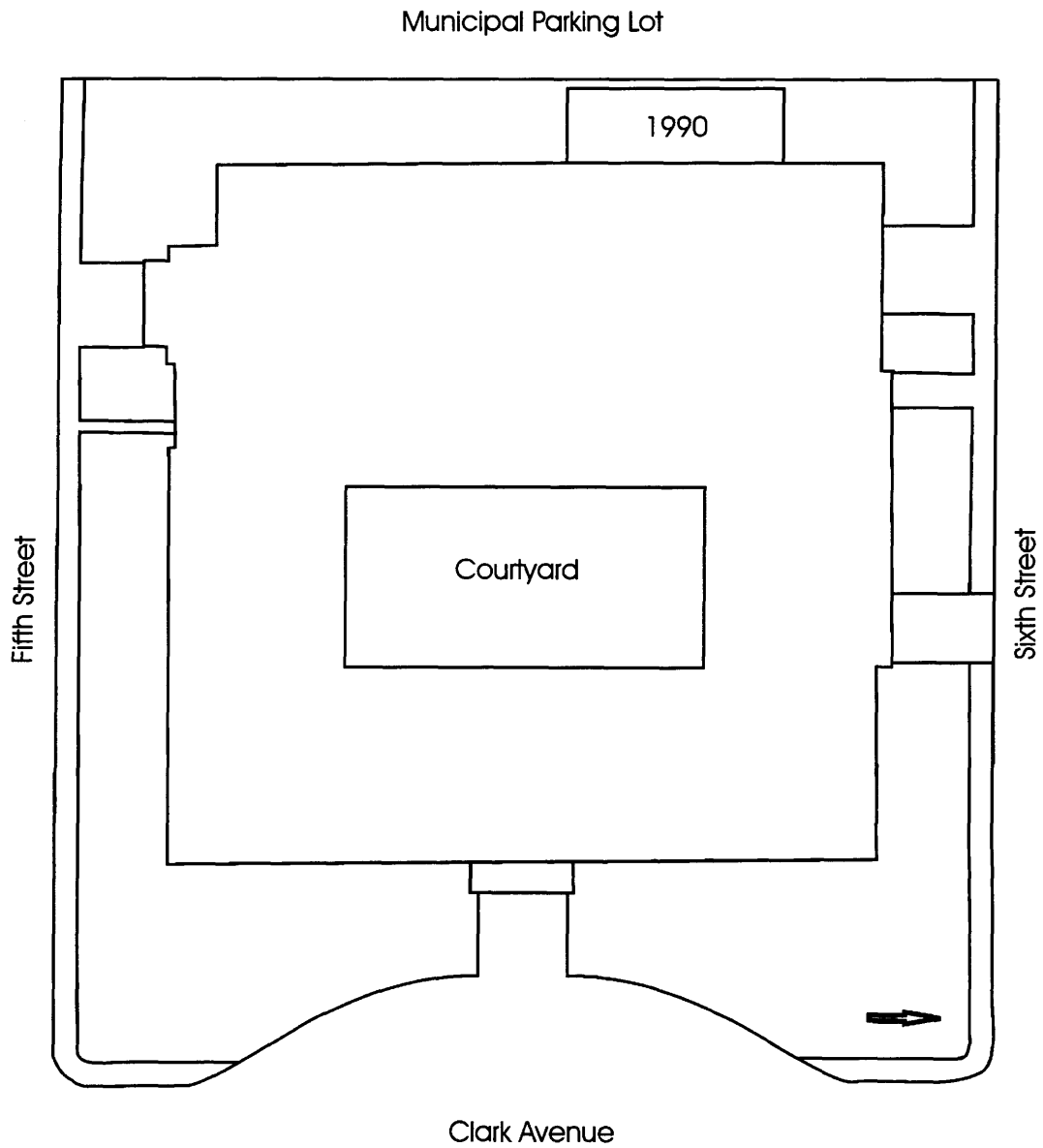

Site Plan Showing Additions

United States Department of the Interior
National Park Service

**NATIONAL REGISTER OF HISTORIC PLACES
CONTINUATION SHEET**

Section Floor Plans Page 8 name of property: Ames High School
county, state: Story County, Iowa

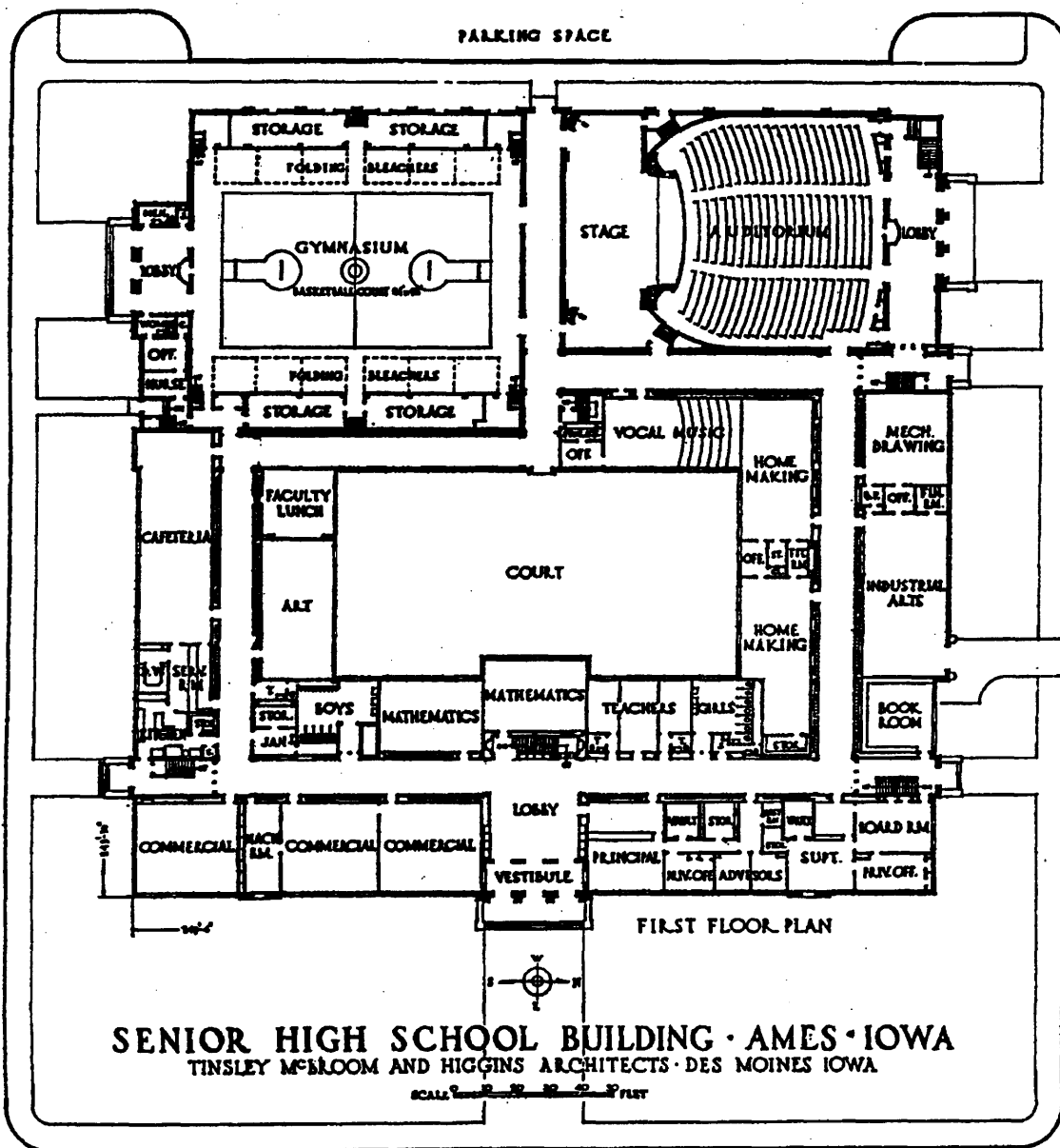

CLARK AVE.

United States Department of the Interior
National Park Service

NATIONAL REGISTER OF HISTORIC PLACES CONTINUATION SHEET

Section Floor Plans Page 9 name of property: Ames High School
county, state: Story County, Iowa

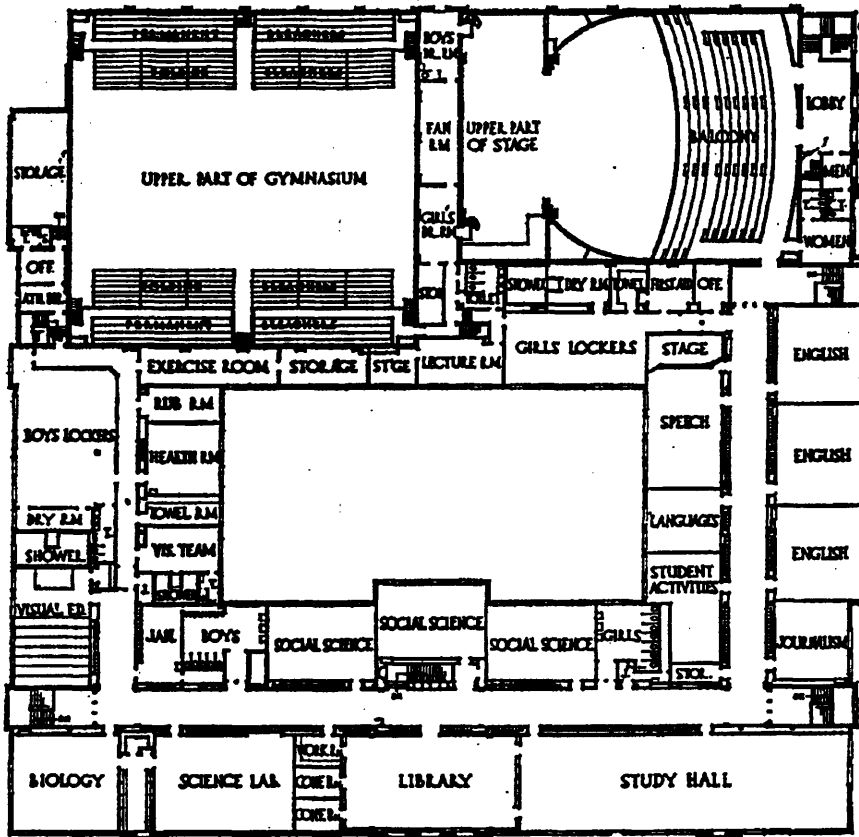

SECOND FLOOR PLAN

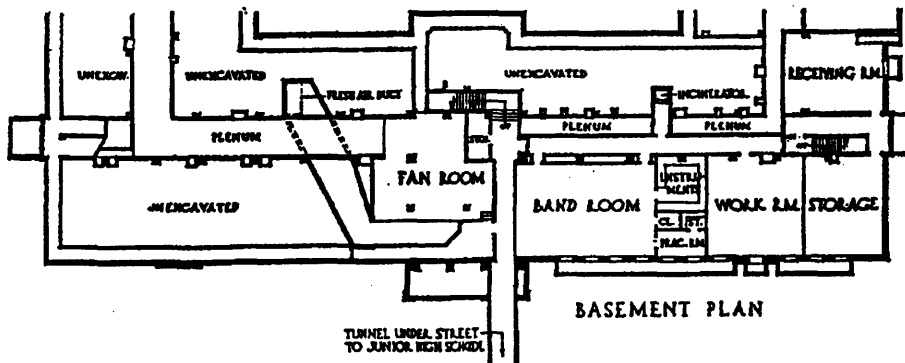

BASEMENT PLAN

United States Department of the Interior
National Park Service

**NATIONAL REGISTER OF HISTORIC PLACES
CONTINUATION SHEET**

Section Floor Plans Page 10 name of property: Ames High School
county, state: Story County, Iowa

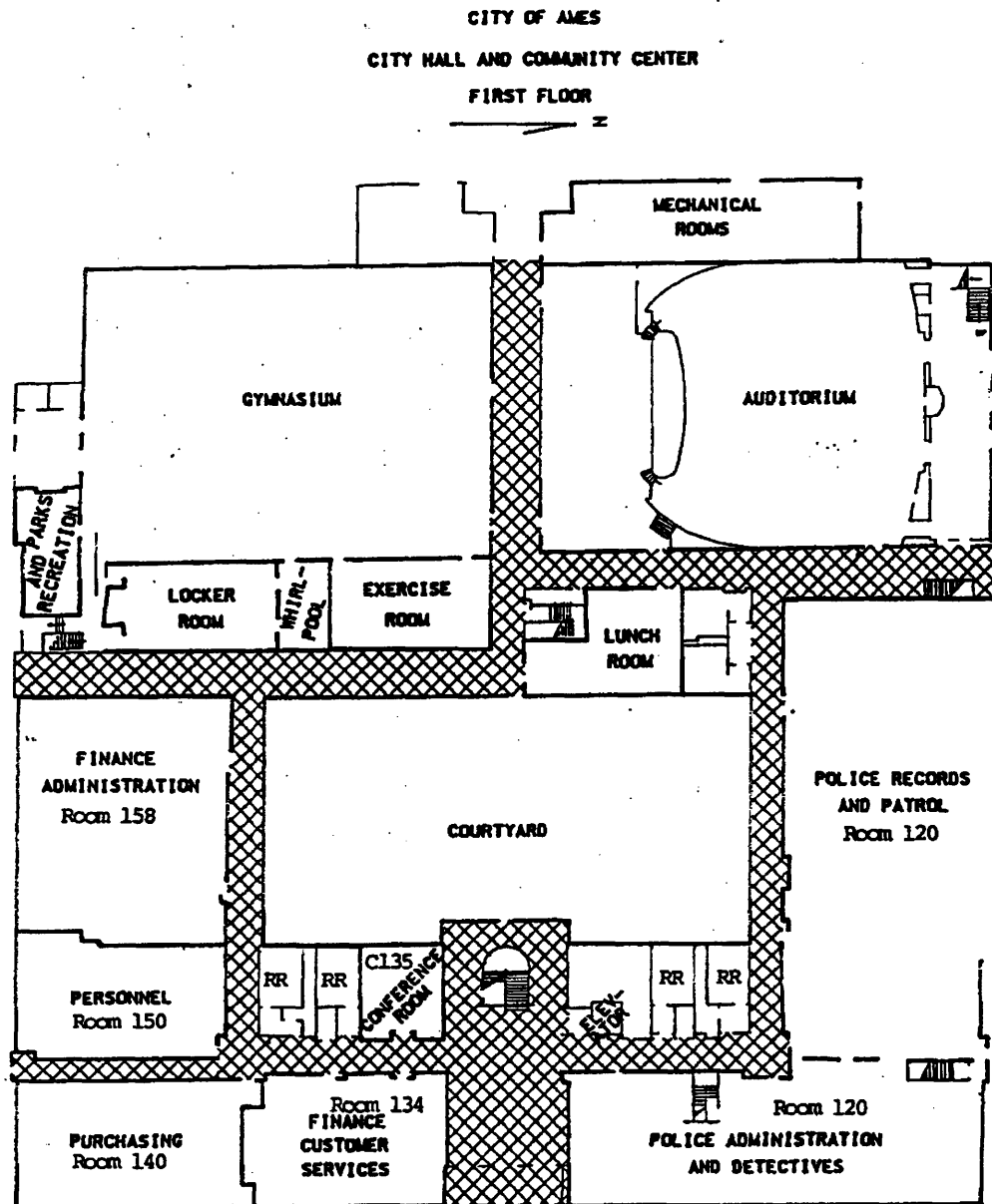

United States Department of the Interior
National Park Service

**NATIONAL REGISTER OF HISTORIC PLACES
CONTINUATION SHEET**

Section Floor Plans Page 11 name of property: Ames High School
county, state: Story County, Iowa

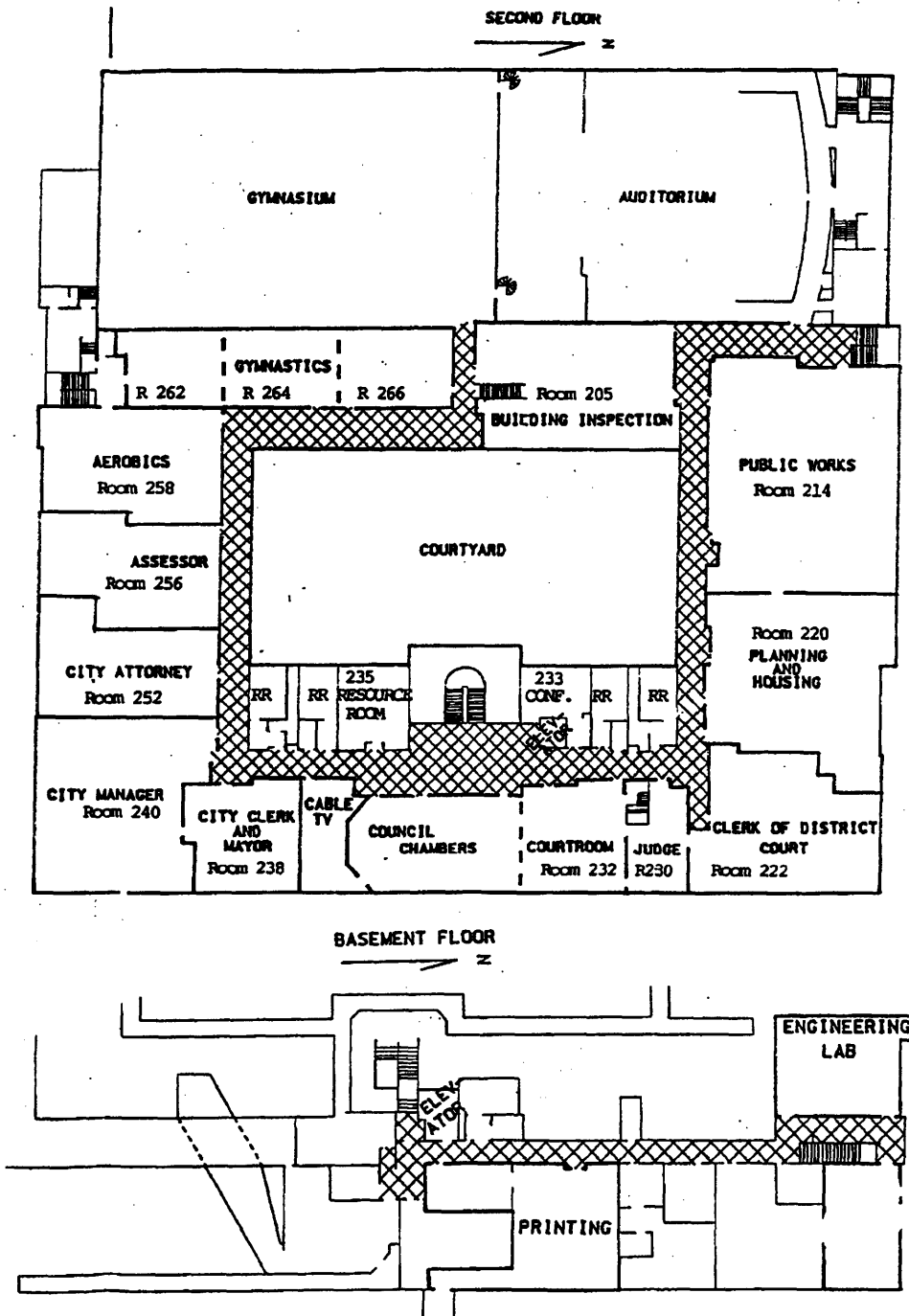

PLAN OF SECOND FLOOR, DECEMBER 2002. (SCALE 1"=50')

CITY MANAGER'S OFFICE, CITY HALL, AMES, IOWA