

Davenport
Department of Community Development
Iowa Office of Historic Preservation
Dennett, Muessig & Associates, Ltd.

DAVENPORT

SURVEY 1982

SITE #82-10-KR-636 MAP NUMBER 6
HISTORIC DISTRICT
NAME First Church of Christ, Scientist
ADDRESS 636 Kirkwood Blvd.



LEGAL DESCRIPTION Le Claire's 11th, Blk. 127,
Lots 6 & 7 exc. N 55.60' thereof

ACREAGE 1 ZONE R-4D UTM 15/703120 4600960
OWNER Pentecostal Deliverance Church TITLE H 1st Church of Christ, Scientist
1518 Fillmore Box 2507
Davenport IA Davenport IA

DESCRIPTION

ARCHITECTURAL STYLE Neoclassical Revival DATE 1912
FORM 1-1/2 stories, cross-gable plan w/central polygonal belvedere;
tetrastyle temple front w/Roman Doric columns in antis
MATERIALS wood, concrete, stucco
FENESTRATION various: diamond lattice, fanlights, 6-light fixed sash
FEATURES full entablature; windows in aedicular frames; entrance
recessed behind tetrastyle "screen", surmounted by fanlight; entry with three
openings has Palladian motif, w/central opening arched, the others rectangular.
ALTERATIONS none of significance on exterior
SITE corner lot in late 19th century residential area

ARCHITECTURAL SIGNIFICANCE The First Church of Christ, Scientist, was built from designs by the local architectural firm of Clausen & Clausen, with Rudolph Clausen probably taking the lead. The severely neoclassical structure eschews all exterior religious symbolism (except, perhaps, the cross plan), and reminds one strongly of Davenport's first church, the Greek Revival St. Anthony's Roman Catholic Church of 1836. The Christian Science Church also seems to foreshadow some of R.J. Clausen's later works, particularly the Scott County Savings Bank and Masonic Temple, both of which express neoclassical forms in an almost abstract way.

HISTORICAL DATA

The First Church of Christ, Scientist was constructed in 1912, twenty years after the congregation was founded by 16 local practitioners, as a branch of the mother church in Boston. A reading room was opened in a separate location in downtown Davenport. This congregation was and is the only Christian Science church in the city.

HISTORICAL SIGNIFICANCE

SOURCES Index of Clausen & Clausen Jobs, Typescript, n.d., Charles Richardson Associates, Davenport
Davenport City Directories, 1910, 1911, 1912, 1913
"Articles of Incorporation and Bylaws of First Church of Christ, Scientist," Davenport, Iowa, 1981.

ARCHITECTURAL EVALUATION

DESIGN good STATURE focus
LEVEL OF SIGNIFICANCE local

CONTEXT good FABRIC excellent
DISTRICT CLASSIFICATION

HISTORICAL EVALUATION

PRIMARY THEME
LEVEL OF SIGNIFICANCE

SECONDARY THEME

NATIONAL REGISTER ELIGIBLE YES

PHOTO ID 1735-24,26

Martha H. Bowers, Architectural Historian

Marlys Svendsen, Historian

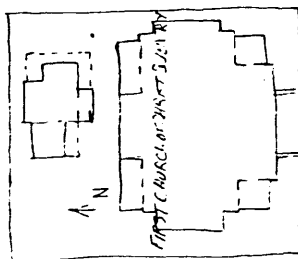

M. BOWERS 8/17/82

FOR DIVISION OF HISTORIC PRESERVATION USE ONLY

1 DATE RECEIVED _____

2 DATE OF STAFF EVALUATION _____

	A ARCHITECTURAL	B HISTORICAL
ELIGIBLE FOR NRHP	<input type="checkbox"/>	<input type="checkbox"/>
NOT ELIGIBLE FOR NRHP	<input type="checkbox"/>	<input type="checkbox"/>

3 NRHP ACTION

A STATE REVIEW COMM APP DISAPP T'ABLED DATE _____

B FEDERAL REVIEW APP DISAPP T'ABLED DATE _____

4 DHP SOURCES

<input type="checkbox"/> COUNTY RESOURCES	<input type="checkbox"/> DET OF ELIGIBILITY
<input type="checkbox"/> WSHIELD SURVEY	<input type="checkbox"/> R & C _____
<input type="checkbox"/> NRHP	<input checked="" type="checkbox"/> DAVENPORT A/H SURVEY
<input type="checkbox"/> GRANT _____	<input type="checkbox"/> _____

5 SUBJECT TRACES _____

6 PHOTO _____