

**United States Department of the Interior
National Park Service**

**National Register of Historic Places
Inventory—Nomination Form**

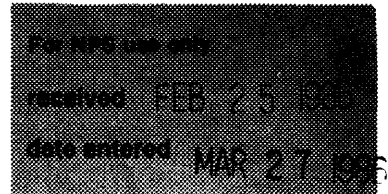

Continuation sheet

Item number

Page

<u>Name:</u>	Historic: Gaffney Commercial Historic District	Location: Along N. Lime- stone St. between E. Meadow St. and Cherokee Ave. and along adjacent parts of Robinson, Frederick, Birnie and Wall Streets.
	Common: Gaffney Commercial Historic District	Classification: District

Owner: Multiple Ownership (more than 50 owners)

Representation in Existing Surveys: South Carolina Inventory of Historic Places, 1985

Description: The Gaffney Commercial Historic District consists of forty-one contributing resources located in downtown Gaffney. Of the sixty-seven resources located within the district forty-one were built before 1930 and retain their historic character. Many of the remaining buildings were constructed before 1930 but have been altered. The buildings in the district are primarily commercial buildings in vernacular interpretations of the Commercial Italianate, Victorian Romanesque, and Neo-Classical styles of the turn of the century. All of the buildings are of brick construction and vary from one to four stories in height. The downtown area, which continues to be a center of Gaffney commerce, retains much of its early twentieth century character.

Key resources which establish the character of the historic district:

26. Brown Building, 521 N. Limestone: Built in 1915 by Horace Brown, this three-story brick building housed the Brown Department Store, the Chamber of Commerce, and Elks Club. It features a crenellated parapet with stone coping and Tudor design concrete panels. The storefront retains its original Tudor arches at the entrances.

27. Settlemyer Building, 601-603 N. Limestone: Constructed in 1903, this three-story brick building was the home of the Cherokee Savings Bank for many years. The building features a corner entrance with a marble Ionic column. Pilasters divide the upper facade and at the roofline is a corbelled brick cornice. Windows on the third story have rounded arches; a recessed balcony is also located on the third floor.

58. Star Theatre, 400 N. Limestone: Built in 1903, the Star Theatre is a two-story, brick building with a bracketed cornice, fixed attic windows, and rounded arched windows on the second story. The building was used for many years as the Star Theatre.

68. Hamrick Theatre, 306 N. Limestone: This two-story brick and stucco building was constructed in 1930 as the Hamrick Theatre. The exterior has both Spanish Colonial and Art Deco detailing. Windows have rounded arches and the original recessed entrance to the theatre is intact.

Other resources which contribute to the character of the district:

1. 100 Wall Street: ca. 1907 brick commercial building.
2. 112-114 W. Birnie Street: ca. 1900 molded concrete block and brick commercial building.
3. 108 W. Birnie Street: ca. 1900 brick commercial building.
5. 401-405 N. Limestone Street: ca. 1900 brick commercial building.
6. 407-411 N. Limestone Street: ca. 1900 brick commercial building; new brick facade added ca. 1925.
7. 413 N. Limestone Street: ca. 1900 brick commercial building; new brick facade added ca. 1920.
8. 415 N. Limestone Street: ca. 1910 brick commercial building.
9. 417 N. Limestone Street: ca. 1920 brick commercial building.
10. 419 N. Limestone Street: ca. 1900 brick commercial building.
13. 105 W. Frederick Street: ca. 1900 brick commercial building.
14. 107 W. Frederick Street: ca. 1920 brick commercial building.
15. 109-111 W. Frederick Street: ca. 1920 brick commercial building.
16. 106-110 W. Frederick Street: ca. 1905 brick commercial building.
17. 501 N. Limestone Street: brick commercial building constructed in 1901.
19. 507 N. Limestone Street: ca. 1910 brick commercial building.
21. 511 N. Limestone Street: brick commercial building constructed in 1919.
22. 513 N. Limestone Street: ca. 1910 brick commercial building.
23. 515 N. Limestone Street: ca. 1918 brick commercial building.
25. 519 N. Limestone Street: ca. 1910 brick commercial building.
28. 616 N. Limestone Street: ca. 1905 brick commercial building.
31. Concord Street: ca. 1905 brick warehouse.
34. 108-114 E. Robinson Street: ca. 1900 brick commercial building.

35. 520-522 N. Limestone Street: brick commercial building constructed in 1923.
36. 518 N. Limestone Street: ca. 1920 brick commercial building.
39. 510 N. Limestone Street: ca. 1915 brick commercial building.
43. 500 N. Limestone Street: brick commercial building constructed in 1905.
44. 103 E. Frederick Street: ca. 1925 brick addition at the rear of the 500 N. Limestone Street building.
46. 107 E. Frederick Street: ca. 1908 brick commercial building.
48. 129 E. Frederick Street: ca. 1910 brick commercial building.
52. 418 N. Limestone: ca. 1908 brick commercial building.
53. 416 N. Limestone Street: ca. 1917 brick commercial building with terra-cotta facade.
55. 412 N. Limestone Street: ca. 1900 brick commercial building.
57. 404 N. Limestone Street: ca. 1905 brick commercial building.
60. 113 E. Birnie Street: ca. 1920 brick commercial building.
61. 120 E. Birnie Street: ca. 1910 brick commercial building.
63. 110-114 E. Birnie Street: ca. 1910 brick commercial building with three separate storefronts.
66. 314-316 N. Limestone Street: ca. 1905 brick commercial building.

Resources which do not contribute to the character of the district:

4. 106 W. Birnie Street: ca. 1950 brick commercial building.
11. 421 N. Limestone Street: ca. 1940 brick commercial building.
12. 423 N. Limestone Street: ca. 1970 brick and stucco commercial building.
18. 503-505 N. Limestone Street: ca. 1915 commercial building that has been extensively altered; much of the original ornamental terra-cotta has been removed and the facade has been partially brick-veneered.
20. 509 N. Limestone Street: ca. 1940 brick commercial building.
24. 517 N. Limestone Street: ca. 1905 brick commercial building with a ca. 1970 metal facade.
29. 614 N. Limestone Street: ca. 1910 brick commercial building extensively altered by partial enclosure of second story windows and remodeling of storefront.

30. 612 N. Limestone Street: ca. 1910 brick commercial building extensively altered by partial enclosure of second story windows and remodeling of storefront.
32. 606 N. Limestone Street: ca. 1970 frame commercial building.
33. 600-604 N. Limestone Street: ca. 1895 brick commercial building extensively altered by partial enclosure of window openings and replacement of sash.
37. 516 N. Limestone Street: ca. 1940 brick commercial building with a ca. 1970 metal and stucco facade.
38. 514 N. Limestone Street: ca. 1930 brick commercial building with a ca. 1970 metal and stucco facade.
40. 508 N. Limestone Street: ca. 1915 brick commercial building with a ca. 1970 altered facade.
42. 504 N. Limestone Street: ca. 1905 brick commercial building with a ca. 1970 metal facade.
45. 105 E. Frederick Street: ca. 1960 brick commercial building.
47. 109 E. Frederick Street: ca. 1940 brick commercial building.
49. 106 E. Frederick Street: 1897 brick commercial building which has been extensively altered by enclosure of the windows with brick and boarding of the store front.
50. 104 E. Frederick Street: ca. 1960 brick commercial building.
51. 422 N. Limestone Street: brick commercial building constructed ca. 1905; entire original facade was removed and replaced during the 1970s.
54. 414-416 N. Limestone Street: ca. 1905 brick commercial building with added metal facade.
56. 408 N. Limestone Street: ca. 1950 brick commercial building.
59. 109 E. Birnie Street: ca. 1920 brick commercial building; entire original facade was removed in the 1940s and replaced with a concrete and stucco facade.
62. 116 E. Birnie Street: ca. 1950 brick commercial building.
64. 320-322 N. Limestone Street: 1907 commercial building; addition of metal siding ca. 1970.
65. 318 N. Limestone Street: ca. 1950 brick commercial building.
67. 312 N. Limestone Street: ca. 1905 brick commercial building extensively altered by enclosure of windows and transom and alteration of cornice.

#41 was not used.

Significance: The Gaffney Commercial Historic District encompasses a three-block area which has been the commercial center of the city since ca. 1875. Frame and brick buildings were constructed along this section of North Limestone Street following the completion of the Airline Railroad through Gaffney in 1873. This area evolved as the primary business center of Gaffney due to the proximity of the railroad and depot. By 1910, several dozen brick businesses containing shops, offices and warehouses had been constructed in the downtown area and the majority of Gaffney's well known firms were located here. During the 1910s and early 1920s, the commercial area continue to grow with a number of notable buildings constructed in the district. While most buildings are vernacular styles of the period, a number are notable for their excellent detailing and craftsmanship.

Acreage: Approximately 7.5 acres

Verbal Boundary Description: The boundary of the Gaffney Commercial Historic District nomination is shown as the heavy black line on the accompanying tax map 99-03, which is drawn at a scale of 1'=100'. The nominated property includes the largest concentration of contributing resources with the smallest number of noncontributing in the central business district of Gaffney.

UTM Reference Points:

A. 17/441130/3881570	B. 17/441160/3881540
C. 17/440960/3881240	D. 17/440890/388280
E. 17/440910/3881380	F. 17/441080/3881540

Other Information:

Level of Significance: Local

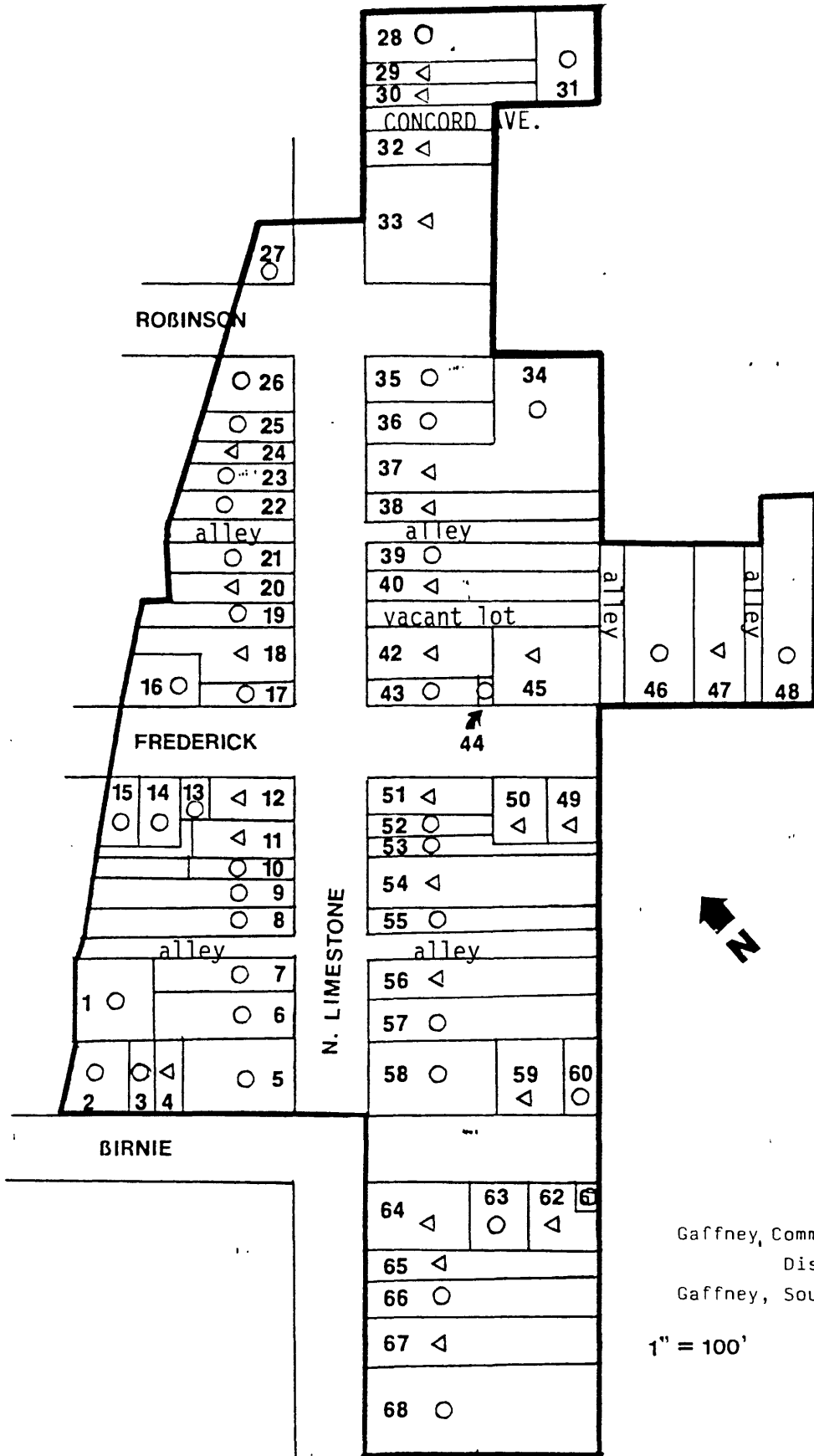

Gaffney, Commercial Historic District
 Gaffney, South Carolina

1" = 100'

- Contributing Resources
- ◁ Noncontributing Resources