

PH0678937

FOR NPS USE ONLY

RECEIVED MAR 12 1979

DATE ENTERED

MAY 10 1979

NATIONAL REGISTER OF HISTORIC PLACES INVENTORY -- NOMINATION FORM

SEE INSTRUCTIONS IN *HOW TO COMPLETE NATIONAL REGISTER FORMS*
TYPE ALL ENTRIES -- COMPLETE APPLICABLE SECTIONS

1 NAME

HISTORIC Chaplin-Clarke House

AND/OR COMMON
Chaplin-Clarke House

2 LOCATION

STREET & NUMBER
109 Haverhill Street

CITY, TOWN
Rowley

STATE
Massachusetts

VICINITY OF
CODE
025

NOT FOR PUBLICATION
CONGRESSIONAL DISTRICT
6th

COUNTY
Essex

CODE
009

3 CLASSIFICATION

CATEGORY	OWNERSHIP	STATUS	PRESENT USE
<input type="checkbox"/> DISTRICT	<input type="checkbox"/> PUBLIC	<input checked="" type="checkbox"/> OCCUPIED	<input type="checkbox"/> AGRICULTURE <input type="checkbox"/> MUSEUM
<input checked="" type="checkbox"/> BUILDING(S)	<input checked="" type="checkbox"/> PRIVATE	<input type="checkbox"/> UNOCCUPIED	<input type="checkbox"/> COMMERCIAL <input type="checkbox"/> PARK
<input type="checkbox"/> STRUCTURE	<input type="checkbox"/> BOTH	<input type="checkbox"/> WORK IN PROGRESS	<input type="checkbox"/> EDUCATIONAL <input checked="" type="checkbox"/> PRIVATE RESIDENCE
<input type="checkbox"/> SITE	PUBLIC ACQUISITION	ACCESSIBLE	<input type="checkbox"/> ENTERTAINMENT <input type="checkbox"/> RELIGIOUS
<input type="checkbox"/> OBJECT	<input type="checkbox"/> IN PROCESS	<input checked="" type="checkbox"/> YES: RESTRICTED	<input type="checkbox"/> GOVERNMENT <input type="checkbox"/> SCIENTIFIC
	<input type="checkbox"/> BEING CONSIDERED	<input type="checkbox"/> YES: UNRESTRICTED	<input type="checkbox"/> INDUSTRIAL <input type="checkbox"/> TRANSPORTATION
		<input type="checkbox"/> NO	<input type="checkbox"/> MILITARY <input type="checkbox"/> OTHER:

4 OWNER OF PROPERTY

NAME
Mr. & Mrs. Daniel L. Herlihy

STREET & NUMBER
109 Haverhill Street

CITY, TOWN
Rowley

VICINITY OF

STATE
Massachusetts

5 LOCATION OF LEGAL DESCRIPTION

COURTHOUSE,
REGISTRY OF DEEDS, ETC. South Essex Registry of Deeds

STREET & NUMBER
32 Federal Street

CITY, TOWN
Salem

STATE
Massachusetts

6 REPRESENTATION IN EXISTING SURVEYS

TITLE
Inventory of the Historic Assets of the Commonwealth #37

DATE
1976 FEDERAL STATE COUNTY LOCAL

DEPOSITORY FOR
SURVEY RECORDS Massachusetts Historical Commission

CITY, TOWN
Boston

STATE
Massachusetts

7 DESCRIPTION

CONDITION		CHECK ONE	CHECK ONE
<input checked="" type="checkbox"/> EXCELLENT	<input type="checkbox"/> DETERIORATED	<input type="checkbox"/> UNALTERED	<input checked="" type="checkbox"/> ORIGINAL SITE
<input type="checkbox"/> GOOD	<input type="checkbox"/> RUINS	<input checked="" type="checkbox"/> ALTERED	<input type="checkbox"/> MOVED DATE _____
<input type="checkbox"/> FAIR	<input type="checkbox"/> UNEXPOSED		

DESCRIBE THE PRESENT AND ORIGINAL (IF KNOWN) PHYSICAL APPEARANCE

The Chaplin-Clarke House is located on Haverill Street a short distance southwest of Rowley Center. Despite its proximity to the center, the setting is rural and landscaping is natural. The house, which faces south, is built into the side of a hill so that its western half is 1½ stories in height while its eastern half is 2½ stories.

The facade of this five bay, center entrance house is sheathed in clapboards while the side elevations are shingled. The gabled lean-to roof is covered with cedar shingles and the central chimney is parged. Exterior decorative detail is minimal, consisting of simple cornerboards, door and window surrounds. On the east elevation there is a framed overhang on the second story and a hewn overhang in the attic.

The facade is asymmetrical with the entrance placed slightly west of center. The two windows on the one story west side are full size, while those on the two story eastern side are smaller and are placed above a similar pair lighting the first story. There is a second entrance to the ground floor in the eastern corner. The west elevation has one window in the attic and two at the first floor as well as a door and small square window in the lean-to. The east elevation has one window each in the attic and second story and three at the first floor. Fenestration on the low rear elevation is irregular. A second chimney rises from the northwest corner of the ell.

Interior details include one seven foot and two ten foot fireplaces, chamfered structural members, and some original sheathing and hardware.

8 SIGNIFICANCE

PERIOD	AREAS OF SIGNIFICANCE -- CHECK AND JUSTIFY BELOW				
<input type="checkbox"/> PREHISTORIC	<input type="checkbox"/> ARCHEOLOGY-PREHISTORIC	<input type="checkbox"/> COMMUNITY PLANNING	<input type="checkbox"/> LANDSCAPE ARCHITECTURE	<input type="checkbox"/> RELIGION	
<input type="checkbox"/> 1400-1499	<input type="checkbox"/> ARCHEOLOGY-HISTORIC	<input type="checkbox"/> CONSERVATION	<input type="checkbox"/> LAW	<input type="checkbox"/> SCIENCE	
<input type="checkbox"/> 1500-1599	<input type="checkbox"/> AGRICULTURE	<input type="checkbox"/> ECONOMICS	<input type="checkbox"/> LITERATURE	<input type="checkbox"/> SCULPTURE	
<input checked="" type="checkbox"/> 1600-1699	<input checked="" type="checkbox"/> ARCHITECTURE	<input type="checkbox"/> EDUCATION	<input type="checkbox"/> MILITARY	<input type="checkbox"/> SOCIAL/HUMANITARIAN	
<input checked="" type="checkbox"/> 1700-1799	<input type="checkbox"/> ART	<input type="checkbox"/> ENGINEERING	<input type="checkbox"/> MUSIC	<input type="checkbox"/> THEATER	
<input type="checkbox"/> 1800-1899	<input type="checkbox"/> COMMERCE	<input checked="" type="checkbox"/> EXPLORATION/SETTLEMENT	<input type="checkbox"/> PHILOSOPHY	<input type="checkbox"/> TRANSPORTATION	
<input type="checkbox"/> 1900-	<input type="checkbox"/> COMMUNICATIONS	<input type="checkbox"/> INDUSTRY	<input type="checkbox"/> POLITICS/GOVERNMENT	<input type="checkbox"/> OTHER (SPECIFY)	
		<input type="checkbox"/> INVENTION			

SPECIFIC DATES 1670, 1700

BUILDER/ARCHITECT Joseph Chaplin

STATEMENT OF SIGNIFICANCE

The Chaplin-Clarke house, which is the oldest in Rowley, is an unusual and well preserved example of seventeenth century construction. It is believed that it stands on the site of a primitive structure erected by Hugh Chaplin in 1643. His son Joseph erected a one room deep house c.1670 when he married. The lean-to was added c.1700 completing the form of the present house.

Early in the eighteenth century the property was acquired by Richard Clarke who is buried a few rods west of the house. It had only one other owner before being acquired by the Society for the Preservation of New England Antiquities early in the twentieth century. Recently it has been returned to private ownership. Long regarded as the oldest house in town, the Chaplin-Clarke house is the last vestige of Rowley's original settlement which, by 1650, had grown to include sixty families.

An archeological investigation of the area could reveal significant information about early historic period construction techniques and lifeways in Rowley. The data could also provide comparative information about 17th century coastal adaptations.

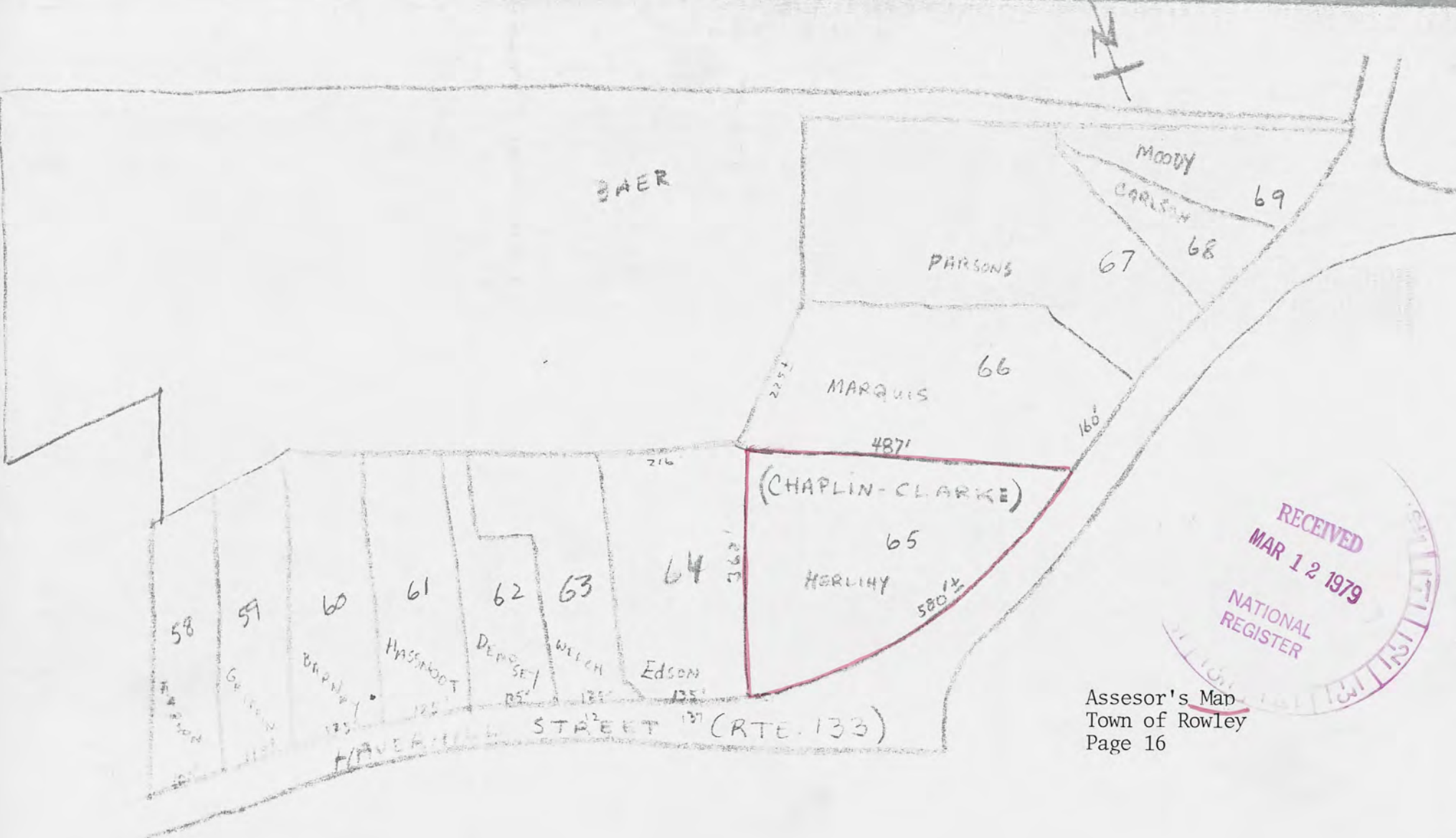

Assesor's Map
 Town of Rowley
 Page 16

PROPERTY MAP
 ROWLEY, MASSACHUSETTS

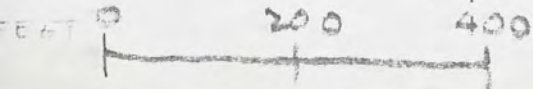

(REVISED TO JAN 1, 1974)

Property Chaplin-Clarke House

State Mass (Essex) Working Number 3.12.79.501

TECHNICAL

Photos 2
Maps 1,1

CONTROL

pl
OK 3.13.79

HISTORIAN

ARCHITECTURAL HISTORIAN

ARCHEOLOGIST

OTHER

HAER

Inventory _____

Review _____

THE HOUSE HAS LONG BEEN KNOWN AS THE EARLIEST EXISTANT HOUSE IN ROWLEY. IT IS AN UNUSUAL AND WELL PRESERVED EXAMPLE OF 17^C CONSTRUCTION.

REVIEW UNIT CHIEF

accept
Mr Douber
5/9/79

BRANCH CHIEF

KEEPER

National Register Write-up _____

Federal Register Entry _____

6-5-79

Send-back _____

Re-submit _____

Entered MAY 10 1979



Chaplin-Clarke House
Rowley, Massachusetts
Richard Cheek 1975
Society for the Preservation of New
England Antiquities
Cambridge St., Boston, Mass.

MAR 12 1979

Photo #1

Facade and east elevation

MAY 10 1979

Chaplin-Clarke House
South Facade
Essex County



Chaplin-Clarke House
Rowley, Massachusetts
Richard Cheek 1975
Society for the Preservation of New
England Antiquities
Cambridge St., Boston, Mass.

MAY 10 1979

Photo #2
Facade and west elevation

MAR 12 1979

Chaplin-Clarke House
West end
Essex County



Chaplin-Clarke House
Rowley, Massachusetts

UTM REFERENCES:
42°30'19"/345040/4730050

Maped, edited, and published by the Geological Survey
Control by USGS, USC&GS, and Massachusetts Geodetic Survey
Topography by planetable surveys 1942. Revised 1966
Polyconic projection. 1927 North American datum
10,000-foot grid based on Massachusetts coordinate system,
mainland zone
1000-meter Universal Transverse Mercator grid ticks,
zone 19, shown in blue

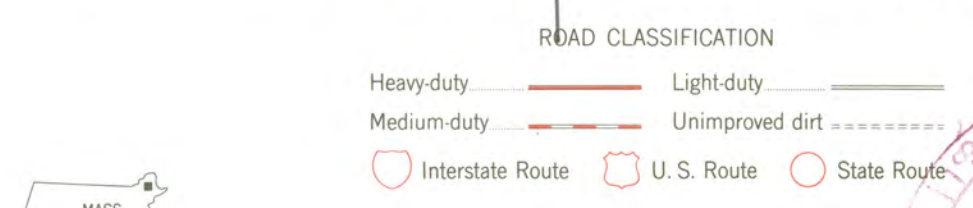
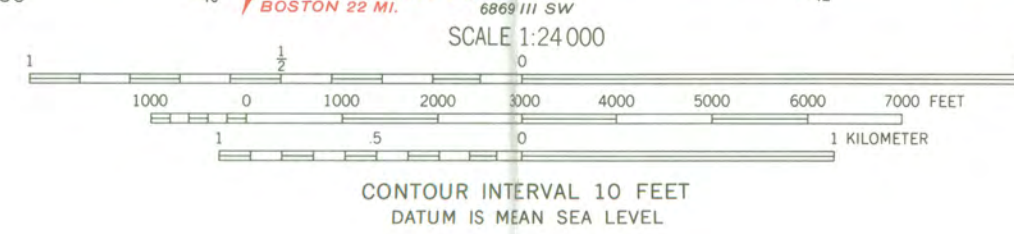
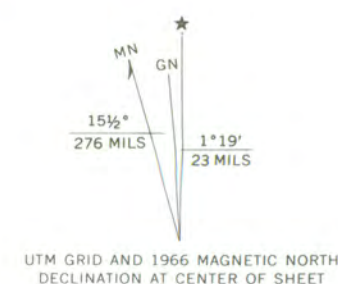

GEORGETOWN, MASS.
N4237.5—W7052.5/7.5



THIS MAP COMPLIES WITH NATIONAL MAP ACCURACY STANDARDS
FOR SALE BY U.S. GEOLOGICAL SURVEY, WASHINGTON, D. C. 20242
A FOLDER DESCRIBING TOPOGRAPHIC MAPS AND SYMBOLS IS AVAILABLE ON REQUEST

AMS 6869 III NW—SERIES V814

MAY 10 1979



PAUL GUZZI

Secretary of the
Commonwealth

The Commonwealth of Massachusetts

Office of the Secretary

Massachusetts Historical Commission

294 Washington Street Boston, Massachusetts 02108

(617) 727-8470

PROPOSED NATIONAL REGISTER NOMINATION NOTIFICATION TO OWNER

DATE: 16 December 1977

TO: Mr. & Mrs. Daniel J. Herlihy

ADDRESS: 109 Haverhill St., Rowley MA. 01969

FROM: MASSACHUSETTS HISTORICAL COMMISSION

SUBJECT: NATIONAL REGISTER OF HISTORIC PLACES

THIS IS TO NOTIFY YOU THAT THE FOLLOWING PROPERTY:

NAME: Chaplin-Clarke House

ADDRESS: 109 Haverhill Street, Rowley

NOMINATED BY: Rowley Historical Commission

is being considered by the Massachusetts Historical Commission for nomination to the National Register of Historic Places.

The National Register affords recognition and protection for districts, sites, buildings, structures and objects significant in American History, architecture, archeology and culture. Listing in the National Register places no restrictions on the owner's actions unless Federal funding or licensing is involved. However, certain Federal Tax consequences may result from listing in the National Register. Please refer to section 2124 of the Tax Reform Act of 1976 for an explanation of these provisions.

Please acknowledge receipt of this notification by signing below and returning this form to Joseph R. Orfant, National Register Editor, Massachusetts Historical Commission at the address above. The State Review Board will not consider this nomination until we receive your comments or thirty days have passed from the date of notification.

Written comments on the significance of this property are encouraged and may be attached to this form.

Signature Daniel J. Herlihy Date Dec. 19, 1977

RECEIVED

MAR 12 1979

NATIONAL
REGISTER

RECEIVED

DEC 22 1977

MASS. HIST. COMM.

ENTRIES IN THE NATIONAL REGISTER

STATE MASSACHUSETTS

Date Entered MAY 10 1979

<u>Name</u>	<u>Location</u>
Odd Fellow's Hall	Shelburne Falls Franklin County
Conkey-Stevens House	Amherst Hampshire County
Sanderson, Julia, Theater (Paramount Theater)	Springfield Hampden County
Winchester Square Historic District	Springfield Hampden County
Turner, Stephen, House	Norfolk Norfolk County
Abbot, Edwin, House (Longy School of Music)	Cambridge Middlesex County
Chaplin-Clarke House	Rowley Essex County

Also Notified

Honorable Paul G. Tsongas

Honorable Edward M. Kennedy

Honorable Silvio O. Conte

Honorable Edward P. Boland

Honorable Margaret M. Heckler

Honorable Thomas P. O'Neill

Honorable Nicholas Mayroules

State Historic Preservation Officer

Mrs. Patricia L. Weslowski

Executive Director

Massachusetts Historical Commission

294 Washington Street

Boston, Massachusetts 02108

NR Byers/bjr 5/14/79

For further information, please call the National Register at (202) 343-6401.