

PH0023493

NATIONAL REGISTER OF HISTORIC PLACES
INVENTORY - NOMINATION FORM

(Type all entries - complete applicable sections)

STATE: Georgia	
COUNTY: Thomas	
FOR NPS USE ONLY	
ENTRY NUMBER 70.6.10.0040	DATE 6/22/70

1. NAME

COMMON:
Jeffries House

AND/OR HISTORIC:
Augustine Hansell House

2. LOCATION

STREET AND NUMBER:
429 South Hansell Street

CITY OR TOWN:
Thomasville

STATE Georgia	CODE 10	COUNTY: Thomas	CODE 275
-------------------------	-------------------	--------------------------	--------------------

3. CLASSIFICATION

CATEGORY (Check One)	OWNERSHIP	STATUS	ACCESSIBLE TO THE PUBLIC
District <input type="checkbox"/> Building <input checked="" type="checkbox"/> Site <input type="checkbox"/> Structure <input type="checkbox"/> Object <input type="checkbox"/>	Public <input type="checkbox"/> Private <input checked="" type="checkbox"/> Both <input type="checkbox"/>	Public Acquisition: In Process <input type="checkbox"/> Being Considered <input type="checkbox"/>	Occupied <input checked="" type="checkbox"/> Unoccupied <input type="checkbox"/> Preservation work in progress <input type="checkbox"/>
PRESENT USE (Check One or More as Appropriate)			Yes: <input type="checkbox"/> Restricted <input type="checkbox"/> Unrestricted <input type="checkbox"/> No: <input checked="" type="checkbox"/>
Agricultural <input type="checkbox"/> Commercial <input type="checkbox"/> Educational <input type="checkbox"/> Entertainment <input type="checkbox"/>	Government <input type="checkbox"/> Industrial <input type="checkbox"/> Military <input type="checkbox"/> Museum <input type="checkbox"/>	Park <input type="checkbox"/> Private Residence <input checked="" type="checkbox"/> Religious <input type="checkbox"/> Scientific <input type="checkbox"/>	Transportation <input type="checkbox"/> Other (Specify) <input type="checkbox"/>

4. OWNER OF PROPERTY

OWNERS NAME:
Mrs. M.H. Jeffries

STREET AND NUMBER:
429 South Hansell Street

CITY OR TOWN:
Thomasville

STATE: Georgia	CODE 10
--------------------------	-------------------

5. LOCATION OF LEGAL DESCRIPTION

COURTHOUSE, REGISTRY OF DEEDS, ETC.:
Thomas County Courthouse

STREET AND NUMBER:
North Broad Street

CITY OR TOWN:
Thomasville

STATE: Georgia	CODE 10
--------------------------	-------------------

APPROXIMATE ACREAGE OF NOMINATED PROPERTY:
2.9 Acres

6. REPRESENTATION IN EXISTING SURVEYS

TITLE OF SURVEY:
Thomasville Landmarks Architectural Inventory

DATE OF SURVEY: **10/1/69** Federal State County Local

DEPOSITORY FOR SURVEY RECORDS:
Thomasville Landmarks, Inc.

STREET AND NUMBER:
Box 44

CITY OR TOWN:
Thomasville

STATE: Georgia	CODE 10
--------------------------	-------------------

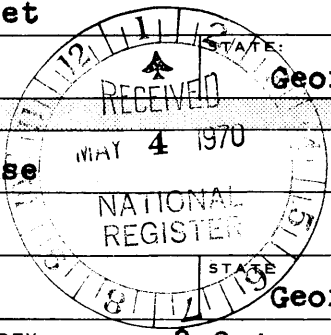

SEE INSTRUCTIONS

STATE: Georgia
COUNTY: Thomas
ENTRY NUMBER
DATE

FOR NPS USE ONLY

7. DESCRIPTION

CONDITION	(Check One)				
	Excellent <input checked="" type="checkbox"/>	Good <input type="checkbox"/>	Fair <input type="checkbox"/>	Deteriorated <input type="checkbox"/>	Ruins <input type="checkbox"/>
INTEGRITY	(Check One)			(Check One)	
	Altered <input checked="" type="checkbox"/>	Unaltered <input type="checkbox"/>		Moved <input type="checkbox"/>	Original Site <input checked="" type="checkbox"/>

DESCRIBE THE PRESENT AND ORIGINAL (If known) PHYSICAL APPEARANCE

The Jefferies House is a one and one-half story frame cottage of exceptional quality. The main house is of the center hall plan with four rooms. A kitchen wing and a bedroom wing have been added to the house, in 1927, and do not detract from its appearance. The heavy overhanging portico is supported by six square columns and is panelled with flush siding. Two small windows are centered in the gable. The cornice and verge-board are flat with shallow brackets supporting a narrow fascia. The bracket detail is continued in the gable end of the pediment. The siding, with the exception of the front elevation is clapboard. The house has flat corner boards, and simple window trim of the Greek Revival period. The entrance is a panelled door with flanking side lights and a fixed transom.

Interior detail is almost all original and Greek Revival in design, including excellent doorways, an enclosed stairway and four fireplaces with good carved mantels. Floors in the original section are of wide pine, ceilings are pine and walls are wood and plaster. The grounds and the house are in excellent condition.

SEE INSTRUCTIONS

8. SIGNIFICANCE

PERIOD (Check One or More as Appropriate)

Pre-Columbian 16th Century 18th Century 20th Century
 15th Century 17th Century 19th Century

SPECIFIC DATE(S) (If Applicable and Known)

1852-53

AREAS OF SIGNIFICANCE (Check One or More as Appropriate)

Aboriginal	Education	<input type="checkbox"/>	Political	<input type="checkbox"/>	Urban Planning	<input type="checkbox"/>
Prehistoric	Engineering	<input type="checkbox"/>	Religion/Phi-		Other (Specify)	<input type="checkbox"/>
Historic	Industry	<input type="checkbox"/>	losophy	<input type="checkbox"/>	_____	
Agriculture	Invention	<input type="checkbox"/>	Science	<input type="checkbox"/>	_____	
Art	Landscape	<input type="checkbox"/>	Sculpture	<input type="checkbox"/>	_____	
Commerce	Architecture	<input type="checkbox"/>	Social/Human-		_____	
Communications	Literature	<input type="checkbox"/>	itarian	<input type="checkbox"/>	_____	
Conservation	Military	<input type="checkbox"/>	Theater	<input type="checkbox"/>	_____	
	Music	<input type="checkbox"/>	Transportation	<input type="checkbox"/>	_____	

STATEMENT OF SIGNIFICANCE (Include Personages, Dates, Events, Etc.)

The Jeffries House was built for Augustine Hansell in 1852-53 by Thomas County and Thomasville's most important architect, John Wind. Hansell was Mayor in 1859, a Judge of the Superior Court of the Southern Judicial Circuit and a lieutenant in the Thomasville Guards. He organized the Thomas Reserves and was commander of one of Thomas County's Militia Companies.

The house is now owned by Mrs. M.H. Jefferies, grand-daughter of Hansell, and the house has been in the same family since it was built. It is one of the three best 'cottages' in Thomasville.

SEE INSTRUCTIONS

9. MAJOR BIBLIOGRAPHICAL REFERENCES

Perkerson, M.F. White Columns in Georgia, pp306

Rogers, W.W., Ante-Bellum Thomas County, Tallahassee, 1963
pp.17, 22-23, 40, 79, 105, 115, 119

10. GEOGRAPHICAL DATA

LATITUDE AND LONGITUDE COORDINATES DEFINING A RECTANGLE LOCATING THE PROPERTY				OR	LATITUDE AND LONGITUDE COORDINATES DEFINING THE CENTER POINT OF A PROPERTY OF LESS THAN ONE ACRE			
CORNER	LATITUDE				LONGITUDE			
NW	Degrees	Minutes	Seconds	Degrees	Minutes	Seconds		
NE	30	50	17	83	58	19		
SE	30	50	16	83	58	16		
SW	30	50	16	83	58	16		

LIST ALL STATES AND COUNTIES FOR PROPERTIES OVERLAPPING STATE OR COUNTY BOUNDARIES

STATE:	CODE	COUNTY	CODE
STATE:	CODE	COUNTY:	CODE
STATE:	CODE	COUNTY:	CODE
STATE:	CODE	COUNTY:	CODE

11. FORM PREPARED BY

NAME AND TITLE: **Russell Wright, Consultant**

ORGANIZATION: **Thomasville Landmarks, Inc.** DATE: **12/5/69**

STREET AND NUMBER: **Box 44**

CITY OR TOWN: **Thomasville** STATE: **Georgia** CODE: **10**

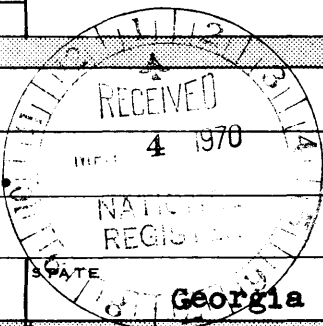

NO UTM
CX
SEE INSTRUCTIONS

12. STATE LIAISON OFFICER CERTIFICATION

As the designated State Liaison Officer for the National Historic Preservation Act of 1966 (Public Law 89-665), I hereby nominate this property for inclusion in the National Register and certify that it has been evaluated according to the criteria and procedures set forth by the National Park Service. The recommended level of significance of this nomination is:

National State Local

Name: Mary Gugony Jurrett

Title: State Liaison Officer - Ga.

Date: Apr. 28, 1970

NATIONAL REGISTER VERIFICATION

I hereby certify that this property is included in the National Register.

Ernest Allen Connolly
Chief, Office of Archeology and Historic Preservation

Date: JUN 22 1970

ATTEST:

William J. ...
Keeper of The National Register

Date: MAY 27 1970

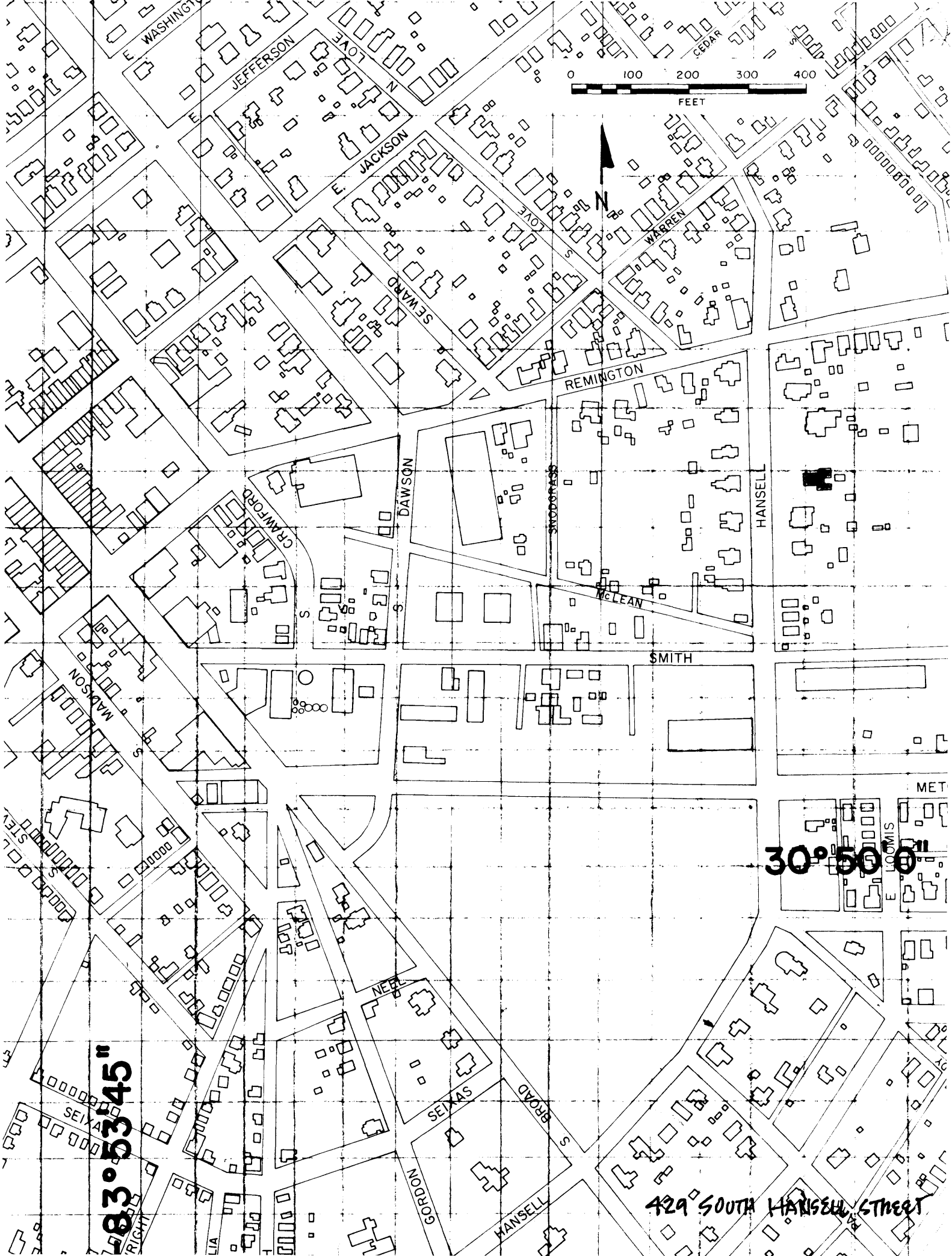
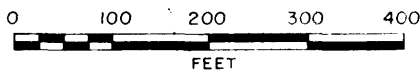

83° 53' 45"

30° 50' 0"

429 SOUTH HANSELL STREET