

FORM B - BUILDING

AREA	FORM NO.
MID CAM.	II B 30A

MASSACHUSETTS HISTORICAL COMMISSION  
80 BOYLSTON STREET, BOSTON, MA 02116

USGS Map #24

-----

PHOTO: (3x3" or 3x5", black & white)  
staple to left side of form

Photo number 88-30A

-----

Town Cambridge, Mass.  
Cambridge MRA

Address 19 Ware Street

Historic Name The Stanstead

Use: Present residential

Original residential

DESCRIPTION:

Date 1887

Source building permit

Style Romanesque Revival

Architect J.R. & W.P. Richards

Exterior wall fabric brick

Outbuildings NA

Major alterations (with dates) none

Moved no Date NA

Approx. acreage .2867 acres

SKETCH MAP

Show property's location in relation to nearest cross streets and/or geographical features. Indicate all buildings between inventoried property and nearest intersection. Indicate north.

SEE ATTACHED MAP

Recorded by T. Alduino

Organization Cambridge Historical Com.

Date 1985

UTM 19/325910/4693230

USGS Quad: Boston South (Staple additional sheets here)

Setting In character. Ware Street is largely residential with apartment buildings such as The Stanstead, predominating. A notable neighbor includes the New England Telephone at 10 Ware Street (1932), a brick Neo-Georgian structure built to resemble an apartment house.

ARCHITECTURAL SIGNIFICANCE (Describe important architectural features and  
evaluate in terms of other buildings within the community.)

The Stanstead meets Criterion C as an early example of the apartment house type. Built for John H. Hubbard, a Harvard Square apothecary, this three story apartment building has a center entrance flanked by projecting three story bays. The side elevations also have projecting bays. The principal Romanesque details are the Richardsonian arched doorway, the patterned horizontal brick courses and parapet with recessed panels, and the irregular fenestration. The windows are trimmed in freestone. The architects, J.R. and W.P. Richards designed several multi-family  
HISTORICAL SIGNIFICANCE (Explain the role owners played in local or state history and how the building relates to the development of the community.) Continued

The Stanstead is an early example of a single entrance apartment house modeled after wood frame triple deckers which were just becoming popular in Cambridge. Some contemporary multi-family dwellings such as 23-29 Ware Street (1886-87), also built for John H. Hubbard, were modeled after earlier rowhouse types, had several entrances, and were divided vertically instead of horizontally into flats. Other multi-unit dwellings were disguised as single family residences: 382-392 Harvard Street (1889, J.R. & W.P. Richards). The Stanstead presents itself openly as an apartment house and is significant under Criterion A, for its importance in understanding the emergence of multi-unit dwellings as an acceptable living alternative in Cambridge.

BIBLIOGRAPHY and/or REFERENCES (name of publication, author, date and publisher)

SEE ATTACHED BIBLIOGRAPHY

INVENTORY FORM CONTINUATION SHEET

MASSACHUSETTS HISTORICAL COMMISSION  
Office of the Secretary, Boston

Community: Cambridge, Mass. Cambridge MRA	Form No: II B 30A
Property Name: The Stanstead	

Indicate each item on inventory form which is being continued below.

Architectural Significance con't.

dwellings in Cambridge, including the elaborate single entrance apartment house, The Jarvis (1890), with a similiar Richardsonian arch. The Stanstead meets criteria C as an early apartment building.

Staple to Inventory form at bottom

MASSACHUSETTS HISTORICAL COMMISSION  
Office of the Secretary, Boston

Cambridge Cambridge	Mass. MRA	MC II B 30A
Property Name: 19 Ware St.		

Indicate each item on inventory form which is being continued below.

Bibliography/References

- Cambridge Historical Commission. Survey of Architectural History in Cambridge: Volume I, East Cambridge (1965), out of print.  
Volume II, Mid Cambridge (1967), Cambridge, MA  
Volume III, Cambridgeport (1971), Cambridge, MA  
Volume IV, Old Cambridge (1973), Cambridge, MA  
Volume V, Northwest Cambridge (1977), Cambridge, MA
- Cambridge Historical Society, Proceedings (1906-Present), Cambridge, MA.
- D.A.R., Winthrop Chapter, An Historical Guide to Cambridge (1907), Cambridge, MA.
- Gillman, A. (ed.), Cambridge of Eighteen Hundred and Ninety-Six (1896), Cambridge, MA.
- Paige, L.R., History of Cambridge (1877), Boston, MA.; Supplement (1930), Boston, MA.
- Rand, C., Cambridge, U.S.A. (1964), New York, NY.
- Rettig, R.B., Guide to Cambridge Architecture (1969), Cambridge, MA.
- Stillman, W.J. (ed.), Poetic Localities of Cambridge (1876), Cambridge, MA.
- Woods, R.A., and Kennedy, A.J. (Warner, ed.), Zone of Emergence (1962), Cambridge, MA.
- Zaitzevsky, C., with the advice of the Review Committee members, The Harvard University Study of Historic and Architectural Properties in the Environs of Cambridge, (April 1983-December 1984), Cambridge, MA.

Staple to Inventory form at bottom

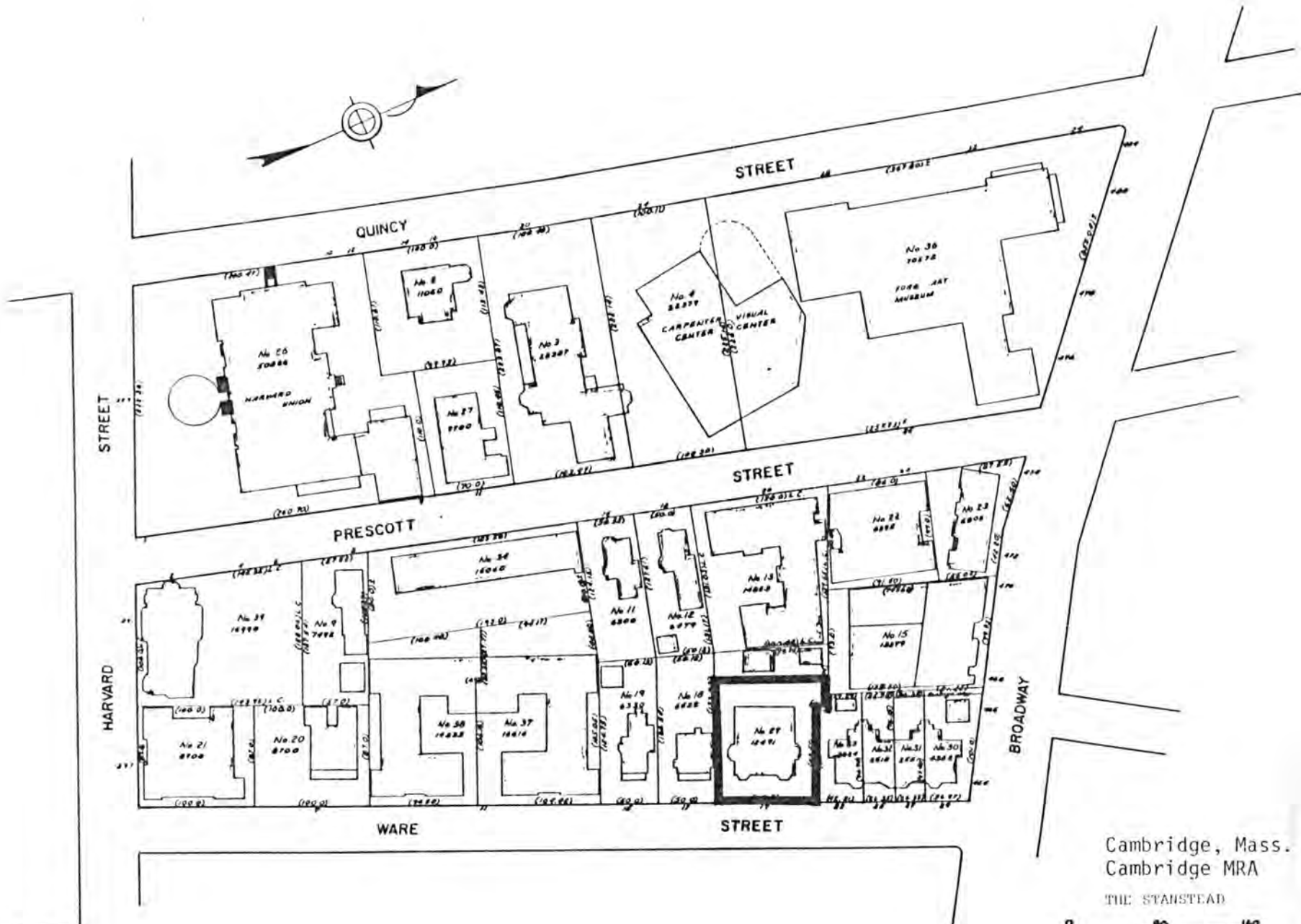

Cambridge, Mass.  
Cambridge MRA

THE STANSTEAD



Base: City of Cambridge  
Assessor's Plans

January 1983

United States Department of the Interior  
National Park Service

National Register of Historic Places  
Inventory—Nomination Form

For NPS use only  
received  
date entered

Continuation sheet

Item number

Page

Multiple Resource Area  
Thematic Group

Name Cambridge Multiple Resource Area  
State MASSACHUSETTS

Nomination/Type of Review

Date/Signature

181. Memorial Drive Apartments Hist. Dist.

Entered in the  
National Register

*for* Keeper Alvina Byers 5/19/86

Attest

182. Montrose, The

Entered in the  
National Register

*for* Keeper Alvina Byers 5/19/86

Attest

183. Peabody Court Apartments

Entered in the  
National Register

*for* Keeper Alvina Byers 5/19/86

Attest

184. Shady Hill Historic District

Substantive Review

*for* Keeper Patrick Andrews 5/19/86

Attest

Beth A. Savage 5-19-86

185. Stanstead, The

Entered in the  
National Register

*for* Keeper Alvina Byers 5/19/86

Attest

186. Stickney-Shepard House

Entered in the  
National Register

*for* Keeper Alvina Byers 5/19/86

Attest

187. Warren, H. Langford, House

Entered in the  
National Register

*for* Keeper Alvina Byers 5/19/86

Attest

188. Withey, S. B., House

Entered in the  
National Register

*for* Keeper Alvina Byers 5/19/86

Attest

189. Wood, J. A., House

Entered in the  
National Register

*for* Keeper Alvina Byers 5/19/86

Attest

190. Biological Laboratory

Substantive Review

*for* Keeper automatically  
DOE/owner obj. 1/26/87

Attest

DOE/OWNER OBJECTION

Determined Eligible

NATIONAL REGISTER OF HISTORIC PLACES  
EVALUATION/RETURN SHEET

Stanstead, The (Cambridge MRA)  
Middlesex County  
MASSACHUSETTS

Working No. APR 4 1986  
Fed. Reg. Date: 2/3/87  
Date Due: 5/1/86 - 5/19/86  
Action:  ACCEPT 5-19-86  
 RETURN  
 REJECT  
Federal Agency: \_\_\_\_\_

Entered in 1986  
National Register

- resubmission
- nomination by person or local government
- owner objection
- appeal

Substantive Review:  sample  request  appeal  NR decision

Reviewer's comments:

Recom./Criteria \_\_\_\_\_  
Reviewer \_\_\_\_\_  
Discipline \_\_\_\_\_  
Date \_\_\_\_\_  
\_\_\_\_\_ see continuation sheet

Nomination returned for: \_\_\_\_\_ technical corrections cited below  
\_\_\_\_\_ substantive reasons discussed below

1. Name

2. Location

3. Classification

Category	Ownership	Status	Present Use
	Public Acquisition	Accessible	

4. Owner of Property

5. Location of Legal Description

6. Representation in Existing Surveys

Has this property been determined eligible?  yes  no

7. Description

Condition

- excellent
- good
- fair
- deteriorated
- ruins
- unexposed

Check one

- unaltered
- altered

Check one

- original site
- moved date \_\_\_\_\_

Describe the present and original (if known) physical appearance

- summary paragraph
- completeness
- clarity
- alterations/integrity
- dates
- boundary selection

---

**8. Significance**

Period \_\_\_\_\_ Areas of Significance—Check and justify below

Specific dates \_\_\_\_\_ Builder/Architect \_\_\_\_\_  
Statement of Significance (*in one paragraph*)

- summary paragraph
- completeness
- clarity
- applicable criteria
- justification of areas checked
- relating significance to the resource
- context
- relationship of integrity to significance
- justification of exception
- other

---

**9. Major Bibliographical References**

---

**10. Geographical Data**

Acreage of nominated property \_\_\_\_\_

Quadrangle name \_\_\_\_\_

UTM References \_\_\_\_\_

---

Verbal boundary description and justification

---

**11. Form Prepared By**

---

**12. State Historic Preservation Officer Certification**

The evaluated significance of this property within the state is:

\_\_\_\_ national      \_\_\_\_ state      \_\_\_\_ local

State Historic Preservation Officer signature

title \_\_\_\_\_ date \_\_\_\_\_

---

**13. Other**

- Maps
- Photographs
- Other

Questions concerning this nomination may be directed to \_\_\_\_\_

Signed \_\_\_\_\_ Date \_\_\_\_\_ Phone: \_\_\_\_\_



The Stanstead  
*Cambridge MA Ma*  
19 Ware Street

88-30A

Please refer to the map in the  
Multiple Property Cover Sheet  
for this property

Multiple Property Cover Sheet Reference Number: 64000275