

UNITED STATES DEPARTMENT OF THE INTERIOR
NATIONAL PARK SERVICE

**NATIONAL REGISTER OF HISTORIC PLACES
INVENTORY -- NOMINATION FORM**

FOR FEDERAL PROPERTIES

FOR NPS USE ONLY

RECEIVED

JAN 31 1986

DATE ENTERED

JUL 17 1986

SEE INSTRUCTIONS IN *HOW TO COMPLETE NATIONAL REGISTER FORMS*
TYPE ALL ENTRIES -- COMPLETE APPLICABLE SECTIONS

1 NAME

HISTORIC

United States Post Office

AND/OR COMMON

Norwich Main Post Office

2 LOCATION

STREET & NUMBER

340 Main Street

— NOT FOR PUBLICATION

CITY, TOWN

Norwich

N/A VICINITY OF

CONGRESSIONAL DISTRICT

Second Congressional District

STATE

Connecticut

CODE
0520

COUNTY

New London

CODE
011

2 CLASSIFICATION

CATEGORY	OWNERSHIP	STATUS	PRESENT USE
<input type="checkbox"/> DISTRICT	<input checked="" type="checkbox"/> PUBLIC	<input checked="" type="checkbox"/> OCCUPIED	<input type="checkbox"/> AGRICULTURE
<input checked="" type="checkbox"/> BUILDING(S)	<input type="checkbox"/> PRIVATE	<input type="checkbox"/> UNOCCUPIED	<input type="checkbox"/> MUSEUM
<input type="checkbox"/> STRUCTURE	<input type="checkbox"/> BOTH	<input type="checkbox"/> WORK IN PROGRESS	<input type="checkbox"/> COMMERCIAL
<input type="checkbox"/> SITE	PUBLIC ACQUISITION	ACCESSIBLE	<input type="checkbox"/> EDUCATIONAL
<input type="checkbox"/> OBJECT	N/A IN PROCESS	<input checked="" type="checkbox"/> YES: RESTRICTED	<input type="checkbox"/> ENTERTAINMENT
	<input type="checkbox"/> BEING CONSIDERED	<input type="checkbox"/> YES: UNRESTRICTED	<input checked="" type="checkbox"/> GOVERNMENT
		<input type="checkbox"/> NO	<input type="checkbox"/> RELIGIOUS
			<input type="checkbox"/> INDUSTRIAL
			<input type="checkbox"/> MILITARY
			<input type="checkbox"/> PARK
			<input type="checkbox"/> PRIVATE RESIDENCE
			<input type="checkbox"/> SCIENTIFIC
			<input type="checkbox"/> TRANSPORTATION
			<input type="checkbox"/> OTHER:

4 AGENCY

REGIONAL HEADQUARTERS: (If applicable)

New England Field Real Estate and Building Office

STREET & NUMBER

1050 Waltham Street

CITY, TOWN

Lexington

N/A VICINITY OF

STATE

Massachusetts 02173

5 LOCATION OF LEGAL DESCRIPTION

COURTHOUSE,

REGISTRY OF DEEDS, ETC.

City and Town Clerk's Office

STREET & NUMBER

City Hall, 100 Broadway, Room 214

CITY, TOWN

Norwich

STATE

Connecticut 06360

6 REPRESENTATION IN EXISTING SURVEYS

TITLE

Historic Resources Inventory Buildings and Structures

DATE

January 1981

— FEDERAL STATE — COUNTY — LOCAL

DEPOSITORY FOR
SURVEY RECORDS

Connecticut Historic Commission

CITY, TOWN

59 South Prospect Street

STATE

Hartford, CT 06106

7 DESCRIPTION

CONDITION		CHECK ONE	CHECK ONE
<input checked="" type="checkbox"/> EXCELLENT	<input type="checkbox"/> DETERIORATED	<input type="checkbox"/> UNALTERED	<input checked="" type="checkbox"/> ORIGINAL SITE
<input type="checkbox"/> GOOD	<input type="checkbox"/> RUINS	<input checked="" type="checkbox"/> ALTERED	<input type="checkbox"/> MOVED DATE _____
<input type="checkbox"/> FAIR	<input type="checkbox"/> UNEXPOSED		

DESCRIBE THE PRESENT AND ORIGINAL (IF KNOWN) PHYSICAL APPEARANCE

The original building and its addition are located on the edge of the downtown within a highly mixed area. There are residential, commercial, governmental, and recreational facilities; some of which are in a poor state of repair.

The post office site is very well maintained and sensitively landscaped. Great care had been taken to reflect the symmetry of the building. The exterior of the building is in excellent condition. The interior lobby, while in very good condition, has been somewhat modified from its original grandeur.

The Post Office was constructed of brick and stone with a portico of four fluted ionic columns at the entry. The building was designed as a monument to symbolize Federal ideas and bring an example of sophisticated architecture to the community. The first facade incorporates medallions which support the cornice and a stone ballustrade screens the mansard style roof from sight. A recent re-roofing and flashing project added a metal flashing at the ballustrade which somewhat distracts from the original aesthetics. The windows are wood double hung on the first floor with fixed single panels on the second floor. An elaborate stone architrave caps the larger windows which have been set in a brick wall with cast stone quoins at the corners. The interior contains ionic pilasters reflecting the exterior columns combined with elaborately detailed ceiling mouldings. The woodwork in the lobby area also is precisely appointed and has been treated with a deep stain.

The building has an exterior bearing wall and steel frame structure. The 1938 building addition, which flanks both sides of the existing building, was designed to maintain the symmetry of the original building and utilizes similar materials. Although the addition lacks the ornamentation and monumentality of the original building, it does contain some similar details which visually ties the facades together.

8 SIGNIFICANCE

PERIOD	AREAS OF SIGNIFICANCE -- CHECK AND JUSTIFY BELOW			
<input type="checkbox"/> PREHISTORIC	<input type="checkbox"/> ARCHEOLOGY-PREHISTORIC	<input type="checkbox"/> COMMUNITY PLANNING	<input type="checkbox"/> LANDSCAPE ARCHITECTURE	<input type="checkbox"/> RELIGION
<input type="checkbox"/> 1400-1499	<input type="checkbox"/> ARCHEOLOGY-HISTORIC	<input type="checkbox"/> CONSERVATION	<input type="checkbox"/> LAW	<input type="checkbox"/> SCIENCE
<input type="checkbox"/> 1500-1599	<input type="checkbox"/> AGRICULTURE	<input type="checkbox"/> ECONOMICS	<input type="checkbox"/> LITERATURE	<input type="checkbox"/> SCULPTURE
<input type="checkbox"/> 1600-1699	<input checked="" type="checkbox"/> ARCHITECTURE	<input type="checkbox"/> EDUCATION	<input type="checkbox"/> MILITARY	<input type="checkbox"/> SOCIAL/HUMANITARIAN
<input type="checkbox"/> 1700-1799	<input type="checkbox"/> ART	<input type="checkbox"/> ENGINEERING	<input type="checkbox"/> MUSIC	<input type="checkbox"/> THEATER
<input type="checkbox"/> 1800-1899	<input type="checkbox"/> COMMERCE	<input type="checkbox"/> EXPLORATION/SETTLEMENT	<input type="checkbox"/> PHILOSOPHY	<input type="checkbox"/> TRANSPORTATION
<input checked="" type="checkbox"/> 1900-	<input type="checkbox"/> COMMUNICATIONS	<input type="checkbox"/> INDUSTRY	<input type="checkbox"/> POLITICS/GOVERNMENT	<input type="checkbox"/> OTHER (SPECIFY)
		<input type="checkbox"/> INVENTION		

SPECIFIC DATES	Designed: 1903 Built: 1905	Addition: 1940	Original Building- James Knox Taylor Addition - Louis A. Simon
----------------	-------------------------------	----------------	---

STATEMENT OF SIGNIFICANCE

The original post office was built by Congressional Authorization under the provisions of the Tarsney Act (1893-1912) by James Knox Taylor, Supervising Architect of the Treasury. The building was designed in 1903, one of only six buildings designed that year throughout the United States, and built in 1905. This post office occupies a prominent position in both location and design. The building also functions as a stabilizing influence within the town. The building is an excellent example of Neo-Classical architecture both in its relationship to the local community and as an example of a building designed by an Architect in the Federal employ.

The building, which employs modern steel frame construction, demonstrates an affluency for fine detail. The stone work is utilized on many fine details on the ballustrades, medallions, quoins, columns and window surrounds.

Because this building was only one of six buildings designed by the Supervising Architect Taylor in 1903, much attention was spent in its detailing.

The addition, which was built in 1938, was designed by Supervising Architect Louis A. Simon. It reflected the new attitude for government building to be efficient and economical and speedy to construct. The addition is very simple yet contributes to the existing building's symmetry. The building was constructed under the Public Works Administration as part of the expanded public building program of 1926 after the crash of 1929 and the subsequent depression to help stimulate the local economy.

9 MAJOR BIBLIOGRAPHICAL REFERENCES Building Evaluation Forms, C. 1979
History of Post Office Construction 1900-1940, July, 1982

Craig, Lois, ed., The Federal Presence: Architecture, Politics and Symbols in the United States Government Building, Cambridge, Massachusetts: The MIT Press, 1979

Harby, Stephen W., Norwich, CT: A Guide to its Architecture, 1976

10 GEOGRAPHICAL DATA

ACREAGE OF NOMINATED PROPERTY .91

UTM REFERENCES

A	1 8	7 4 4 3 2 0	4 6 0 0 9 0 0	B			
	ZONE	EASTING	NORTHING		ZONE	EASTING	NORTHING
C				D			

VERBAL BOUNDARY DESCRIPTION

The Post Office building is located on an irregularly shaped lot with a 175.81 frontage on Main Street. The eastern boundary which runs perpendicular to Main Street and borders the Elks Hall is 264.9 feet long. The remaining lot lines are irregularly laid out dividing the land between the Post Office and adjacent buildings. Except for the raised landscape front setback, the remainder of the site is used for vehicular parking, drives, and pedestrian walkways.

LIST ALL STATES AND COUNTIES FOR PROPERTIES OVERLAPPING STATE OR COUNTY BOUNDARIES

STATE	CODE	COUNTY	CODE
STATE	CODE	COUNTY	CODE

11 FORM PREPARED BY

NAME / TITLE

Richard P. DeCoste

ORGANIZATION

SULLIVAN DESIGN GROUP, INC.

DATE

July 17, 1985

STREET & NUMBER

44 ADAMS STREET

TELEPHONE

(617) 848-1545

CITY OR TOWN

Braintree,

STATE

Massachusetts 02184

12 CERTIFICATION OF NOMINATION

STATE HISTORIC PRESERVATION OFFICER RECOMMENDATION

YES NO NONE

[Signature]
STATE HISTORIC PRESERVATION OFFICER SIGNATURE

In compliance with Executive Order 11593, I hereby nominate this property to the National Register, certifying that the State Historic Preservation Officer has been allowed 90 days in which to present the nomination to the State Review Board and to evaluate its significance. The evaluated level of significance is National State Local.

FEDERAL REPRESENTATIVE SIGNATURE

TITLE

[Signature]

Director, Office of Real Estate

DATE

[Signature]

FOR NPS USE ONLY

I HEREBY CERTIFY THAT THIS PROPERTY IS INCLUDED IN THE NATIONAL REGISTER

DIRECTOR, OFFICE OF ARCHEOLOGY AND HISTORIC PRESERVATION

DATE

7/17/86

ATTEST:

[Signature]

DATE

7-15-86

KEEPER OF THE NATIONAL REGISTER

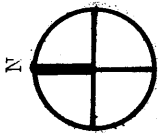

Floor
Covering

PARK STREET

ELKS HALL

- 1) Box Lobby
- 2) Service Lobby
- 3) Postmaster
- 4) Assistant Postmaster
- 5) Work Area
- 6) Mailing Platform
- 7) Loading Dock

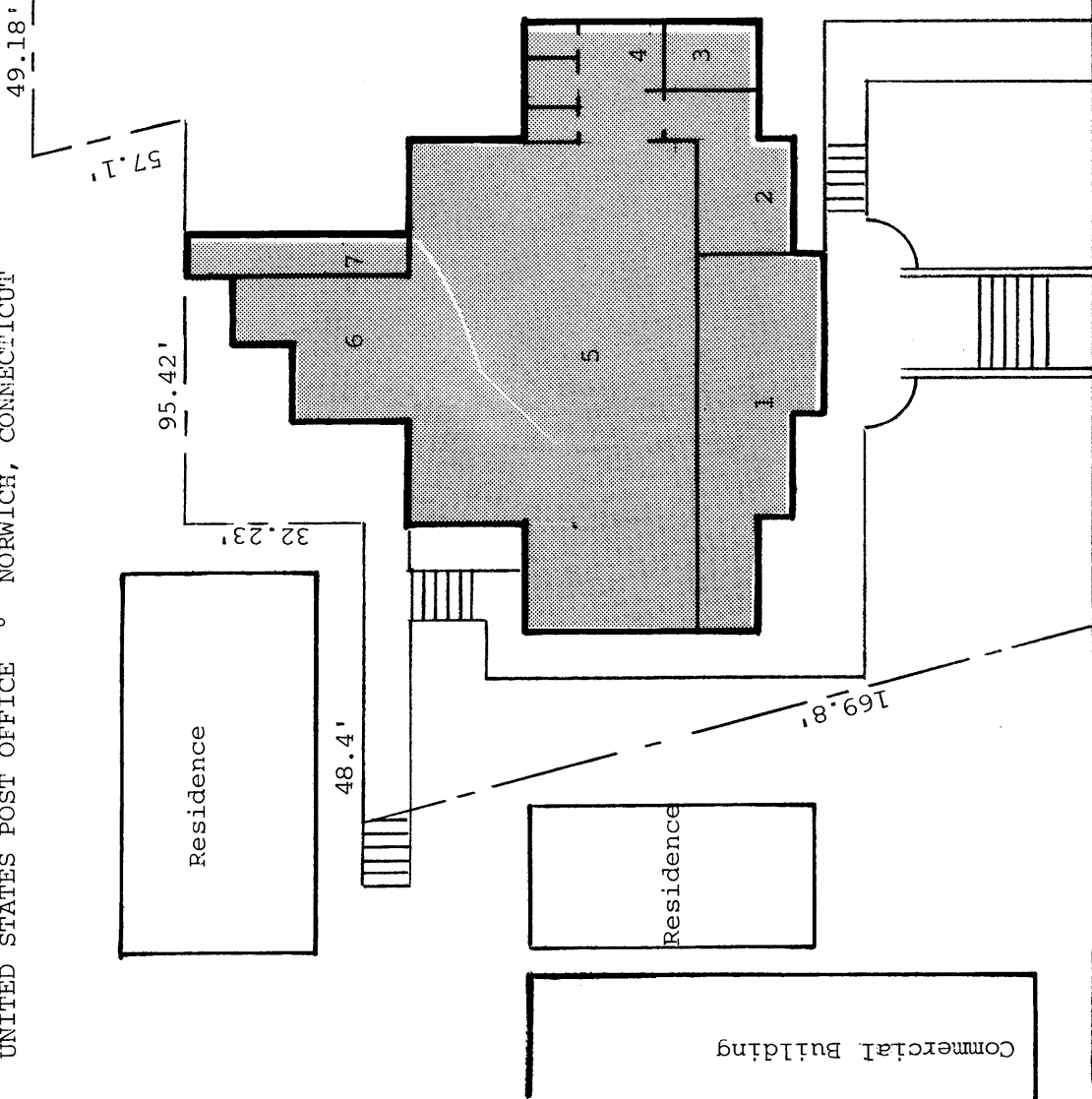

MAIN STREET

Y. M. C. A.

Residence

Commercial Building

Residence

Residence