

58 574

C. NUMBER 82-196-0253

B. COUNTY Vanderburgh

A. NAME EDWARDS MFG.

F. QUAD SHEET Evansville South

E. TOWN/CTY Evansville

D. ADDRESS 326 N. W. Sixth Street

I. UTM Reference 4205080

16 449780

CENSUS TRACT # 10

H. HAER

HABS

NR

NHL

H.

G. SITE X STRUCTURE

STATE OF INDIANA DEPARTMENT OF NATURAL RESOURCES INDIANA HISTORIC SITES AND STRUCTURES INVENTORY

1. HISTORIC NAME L. PUSTER & CO. FURNITURE MFG. 2. OWNERSHIP: PUBLIC X PRIVATE NAME W.C. Bussing, Jr. ADDRESS Stockwells Eng. Bldg 15; Lots 1-4. (29-30-1)

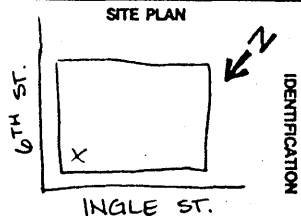

5. USE PRESENT PAST 6. CATEGORY DISTRICT X BUILDING(S) STRUCTURE SITE OBJECT 8. ENDANGERED X NO YES/BY WHAT 7. ACCESSIBLE X YES/RESTRICTED YES/UNRESTRICTED NO 9. DATE 1887 10. ARCHITECT/BUILDER

11. PERIODS: PREHIS/ORIC 17TH/18TH CEN. 1800-1860 X 1861-1899 1900-PRESENT

12. AREAS OF SIGNIFICANCE Archeology-Prehistoric Conservation Law Sculpture Archeology-Historic Economics Literature Social/Humanitarian Agriculture Education Military Theater X Architecture Engineering Music Transportation Art Exploration/Settlement Philosophy Other (Specify) Commerce X Industry Politics/Government Communications Invention Religion Community Planning Landscape Architecture Science

13. STYLE Federal Greek Revival Gothic Revival Italianate Second Empire Stick Style/Eastlake Queen Anne Romanesque Revival Colonial Revival Neo-Classical Bungalow Vernacular X Other (Specify) NONE X MAJOR 14. CONDITION EXCELLENT X GOOD FAIR DETERIORATED RUINS UNEXPOSED 16. SITE INTEGRITY X ORIGINAL SITE MOVED DATE 17. OUTBUILDINGS/SECONDARY STRUCTURES X NO YES

15. ALTERATIONS UNALTERED X MINOR MAJOR 18. IN ESTABLISHED HISTORIC DISTRICT X NO YES/NAME

19. DESCRIPTION OF ENVIRONMENT (NATURAL AND MAN-MADE) DOWNTOWN AREA. FIRST FLOOR FACADE "MODERNIZED" A LONG TIME AGO, TO PLASTER (OR CONCRETE?) WITH BLACK GLASS FRAMING WINDOWS AND DOORS

20. INFORMATION SOURCES TOWNSHIP ASSESSOR

21. PREPARED BY NANCY J. LONG 22. DATE 10/13/77; 7/78

Architectural Information

- 1. 2. 3. 4. 5. 6. 7. 8. 9. 10. 11. 12. 13. 14. 15. 16. FOUR STORY INDUSTRIAL BUILDING CONSIDERABLE DECORATIVE BRICK 17. DETAILING, INCLUDING ANGLED BRICKS, GROOVES, CORBELLING, STRING 18. COURSING IN DARKER BRICK. BASICALLY COMMON BOND RED BRICK. 19. STARS AT ENDS OF TIE-RODS. SEGMENTAL ARCHED WINDOWS W/ 20. RADIATING BRICK HEADS (DARK HEADER COURSE FIRST 2 FLOORS). 21. DOUBLEHUNG SASHES, 6 OVER 6 LARGE CHIMNEY STACK AT ONE 22. CORNER. 23. 24. Furniture manufactory 25. 26. 27. 28. 29. 30. 31. 32. 33. 34. 35.



36

STATE OF INDIANA
DEPARTMENT OF NATURAL RESOURCES
INDIANA HISTORIC SITES AND STRUCTURES INVENTORY

Historical Information

A. NAME Edwards Manufacturin-Puster Furniture c. NUMBER 82-196-0253
Building

B. ADDRESS ¹²⁰~~324~~ NW Sixth Street

D. UTM References |1,6| |4,4,9|7,8,0| |4,2|0,3|0,8,0|

E. Evansville developed a reputation in the 19th Century as a furniture manufacturing center of large proportions. Louis Puster and three associates built this block (originally one-half of a pair) in 1887 to house their furniture concern. Puster & Company--along with the majority of the Evansville furniture industry--vanished in the 1930s and the Great Depression.

F. INFORMATION SOURCES City Directories; Deed Records.

G. PREPARED BY Douglas L. Stern

H. DATE 28 January 1982
