

United States Department of the Interior
National Park Service

National Register of Historic Places
Inventory—Nomination Form

For NPS use only

received **Aug 18 1983**
date entered

See instructions in *How to Complete National Register Forms*
Type all entries—complete applicable sections

1. Name

historic N/A

and/or common Flagstaff

2. Location

street & number 1815 Lakeshore Drive N/A not for publication

city, town Mandeville N/A vicinity of

state LA code 22 parish ~~LA 22~~ St. Tammany code 103

3. Classification

Category	Ownership	Status	Present Use
<input type="checkbox"/> district	<input type="checkbox"/> public	<input checked="" type="checkbox"/> occupied	<input type="checkbox"/> agriculture
<input checked="" type="checkbox"/> building(s)	<input checked="" type="checkbox"/> private	<input type="checkbox"/> unoccupied	<input type="checkbox"/> commercial
<input type="checkbox"/> structure	<input type="checkbox"/> both	<input type="checkbox"/> work in progress	<input type="checkbox"/> educational
<input type="checkbox"/> site	Public Acquisition	Accessible	<input type="checkbox"/> entertainment
<input type="checkbox"/> object	<u>N/A</u> in process	<input checked="" type="checkbox"/> yes: restricted	<input type="checkbox"/> government
	<u>N/A</u> being considered	<input type="checkbox"/> yes: unrestricted	<input type="checkbox"/> industrial
		<input type="checkbox"/> no	<input type="checkbox"/> military
			<input type="checkbox"/> museum
			<input type="checkbox"/> park
			<input checked="" type="checkbox"/> private residence
			<input type="checkbox"/> religious
			<input type="checkbox"/> scientific
			<input type="checkbox"/> transportation
			<input type="checkbox"/> other:

4. Owner of Property

name Dr. and Mrs. Harvey Colvin 504-626-8524

street & number 1815 Lakeshore Drive

city, town Mandeville N/A vicinity of state LA 70448

5. Location of Legal Description

courthouse, registry of deeds, etc. St. Tammany Parish Courthouse

street & number 510 E. Boston P. O. Box 1090

city, town Covington state LA 70433

6. Representation in Existing Surveys

title LA Historic Sites Survey has this property been determined eligible? yes no

date 1983 federal state county local

depository for survey records LA State Historic Preservation Office

city, town Baton Rouge state LA

7. Description

Condition
 excellent deteriorated
 good ruins
 fair unexposed

Check one
 unaltered
 altered

Check one
 original site
 moved date _____ N/A

Describe the present and original (if known) physical appearance

Flagstaff (c.1900) is a large two-story frame raised cottage, five bays wide, with mainly Colonial Revival details. It is located on the Pontchartrain lakefront, east of the center of Mandeville. Despite several alterations, the house retains its National Register eligibility.

The house has a single principal story which is raised eight feet above grade on brick piers. Originally the ground story service area was largely open, but today it is enclosed with latticework. The upper story has a deep front gallery and a wide central hall with a large room each side. The rear of the house consists of a pair of sizable cabinets and a deep gallery between. There is also a small side wing with a forward facing semihexagonal bay. The front gallery has six colossal columns, a full entablature, and a heavy bracketed cornice. It is surmounted by a central gable with inset scrollsawn ornamentation. Windows are plate glass and shutters are of the movable louver type. The interiors are large but plain in character.

Since construction the following changes have been made in the house;

1. A 1915 flood apparently damaged some of the columns and the original Ionic capitals were replaced with the present curious "Doric" capitals.
2. The old rear gallery has been enclosed for a family room.
3. One of the original fireplaces and both mantels have been lost.
4. A staircase has been installed and the attic has been finished off.
5. A second story rear entrance with an awning has been installed.
6. A portion of the upper front gallery has been screened in.

Assessment of Integrity:

Despite these changes, the house retains the features which establish its significance (see Item 8).

To the rear of the house is an unaltered two-story frame kitchen building which appears to be older than the house. It is listed as a contributing element because, as a support structure, it helps establish Flagstaff's identity as a period residence. Town residences of this period frequently had numerous out-buildings, although relatively few retain them. In recent years a shed awning has been attached at the rear of the kitchen. This should be seen as a minor change.

NB: The above c.1900 date is based upon the architectural evidence. It is commonly held that Flagstaff was built in 1850; however, the architectural evidence indicates that the present house dates from the turn-of-the-century.

8. Significance

Period	Areas of Significance—Check and justify below			
<input type="checkbox"/> prehistoric	<input type="checkbox"/> archeology-prehistoric	<input type="checkbox"/> community planning	<input type="checkbox"/> landscape architecture	<input type="checkbox"/> religion
<input type="checkbox"/> 1400–1499	<input type="checkbox"/> archeology-historic	<input type="checkbox"/> conservation	<input type="checkbox"/> law	<input type="checkbox"/> science
<input type="checkbox"/> 1500–1599	<input type="checkbox"/> agriculture	<input type="checkbox"/> economics	<input type="checkbox"/> literature	<input type="checkbox"/> sculpture
<input type="checkbox"/> 1600–1699	<input checked="" type="checkbox"/> architecture	<input type="checkbox"/> education	<input type="checkbox"/> military	<input type="checkbox"/> social/ humanitarian
<input type="checkbox"/> 1700–1799	<input type="checkbox"/> art	<input type="checkbox"/> engineering	<input type="checkbox"/> music	<input type="checkbox"/> theater
<input type="checkbox"/> 1800–1899	<input type="checkbox"/> commerce	<input type="checkbox"/> exploration/settlement	<input type="checkbox"/> philosophy	<input type="checkbox"/> transportation
<input checked="" type="checkbox"/> 1900–	<input type="checkbox"/> communications	<input type="checkbox"/> industry	<input type="checkbox"/> politics/government	<input type="checkbox"/> other (specify)
		<input type="checkbox"/> invention		

Specific dates c. 1900 **Builder/Architect** Uncertain

Statement of Significance (in one paragraph) Criterion C

Flagstaff is locally significant in the area of architecture because it is a very superior example of a raised cottage within the context of the town of Mandeville.

The town of Mandeville developed as a residential resort community principally in the late-nineteenth and early-twentieth centuries. The Louisiana Comprehensive Historic Sites Survey has identified some 232 older structures in Mandeville, most of which date from this period. One of the major late-nineteenth/early-twentieth century architectural types which emerged from the survey is the galleried raised cottage. These are gallery fronted houses, with the ridge of the roof parallel to the front, and with a single principal story raised above grade. Architecturally they should be seen as a continuation of the antebellum plantation raised cottage tradition.

Of the 232 identified older structures in Mandeville, 91 are cottages of this type. Some have forward facing gables, some have dormers, while others have clean rooflines. Most are relatively small and feature plain square post columns or bungalow style columns. Sixteen of Mandeville's late-nineteenth/early-twentieth century cottages are two stories high. That is to say the principal floor is raised a full story above grade and there is a service area below. Among this group there are a small number of very large examples which feature distinctive detailing and which qualify as landmarks within the town. Of these, Flagstaff is the only one which features colossal columns, a full entablature, and a fully developed bracketed cornice. The central gable adds to its monumentality. For these reasons, Flagstaff should be regarded as the apex of the late-nineteenth/early-twentieth century raised cottage tradition in Mandeville.

9. Major Bibliographical References

Louisiana Comprehensive Historic Sites Survey, St. Tammany Parish,
1915 photo of Flagstaff, copy in National Register file.

10. Geographical Data

Acreeage of nominated property @1/2 acre

Quadrangle name Mandeville, LA

Quadrangle scale 1:24000

UTM References

A

1	5	7	8	12	1	0	0	3	13	6	1	2	2	0
Zone	Easting			Northing										

B

Zone	Easting			Northing										

C

--	--	--	--	--	--	--	--	--	--	--	--	--	--	--

D

--	--	--	--	--	--	--	--	--	--	--	--	--	--	--

E

--	--	--	--	--	--	--	--	--	--	--	--	--	--	--

F

--	--	--	--	--	--	--	--	--	--	--	--	--	--	--

G

--	--	--	--	--	--	--	--	--	--	--	--	--	--	--

H

--	--	--	--	--	--	--	--	--	--	--	--	--	--	--

Verbal boundary description and justification

Please refer to attached sketch map.

List all states and counties for properties overlapping state or county boundaries

state N/A code county code

state code county code

11. Form Prepared By

Assisted by owners

name/title National Register Staff, Division of Historic Preservation

organization State of Louisiana date June 1983

street & number P.O. Box 44247 telephone 504-342-6682

city or town Baton Rouge state Louisiana 70804

12. State Historic Preservation Officer Certification

The evaluated significance of this property within the state is:

national state local

As the designated State Historic Preservation Officer for the National Historic Preservation Act of 1966 (Public Law 89-665), I hereby nominate this property for inclusion in the National Register and certify that it has been evaluated according to the criteria and procedures set forth by the National Park Service.

State Historic Preservation Officer signature



Robert B. DeBlieux

title State Historic Preservation Officer

date August 5, 1983

For NPS use only

I hereby certify that this property is included in the National Register

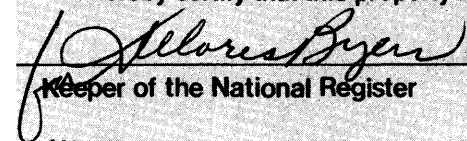
Keeper of the National Register

Entered in the
National Register

date 9/15/83

Attest:

date

Chief of Registration

BOUNDARY LINES
RUN PARALLEL TO
BUILDING FACADES,
DISTANCES AS
SHOWN. THE HOUSE
FACES LAKESHORE DRIVE.

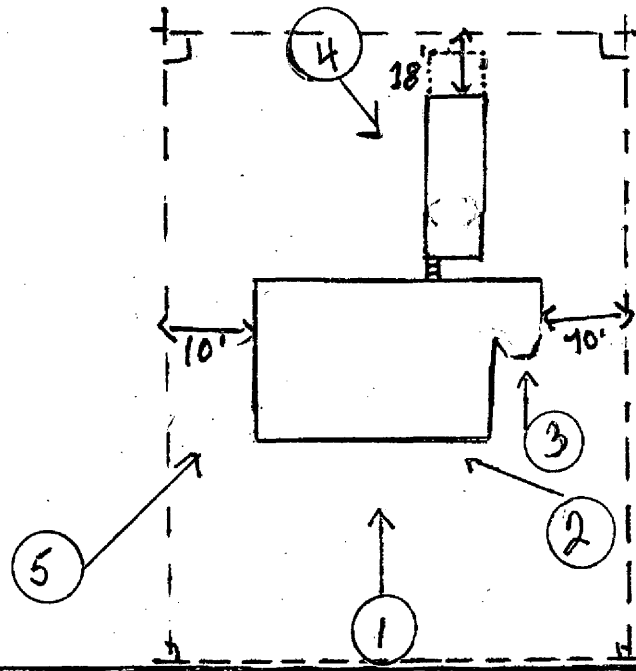

LAKESHORE DRIVE

FLAGSTAFF, MANDEVILLE, LA ST. TAMMANY PARISH