

**United States Department of the Interior  
National Park Service**

**National Register of Historic Places  
Continuation Sheet**

Section number \_\_\_\_\_ Page \_\_\_\_\_

**SUPPLEMENTARY LISTING RECORD**

**NRIS Reference Number: 93001418**

**Date Listed: 12/23/93**

Picnic Shelter-Sitting Bull Falls  
Recreation Area  
Property Name

Eddy  
County

NM  
State

Public Works of the CCC in the Lincoln National Forest MPS  
Multiple Name

-----  
This property is listed in the National Register of Historic Places in accordance with the attached nomination documentation subject to the following exceptions, exclusions, or amendments, notwithstanding the National Park Service certification included in the nomination documentation.

  
Signature of the Keeper

10/27/94  
Date of Action

=====  
**Amended Items in Nomination:**

**Period of Significance:**

The period of significance is revised to read: 1940.  
[This corresponds to the date of construction by the CCC. The years 1960 and 1993 are deleted as significant dates since no justification is provided for their exceptional nature.]

**Area of Significance:**

Entertainment/Recreation is not sufficiently justified by the statement of significance and is therefore dropped as an area of significance.

This information was confirmed with the FPO for the US Forest Service.

**DISTRIBUTION:**

- National Register property file
- Nominating Authority (without nomination attachment)

RECEIVED

14/8

United States Department of the Interior  
National Park Service

NOV 12 1993

NATIONAL REGISTER OF HISTORIC PLACES  
REGISTRATION FORM

NATIONAL  
REGISTER

This form is for use in nominating or requesting determinations of eligibility for individual properties or districts. See instructions in "Guidelines for Completing National Register Forms" (National Register Bulletin 16). Complete each item by marking "x" in the appropriate box or by entering the requested information. If an item does not apply to the property being documented, enter "N/A" for "not applicable". For functions, styles, materials, and areas of significance, enter only the categories and subcategories listed in the instructions. For additional space use continuation sheets (Form 10-900a). Type all entries.

1. Name of Property

historic name Picnic Shelter - Sitting Bull Falls Recreation Area

other names/site number AR-03-08-03-417

2. Location

street & number Sitting Bull Falls, Lincoln NF /NA/ not for publication

city, town Carlsbad / x/ vicinity

state New Mexico code NM county Eddy code 015 zip code 88220

3. Classification

Ownership of Property	Category of Property	Number of Resources within Property	
		Contributing	Noncontributing
<input type="checkbox"/> private	<input type="checkbox"/> building(s)		<input type="checkbox"/> buildings
<input type="checkbox"/> public-local	<input type="checkbox"/> district		<input type="checkbox"/> sites
<input type="checkbox"/> public-State	<input type="checkbox"/> site		<input type="checkbox"/> structures
<input checked="" type="checkbox"/> public-Federal	<input checked="" type="checkbox"/> structure	1	<input type="checkbox"/> objects
	<input type="checkbox"/> object	1	<input type="checkbox"/> Total

Name of related multiple property listing:

Number of contributing resources previously listed in the National Register 0

Public Works of the CCC in the Lincoln National Forest, NM

4. State/Federal Agency Certification

As the designated authority under the National Historic Preservation Act of 1966, as amended, I hereby certify that this X nomination  request for determination of eligibility meets the documentation standards for registering properties in the National Register of Historic Places and meets the procedural and professional requirements set forth in 36 CFR Part 60. In my opinion, the property X meets  does not meet the National Register criteria.  See continuation sheet.

*Evan J. DeBlouis*

Signature of certifying official

Date

USDA - Forest Service

National Historic Preservation Officer

Federal agency and bureau

In my opinion, the property  meets  does not meet the National Register criteria.  See continuation sheet.

*Ry Sebastia*

Signature of commenting or other official

Date

New Mexico State Historic Preservation Officer

7-19-93

State agency and bureau

| State agency and bureau |

**5. National Park Service Certification**

/ I, hereby, certify that this property is:

   entered in the National Register.

Beth Poland

12/23/93

   See continuation sheet.

   determined eligible for the National Register.

   See continuation sheet.

   determined not eligible for the National Register.

   removed from the National Register.

   other, (explain:)

Signature of the Keeper

Date of Action

**6. Function or Use**

Historic Functions (enter categories from instructions)

Recreation and Culture

Current Functions (enter categories from instructions)

Recreation and Culture

**7. Description**

Architectural Classification (enter categories from instructions)

Late 19th and Early 20th Century

American Movements

other: Rustic

Materials enter categories from instructions)

foundation Stone

walls Limestone

Sandstone

roof Wood

other Concrete

Describe present and historic physical appearance.

**DESCRIPTION**

This picnic shelter is one of two that were constructed by the Civilian Conservation Corps (CCC) in 1940 at Sitting Bull Falls Recreation Area. This shelter is small and can facilitate a large family or 2 small groups. Built in the rustic style, this shelter faces east and is situated on a hill slope on a trail to Sitting Bull Falls. It overlooks Sitting Bull Canyon and a CCC built dam. This one story, square shelter measures 26' x 19'. It is open on the north and east sides, and is against a hill slope on the south and west sides. Three concrete steps lead into the east side of the shelter.

The shelter has a stone foundation. The original floor was flagstone, but this was covered with concrete, possibly in the 1960s. This alteration is not noticeable from the exterior of the shelter and does not mar its appearance.

United States Department of the Interior  
National Park Service

NATIONAL REGISTER OF HISTORIC PLACES  
CONTINUATION SHEET

Picnic Shelter - Sitting Bull Falls Recreation Area  
Section number 7 Page 2

---

The shed roof is supported by four masonry piers that were constructed with square limestone and sandstone blocks, collected in Last Chance Canyon. The stones have a natural finish. The roof is constructed of Ponderosa pine log beams covered with 1" x 6" rough sawn boards, 1" x 2" edge metal, 30 lb felt, and asphalt roofing, which was laid with a 6" overlap and was sealed with roofing tar. In May 1992, the shelter was partially restored and rehabilitated during a historic preservation field school. Lincoln National Forest employees worked with six historic preservationists from Mary Washington College, Fredericksburg, VA, to restore the shelter roof and remove graffiti in the shelter. These restorations match the original appearance of the shelter, and thus, had no adverse effect on the structure.

Originally, the roof of the picnic shelter was constructed of log vigas, sheathing boards, and rolled asphalt. This roof had been covered with three inches of poured cement at an unknown later date. The field school and the Lincoln National Forest employees removed the roof, and replaced the rotten vigas, sheathing boards and rolled asphalt in their restoration of the shelter.

The shelter contains two painted stone and cement picnic tables, and has two small cement benches along the interior of the west wall.

The graffiti removal was undertaken with solvents, such as acetone, paint thinner, and Graffiti Remover, that did not harm the rock. The picnic tables and benches in the shelter were painted tan to cover graffiti and complement the rock material.

The above undertaking was submitted to the New Mexico State Historic Preservation Office and the modifications were considered to have no adverse effect on the shelter. It was repaired and restored to its original appearance.

Natural Setting

Sitting Bull Falls is located on the eastern edge of the Guadalupe Ranger District, 42 miles northwest of Carlsbad, at the end of Forest Road 137. The picnic shelter presented for nomination is located within Sitting Bull Falls Recreation Area in Sitting Bull Canyon on a bench to the north of Sitting Bull Falls at an elevation of 4660'. The canyon is a combination of rock cliffs and slopes over 50%. This area is very rocky and limestone and sandstone outcrops are abundant. The vegetation is predominantly scrub oak, Texas Madrone, agave, ocatillo, and prickly pear. A 150' high limestone cliff supports the water fall, and a variety of mosses and ferns grow in the immediate area. There are many natural pools above and below the falls.

See continuation sheet x

United States Department of the Interior  
National Park Service

NATIONAL REGISTER OF HISTORIC PLACES  
CONTINUATION SHEET

Picnic Shelter - Sitting Bull Falls Recreation Area  
Section number 7 Page 3

---

History of the Surrounding Area

Sitting Bull Falls was originally part of a large ranch owned by Albert Knott from the early 1900s to 1924. At that time, the area was isolated and had a very natural setting. The Forest Service purchased Sitting Bull Falls in the mid-1920s, and by 1931 visitors could reach the falls by hiking one mile from a graded Forest Service road.

Sitting Bull Falls was a very unique and popular recreation site. Visitors traveled long distances to see Sitting Bull Falls, to swim in the pools and to hike in the canyon. In order to accommodate increased visitor attendance, Forest Road 137 was constructed in the mid 1930s, which led to a parking area to the north of the falls.

The popularity of the site made Sitting Bull Falls a logical choice for development by the CCC. Work began in the late 1930s at Sitting Bull Falls, and the main goal of the CCC was to retain the natural environment and to build structures that fit into the setting. Three shelters, a restroom, and dam were constructed on a bench to the north of the falls and were in the rustic style with rough cut limestone and sandstone from Last Chance Canyon and log beam roofs. The grand opening of the facility was in 1940. The recreation area has continued to be a popular tourist location and to maintain its historic integrity, it has been recorded as site AR-03-08-03-417, by the Lincoln National Forest.

8. Statement of Significance

Certifying official has considered the significance of this property in relation to other properties:

nationally  statewide  locally

Applicable National Register Criteria  A  B  C  D

Criteria Considerations (Exceptions)  A  B  C  D  E  F  G

Areas of Significance (enter categories from instructions)	Period of Significance	Significant Dates
<u>Architecture</u>	<u>1940s</u>	<u>1940, 60, 93</u>
<u>Social History</u>	_____	_____
<u>Government</u>	_____	_____
<u>Entertainment/Recreation</u>	_____	_____
_____	Cultural Affiliation	_____
_____	<u>N/A</u>	_____
_____	_____	_____

Significant Person	Architect/Builder
<u>N/A</u>	<u>Design: USDA - Forest Service</u>
	<u>Construction: CCC</u>

State significance of property, and justify criteria, criteria considerations, and areas and periods of significance noted above.

Statement of Significance

The picnic shelter at Sitting Bull Falls Recreation Area is eligible for the National Register under criteria A and C as described in 36 CFR 60.4. This was a Civilian Conservation Corps facility built in 1940 by members from Camp F-37-N. CCC projects such as this one were important to the revitalization of the national economy during the Depression. As specified in National Register criteria, this structure possesses integrity of location, design, setting, materials, workmanship, feeling, and association. The picnic shelter represents an important historic resource, one that is not only associated with significant events in American History, but also one that embodies distinctive characteristics of CCC workmanship and architectural design.

CCC architecture was unique, especially the rustic style which is embodied in the shelters. This structure fits very well into the surrounding environment and is very plain in plan and design. Furthermore, stones from Last Chance Canyon were utilized in the shelter construction. This shelter is one of two of the best examples of the rustic style on the forest.

The structure is a product of an important government program that aided social welfare. The CCC employed many young men who were jobless, helping individuals and communities as a whole. It gave young men a sense of accomplishment, and the workmanship of CCC structures is notable. The Sitting Bull Falls picnic shelter is a representation of such workmanship, and its present condition is extraordinary considering its age.

x See continuation sheet

United States Department of the Interior  
National Park Service

**NATIONAL REGISTER OF HISTORIC PLACES  
CONTINUATION SHEET**

Picnic Shelter - Sitting Bull Falls Recreation Area  
Section number  8  Page  2

---

The May 1992 Challenge Cost Share Field school rehabilitated and partially restored the picnic shelter. The restoration had a beneficial effect on the shelter and returned it to its original appearance.

The changes made to the Sitting Bull Falls Recreation Facility since the 1930s have not destroyed its integrity. There are few historical sites on the Guadalupe Ranger District, and fewer CCC structures remaining both on the Guadalupe district and on the forest as a whole. This makes the picnic shelter at Sitting Bull Falls an important historic site as well as an example of CCC work on the Lincoln National Forest.

---

## 9. Major Bibliographical References

---

- Anon.  
1931 "Forest Service Completes a Graded Road to Scenic Falls." Advocate. June 11. Artesia, NM.
- Comer, C. S.  
1991a Sitting Bull Falls Graffiti Removal Project. Lincoln National Forest Cultural Resources Report # 1991-08-097.  
1991b Sitting Bull Falls Roof Replacement. Lincoln National Forest Cultural Resources Report # 1991-08-116.  
1991c Sitting Bull Falls Roof Replacement Addendum. Lincoln National Forest Cultural Resources Report # 1991-08-116B.
- Davis, S. H.  
1989 "Childhood Spent Near the Falls." Current Argus. Jan. 9. Carlsbad, NM.
- Goodall H.  
1988 Log Structure Stabilization Training Manual. Carson National Forest, New Mexico.
- Higgins, H. C.  
1987a The Big Canyon Cabin Assessment. Lincoln National Forest Cultural Resources Report # 1987-08-017. USDA.  
1987b The National Allotment Road Closures. Lincoln National Forest Cultural Resources Report # 1987-08-038. USDA.
- Higgins, H. C. and D. M. Johnson  
1987 A Research Design for a Cultural Resources Random Sample Survey of the Lincoln National Forest. Lincoln National Forest Cultural Resources Report # 1987-08-090. USDA.
- Holmes, M.  
1983 "Sitting Bull Falls Named for Liar, Not Indian." El Paso Times. Jan. 3. El Paso, TX.
- Irwin, P. N.  
1986 Fire Lookout Towers National Register Information. Lincoln National Forest Cultural Resources Report # 1986-08-058. USDA.
- Johnson, D. M., T. R. Fulgham, and L. S. Reed.  
1988 Lincoln National Forest Cultural Resources Planning Assessment. Ms. on file, Lincoln National Forest, Supervisor's Office, Alamogordo.
- Macy, G. D.  
1933 "State Park Conservation Camps." New Mexico Magazine. November.
- Spoerl, P. M.  
1983 Thousands of Years of Use: Prehistory and History of the Lincoln National Forest. Ms. on file, Lincoln National Forest, Supervisor's Office, Alamogordo.



United States Department of the Interior  
National Park Service

NATIONAL REGISTER OF HISTORIC PLACES  
CONTINUATION SHEET

Sitting Bull Falls Recreation Area  
Section number 9 Page 2

---

Steen, H. K.

1976 The U.S. Forest Service -- A History. Seattle: University of Washington Press.

Troop, E. G.

1979 Utterly Visionary and Chimerical: A Federal Response to the Depression. MA Thesis: Portland State University.

Toulouse, J. H.

1933 "CCC in the Sandias." New Mexico Magazine. September.

USDA, Forest Service

1991 Managing and Maintaining Historic Buildings. Ms. on file, Lincoln National Forest, Supervisor's Office, Alamogordo.

1991 The Civilian Conservation Corps: Coronado National Forest, 1933-1942. U.S. Government Printing Office.

U.S. Department of the Interior

1986 National Register Bulletin 16. National Park Service.

West, T.

1992 Centennial Mini-Histories of the Forest Service. USDA Forest Service, FS-518.

Previous documentation on file (NPS):

- preliminary determination of individual listing (36 CFR 67) has been requested.
- previously listed in the National Register
- previously determined eligible by the National Register
- designated a National Historic Landmark
- recorded by Historic American Buildings Survey # \_\_\_\_\_
- recorded by Historic American Engineering Record # \_\_\_\_\_

- Primary location of additional data:
- State hist. preservation office
  - Other State agency
  - Federal agency
  - Local government
  - University
  - Other

Specify repository:  
Lincoln National Forest

**10. Geographical Data**

Acreeage of property Less than 1 acre

**UTM References**

A 113 528690 3567430  
 Zone Easting Northing

C           
 Zone Easting Northing

B           
 Zone Easting Northing

D           
 Zone Easting Northing

See continuation sheet

**Verbal Boundary Description**

The boundary consists of the foundation of the structure and the stairs totalling 21 feet wide by 26 feet long which runs east to west.

See continuation sheet

**Boundary Justification**

The boundary encompasses the walls and foundation of the structure and the stairs leading to the foundation.

See continuation sheet

**11. Form Prepared By**

name/title	<u>Holly Houghten, Archeologist</u>	<u>Christy Comer, Archeologist</u>
organization	<u>Lincoln National Forest</u>	date <u>July 7, 1993</u>
street & number	<u>1101 New York Avenue</u>	telephone <u>(505) 434-7273</u>
city or town	<u>Alamogordo</u>	state <u>NM</u> zip code <u>88310</u>

NPS Form 10-900

OMB No. 1024-0018

United States Department of the Interior  
 National Park Service

**NATIONAL REGISTER OF HISTORIC PLACES  
 REGISTRATION FORM**

This form is for use in nominating or requesting determinations of eligibility for individual properties or districts. See instructions in "Guidelines for Completing National Register Forms" (National Register Bulletin 16). Complete each item by

Sitting Bull Falls (AR-03-08-03-417)  
 Guadalupe District, Lincoln National Forest  
 Shelter I Original Planned Drawing

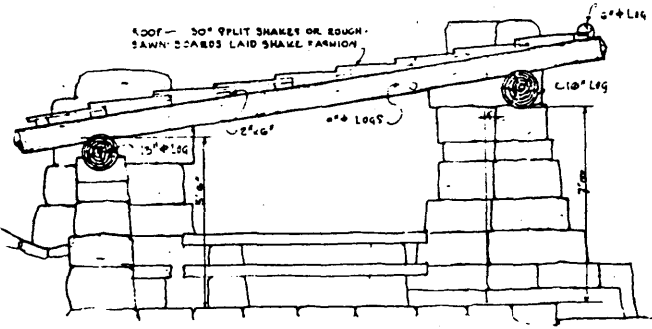

SECTION  
 SCALE: 3/8"=1'-0"

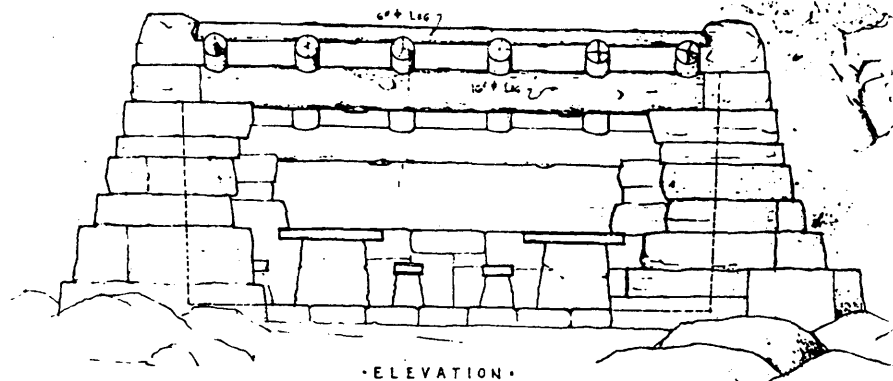

ELEVATION  
 SCALE: 3/8"=1'-0"

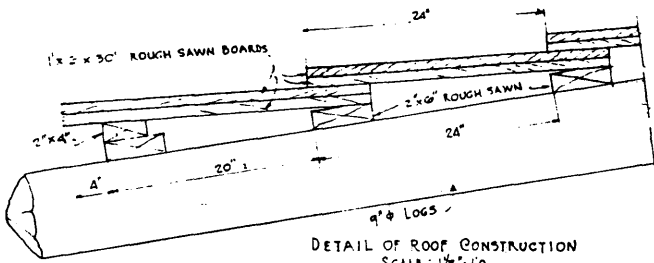

DETAIL OF ROOF CONSTRUCTION  
 SCALE: 1/2"=1'-0"

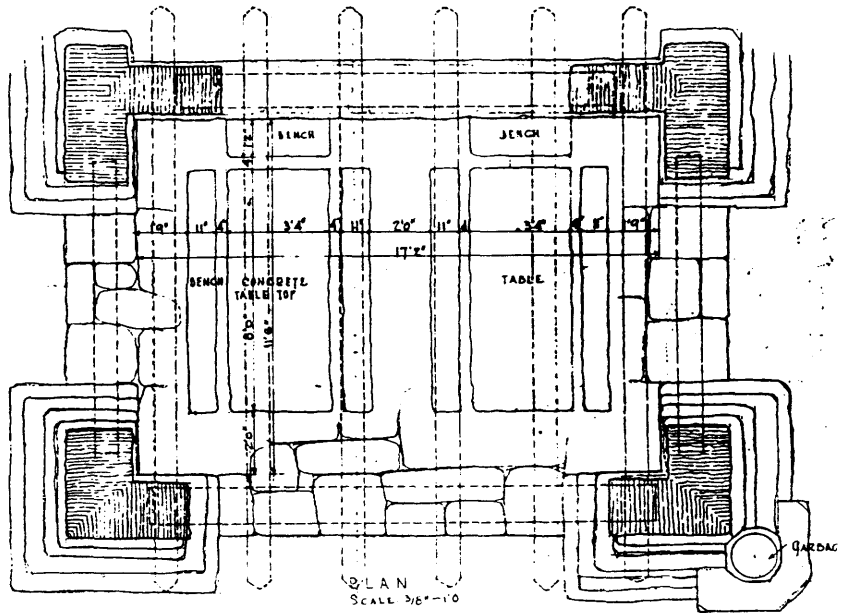

PLAN  
 SCALE: 3/8"=1'-0"

DRAWINGS ISSUED			
DRAWING	REVISED	ISSUED	
2	19	12/23/48	Prin. Print to Lincoln
2	34	1-10-48	1-LIA. FAB. HL. HOOD

DESIGN BY \_\_\_\_\_  
 DRAWN BY \_\_\_\_\_  
 APPROVED BY \_\_\_\_\_  
 APPROVED BY \_\_\_\_\_

U. S. DEPARTMENT OF AGRICULTURE  
 FOREST SERVICE  
 DIVISION OF RECREATION AND LANDS  
 REGION THREE.

TWO-UNIT SHELTER  
 SITTING BULL FALLS PICNIC GRO  
 LINCOLN NATIONAL FORE  
 SCALE: AS NOTED  
 PLATE: D-8401