

United States Department of the Interior
National Park Service

National Register of Historic Places
Registration Form

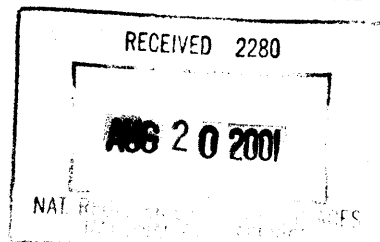

This form is for use in nominating or requesting determinations for individual properties and districts. See instructions in *How to Complete the National Register of Historic Places Registration Form* (National Register Bulletin 16A). Complete each item by marking "x" in the appropriate box or by entering the information requested. If an item does not apply to the property being documented, enter "N/A" for "not applicable." For functions, architectural classification, materials, and areas of significance, enter only categories and subcategories from the instructions. Place additional entries and narrative items on continuation sheets (NPS Form 10-900a). Use a typewriter, word processor, or computer, to complete all items.

1. Name of Property

historic name Esterly Pit #2/Llano de Oro Mine

other names/site number N/A

2. Location

street & number Approximately 1.5 miles north of the intersection of the Waldo Road and BLM Road 40-8-28 not for publication

city or town Cave Junction USDI BLM Medford District vicinity

state Oregon code OR county Josephine code 033 zip code 97523

3. State/Federal Agency Certification

As the designated authority under the National Historic Preservation Act, as amended, I hereby certify that this nomination request for determination of eligibility meets the documentation standards for registering properties in the National Register of Historic Places and meets the procedural and professional requirements set forth in 36 CFR Part 60. In my opinion, the property meets does not meet the National Register criteria. I recommend that this property be considered significant nationally statewide locally. (See continuation sheet for additional comments.)

[Signature] 8/14/01
Signature of certifying official/Title Date
Preservation Officer, Bureau of Land Management
State of Federal agency and bureau

In my opinion, the property meets does not meet the National Register criteria. (See continuation sheet for additional comments.)

[Signature] 12/10/00
Signature of certifying official/Title Deputy SHPO Date
Oregon State Historic Preservation Office
State or Federal agency and bureau

4. National Park Service Certification

- I hereby certify that the property is:
- entered in the National Register.
 See continuation sheet.
 - determined eligible for the National Register
 See continuation sheet.
 - determined not eligible for the National Register.
 - removed from the National Register.
 - other, (explain): _____

Signature of the Keeper Entered in the National Register Date of Action 10-4-01

United States Department of the Interior
National Park Service

National Register of Historic Places Registration Form

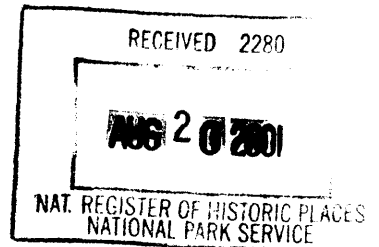

This form is for use in nominating or requesting determinations for individual properties and districts. See instructions in *How to Complete the National Register of Historic Places Registration Form* (National Register Bulletin 16A). Complete each item by marking "x" in the appropriate box or by entering the information requested. If an item does not apply to the property being documented, enter "N/A" for "not applicable." For functions, architectural classification, materials, and areas of significance, enter only categories and subcategories from the instructions. Place additional entries and narrative items on continuation sheets (NPS Form 10-900a). Use a typewriter, word processor, or computer, to complete all items.

1. Name of Property

historic name Esterly Pit #2/Llano de Oro Mine

other names/site number N/A

2. Location

street & number Approximately 1.5 miles north of the intersection of the Waldo Road and BLM Road 40-8-28 | not for publication

city or town Cave Junction USDI BLM Medford District vicinity

state Oregon code OR county Josephine code 033 zip code 97523

3. State/Federal Agency Certification

As the designated authority under the National Historic Preservation Act, as amended, I hereby certify that this nomination request for determination of eligibility meets the documentation standards for registering properties in the National Register of Historic Places and meets the procedural and professional requirements set forth in 36 CFR Part 60. In my opinion, the property meets does not meet the National Register criteria. I recommend that this property be considered significant nationally statewide locally. (See continuation sheet for additional comments.)

Signature of certifying official/Title _____ Date _____

State of Federal agency and bureau _____

In my opinion, the property meets does not meet the National Register criteria. (See continuation sheet for additional comments.)

Signature of certifying official/Title _____ Date _____

State or Federal agency and bureau _____

4. National Park Service Certification

I hereby certify that the property is:

Signature of the Keeper

Date of Action

- entered in the National Register.
 - See continuation sheet.
- determined eligible for the National Register
 - See continuation sheet.
- determined not eligible for the National Register.
- removed from the National Register.
- other, (explain:) _____

Esterly Pit #2/Llano de Oro Mine
Name of Property

Josephine Oregon
County and State

5. Classification

Ownership of Property
(Check as many boxes as apply)

- private
- public-local
- public-State
- public-Federal

Category of Property
(Check only one box)

- building(s)
- district
- site
- structure
- object

Number of Resources within Property
(Do not include previously listed resources in the count.)

Contributing	Noncontributing	
_____	_____	buildings
1	_____	sites
2	_____	structures
_____	_____	objects
3	_____	Total

Name of related multiple property listing
(Enter "N/A" if property is not part of a multiple property listing.)

Mining Resources of the Upper Illinois Valley
Oregon

**Number of contributing resources previously listed
in the National Register**

0

6. Function or Use

Historic Functions
(Enter categories from instructions)

INDUSTRY/PROCESSING/EXTRACTION

Current Functions
(Enter categories from instructions)

VACANT/NOT IN USE

7. Description

Architectural Classification
(Enter categories from instructions)

NO STYLE

Materials
(Enter categories from instructions)

foundation _____

walls _____

roof _____

other EARTH; STONE

Narrative Description

(Describe the historic and current condition of the property on one or more continuation sheets.)

Please See Continuation Pages

8. Statement of Significance

Applicable National Register Criteria

(Mark "x" in one or more boxes for the criteria qualifying the property for National Register listing.)

- A Property is associated with events that have made a significant contribution to the broad patterns of our history.
- B Property is associated with the lives of persons significant in our past.
- C Property embodies the distinctive characteristics of a type, period, or method of construction or represents the work of a master, or possesses high artistic values, or represents a significant and distinguishable entity whose components lack individual distinction.
- D Property has yielded, or is likely to yield, information important in prehistory or history.

Criteria Considerations

(Mark "x" in all the boxes that apply.)

Property is:

- A owned by a religious institution or used for religious purposes.
- B removed from its original location.
- C a birthplace or grave.
- D a cemetery.
- E a reconstructed building, object, or structure.
- F a commemorative property.
- G less than 50 years of age or achieved significance within the past 50 years.

Areas of Significance

(Enter categories from instructions)

INDUSTRY

Period of Significance

1907-1940

Significant Dates

N/A

Significant Person

(Complete if Criterion B is marked above)

George M. Esterly

Cultural Affiliation

N/A

Architect/Builder

N/A

Narrative Statement of Significance

(Explain the significance of the property on one or more continuation sheets.)

9. Major Bibliographical References

Bibliography

(Cite the books, articles, and other sources used in preparing this form on one or more continuation sheets.)

Previous documentation on file (NPS):

- preliminary determination of individual listing (36 CFR 67) has been requested
- previously listed in the National Register
- previously determined eligible by the National Register
- designated a National Historic Landmark
- recorded by Historic American Buildings Survey # _____
- recorded by Historic American Engineering Record # _____

Primary location of additional data:

- State Historic Preservation Office
- Other State agency
- Federal agency
- Local government
- University
- Other

Name of repository:

USDI BLM Medford District

Esterly Pit #2/Llano de Oro Mine
Name of Property

Josephine Oregon
County and State

10. Geographical Data

Acrage of Property 16.451

UTM References

(Place additional UTM references on a continuation sheet.)

1	Zone	Easting	Northing
2	Zone	Easting	Northing

3	Zone	Easting	Northing
4	Zone	Easting	Northing

See continuation sheet

Verbal Boundary Description

(Describe the boundaries of the property on a continuation sheet.)

Boundary Justification

(Explain why the boundaries were selected on a continuation sheet.)

11. Form Prepared By

name/title Katherine C. Atwood (with) Dr. Ward Tonsfeldt
 organization (for) USDI Bureau of Land Management date August 17, 2000
 street & number 365 Holly St. Medford District telephone (541) 482-8714
 city or town Ashland state OR zip code 97520

Additional Documentation

Submit the following items with the completed form:

Continuation Sheets

Maps

A USGS map (7.5 or 15 minute series) indicating the property's location.

A Sketch map for historic districts and properties having large acreage or numerous resources.

Photographs

Representative black and white photographs of the property.

Additional Items

(Check with the SHPO or FPO for any additional items)

Property Owner

(Complete this item at the request of SHPO or FPO.)

name Please See Continuation Sheets
 street & number _____ telephone _____
 city or town _____ state _____ zip code _____

Paperwork Reduction Act Statement: This information is being collected for applications to the National Register of Historic Places to nominate properties for listing or determine eligibility for listing, to list properties, and to amend existing listings. Response to this request is required to obtain a benefit in accordance with the National Historic Preservation Act, as amended (16 U.S.C. 470 et seq.).

Estimated Burden Statement: Public reporting burden for this form is estimated to average 18.1 hours per response including time for reviewing instructions, gathering and maintaining data, and completing and reviewing the form. Direct comments regarding this burden estimate or any aspect of this form to the Chief, Administrative Services Division, National Park Service, P.O. Box 37127, Washington, DC 20013-7127; and the Office of Management and Budget, Paperwork Reductions Projects (1024-0018), Washington, DC 20503.

**United States Department of the Interior
National Park Service**

**National Register of Historic Places
Continuation Sheet**

Mining Resources of the Upper Illinois Valley
Esterly Pit No. 2/Llano de Oro Mine

Section Number: 7 Page: 1

Summary Description

One of the six resources included with this multiple property submission that are associated with the Logan/Esterly mining operations, the Esterly Pit #2 Llano de Oro Mine preserves distinct features from the industrial period of hydraulic mining in the Upper Illinois Valley between 1907 and 1942. Located approximately six miles south of Cave Junction, Oregon, the Esterly Lakes were created when deep auriferous gravels of the Llano de Oro formation were excavated by giants and lifted with elevators, leaving large pits that subsequently filled with water. Among the four "ponds" known today as the Esterly Lakes, the Esterly Pit #2 Llano de Oro Mine, is the only one located on Bureau of Land Management property. Mined extensively, the gold-bearing gravels of the Llano de Oro formation in French Flat received considerable attention after 1900. Containing 16.451 acres, the nominated property displays distinct characteristics of its type that enables us to understand the processes involved in mining the gravels in this area. The site retains integrity of location, design, setting, workmanship and accurately conveys the historic associations for which it is significant.

Location and Setting

Esterly Pit #2 Llano de Oro Mine is located in the northwest quarter of Section 22 Township 40 South, Range 8 West, W.M., (Josephine County Assessors Plat 40-8-22, Tax Lot 200). The mine pit is reached by Bureau of Land Management Road 40-8-28. The mine is situated in a valley at an elevation of approximately 1,500 feet above sea level. Located on the Llano de Oro formation that contained deep deposits of auriferous graves, the site is rimmed with serpentine soils. (Shenon 1933). Water for the mine was taken from the East Fork Illinois from the Logan/Esterly Middle Ditch and water from the ditch was piped directly to the pit (Budy 1999: 35HS11-485).

The mine is located in the bottom of French Flat. Hydraulic mining activity created the pit, now a pond, in the early 1900s and the appearance of the central part of this small valley prior to mining activity is unknown. Vegetation is very sparse across the mined landscape. The Esterly Pit #2 is located in a Ponderosa pine/manzanita vegetation zone with an on-site plant community that includes ponderosa pine, manzanita, grass, riparian sedges and rushes, occasional oak and madrone (Budy 1999: 35HS11-485).

United States Department of the Interior
National Park Service

National Register of Historic Places
Continuation Sheet

Mining Resources of the Upper Illinois Valley
Esterly Pit No. 2/Llano de Oro Mine

Section Number: 7 Page: 2

Site Description

Access to the gold bearing gravels of the Llano de Oro formation in French Flat required considerable capital investment in water systems and in special equipment. With the introduction of hydraulic elevators about 1901, the deep gravels in French Flat could be lifted to the surface for removal of the gold. The ditches known now as the Logan/Esterly Upper and Middle Ditches needed to be enlarged and expanded to accommodate high pressure needs to run the giants (Budy 1999: 35HS11-485). In the absence of natural gravity to channel runoff, it was necessary to build a storage reservoir and to expand the long tailrace known as Logan's Cut to French Flat (Shenon 1933:186; Budy 1999: 35HS11-485).

Generally circular, but with an irregular outer edge, the **Esterly Pit #2 (A)** measures as much as 500 feet in diameter at its widest point. Extensive tailings piles, resulting from the materials lifted and mined from the pit, extend to the east and south of the pit, on private land, as much as one thousand feet. Lower **tailings (B)** extend west of the mined pit on public land, in a roughly circular pattern, approximately 500 feet in diameter at the widest point (Budy 1999: 35HS11-485).

Integrity

With the exception of a recent prospect on the extreme west edge of the site, the property appears little modified since its abandonment in the early 1940s. The Esterly Pit #2 Llano de Oro Mine site encompasses within its boundary highly visible, key earthworks that retain their original location and appearance. The Esterly Pit #2's setting remains intact without compromising modern intrusions and enables the site to retain integrity of feeling. The Esterly Pit #2 Llano de Oro Mine has strong associations with historic mining technologies employed between 1900 and 1930. Through its earthworks, the site enables us to better understand hydraulic mining that so significantly affected development in the Upper Illinois Valley.

United States Department of the Interior
National Park Service

National Register of Historic Places
Continuation Sheet

Mining Resources of the Upper Illinois Valley

Esterly Pit No. 2/Llano de Oro Mine

Section Number: 8 Page: 1

Significance

Worked between 1900 and 1942, the Esterly Pit #2 Llano de Oro Mine is locally significant for its association with industrial mining in the Upper Illinois Valley, Waldo vicinity. Submitted as part of a multiple property submission, "Mining Resources of the Upper Illinois Valley, Oregon," the Esterly Pit #2 Llano de Oro Mine represents its associated historic context, "Gold Placer Mining and Development of the Waldo Vicinity, 1851-1942." The Esterly Pit #2 meets the registration requirements outline registration document for mines developed during the industrial hydraulic era. It was developed during the historic period and retains integrity of location, setting, design and feeling. The site evokes direct historic associations with mining in the Upper Illinois Valley. The Esterly Pit #2 Llano de Oro Mine is eligible to the National Register of Historic Places under Criterion A as an important, tangible representative of historic mining activities in the Upper Illinois Valley. The mine is additionally eligible under Criterion B for its associations with George M. Esterly, prominent engineer and investor responsible for the mine's final period of development. As a tangible expression of Mr. Esterly's mining experience and knowledge, the Esterly Pit #2 constitutes an important representative of his influence in the Waldo vicinity. With the destruction of the Esterly home by fire in the mid-1980s, the mine's associations with George Esterly increased in importance.

History

A portion of the Esterly Mine property was worked before 1860 by French-Canadian miners J. Carron (also spelled Caro) and J. Baptiste Desselles, who also originally mined the area later known as French Flat (Street and Street 1973: 22). Additional early work on the Esterly Mine property is noted by Shenon who states:

The first important work on the ... property was done south of the highway near the center of section 27 by early-day miners. C.H. White, who was acquainted with one of the miners, states that they mined gold work \$80,000 from this place. (Shenon, p. 186)

About 1883, George Simmons, who owned extensive lands in the area of French Flat, acquired the intermittent waterway known as Carroll (Carron) Gulch and soon sold a

United States Department of the Interior
National Park Service

National Register of Historic Places
Continuation Sheet

Mining Resources of the Upper Illinois Valley
Esterly Pit No. 2/Llano de Oro Mine

Section Number: 8 Page: 2

half-interest in his property to Frank Ennis and Theodoric Cameron. Mining records show that Frank Ennis et. al. established the placer location on February 26, 1883 (Josephine County Mining Records 4:368). In 1887 Theodoric Cameron located additional mining ground (Josephine County Mining Records 5:135). Holding 900 acres, the firm was known as Ennis, Simmons and Co. (Josephine County Deeds 3:300; *Rogue River Courier* July 30, 1886; Chapman Publishing Company 1904:229.) In 1886 the local newspaper noted:

This company is making an open cut from the river at the outlet of the gulch above the old Fisher ranch which extends up the drain of the Caro gulch about half a mile from the Illinois river. Most has been completed...the plan of opening being the same as that adopted in Butcher Gulch, the cut being about seventy feet deep, and when completed to the old Caro mine, will be about three and a half miles long. The company has an immense ditch which they take from the river on the line of the old ditch but which has been enlarged...(*Rogue River Courier* July 30, 1886 in Street:1973: 30).

Simmons, Cameron and Ennis obtained water rights to two ditches built by the Sailors' Diggings Water Mining and Milling Company (one eleven and one seven miles long) and put in a three-mile long placer mining tail race that in some places measured over seventy feet deep. Ennis eventually sold out his interest in the company and when James T. Logan joined Simmons and Cameron in the endeavor, the mine became known as the Simmons, Cameron and Logan Mine. Logan, a native of Ohio, was born in 1867 (Street 1973: 32-33; Grants Pass *Bulletin* January 29, 1937, 1:6; Josephine County Mining Records, 4:457; Phillips 1988:14):

Simmons, Cameron and Logan spent large sums making a cut known as the Logan Cut -- six miles long to the Illinois River -- to drain Carroll [Carron] Slough before mining their property, but recouped the expenditure from mining the slough portion of the land in sections 10,15, and 16 of Township 40 South, Range 8 West (Grants Pass *Bulletin*, January 29, 1937, 1:6) (Brooks and Ramp 1969: 242)

United States Department of the Interior
National Park Service

National Register of Historic Places
Continuation Sheet

Mining Resources of the Upper Illinois Valley
Esterly Pit No. 2/Llano de Oro Mine

Section Number: 8 Page: 3

George Simmons died October 6, 1901. His widow, Jane Simmons, continued to live on the property with her daughter and son-in-law, Ella and James Logan. (Ella Simmons and James Logan were married in September 1900). Following his father-in-law's death, Logan became manager of the farm and the mining properties (Josephine County Marriage Records; Chapman Publishing Company 1904: 986; *Grants Pass Daily Courier* December 31, 1927, 1:6). In March 1902 James Logan acquired the Cameron share of the mining property in Sections 9, 10, 11, 15, 16, 22, 27 and 28 "known as the Simmons and Cameron claims." The transfer included improvements described as the Upper Ditch, the Upper Race (11 miles long), the Lower Main Pipe Ditch and the main sluice ditch (Josephine County Mining Records 4:476). In 1903, with the mine under Logan's management, the local newspaper noted improvements on the property:

The well known Simmons-Cameron mine of the Waldo district, one of the largest hydraulic placers in Southern Oregon, has had this season the most profitable run of many years. J.T Logan has initiated a number of improvements since he took charge of the property, the most notable being a hydraulic elevator which was installed this last year. ...(*Rogue River Courier*, April 16, 1903 quoted in Street 1973: 8).

From about 1907 until the early 1940s, mining was confined to the four pits in French Flat. During the mining season when ample water was available, the mine operated two giants in the pits, two hydraulic elevators, and one giant for stacking tailings (Shenon 1933:187). Local sources note that about 1908 operations were moved to the "former [Scott] land claim... where the hydraulic elevators were used. The company also mined gravel on French Flat between 1907 and 1917 (*Grants Pass Bulletin*, January 29, 1937 1:6).

In 1910 the New York-based Waldo Consolidated Gold Mining Company acquired the Simmons, Cameron, Logan property, as well as the Deep Gravel Mine and the Osgood or High Gravel Mine (*Waldo Consolidated Gold Mining Co. of Oregon* 1910). The Waldo Consolidated Gold Mining Company obtained approximately 1700 acres with the Logan Mine of which approximately 600 acres were understood to be gold-bearing.

United States Department of the Interior
National Park Service

National Register of Historic Places
Continuation Sheet

Mining Resources of the Upper Illinois Valley
Esterly Pit No. 2/Llano de Oro Mine

Section Number: 8 Page: 4

Within a few years, however, this company defaulted on its payments and Logan again assumed the mining property.

In 1916 the Logan, Simmons and Cameron mine, "commonly known as the Logan Placer," was under option to George Esterly of Seattle, Washington. Geologists described the property at that time:

Several long ditches carry water from the higher portions of the east and west forks of the Illinois River to the placer ground. ... A hydraulic elevator was used to remove material from the pit, which had a maximum depth of about 15 feet. There are three ditches, the water from one being used in the elevator under a head of 325 feet, that from another being employed in 2 giants, and that from the third being used to clear away the tailings from the end of the sluice at the head of the elevator (Parks and Swartley 1916:143)

Early in 1917, the *Portland Oregonian* described the property:

The Logan-Simmons mine, probably the best known placer property of Southern Oregon and a most dependable producer, has been under option to parties from Seattle and Tacoma for several months past, during which time it has been under examination. G.E. Esterly, of Seattle, is now at the mine directing the examination ...(*Portland Oregonian* March 26, 1917, 2:4).

On June 26, 1917 George and Marilla Esterly, along with James Logan and his family members located a placer claim and on August 16, 1917 James Logan sold his mining operation to Esterly's Waldo Corporation, a newly formed organization had \$100,000 in capital stock and an office in Seattle, Washington. George M. Esterly was the company's general manager. The deed of sale noted the inclusion of mining claims totaling thousands of acres, all water rights, all equipment of the Logan Cameron Simmons Mine (Josephine County Deed Records 28:276; Josephine County Mining Records 23:233-234).

United States Department of the Interior
National Park Service

National Register of Historic Places
Continuation Sheet

Mining Resources of the Upper Illinois Valley
Esterly Pit No. 2/Llano de Oro Mine

Section Number: 3 Page: 5

George Esterly was born June 15, 1868 in Whitewater, Wisconsin. Described in the *Portland Oregonian* as "one of the best-known mining men in the west," Esterly was a mechanical and mining engineer who had developed extensive Alaskan mining interests. He and his wife, Marilla Anderson Esterly invested personal funds in their sizeable mining operations near Waldo and the gave name Llano de Oro, or Plain of Gold, to their extensive mine. The Esterlys replaced or extensively modified the Logan home near the Waldo Road and installed a significant amount of up-to-date mining equipment on the property. Esterly would live out his life at Waldo where he died on December 2, 1931 (*Portland Oregonian* December 4, 1931, 19:5-6). In noting his death, the local newspaper wrote:

For the past twelve years he was manager and part owner for the Llano de Oro Mines, which is one of the best equipped Placer Mines in the United States...He formerly mined extensively in Alaska where he installed the first lighting system in Dawson and laid out the city of Cordova...(*Grants Pass Courier*, December 2, 1931).

In December 1920, the Waldo Corporation sold mining property, buildings, barns and equipment not owned personally by the Esterly family, to Victor H. Elfsendahl and Thad Sweek of Seattle (Josephine County Deeds 52:360). In June 1923, these buyers sold the property to G.W. Hales of Cook County Illinois (Josephine County Deed Records 62:512).

P.J. Shenon, who interviewed George Esterly before the latter's death in late 1931 noted that mining at that time was confined to the south half of Section 15, the south half of Section 22 and the north half of Section 27, Township 40 South, Range 8 West. Shenon wrote:

During the mining season, which averages about 7 months yearly, sufficient water is available to operate 2 giants in the pits, 2 hydraulic elevators, and 1 giant for stacking tailings. When the plant is operating steadily, from 15,000 to 30,000 cubic yards of gravel, depending largely on the seasonal water supply is washed each month (Shenon 1933:187).

United States Department of the Interior
National Park Service

National Register of Historic Places
Continuation Sheet

Mining Resources of the Upper Illinois Valley
Esterly Pit No. 2/Llano de Oro Mine

Section Number: 8 Page: 6

In the 1930s G.W. Hales leased out the mining property to others. Clarence Stout, who worked the property wrote to the Illinois Valley newspaper:

We have three pits working on our property at the present time... On November 2nd we started our "Fry" pit. A few days later Homer White and son started on our ground above Waldo. In addition there is another pit working in Carroll Slough. This is one less pit than we had last year... As far as I know, we are the largest placer mine in Oregon in point of acreage and production. While we cannot be called a big operation, we have... spent around \$60,000 for labor and supplies in the community during the past three years (*Illinois Valley News* November 17, 1938).

A mining publication described the property in 1938:

...A crew of ten men is employed at the Esterly mines which ... are being operated under lease from G.W. Hales. Ditches and flumes have been prepared and the pipe line laid. Open pit methods of mining are employed and the gold, platinum, and silver values are recovered by riffles and jigs...(The *Mining Journal*, October 15, 1938 in Oregon Department of Geology and Mineral Industries 1942:194).

In May 1940, Oregon's field geologist reported that the Esterly Mine was the leading hydraulic operation in the state. He noted that, "Not only is the Esterly the leading hydraulic gold-producer in the state, but it produces more platinum than any other one property in the state" (*Illinois Valley News*, May 9, 1940 Section 2). Years later, former mine manager Stout recalled, "Our operation continued until July of 1942, at which time we ceased operations due to adverse conditions created by World War II" (Hill 1979: 78).

In George Esterly estimated that since 1917 production in gold and platinum had stood at about \$225,000 and the total production of the entire property at about \$500,000. Esterly also related that platinum accounted for one tenth of the value of the clean-ups when it was worth \$110 an ounce (Shenon 1933:186).

United States Department of the Interior
National Park Service

National Register of Historic Places
Continuation Sheet

Mining Resources of the Upper Illinois Valley
Esterly Pit No. 2/Llano de Oro Mine

Section Number: 9 Page: 1

Bibliography

Budy, Elizabeth E.

1999 *Esterly Pit #2, Llano de Oro Mine Cultural Site Record 35HS11-485* (for
USDI-BLM Medford District)

Chapman Publishing Company

1904 *Portrait and Biographical Record of Western Oregon*, Chapman
Publishing Company Portland, Oregon.

(DOGAMI) Oregon Department of Geology and Mineral Industries

1942 *Oregon Metal Mines Handbook, Bulletin 14-C Southwestern
Oregon*, Volume 2, Section 1 [Josephine County], Portland, Oregon.

Parks, H.M. and A.M. Swartley

1916 *Handbook of the Mining Industry of Oregon*. Oregon Bureau of Mines and
Geology, Mineral Resources of Oregon, Volume 2, No. 4.

Shenon, Philip J.

1933c *Geology and Ore Deposits of the Takilma-Waldo District, Oregon,
Including the Blue Creek District*. U.S. Geological Survey Bulletin 846-B
Government Printing Office, Washington D.C.

United States Department of the Interior
National Park Service

National Register of Historic Places
Continuation Sheet

Mining Resources of the Upper Illinois Valley
Esterly Pit No. 2/Llano de Oro Mine

Section Number: 10 Page: 1

A map showing locations of the twenty resources included in this Multiple Property Submission is contained with the cover document. A photocopied section of a USGS map indicates the location of the Esterly Pit #2/Llano de Oro Mine is also contained within the nomination document.

Boundary Description

The Esterly Pit #2 is located in the northwest quarter of Section 22, Township 40 South, Range 8 West, (W.M.), in Josephine County Oregon. The property is identified on USGS map O'Brien quadrangle, 7.5 minute series, included with this nomination. The property is further described as follows:

Beginning at the intersection of the French Flat Road and a spur road in the NW $\frac{1}{4}$ of the SW $\frac{1}{4}$ of Section 22 T. 40 S. R. 8 W. W.M., continue East along the spur road to its intersection with the property boundary between Tax Lot 200 and Tax Lot 300 (as shown on Josephine County Assessor's Plat 40-8-22) in the NW $\frac{1}{4}$ of the SW $\frac{1}{4}$ of Section 22, T. 40 S. R. 8 W., (W.M). Continue north along the property line to its intersection with the French Flat Road in the SW $\frac{1}{4}$ of the NW $\frac{1}{4}$ of Section 22, T. 40 S., R. 8 W., (W.M.). Continue South along the French Flat Road to the point of beginning. The nominated area contains 16.451 acres.

Boundary Justification

The boundary of the nominated property includes that portion of Esterly Pit #2 Llano de Oro Mine and its immediate setting that is historically associated with placer mining, and is contained on lands administered by the USDI Bureau of Land Management.

**United States Department of the Interior
National Park Service**

**National Register of Historic Places
Continuation Sheet**

Mining Resources of the Upper Illinois Valley
Esterly Pit No. 2/Llano de Oro Mine

Section Number: 10 **Page:** 2

UTM References

Zone	Location	Easting	Northing
10	1	447406.39482	4658211.22322
	2	447406.39482	4657828.77482
	3	447181.02344	4657774.13933
	4	447153.70569	4657931.21636

United States Department of the Interior
National Park Service

National Register of Historic Places
Continuation Sheet

Mining Resources of the Upper Illinois Valley
Esterly Pit No. 2/Llano de Oro Mine

Section Number: Page:
 Photographs 1

Photographs

Photograph No. 1

- 1) Esterly Pit #2/Llano de Oro Mine
- 2) N.W. ¼ of Section 22, T. 40 S., R. 8W. W.M., Josephine County Oregon
- 3) Photographer: Elizabeth Budy
- 4) Date of Photograph: August 1999
- 5) Negative holder: Bureau of Land Management
 3040 Biddle Road Medford, Oregon 97504
- 6) View: Overview French Flat and Esterly Pit #2, looking south
- 7) Photograph number 1 of 3

Photograph No. 2

- 1) Esterly Pit #2/Llano de Oro Mine
- 2) N.W. ¼ of Section 22, T. 40 S., R. 8W. W.M., Josephine County Oregon
- 3) Photographer: Elizabeth Budy
- 4) Date of Photograph: August 1999
- 5) Negative holder: Bureau of Land Management
 3040 Biddle Road Medford, Oregon 97504
- 6) View: Esterly Pit #2, looking south
- 7) Photograph number 2 of 3

Photograph No. 3

- 1) Esterly Pit #2/Llano de Oro Mine
- 2) N.W. ¼ of Section 22, T. 40 S., R. 8W. W.M., Josephine County Oregon
- 3) Photographer: Unknown
- 4) Date of Photograph: c. 1920
- 5) Negative holder: Kerbyville Museum
 24195 Redwood Highway Kerby, Oregon 97531
- 6) View: Esterly Pit
- 7) Photograph number 3 of 3

**United States Department of the Interior
National Park Service**

**National Register of Historic Places
Continuation Sheet**

Mining Resources of the Upper Illinois Valley
Esterly Pit No. 2/Llano de Oro Mine

Section Number: 11 **Page:** 1

Property Owner Notification

Bureau of Land Management
Ron Wenker, District Manager
Grants Pass Resource Area Manager
Ann Ramage, Archaeologist
Medford Field Office
3040 Biddle Road
Medford OR 97504

Oregon-Washington State Office
Bureau of Land Management
Elaine Zielinski, Director
Richard Hanes, Cultural Resource Lead
PO Box 2965
Portland OR 97208-2965

Federal Preservation Officer Certification

Mr. John G. Douglas, Preservation Officer
Bureau of Land Management (240)
204-LS
18th and C Streets, NW
Washington, DC 20240

Esterly Pit #2

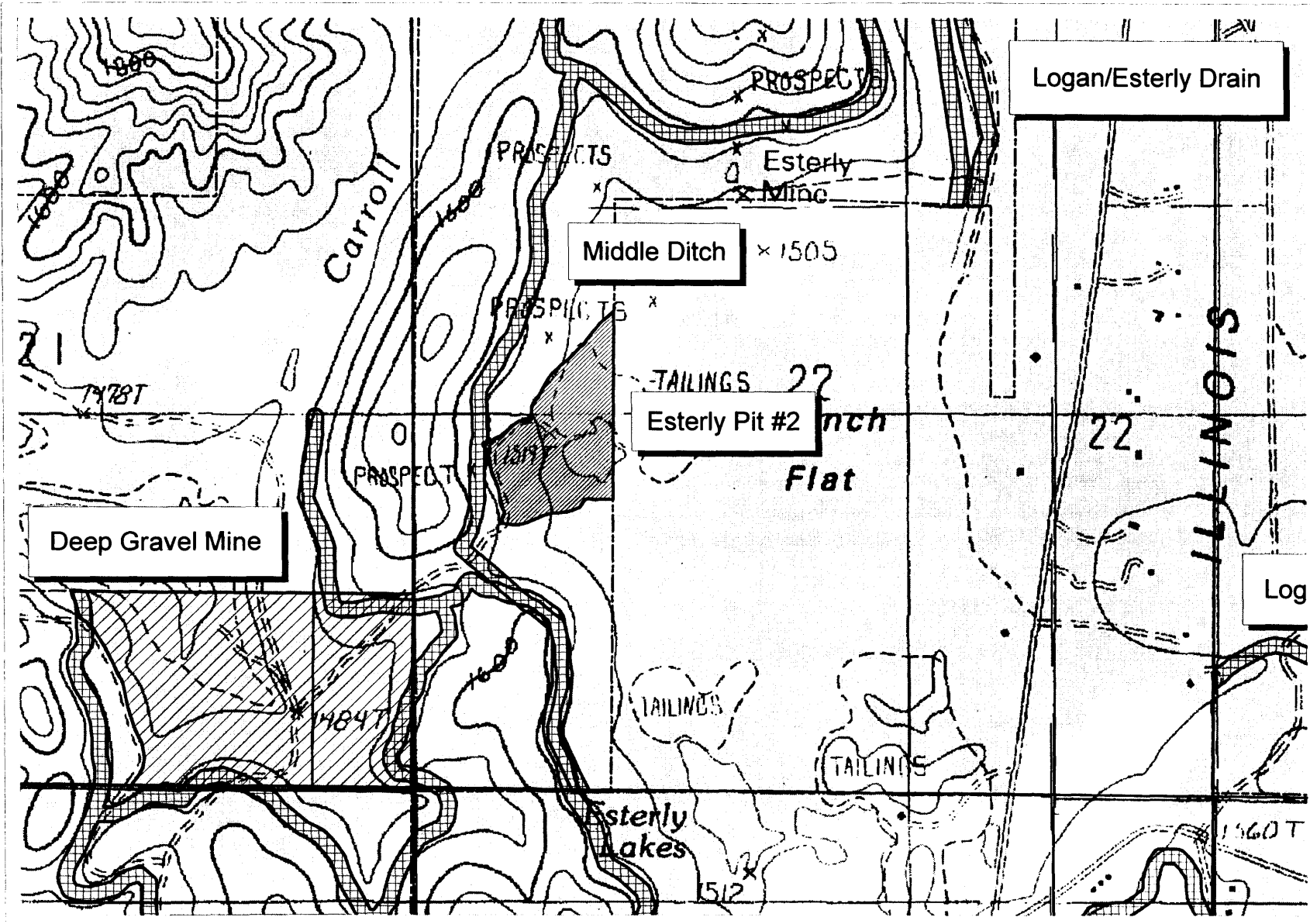

Esterly Pit #2
 35HS11-485
 A portion of the
 O'Brien Quad
 (Sec 22
 T40S, R8W, wm)
 showing
 Historic Placer
 Mining Resources
 in the Waldo Vicinity.

- Mines**
- Allen Gulch Mill
 - Cameron Mine
 - Deep Gravel Mine
 - Esterly Pit #2
 - Fry Gulch
 - High Gravel Mine
 - Old Placer Mine
 - Plataurica Mine
 - Waldo Mine

- General Symbology**
- Ditches
 - Mines
 - Town, cemetery
 - BLM boundary
 - Section Lines

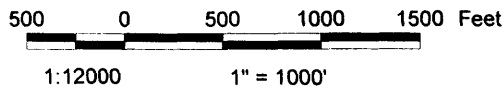
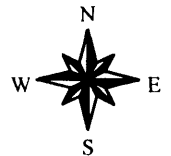

Map created August 2000 by Ralph Delamarter
 Features based on site investigations by W Tonsfeldt, E Budy and others
 Base images: digital raster graphs (DRG) and digital orthoquads (DOQ)(1995)
 of O'Brien, Takilma and Broken Rib quads (scale 1:24000).

Sketch MAP
 35HS11-485
 Esterly Pit #2
 Elizabeth Budy
 8/21/99

NORTH

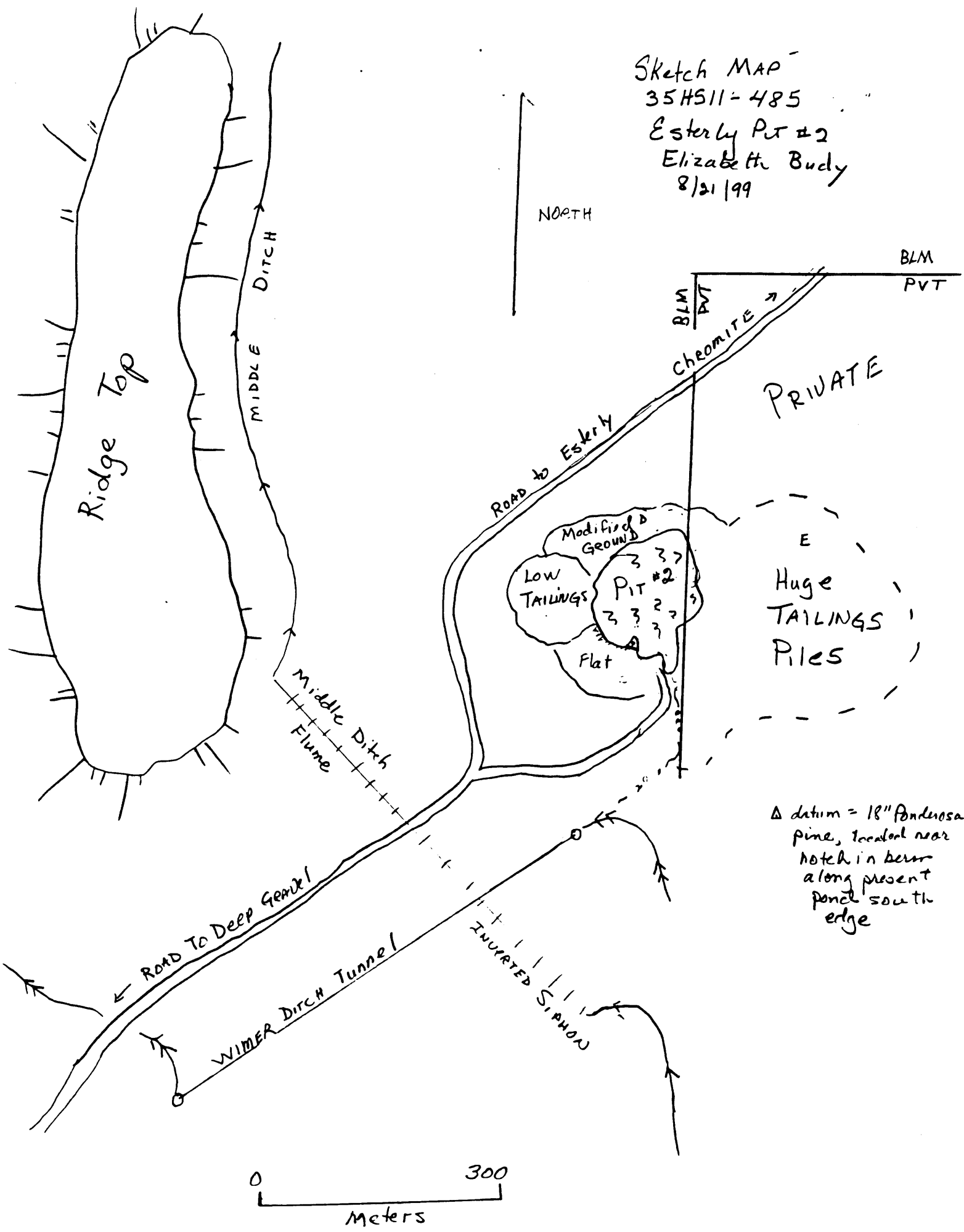

Δ datum = 18" ponderosa pine, located near notch in beam along present pond south edge

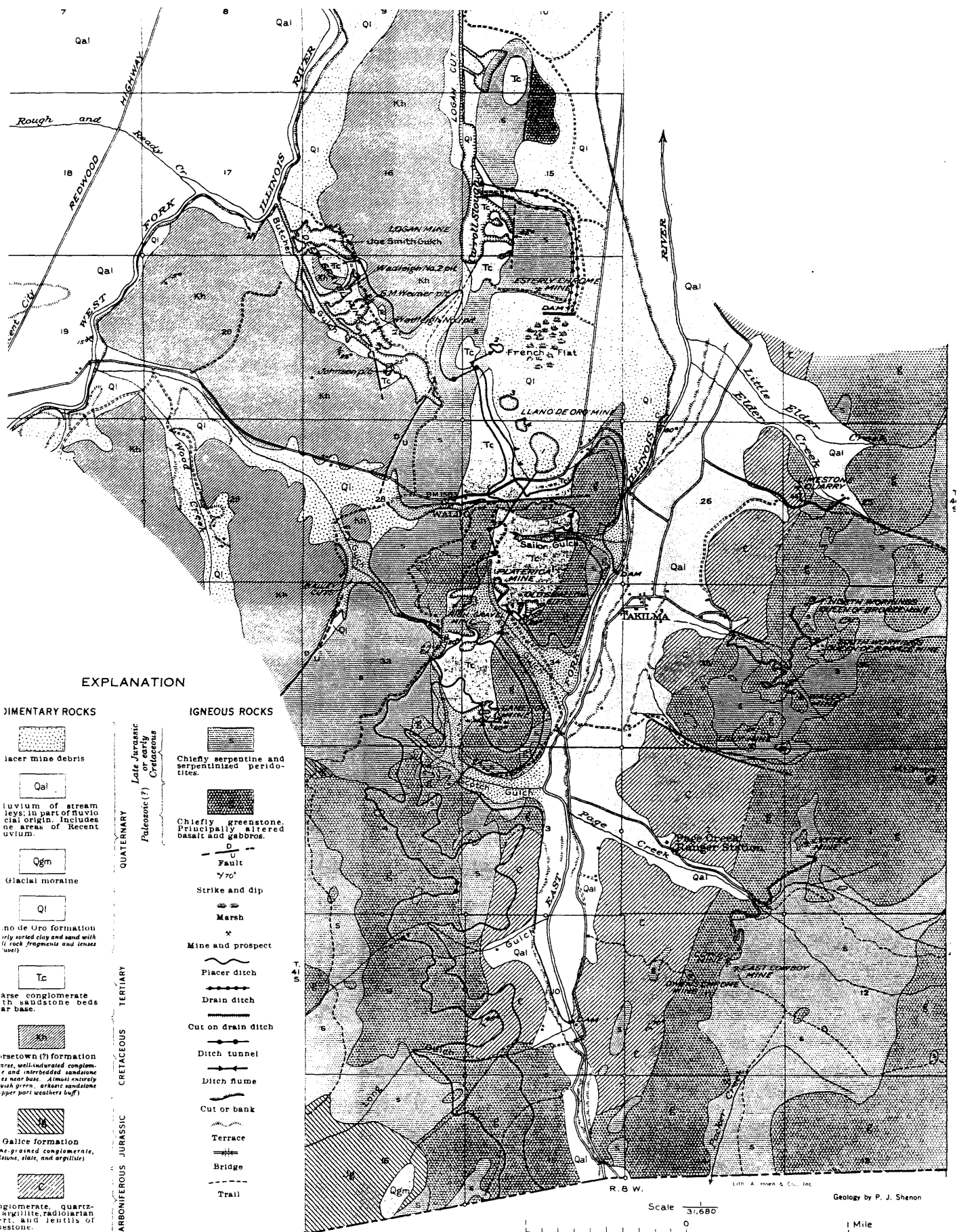

EXPLANATION

SEDIMENTARY ROCKS

- Placer mine debris
- Alluvium of stream beds, in part of fluvio glacial origin. Includes some areas of Recent alluvium.
- Glacial moraine
- Llanos de Oro formation (finely sorted clay and sand with (1) rock fragments and lenses (see note))
- Arise conglomerate (thin sandstone beds at base)
- Forestown (?) formation (massive, well-indurated conglomerate and interbedded sandstone to near base. Almost entirely with green, arkose sandstone upper part weathers buff)
- Galice formation (fine-grained conglomerate, stone, slate, and argillite)
- Conglomerate, quartz, argillite, radiolarian, etc. and lenses of testone.

IGNEOUS ROCKS

- Chiefly serpentine and serpentinized peridotites.
- Chiefly greenstone (principally altered basalt and gabbros).
- Fault
- Strike and dip
- Marsh
- Mine and prospect
- Placer ditch
- Drain ditch
- Cut on drain ditch
- Ditch tunnel
- Ditch flume
- Cut or bank
- Terrace
- Bridge
- Trail

QUATERNARY
 Tertiary (?)
 TERTIARY
 CRETACEOUS
 JURASSIC
 CARBONIFEROUS

Scale 1/37,680

Geology by P. J. Shenon

GEOLOGIC MAP OF THE TAKILMA-WALDO DISTRICT, JOSEPHINE COUNTY, OREGON