

United States Department of the Interior National Park Service

National Register of Historic Places Registration Form

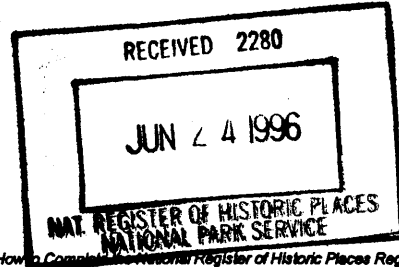

This form is for use in nominating or requesting determinations for individual properties and districts. See instructions in *How to Complete the National Register of Historic Places Registration Form* (National Register Bulletin 16A). Complete each item by marking "X" in the appropriate box or by entering the information requested. If any item does not apply to the property being documented, enter "N/A" for "not applicable." For functions, architectural classification, materials, and areas of significance, enter only categories and subcategories from the instructions. Place additional entries and narrative items on continuation sheets (NPS Form 10-900a). Use a typewriter, word processor, or computer, to complete all items.

1. Name of Property

historic name HILLSIDE HISTORIC DISTRICT

other names/site number _____

2. Location

street & number Portions of NE and SE Washington Avenue, NE and SE Adams, etc. _____ not for publication _____
city or town Chehalis _____ vicinity _____
state Washington code WA county Lewis code 041 zip code 98532

3. State/Federal Agency Certification

As the designated authority under the National Historic Preservation Act of 1986, as amended, I hereby certify that this nomination request for determination of eligibility meets the documentation standards for registering properties in the National Register of Historic Places and meets the procedural and professional requirements set forth in 36 CFR Part 60. In my opinion, the property meets does not meet the National Register criteria. I recommend that this property be considered significant nationally statewide locally. (See continuation sheet for additional comments.)

Mary M. Thompson _____ 6/18/96 _____
Signature of certifying official Date

Mary Thompson, State Historic Preservation Officer _____
State or Federal agency and bureau

In my opinion, the property meets does not meet the National Register criteria. (See continuation sheet for additional comments.)

Signature of commenting or other official Date

State or Federal agency and bureau

4. National Park Service Certification

I, hereby, certify that this property is:

- entered in the National Register. See continuation sheet
- determined eligible for the National Register. See continuation sheet
- determined not eligible for the National Register.
- removed from the National Register.
- other, (explain:) _____

Edson H Beall _____ 6-1-96 _____
Entered in the
National Register

for _____
Signature of Keeper Date of Action

USDI/NPS NRHP Registration Form

Property Name HILLSIDE HISTORIC DISTRICT

County and State LEWIS CO., WA

Page 3

8. Statement of Significance

Applicable National Register Criteria (Mark "x" in one or more boxes for the criteria qualifying the property for National Register listing.)

- A Property is associated with events that have made a significant contribution to the broad patterns of our history.
- B Property is associated with the lives of persons significant in our past.
- C Property embodies the distinctive characteristics of a type, period, or method of construction or represents the work of a master, or possesses high artistic values, or represents a significant and distinguishable entity whose components lack individual distinction.
- D Property has yielded, or is likely to yield, information important in prehistory or history.

Criteria Considerations (Mark "x" in all the boxes that apply.)

- A owned by a religious institution or used for religious purposes.
- B removed from its original location.
- C a birthplace or a grave.
- D a cemetery.
- E a reconstructed building, object, or structure.
- F a commemorative property.
- G less than 50 years of age or achieved significance within the past 50 years.

Areas of Significance

(Enter categories from instructions.)

ARCHITECTURE

EXPLORATION/SETTLEMENT

Period of Significance

1890-1946

Significant Dates

1890

Cultural Affiliation

Significant Person

Architect/Builder

Narrative Statement of Significance (Explain the significance of the property on one or more continuation sheets.)

Property Name HILLSIDE HISTORIC DISTRICT

County and State LEWIS CO., WA

9. Major Bibliographical References

(Cite the books, articles, and other sources used in preparing this form on one or more continuation sheets.)

Previous documentation on file (NPS):

- preliminary determination of individual listing (36 CFR 67) has been requested
- previously listed in the National Register
- previously determined eligible by the National Register
- designated a National Historic Landmark
- recorded by Historic American Buildings Survey # _____
- recorded by Historic American Engineering Record # _____

- Primary location of additional data:
- State Historic Preservation Office
 - Other State agency
 - Federal agency
 - Local government
 - University
 - Other
- Specify repository: _____

10. Geographical Data

Acreage of property approx. 125

UTM References

	Zone	Easting	Northing		Zone	Easting	Northing
1	<u>1/0</u>	<u>5/0/2/3/8/0</u>	<u>5/1/6/8/1/0/0</u>	3	<u>1/0</u>	<u>5/0/3/7/6/0</u>	<u>5/1/6/6/7/7/0</u>
2	<u>1/0</u>	<u>5/0/2/2/6/0</u>	<u>5/1/6/7/9/3/0</u>	4	<u>1/0</u>	<u>5/0/3/6/2/0</u>	<u>5/1/6/6/6/3/0</u>

See continuation sheet

Verbal Boundary Description (Describe the boundaries of the property on a continuation sheet.)

Boundary Justification (Explain why the boundaries were selected on a continuation sheet.)

11. Form Prepared By

name/title Jennifer Watson/edited by Lauren McCroskey
 organization Chehalis/Lewis County Historic Preservation Office date 4-30-96
 street & number Lewis County Museum telephone (360) 748-0831
 city or town Chehalis state WA zip code 98532

Additional Documentation

Submit the following items with the completed form:

Continuation Sheets

Maps

- A USGS map (7.5 or 15 minute series) indicating the property's location.
- A sketch map for historic districts and properties having large acreage or numerous resources.

Photographs

Representative black and white photographs of the property.

Additional items (Check with the SHPO or FPO for any additional items.)

Property Owner (Complete this item at the request of SHPO or FPO.)

name _____
 street & number _____ telephone _____
 city or town _____ state _____ zip code _____

United States Department of the Interior
National Park Service

National Register of Historic Places
Continuation Sheet

Section number 7 Page 1
Name of Property Hillside Historic District
County and State Lewis County, WA

The Chehalis Hillside Historical District is located in the eastern part of town, one street east from the historic downtown area. It is a residential, mostly middle class neighborhood with a few prominent houses among smaller worker houses, most of which are well preserved. The dominant architectural styles are Craftsman and Bungalow with a few examples of Queen Anne, and Tudor. The district encompasses the majority of Washington and Adams Avenues approximately twelve non-standard blocks in length, and three blocks extending uphill. The area was once a part of the Chehalis Land & Timber Company, William Urquhart, Park Hill, N. B. Coffman, Alva E. Judd, Mc Fadden, and Wife's 1/2 Additions. The streets running the length of the area, Washington Avenue, Adams Avenue, and Jefferson Avenue, were platted in 1888 and 1889. The area was first developed in the 1890s and development continued until the 1930s, with a few houses constructed later, but still leaving the area with the general character of the first quarter of the century.

General Setting: The district is located along northeast and southeast Washington Avenue, northeast and southeast Adams Avenue, Jefferson Avenue, northeast Hillside, northeast Terrace, and Cascade Avenue. Within these blocks resided several of the city's more prominent citizens including Harry C. Coffman, Arthur St. John, Arthur Parrish, A. L. Ribelin, David Urquhart, Morris Burnett, Clarence Ellington, Dr. George Dow, Thomas C. Rush, and several others. The district is located on a hill overlooking downtown Chehalis and is a part of two of the four "mini-grids" that make up Chehalis rather than the common singular rectangular grids. Washington, Adams, and Jefferson Avenues are all laid out in the common block system. Hillside Drive and Terrace Road are a part of winding narrow streets much like what is found in the hilly regions in Europe. These lots are irregular in size and generous. The difference in street layouts within the district adds a diversity to the neighborhood that is pleasant and provides a break from the monotonous block system.

Architectural Character: The Hillside Historical District is composed of 141 contributing properties. All are single family dwellings with the exception of two apartment complexes. Because the houses are located on a hill, either the front or the back yards are sloped, depending on the side of street where located. This provides for a variety of different landscapes and a wonderful view of the city.

The majority of the houses were built in four growth periods: approximately 1890 to 1907, 1910, 1914, and 1930. The majority of the houses reflect the Craftsman style of the 'teens and 1920s. Other styles include the bungalow, also popular for the time, Queen Anne, Late Victorian Shingle, Tudor, American Foursquare, and Colonial Revival.

United States Department of the Interior
National Park Service

National Register of Historic Places
Continuation Sheet

Section number 7 Page 2
Name of Property Hillside Historic District
County and State Lewis County, WA

The houses are built of balloon frame construction, originally sided with brick, clapboards, shingles, drop siding, or a combination of these materials. There are mainly two scales of houses in this area: large two-and-one-half-story houses which are Queen Anne and Craftsman in style, and smaller one-and-one-half-story houses expressed mainly as bungalows.

Integrity: The integrity of the individual houses ranges from excellent to seriously compromised, but the district as a whole retains substantial integrity from the historic period. Most of the houses are historically recognizable in terms of their form, massing, roof line, exterior surfacing, windows and other details. Some contemporary houses have been built but the majority of those are nearly forty years old. Basically the lots have stayed the same without changes in size.

House Types: Craftsman Style: Most of the homes in this district are built in the Craftsman style, with several variations. The majority of the district developed during two of three building spurts between 1914 and 1930, at the height of Craftsman popularity. Craftsman principles valued structural honesty, handcrafted features, and a harmonious relationship between site and building. These homes are typically characterized by low pitched gable roofs with broad overhanging eaves, shingle or clapboard siding, and "structural ornament" such as braces and exposed rafter tails. The movement began in California around the turn of the century and influenced houses all over the country until 1930. There are four principle subtypes: the front-gabled roof, cross-gabled roof, side-gabled roof, and the hipped roof. Out of sixty-four Craftsman houses in this district, thirty-two are front-gabled, twenty-four are side-gabled, and eight are cross-gabled.

Within the district two fine examples of the front-gabled Craftsman include 200 North-east Washington Ave., the Hotchkiss Home and 1098 Southeast Adams Avenue, the Baker Home. The Hotchkiss Home is two stories and was built approximately 1912. This home has a dominant front gable with a large dormer on the left side. The front of the house has a large exposed brace under the peak of the gable. There are three large windows with leaded glass casements on the sides and upper portions of the windows. A balcony provides a visual break between the first and second stories. This house has shingle siding and a side entry. The Baker Home is a one-and-one-half-story home with a plain front gable and front gable dormer set off center on the right side. There is also a shed dormer on the left side of the building. The upper level windows have the original leaded glass casements while the front window is larger. The siding is horizontal wood. This house has a half front porch under the gable.

United States Department of the Interior
National Park Service

**National Register of Historic Places
Continuation Sheet**

Section number 7 Page 3
Name of Property Hillside Historic District
County and State Lewis County, WA

One fine example of the cross-gabled roof is the Saunders home at 177 Northeast Washington Avenue, built approximately 1910. Alfred Saunders was a farmer and later became a watchman. This one-and-one-half-story home has a large cross gabled roof line. The front of the home has a row of four windows on the upper story, centered over a covered porch. Exposed brackets add decoration under the eaves and windows.

One fine example of the side-gable roof is the Scherer Home located on 185 Northeast Division, built approximately 1912. This example has, unfortunately, not received landscaping care, resulting in overgrowth covering much of the building. The building still appears sound. The side gabled roof line is broken in the center with a large shed dormer boasting a row of four windows with an upper leaded glass casement. A covered porch extends the length of the front of the building with three large square pillars upholding the overhanging eaves. Exposed rafters and framed windows decorate the exterior, which is clad with horizontal wood siding.

Bungalows are often grouped among Craftsman style houses because of their compatible size and style. Craftsman houses, typically one-and-one-half to two or two-and-one-half-stories contrast with bungalow houses which were most often one story and considered to be the perfect size for a family without servants. In the Hillside Historic District there are thirty-seven bungalow houses. Two examples of this style found in the district are the Henriot Home, 272 Northeast Terrace and the Smith Home, 365 Southeast Washington Avenue. The latter is a one story, front gabled home built approximately in 1923. Exposed brackets and rafters add decoration to the front as does a horizontal beam under the gable, almost making the gabled roof appear to be one large pediment. The front of the house is dominated by a large covered porch with double pillars at each corner of the roof. The siding is wood shingle. The Smith Home is another well kept home built circa 1928. This is another front gabled building with a porch on the right side under a second, off-centered gable. Instead of exposed rafters this home has only exposed brackets under the eaves. The siding is horizontal wood.

House Types: Tudor: Popular in the early twentieth century this style was a common choice in the 1920s and early 1930s when Colonial Revival was its rival in popularity. The style is typically identified by steeply pitched side gables dominated by one or more prominent cross gables, tall narrow windows, usually in multiple groups with multi-pane glazing. Principle siding includes stucco, brick, stone, and less often wood, though that is what is predominant in the Hillside District. There are eleven examples of the Tudor

United States Department of the Interior
National Park Service

National Register of Historic Places
Continuation Sheet

Section number 7 Page 4
Name of Property Hillside Historic District
County and State Lewis County, WA

style in the district, including the Ellington Home and the Bishop Home at 126 Northeast Washington Avenue and 171 Terrace, respectively. The Ellington Home, built approximately 1930, has an asymmetrical roofline. The roof is steeply pitched with eaves extending down two stories. The front of the home has two connected front gables. The larger, full gable has a row of three double-hung sash windows with an upper leaded glass casement, and the gable on the right has two side-by-side windows, and a double-hung upper leaded glass casement. This home is a full two stories with horizontal and terra cotta siding. The Bishop Home was built approximately 1928 for lawyer Willard Bishop. This large home has a cross-gabled roofline punctuated with three dormers to the right of the front gable. The building is two stories; the upper level is half timbered in a basic horizontal and vertical pattern, and the lower level is horizontal wood siding. The windows appear to be original with some leaded glass casement.

House Types: Late Victorian: There are several different styles of Victorian architecture. Examples of Queen Anne, Shingle, and Stick styles can be found in the district. Although these examples are less ornate than those found in larger cities they are still good representative examples. The Queen Anne style was dominant between 1880 and 1900 and persisted through the first decade of the new century. The first example of this style, found in Rhode Island, spread across the country through the first architectural magazine *The American Architect and Building News* and moved westward with help from the railroad and pre-cut architectural details. Three prime examples of the Queen Anne style found in the district are the Rush Home, the Dieckmann Home, and the Burnett Home found at 472 Northeast Washington Ave., 555 Northeast Jefferson, and 280 Northeast Cascade, respectively. The Rush Home was built prior to 1893 for Thomas Rush. It has a complex asymmetrical roofline, with a dominant turret with a pyramidal roof. The front porch gable peak has a wooden sunburst motif and the porch is supported with turned porch posts. The other gables are covered with imbricated shingles. The front of the home features a one story square bay window decorated with imbricated shingles; the window is not original. The rest of the exterior of the home is covered with horizontal beveled wood siding. Originally the house had more gingerbread detailing and the kitchen in the rear was added on at an unknown date. The Dieckmann Home was built prior to 1893, and between that date and 1912 several additions were made to transform the basic square plan into the present Queen Anne style home it is today. Charles Dieckmann was a gold prospector who would often leave for six month trips with his wife. This two story home also has a complex asymmetrical roof line with a prominent two-story turret on the western frontage. A porch covers the entrance and wraps around

United States Department of the Interior
National Park Service

**National Register of Historic Places
Continuation Sheet**

Section number 7 Page 5
Name of Property Hillside Historic District
County and State Lewis County, WA

the southern exposure. The exterior is finished in horizontally placed narrow siding. The Burnett Home was built around 1893 for John M. Kemper and later was owned by Morris Burnett a prominent member of the city who owned and operated a jewelry store considered the "Tiffany" of Chehalis. This two-story house has an irregular silhouette and roofline but restrained detailing of the Queen Anne style. On the southwest corner, a prominent two story tower with a conical roof and curved glass windows add character to the home. An early change, undated but probably prior to 1920, is the porch, which was extended across the front of the house to enclose a tower which no longer exists.

Other Styles: English Cottage Style: The Ribelin Home, located at 502 Northeast Adams Avenue, was built by J. Def Griffin in 1928 for A. L. Ribelin, the J. C. Penny's manager. Before building the home one house had to be moved across the street: 540 Northeast Adams Ave, the Urquhart Home. The Ribelin Home is a two-story building with stucco siding and a simulated thatch roof of red composition shingles. The front of the building has two clipped gables and a row of three double-hung sash windows with upper leaded glass casement. The entry is protected by an overhanging roof. On the second floor above the entry is a pair of stained glass windows. On either side of the entryway are windows similar to those found under the gables. At either end of the house are rounded arch windows. The arrangement is balanced and symmetrical.

American Foursquare: There are two prominent examples of the American Foursquare style found within the district including the Dr. Dow Home at 438 Northeast Washington and the Schmidt Home at 279 Hillside. The Dr. Dow Home built approximately in 1904 also has Italianate influences. The two-story building has a low pitch hipped roof with wide extending eaves supported by large brackets. Two dormers and a long porch extending across the front of the house decorate the exterior of the home. The porch has wide overhanging eaves supported by brackets and is carried by five paired posts. Windows are two light, some with upper panes. There is also a bay window on the north side of the house that is flanked by sidelights. The Schmidt Home is a less ornate version of the American Foursquare style. This house was built approximately 1924 and is two stories. The roof is hipped without dormers and the two stories are without a visual break such as a belt course. The windows are asymmetrical and the front door is capped with a palladian window.

United States Department of the Interior
National Park Service

**National Register of Historic Places
Continuation Sheet**

Section number 7 Page 6
Name of Property Hillside Historic District
County and State Lewis County, WA

Residential Vernacular: The Cory Home at 78 Northeast Washington Avenue and The Boone Home at 622 Southeast Washington Avenue are fine examples of this eclectic type. The Cory Home was built in 1925 for Arthur S. Cory, the son of a Methodist minister and president of Savings and Loan. This home has a hipped roof, with the front of the roof broken by two large upper story windows resembling a large dormer. At the right corner of the front of the house is a small pediment above two side-by-side windows, and on the left is a row of three windows. Centered in the front is a covered porch. Mr. Cory was the founder of Lewis County Savings; he also served in the Washington State House of Representatives. In February of 1965 the Corys gave the home to the Lewis County Museum to house pioneer artifacts; the Museum stayed for many years until it was sold for a residence once again. Much of the house is original with period lighting, plumbing fixtures, and interior oak finishings. The Boone Home was built approximately 1925 and occupied by John Boone, owner of a local mortuary, until 1956. This home is the only example of Mediterranean Revival in the Historic Hillside District. It has lost its original integrity of multi-paned windows and parapet balusters, but because this is the only example of this style in the district, it is still contributing. It is a one-and-one-half-story building with a flat roof, stucco exterior walls and parapets at the roofline.

Integrity Standards: The integrity standards used to determine the status of the contributing and noncontributing district properties were based upon the registration standards spelled out in the "Historic Resources of Chehalis" Multiple Properties Documentation Form. Those designated as contributing retain the essential architectural design qualities of form, materials, style, and construction methods. Window and door openings must be intact, though limited window replacement is allowable as long as the openings retain the original shape and size. Residing does not compromise eligibility as long as the architectural style is identifiable through original details. Conversely, noncontributing properties are those homes that have been altered so as to confuse historic relationships and make architectural styles, periods, and design aspects mostly undetectable.

United States Department of the Interior
National Park Service

**National Register of Historic Places
Continuation Sheet**

Section number 7 Page 7
Name of Property Hillside Historical District
County and State Lewis County, WA

HILLSIDE HISTORICAL DISTRICT, CHEHALIS

CONTRIBUTING PROPERTIES

ADDRESS	STYLE	YEAR BUILT	ARCHITECT
<hr/>			
1116 SE Washington Ave.			
556 (760) NE Washington Ave. (Past Owner: Amos F. Scherer)	Side-Gabled Craftsman	ca. 1912	
549 (769) NE Washington Ave. (Past Owners: Fred A Allen, 1910-1919; Nathan Nuce, owner of Nuce's Department Store, 1919-1962; Carol Ayers, 1963-present)	Side-Gabled Craftsman	ca. 1910	
546 (770) NE Washington Ave. (Past Owner: Charles D. Powell, dentist)	Queen Anne	before 1907	
538 (780) NE Washington Ave. (Past Owner: Robert D. McCord)	Side-Gabled Craftsman	ca. 1918	
525 (789) NE Washington Ave. (Past Owner: Augustus T. Jeffries)	Side-Gabled Craftsman	before 1896	
472 (868) NE Washington Ave. (Past Owner: Thomas C. Rush, 1900-1948)	Queen Anne	ca. 1893	
438 (902) NE Washington Ave. (Past Owner: Dr. George Dow)	American Four-Square	ca. 1904	
412 (902) NE Washington Ave. (Past Owner: John W. Alexander, President of Security State Bank)	Colonial Revival	1928	Henderson Bankus Co. of Portland
402 (938) NE Washington Ave. (Past Owners: J. Magnus, asst. postmaster Virgil R. Lee, vice-principal of Cascade School)	Side-Gabled Craftsman	ca. 1914	

United States Department of the Interior
National Park Service

National Register of Historic Places
Continuation Sheet

Section number 7 Page 8
Name of Property Hillside Historical District
County and State Lewis County, WA

HILLSIDE HISTORICAL DISTRICT, CHEHALIS

CONTRIBUTING PROPERTIES

ADDRESS	STYLE	YEAR BUILT	ARCHITECT
368 (960) NE Washington Ave. (Past Owner: Harry C. Coffman)	Dutch Colonial	before 1908	
365 (959) NE Washington Ave. (Past Owner: Goldie F. Johnston)	Dutch Colonial	ca. 1915	
336 (968) NE Washington Ave. (Past Owner: Virgil Lee)	Side-Gabled Craftsman	ca. 1922	
335 (967) NE Washington Ave. (Past Owners: James M. Sleicher Rodney John Etherton)	Side-Gabled Craftsman	1920	
322 (978) NE Washington Ave. (Past Owners: Turner G. Marvin Walter W. Lutz Audrey L. Janikula Daniel L. Keeper)	Front-Gabled Craftsman	1890s	
317 (977) NE Washington Ave. (Past Owner: Anders W. Edman)	Cross-Gabled Craftsman	ca. 1914	
306 (980) NE Washington Ave. (Past Owners: Howard Geissler Frank McCord Eva Morris)	Front-Gabled Craftsman	1890s	
297 (983) NE Washington Ave. (Past Owners: William A. Reynolds, superior court judge; George F. Petterson)	Side-Gabled Craftsman	ca. 1922	

United States Department of the Interior
National Park Service

National Register of Historic Places
Continuation Sheet

Section number 7 Page 9
Name of Property Hillside Historical District
County and State Lewis Countv. WA

HILLSIDE HISTORICAL DISTRICT, CHEHALIS

CONTRIBUTING PROPERTIES

ADDRESS	STYLE	YEAR BUILT	ARCHITECT
292 (986) NE Washington Ave. (Past Owners: Isabell Sims James B. Browning Leland Uehling)	Front-Gabled Craftsman	1890s	
233 (999) NE Washington Ave. (Past Owner: Fred Balfour)	Front-Gabled Craftsman	ca. 1920	
219 (1027) NE Washington Ave. (Past Owners: William C. Cross Harold Smith Alpha E. Oliphant)	Tudor	1912	
214 (1006) NE Washington Ave. (Past Owners: Hosea B. Coffman Fred N. Beal)	Side-Gabled Craftsman	1913	
200 (1012) NE Washington Ave. (Past Owners: Walter B. Hotchkiss Frank L. Lipscomb Thomas J. Green Dr. Patrick M. O'Neill)	Front-Gabled Craftsman	1912	
177 (1031) NE Washington Ave. (Past Owner: Alfred Saunders, farmer)	Cross-Gabled Craftsman	ca. 1910	
156 (1030) NE Washington Ave. (Past Owner: Ernest A. Stoppelman, president-manager South Chevrolet)	American Foursquare	ca. 1926	
126 (1036) NE Washington Ave. (Past Owner: Clarence Ellington, owner/editor Chehalis Bee-Bugget)	Tudor	ca. 1930	

United States Department of the Interior
National Park Service

**National Register of Historic Places
Continuation Sheet**

Section number 7 Page 10
Name of Property Hillside Historical District
County and State Lewis County, WA

HILLSIDE HISTORICAL DISTRICT, CHEHALIS

CONTRIBUTING PROPERTIES

ADDRESS	STYLE	YEAR BUILT	ARCHITECT
90 (1056) NE Washington Ave. (Past Owner: Grace Smith)	Side-Gabled Craftsman	ca 1925	
78 (1070) NE Washington Ave. (Past Owners: Arthur S. Cory David B. Crook Leroy S. Simpson)	Craftsman	ca. 1918	
75 (1061) NE Washington Ave. (Past Owners: John Denhof A. F. Petit)	Tudor	ca. 1936	
26 (1114) NE Washington Ave. (Past Owners: Frank H. Taylor Luther Wigglesworth, beer parlor owner Douglas Spanier)	Queen Anne	ca. 1931	
78 (1150) SE Washington Ave. (Past Owners: William R. Giffin, manager West Oil Co. Harvey H. Attridge)	Front-Gabled Craftsman	ca. 1912	
83 SE Washington Ave.			
117 (1171) SE Washington Ave. (Past Owner: Thomas O. Hendricks)	Tudor	before 1931	
145 (1181) SE Washington Ave. (Past Owner: Manning J. Howard)	Front-Gabled Craftsman	ca. 1928	
155 (1191) SE Washington Ave. (Past Owner: Price A. Barber)	Front-Gabled Craftsman	1926	
170 (1194) SE Washington Ave. (Past Owner: Robert P. Warmuth, owner of a grocery store)	Side-Gabled Craftsman	1919	

United States Department of the Interior
National Park Service

National Register of Historic Places
Continuation Sheet

Section number 7 Page 11
Name of Property Hillside Historical District
County and State Lewis County, WA

HILLSIDE HISTORICAL DISTRICT, CHEHALIS

CONTRIBUTING PROPERTIES

ADDRESS	STYLE	YEAR BUILT	ARCHITECT
179 (1201) SE Washington Ave. (Past Owner: Jesse R. Imus)	Front-Gabled Craftsman	ca. 1912	
(1217) SE Washington (Past Owners: William Johnson Jas McGee Richard C. Hoakenson Kenneth Wahlstrom)	Side-Gabled Bungalow	ca. 1912	
240 (1230) SE Washington Ave. (Past Owners: Samuel Best Renrue W. Crowell)	Front-Gabled Craftsman	ca. 1912	
245 (1229) SE Washington Ave. (Past Owners: Robert Fechtner Stanely A. Giske)	Side-Gabled Craftsman	ca. 1917	
254 (1238) SE Washington Ave. (Past Owner: Claude S. Vanderslice)	Craftsman	before 1931	
267 (1247) SE Washington Ave. KAUFMAN APARTMENTS	Tudor	1923	
280 (1246) SE Washington Ave. (Past Owner: Chester A. Studebaker)	Craftsman	ca. 1912	
365 (1287) SE Washington Ave. (Past Owner: Errol Smith)	Bungalow	ca. 1928	
377 (1295) SE Washington Ave. (Past Owner: Oscar A. Lotz)	Cross-Gabled Craftsman	ca. 1932	

United States Department of the Interior
National Park Service

**National Register of Historic Places
Continuation Sheet**

Section number 7 Page 12
Name of Property Hillside Historical District
County and State Lewis County, WA

HILLSIDE HISTORICAL DISTRICT, CHEHALIS

CONTRIBUTING PROPERTIES

ADDRESS	STYLE	YEAR BUILT	ARCHITECT
221 431 (1323) SE Washington Ave.	Side-Gabled Craftsman	before 1931	
445 (1331) SE Washington Ave. (Past Owner: Albert E. Chamberlain)	Craftsman	ca. 1931	
465 (1339) SE Washington Ave. (Past Owner: George C. Bartel)	Front-Gabled Bungalow	1912	
493 (1357) SE Washington Ave. (Past Owners: Fredrick Bartz Josephine Fishback)	Bungalow	1912	
507 (1363) SE Washington Ave. (Past Owner: Nils A Hogberg, dentist)	Side-Gabled Craftsman	1923	
523 (1367) SE Washington Ave. (Past Owner: Sigurd Hansen)	Tudor	ca. 1926	
541 SE Washington Ave.			
561 (1375) SE Washington Ave. (Past Owner: Roy C. Strom; Morris, Morris, & Strom)	Residential Vernacular	1923	
585 (1391) SE Washington Ave. (Past Owner: Herbert W. Nelson)	Bungalow	1926	
622 (1408) SE Washington Ave. (Past Owner: John Boone)	Residential Vernacular	before 1923	
641 (1423) SE Washington Ave. (Past Owner: Leo J. Mitchell)	Side-Gabled Craftsman	before 1931	

United States Department of the Interior
National Park Service

**National Register of Historic Places
Continuation Sheet**

Section number 7 Page 13
Name of Property Hillside Historical District
County and State Lewis County, WA

HILLSIDE HISTORICAL DISTRICT, CHEHALIS

CONTRIBUTING PROPERTIES

ADDRESS	STYLE	YEAR BUILT	ARCHITECT
664 (1428) SE Washington Ave. (Past Owner: Freemont Burross, Chehalis Tile Company)	Side-Gabled Craftsman	ca. 1926	
671 (1431) SE Washington Ave. (Past Owner: T.F. Willms, owner Ben Franklin)	Colonial Revival	1938	D.W. Hillborn of Vancouver
686 (1438) SE Washington Ave. (Past Owner: Corkins, Puget Sound Power Sound and Light)	Side-Gabled Bungalow	ca. 1926	
693 (1443) SE Washington Ave. (Past Owner: Oscar Lotz)	Cross-Gabled Bungalow	ca. 1934	
698 (1448) SE Washington Ave. (Past Owner: Arthur E. Cook, owner of Enterprise Electric Francis S. Fitz-Patrick)	Side-Gabled Craftsman	ca. 1930	
722 (1462) SE Washington Ave. (Past Owner: Manning Vincent A. Mitchell)	Tudor	before 1931	
742 (1472) SE Washington Ave. (Past Owner: Tauscher)	Tudor	ca. 1926	
764 (1486) SE Washington Ave. (Past Owner: Ethel Laughlin, 1924-1941 Dr. Bain)	Late Victorian, Shingle	ca. 1924	John Schwartz Contractor
839 (1517) SE Washington Ave. (Past Owner: Walter Logan)	Side-Gabled Bungalow	before 1927	
853 (1523) SE Washington Ave.	Side-Gabled Craftsman	before 1931	

United States Department of the Interior
National Park Service

**National Register of Historic Places
Continuation Sheet**

Section number 7 Page 14
Name of Property Hillside Historical District
County and State Lewis County, WA

HILLSIDE HISTORICAL DISTRICT, CHEHALIS

CONTRIBUTING PROPERTIES

ADDRESS	STYLE	YEAR BUILT	ARCHITECT
861 (1531) SE Washington Ave. (Past Owner: Charles Clark)	Bungalow	before 1931	
964 (1574) SE Washington Ave. (Past Owner: Charles Neville)	Craftsman	ca. 1919	
978 (1580) SE Washington Ave. (Past Owner: Luther Wigglesworth)	Craftsman	before 1931	
1001 (1585) SE Washington Ave.	Craftsman	ca. 1914	
1037 (1601) SE Washington Ave. (Past Owner: William Smith)	Bungalow	ca. 1926	
1040 (1610) SE Washington Ave. (Past Owner: Alton V. Haslet)	Bungalow	before 1931	
1060 (1618) SE Washington Ave. (Past Owner: James A. Gray)	Craftsman	before 1931	
1079 (1629) SE Washington Ave. (Past Owners: Bailey B. Smith, engineer Max Chaney)	Bungalow	before 1914	
1082 (1630) SE Washington Ave. (Past Owner: Elsie Jones)	Bungalow	before 1931	

United States Department of the Interior
National Park Service
National Register of Historic Places
Continuation Sheet

Section number 7 Page 15
Name of Property Hillside Historical District
County and State Lewis County, WA

HILLSIDE HISTORICAL DISTRICT, CHEHALIS

CONTRIBUTING PROPERTIES

ADDRESS	STYLE	YEAR BUILT	ARCHITECT
596 (674) NE Adams Ave. (Past Owner: Willis Barber, 1931)	Queen Anne	before 1893	
590 (684) NE Adams Ave. (Past Owners: Arthur E Diefendorf John Lindner)	Side-Gabled Craftsman	before 1893	
573 (697) NE Adams Ave. (Past Owner: Jay L Widby)	Front-Gabled Craftsman	ca. 1932	
570 (698) NE Adams Ave. (Past Owners: Leonard Kuehner proprietor of Germania Bar Ethel Anderson)	Queen Anne	before 1893	
555 (715) NE Adams Ave. (Past Owners: Charles L. Laughlin Charles P. Fullton)	Side-Gabled Bungalow	ca. 1912	
550 (722) NE Adams Ave. (Past Owners: John L. Irish; Irish & Shanner Leslie Robert Monahan)	pre railroad/Folk House	ca. 1885	
543 (727) NE Adams Ave. (Past Owners: Otto F. Schultz; Proprietor of City Restaurant Chester Anderson)	Front-Gabled Craftsman	ca. 1910	

United States Department of the Interior
National Park Service

**National Register of Historic Places
Continuation Sheet**

Section number 7 Page 16
Name of Property Hillside Historical District
County and State Lewis County, WA

HILLSIDE HISTORICAL DISTRICT, CHEHALIS

CONTRIBUTING PROPERTIES

ADDRESS	STYLE	YEAR BUILT	ARCHITECT
540 (734) NE Adams Ave. (Past Owners: David Urquhart Berqyn Lee Bushlen)	Queen Anne	ca 1893	
535 (733) NE Adams Ave. (Past Owners: John Black Albert F. Bixby)	Tudor	ca. 1910	
502 (770) NE Adams Ave. (Past Owners: A.L. Ribelin, J.C. Penny Manager Franklin Scheidel, Jr. Dan H. Mitchell)	Tudor	1927	
486 (778) NE Adams Ave. (Past Owners: William P. Brady Jack F. Charneski)	Queen Anne	before 1890	
482 (786) NE Adams Ave. (Past Owner: W.P. Brady)	Front-Gabled Bungalow	1925	
479 (785) NE Adams Ave. (Past Owners: A.R. Parrish Robert Kranz)	Queen Anne	1905	
472 (792) NE Adams Ave. (Past Owners: Arthur St. John Robert Wiseman)	Queen Anne	before 1893	

United States Department of the Interior
National Park Service

**National Register of Historic Places
Continuation Sheet**

Section number 7 Page 17
Name of Property Hillside Historical District
County and State Lewis County, WA

HILLSIDE HISTORICAL DISTRICT, CHEHALIS

CONTRIBUTING PROPERTIES

ADDRESS	STYLE	YEAR BUILT	ARCHITECT
471 (793) NE Adams Ave. (Past Owner: Phineas H. Dodge)	Cross-Gabled Bungalow	before 1893	
454 (810) NE Adams Ave. (Past Owner: Tony Hanson, Tailor)	Side-Gabled Craftsman	before 1910	
444 (814) NE Adams Ave. (Past Owner: J.P. Porter - PORTER APARTMENTS)	Chicago Commercial Style	1918	
432 (836) NE Adams Ave. (Past Owners: Archibald D. Hogue John C. Nowadnick)	Bungalow	ca 1912	
425 (827) NE Adams Ave. (Past Owners: Cassius M. Russell Mrs. Anna Bowring)	Queen Anne	before 1893	
412 NE Adams Ave.			
389 (859) NE Adams Ave. (Past Owners: Elmer Mc Broom, President of Advocate Printing Mrs. A. Hilda)	Craftsman	ca. 1908	
336 (892) NE Adams Ave. (Past Owners: Fred MacFarlane Judge James S. Turner)	Late-Victorian, Shingle	ca. 1926	
1098 (1598) SE Adams Ave. (Past Owners: Irvin W. Baker John Gelbertson)	Front-Gabled Craftsman	ca. 1914	

United States Department of the Interior
National Park Service

**National Register of Historic Places
Continuation Sheet**

Section number 7 Page 18
Name of Property Hillside Historical District
County and State Lewis County, WA

HILLSIDE HISTORICAL DISTRICT, CHEHALIS

CONTRIBUTING PROPERTIES

ADDRESS	STYLE	YEAR BUILT	ARCHITECT
1046 (1586) SE Adams Ave. (Past Owner: George F. Koons)	Side-Gabled Craftsman	ca. 1918	
1041 (1573) SE Adams Ave. (Past Owner: Daniel J. Mc Donald)	Craftsman	ca. 1939	
1024 (1564) SE Adams Ave. (Past Owner: Corwin Sabin)	Queen Anne	ca. 1929	
999 SE Adams Ave.			
979 (1545) SE Adams Ave. (Past Owner: Loyal E. Dybig)	Side-Gabled Bungalow	ca. 1924	
972 (1544) SE Adams Ave. (Past Owner: Guy A. Turner)	Side-Gabled Craftsman	ca. 1929	
956 (1538) SE Adams Ave. (Past Owner: Rex L. Ellis)	Side-Gabled Bungalow	ca. 1934	
882 (1500) SE Adams Ave. (Past Owner: John W. Malin)	Cross-Gabled Bungalow	ca. 1926	
859 SE Adams Ave.	Small Gabled		
761 (1445) SE Adams Ave. (Past Owner: Ferdinand P. Siegwarth)	Cross-Gabled Craftsman	ca. 1926	
743 (1431) SE Adams Ave. (Past Owners: Grant Parsons Tobias F. Williams)	Craftsman	ca. 1926	
721 (1421) SE Adams Ave. (Past Owner: Harold Bogan)	Cross-Gabled Bungalow	ca. 1928	
711 SE Adams Ave.	Front-Gabled Craftsman		

United States Department of the Interior
National Park Service

**National Register of Historic Places
Continuation Sheet**

Section number 7 Page 19
Name of Property Hillside Historical District
County and State Lewis County, WA

HILLSIDE HISTORICAL DISTRICT, CHEHALIS

CONTRIBUTING PROPERTIES

ADDRESS	STYLE	YEAR BUILT	ARCHITECT
703 (1411) SE Adams Ave. (Past Owner: eorge Thompson)	French Eclectic	ca. 1928	
684 (1408) SE Adams Ave. (Past Owners: Francis W. Mathias Peder Jenseth)	Front-Gabled Craftsman	ca. 1914	
679 (1401) SE Adams Ave. (Past Owner: Benjamin D. Fay)	Adam Classical Revival	ca. 1934	
658 (1406) SE Adams Ave. (Past Owner: J. A. Wright)	Bungalow	before 1931	
602 (1364) SE Adams Ave. (Past Owner: Salvenus A. Hendricks)	Bungalow	ca. 1926	
278 SE Adams Ave.	Rustic Style		
241 SE Adams Ave.	Side Gabled Craftsman		
25 (1081) SE Adams Ave. (Past Owner: Mrs. Matilda E. Smith)		ca. 1910	
16 (1088) SE Adams (Past Owner: Walter J. Cagley)	Cross-Gabled Craftsman	before 1945	
555 (741) NE Jefferson Ave. (Past Owners: Charles Dieckmann Robert Lintott)	Queen Anne	before 1893	
491 NE Jefferson Ave.			

NPS Form 10-900-a
OMB No. 1024-0018
(8-86)

United States Department of the Interior
National Park Service

**National Register of Historic Places
Continuation Sheet**

Section number 7 Page 20
Name of Property Hillside Historical District
County and State Lewis County, WA

HILLSIDE HISTORICAL DISTRICT, CHEHALIS

CONTRIBUTING PROPERTIES

ADDRESS	STYLE	YEAR BUILT	ARCHITECT
483 (825) NE Jefferson Ave. (Past Owner: James Balsom)	Front-Gabled Tudor	ca. 1932	
477 (837) NE Jefferson Ave. (Past Owner: Donald G. Abel, Lawyer)	Side-Gabled Craftsman	ca. 1928	
279 Hillside (Past Owner: John R. Schmidt)	American Foursquare	ca. 1924	
296 (902) NE Hillside (Past Owner: John L. Cruse, Sr.)	Cross-Gabled Craftsman	ca. 1926	
262 (948) NE Hillside (Past Owners: Chapin D. Foster William T. Brumfield)	Craftsman	ca. 1929	
156 (1045) NE Hillside (Past Owner: Alvin D. Ziska)	Side-Gabled Craftsman	ca. 1930	
116 NE Hillside Dr.			
281 (1110 Washington Ave.) Terrace (Past Owners: Roberts 1926-1938 Barbra Wood 1938-1939 Edna Hawkins 1939-1956 Richard Follet 1956-1968 Tibbits 1968-present owner of D & J Meats)	Tudor	1926	
272 (1102) NE Terrace (Past Owners: Abel and Catherine Henriot, carpenter Oscar Mills, mayor Steve Paterson, timber)	Side-Gabled Bungalow	1919	

United States Department of the Interior
National Park Service

National Register of Historic Places
Continuation Sheet

Section number 7 Page 21
Name of Property Hillside Historical District
County and State Lewis County, WA

HILLSIDE HISTORICAL DISTRICT, CHEHALIS

CONTRIBUTING PROPERTIES

ADDRESS	STYLE	YEAR BUILT	ARCHITECT
261(1068) NE Terrace (Past Owners: Cleo E. Henriot, president of Twin City Fuel Leonard Sonneman, mayor John H. Prosser, carpenter)	Craftsman	1925	
241 (1036) NE Terrace (Past Owners: Russell L. Ponder, attorney Donald A. Mitchell)	Tudor	ca. 1930	
171 (966) NE Terrace (Past Owners: Willard E. Bishop, Lawyer 1928-1942 Elmer Jastead, logger Don Mitchell, superintendent of schools Karen Schiedle Kenneth James Craig Ruthford)	Tudor	ca. 1928	
155 (932) NE Terrace (Past Owners: Alva E. Judd Arthur St. John Charlie Hughs)	Cross-Gabled Craftsman	begun 1918	
120 (905) NE Terrace (Past Owner: Alva E. Judd Arthur St. John Charlie Hughs)	Cross-Gabled Craftsman	begun 1918	

NPS Form 10-900-a
OMB No. 1024-0018
(8-86)

United States Department of the Interior
National Park Service

**National Register of Historic Places
Continuation Sheet**

Section number 7 Page 22
Name of Property Hillside Historical District
County and State Lewis County, WA

HILLSIDE HISTORICAL DISTRICT, CHEHALIS

CONTRIBUTING PROPERTIES

ADDRESS	STYLE	YEAR BUILT	ARCHITECT
103 (902) NE Terrace (Past Owner: Hans B. Bebe Dr. Lester Steck Dr. Morley Walter Holtz Art and Ruth Hansen)	Craftsman	1929	
185 (1105) NE Division (Past Owners: Amos F. Scherer Michael L. Sullivan)	Bungalow	ca. 1912	
171 (966) NE Terrace (Past Owners: Willard E. Bishop, Lawyer 1928-1942 Elmer Jastead, logger Don Mitchell, superintendent of schools Karen Schiedle Kenneth James Craig Ruthford)	Tudor	ca. 1928	
161 NE Terrace Dr.			
155 (932) NE Terrace (Past Owners: Alva E. Judd Arthur St. John Charlie Hughs)	Cross-Gabled Craftsman	begun 1918	
120 (905) NE Terrace (Past Owners: Alva E. Judd Arthur St. John Charlie Hughs)	Cross-Gabled Craftsman	begun 1918	

United States Department of the Interior
National Park Service

**National Register of Historic Places
Continuation Sheet**

Section number 7 Page 23
Name of Property Hillside Historical District
County and State Lewis County, WA

HILLSIDE HISTORICAL DISTRICT, CHEHALIS

CONTRIBUTING PROPERTIES

ADDRESS	STYLE	YEAR BUILT	ARCHITECT
135 (1085) NE Division (Past Owner: William H. Kenoyer)	American Foursquare	ca. 1912	
280 (726) NE Cascade (Past Owners: John M. Kempner Harry John Miller Morris Burnett Bruce Barkis)	Queen Anne	ca. 1894	
154 Eleventh St.	Gabled		
181 Ninth St.	Side Gabled		
121 Ninth St.	Bungalow		
43 Eighth St.			
85 Sixth St.	Gabled el farmhouse		
16 NE Adams			
79 North St.			
80 North St.	Dutch Colonial Revival		
?	Christian Science Church		
125 School St.	worker's house		
116 School St.	Queen Anne		
138 School St.	Colonial Revival		
187 Highland Place			

United States Department of the Interior
National Park Service

**National Register of Historic Places
Continuation Sheet**

Section number 7 Page 24
Name of Property Hillside Historical District
County and State Lewis County, WA

HILLSIDE HISTORICAL DISTRICT, CHEHALIS

NON-CONTRIBUTING BUILDINGS

572 & 570 NE Washington Ave.	duplex
541 NE Washington Ave.	house
528 NE Washington Ave.	house
492 NE Washington Ave.	house
484 NE Washington Ave.	Parke Terrace Apartments
459 & 457 NE Washington Ave. Building	commercial buildings added on to Apartment
City Administration Buildings	
Library	
397 & 395 NE Washington Ave.	duplex
359 & 397 NE Washington Ave.	duplex
261 NE Washington Ave.	apartments
261 NE Washington Ave.	ranch style
240 NE Washington Ave.	quadroplex
45 NE Washington Ave.	apartments
14 NE Washington Ave.	house
12 SE Washington Ave.	house
38 SE Washington Ave	house

United States Department of the Interior
National Park Service

**National Register of Historic Places
Continuation Sheet**

Section number 7 Page 25
Name of Property Hillside Historical District
County and State Lewis County, WA

HILLSIDE HISTORICAL DISTRICT, CHEHALIS

NON-CONTRIBUTING BUILDINGS

62 SE Washington Ave.	house
120 SE Washington Ave.	house
202 SE Washington Ave.	split-level
350 SE Washington Ave.	retirement home
417 SE Washington Ave.	care ambulance (crew quarters)
477 SE Washington Ave.	house
500 SE Washington Ave.	Providence Extended Care
641 SE Washington Ave.	
818 SE Washington Ave.	
836 SE Washington Ave.	
882 SE Washington Ave.	cross-gable compromised
885 SE Washington Ave.	house
945 SE Washington Ave.	house
961 SE Washington Ave.	compromised house
1006 SE Washington Ave.	compromised house

United States Department of the Interior
National Park Service

**National Register of Historic Places
Continuation Sheet**

Section number 7 Page 26
Name of Property Hillside Historical District
County and State Lewis County, WA

HILLSIDE HISTORICAL DISTRICT, CHEHALIS

NON-CONTRIBUTING BUILDINGS

1025 NE Adams Ave.	compromised bungalow
580 NE Adams Ave.	house
517 NE Adams Ave.	Apartments
462 NE Adams Ave.	house
457 & 459 NE Adams Ave.	duplex
445, 447 & 449 NE Adams Ave.	triplex
441 NE Adams Ave.	rambler
431 NE Adams Ave.	
420 NE Adams Ave.	house
361 NE Adams Ave.	apartments
339 NE Adams Ave.	apartments
1075 SE Adams Ave.	house
1019 SE Adams Ave.	rambler
959 SE Adams Ave.	house
942 SE Adams Ave.	house

United States Department of the Interior
National Park Service

**National Register of Historic Places
Continuation Sheet**

Section number 7 Page 27
Name of Property Hillside Historical District
County and State Lewis County, WA

HILLSIDE HISTORICAL DISTRICT, CHEHALIS

NON-CONTRIBUTING BUILDINGS

920 SE Adams Ave.	house
885 SE Adams Ave.	house
846 SE Adams Ave.	
829 SE Adams Ave.	house
824 SE Adams Ave.	
798 SE Adams Ave.	
779 SE Adams Ave.	
761 SE Adams Ave.	house
758 SE Adams Ave.	house
718 SE Adams Ave.	house
39 SE Adams Ave.	house
706 SE Adams Ave.	
661 SE Adams Ave.	
616 SE Adams Ave.	modern
261 SE Adams Ave.	

United States Department of the Interior
National Park Service

**National Register of Historic Places
Continuation Sheet**

Section number 7 Page 28
Name of Property Hillside Historical District
County and State Lewis County, WA

HILLSIDE HISTORICAL DISTRICT, CHEHALIS

NON-CONTRIBUTING BUILDINGS

238 SE Adams Ave.	house
206 SE Adams Ave.	house
189 SE Adams Ave.	
151 SE Adams Ave.	house
39 SE Adams Ave.	house
16 SE Adams Ave.	
10 SE Adams Ave.	house
592 NE Jefferson Ave.	house
577 NE Jefferson Ave.	apartment building
497 NE Jefferson Ave.	apartments
187 NE Terrace Ave.	house
188 NE Terrace Ave.	house
163 NE Division	
163 Ninth	house
119 Ninth	house
179 Sixth	house
616 Adams	house

300 Market	apartments
175 Third	house
170 First St.	house
179 First St.	house
73 East Main	house
112 School St.	Doctor's Office
303 Jefferson	house
145 NE Hillside	house
39 SE Adams	house
25 SE Adams	house
99 SE Adams	house
981 SE Washington Ave.	house
567 NE Adams Ave.	house
527 NE Adams Ave.	house
505 Jefferson Ave.	house
402 NE Adams Ave.	house

United States Department of the Interior
National Park Service

**National Register of Historic Places
Continuation Sheet**

Section number 8 Page 1
Name of Property Hillside Historical District
County and State Lewis County, WA

The city of Chehalis is a small town with two well preserved historical areas already designated. The downtown area has several buildings listed in the National Register, some of which were built by residents of the Hillside District before the district really developed. Another neighborhood already listed in the National Register is the Pennsylvania Avenue District. The Hillside District consists mainly of Craftsman and Bungalow style houses with a few other styles scattered throughout. These other styles include Queen Anne, Shingle, Tudor, American Foursquare, and Colonial Revival. This area is fairly well preserved, and with the exception of a few newer buildings, still retains the associative qualities of the period of significance. By comparison, the Historic Pennsylvania Avenue is composed of thirty-three houses, most of which were built between 1905 and 1915, and are Craftsman and late Victorian styles. In both districts the houses are constructed and sided with the same materials, such as clapboards, shingles, etc. The Pennsylvania District developed in a shorter period of time than the Hillside District, which is reasonable considering the size difference between the two districts. There were also more prominent members of Chehalis society residing in the Pennsylvania District because it was easier to build on lower ground rather than dragging materials uphill. The Pennsylvania Avenue District was developed into a residential area while the hillside remained farmland and orchards.

The nominated Hillside Historic District is what was the northern half of the Schuyler and Eliza Saunders Donation Land Claim. The couple acquired the land around 1852 through the Donation Land Claim Act, an early version of the Homestead Act unique to the Pacific northwest. This Act provided six-hundred-forty acres per couple in the Pacific Northwest. In 1859 the couple divorced and Eliza gained sole control of three hundred-twenty acres of land, splitting their Donation Land Claim, and drawing the line roughly parallel to First and East Main. O.B. McFadden purchased Schuyler Saunders' half. In years later the land was sold to Alva E. Judd, the Chehalis Land and Timber Company, William Urquhart, O.B. Mc Fadden, and N.B. Coffman, whose additions were platted and became the neighborhood the Hillside District is today.

Alva E. Judd was born in Iowa in 1881. He attended various colleges and universities near Iowa, gaining a teaching certificate and the knowledge to become a superintendent of schools. In 1907 he moved to Lewis County where he became a reporter for the Lewis County Advocate. In 1909 he started a real estate, insurance, and rental company first called J.E. Leonard and Company, which was later changed to Urquhart and Judd after David Urquhart joined the venture. A.E. Judd was appointed special deputy

United States Department of the Interior
National Park Service

**National Register of Historic Places
Continuation Sheet**

Section number 8 Page 2
Name of Property Hillside Historical District
County and State Lewis County, WA

collector for the Internal Revenue Service and promoted by the federal government in the Internal Tax Service. He was in the political minority in the area as a democrat. His addition included land on Highland, Hillside, and Terrace. The Chehalis Land and Timber Company was organized in 1888 and, for the next quarter of a century it platted and promoted the townsite. This company was responsible for developing large tracts of commercial and residential real estate including much of the Hillside Historic District. The original investors in the land company included Noah B. Coffman, John Dobson, Francis Donahoe, David C. Millett, and William M. Urquhart. This group not only controlled the area's real estate, they also dominated political life with four out of five members serving as mayor and filling other civic roles. Their addition included land on most of Northeast Adams Avenue, Jefferson Avenue, and half of Northeast Washington Avenue. In 1888 and 1889 the Chehalis Land and Timber Company platted the north-east section of the Hillside Historic District. The company named the five major streets of the new residential neighborhood after the first five presidents of the United States, perhaps out of patriotism connected with statehood (1889) for Washington Territory. The southern portion of the Hillside Historic District was platted by members of the company between 1905 and 1910. The hilly terrain of Terrace was platted in the 1920s.

Born in Lewis County in 1855 William Muir Urquhart was the son of a Scottish immigrant. His father settled and platted the present nearby town of Napavine and owned a General Merchandise store in 1873. After his twenty-six year old brother died William Muir Urquhart Jr. took over his Chehalis branch of the store, serving the thirty inhabitants of the city. He became leading general merchant in town and served as vice-president of the Coffman Dobson Bank. In 1906 he retired from the store to care for his properties and attend to his official duty as director of the band and original member of its organization. His civic roles in the community throughout his lifetime included being one of the incorporators of the Chehalis Land and Timber Company, postmaster for seven years, member of the school board, councilman, mayor, and county treasurer. His land included parts of Southeast Adams and over half of Southeast Washington Avenues.

O.B. McFadden was born in Pennsylvania and in 1853 and was appointed territorial judge by President Franklin Pierce. In 1858 President Buchanan promoted him to chief justice. He resided in Vancouver while serving, until 1861 when he purchased three hundred twenty acres of the southeastern portion of Schuyler Saunders' land. His log cabin was built shortly after his purchase of land and is still in use on Chehalis Avenue

United States Department of the Interior
National Park Service

National Register of Historic Places
Continuation Sheet

Section number 8 Page 3
Name of Property Hillside Historical District
County and State Lewis County, WA

and is listed in the National Register. One of O. B. McFadden's many contributions to the Chehalis community was raising \$1,000 from the state to construct a courderoy road of cedar logs through the wet lands to make travel possible through the rainy seasons. He also petitioned the territorial legislature to move the county seat from Claquato to Chehalis. O. B. McFadden died in the 1870s and in 1905 the Chehalis Land and Timber Company acquired his land and platted it. His land included the other section of Southeast Washington Avenue. Born in 1857, N. B. Coffman moved from Indiana to Illinois where he attended the University of Illinois, then studied and practiced law. He opened a practice in Nebraska but after a few months entered the Exchange Bank as a cashier. In 1883 he moved to Tacoma where he worked in the first bank in town. In 1884 he came to Chehalis and opened the private banking business of Coffman and Allen with C. H. Allen. He practiced law at the same time but the business of banking soon occupied more of his time. After a few years Mr. Allen died leaving Coffman sole proprietor. In 1889 the bank took out a national charter. Under this charter his associates became John Dobson, Francis Donahoe, William Urquhart, and Daniel C. Millett. They surrendered the national charter but the associates remained the same. N. B. Coffman's father was one of the organizers of the Republican party. N. B. Coffman was also a Republican and was one of the delegates from Washington to the national Republican convention that nominated McKinley. With his associates Mr. Coffman platted and sold much of the city of Chehalis and laid out and joined in donating the city's parks. In his lifetime he was a founder of the Citizen's Club (later renamed as the Chamber of Commerce), the treasurer of the Episcopal church in western Washington; fraternally he was a Knight Templar.

Prior to 1893 there were several houses scattered along the hill. In the first two decades of the twentieth century the Citizen's Club advertised the benefits of Lewis County at the Alaska-Yukon-Pacific Exposition which had a national audience. Elaborate brochures were prepared and a pitch was made to capitalists to bring new industry to Chehalis. In 1912 one newspaper reported that the efforts of the Citizen's Club had brought half a dozen industries with substantial payrolls to the area. Between 1850 and 1950 Chehalis developed from a rural townsite with a few homesteads to an agricultural and wood processing center of over 5,600 residents. During this time the city center shifted twice with much of the present urban form established by 1920. The third city center is located on Market Avenue and Boistford, just one block downhill from Washington Avenue, a large part of the Hillside Historical District. The city center was shifted in 1892 after two disasterous fires in the same year.

United States Department of the Interior
National Park Service

National Register of Historic Places
Continuation Sheet

Section number 8 Page 4
Name of Property Hillside Historical District
County and State Lewis County, WA

In early Chehalis the population consisted mainly of Caucasians of British and German ancestry who came from the midwestern United States and California and Oregon. Until 1920 the number of men was more than women. The three largest population increases occurred between 1875 when the population was 100, and 1883 when it increased to 700. From 700 in 1883 the population jumped to 1,309 in 1890, a smaller increase but still significant. And the final major population increase occurred between 1900 when it was 1,775 and 1910 when the number of residents grew to 4,507. These population increases correspond with the building spurts on the hillside, where approximate dates of construction are highest prior to 1893, prior to 1912, and around 1928.

One article in the Chehalis Bee-Nugget printed November 7, 1913 announces the pavement of Washington Avenue and the beautification of the ". . . most beautiful, convenient and slightly residence street to be found in any city in the southwest Washington . . ." newly opened to the public. The article predicts the construction of ". . . many attractive homes in that section of Chehalis inside the next two or three years."

The Hillside District is not composed strictly of large homes owned by wealthy families, nor does it strictly contain small modest homes. It is a combination of both, with a lot of variation in between. Property owner occupations ranged from bartender to department store owner, mill worker to mayor, and candy maker to jewelry store owner. This variety in social and economic classes merged to form a livable neighborhood that is a true representation of society, with a mixed socioeconomic neighborhood working together. There is a contrast among these houses which reflects the different people which contributed to the district. There are members of pioneer families such as the Coffmans and Urquharts as well as "newcomers." Lot sizes vary as some of the wealthier families purchased multiple lots, such as the lot upon which the Rush Home was originally placed; and there are also tiny lots where small millworker housing is found on Washington Avenue.

Today just as when the area first began to grow, there is still a mixture of wealthy and lower economic classes throughout the district. Some of the houses are perfectly maintained while others are lacking in upkeep, a reality of most historic neighborhoods.

NPS Form 10-900-a
OMB No. 1024-0018
(8-86)

United States Department of the Interior
National Park Service

National Register of Historic Places
Continuation Sheet

Section number 9 Page 1
Name of Property Hillside Historical District
County and State Lewis County, WA

BIBLIOGRAPHY

Blumenson, John J.-G. Identifying American Architecture: A Pictorial Guide to Styles & Terms 1600-1945. American Association for State and Local History: Nashville, TN, 1977.

Burgett, Jas, Personal Interview, July 1995.

Chehalis Bee-Nugget, November 7, 1913, "Activity on Washington Avenue."

Chehalis Bee-Nugget: Historical Souvenir Edition, May 14, 1915, pages 21, 32, 37, 38.

Historic Downton Chehalis: A Public Guide, Chehalis, Washington.

Historical Inventory Forms, 1979.

Hunt, Nelson E., Phone Interview, 1995.

Inventory of Historic Resources: Chehalis, WA, Department of Community Services, City of Chehalis Washington, 1987.

Lewis County Advocate, June 24, 1953, Obituary for Morris S. Burnett.

McAlester, Virginia & Lee, A Field Guide to American Houses, Alfred A. Knopf: New York, 1984

Pennsylvania Avenue - West Side Historic District: Chehalis, Washington, National Register Form MPD.

Pennsylvania Avenue - West Side: National Historic District: A Public Guide, Chehalis, WA.

Polk's Chehalis Directories 1907 through present, R. L. Polk & Company, Kansas City, MO.

NPS Form 10-900-a
OMB No. 1024-0018
(8-86)

United States Department of the Interior
National Park Service

**National Register of Historic Places
Continuation Sheet**

Section number 9 Page 2
Name of Property Hillside Historical District
County and State Lewis County, WA

Sanborn Fire Insurance Maps, 1893, 1896, 1912, 1924.

St. Helen's Club Chehalis, A History of Chehalis, Bicentennial Edition 1976.

Terrace research done by Doris Tibitts, neighborhood resident and local store owner.

Washington State Office of Historic Preservation Historic Property Inventory Forms.

Weyeneth, Robert, Multiple Property Nomination: State of Historic Context on Urban Growth in Chehalis between 1850 and 1950.

NPS Form 10-900-a
OMB No. 1024-0018
(8-86)

United States Department of the Interior
National Park Service

**National Register of Historic Places
Continuation Sheet**

Section number 10 Page 1
Name of Property Hillside Historical District
County and State Lewis County, WA

VERBAL BOUNDARY JUSTIFICATION

The Chehalis Hillside District is bound by all the streets featuring properties included in the proposed district. These streets are Washington Avenue and Adams Avenue from Division to Eleventh, extending northeast to southeast. The other streets moving up the hill including Cascade Avenue, Hillside, Terrace and Jefferson Avenues are also included because of the historical significance of the architecture represented on these streets.



United States Department of the Interior
National Park Service

National Register of Historic Places
Continuation Sheet

Section number 11 Page 1
Name of Property Hillside Historical District
County and State Lewis Countv. WA

PHOTO #	ADDRESS	PHOTO FACING
1	185 NE Division	south
2	280 NE Cascade	northeast
3	555 NE Jefferson Ave.	west
4	556 NE Washington Ave.	east
5	472 NE Washington Ave.	east
6	438 NE Washington Ave.	east
7	402 NE Washington Ave.	east
8	177 NE Washington Ave.	west
9	200 NE Washington Ave.	east
10	126 NE Washington Ave.	east
11	78 NE Washington Ave.	east
12	26 NE Washington Ave.	east
13	145 NE Washington Ave.	west
14	170 NE Washington Ave.	east
15	280 SE Washington Ave.	east
16	431 SE Washington Ave.	west
17	507 SE Washington Ave.	west
18	622 SE Washington Ave.	east
19	722 SE Washington Ave.	east
20	742 SE Washington Ave.	east
21	1079 SE Washington Ave.	west
22	540 NE Adams Ave.	east
23	502 NE Adams Ave.	east
24	703 SE Adams Ave.	west
25	956 SE Adams Ave.	east
26	1024 SE Adams Ave.	east
27	1098 SE Adams Ave.	east
28	272 NE Terrace	east
29	272 NE Terrace	north
30	171 NE Terrace	west
31	279 NE Hillside	west

North

-  Contributing
-  Non Contributing
-  Photograph Views and Numbers
- 1234 Numbered Properties indicate Property Addresses

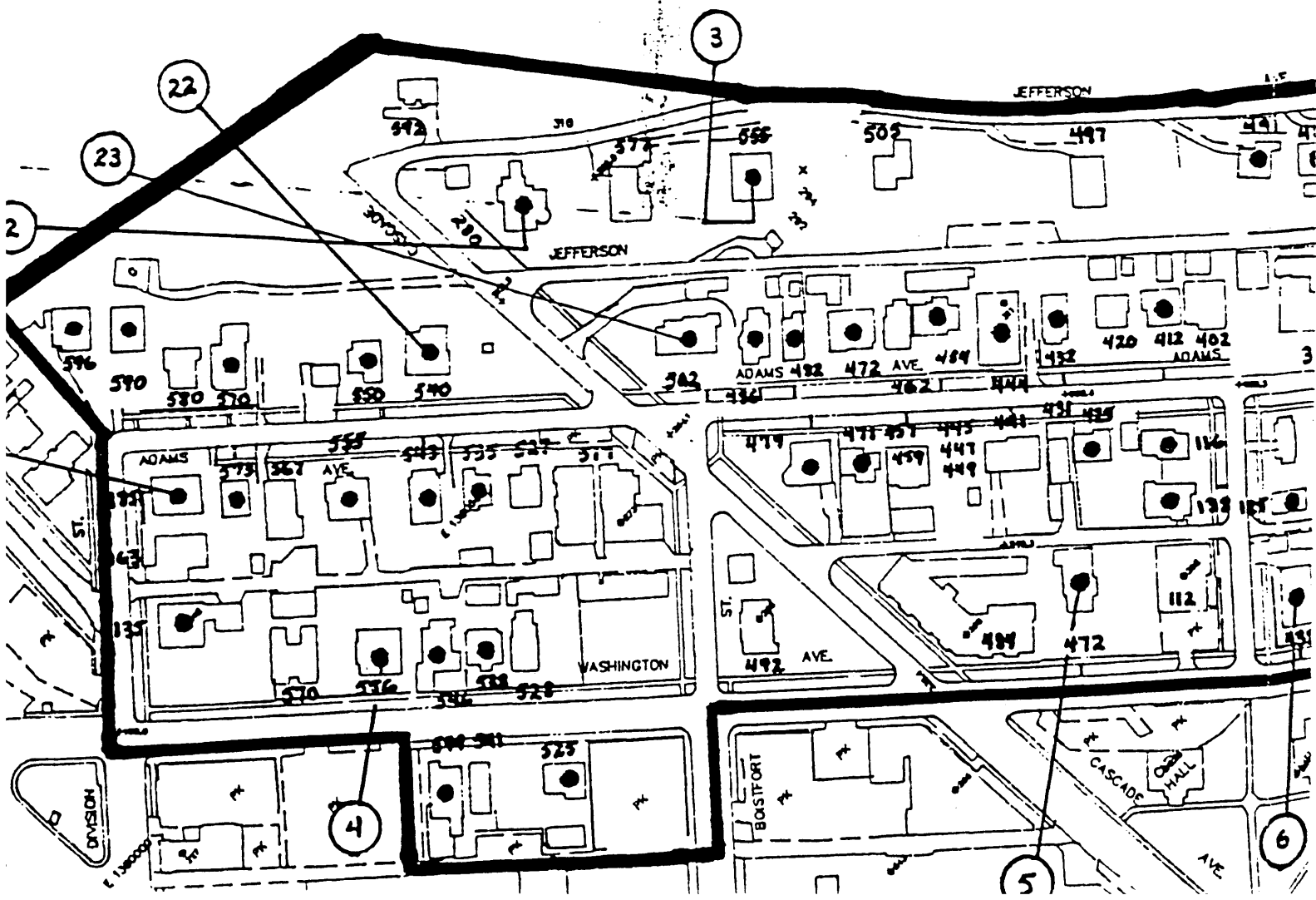

scrs
ite

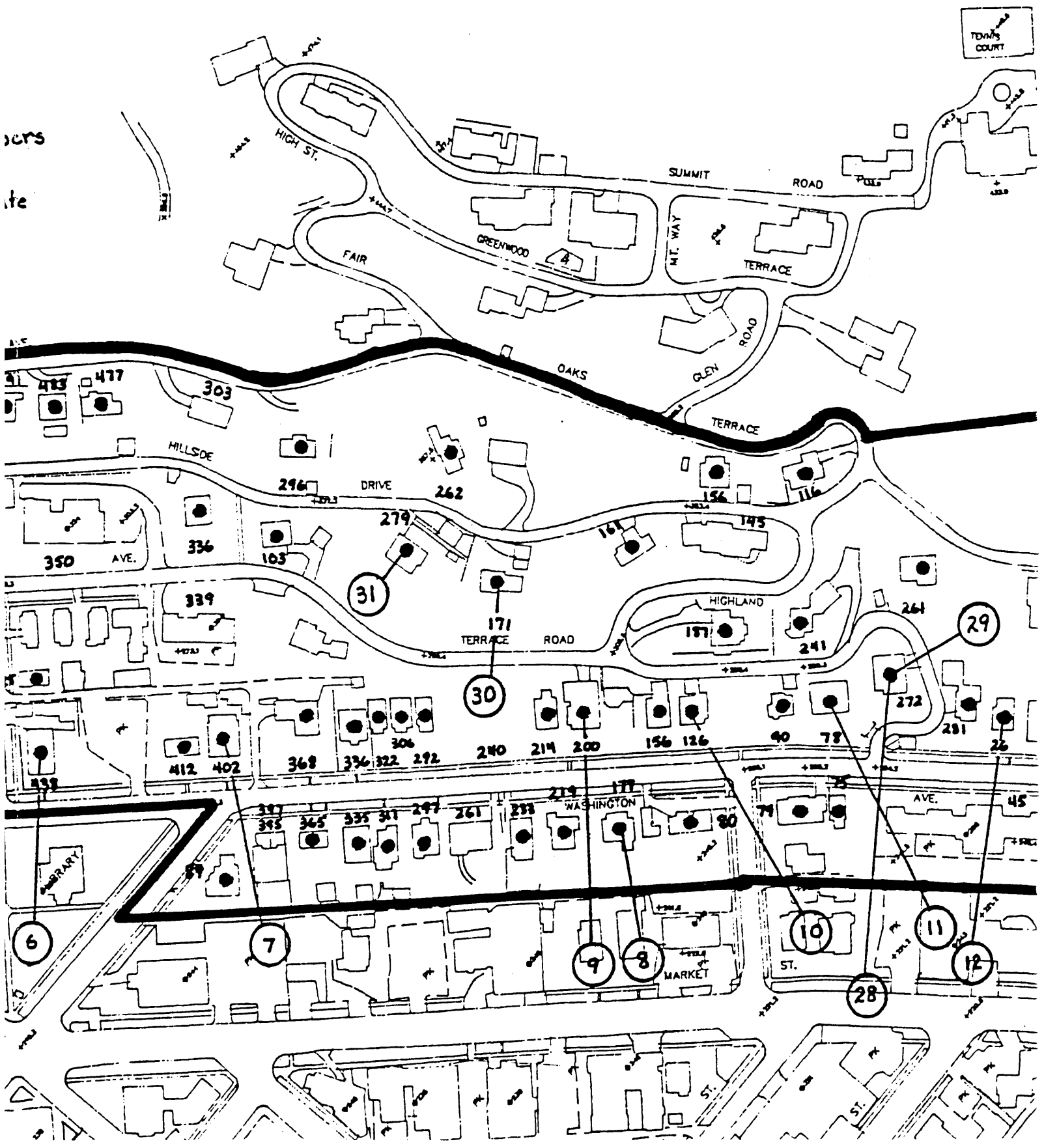

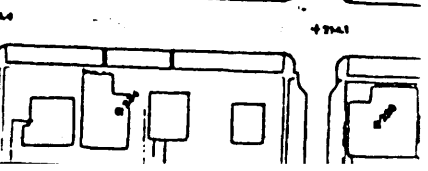
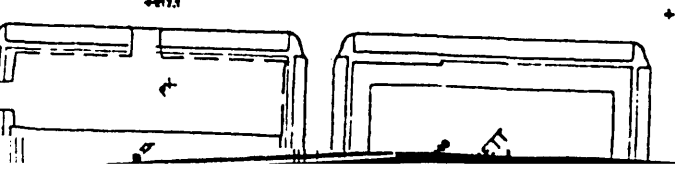
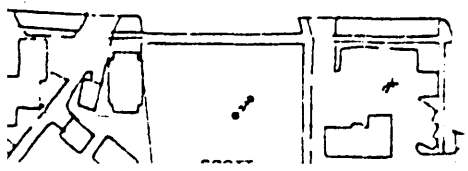
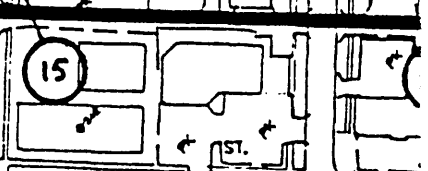
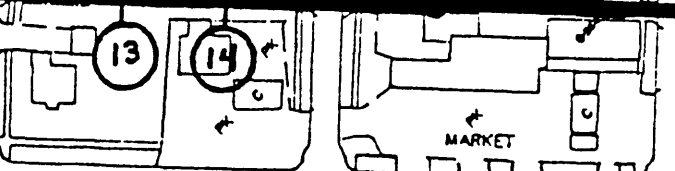
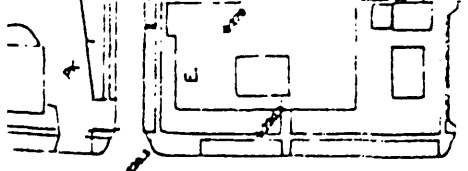
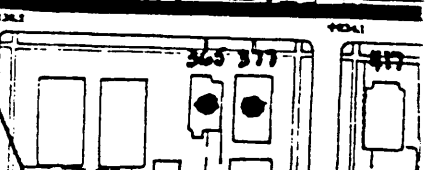
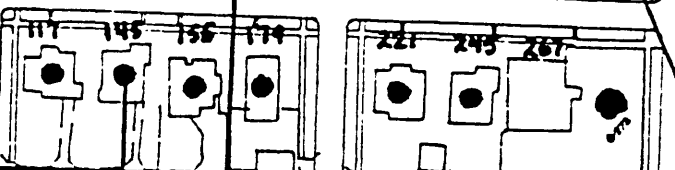
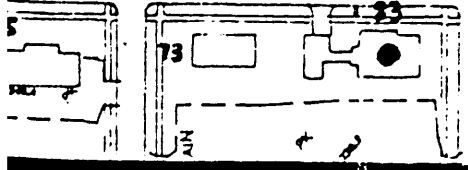
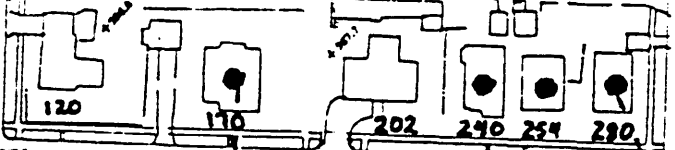
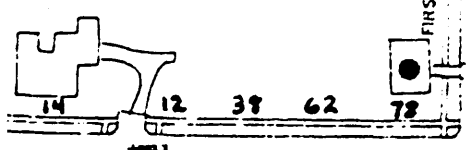
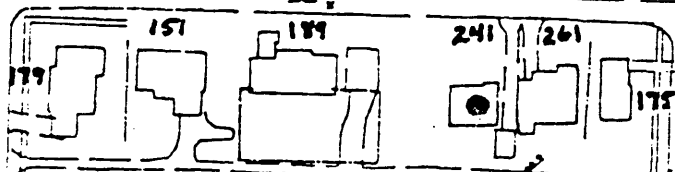
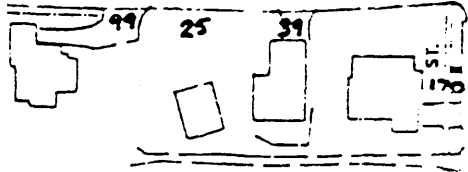
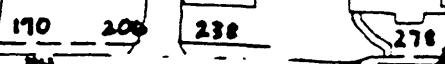
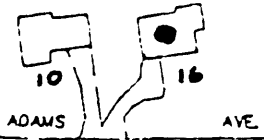
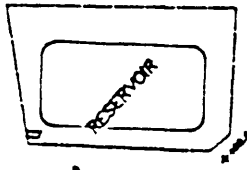
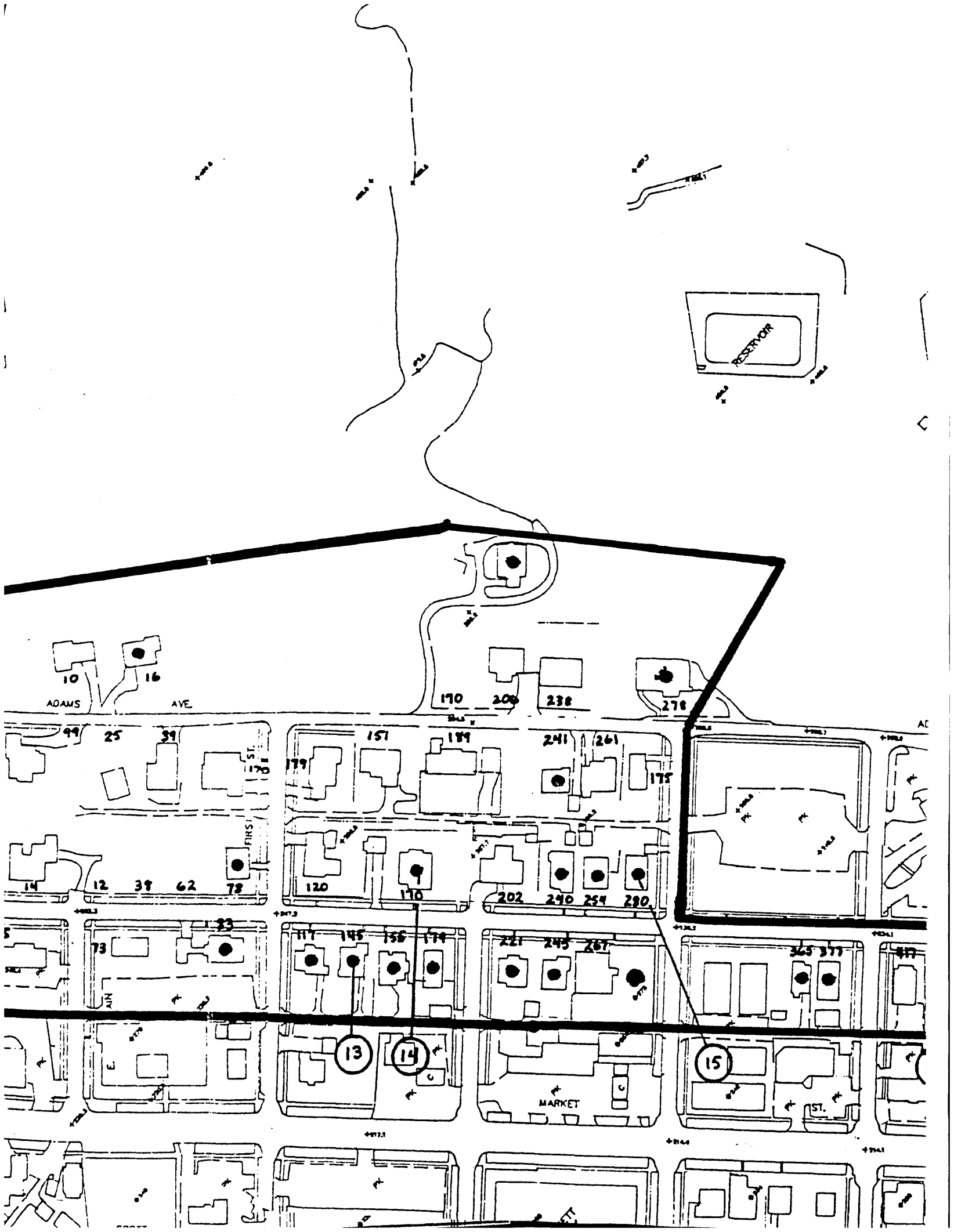

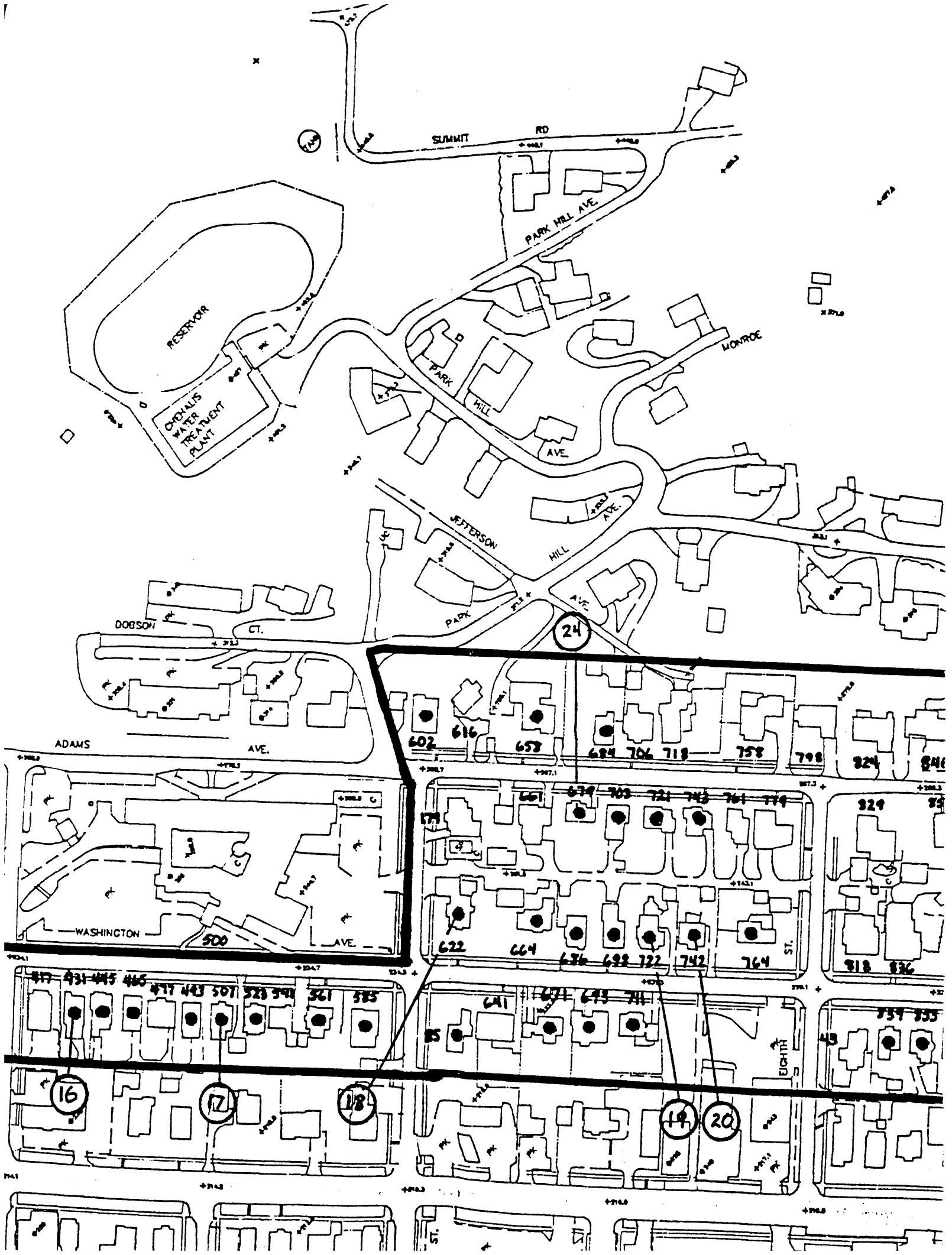

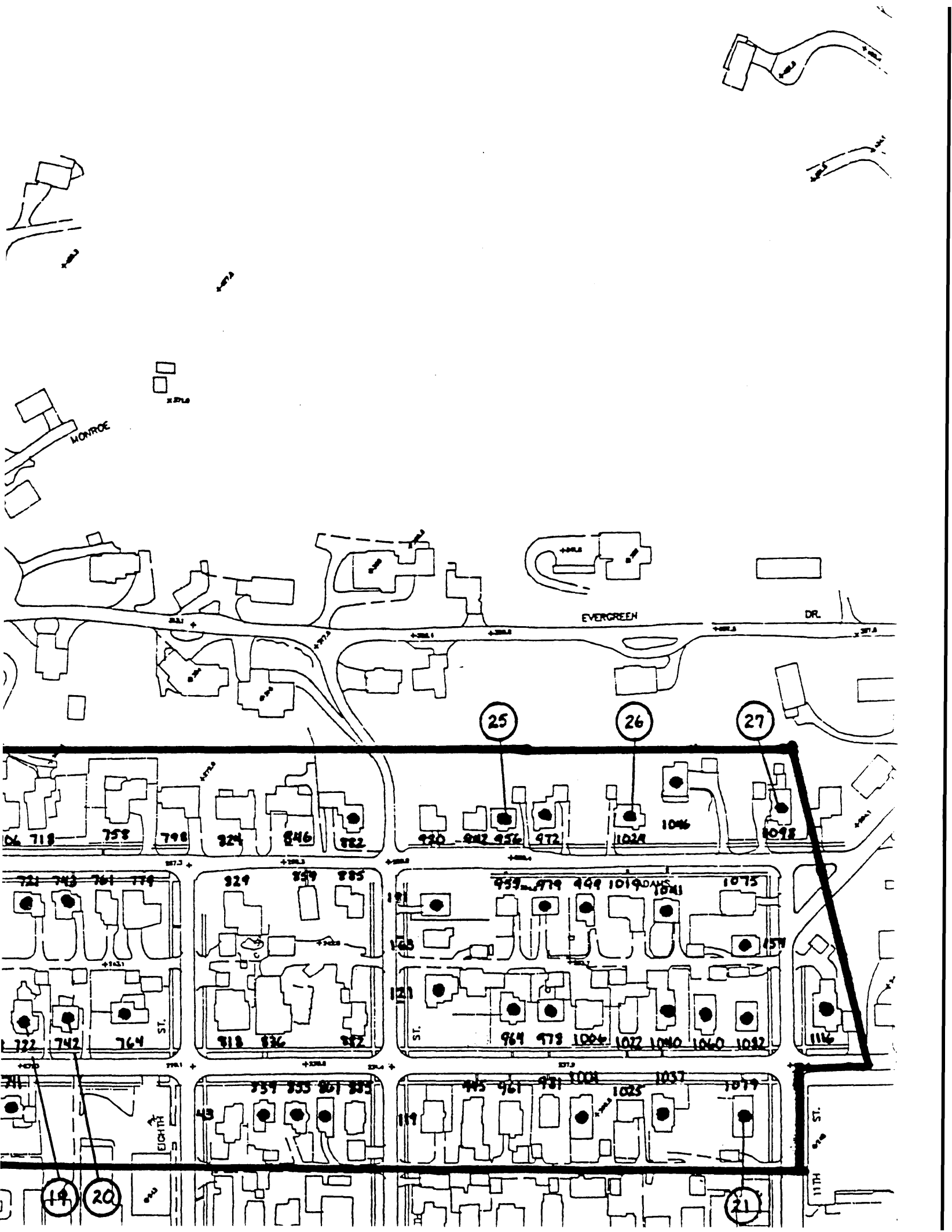

MONROE

EVERGREEN

DR.

25

26

27

19

20

21

EIGHTH

11TH

