

DEC 28 1988 DEC 28

3258

KENTUCKY HISTORIC RESOURCES
Individual Inventory Form

Resource # Be-38
Boone County

1. Name of Resource: Ryle's Super Market and Oddfellows Building

2. Original Owner: Berkshire family

3. Other Names: Hitzfield's Store; Berkshire's Store

4. Prehistoric Site Building Object
Historic Site Structure Other

5. Location: 6571 Tanner Street
Petersburg, KY

6. Owner's Name: Katherine Ryle []

7. Owner's Address: 6571 Tanner Street
Petersburg, KY 41080

8. Evaluation: National Register []

9. Recognition & Date:
Nat.Landmark _____ Local Landmark _____
Nat.Register _____ HABS/HAER _____
Highway Marker _____ KY Inventory 1977
KY Landmark Certificate

10. N.R.Status & Date:

11. N.R.Group:
District Name: []
Mult.Resource Area: Boone County []
Thematic Name: []

12. Historical Theme:
Primary: Commerce []
Secondary: Architecture []
Other: []

13. Statement of Significance:
This property is significant under criterion C and A as a good representative of small-town commercial development in the county in the period 1870-1930 and as a good example of vernacular commercial architecture in Boone County in the early 20th century (1900-1930). []

16. Date: Original Building 1913* []
Addition []

17. Style: No academic style []

18. Architect/Builder: unknown

19. No. of Stories: two []

20. Original Floor Plan: one room, each floor []

21. Single Pile Double Pile N.A.

22. Roof Form & Material: Original
hip asphalt shingles Not Original

23. Structural Material: brick []

24. Exterior Material: common bond brick []

25. Foundation Material: stone []

26. Major Alterations: None
Moved/Rebuilt Other
Additions

27. Special Features: original grocery store interior

28. Outbuildings: none []

29. Original Function: commercial (grocery) []

30. Present Use: commercial (grocery store) []

31. Condition: excellent []

32. Endangered: Yes
No

33. Attach Photos: Roll: 2 Photo Nos: 26 No. of Slides:
17 6 & 7

14. History:
The first floor of the building has always been used as a grocery store, operated by the Ryles since 1944, by the Hitzfields for the previous 20 years, and by the Berkshires before then. The bricks for the building came from the Boone County Distillery in Petersburg.

15. Source of historical information and/or contact person:
*owner; stone plaque

34. Prepared by: Kenneth T. Gibbs

35. Organization: Boone Co.Hist.Pres.Rev.Brd.

36. Date: September 1986

37. New Survey _____ Resurvey

KENTUCKY HISTORIC RESOURCES
 Individual Inventory Form

Resource # Be-38

38. UTM Point of Primary Building: Zone Easting Northing 39. G.I.S. Mod. []
 Quadrant: Lawrenceburg J6 684220 4326380 40. Coordi.Accuracy []

41. UTM Points of Boundary (for N. R. eligible sites only):

A.	---	---	---	D.	---	---	---
B.	---	---	---	E.	---	---	---
C.	---	---	---	F.	---	---	---

42. Total Acreage in Present Property: 0.096 43. Acreage included in proposed N.R. boundary: 0.096

44. Site Plan (and boundary description and justification for N.R. sites):

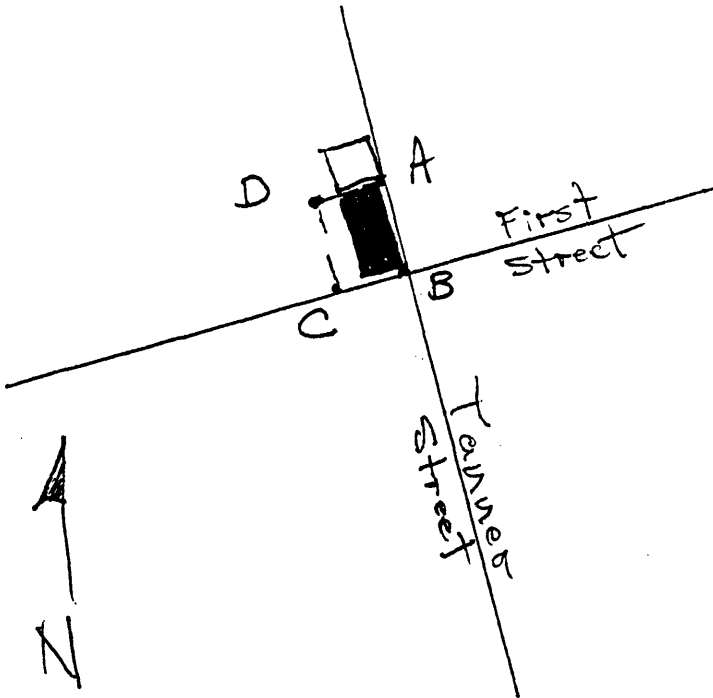

The nominated property is the east 60 feet of city lot 58. The boundary includes the building and the part of the city lot associated with the building. A contiguous building on the north is unrelated historically, under separate ownership, and is not included in the boundaries. Boundary A-B is on the west side of Tanner Street, and boundary B-C is on the north side of First Street.

Contributing: 1 building

45. Description and House Plan:

Simple in form and execution, this building consists of a rectangular two-story block under an overhanging hipped roof. The functional arrangement and type of openings in the first floor convey the commercial use, while the only indication that the second story was for a fraternal organization is a commemorative stone over the central pair of windows, reading "IOOF 1913." The lintels are of stone, and the cornice and a horizontal band above the first floor openings on the main front, both of vaguely classical profile, are of metal. Historical photo in the possession of the owner shows no alterations since the building's construction (except for a raised stone planter installed across the main front).

Not only has the main front remained unaltered, but the interior as well is unchanged. It consists of a single rectangular room with the original pressed tin ceiling and an elaborate pressed tin cove cornice, supported by six slender iron supports. The checkout counter has always been at the east end of the building, beneath the pair of small, high windows. The west end is partitioned for storage and butcher areas, reached by a service door at the western end of the main front.

The building abuts a one-story garage to the west, but there is no connection either by use or ownership between the two buildings.

KENTUCKY HISTORIC RESOURCES
Individual Inventory Form

Resource # Be-38
Boone County

1. Name of Resource: Ryle's Super Market and Oddfellows Building

2. Original Owner: Berkshire family

3. Other Names: Hitzfield's Store; Berkshire's Store

4. Prehistoric Site Building Object
Historic Site Structure Other

5. Location: 6571 Tanner Street
Petersburg, KY

6. Owner's Name: Katherine Ryle []

7. Owner's Address: 6571 Tanner Street
Petersburg, KY 41080

8. Evaluation: National Register []

9. Recognition & Date:
Nat.Landmark _____ Local Landmark _____
Nat.Register _____ HABS/HAER _____
Highway Marker _____ KY Inventory 1977
KY Landmark Certificate _____

10. N.R.Status & Date:

11. N.R.Group:
District Name: []
Mult.Resource Area: Boone County []
Thematic Name: []

12. Historical Theme:
Primary: Commerce []
Secondary: Architecture []
Other: []

13. Statement of Significance:
This property is significant under criterion C and A as a good representative of small-town commercial development in the county in the period 1870-1930 and as a good example of vernacular commercial architecture in Boone County in the early 20th century (1900-1930). []

16. Date: Original Building 1913* []
Addition []

17. Style: No academic style []

18. Architect/Builder: unknown

19. No. of Stories: two []

20. Original Floor Plan: one room, each floor []

21. Single Pile Double Pile N.A.

22. Roof Form & Material: Original
hip asphalt shingles Not Original

23. Structural Material: brick []

24. Exterior Material: common bond brick []

25. Foundation Material: stone []

26. Major Alterations: None
Moved/Rebuilt Other
Additions

27. Special Features: original grocery store interior

28. Outbuildings: none []

29. Original Function: commercial (grocery) []

30. Present Use: commercial (grocery store) []

31. Condition: excellent []

32. Endangered: Yes
No

33. Attach Photos: Roll: 2 Photo Nos: 26 No. of Slides:
17 6 & 7

14. History:
The first floor of the building has always been used as a grocery store, operated by the Ryles since 1944, by the Hitzfields for the previous 20 years, and by the Berkshires before then. The bricks for the building came from the Boone County Distillery in Petersburg.

15. Source of historical information and/or contact person:
*owner; stone plaque

34. Prepared by: Kenneth T. Gibbs

35. Organization: Boone Co.Hist.Pres.Rev.Brd.

36. Date: September 1986

37. New Survey _____ Resurvey

KENTUCKY HISTORIC RESOURCES
 Individual Inventory Form

Resource # Be-38

38. UTM Point of Primary Building: Zone Easting Northing 39. G.I.S. Mod. []
 Quadrant: Lawrenceburg J6 684220 4326380 40. Coordi.Accuracy []

41. UTM Points of Boundary (for N. R. eligible sites only):

A.	---	---	---	D.	---	---	---
B.	---	---	---	E.	---	---	---
C.	---	---	---	F.	---	---	---

42. Total Acreage in Present Property: 0.096 43. Acreage included in proposed N.R. boundary: 0.096

44. Site Plan (and boundary description and justification for N.R. sites):

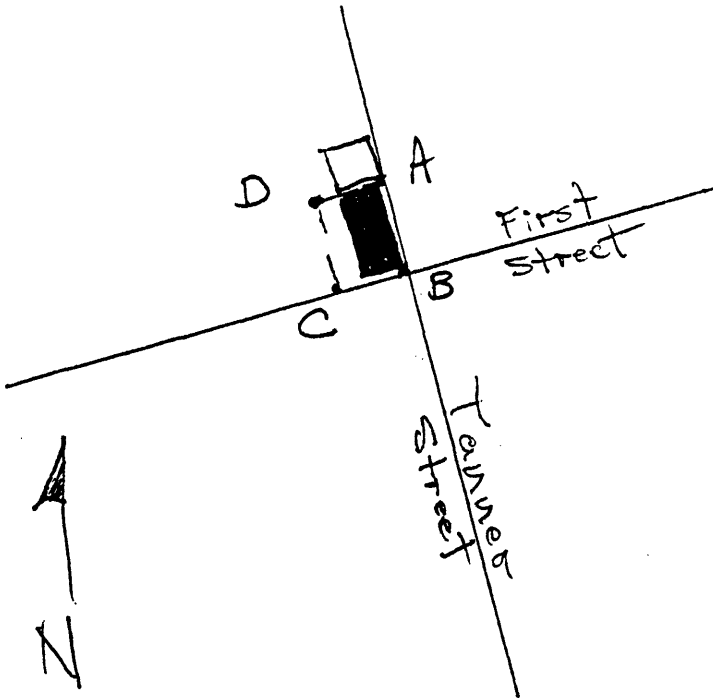

The nominated property is the east 60 feet of city lot 58. The boundary includes the building and the part of the city lot associated with the building. A contiguous building on the north is unrelated historically, under separate ownership, and is not included in the boundaries. Boundary A-B is on the west side of Tanner Street, and boundary B-C is on the north side of First Street.

Contributing: 1 building

45. Description and House Plan:

Simple in form and execution, this building consists of a rectangular two-story block under an overhanging hipped roof. The functional arrangement and type of openings in the first floor convey the commercial use, while the only indication that the second story was for a fraternal organization is a commemorative stone over the central pair of windows, reading "IOOF 1913." The lintels are of stone, and the cornice and a horizontal band above the first floor openings on the main front, both of vaguely classical profile, are of metal. Historical photo in the possession of the owner shows no alterations since the building's construction (except for a raised stone planter installed across the main front).

Not only has the main front remained unaltered, but the interior as well is unchanged. It consists of a single rectangular room with the original pressed tin ceiling and an elaborate pressed tin cove cornice, supported by six slender iron supports. The checkout counter has always been at the east end of the building, beneath the pair of small, high windows. The west end is partitioned for storage and butcher areas, reached by a service door at the western end of the main front.

The building abuts a one-story garage to the west, but there is no connection either by use or ownership between the two buildings.