

United States Department of the Interior  
National Park Service

For NPS use only

National Register of Historic Places  
Inventory—Nomination Form

received AUG 5 1985

date entered SEP 5 1985

See instructions in *How to Complete National Register Forms*  
Type all entries—complete applicable sections

1. Name

historic Thankful Baptist Church

and/or common same

2. Location

street & number 935 Spiderwebb Drive

N/A not for publication

city, town Rome

N/A vicinity of

state Georgia

code 013

county Floyd

code 115

3. Classification

Category	Ownership	Status	Present Use
<input type="checkbox"/> district	<input type="checkbox"/> public	<input checked="" type="checkbox"/> occupied	<input type="checkbox"/> agriculture
<input checked="" type="checkbox"/> building(s)	<input checked="" type="checkbox"/> private	<input type="checkbox"/> unoccupied	<input type="checkbox"/> commercial
<input type="checkbox"/> structure	<input type="checkbox"/> both	<input type="checkbox"/> work in progress	<input type="checkbox"/> educational
<input type="checkbox"/> site	<b>Public Acquisition</b>	<b>Accessible</b>	<input type="checkbox"/> entertainment
<input type="checkbox"/> object	<input checked="" type="checkbox"/> N/A in process	<input checked="" type="checkbox"/> yes: restricted	<input type="checkbox"/> government
	<input type="checkbox"/> being considered	<input checked="" type="checkbox"/> yes: unrestricted	<input type="checkbox"/> industrial
		<input type="checkbox"/> no	<input type="checkbox"/> military
			<input type="checkbox"/> museum
			<input type="checkbox"/> park
			<input type="checkbox"/> private residence
			<input checked="" type="checkbox"/> religious
			<input type="checkbox"/> scientific
			<input type="checkbox"/> transportation
			<input type="checkbox"/> other:

4. Owner of Property

name Thankful Baptist Church c/o Reverend O.B. Yates

street & number 935 Spiderwebb Drive

city, town Rome

N/A vicinity of

state Georgia 30161

5. Location of Legal Description

courthouse, registry of deeds, etc. Superior Court

street & number Floyd County Courthouse

city, town Rome

state Georgia

6. Representation in Existing Surveys

Historic Structures Field Survey:

title Floyd County

has this property been determined eligible?  yes  no

date 1977

federal  state  county  local

depository for survey records Georgia Department of Natural Resources

city, town Atlanta

state Georgia

## 7. Description

<b>Condition</b>		<b>Check one</b>	<b>Check one</b>
<input type="checkbox"/> excellent	<input type="checkbox"/> deteriorated	<input type="checkbox"/> unaltered	<input checked="" type="checkbox"/> original site
<input checked="" type="checkbox"/> good	<input type="checkbox"/> ruins	<input checked="" type="checkbox"/> altered	<input type="checkbox"/> moved date _____
<input type="checkbox"/> fair	<input type="checkbox"/> unexposed		

### Describe the present and original (if known) physical appearance

Thankful Baptist Church, constructed in 1881, is a Gothic-style brick church, sited on a small hill landscaped with grass and trees. It is located northeast of Rome's Central Business District at the intersection of Gibbons Street and Spiderwebb Drive.

The south front facade has three bays, separated by stepped wall buttresses, an occular shaped window above the central portal, and a bell tower with spire on the southeast corner. The east and west facades have seven bays, separated by stepped wall buttresses. All of the stained glass windows have lancet arches and hood moldings. Other exterior details include a shingle metal roof with board-and-batten siding, and wood-framed cornices, eaves, and windows.

The plan of the historic church consists of the narthex and the sanctuary. The interior of the sanctuary has original wooden pews and stained glass windows, plaster walls with wood paneled wainscoting, a pressed-metal central ceiling, and posts with exposed framing in the nave arcade. The wall behind the pulpit is original. The 1976 renovation of the church consisted of sanding and refinishing the original pews, adding a new HVAC system, sandblasting of the exterior brick, remodeling of the narthex, pastor's study, and ladies room which included the lowering of ceilings, the addition of wood paneling and carpeting. The pulpit area was also remodeled and wall paintings at the rear of the sanctuary and rear of the narthex were added.

Other structures on the church property (but not on the nominated property) are the brick annex and church office which date from the early 1960s. The church office, which is detached from the historic church building, was used as a parsonage until the early 1980s.

The boundary of the nominated property is comprised of the historic church building and its surrounding landscape. It includes Gibbons Street to the west, Spiderwebb Drive to the south, the west side of the concrete drive and sidewalk on the east, and the brick retaining wall on the rear (north). It does not include the modern, detached church office or annex.

Thankful Baptist Church is one of few historic structures in the area, and it is surrounded by a mixture of commercial, fast-food establishments, and undeveloped properties.



## 9. Major Bibliographical References

Jaeger, Dale. "Thankful Baptist Church - Historic Property Information Form". August, 1984. (On file at the Historic Preservation Section, Georgia Department of Natural Resources).

## 10. Geographical Data

Acree of nominated property less than 1 acre

Quadrangle name Rome North, GA

Quadrangle scale 1:24000

### UTM References

A 

1	6	6	6	9	4	4	10	3	7	9	2	2	2	0
Zone	Easting			Northing										

B 

1	6	6	6	9	5	2	0	3	7	9	2	0	0	0
Zone	Easting			Northing										

C 

1	6	6	6	9	3	0	10	3	7	9	2	0	0	0
Zone	Easting			Northing										

D 

Zone	Easting			Northing										

E 

Zone	Easting			Northing										

F 

Zone	Easting			Northing										

G 

Zone	Easting			Northing										

H 

Zone	Easting			Northing										

### Verbal boundary description and justification

The boundary of the nominated property is indicated by a heavy black line on the enclosed "property/sketch map" and is justified in Section 7.

### List all states and counties for properties overlapping state or county boundaries

state	code	county	code
N/A			

state	code	county	code
-------	------	--------	------

## 11. Form Prepared By

name/title Andrea Niles, Survey and Research Specialist

organization Georgia Department of Natural Resources date 7-3-85

street & number 270 Washington Street SW telephone 404/656-2840

city or town Atlanta state Georgia

## 12. State Historic Preservation Officer Certification

The evaluated significance of this property within the state is:

national  state  local

As the designated State Historic Preservation Officer for the National Historic Preservation Act of 1966 (Public Law 89-665), I hereby nominate this property for inclusion in the National Register and certify that it has been evaluated according to the criteria and procedures set forth by the National Park Service.

State Historic Preservation Officer signature

*Elizabeth A. Lyon*  
Elizabeth A. Lyon

title Deputy State Historic Preservation Officer

date 7/11/85

### For NPS use only

I hereby certify that this property is included in the National Register

Entered in the  
National Register

date 9/5/85

*for [Signature]*  
Keeper of the National Register

Attest:

date

Chief of Registration

# THANKFUL BAPTIST CHURCH

ROME, GEORGIA  
SKETCH MAP

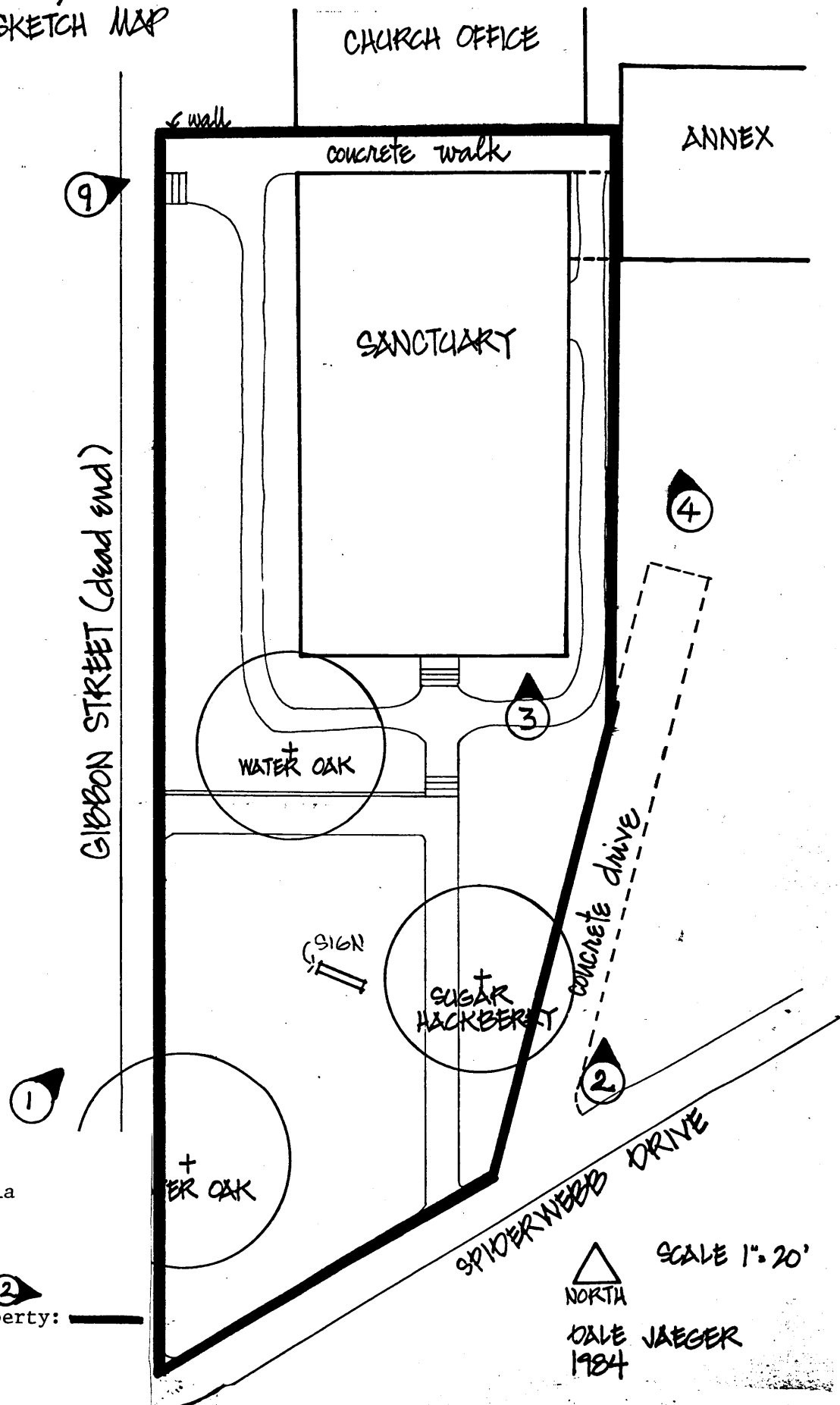

Thankful Baptist Church  
Rome, Floyd County, Georgia

Property/Sketch Map:  
Scale: 1 inch = 20 feet  
Direction of photograph: ②  
Boundary of nominated property: ———  
North: ↑

SCALE 1" = 20'  
NORTH  
DALE JAEGER  
1984

# THANKFUL BAPTIST CHURCH

ROME, GEORGIA  
FLOORPLAN

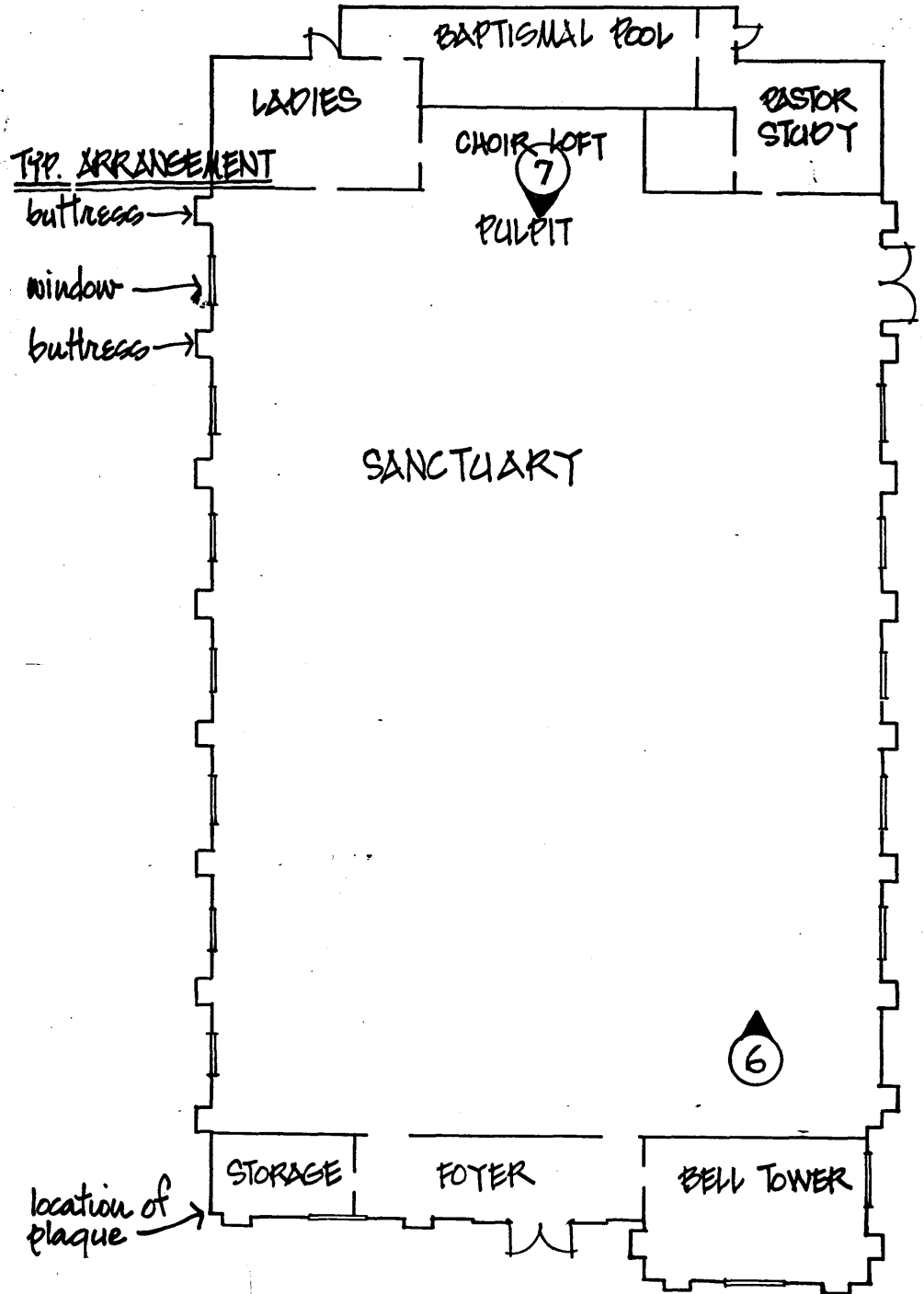

Thankful Baptist Church  
Rome, Floyd County, Georgia

Interior Plan:

Scale: 1 inch = 20 feet

Direction of photograph: (2)

North:



SCALE 1"=10'

DALE JAEGER  
1984