

DATA SHEET

Form 10-300
(Rev. 6-72)

UNITED STATES DEPARTMENT OF THE INTERIOR
NATIONAL PARK SERVICE

NATIONAL REGISTER OF HISTORIC PLACES INVENTORY - NOMINATION FORM

(Type all entries - complete applicable sections)

STATE: Louisiana
COUNTY: West Feliciana
FOR NPS USE ONLY
ENTRY DATE MAR 17 1975

1. NAME

COMMON:
Cottage Plantation

AND/OR HISTORIC:
Cottage Plantation

2. LOCATION

STREET AND NUMBER:
Cottage Lane on U. S. 61 north of St. Francisville

CITY OR TOWN:
St. Francisville

CONGRESSIONAL DISTRICT:
8th John Rarick

STATE: Louisiana CODE: 22 COUNTY: West Feliciana CODE: I25

3. CLASSIFICATION

CATEGORY (Check One)	OWNERSHIP	STATUS	ACCESSIBLE TO THE PUBLIC
<input type="checkbox"/> District <input checked="" type="checkbox"/> Building <input type="checkbox"/> Site <input type="checkbox"/> Structure <input type="checkbox"/> Object	<input type="checkbox"/> Public <input checked="" type="checkbox"/> Private <input type="checkbox"/> Both	Public Acquisition: <input type="checkbox"/> In Process <input type="checkbox"/> Being Considered	<input checked="" type="checkbox"/> Occupied <input type="checkbox"/> Unoccupied <input type="checkbox"/> Preservation work in progress
PRESENT USE (Check One or More as Appropriate)			
<input checked="" type="checkbox"/> Agricultural <input checked="" type="checkbox"/> Commercial <input type="checkbox"/> Educational <input type="checkbox"/> Entertainment	<input type="checkbox"/> Government <input type="checkbox"/> Industrial <input type="checkbox"/> Military <input type="checkbox"/> Museum	<input type="checkbox"/> Park <input type="checkbox"/> Private Residence <input type="checkbox"/> Religious <input type="checkbox"/> Scientific	<input type="checkbox"/> Transportation <input checked="" type="checkbox"/> Other (Specify) <u>Tourist Attraction</u>

4. OWNER OF PROPERTY

OWNER'S NAME:
Mr. and Mrs. J.E. Brown

STREET AND NUMBER:
631 Drexel Avenue

CITY OR TOWN:
Clencoe,

STATE:
Illinois

5. LOCATION OF LEGAL DESCRIPTION

COURTHOUSE, REGISTRY OF DEEDS, ETC.:
Courthouse, West Feliciana Parish

STREET AND NUMBER:

CITY OR TOWN:
St. Francisville

STATE:
Louisiana

CODE:
22

6. REPRESENTATION IN EXISTING SURVEYS

TITLE OF SURVEY:
Writers' Program of the Work Projects Administration

DATE OF SURVEY: 1941 Federal State County Local

DEPOSITORY FOR SURVEY RECORDS:
Library of Congress

STREET AND NUMBER:

CITY OR TOWN:
Washington

STATE:
D.C.

CODE:

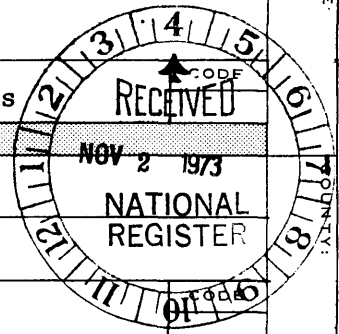

SEE INSTRUCTIONS

STATE: COUNTY: ENTRY NUMBER: DATE: FOR NPS USE ONLY

7 DESCRIPTION

CONDITION	(Check One)					
	<input checked="" type="checkbox"/> Excellent	<input type="checkbox"/> Good	<input type="checkbox"/> Fair	<input type="checkbox"/> Deteriorated	<input type="checkbox"/> Ruins	<input type="checkbox"/> Unexposed
	(Check One)			(Check One)		
	<input checked="" type="checkbox"/> Altered	<input type="checkbox"/> Unaltered	<input type="checkbox"/> Moved	<input checked="" type="checkbox"/> Original Site		

DESCRIBE THE PRESENT AND ORIGINAL (if known) PHYSICAL APPEARANCE

The Cottage Plantation is located on U. S. Highway 61, six miles north of St. Francisville, Louisiana, on the east side of the road. It stands complete as it did in ante-bellum days, having in addition to the plantation home the old school house, outside kitchen, milk house, carriage house, barn, slave houses, and other out buildings. The house is furnished with much of the original furniture.

The Cottage Plantation is located on land secured by John Allen and Partrick Holland by Spanish Land grant in 1795, and acquired by Judge Thomas Butler about 1800.

Low, rambling, with an exceptionally long front gallery, the main house is composed of a series of buildings joined together, erected from 1795 to 1859, with the core, or original structure, from the Spanish colonial era.

The house consists of two buildings in the form of an L with the original house as part of the foot of the L. The original house was about 42 feet in length, and it was extended to 85 feet in the very early 1800's. The extension copied the architecture of the original building so that it appears to be one structure. The roof at the rear of the house was raised in the early 1800's to provide a gallery running the length of the house and it copied the front of the house.

The last section of the house to be built was the great wing, or the side of the L, 65 feet long, whose front gallery adjoins the back gallery of the original building. A unique feature in its construction is that the whole length of the cornice is pierced by a series of louvers, serving the double purpose of ventilating and keeping the glare off the gallery.

The Cottage is completely built of virgin cypress, except the massive sills (16 x 16 inches) which are of blue poplar. All of the pillars on the galleries are hand wrought, as is the exterior and interior woodwork. There are twelve square rooms in the main house and four in the wing. The rooms in the main section of the house open onto the gallery through door-windows with stationary shutters. Every room is furnished with a handcarved fireplace mantle, some of extreme simplicity and others elaborate with fluted Doric columns and panels in a sunburst design.

The roof of cypress weatherboarding is broken by second-floor dormer windows.

The dependencies are all of wood construction, generally cypress and wherever located in the yard have shingled roofs.

School house: 14 ft. by 26 ft. with 8 ft. overhanging roof on west side, 6 ft. gallery on north side, 2 rooms each with fireplace. In the days when the building was used as a school, one room was the school room and the other the tutor's bedroom.

Milk House: 12 ft. 3 in. square, in this building milk from the plantation dairy was processed into milk, cream, butter, etc.

Kitchen: 30 ft. 3 in. x 18 ft. 6 in., contains two rooms, one the kitchen, the other the laundry. Massive fireplaces rear extending 7 ft. 8 in. from the building.

Greenhouses: 2 in number, of brick construction, 12 ft. 8 in. wide and 20 ft. in length.

Cistern Sheds: 2 in number, roof supported by corner posts and are 10 feet square.

SEE INSTRUCTIONS

**NATIONAL REGISTER OF HISTORIC PLACES
INVENTORY - NOMINATION FORM**

(Continuation Sheet) Page 1

STATE	
Louisiana	
COUNTY	
West Feliciana	
FOR NPS USE ONLY	
ENTRY NUMBER	DATE
	MAR 17 1975

(Number all entries)

7. Description (cont'd)

Carriage Barn: 20 ft. 4 in. wide, 30 ft. long with overhanging shed on east side extending 18 ft.

Horse Barn: 2 ft. 6 in. wide, 32 ft. 6 in. long with overhanging sheds on east and west sides each extending 10 ft. 8 in.

Slave Cabins: 3 in number, each containing 2 rooms, fireplace in each room, 32 ft. 6 in. long.

Cemetery: Walled, 40 ft. x 55 ft.

Smokehouse: 15 ft. 3 in. wide by 15 ft. 2 in. in length.

Utility House: 20 ft. 3 inches square, contains four rooms, as follows: Saddle or tack room, Commissary for plantation workers, room for storage of dishes and items for the dining room, Lumber room for storage of trunks, suitcases and traveling equipment.



8. SIGNIFICANCE

PERIOD (Check One or More as Appropriate)

- | | | | |
|--|---------------------------------------|--|---------------------------------------|
| <input type="checkbox"/> Pre-Columbian | <input type="checkbox"/> 16th Century | <input checked="" type="checkbox"/> 18th Century | <input type="checkbox"/> 20th Century |
| <input type="checkbox"/> 15th Century | <input type="checkbox"/> 17th Century | <input checked="" type="checkbox"/> 19th Century | |

SPECIFIC DATE(S) (If Applicable and Known)

Spanish Land Grant 1795

AREAS OF SIGNIFICANCE (Check One or More as Appropriate)

- | | | | |
|--|--|---|--|
| <input type="checkbox"/> Aboriginal | <input type="checkbox"/> Education | <input checked="" type="checkbox"/> Political | <input type="checkbox"/> Urban Planning |
| <input type="checkbox"/> Prehistoric | <input type="checkbox"/> Engineering | <input type="checkbox"/> Religion/Philosophy | <input checked="" type="checkbox"/> Other (Specify) |
| <input type="checkbox"/> Historic | <input type="checkbox"/> Industry | <input type="checkbox"/> Science | <u>Complete working plantation as it existed in early 1800's</u> |
| <input type="checkbox"/> Agriculture | <input type="checkbox"/> Invention | <input type="checkbox"/> Sculpture | |
| <input checked="" type="checkbox"/> Architecture | <input checked="" type="checkbox"/> Landscape Architecture | <input type="checkbox"/> Social/Humanitarian | |
| <input type="checkbox"/> Art | <input type="checkbox"/> Literature | <input type="checkbox"/> Theater | |
| <input type="checkbox"/> Commerce | <input type="checkbox"/> Military | <input type="checkbox"/> Transportation | |
| <input type="checkbox"/> Communications | <input type="checkbox"/> Music | | |
| <input type="checkbox"/> Conservation | | | |

STATEMENT OF SIGNIFICANCE

The Cottage Plantation has practically all of the original outbuildings or dependencies remaining in good condition, therefore, constitutes a complete working plantation just as it was in the early 1800's.

The plantation contains the main house; the School House, which was at one time the law office for Judge Thomas Butler, the first Criminal Court judge of the Florida Parishes and a member of Congress; the outside kitchen; a smoke house; and the utility house containing saddle and harness room, commissary, china storage room, and lumber room. Also on the grounds are two green houses, a carriage barn, a horse barn and three slave cabins.

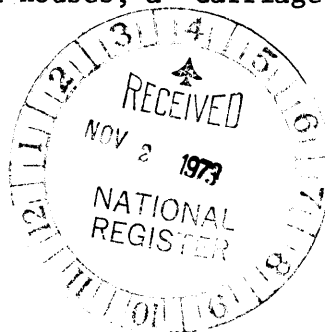

SEE INSTRUCTIONS

9. MAJOR BIBLIOGRAPHICAL REFERENCES

The Felicianas of Louisiana - Miriam G. Reeve, Baton Rouge, La. Claitor's Bookstore 1967.
 A Treasure of Louisiana Plantation Homes - J. Wesley Cooper Philadelphia, Penn. Edward Stern and Co., Inc., 1961.
 Beau Sejour - Ben Earl Looney, Baton Rouge: Claitor's Publishing Division 1972.
 Biographical Directory of the American Congress 1774-1927, U. S. Government Printing Office, 1927.

029 P1413
 006 P1413/081 259/5135
 007 P1413/011 259/513N
 038 P1413/064 559/51MS
 SW 15/655 490/341388C

10. GEOGRAPHICAL DATA

LATITUDE AND LONGITUDE COORDINATES DEFINING A RECTANGLE LOCATING THE PROPERTY				O R	LATITUDE AND LONGITUDE COORDINATES DEFINING THE CENTER POINT OF A PROPERTY OF LESS THAN TEN ACRES							
CORNER	LATITUDE				LONGITUDE			LATITUDE			LONGITUDE	
	Degrees	Minutes	Seconds	Degrees	Minutes	Seconds	Degrees	Minutes	Seconds	Degrees	Minutes	Seconds
NW	30°	51'	24"	91°	22'	26"						
NE	30°	51'	24"	91°	20'	48"						
SE	30°	50'	58"	91°	20'	48"						
SW	30°	50'	58"	91°	22'	26"						

APPROXIMATE ACREAGE OF NOMINATED PROPERTY: 519 acres

LIST ALL STATES AND COUNTIES FOR PROPERTIES OVERLAPPING STATE OR COUNTY BOUNDARIES

STATE:	CODE	COUNTY	CODE
STATE:	CODE	COUNTY:	CODE
STATE:	CODE	COUNTY:	CODE
STATE:	CODE	COUNTY:	CODE

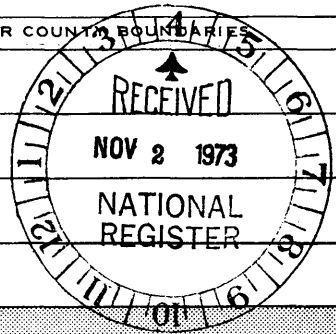

SEE INSTRUCTIONS

11. FORM PREPARED BY

NAME AND TITLE:
J. E. Brown

ORGANIZATION: _____ DATE: _____

STREET AND NUMBER:
631 Drexel Avenue

CITY OR TOWN: **Glencoe** STATE: **Illinois** CODE: _____

12. STATE LIAISON OFFICER CERTIFICATION

As the designated State Liaison Officer for the National Historic Preservation Act of 1966 (Public Law 89-665), I hereby nominate this property for inclusion in the National Register and certify that it has been evaluated according to the criteria and procedures set forth by the National Park Service. The recommended level of significance of this nomination is:

National State Local

Name: Jay R. Brown
 Title: State Historic Preservation Officer
Director, Department of Art,
Historical and Cultural
Preservation

Date: October 31, 1973

NATIONAL REGISTER VERIFICATION

I hereby certify that this property is included in the National Register.

AR Winters
 Director, Office of Archeology and Historic Preservation

Date: 3/17/75

ATTEST:
Charles H. Henry
 Keeper of The National Register

Date: 3-14-75

**NATIONAL REGISTER OF HISTORIC PLACES
INVENTORY - NOMINATION FORM**

(Continuation Sheet)

STATE Louisiana	
COUNTY West Feliciana	
FOR NPS USE ONLY	
ENTRY NUMBER	DATE
	MAR 17 1975

(Number all entries)

8. Significance

Thomas Butler 1785-1847

Butler, Thomas, a representative from Louisiana; born near Carlisle, Cumberland County, Pa., April 14, 1785; attended the common schools and received a College education in Pittsburgh, Pa.; studied law, was admitted to the bar in 1806, and commenced practice at Pittsburgh, Pa.; moved to Mississippi Territory about 1807; Captain of a cavalry troop in the Mississippi Territory Militia in 1810; purchased land in the Parish of Feliciana, Orleans Territory, and settled there in 1811; appointed Parish Judge December 14, 1812; appointed Judge of the Third District by Gov. Claiborne of Louisiana, March 4, 1813; elected to the Fifteenth Congress to fill the vacancy caused by the resignation of Thomas B. Robertson, reelected to the Sixteenth Congress, and served from November 15, 1818 to March 3, 1821; unsuccessful candidate for nomination in 1820; appointed special judge of the third judicial district ward affiliated with the American Party; owing to ill health declined to be a candidate for Congress in 1844; owner of twelve sugar and cotton plantations; president of the board of trustees of the Louisiana College, Jackson, La., member of the Pennsylvania Society of the Cincinnati; died in St. Louis, Missouri, August 7, 1848; interment on his plantation, "The Cottage" near St. Francisville, West Feliciana Parish, Louisiana.

Biographical Directory of the American Congress 1774-1927, page 770.

Very little information was found on the Butler property known as The Cottage except that it was considered their home. Most of the available information concerned other property owned by the Butlers which was considered to be investments.

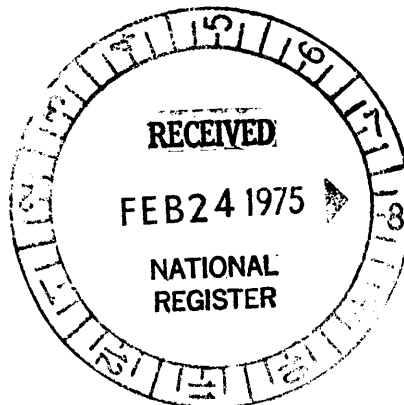

UNITED STATES DEPARTMENT OF THE INTERIOR
NATIONAL PARK SERVICE

**NATIONAL REGISTER OF HISTORIC PLACES
INVENTORY -- NOMINATION FORM**

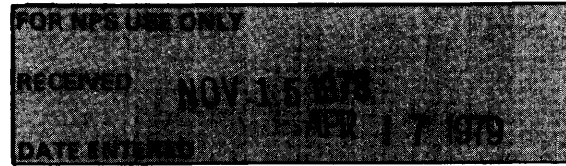

CONTINUATION SHEET

ITEM NUMBER 8 PAGE 5

NOTES

¹Andrea M. Mattei, "Women on the Plantation," (Honors Thesis, Mount Holyoke College, 1976), 1, hereinafter cited as Mattei, "Women on the Plantation."

²Mattei, "Women on the Plantation," 2-3, 84; Edwin A. Davis, Louisiana: A Narrative History, 3rd. ed. (Baton Rouge: Claitor's Publishing Co., 1971), 197; William K. Dart, The Louisiana Judicial System (N.p.: Bobbs-Merril, 1917), 59-60.

³Census of 1830, Louisiana, West Feliciana Parish, Population Schedule, p. 329; Mattei, "Women on the Plantation," 85; Alcee Fortier, Louisiana Vol. 2 (N.p.: Century Historical Association, 1914), 140.

⁴Census of 1860, Louisiana, West Feliciana Parish, Population Schedule, p. 28; Joseph K. Menn, The Large Slaveholders of Louisiana--1860 (New Orleans: Pelican Publishing Co., 1964), 228-229 hereinafter cited as Menn, Large Slaveholders of Louisiana; Mattei, "Women on the Plantation," 86.

⁵Menn, Large Slaveholders of Louisiana, 226-267, 331-332.

⁶Mattei, "Women on the Plantation," 85; Census of 1870, Louisiana, West Feliciana Parish, Population Schedule, p. 59.

⁷Census of 1870, Louisiana, West Feliciana Parish, Agriculture Census, p. 1.

⁸For elaboration on the Mathews women as plantation managers, see Mattier, "Women on the Plantation." There is a copy of this work with the Mathews Family Papers in the Department of Archives and Manuscripts, LSU Library, Baton Rouge.

UNITED STATES DEPARTMENT OF THE INTERIOR
NATIONAL PARK SERVICE

**NATIONAL REGISTER OF HISTORIC PLACES
INVENTORY -- NOMINATION FORM**

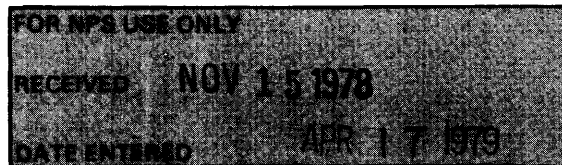

CONTINUATION SHEET

ITEM NUMBER 9 PAGE 2

- Census of 1830. Louisiana, West Feliciana Parish: Population Schedule.
- Dart, William K. The Louisiana Judicial System. N.p.: Bobbs-Merrill, 1917.
- Davis, Edwin A. Louisiana: A Narrative History, 3rd. ed., Baton Rouge: Claitor's Publishing Co., 1971.
- Fortier, Alcee. Louisiana. Vol. 2. N.p.: Century Historical Association, 1914.
- Mathews Family Papers. Department of Archives and Manuscripts, LSU Library, Baton Rouge.
- Mattei, Andrea M. "Women on the Plantation." Honors Thesis, Mount Holyoke College, 1976.
- Menn, Joseph K. The Large Slaveholders of Louisiana--1860. New Orleans: Pelican Publishing Co., 1964.
- Watts, Charles. "Discourse on the Life and Character of the Hon. George Mathews." Louisiana Historical Quarterly, Vol. 4 (April 1921): 189-200.



SECTION A-A

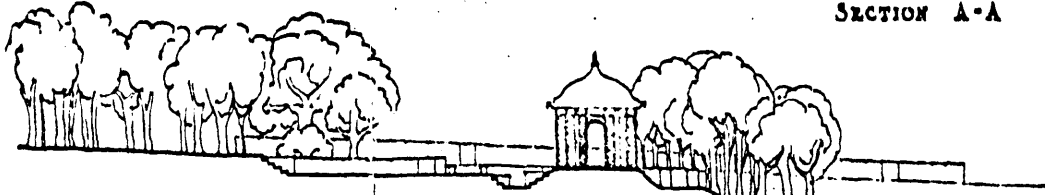

SECTION B-B

PLAN AND SECTIONS OF
BOX GARDEN
SCALE: 1/16" = 1'-0"

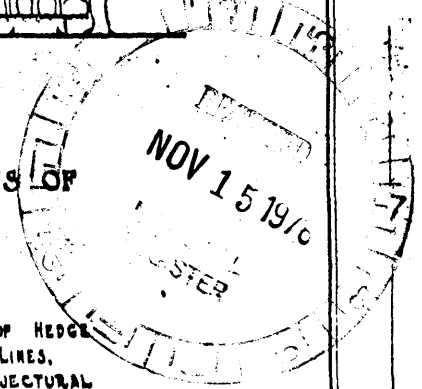

NOTE - EXISTING PORTIONS OF HEDGE
SHOWN WITH HATCHED LINES.
THE REMAINDER IS CONJECTURAL

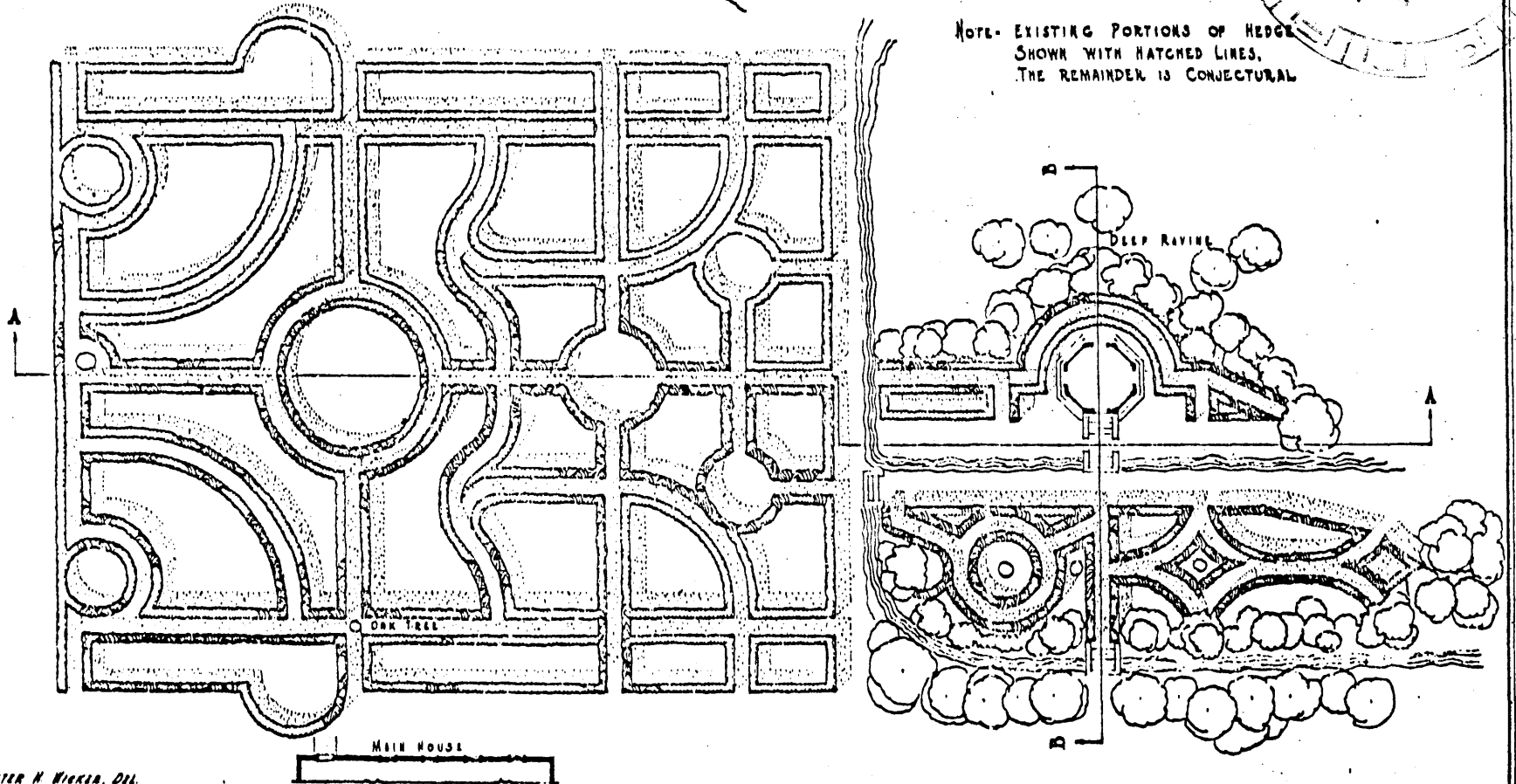

CHESTER H. WICKER, Dtl.

WORK PROJECTS ADMINISTRATION
OFFICIAL PROJECT NO 166-1-64-106
UNDER DIRECTION OF UNITED STATES DEPARTMENT OF THE INTERIOR
NATIONAL PARK SERVICE, BRANCH OF PLANS AND DESIGN

GREENWOOD PLANTATION
(VENTRESS)

NAME OF STRUCTURE

BAINS
WEST FELICIANA PARISH, LA.

SURVEY NO
LA-16
JUNE 23, 1941

HISTORIC AMERICAN
BUILDINGS SURVEY
SHEET 4 OF 4 SHEETS

UNIVERSITY OF MICHIGAN
LIBRARY

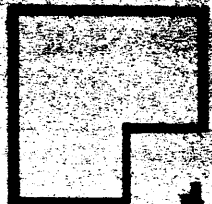

← OLD KITCHEN

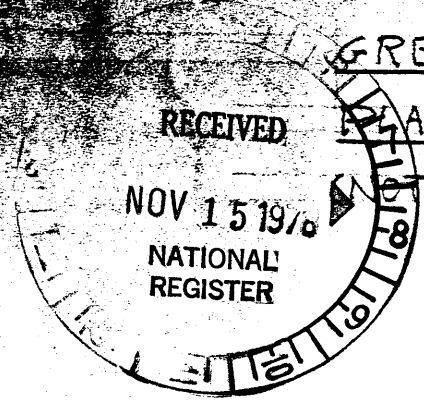

GREENWOOD
PLANTATION

(NOT TO SCALE)

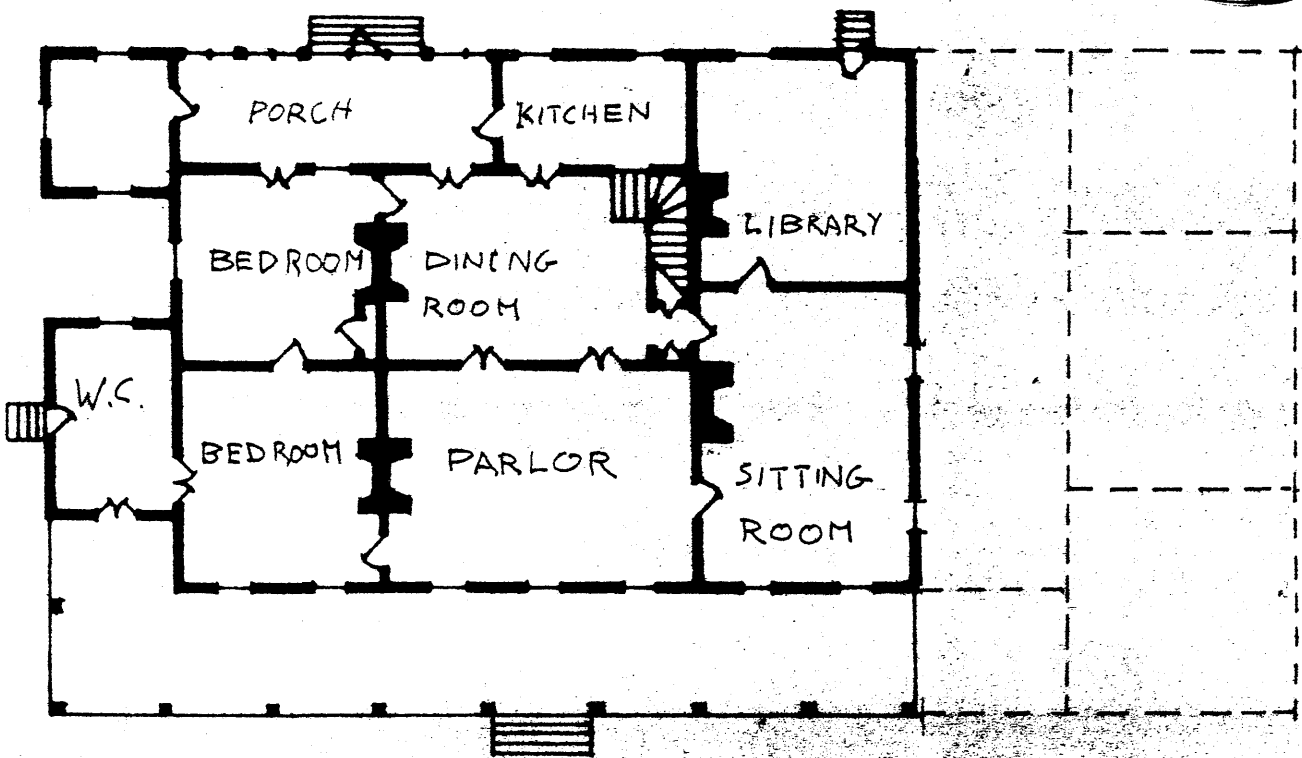

WING ADDED IN 1850'S
RECENTLY DEMOLISHED



FIRST FLOOR

PRESENT GALLERY BUILT
IN THE 1850'S

GAZEBO
(LOCATION APPROXIMATE)

