

**NATIONAL REGISTER OF HISTORIC PLACES
INVENTORY - NOMINATION FORM**

(Type all entries - complete applicable sections)

STATE: Minnesota	
COUNTY: Chisago	
FOR NPS USE ONLY	
ENTRY NUMBER	DATE
	APR 11 1972

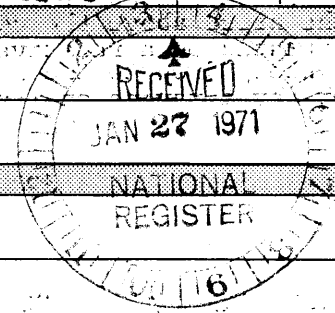

1. NAME

COMMON:
Angel's Hill Historic District

AND/OR HISTORIC:
Angel's Hill

2. LOCATION

STREET AND NUMBER:

CITY OR TOWN:
Taylors Falls

STATE: Minnesota

CODE 27	COUNTY: Chisago	CODE 025
------------	--------------------	-------------

3. CLASSIFICATION

CATEGORY (Check One)	OWNERSHIP	STATUS	ACCESSIBLE TO THE PUBLIC
<input checked="" type="checkbox"/> District <input type="checkbox"/> Site <input type="checkbox"/> Building <input type="checkbox"/> Structure <input type="checkbox"/> Object	<input type="checkbox"/> Public <input checked="" type="checkbox"/> Private <input type="checkbox"/> Both	<input checked="" type="checkbox"/> Occupied <input type="checkbox"/> Unoccupied <input checked="" type="checkbox"/> Preservation work in progress	Yes: <input checked="" type="checkbox"/> Restricted <input type="checkbox"/> Unrestricted <input type="checkbox"/> No
PRESENT USE (Check One or More as Appropriate)			
<input type="checkbox"/> Agricultural <input type="checkbox"/> Commercial <input type="checkbox"/> Educational <input type="checkbox"/> Entertainment	<input type="checkbox"/> Government <input type="checkbox"/> Industrial <input type="checkbox"/> Military <input checked="" type="checkbox"/> Museum	<input type="checkbox"/> Park <input checked="" type="checkbox"/> Private Residence <input checked="" type="checkbox"/> Religious <input type="checkbox"/> Scientific	<input type="checkbox"/> Transportation <input type="checkbox"/> Other (Specify)

4. OWNER OF PROPERTY

OWNER'S NAME:
Multiple

STREET AND NUMBER:

CITY OR TOWN: STATE: CODE

5. LOCATION OF LEGAL DESCRIPTION

COURTHOUSE, REGISTRY OF DEEDS, ETC.:
Chisago County Courthouse

STREET AND NUMBER:

CITY OR TOWN: STATE: CODE

Center City Minnesota 27

6. REPRESENTATION IN EXISTING SURVEYS

TITLE OF SURVEY:
Historic American Buildings Survey (W.H.C. Folsom House & First Methodist Church)

DATE OF SURVEY: 1934 Federal State County Local

DEPOSITORY FOR SURVEY RECORDS:
Library of Congress

STREET AND NUMBER:

CITY OR TOWN: STATE: CODE

Washington D.C. 001

SEE INSTRUCTIONS

STATE: Minnesota	FOR NPS USE ONLY
COUNTY: Chisago	
ENTRY NUMBER APR 11 1972	DATE

7. DESCRIPTION

CONDITION	(Check One)				
	<input type="checkbox"/> Excellent	<input checked="" type="checkbox"/> Good	<input type="checkbox"/> Fair	<input type="checkbox"/> Deteriorated	<input type="checkbox"/> Ruins
	(Check One)			(Check One)	
	<input checked="" type="checkbox"/> Altered	<input type="checkbox"/> Unaltered	<input type="checkbox"/> Moved	<input checked="" type="checkbox"/> Original Site	

DESCRIBE THE PRESENT AND ORIGINAL (if known) PHYSICAL APPEARANCE

Angel's Hill is said to have originally been a derisive term applied by a flamboyant resident to that area clustered around the Methodist Church on one of the hills above the commercial district of Taylors Falls. The neighborhood is situated on a relatively flat bench, isolated from the rest of the village by a steep drop to the river and Interstate Park on the east and south perimeter, by a ravine on its north edge through which Chisago County road #20 drops down into the business district, and by an as yet undeveloped, rocky but tree covered ridge rising steeply to the west. The neighborhood is bisected by the remains of the old Government Road that once linked St. Paul with Lake Superior.

The locations of all the buildings in the district are noted on the attached site plan. Those of significance are numbered and described below.

1. Schottmuller Brewery c. 1856. Three story wood frame with low hipped roof. Clapboard. Set into the hill for immediate access to beer storage caves. Currently being restored for use as store and residence.

2. Village Jail. Date unknown. One story wood frame with attic. Now used as ice storage house. Bars in upper window are evidence of its original use.

3. First School House and Community Center. 1852. One story. Clapboard. Wood frame. Greek Revival. Now altered to serve as village maintenance garage. Original cupola removed. Building moved from across the street.

4. W.H.C. Folsom House, 1854-55. Two story, clapboard sided, wood frame. Distinguished by the unusually delicate treatment of its front porches, the Federal style details at the frames of the French doors opening onto the porches, and the louvered fan lights in the pediments. The house is otherwise Greek Revival in style. Except for the later portico at the main entrance, and for kitchen and bathroom revisions, the house is essentially unaltered. Occupied by the Folsom family until its recent acquisition by the Minnesota Historical Society, it is now a museum dedicated to Folsom, one of early Minnesota's foremost lumbermen, developers, historicans, and legislators.

5. First Methodist Church, 1861. Wood frame, clapboard sided on the side and rear elevation. Topped by a small domed bell tower. The wider, flat horizontal boards appearing only on the front elevation, perhaps to give the illusion of stone, are interrupted by four massive pilasters, tapered such that they are wider at the base than at the modest capital. The building is typical of the small meeting houses recalled by its New England born parishioners. Unaltered except for dropped ceiling, window revisions and new basement. One of the finest examples of Greek Revival architecture surviving in Minnesota. J.L. Bullard was the carpenter-builder.

6. Site of Taylors Falls School c. 1856. Three story brick building with bell tower, designed by J.L. Bullard. Demolished in 1961. Also site of first Chisago County buildings removed when county seat changed to Center City.

7. Levi Folsom House, 1856. Two story clapboard sided, wood frame. Greek Revival. Essentially unaltered except for substitution of smaller windows for the original French doors and the removal of the front porch.

8. Platt Walker House, c. 1860. Two story wood frame. Greatly altered.

9. Site of Chisago Seminary, c. 1850's. Two story wood frame. Demolished 1890's.

10. Hodgkinson House, c. 1860. Two story wood frame Greek Revival. French doors on the front elevation. First floor now partially covered with asbestos siding over original clapboard.

11. George DeAttly House, c. 1860's. One story wood frame, greatly altered.

12. Winslow House, c. 1857. Two story wood frame, clapboard sided, with wood blinds. This is typical of the New England variation of Greek Revival houses prevalent in Minnesota River communities of the 1850's. Noteworthy is the recessed front doorway surrounded above and on the sides by a narrow band of glass and framed by pilasters and denticulated architrave. Building entablature especially elaborate for Minnesota Greek Revival. Interior parlor windows are simplified frontier adaptation of that illustrated on Plate #6 of Minard LaFever's The Beauties of Modern Architecture.

13. House, date unknown. Originally one story wood frame, Greek Revival, the house has been completely altered, moved back on the site and a flat-roofed second story added.

14. House c. 1860. Two story, wood frame clapboard sided. Greek Revival. Front windows are inappropriate later addition. Interior completely altered.

RECEIVED
JAN 27 1961
NATION
REGIST

SEE INSTRUCTIONS

SIGNIFICANCE

PERIOD (Check One or More as Appropriate)

- | | | | |
|--|---------------------------------------|--|---------------------------------------|
| <input type="checkbox"/> Pre-Columbian | <input type="checkbox"/> 16th Century | <input type="checkbox"/> 18th Century | <input type="checkbox"/> 20th Century |
| <input type="checkbox"/> 15th Century | <input type="checkbox"/> 17th Century | <input checked="" type="checkbox"/> 19th Century | |

SPECIFIC DATE(S) (If Applicable and Known)

AREAS OF SIGNIFICANCE (Check One or More as Appropriate)

- | | | | |
|--|---|---|--|
| <input type="checkbox"/> Aboriginal | <input checked="" type="checkbox"/> Education | <input type="checkbox"/> Political | <input type="checkbox"/> Urban Planning |
| <input type="checkbox"/> Prehistoric | <input type="checkbox"/> Engineering | <input checked="" type="checkbox"/> Religion/Philosophy | <input type="checkbox"/> Other (Specify) |
| <input type="checkbox"/> Historic | <input type="checkbox"/> Industry | <input type="checkbox"/> Science | _____ |
| <input type="checkbox"/> Agriculture | <input type="checkbox"/> Invention | <input type="checkbox"/> Sculpture | _____ |
| <input checked="" type="checkbox"/> Architecture | <input type="checkbox"/> Landscape Architecture | <input type="checkbox"/> Social/Humanitarian | _____ |
| <input type="checkbox"/> Art | <input type="checkbox"/> Literature | <input type="checkbox"/> Theater | _____ |
| <input type="checkbox"/> Commerce | <input type="checkbox"/> Military | <input type="checkbox"/> Transportation | _____ |
| <input type="checkbox"/> Communications | <input type="checkbox"/> Music | | |
| <input type="checkbox"/> Conservation | | | |

STATEMENT OF SIGNIFICANCE

Between 1840 and 1870 settlers were attracted from New England and particularly the forests of Maine to the timber rich St. Croix Valley. For a brief period it was the Northern white pine center of the world. In a setting of rolling hills, formidable rock outcroppings and thick forests that strongly resembled their homeland, the New Englanders built villages closely resembling those they had left. The national architectural style was Greek Revival and it was equally popular in New England, but with their interest in economy together with a desire for as much sunlight as possible, the Yankees tended to discard the high ceilings and shaded porticoes of warmer regions and apply Grecian detail to structures which were otherwise Georgian or Federal in style. The style of Angel's Hill buildings is mainly the New England variation of Greek Revival.

The buildings of Angel's Hill have an infinite variety of detail but are almost all built of solid white pine frame covered with white clapboard and trimmed with green painted exterior wood blinds. Foundations and numerous retaining walls lining its roadways are constructed of local traprock or sandstone. The church, while in complete harmony in material, color and design with its neighbors, dominates the district physically, socially and spiritually. The total effect is one of unity but not monotony.

When the lumber supply was depleted, the economy declined as there was only agriculture and tourism to sustain the area. Angel's Hill, physically isolated from the rest of the village, was spared both the ravages of fire that destroyed the business district, and the need to replace its existing small buildings with larger ones of non-related scale and style. It survived relatively unchanged. Today's prosperity has allowed the district to make essential repairs and some architecturally inappropriate alterations, but the physical isolation of the neighborhood has continued to discourage such contemporary innovations as drive-ins and filling stations.

While there are unquestionably important old buildings in other communities which individually equal or surpass in historic and architectural merit those of this district it is a handsome collection of well maintained and actively used old buildings each in the proper context of its natural setting that is the real significance of Angel's Hill.



SEE INSTRUCTIONS



71

9. MAJOR BIBLIOGRAPHICAL REFERENCES

Fifty Years in the Northwest, W.H.C. Folsom, Pioneer Press Publishing Company, St. Paul, 1888.
History of Washington County and the St. Croix Valley, Warner and Foote, eds. North Star Publishing Company, 1881.
Minnesota Houses-An Architectural and Historical View, Roger Kennedy, Dillon Press, Minneapolis, 1967.
Taylor's Falls Reporter, Taylor's Falls Public Library, Taylor's Falls, Minnesota
Taylor's Falls Journal, Public Library, Taylor's Falls, Minnesota
Greek Revival Building in Taylor's Falls, David Herold, Manuscript, 1970, Public Library, Taylor's Falls, Minnesota.

10. GEOGRAPHICAL DATA

LATITUDE AND LONGITUDE COORDINATES DEFINING A RECTANGLE LOCATING THE PROPERTY			OR	LATITUDE AND LONGITUDE COORDINATES DEFINING THE CENTER POINT OF A PROPERTY OF LESS THAN TEN ACRES		
CORNER	LATITUDE	LONGITUDE		LATITUDE	LONGITUDE	
NW	Degrees Minutes Seconds 45 ° 24 ' 40 "	Degrees Minutes Seconds 92 ° 39 ' 30 "		Degrees Minutes Seconds	Degrees Minutes Seconds	
NE	45 ° 24 ' 40 "	92 ° 39 ' 01 "				
SE	45 ° 24 ' 15 "	92 ° 39 ' 30 "				
SW	45 ° 24 ' 15 "	92 ° 39 ' 01 "				

APPROXIMATE ACREAGE OF NOMINATED PROPERTY: 90 acres

LIST ALL STATES AND COUNTIES FOR PROPERTIES OVERLAPPING STATE OR COUNTY BOUNDARIES

STATE:	CODE	COUNTY	CODE

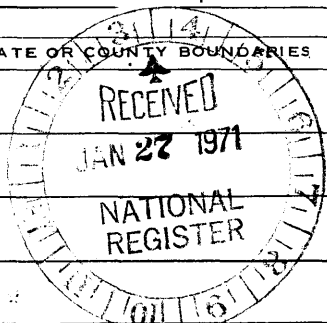

SEE INSTRUCTIONS

11. FORM PREPARED BY

NAME AND TITLE:
Brooks Cavin, AIA

ORGANIZATION: Minnesota Society of Architects DATE: 12/1/70

STREET AND NUMBER:
117 Main Street SE

CITY OR TOWN: Minneapolis STATE: Minnesota CODE: 27

12. STATE LIAISON OFFICER CERTIFICATION

As the designated State Liaison Officer for the National Historic Preservation Act of 1966 (Public Law 89-665), I hereby nominate this property for inclusion in the National Register and certify that it has been evaluated according to the criteria and procedures set forth by the National Park Service. The recommended level of significance of this nomination is:

National State Local

Name Russell W. Fridley

Title Director, Minnesota Historical Society

Date _____

NATIONAL REGISTER VERIFICATION

I hereby certify that this property is included in the National Register.

Robert M. Utley
 Chief, Office of Archeology and Historic Preservation

Date 4/11/72

ATTEST:
William S. Galt
 Keeper of The National Register

Date APR 11 1972

NATIONAL REGISTER OF HISTORIC PLACES
INVENTORY - NOMINATION FORM

(Continuation Sheet)

STATE	
Minnesota	
COUNTY	
Chisago	
FOR NPS USE ONLY	
ENTRY NUMBER	DATE
APR 11 1972	

(Number all entries) Angel's Hill-Physical Appearance (continued)

15. Patrick Fox (Fox-Dobney) House, 1852. Story and one-half wood frame. Clapboard sided with wood blinds. Moved from Bench Street location in 1968, this is said to be the oldest village building standing. Good example of Greek Revival with small, square columned portico. Now located on site of stagecoach stopping house, built in 1850's and demolished in 1932.
18. Thomas Lacey House ca. 1860. Two story wood frame. Clapboard siding. Gable end faces street. French doors open from both floor levels to porches which are replacement for earlier porches. Original bargeboards removed when exterior of upper story remodeled. Probably built by J.L. Bullard.
19. Hobbs House, ca. 1860, two story wood frame, clapboard siding. Main entrance centered on long side of the building. Greek Revival doorway and Gothic Revival bargeboards add character to otherwise undecorated structure. Altered by removal of first floor French doors and by replacement of original front porch.
20. McKusick House, ca. 1850. Two story clapboard sided, wood frame Greek Revival. Moved from Stillwater, Minnesota in 1969. Currently being restored.
21. Nevers House, date unknown. Small story and one half wood frame, clapboard siding with wood blinds. Several later additions. Greek Revival with later Victorian embellishment at front entrance.
22. Royal C. Gray House ca. 1864. Two story, clapboard siding, wood frame. Carpenter Gothic in style, rich with turned and sawn wood ornamentation.
23. Dresser-Murdock House, 1859. Two story clapboard siding, wood frame with French doors at upper and lower floors of street elevation. Building is combination of several styles having Greek Revival doorway and Gothic Revival bargeboards. The Tuscan Italiante tower lavishly decorated with stick and shingle style and pierced with round "oeil de boeuf" windows was added together with Eastlake style front porch in 1880's by carpenter/builder Thomas Peck.
24. Soap House, date unknown. Except for the wood shed attached to the house, the only remaining out-building for the Dresser-Murdock House. Built of local brick, the small structure was used to house the making of soap. Now in ruinous state.
25. House, ca. 1860's. Two story wood frame. Moved from the Milltown section of the village around 1900 and greatly altered.
26. Barn, date unknown. Wood frame with vertical sod siding and battens.
27. Barn, date unknown. Wood frame.
28. Lucius Snall House, ca. 1870. Two story wood frame clapboard siding with exterior wood blinds.
29. William Dobney House, ca. 1860's. Two story wood frame, clapboard siding. Conservative New England variation of the cube shaped bracketed Italiante house with low hipped roof and widow's walk. Somewhat altered at beginning of 20th century both on exterior and interior.
30. House, date unknown. Two story wood frame. Greek Revival. Altered with later addition of stucco and with revisions to door and window locations and detail. Interior completely altered.
31. Methodist Parsonage, date unknown. Two story wood frame, Greek Revival. Altered by addition of grey shingle siding over original clapboard and with front porch. Principle feature is handsome recessed doorway.
32. Hovey House, date unknown. Story and one half wood frame, clapboard siding. Greek Revival.
33. House, ca. 1890. Story and one half, wood frame, clapboard sided. Greek Revival to which two story wood frame wing has been added.

**NATIONAL REGISTER OF HISTORIC PLACES
INVENTORY - NOMINATION FORM**

(Continuation Sheet)

STATE	
Minnesota	
COUNTY	
Chisago	
FOR NPS USE ONLY	
ENTRY NUMBER	DATE
	APR 11 1972

(Number all entries) 8. Significance (cont.)

34. Wellhead - wood restored. Supplied entire district above W. H. Folsom House with drinking water until 1915.

ANGEL'S HILL
HISTORIC SITE
LIMITS

SECT. 25
T 34N - R 19W

Scale: 1"=400'

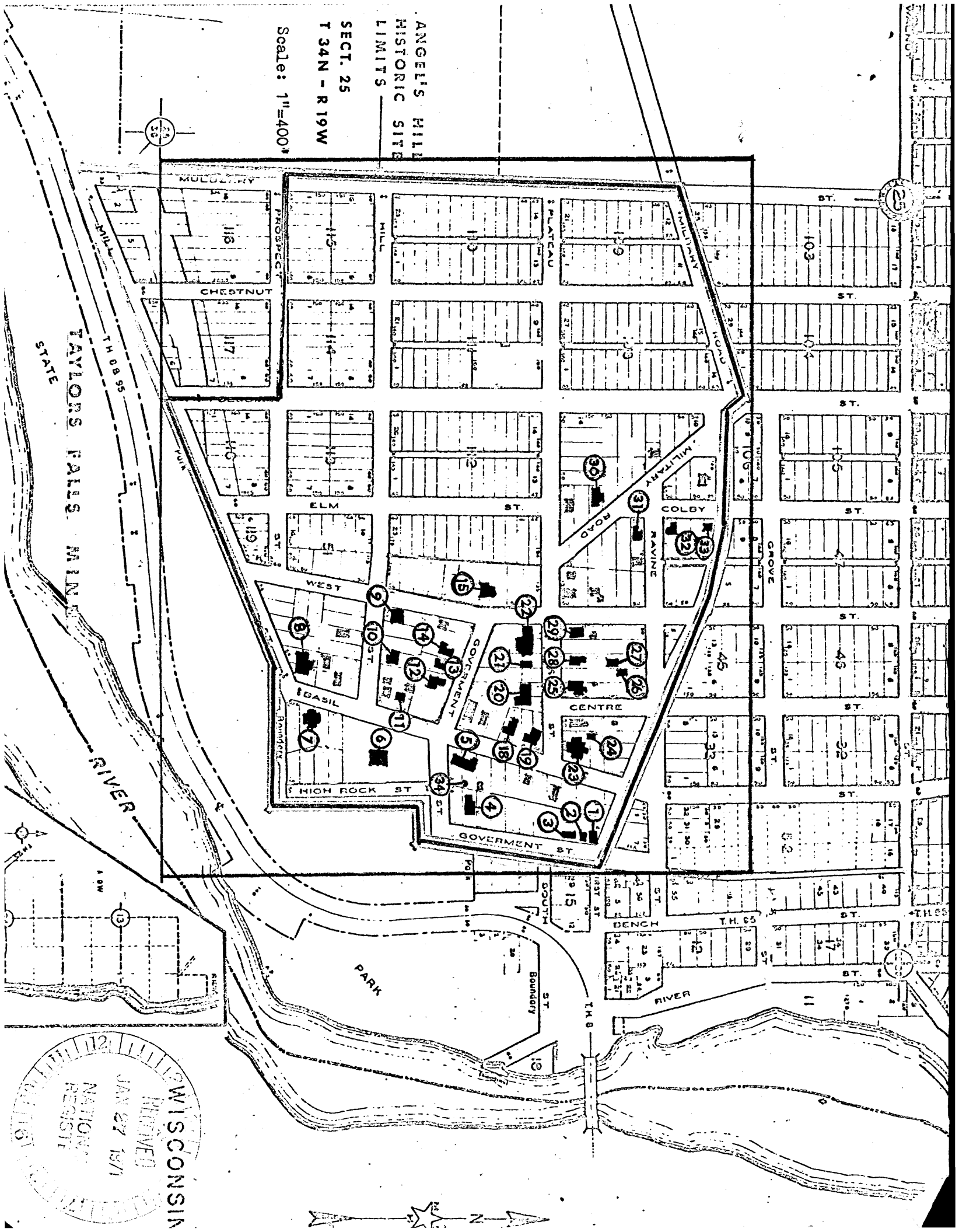

RECEIVED
JAN 27 1971
NATIONAL REGISTER

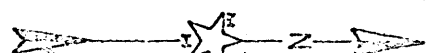

Form 10-301
(Dec. 1968)

UNITED STATES DEPARTMENT OF THE INTERIOR
NATIONAL PARK SERVICE

**NATIONAL REGISTER OF HISTORIC PLACES
PROPERTY MAP FORM**

(Type all entries - attach to or enclose with map)

STATE Minnesota	
COUNTY Chisago	
FOR NPS USE ONLY	
ENTRY NUMBER APR 11 1972	DATE

SEE INSTRUCTIONS

1. NAME			
COMMON: Angel's Hill Historic District			
AND/OR HISTORIC: Angel's Hill			
2. LOCATION			
STREET AND NUMBER:			
CITY OR TOWN: Taylors Falls			
STATE: Minnesota	CODE 27	COUNTY: Chisago	CODE 025
3. MAP REFERENCE			
SOURCE: Plat Book of Chisago County, Minnesota.			
SCALE: 1"=400'			
DATE: 1965			
4. REQUIREMENTS			
TO BE INCLUDED ON ALL MAPS			
1. Property boundaries where required.			
2. North arrow.			
3. Latitude and longitude reference.			

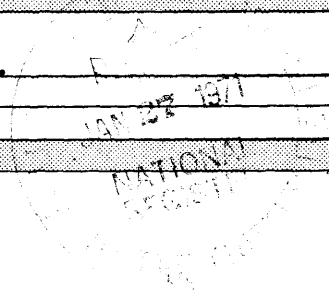

7475 II
(RUSH CITY)

UNITED STATES
DEPARTMENT OF THE INTERIOR
GEOLOGICAL SURVEY

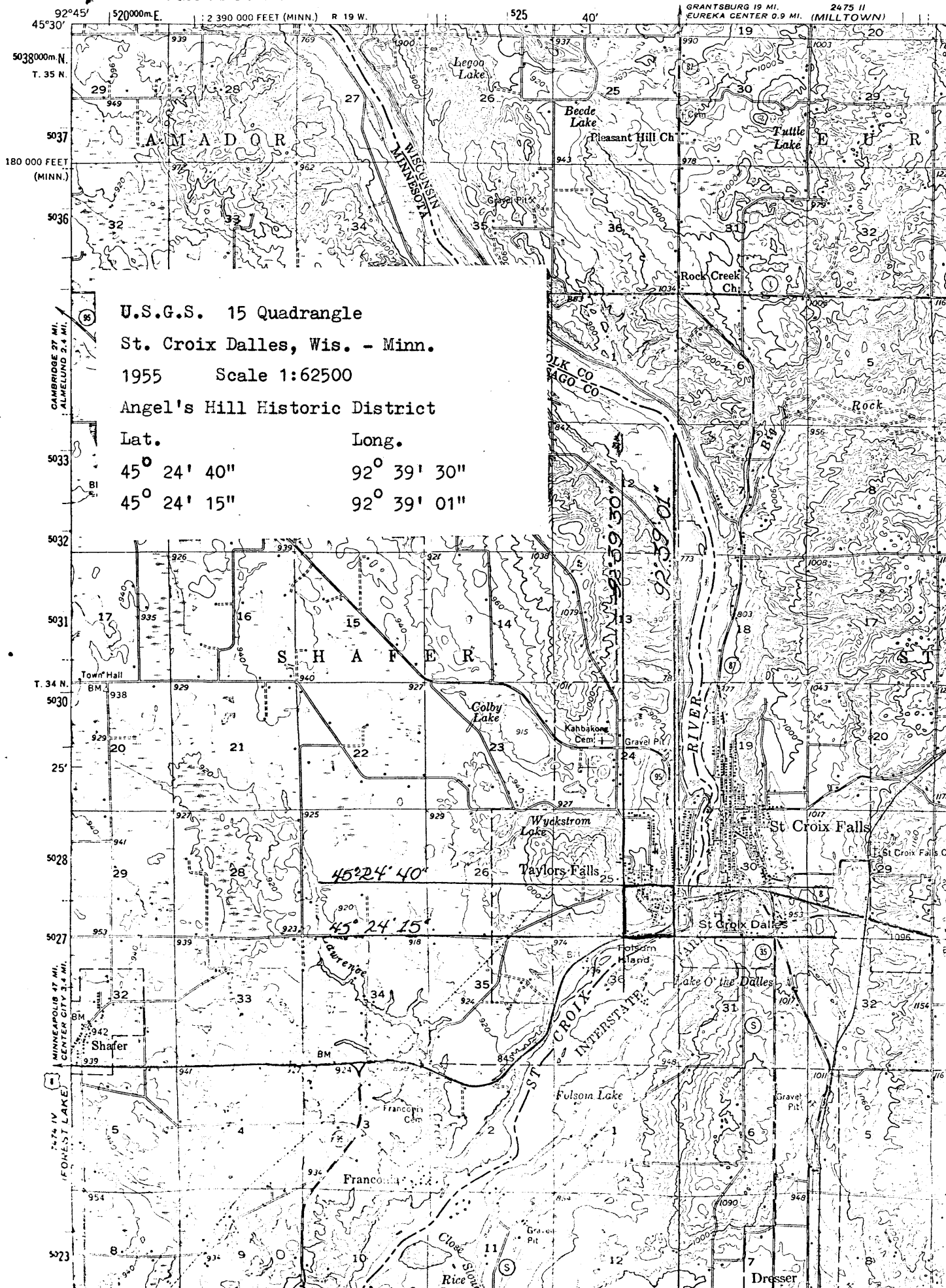

92°45' 520000m E. 2 390 000 FEET (MINN.) R 19 W. 525 40' GRANTSBURG 19 MI. EUREKA CENTER 0.9 MI. (MILLTOWN) 2475 II

5038000m N. T. 35 N. 5037 180 000 FEET (MINN.) 5036

CAMBRIDGE 27 MI. ALMELUND 2.4 MI.

T. 34 N. 5030 25'

MINNEAPOLIS 47 MI. CENTER CITY 3.4 MI. 5028 29

7474 IV (FOREST LAKE) 5023

U.S.G.S. 15 Quadrangle
St. Croix Dalles, Wis. - Minn.
1955 Scale 1:62500
Angel's Hill Historic District

Lat. Long.
45° 24' 40" 92° 39' 30"
45° 24' 15" 92° 39' 01"

45° 24' 40"
45° 24' 15"

92° 39' 30"
92° 39' 01"

Form 10-301
(July 1969)

UNITED STATES DEPARTMENT OF THE INTERIOR
NATIONAL PARK SERVICE

**NATIONAL REGISTER OF HISTORIC PLACES
PROPERTY MAP FORM**

(Type all entries - attach to or enclose with map)

STATE	
Minnesota	
COUNTY	
Chisago	
FOR NPS USE ONLY	
ENTRY NUMBER	DATE
APR 11 1972	

SEE INSTRUCTIONS

1. NAME			
COMMON: Angel's Hill Historic District			
AND/OR HISTORIC: Angel's Hill			
2. LOCATION			
STREET AND NUMBER:			
CITY OR TOWN: Taylors Falls			
STATE:	CODE	COUNTY:	CODE
Minnesota	27	Chisago	025
3. MAP REFERENCE			
SOURCE: U.S.G.S. 15 Quadrangle, St. Croix Dalles, Wis.-Minn.			
SCALE: 1:62500			
DATE: 1955			
4. REQUIREMENTS:			
TO BE INCLUDED ON ALL MAPS			
1. Property boundaries where required.			
2. North arrow.			
3. Latitude and longitude reference.			