

KENTUCKY HISTORIC RESOURCES INVENTORY

Site No. Bn-185

1. Historic Name(s) Original Owner		22. ADD/County BRADD/Barren	
2. Present Name Old Zion Methodist Church <i>Park City, Ky.</i>		23. U.S.G.S. Quadrant (15'/75') G.I.S. Mod.	
3. Location 1/8 miles east of Highway 255 on Highway 1297		24. UTM Reference Zone Easting Northing	
4. Owner's Name Pastor Harold Squires		25. Coordinate Accuracy	
5. Owner's Address Route # 1, Park City, Ky.		26. Prehistoric Site Object Historic Site Structure Building Other	
6. Open to Public Yes <input checked="" type="checkbox"/> No <input type="checkbox"/>	7. Visible from road Yes <input checked="" type="checkbox"/> No <input type="checkbox"/>	8. Ownership Private <input type="checkbox"/> Local <input type="checkbox"/> State <input type="checkbox"/> Federal <input type="checkbox"/>	
9. Local Contact/Organization		27. National Register District Name:	
10. Site Plan with North Arrow		28. Significance Evaluation National Register	
		29. Status Date National Landmark <input type="checkbox"/> National Register <input type="checkbox"/> Landmark Certificate <input type="checkbox"/> Kentucky Survey <input type="checkbox"/> Local Landmark <input type="checkbox"/> HABS/HAER <input type="checkbox"/>	
		30. Historic Theme Primary <input type="checkbox"/> Secondary <input type="checkbox"/> Other <input type="checkbox"/>	
		31. Endangered Yes <input type="checkbox"/> No <input type="checkbox"/>	
		32. Preservation Project Status <input type="checkbox"/>	
		Actual Cost in \$1,000s	
		33. ATTACH PHOTO	
		34. Prepared by: Jayne C. Henderson	
		35. Organization SCKHS	
		36. Date Fall, 1981	
37. Revision Dates 38. Staff Review			
11. Architect		12. Builder	
13. Date 1856 A. <input type="checkbox"/> B. <input type="checkbox"/>		14. Style A. Vernacular <input type="checkbox"/> B. <input type="checkbox"/>	
15. Original Use church <input type="checkbox"/>		16. Present use same <input type="checkbox"/>	
17. Condition good <input type="checkbox"/>		18. Description Flemish bond front-Common bond sides-12/12 lights in window openings.	
No. Stories one <input type="checkbox"/>		Single Pile <input type="checkbox"/> NA <input type="checkbox"/>	
Double Pile <input type="checkbox"/>		Floor Plan gable end <input type="checkbox"/>	
Structural Fabric brick A. <input type="checkbox"/> B. <input type="checkbox"/>		Decorative Fabric Flemish bond A. <input type="checkbox"/> B. <input type="checkbox"/>	
Roof Form gable			
19. History The Old Zion Church was built around 1856.			
20. Significance The Old Zion Methodist Church is the most intact nineteenth century brick church structure in the county (outside of Glasgow)			
21. Source of Information			

(Continue on Back)

Roll No. 27
Picture No. Photo 101
Direction _____

KENTUCKY HISTORIC RESOURCE INVENTORY SUPPLEMENT
BOUNDARY AND LOCATION INFORMATION

Historic Property Name Old Zion Church Site # BW-185

Multiple Resource/Thematic Nomination Title Barren County Multiple Resource

U.T.M. Coordinates - List multiple UTM's if property is ten or more acres.

A. 16 583240 4093 240 D. _____

B. _____ E. _____

C. _____ F. _____

Verbal Boundary Description

Acreage less than one acre

See Map 5

The nominated area is an imaginary line 50 feet from and parallel to the foundation of the building. No outbuildings are included. Nominated area in red

Sketch of Site Plan (Showing outbuildings, structures, landscape features and the site boundary as described above.)

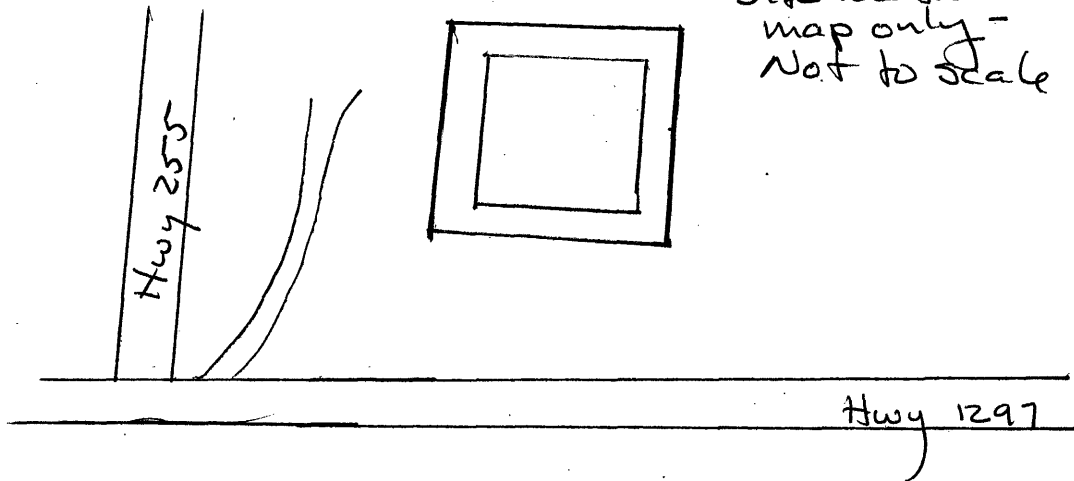

Official Courthouse Property Reference:

KENTUCKY HISTORIC RESOURCES INVENTORY

Site No. Bn-185

1. Historic Name(s) Original Owner		22. ADD/County BRADD/Barren	
2. Present Name Old Zion Methodist Church <i>Park City, Ky.</i>		23. U.S.G.S. Quadrant (15'/75') G.I.S. Mod.	
3. Location 1/8 miles east of Highway 255 on Highway 1297		24. UTM Reference Zone Easting Northing	
4. Owner's Name Pastor Harold Squires		25. Coordinate Accuracy	
5. Owner's Address Route # 1, Park City, Ky.		26. Prehistoric Site Object Historic Site Structure Building Other	
6. Open to Public Yes <input checked="" type="checkbox"/> No <input type="checkbox"/>	7. Visible from road Yes <input checked="" type="checkbox"/> No <input type="checkbox"/>	8. Ownership Private <input type="checkbox"/> Local <input type="checkbox"/> State <input type="checkbox"/> Federal <input type="checkbox"/>	
9. Local Contact/Organization		27. National Register District Name:	
10. Site Plan with North Arrow		28. Significance Evaluation National Register	
		29. Status Date National Landmark <input type="checkbox"/> National Register <input type="checkbox"/> Landmark Certificate <input type="checkbox"/> Kentucky Survey <input type="checkbox"/> Local Landmark <input type="checkbox"/> HABS/HAER <input type="checkbox"/>	
		30. Historic Theme Primary <input type="checkbox"/> Secondary <input type="checkbox"/> Other <input type="checkbox"/>	
		31. Endangered Yes <input type="checkbox"/> No <input type="checkbox"/>	
		32. Preservation Project Status <input type="checkbox"/>	
		Actual Cost in \$1,000s <input type="checkbox"/>	
		33. ATTACH PHOTO	
		Roll No. <u>27</u>	
		Picture No. <u>Photo 101</u>	
		Direction _____	
34. Prepared by: Jayne C. Henderson			
35. Organization SCKHS			
36. Date Fall, 1981			
37. Revision Dates 38. Staff Review			

18. Description Flemish bond front-Common bond sides-12/12 lights in window openings.	11. Architect	12. Builder	13. Date 1856 A. <input type="checkbox"/> B. <input type="checkbox"/>
(Continue on Back)	14. Style A. Vernacular <input type="checkbox"/> B. <input type="checkbox"/>	15. Original Use church <input type="checkbox"/>	16. Present use same <input type="checkbox"/>
	17. Condition good <input type="checkbox"/>	No. Stories one <input type="checkbox"/>	Single Pile _____ NA _____
	Double Pile _____	Floor Plan gable end <input type="checkbox"/>	Structural Fabric brick A. <input type="checkbox"/> B. <input type="checkbox"/>
	Decorative Fabric Flemish bond A. <input type="checkbox"/> B. <input type="checkbox"/>	Roof Form gable	

19. History The Old Zion Church was built around 1856.	21. Source of Information
20. Significance The Old Zion Methodist Church is the most intact nineteenth century brick church structure in the county (outside of Glasgow)	

KENTUCKY HISTORIC RESOURCE INVENTORY SUPPLEMENT
BOUNDARY AND LOCATION INFORMATION

Historic Property Name Old Zion Church Site # BW-185

Multiple Resource/Thematic Nomination Title Barren County Multiple Resource

U.T.M. Coordinates - List multiple UTM's if property is ten or more acres.

A. 16 583240 4093 240 D. _____

B. _____ E. _____

C. _____ F. _____

Verbal Boundary Description

Acreage less than one acre

See Map 5

The nominated area is an imaginary line 50 feet from and parallel to the foundation of the building. No outbuildings are included. Nominated area in red

Sketch of Site Plan (Showing outbuildings, structures, landscape features and the site boundary as described above.)

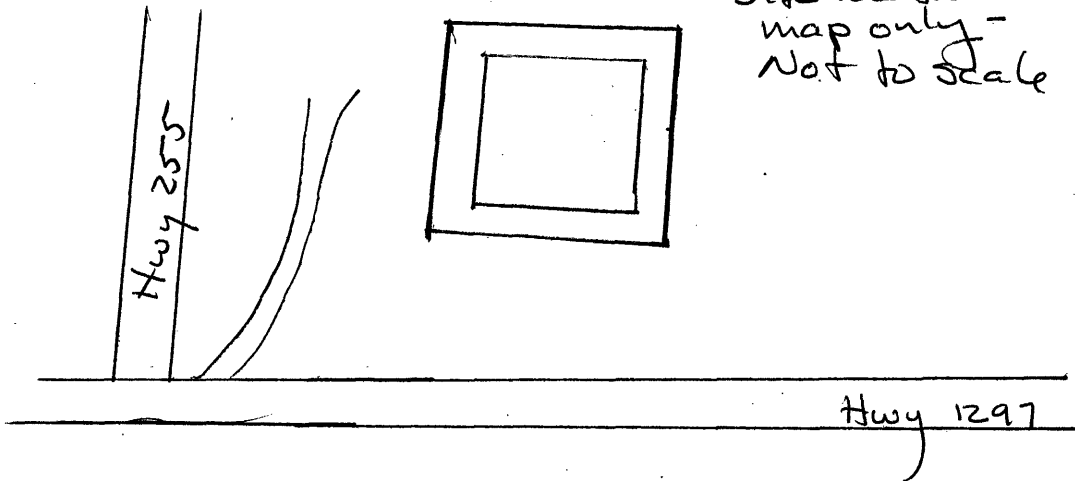

Official Courthouse Property Reference: