

UNITED STATES DEPARTMENT OF THE INTERIOR
NATIONAL PARK SERVICE

**NATIONAL REGISTER OF HISTORIC PLACES
INVENTORY -- NOMINATION FORM**
FOR FEDERAL PROPERTIES

PHO 683 787

| | |
|------------------|-------------|
| FOR NPS USE ONLY | |
| RECEIVED | SEP 7 1978 |
| DATE ENTERED | NOV 30 1978 |

SEE INSTRUCTIONS IN *HOW TO COMPLETE NATIONAL REGISTER FORMS*
TYPE ALL ENTRIES -- COMPLETE APPLICABLE SECTIONS

1 NAME

HISTORIC

Mess Hall and Kitchen, Bunk Houses, Toilet & Shower Room, Tuolumne Meadows

AND/OR COMMON

Buildings 3010, 3011, 3012, 3013, 3014 and 3015

2 LOCATION (Tuolumne Meadows, Yosemite National Park)

STREET & NUMBER

Not applicable

___ NOT FOR PUBLICATION

CITY, TOWN

Not applicable

CONGRESSIONAL DISTRICT

VICINITY OF Lee Vining

14th

STATE

California

CODE

06

COUNTY

Tuolumne

CODE

109

2 CLASSIFICATION

CATEGORY

- ___ DISTRICT
- BUILDING(S)
- ___ STRUCTURE
- ___ SITE
- ___ OBJECT

OWNERSHIP

- PUBLIC
- ___ PRIVATE
- ___ BOTH
- PUBLIC ACQUISITION**
- ___ IN PROCESS
- ___ BEING CONSIDERED

STATUS

- OCCUPIED
- ___ UNOCCUPIED
- ___ WORK IN PROGRESS
- ACCESSIBLE**
- YES: RESTRICTED
- ___ YES: UNRESTRICTED
- ___ NO

PRESENT USE

- ___ AGRICULTURE
- ___ MUSEUM
- ___ COMMERCIAL
- ___ PARK
- ___ EDUCATIONAL
- ___ PRIVATE RESIDENCE
- ___ ENTERTAINMENT
- ___ RELIGIOUS
- GOVERNMENT
- ___ SCIENTIFIC
- ___ INDUSTRIAL
- ___ TRANSPORTATION
- ___ MILITARY
- ___ OTHER:

4 AGENCY

REGIONAL HEADQUARTERS: (If applicable)

National Park Service, Western Regional Office

STREET & NUMBER

450 Golden Gate Avenue, Box 36063

CITY, TOWN

San Francisco

___ VICINITY OF

STATE

California (94102)

5 LOCATION OF LEGAL DESCRIPTION

COURTHOUSE,
REGISTRY OF DEEDS, ETC.

Administration Building, National Park Service

STREET & NUMBER

Box 577

CITY, TOWN

Yosemite Village, Yosemite National Park, California

STATE

6 REPRESENTATION IN EXISTING SURVEYS

TITLE

None

DATE

___ FEDERAL ___ STATE ___ COUNTY ___ LOCAL

DEPOSITORY FOR
SURVEY RECORDS

CITY, TOWN

STATE

7 DESCRIPTION

| CONDITION | | CHECK ONE | | CHECK ONE | |
|------------------------------------|---------------------------------------|------------------------------------|--|-----------|-------|
| <input type="checkbox"/> EXCELLENT | <input type="checkbox"/> DETERIORATED | <input type="checkbox"/> UNALTERED | <input type="checkbox"/> ORIGINAL SITE | | |
| <input type="checkbox"/> GOOD | <input type="checkbox"/> RUINS | <input type="checkbox"/> ALTERED | <input type="checkbox"/> MOVED | DATE | _____ |
| <input type="checkbox"/> FAIR | <input type="checkbox"/> UNEXPOSED | | | | |

DESCRIBE THE PRESENT AND ORIGINAL (IF KNOWN) PHYSICAL APPEARANCE

The Mess Hall and Kitchen building at Tuolumne Meadows, building 3010, is a "T" - shaped building with the head of the "T" at the west end and the front entrance on the north lying on the right side of the "T". The dimensions are roughly 36 by 64 feet. The foundation is of native stone in cement mortar. The first couple of feet of the walls are redwood horizontal lap siding, 1 by 10 inch planks, exposed 8 inches to the weather. Above this the walls are of redwood board and batten construction. The four gable ends are again lap siding. The back or south side has three double 12-lite windows (24 lites in each of the three sets) and one double 8-lite set (16 lites). The west end has two double 6-lite windows (total of 12 lites), and one single 4-lite window, offset towards the rear or south, and an end door which leads into the kitchen and the cook's bedroom. The door has a 4-lite window. The east end of the building has two double 6-lite windows (total of 12 lites each), flanking a stone chimney which serves as a flue for a fireplace. The front of the building features a recessed porch. It has three double 12-lite windows, two of them opening on the porch, and two single 6-lite windows. All windows are casements with metal sash and are equipped with wood V-joint tongue & groove storm shutters, hinged with metal. The front porch, in addition to the windows, has a double door entrance. The steeply pitched gable roof and cross gable of the "T" are finished with red cedar shakes. The porch roof is supported by four pair of stout log posts. False rafters are logs about 8 inches in diameter. The central part of the interior is a dining room about 32 by 27 feet. At the east end this space opens into a "lounge" of the same width as the dining room but only about 8 feet deep along the longer axis of the building. The lounge features a large stone fireplace and chimney centered in the end wall, as well as built-in hinged seats flanking the fireplace and below the windows. Opposite the lounge and next to the porch is an entrance hall roughly 5 by 7 feet, with a door entering from the end of the porch, and also a toilet room of the same size as the entrance hall. At the west end of the building to the rear (south) side is the kitchen, roughly 16 by 20 feet. Toward the front of the building at this end is a bedroom and bath for the cook, separated from the kitchen by a small entry hall behind the door at the west end of the building. The building is little changed from its original form and condition.

East of the Mess Hall and Kitchen building are four small bunkhouses, buildings 3011, 3012, 3013, 3014, aligned along a gentle curve of the hillside, at roughly the same elevation. They are of the same rustic style on a smaller scale. A toilet and shower room, building 3015, stands as a fifth building at the end of the line (or sixth, if the Mess Hall/Kitchen is included). Each bunk house is 13 feet by about 16 feet, outside measurement. Each has a stone foundation. The walls are of horizontal 1 by 10 inch lap siding, 8 inches of which is exposed to the weather, to a height of 4 feet, 8 inches. Above this is vertical board and batten finish, surmounted on the gable ends with more horizontal lap siding. The rear of each building has a double 8-lite window (16-lites total) centered. The front has the same type of window off center to the west, with a door to the east of center. The east end is a windowless wall, the west end features a stone chimney with connecting flue for a stovepipe inside, no fireplace. In each corner of the single room is a tiny closet, 1 foot 8 inches square. Gable roofs of each building have shingle finish.

UNITED STATES DEPARTMENT OF THE INTERIOR
NATIONAL PARK SERVICE

**NATIONAL REGISTER OF HISTORIC PLACES
INVENTORY -- NOMINATION FORM**

| | |
|------------------|-------------|
| FOR NPS USE ONLY | |
| RECEIVED | NOV 30 1978 |
| DATE ENTERED | |

CONTINUATION SHEET

ITEM NUMBER 7 PAGE 2

The toilet and shower building is of the same external design as the bunk houses, including the chimney, except for the windows and size. It is roughly 11 by 20 feet in dimensions. It has a front door offset east of center, and three small single-lite windows offset west of center. The west end has a stone chimney, which in this building provides a flue for a water heater. The east end has centered a horizontal double-pane window flanked by two single pane windows, and the south or back side has the same. Inside, the building features two shower stalls, one each in the north-west and southwest corners, three sinks along the south wall, three toilet stalls along the east wall, and a urinal along the north wall west of the door.

The exterior wood in all of the buildings is stained a dark brown.

These six buildings stand on the slope of a hill which climbs south from the highway, the latter passing east-west a short distance to the north along the southern edge of Tuolumne Meadows. They comprise part of a somewhat larger complex of structures including a number of tent-frames a few feet behind (south) and slightly up slope from the Mess Hall/Kitchen and bunk houses, and a number of storage structures sheathed in corrugated metal just west of the Mess Hall/Kitchen. None of the tent frames or storage structures possess historical or architectural significance or contribute to the integrity of this complex. The environment is a conifer forest.

8 SIGNIFICANCE

| PERIOD | | AREAS OF SIGNIFICANCE -- CHECK AND JUSTIFY BELOW | | | | |
|---|--|--|---|---|--|--|
| <input type="checkbox"/> PREHISTORIC | <input type="checkbox"/> ARCHEOLOGY-PREHISTORIC | <input type="checkbox"/> COMMUNITY PLANNING | <input type="checkbox"/> LANDSCAPE ARCHITECTURE | <input type="checkbox"/> RELIGION | | |
| <input type="checkbox"/> 1400-1499 | <input type="checkbox"/> ARCHEOLOGY-HISTORIC | <input type="checkbox"/> CONSERVATION | <input type="checkbox"/> LAW | <input type="checkbox"/> SCIENCE | | |
| <input type="checkbox"/> 1500-1599 | <input type="checkbox"/> AGRICULTURE | <input type="checkbox"/> ECONOMICS | <input type="checkbox"/> LITERATURE | <input type="checkbox"/> SCULPTURE | | |
| <input type="checkbox"/> 1600-1699 | <input checked="" type="checkbox"/> ARCHITECTURE | <input type="checkbox"/> EDUCATION | <input type="checkbox"/> MILITARY | <input checked="" type="checkbox"/> SOCIAL/HUMANITARIAN | | |
| <input type="checkbox"/> 1700-1799 | <input type="checkbox"/> ART | <input type="checkbox"/> ENGINEERING | <input type="checkbox"/> MUSIC | <input type="checkbox"/> THEATER | | |
| <input type="checkbox"/> 1800-1899 | <input type="checkbox"/> COMMERCE | <input type="checkbox"/> EXPLORATION/SETTLEMENT | <input type="checkbox"/> PHILOSOPHY | <input type="checkbox"/> TRANSPORTATION | | |
| <input checked="" type="checkbox"/> 1900- | <input type="checkbox"/> COMMUNICATIONS | <input type="checkbox"/> INDUSTRY | <input type="checkbox"/> POLITICS/GOVERNMENT | <input type="checkbox"/> OTHER (SPECIFY) | | |
| | | <input type="checkbox"/> INVENTION | | | | |

SPECIFIC DATES 1934 - present

BUILDER/ARCHITECT National Park Service

STATEMENT OF SIGNIFICANCE

The Mess Hall and Kitchen building, four small bunkhouses, and a toilet/shower at Tuolumne Meadows in Yosemite National Park are of local historical significance in the social/humanitarian category as a consequence of their construction by Civilian Conservation Corps labor, and are of local architectural significance in terms of their environmentally harmonious "rustic" design.

During the early 1930's, the old auto road through Tuolumne Meadows was redesigned and relocated, and its new routing passed through an area used for housing maintenance and construction crews during the summer months. The old housing consequently had to be demolished, and to replace it, new accommodations were needed. Originally this new complex of buildings was to be built in 1933, but along with comfort stations in the nearby campground and other structures in the park, it was postponed until 1934. Due to the altitude of Tuolumne Meadows, work on the road and structures could proceed only during a very brief summer season, as the area is closed by snow most of the year.

Plans for the Mess Hall and Kitchen/Bunk House complex were drawn up early in 1934 and completed on April 10 by a draughtsman named Kerr in the National Park Service's branch of Plans and Design. The job was to be Federal Project 286 under Public Works Administration funding, to be built with CCC labor under the supervision of Architect John Wosky. The Mess Hall and Kitchen was laid out on three sheets as Plan No. 3086-A. There were some significant differences between the plan and the building that was erected. As built during the summer of 1934, the floor plan was a reverse or mirror image of the plan. Furthermore, the plan called for the stone foundation to continue as walls above floor level to a height of 2 feet 4 inches. When built, the stone foundation ended at floor level and a belt of horizontal slab siding substituted for the stone wall, the remainder of the building above that level following the original concept. The four bunkhouses were drawn up on a single sheet, Plan 3089-A, and were constructed as drawn. The toilet and shower room, drawn up as Plan 3090-A, again a single sheet, were also erected as drawn. Construction commenced during the 1934 summer season, and the bunkhouses were completed in September and the Mess Hall in October 1934, ready for occupancy in the 1935 season. Thereafter they housed the road construction crews and other laborers working in the Tuolumne Meadows/Tioga Pass high country region during summer seasons. Presumably each of the bunkhouses was intended to house four men, although somewhat crowded at that capacity.

Architecturally, the buildings constitute an excellent example of National Park Service "rustic" architecture of the mid-1930's, neither as highly stylized or decorated as earlier examples of the rustic style, nor as plain and functional as many contemporary and later structures. The Mess Hall and Kitchen building is of the quality of design and construction that one might expect to find in a small tourist lodge, not in a functional

9 MAJOR BIBLIOGRAPHICAL REFERENCES

National Park Service, Western Regional Office, Building Files in Division of Cultural Resources Management; Plan and Drawing Files in Division of Planning, 450 Golden Gate Ave., San Francisco

Monthly Reports of Assistant Architect John Wosky, Branch of Plans and Design, NPS, to the Chief Architect.

Tweed, William, Henry Law and Laura Soulliere, National Park Service Rustic Architecture, 1916-1942. (San Francisco: National Park Service, Western Regional Office, 1977)

10 GEOGRAPHICAL DATA

ACREAGE OF NOMINATED PROPERTY .4132231

UTM REFERENCES

| | | | | | | | | | | | | | |
|---|------|---------|----------|------|---------|----------|---|--|--|--|--|--|--|
| A | 1, 1 | 2, 9, 1 | 35, 0 | 4, 1 | 9, 4 | 0, 1, 0 | B | | | | | | |
| | ZONE | EASTING | NORTHING | ZONE | EASTING | NORTHING | | | | | | | |
| C | | | | | | | D | | | | | | |

VERBAL BOUNDARY DESCRIPTION

The boundary is in the form of a gently curved arc, roughly 60 feet wide and 300 feet in length along the curve, as shown on the site plan, encompassing all six buildings.

LIST ALL STATES AND COUNTIES FOR PROPERTIES OVERLAPPING STATE OR COUNTY BOUNDARIES

| STATE | CODE | COUNTY | CODE |
|-------|------|--------|------|
| STATE | CODE | COUNTY | CODE |

| | | | |
|-------|------|--------|------|
| STATE | CODE | COUNTY | CODE |
|-------|------|--------|------|

11 FORM PREPARED BY

NAME / TITLE

Gordon S. Chappell, Regional Historian

ORGANIZATION

National Park Service, Western Regional Office

DATE

October 25, 1977

STREET & NUMBER

450 Golden Gate Avenue - Box 36063

TELEPHONE

(415) 556-4165

CITY OR TOWN

San Francisco

STATE

California

12 CERTIFICATION OF NOMINATION

STATE HISTORIC PRESERVATION OFFICER RECOMMENDATION

YES NO NONE

JUN 30 1978

Kenny Mellon

STATE HISTORIC PRESERVATION OFFICER SIGNATURE

In compliance with Executive Order 11593, I hereby nominate this property to the National Register, certifying that the State Historic Preservation Officer has been allowed 90 days in which to present the nomination to the State Review Board and to evaluate its significance. The evaluated level of significance is National State Local .

FEDERAL REPRESENTATIVE SIGNATURE

TITLE

Arch. and Hist. Cultural Resources

DATE

8/10/78

FOR NPS USE ONLY

I HEREBY CERTIFY THAT THIS PROPERTY IS INCLUDED IN THE NATIONAL REGISTER

Charles E. Hume

DATE

11-30-78

DIRECTOR, OFFICE OF ARCHAEOLOGY AND HISTORIC PRESERVATION

ATTEST:

W. Ray Juce

DATE

11.24.78

KEEPER OF THE NATIONAL REGISTER

UNITED STATES DEPARTMENT OF THE INTERIOR
NATIONAL PARK SERVICE

**NATIONAL REGISTER OF HISTORIC PLACES
INVENTORY -- NOMINATION FORM**

| |
|---------------------|
| FOR NPS USE ONLY |
| RECEIVED SEP 7 1978 |
| DATE ENTERED |

CONTINUATION SHEET

ITEM NUMBER 8 PAGE 2

employees' structure intended merely for summer use. Situated on a forested rocky slope not far below the Sierra Nevada timberline, the stone and wood in the structures blends well with the environment and renders these structures successful examples of what "rustic" design was intended to achieve. As defined by NPS architects, it was supposed to reflect the hand crafted techniques and tools of pioneer builders, and through the use of native materials such as stone and wood, especially logs, as well as native colors and textures, it would blend rather than contrast with its environment, as these structures do.

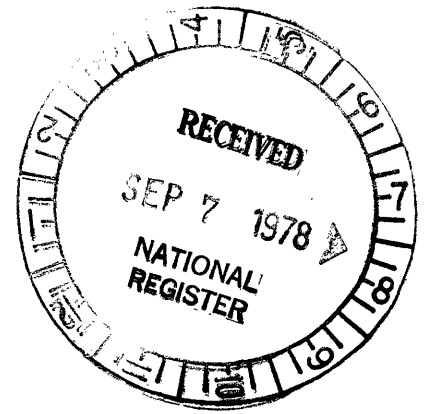

TUOLUMNE MEADOWS
YOSEMITE NATIONAL PARK
SIERRA COUNTY, CALIFORNIA

SITE PLAN - NOT TO SCALE

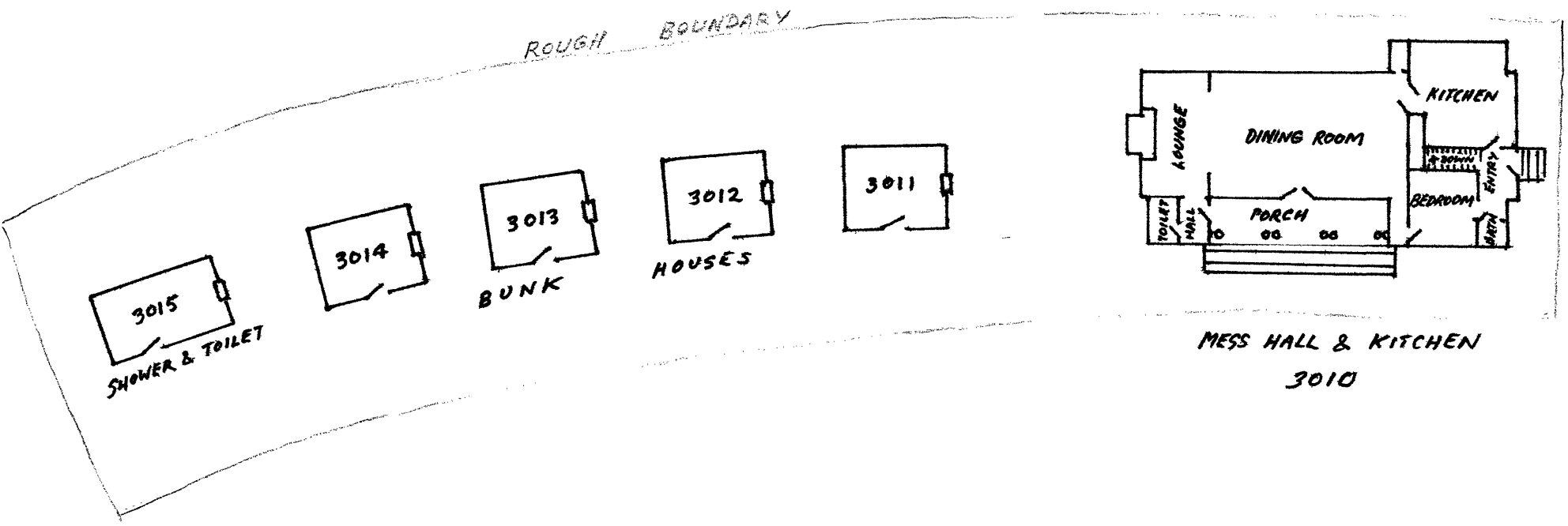

DRAWN BY REGIONAL HISTORIAN GORDON CHAPPELL
OCTOBER 27, 1977