

1561

United States Department of the Interior
National Park Service

RECEIVED 413
DEC 12 1994
INTERAGENCY RESOURCES DIVISION
NATIONAL PARK SERVICE

NATIONAL REGISTER OF HISTORIC PLACES
REGISTRATION FORM

This form is for use in nominating or requesting determinations for individual properties and districts. See instructions in How to Complete the National Register of Historic Places Registration Form (National Register Bulletin 16A). Complete each item by marking "x" in the appropriate box or by entering the information requested. If any item does not apply to the property being documented, enter "N/A" for "not applicable." For functions, architectural classification, materials, and areas of significance, enter only categories and subcategories from the instructions. Place additional entries and narrative items on continuation sheets (NPS Form 10-900a). Use a typewriter, word processor, or computer, to complete all items.

1. Name of Property

historic name Marshfield
other names/site number Old Marsh Home Place

2. Location

street & number Youngblood Road not for publication _____
city or town Trenton vicinity X
state South Carolina code SC county Edgefield code 037
zip code 29847

3. State/Federal Agency Certification

As the designated authority under the National Historic Preservation Act of 1986, as amended, I hereby certify that this X nomination request for determination of eligibility meets the documentation standards for registering properties in the National Register of Historic Places and meets the procedural and professional requirements set forth in 36 CFR Part 60. In my opinion, the property X meets _____ does not meet the National Register Criteria. I recommend that this property be considered significant _____ nationally _____ statewide _____ locally.
(See continuation sheet for additional comments.)

Mary W. Edmonds 12/8/94
Signature of certifying official Date

Mary W. Edmonds, Deputy SBPO, S.C. Department of Archives & History, Columbia, S.C.
State or Federal agency and bureau

In my opinion, the property _____ meets _____ does not meet the National Register criteria.
(See continuation sheet for additional comments.)

Signature of commenting or other official Date

State or Federal agency and bureau

4. National Park Service Certification

I, hereby certify that this property is:

- entered in the National Register _____
_____ See continuation sheet.
- determined eligible for the National Register _____
- determined not eligible for the National Register _____
- removed from the National Register _____
- other (explain): _____

M. J. M. [Signature] 1/9/95

[Signature] _____
Signature of Keeper Date of Action

5. Classification

Ownership of Property

(Check as many boxes as apply)

- private
- public-local
- public-State
- public-Federal

Category of Property

(Check only one box)

- building(s)
- district
- site
- structure
- object

Number of Resources within Property

Contributing	Noncontributing	
3	2	buildings
1	_____	sites
_____	_____	structures
_____	_____	objects
4	2	Total

Name of related multiple property listing
Enter "N/A" if property is not part of a multiple property listing.)

Number of contributing resources previously listed in the National Register 0

N/A

6. Function or Use

Historic Functions (Enter categories from instructions)

Cat: DOMESTIC
DOMESTIC
FUNERARY

Sub: Single Dwelling
Secondary Structure
Cemetery

Current Functions (Enter categories from instructions)

Cat: DOMESTIC
DOMESTIC
FUNERARY

Sub: Single Dwelling
Secondary Structure
Cemetery

7. Description

Architectural Classification

(Enter categories from instructions)

Mid-19th Century

Materials

(Enter categories from instructions)

foundation Wood, Granite
roof Asphalt
walls Wood
other Brick, Wood

Narrative Description

(Describe the historic and current condition of the property on one or more continuation sheets.)

8. Statement of Significance

Applicable National Register Criteria

(Mark "x" in one or more boxes for the criteria qualifying the property for National Register listing)

- A Property is associated with events that have made a significant contribution to the broad patterns of our history.
- B Property is associated with the lives of persons significant in our past.
- C Property embodies the distinctive characteristics of a type period, or method of construction or represents the work of a master, or possesses high artistic values, or represents a significant and distinguishable entity whose components lack individual distinction.
- D Property has yielded, or is likely to yield information important prehistory or history.

Criteria Considerations

(Mark "X" in all the boxes that apply.)

- A** owned by a religious institution or used for religious purposes.
- B** removed from its original location.
- C** a birthplace or a grave.
- D** a cemetery.
- E** a reconstructed building, object, or structure.
- F** a commemorative property.
- G** less than 50 years of age or achieved significance within the past 50 years.

Areas of Significance

(Enter categories from instructions)

Architecture

Significant Dates

ca. 1831
1909

Significant Person

(Complete if Criterion B is marked above)

Cultural Affiliation

N/A

Period of Significance

ca. 1831-1936

Architect/Builder

Narrative Statement of Significance

(Explain the significance of the property on one or more continuation sheets.)

9. Major Bibliographical References

Bibliography

(Cite the books, articles, and other sources used in preparing this form on one or more continuation sheets.)

Previous documentation on file (NPS)

- preliminary determination of individual listing (36 CFR 67) has been requested.
- previously listed in the National Register
- previously determined eligible by the National Register
- designated a National Historic Landmark
- recorded by Historic American Buildings Survey # _____
- recorded by Historic American Engineering Record # _____

Primary Location of Additional Data

- State Historic Preservation Office
- Other State agency
- Federal agency
- Local government
- University
- Other

Name of repository: _____

10. Geographical Data

Acreage of Property Approximately 3.6 acres

UTM References

(Place additional UTM references on a continuation sheet)

	Zone	Easting	Northing	Zone	Easting	Northing
1	<u>17</u>	<u>419580</u>	<u>3735360</u>	3	_____	_____
2	_____	_____	_____	4	_____	_____
	<u>See continuation sheet.</u>					

Verbal Boundary Description

(Describe the boundaries of the property on a continuation sheet.)

Boundary Justification

(Explain why the boundaries were selected on a continuation sheet.)

11. Form Prepared By

name/title Carrie Clark, Staff Researcher

organization Rainsford Development Corporation date 1 August 1994

street & number 108 1/2 Courthouse Square telephone (803) 637-5304

city or town Edgefield state SC zip code 29824

Additional Documentation

Submit the following items with the completed form:

Continuation Sheets

Maps

A **USGS map** (7.5 or 15 minute series) indicating the property's location.

A **Sketch map** for historic districts and properties having large acreage or numerous resources.

Photographs

Representative **black and white photographs** of the property.

Additional items (Check with the SHPO or FPO for any additional items)

Property Owner

(Complete this item at the request of the SHPO or FPO.)

name John W. Kemp, Jr., & Virginia Burton Kemp

street & number P.O. Box 24 telephone (803) 637-3364

city or town Edgefield state SC zip code 29824

Paperwork Reduction Act Statement: This information is being collected for applications to the National Register of Historic Places to nominate properties for listing or determine eligibility for listing, to list properties, and to amend existing listings. Response to this request is required to obtain a benefit in accordance with the National Historic Preservation Act, as amended (16 U.S.C. 470 et seq.).

Estimated Burden Statement: Public reporting burden for this form is estimated to average 18.1 hours per response including the time for reviewing instructions, gathering and maintaining data, and completing and reviewing the form. Direct comments regarding this burden estimate or any aspect of this form to the Chief, Administrative Services Division, National Park Service, P.O. Box 37127, Washington, DC 20013-7127; and the Office of Management and Budget, Paperwork Reductions Project (1024-0018), Washington, DC 20503.

United States Department of the Interior
National Park Service

**NATIONAL REGISTER OF
CONTINUATION SHEET**

Section 7 Page 5

RECEIVED 411

APR 12 1994

HISTORIC PLACES

INTERAGENCY RESOURCES DIVISION
NATIONAL SERVICE

Marshfield
Name of property

Edgefield County, South Carolina
county and State

Marshfield is located on Youngblood Road, off Weaver Road, in the vicinity of Trenton, S.C. The house is an L-shaped, one-story frame residence in a rural setting, and is a clear example of the evolution of an antebellum house in this time period. The original frame house (in the rear of the ell) had a lateral gable roof and consisted of two rooms, with an unattached kitchen, and with porches facing east and west. The original house, built ca. 1831, rests on a foundation of brick and granite rocks with a three-foot crawl space between the flooring and the ground. This original dwelling was wood-frame with unpainted exterior weatherboard. It has been painted on three sides, but the north side of the original building, concealed today by later construction, remains unpainted. Its two rooms presently are used as a kitchen and a sitting room, with a central fireplace in the middle of the two rooms. Western facade window panes in these rooms are six-over-six configuration.

The present kitchen measures 19' x 7' and houses an original fireplace. The ceiling is constructed of tongue and groove boards. The present sitting room shares the original fireplace, has two windows, and opens onto the original east facade. Facade is covered the entire width by a one-story porch, supported by three posts and turned balusters between posts.

An area 19 1/2' x 11', consisting of large stones embedded on top of the ground, marks the floor area where the original unattached kitchen once existed. The 6' wide brick and stone fireplace to this kitchen remains visible. Current occupant says that a handmade brick floor exists beneath this stone layer. This kitchen was torn down ca. 1961.¹

A small room 9' x 12' was added in 1909 and is attached to the rear of the present sitting room. Present occupant believes that the windows and doors from former "parson's rooms" no longer extant on the front of the house addition were used in this room, which today serves as a bedroom. The westward rear porch on the back of the sitting room adjoins this added bedroom via a door.

A "dogtrot" separates the original dwelling and a later antebellum addition. By this time, four additional rooms and a hallway had been added to the house. Southern rear double-panelled doors flanked by five 7 3/4" x 9 1/4" lateral-paned glass windows lead from the "dogtrot" into the hallway. Two rooms are located on each side of the hallway--a living room and bedroom to the west and a dining room and bedroom, both with wooden mantels, to the east. The roof on this addition has a hipped shape. Northern facade window panes are two-over-two. Northern facade double doors are wooden panelled, also flanked by five 7 3/4" x 9 1/4" lateral-paned glass windows. The cornices, called "country

¹Carrie Clark, Interview with Broadus Turner, current occupant, Marshfield, Trenton, S.C., 18 April 1993.

United States Department of the Interior
National Park Service

**NATIONAL REGISTER OF HISTORIC PLACES
CONTINUATION SHEET**

Section 7 Page 6

Marshfield
name of property
Edgefield County, South Carolina
county and State

Chippendale crown," above these two front doors is indicative of woodwork seen over the front doors of four other residences in Edgefield County.² The north facade porch extends the entire width of the addition. This porch, supported by six columns, has turned balusters between them. Six cement steps lead up to the porch. The four front windows of the two front rooms have two-over-two panes.

Several structural changes have taken place on this addition. Two small parson's rooms located on the north facade were demolished in 1909, and a bathroom was added to the rear of the eastern back bedroom at the same time. A sunroom with nine-over-six windows was added to the northeastern side of the house in the 1930s.³

There are four outbuildings near the house, two of which contribute to the historic character of the property and two of which do not contribute. A contributing early-nineteenth century shed or "smokehouse", constructed of hand-hewn and pegged timbers, measures 16'5" x 13' and is located southwest of the house. A contributing early-nineteenth century house, constructed of hand-hewn and pegged timbers and containing a stone fireplace, measures 27' x 18' and is located southeast of the house. A noncontributing modern frame garage is located southeast of the house, and a noncontributing modern wellhouse is also located southeast of the house.⁴

A family cemetery located southwest of the house also contributes to the historic character of the property. The cemetery enclosure, which measures 28' x 30 1/2', is an iron fence with a gate marked "1903." Eight members of the Marsh family are buried in the cemetery, including Sivil Darby Marsh (1776-1855); her son Samuel Marsh (1813-1878) and his wife Deborah Rinehart Marsh (1843-1903); her son Benjamin Marsh (1809-1869); her daughter Sarah Shiles Marsh (1810-1879); her daughter Elizabeth Marsh (1811-1888); and her grandson William B. Marsh (1863); Local tradition identifies an unmarked ground indentation as the grave of John Marsh (1776-1855), husband of Sivil Darby Marsh, which was moved from another cemetery on the property to this family cemetery during the 1930s.⁵

²Ibid. Other locations include Darby Plantation in Trenton; the Dobson House on Columbia Road in Edgefield; the Morgan House on Jeter Street in Edgefield; and the Mims House on Main Street in Edgefield.

³See Attachment A.

⁴See Attachment B.

⁵Carrie Clark, Interview with Broadus Turner, Marshfield, Trenton, S.C., 18 April 1993. See also Attachment C.

United States Department of the Interior
National Park Service

**NATIONAL REGISTER OF HISTORIC PLACES
CONTINUATION SHEET**

Section 8 Page 7

Marshfield
name of property
Edgefield County, South Carolina
county and State

Marshfield, located near Trenton in rural Edgefield County, is an excellent example of antebellum residential architecture in this region of South Carolina.

The main house is architecturally intact and represents at least two or three building campaigns ranging from an early nineteenth century core through early twentieth century alterations. It is an excellent example of the evolution of a vernacular dwelling, illustrating the growth of the house over time based on both family needs and on changing styles and tastes.

The Marsh family cemetery, which is located immediately behind the house, is a contributing resource within the boundaries of the nominated property. Seven Marsh family members are buried there in marked graves, with two others presumed buried inside the iron fence enclosure and an additional family member presumed buried in the vicinity but outside the enclosure.⁶

Family tradition places Marshfield or "the Old Marsh Homeplace" existing as early as 1776, as this is traditionally the birthplace of Sivil Darby Marsh (1776-1855), wife of John Marsh and daughter of Benjamin Darby, who bought large landholdings in this area as early as 1794.⁷ Darby's landholdings became known as the "Darby Place" or "Darby Tract" and were usually described as being "on both sides of the road leading to the Pine House from Edgefield Court House."⁸ It is likely that Benjamin Darby sold or gave this property to his daughter Sivil. John Marsh (1776-1855), Sivil's husband, is listed in the Edgefield County Industrial Census for 1850 as owning a "machine shop (turning and circle sawing)" on the plantation, producing "bedsteads, lathes, and tablelegs."⁹ Their son Samuel (1813-1878) inherited the property and farmed it until his death, when it passed to his wife, Deborah Ann Rinehart Marsh (1843-1903).¹⁰ Samuel Marsh's will stipulated that his property was to go to his children after his wife's

⁶See Attachment C.

⁷State Plat Book 33, p. 48, South Carolina Department of Archives and History, Columbia, S.C. Darby bought 100 acres on Horn Creek on both sides of a wagon road near land belonging to Ezekeal McClendon; surveyed by Robert Lang, 21 December 1794.

⁸Deed Book E, p. 168, Edgefield County Clerk of Court, Edgefield County Courthouse, Edgefield, S.C.

⁹Schedule 5: Products of Industry in the District of Edgefield of South Carolina, 1850, p. 597. S.C. Department of Archives and History Microcopy Number 2, Columbia, S.C.

¹⁰Will Book F, p. 303, Edgefield County Probate Office, Edgefield, S.C.

United States Department of the Interior
National Park Service

**NATIONAL REGISTER OF HISTORIC PLACES
CONTINUATION SHEET**

Section 8 Page 8

Marshfield
name of property
Edgefield County, South Carolina
county and State

death, and when she died in 1903, their son Samuel B. Marsh inherited the property and deeded it to his two sisters, Mattie Q. and Daisy F. Marsh.¹¹ Mattie sold her half of the property to Daisy in 1907.¹² Daisy Marsh Yonce sold the property to her husband Andrew C. Yonce in 1908, and Yonce left the property to his daughter Sarah Marsh Yonce in 1936.¹³ Miss Yonce deeded the property to the present owners, John and Virginia Kemp, in 1993.¹⁴

The fact that there are several outbuildings on the property provides additional evidence of a larger working plantation and farmstead in the antebellum era. In 1867 Samuel Marsh brought 2,000 pounds of guano from Wilcox, Gibbs, and Company of Augusta to fertilize his "crops of cotton, corn, wheat and other grains" grown during that year.¹⁵ Apparently, down through the years the soil at Marshfield, which is classified as "Norfolk loamy sand," has remained fertile and productive, as the property continues to be a successful farm today, having produced asparagus in the 1930s and leasing acreage until 1993 for peach orchards. A 1981 soil survey of Edgefield County notes, "this soil has good suitability for row crops, small grain, hay, pasture, and peaches."¹⁶ Evidence of landscaping and gardening activity over time is very apparent when considering large trees and shrubs on the property. Sivil Darby Marsh, in an entry in her 1789 diary, noted, "we're gathering the wild pease. They carry us far into the winter."¹⁷ These wild pea vines are still growing on the property.

The archaeological remains of additional outbuildings on the farm are also likely to exist and to contain sufficient integrity, given the rural character of the landscape, to be capable of yielding information about the operation of the Marsh farm throughout the nineteenth century and in the

¹¹Deed Book 18, p. 575, Edgefield County Clerk of Court, Edgefield County Courthouse, Edgefield, S.C.

¹²Deed Book 22, p. 322, Edgefield County Clerk of Court, Edgefield County Courthouse, Edgefield, S.C.

¹³Deed Book 22, p. 588, Edgefield County Clerk of Court, Edgefield County Courthouse, Edgefield, S.C.; File 172, Package 6733, Edgefield County Probate Office, Edgefield, S.C.

¹⁴Deed Book 144, p. 158, Edgefield County Clerk of Court, Edgefield County Courthouse, Edgefield, S.C.

¹⁵Deed Book N, p. 15, Edgefield County Clerk of Court, Edgefield County Courthouse, Edgefield, S.C.

¹⁶U.S. Department of Agriculture, Soil Survey of Edgefield County, South Carolina, (March 1981), p. 29.

¹⁷Carrie Clark, Interview with Broadus Turner, Marshfield, Trenton, S.C., 18 April 1993.

United States Department of the Interior
National Park Service

**NATIONAL REGISTER OF HISTORIC PLACES
CONTINUATION SHEET**

Section 8 Page 9

Marshfield
name of property
Edgefield County, South Carolina
county and State

first half of the twentieth century, as well as about the everyday life of a typical South Carolina farm family of the period. It is likely that such historic period archaeological sites might contribute further to the significance of Marshfield Plantation. Future archaeological investigations should be encouraged to determine the possible eligibility of the property for the National Register under Criterion D.

United States Department of the Interior
National Park Service

**NATIONAL REGISTER OF HISTORIC PLACES
CONTINUATION SHEET**

Section 9 Page 10

Marshfield
name of property
Edgefield County, South Carolina
county and State

BIBLIOGRAPHY

County Records in Courthouse and Probate Office

Edgefield County Courthouse, Edgefield, S.C.
Deed Books, Clerk of Court
Edgefield County Probate Office, Edgefield, S.C.
Estate Records
Will Books

County Records on Microfilm at S.C. Department of Archives and History
Edgefield County Deeds and Plat Books

Schedule 5, Products of Industry in the District of Edgefield of South
Carolina, 1850. S.C. Department of Archives and History Microcopy Number 2.

Interviews

John Kemp, Marshfield, Trenton, S.C., 18 April 1993.
Broadus Turner, Marshfield, Trenton, S.C., 18 April 1993.

Published Sources

Harmon, Lillian Marsh. The Plantation Marshes. Edgefield: The Edgefield
Advertiser, 1964.
U.S. Department of Agriculture, Soil Survey of Edgefield County, South
Carolina, March 1981.

United States Department of the Interior
National Park Service

**NATIONAL REGISTER OF HISTORIC PLACES
CONTINUATION SHEET**

Section 10 Page 11

Marshfield
name of property
Edgefield County, South Carolina
county and State

Verbal Boundary Description

The boundary of the nominated property is shown as the pencil line labeled "Marshfield" on the accompanying Edgefield County Tax Map 158, Parcel 5, drawn at a scale of 1" = 400'.

Verbal Boundary Justification

The nominated property includes the main house and its associated historic outbuildings and family cemetery and includes the intact historic resources associated with Marshfield.

United States Department of the Interior
National Park Service

**NATIONAL REGISTER OF HISTORIC PLACES
CONTINUATION SHEET**

Section PHOTOGRAPHS Page 12

Marshfield
name of property
Edgefield County, South Carolina
county and State

The following information is the same for each of the photographs:

Name of Property: Marshfield
Location of Property: Youngblood Road
Trenton vicinity, Edgefield County, South Carolina
Name of Photographer: Carrie Clark, Rainsford Development Inc.,
Edgefield, S.C.
Location of Negatives: S.C. Department of Archives & History,
Columbia, S.C.
Date of Photograph: 19 November 1992







1. Facade, facing S
2. Facade, Window detail, facing S
3. Facade, Cornice detail, facing S
4. Facade, Left oblique, facing SW
5. Left elevation with original ell at left, facing W
6. Rear elevation with original ell at left, facing N
7. Original ell, facing N
8. Original ell, detail of porch to addition, facing N
9. Original ell, gable detail, facing N
10. Original ell, with additions, facing NE
11. Original ell, rear porch, facing SE
12. Slave cabin, Right oblique, facing SW
13. Slave cabin, Facade, facing W
14. Slave cabin, Left elevation, facing N
15. Slave cabin, Rear elevation (C) with well house (L) and garage (R),
facing E
16. Slave cabin, Interior
17. Original kitchen fireplace, facing NW
18. Present kitchen, interior
19. Smokehouse, Left oblique, facing N
20. Garage, right oblique (L) with well house (left center), smokehouse (right
center), & main house (R), facing SW
21. Marsh Family cemetery, facing W
22. Marsh Family cemetery, detail of Samuel & Deborah Marsh gravestone, facing
SW
23. Marsh Family cemetery, detail of iron gate
24. Marsh Family cemetery showing relationship to main house, facing E

ATTACHMENT A

MARSHFIELD
Trenton, S.C.

Drawing Not to Scale



	Original Building pre 1831		Porches
	Building Addition 1831		Chimneys
	Building Changes 1909, 1930's, 1961		Cemetery

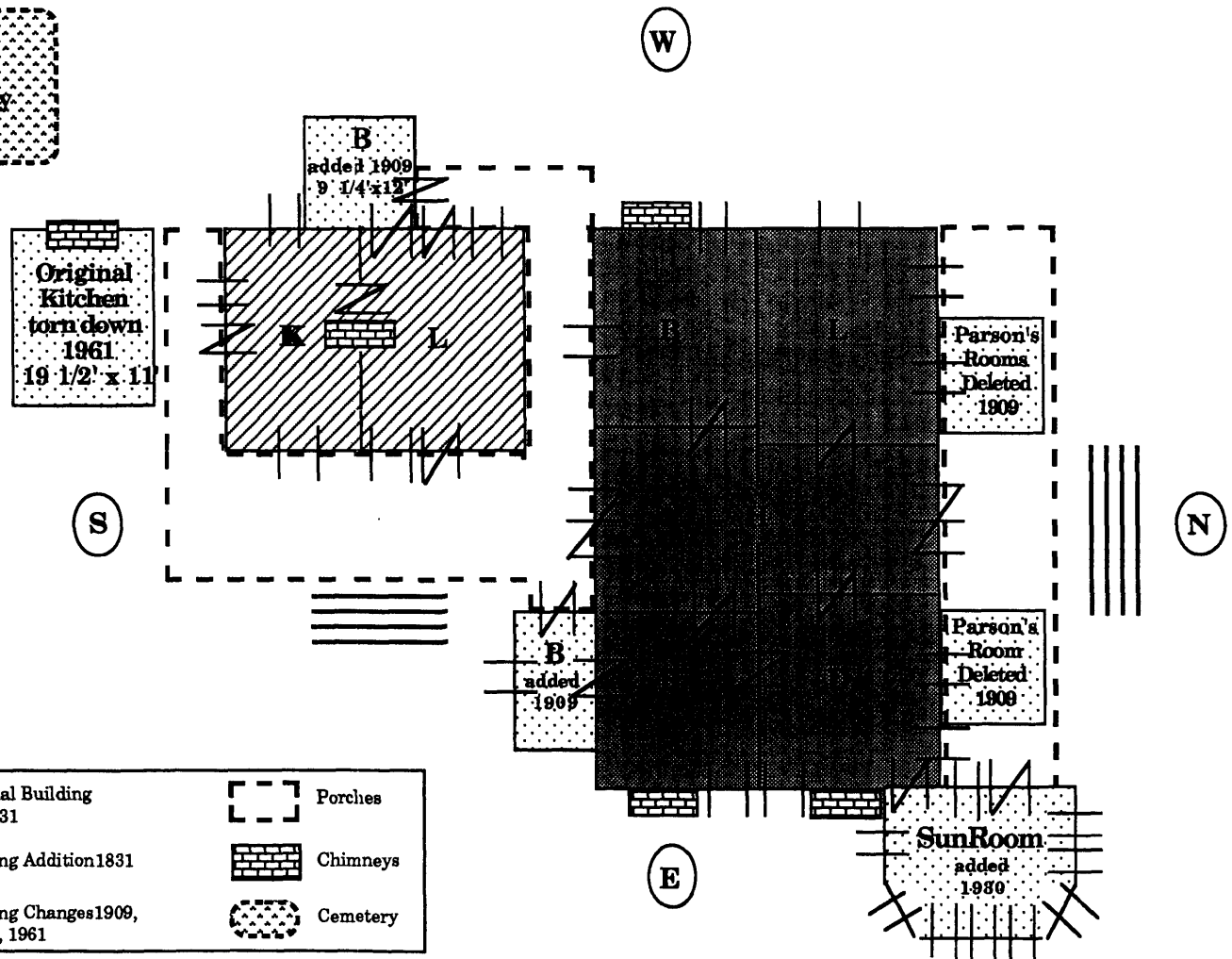

**ATTACHMENT B
MARSHFIELD
Trenton, S.C.**

Drawing Not to Scale

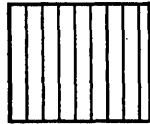

Wood Frame 16' 5" x 13' Shed; earthen foundation; hand-hewn pegged timbers, 18th century, originally a "smoke-house"

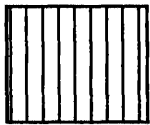

Wood Frame Garage; Modern 1930's

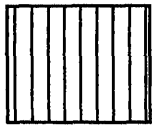

Wood Frame 27'x18' Slave Cabin; 18th Century; wooden pegged, hand-hewn beams



Wood Frame Well House; Modern

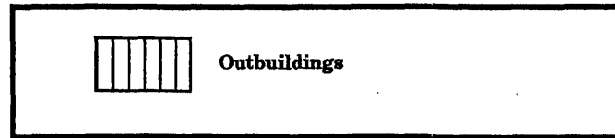

Outbuildings

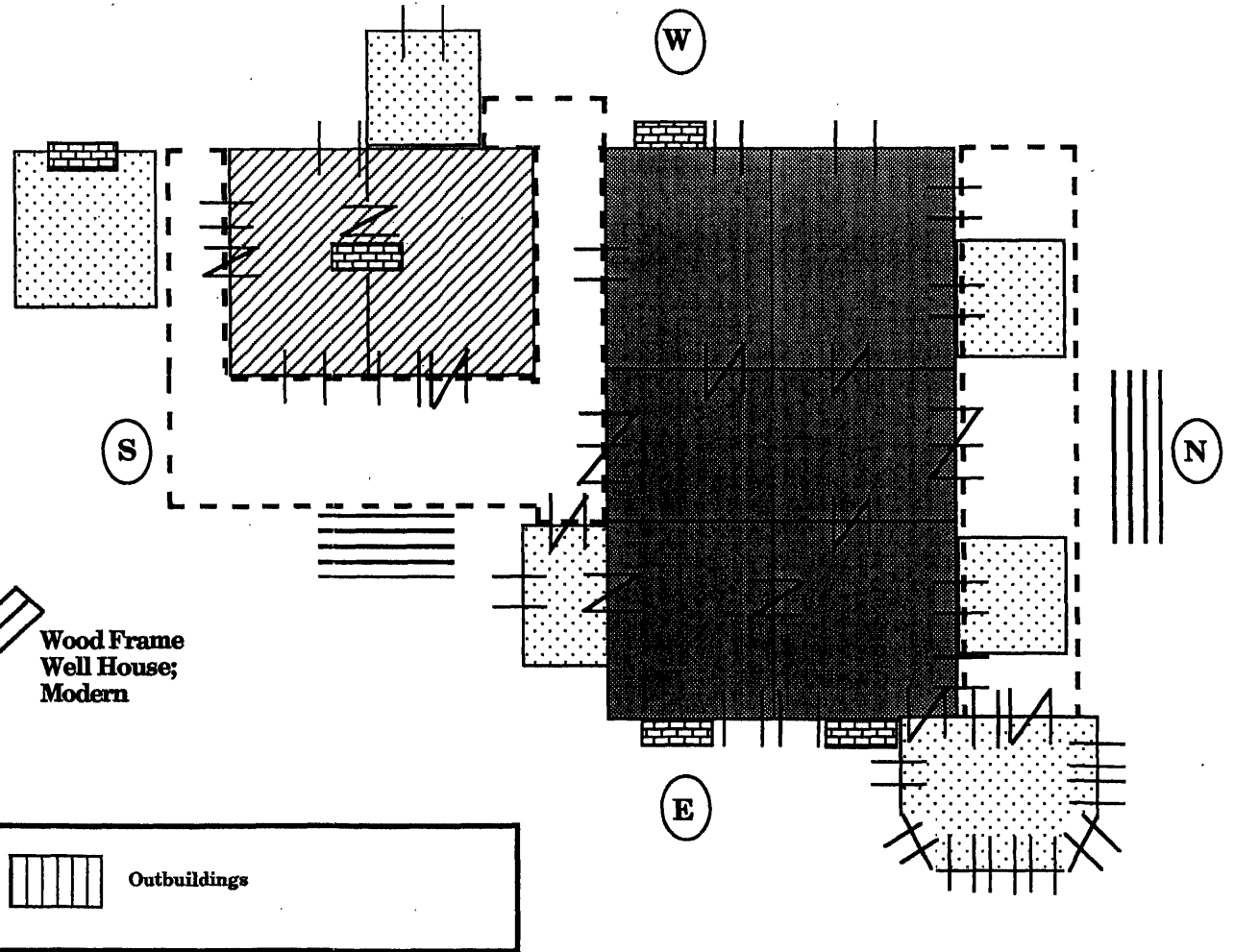

ATTACHMENT C
MARSHFIELD FAMILY CEMETERY
Trenton, S.C.
Grave Locations

Iron Fence measures 28 feet by 30 1/2 feet

MARSH
United 1863

Our Uncle
Benjamin Marsh
b. 5/16/1809
d. 8/24/1809



Our Grandma
Sevil Darby Marsh
b. 12/24/1776
d. 8/14/1855



Our Brother
William B. Marsh
b. 4/5/1863
d. 4/22/1863

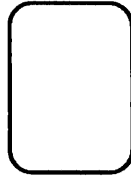

Samuel Marsh
b. 2/9/1813
d. 3/22/1878
Father



Deborah Rinehart
b. 5/15/1843
d. 5/15/1903
Mother

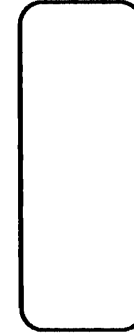

Our Aunt
Sarah Shiles Marsh
b. 6/14/1810
d. 10/23/1879



Our Aunt
Elizabeth Marsh
b. 9/21/1811
d. 7/6/1888



Unmarked
Indention
(supposedly grave of
John Marsh)



Unmarked
Indention

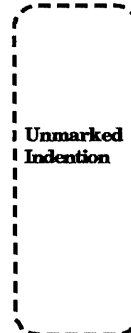

Unmarked
Indention

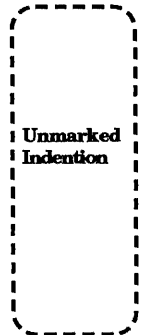

Gate
"1903"



United States Department of the Interior
National Park Service

National Register of Historic Places
Continuation Sheet

Section number _____ Page _____

SUPPLEMENTARY LISTING RECORD

NRIS Reference Number: 94001561

Date Listed: 1/9/95

Marshfield
Property Name

Edgefield SOUTH CAROLINA
County State

Multiple Name

This property is listed in the National Register of Historic Places in accordance with the attached nomination documentation subject to the following exceptions, exclusions, or amendments, notwithstanding the National Park Service certification included in the nomination documentation.

Signature of the Keeper

1/10/95
Date of Action

=====
Amended Items in Nomination:

Section No. 3

This nomination is amended to show that the South Carolina SHPO recommends that the property be considered significant at the local level.

The cemetery being nominated is the one shown on Attachment A as Cemetery No. 1. Too little information is available on Cemetery No. 2 to consider it contributing to the significance of the property; it is not included within the boundaries.

This information was provided by the South Carolina SHPO (1/9/95)

DISTRIBUTION:

- National Register property file
- Nominating Authority (without nomination attachment)