

DEC 20 1988

3558

KENTUCKY HISTORIC RESOURCES  
Individual Inventory Form

Resource # Me-150  
Mercer County

1. Name of Resource: Peter Dunn House

2. Original Owner: Peter Rench Dunn

3. Other Names: Lone Pine

4. Prehistoric Site Building X Object  
Historic Site Structure Other

5. Location: West of old US 127 south of McAfee

6. Owner's Name: Harry Strickland [ P ]

7. Owner's Address: Louisville Road Harrodsburg, Ky. 40330

8. Evaluation: [ N ]

9. Recognition & Date: Nat.Landmark \_\_\_\_\_ Local Landmark \_\_\_\_\_  
Nat.Register \_\_\_\_\_ HABS/HAER \_\_\_\_\_  
Highway Marker \_\_\_\_\_ KY Inventory 1971, 1980  
KY Landmark Certificate 1971

10. N.R.Status & Date:

11. N.R.Group: District Name: [ ]  
Mult.Resource Area: Mercer County [ ]  
Thematic Name: [ ]

12. Historical Theme: Primary: Architecture [ 030 ]  
Secondary: [ ]  
Other: [ ]

13. Statement of Significance: See Attached.

16. Date: Original Building 1840 [ 7 ]  
Addition [ ]

17. Style: Federal/ [ 31 ]  
[ ]

18. Architect/Builder: Unknown

19. No. of Stories: [ 1.0 ]

20. Original Floor Plan: Central Passage [ CP ]

21. Single Pile X Double Pile N.A.

22. Roof Form & Material: Original \_\_\_\_\_  
Gable Not Original \_\_\_\_\_

23. Structural Material: Brick [ B ]

24. Exterior Material: Brick : Flemish bond [ B ]

25. Foundation Material: Stone [ S ]

26. Major Alterations: None \_\_\_\_\_  
Moved/Rebuilt Other \_\_\_\_\_  
Additions To rear \_\_\_\_\_

27. Special Features:

28. Outbuildings: two [ ]

29. Original Function: Single family dwelling [ 01A ]

30. Present Use: Single family dwelling [ 01A ]

31. Condition: Good [ G ]

32. Endangered: Yes \_\_\_\_\_  
No X

33. Attach Photos: Roll: Photo Nos: No. of Slides:  
4 4-11



14. History: Peter Dunn bought 190 acres including this house site in 1822. He was active in the agricultural enterprises of horse raising and pork packing. He was also a significant contributor to the New Providence Presbyterian Church.



Additional History attached.

15. Source of historical information and/or contact person: KHC Inventory Form: Clay Lancaster, 1981  
Frances Keightly, 1970

34. Prepared by: H. Powell/F. Keightly  
35. Organization: Landmark Association  
36. Date: 1986  
37. New Survey \_\_\_\_\_ Resurvey X

KENTUCKY HISTORIC RESOURCES  
 Individual Inventory Form

Resource # Me-150

38. UTM Point of Primary Building: Zone Easting Northing 39. G.I.S. Mod. [ ]  
 Quadrant: Harrodsburg -- 688700 4190590 40. Coordi.Accuracy [ ]

41. UTM Points of Boundary (for N. R. eligible sites only):

A. ----- D. -----  
 B. ----- E. -----  
 C. ----- F. -----

42. Total Acreage in Present Property: 43. Acreage included in proposed N.R. boundary:

44. Site Plan (and boundary description and justification for N.R. sites):

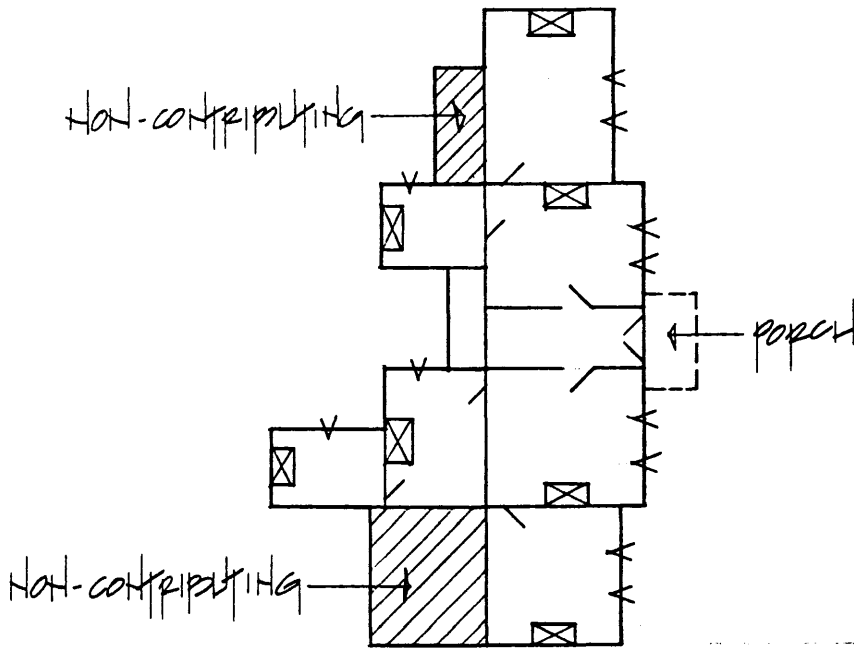

45. Description and House Plan:

The Dunn House, or Lone Pine, is a one-story brick structure composed of a central pavillion and two wings. The core or central pavillion is five bays with a central hallway. Each side of the hallway is flanked by a single room with an interior end chimney. The entrance is flanked by pilasters, sidelights, and a transom. A one-bay pedimented porch supported by paired squared posts covers the entrance. The two wings on either side of the main block of the house are recessed slightly and are two bays. Windows contain a glazing of 6 over 6. Flared lintels are found over each window in the front facade. Two one-story wings extend to the rear. The ell on the south side also contains the kitchen. The foundation under the entire structure is stone. To the south is a stone outbuilding with a gable roof.





Form 10-445  
(5/62)

<p>1. STATE <b>Kentucky</b>          COUNTY <b>Mercer</b>          TOWN <b>Harrodsburg</b> VICINITY <b>4 Mi. N.</b>          STREET NO. <b>On the Louisville Road</b></p> <p>ORIGINAL OWNER <b>Peter Rench Dunn</b>          ORIGINAL USE <b>Dwelling</b>          PRESENT OWNER <b>Mr. and Mrs. H. T. Asbury</b>          PRESENT USE <b>Dwelling</b>          WALL CONSTRUCTION <b>Brick</b>          NO. OF STORIES <b>One</b></p>	<p>HISTORIC AMERICAN BUILDINGS SURVEY INVENTORY</p> <p>2. NAME <b>Lone Pine</b></p> <p>DATE OR PERIOD <b>1825</b>          STYLE <b>Georgian</b>          ARCHITECT          BUILDER</p> <p>3. FOR LIBRARY OF CONGRESS USE</p>
<p>4. NOTABLE FEATURES, HISTORICAL SIGNIFICANCE AND DESCRIPTION <span style="float: right;">OPEN TO PUBLIC <b>No</b></span></p> <p>Peter Dunn bought his first property in 1822, two years after he married Jane Buchanan, a cousin of Pres. James Buchanan. The core of his extensive holdings, 190 acres, was purchased from John McGee on the east side of Salt River. He later expanded his estate to include part of McAfee and it stretched all the way from the Salt River to the old Frankfort turnpike, embracing between 1000 and 2000 acres. He furnished the ground and a large part of the funds for the New Providence Pres. Church which was organized by the McAfees in 1784. He bred fine horses, was active in banking in Harrodsburg and Danville and served as president of one of the banks in Harrodsburg. He also operated a hemp business at McAfee and a large pork packing plant at Oregon which shipped supplies as far as New Orleans. He died March 5, 1858. (Hist. of Ky. by E. Polk Johnson, Vol. 3, p. 1164-1165; Mercer Co. Ct. Records - Deed Book 12, p. 539, Deed Bk. 16, p. 459, Deed Bk. 20, p. 235, Marriage Book 1, p. 256.)</p> <p>The foundation is rough stone with exterior and interior brick walls 14 inches thick. The brick chimneys are enclosed with a fireplace in every room. Each fireplace wall has panelling and twin cupboards except the living room. In the dining room there is panelling above the fireplace opening. The transverse hall is flanked by two large rooms and all others appear to be wings. The mantels are original and plain. Woodwork is grooved with a bullseye in each corner. Windows are double hung with six over six panes. Baseboards are 16 inches high. Doors are panelled with three panels across the top and three vertical on the lower part. The floors are original ash. The front doorway has four paned sidelights and a transom. The architrave is grooved and carved to match the interior trim.</p> <p>5. PHYSICAL CONDITION OF STRUCTURE <span style="float: right;">Endangered Interior <b>excellent</b> Exterior <b>excellent</b></span></p>	
<p>6. LOCATION MAP (Plan Optional)</p>	<p>7. PHOTOGRAPH</p>
<p>8. PUBLISHED SOURCES (Author, Title, Pages)          INTERVIEWS, RECORDS, PHOTOS, ETC.  <b>Inspection of the house and the references cited above.</b></p>	<p>9. NAME, ADDRESS AND TITLE OF RECORDER  <b>Mrs. James M. Keightley</b>  <b>744 Beaumont Ave.</b>  <b>Harrodsburg, Ky. 40330</b>  <b>Mercer Rep. for Ky. Heritage Com.</b></p> <p>DATE OF RECORD <b>Oct. 8, 1970.</b></p>

SUPPLEMENTAL INFORMATION AND PHOTOGRAPHS MAY BE ADDED ON SHEET OF SAME SIZE



Continuation Sheet: Me-150 Peter Dunn House

**Significance Statement**

The Peter Dunn House is significant under Criterion C for the mid-nineteenth century as an example of a single-pile, central passage plan, flanked by two one-room wings. The stone outbuilding dates to the same period as the house.

**Verbal Boundary Justification**

The boundary was chosen to incorporate the house and the contributing outbuilding which maintains integrity. It also contains two noncontributing buildings which are located within the domestic space and maintain the scale of domestic buildings. The boundary follows the yard-fence on the north, west and east sides. On the south side, the boundary follows the yard fence until it reaches the stone structure in the southwest corner. At that point the boundary follows the east, south, and west walls of the stone structure since it retains integrity and contributes to the significance of the property since it was during the same time period as the house. Beyond the yard-fence, on all sides is pasture which does not relate to the domestic space.

The boundary contains two contributing buildings.