

ARCHITECTURAL/HISTORICAL SURVEY

DAVENPORT, IOWA

The Architects Office
 Wehner, Nowysz, Pottschull and Pfiffner
 801 day building, iowa city iowa 52240

DAVENPORT COMMUNITY DEVELOPMENT DEPARTMENT
 IOWA DIVISION OF HISTORIC PRESERVATION

SITE # 82-10-3-W2303 MAP # 2

HIST. DIST. _____

NAME August F. Martzahn House H C

ADDRESS 2303 W. ^{3rd} Third Street

LEGAL DES. Parker's Add. 7 Lot 8 & the E 8
SUB-DIVISION BLOCK PARCEL SUB-PARCEL of lot 7

UTM 3 15 699160 4599260 ACREAGE -1 ZONE R-4D
EASTING NORTHING

OWNER Ben J. Rowley & Wife
2303 W. 3rd St., Davenport, IA 52802

TITLE H. _____
(IF DIFF)

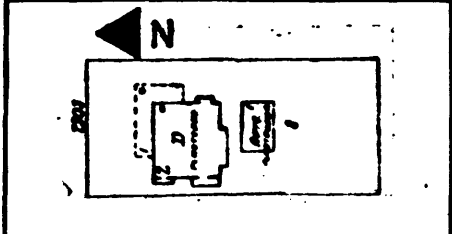

SITE SHEET

DESCRIPTION

FORM 2½ story rectangular hipped roof w/corner veranda CONST. DATE 1911
 MATERIALS Stucco over frame ARCH. STYLE Neo-Georgian Rev. - Craftsman/Prairie
 FENESTRATION Rectangular - various sizes
 DIST. FEATURES Craftsman wood details and leaded glass
 ALTERATIONS None of significance
 SITE & RELATED STR. None of significance

ARCHITECTURE

STATEMENT

This is one of several houses in the survey area that combine a Neo-Georgian Revival mass with Craftsman/Prairie Style elements. A two-tone stucco facade, use of geometrically-patterned leaded glass, large rectilinear brackets (at the entrance), and wide eaves with projecting rafter ends all speak to Craftsman influences. The roof dormers are of interest, particularly for the short posts that support deep cornice returns. Well-preserved, this house is a good illustration of the variety of stylistic influences present in pre-World War I Davenport, and how the popular tradition of combining elements from several styles continued to thrive into the 20th Century.

SOURCES

SIGNIFICANCE

HISTORY

DESCRIPTION

This house was constructed in 1911 by August F. Martzahn, president and general manager of Davenport Slaughter and Rendering Company. Martzahn began his career as a butcher, establishing the slaughter and rendering firm in 1900. The company was the only one of its kind in the city and one of the larger firms in eastern Iowa. Martzahn and his wife Minnie, resided here for a number of years.

SOURCES

City Directories, 1910, 1911, 1912.
Downer, Harry E., History of Davenport and Scott County, Iowa, Vol. II,
Chicago: S. J. Clarke Publishing Co., 1910, pp. 314-315.

ARCHITECTURAL HISTORIAN: Martha Bowers

HISTORIAN: MARLYS SVENDSEN - ROESLER

SURVEY COMP 1981

EVALUATION

ARCHITECTURAL

I. ARCH. EVALUATION Good
II. ENVIR. STATURE Tissue
III. INT. OF CONTEXT Good
IV. INT. OF FABRIC Excellent

LEVEL OF SIGNIFICANCE:

NAT. STATE LOCAL N. ELIG.

HISTORICAL

I. THEME(S) OF SIGNIFICANCE:

A. PRIMARY _____

B. SECONDARY _____

II. LEVEL OF SIGNIFICANCE

NAT. STATE LOCAL

III. NRHP

ELIGIBLE NOT ELIGIBLE

HISTORIC DISTRICT CLASSIFICATION

FOR DIVISION OF HISTORIC PRESERVATION USE ONLY

1. DATE RECEIVED _____

2. DATE OF STAFF EVALUATION _____

	A. ARCHITECTURAL	B. HISTORICAL
ELIGIBLE FOR N.R.H.P.	<input type="checkbox"/>	<input type="checkbox"/>
NOT ELIGIBLE FOR N.R.H.P.	<input type="checkbox"/>	<input type="checkbox"/>

3. N.R.H.P. ACTION

A. STATE REVIEW COMM. APP. DISAPP. TABLED DATE _____

B. FEDERAL REVIEW APP. DISAPP. TABLED DATE _____

4. D.H.P. SOURCES

COUNTY RESOURCES
 W'SHIELD SURVEY
 NRHP
 GRANT _____

DET. OF ELIGIBILITY

R. & C. _____

DAVENPORT A/H SURVEY

5. SUBJECT TRACES

6. PHOTO

1600-5