

A. HISTORIC NAME Masonic Temple
 D. ADDRESS 301 Chestnut Street
 SR _____ NR _____ NHL _____ HABS _____ HAER _____

B. COUNTY Vanderburgh C. NUMBER 163 - 196 - 00667
 E. TWP/CITY Pigeon/Evansville F. QUAD NAME Evansville, Ind. - Ky.
 UTM REFERENCES 18 | | | | | | | | | | | | | | | | | | | | | |

STATE OF INDIANA DEPARTMENT OF NATURAL RESOURCES INDIANA HISTORIC SITES AND STRUCTURES INVENTORY REVISED 1977

MOUNT CONTACT PRINTS HERE

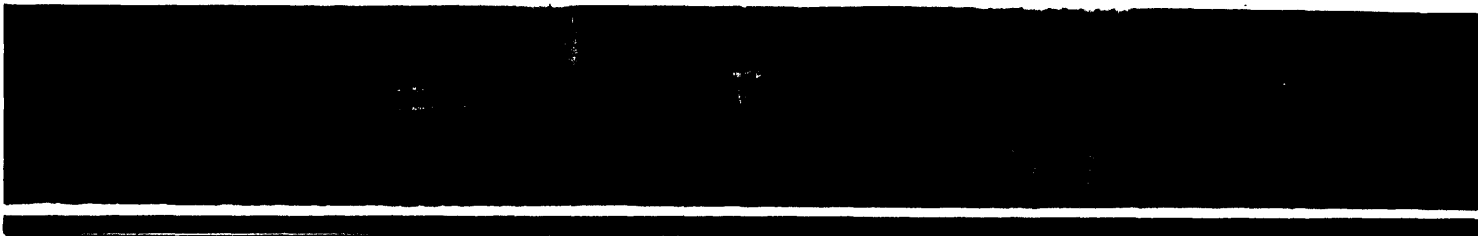

<p>1. COMMON NAME _____</p> <p>2. OWNERSHIP _____ Public <input checked="" type="checkbox"/> Private</p> <p>3. VISIBLE <input checked="" type="checkbox"/> Yes _____ No</p>	<p>4. PROPERTY'S MAILING ADDRESS <u>301 Chestnut Street</u> <u>Evansville, Indiana 47713</u></p>	<p>5. LOCATION NOTES <u>Eastern Enlargement Blk. 10</u> <u>lots 1-3</u> <u>SW 1/4 NW 1/4 NW 1/4 SE 1/4 Sec 30 T6S R10W</u></p>
---	--	---

<p>6. USE</p> <table border="0"> <tr> <td>PRESENT</td> <td>PAST</td> <td></td> <td>PRESENT</td> <td>PAST</td> </tr> <tr> <td>Residence <input type="checkbox"/></td> <td><input type="checkbox"/></td> <td>Military</td> <td><input type="checkbox"/></td> <td><input type="checkbox"/></td> </tr> <tr> <td>Govt./Pol. <input type="checkbox"/></td> <td><input type="checkbox"/></td> <td>Entertainment</td> <td><input type="checkbox"/></td> <td><input type="checkbox"/></td> </tr> <tr> <td>Commerce <input type="checkbox"/></td> <td><input type="checkbox"/></td> <td>Scientific</td> <td><input type="checkbox"/></td> <td><input type="checkbox"/></td> </tr> <tr> <td>Industrial <input type="checkbox"/></td> <td><input type="checkbox"/></td> <td>Religious</td> <td><input type="checkbox"/></td> <td><input type="checkbox"/></td> </tr> <tr> <td>Agriculture <input type="checkbox"/></td> <td><input type="checkbox"/></td> <td>Park</td> <td><input type="checkbox"/></td> <td><input type="checkbox"/></td> </tr> <tr> <td>Transportation <input type="checkbox"/></td> <td><input type="checkbox"/></td> <td>Museum</td> <td><input type="checkbox"/></td> <td><input type="checkbox"/></td> </tr> <tr> <td>Organization <input checked="" type="checkbox"/></td> <td><input checked="" type="checkbox"/></td> <td>Educational</td> <td><input type="checkbox"/></td> <td><input type="checkbox"/></td> </tr> <tr> <td>Other _____</td> <td></td> <td></td> <td><input type="checkbox"/></td> <td><input type="checkbox"/></td> </tr> </table>	PRESENT	PAST		PRESENT	PAST	Residence <input type="checkbox"/>	<input type="checkbox"/>	Military	<input type="checkbox"/>	<input type="checkbox"/>	Govt./Pol. <input type="checkbox"/>	<input type="checkbox"/>	Entertainment	<input type="checkbox"/>	<input type="checkbox"/>	Commerce <input type="checkbox"/>	<input type="checkbox"/>	Scientific	<input type="checkbox"/>	<input type="checkbox"/>	Industrial <input type="checkbox"/>	<input type="checkbox"/>	Religious	<input type="checkbox"/>	<input type="checkbox"/>	Agriculture <input type="checkbox"/>	<input type="checkbox"/>	Park	<input type="checkbox"/>	<input type="checkbox"/>	Transportation <input type="checkbox"/>	<input type="checkbox"/>	Museum	<input type="checkbox"/>	<input type="checkbox"/>	Organization <input checked="" type="checkbox"/>	<input checked="" type="checkbox"/>	Educational	<input type="checkbox"/>	<input type="checkbox"/>	Other _____			<input type="checkbox"/>	<input type="checkbox"/>	<p>7. ENDANGERED</p> <p>_____ Vacant</p> <p>_____ Neglected</p> <p>_____ Encroachment</p> <p>_____ Other _____</p>	<p>8. CATEGORY</p> <p>_____ District</p> <p><input checked="" type="checkbox"/> Building(s)</p> <p>_____ Structure</p> <p>_____ Site</p> <p>_____ Object</p>	<p>9. LOCAL LEGAL PROTECTIONS</p> <p>_____ Historic District</p> <p>_____ Landmark</p> <p>_____ Deed Restriction</p> <p>_____ Other _____</p>
PRESENT	PAST		PRESENT	PAST																																												
Residence <input type="checkbox"/>	<input type="checkbox"/>	Military	<input type="checkbox"/>	<input type="checkbox"/>																																												
Govt./Pol. <input type="checkbox"/>	<input type="checkbox"/>	Entertainment	<input type="checkbox"/>	<input type="checkbox"/>																																												
Commerce <input type="checkbox"/>	<input type="checkbox"/>	Scientific	<input type="checkbox"/>	<input type="checkbox"/>																																												
Industrial <input type="checkbox"/>	<input type="checkbox"/>	Religious	<input type="checkbox"/>	<input type="checkbox"/>																																												
Agriculture <input type="checkbox"/>	<input type="checkbox"/>	Park	<input type="checkbox"/>	<input type="checkbox"/>																																												
Transportation <input type="checkbox"/>	<input type="checkbox"/>	Museum	<input type="checkbox"/>	<input type="checkbox"/>																																												
Organization <input checked="" type="checkbox"/>	<input checked="" type="checkbox"/>	Educational	<input type="checkbox"/>	<input type="checkbox"/>																																												
Other _____			<input type="checkbox"/>	<input type="checkbox"/>																																												

<p>10. CONDITION</p> <p>_____ Excellent</p> <p><input checked="" type="checkbox"/> Good</p> <p>_____ Fair</p> <p>_____ Deteriorated</p> <p>_____ Ruins</p>	<p>11. BUILDING INTEGRITY</p> <p><input checked="" type="checkbox"/> Unaltered</p> <p>_____ Altered</p> <p>_____ Moved</p> <p>_____ Date _____</p>	<p>11a. Specify Alterations</p> <p>Removals _____</p> <p>Structural _____</p> <p>Replacement _____</p> <p>Additions _____</p>
--	--	---

12. DATE 1913 13. STYLE Neo-Classic 14. ARCHITECT/BUILDER Clifford Shopbell & Co.

15. DESCRIPTION 4- story; brick/stone; black masonry; Chestnut - 2nd St.
elevations "matt-brick" resembling stone; terr / 2nd elevations red brick;
6 bays wide, 11 deep; pilasters w. stone bases & capitals alternating w. small
inscriptions windows across 2-3rd story. Facade Material Brick/lim. stone

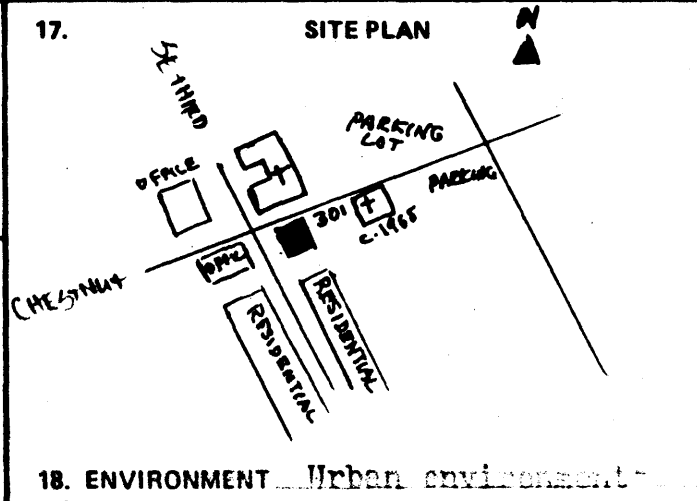

16. CUTBUILDINGS

single & multi-family housing,
modern office bldgs. and an 1860's
church.

19. AREAS OF SIGNIFICANCE

- | | | | |
|--|---|---|--|
| <input type="checkbox"/> Aboriginal | <input type="checkbox"/> Community Planning | <input type="checkbox"/> Humanities | <input type="checkbox"/> Religion |
| <input type="checkbox"/> Arts | <input type="checkbox"/> Education | <input type="checkbox"/> Indian | <input type="checkbox"/> Science/Technology |
| <input checked="" type="checkbox"/> Architecture | <input type="checkbox"/> Engineering | <input type="checkbox"/> Landscape Architecture | <input type="checkbox"/> Social/Ethnicity |
| <input type="checkbox"/> Commerce | <input type="checkbox"/> Environs/Neighborhoods | <input type="checkbox"/> Military | <input type="checkbox"/> Transportation |
| <input type="checkbox"/> Communications | <input type="checkbox"/> Exploration/Settlement | <input type="checkbox"/> Politics/Government | <input type="checkbox"/> Vernacular/Construction |
| <input type="checkbox"/> Other | | | |

Specify the significance for each area checked No perceptible modifications have been made to the Masonic Temple since its construction in 1913. The edifice bears a remarkable resemblance to the YMCA building at 5th + Vine Streets which was erected in the following year and was one of a half-dozen Masonic buildings designed by Shoppell in the region during this period.

20. INFORMATION SOURCES Various newspaper articles

21. SURVEYOR Joan Marchand/form by Pat Sides

22. DATE Surveyed 8/80; Photo'd 3/81

ATTACH
NEGATIVE
ENVELOPE
HERE

A. HISTORIC NAME Masonic Temple B. COUNTY Vanderburgh C. NUMBER 161 - 125 - 00662
D. ADDRESS 301 Chestnut Street E. TWP/CITY Pigeon/Evansville F. QUAD NAME Evansville, Ind. - K
SR _____ NR _____ NHL _____ HABS _____ HAER _____ UTM REFERENCES 18Q 414.919.50J 14210.249.01

STATE OF INDIANA DEPARTMENT OF NATURAL RESOURCES INDIANA HISTORIC SITES AND STRUCTURES INVENTORY REVISED 1977

MOUNT CONTACT PRINTS HERE



1. COMMON NAME _____
2. OWNERSHIP _____ Public Private _____
3. VISIBLE Yes _____ No _____
4. PROPERTY'S MAILING ADDRESS
301 Chestnut Street
Evansville, Indiana 47713
5. LOCATION NOTES
Eastern Encampment 512 10
lots 1-3 Tr (Cora: 20-55-14
SW 1/4 NW 1/4 SE 1/4 Sec 30 T6S R10W

6. USE	PRESENT	PAST	PRESENT	PAST	7. ENDANGERED	8. CATEGORY	9. LOCAL LEGAL PROTECTION
Residence	<input type="checkbox"/>	<input type="checkbox"/>	Military	<input type="checkbox"/>	<input type="checkbox"/> Vacant	<input type="checkbox"/> District	<input type="checkbox"/> Historic District
Gov./Pol.	<input type="checkbox"/>	<input type="checkbox"/>	Entertainment	<input type="checkbox"/>	<input type="checkbox"/> Neglected	<input checked="" type="checkbox"/> Building(s)	<input type="checkbox"/> Landmark
Commerce	<input type="checkbox"/>	<input type="checkbox"/>	Scientific	<input type="checkbox"/>	<input type="checkbox"/> Encroachment	<input type="checkbox"/> Structure	<input type="checkbox"/> Deed Restriction
Industrial	<input type="checkbox"/>	<input type="checkbox"/>	Religious	<input type="checkbox"/>	<input type="checkbox"/> Other _____	<input type="checkbox"/> Site	<input type="checkbox"/> Other _____
Agriculture	<input type="checkbox"/>	<input type="checkbox"/>	Park	<input type="checkbox"/>		<input type="checkbox"/> Object	
Transportation	<input type="checkbox"/>	<input type="checkbox"/>	Museum	<input type="checkbox"/>			
Organization	<input checked="" type="checkbox"/>	<input checked="" type="checkbox"/>	Educational	<input type="checkbox"/>			
Other _____				<input type="checkbox"/>			

10. CONDITION
 Excellent
 Good
 Fair
 Deteriorated
 Ruins
11. BUILDING INTEGRITY
 Unaltered
 Altered
 Moved
Date _____
11a. Specify Alterations
Removals _____
Structural _____
Replacement _____
Additions _____

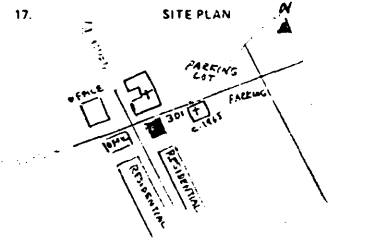

12. DATE 1913 13. STYLE Neo-Classical 14. ARCHITECT/BUILDER Clifford Shopbell & Co.
15. DESCRIPTION 4-story brick & limestone masonry, Chestnut - 2nd St.
construction "cast-in-place" masonry stone; heavy 2nd-story red brick;
6 bays wide, 11 deep; pilasters in blind screen & capitals alternating in small
inscriptions windows across 2-3rd flrs. Facade Material Brick/limestone
16. OUTBUILDINGS _____

18. ENVIRONMENT Urban environment -
single & multi-family housing,
modern office bldgs. and an 1800's
church.

19. AREAS OF SIGNIFICANCE
 Aboriginal Community Planning Humanities Religion
 Arts Education Indian Science/Technology
 Architecture Engineering Landscape Architecture Social/Ethnicity
 Commerce Environs/Neighborhoods Military Transportation
 Communications Exploration/Settlement Politics/Government Vernacular/Construction
 Other _____

Specify the significance for each area checked No perceptible modifications have been made to the Masonic Temple
since its construction in 1913. The edifice bears a remarkable resemblance to the VMAA
building at 5th & Vine Streets which was erected in the following year and was one of a
hand-drawn Masonic building designed by Shopbell in the region during this period.

20. INFORMATION SOURCES Various newspaper articles